



## C-PEN C610R Reader Pen User Guide

[Home](#) » [C-PEN](#) » C-PEN C610R Reader Pen User Guide 

### Contents

- [1 C-PEN C610R Reader Pen](#)
- [2 Content of box](#)
- [3 Buttons and connectors](#)
- [4 Get started](#)
- [5 Technical specification](#)
- [6 Documents / Resources](#)
  - [6.1 References](#)
- [7 Related Posts](#)



**C-PEN C610R Reader Pen**



### **Congratulations to your ReaderPen(TM).**

ReaderPen is designed with the purpose of being a reading assistant, and the objective is to make you an independent reader. Whether you need to read questions in an exam, do your homework, or simply want to read your favourite novel, we hope reading becomes less challenging and more enjoyable.

ReaderPen also supports literacy. The embedded word definition dictionaries make understanding so much easier. The purpose of this guide is to get you started. It does not provide a complete description of all functions and settings as they change by each firmware upgrade we provide. Therefore, for latest and more complete information check our website [www.cpen.com/product/readerpen](http://www.cpen.com/product/readerpen) and our Youtube channel [cpen.com/youtube](http://cpen.com/youtube)

### **Content of box**

ReaderPen, carry case, USB cable, ear-phones, this guide, battery maintenance leaflet.

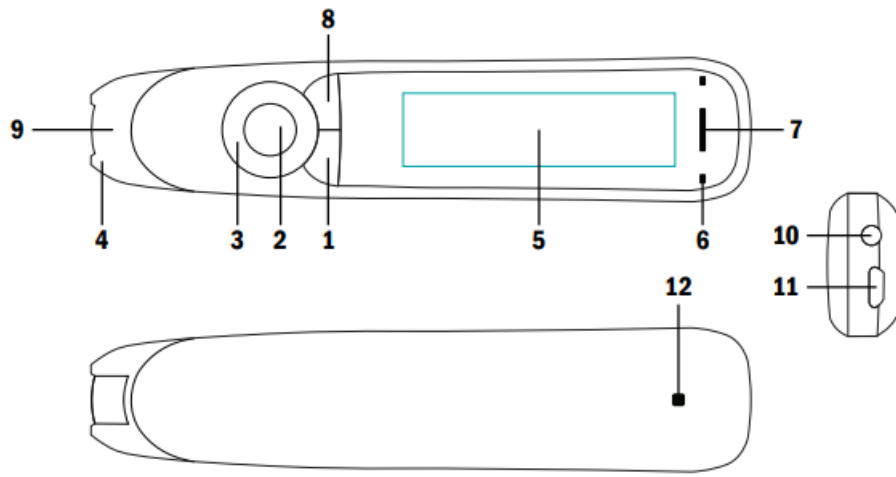

## Buttons and connectors

1. Power On/Off & Back button: Press 3 seconds to power device on or off. Press briefly to use as cancel function in the user interface
2. OK button: When a dialog box or options list pops up, press this button to confirm the operation. The OK button is also used to trigger reading text out loud in Text Reader mode.
3. 4-way Nav button: Press buttons to move focus up, down, left, right.
4. Scan Trigger: Is automatically activated when the pen is in contact with the paper. It triggers scanning and turns on scan light.
5. Screen: The device's display screen.
6. Mic: Used to record voice memo.
7. Speaker: Used when text is read out loud. Muted when headphones are connected.
8. Menu button: Press this button to display context menu (like right mouse click on PC).
9. Scanning window: Frames the text to be scanned.
10. Headphone jack: A standard 3.5 mm headphone jack. Speaker is muted when headphones are connected.
11. Micro USB connector: Used for charging. To charge, connect to USB charger or com-puter USB port.
12. Reset button: Pressing this button resets the device. It is recommended to use this button only when the device cannot be turned off properly.

## ReaderPen functions

Unless otherwise stated, ReaderPen is a stand-alone and self-contained product and works without being connected to any other device. Please check out video guides ([youtube.cpen.com](http://youtube.cpen.com)) for more detailed description.

### Talking menu

The talking menu is an audio navigation function. When set to on, all menu items are read out loud to support e.g. visually impaired users. The setting for this function is found under Set-tings in the main menu.

### Text Reader

Text Reader is an assistive reading function. Scan a word, text line or paragraph and have the text read out loud to you. ReaderPen can be set to read text automatically when scanned, or only read text on screen when manually triggered (by pressing the OK button). Listen through a built-in speakers or earphones. To use it, simply scan a few text lines, and lis-ten to them being read out. It is possible to re-read as many times as you like. Use the navigation buttons to select starting point and then press the OK button and listen. When a specific word is selected, press and hold OK button to zoom in on it and have it read out. Look and listen. The MENU button provides access to several options including clear screen, reading speed, volume, reading pauses, auto read, reading language and the option to look up words in the dictionary.

## Scan to File

This is the function to use when capturing and saving notes from a book or a paper. The scanned text is saved in a text file on Reader-Pen internal memory. This text file can be up-loaded to a computer if ReaderPen is connected via USB. When using Connect Desktop app (ReaderPen companion app) on the computer, files may be shared, edited or re-downloaded to ReaderPen and accessed by Scan to File function (max. 64kB file size). Check [www.cpen.com](http://www.cpen.com) for more details. A text file may also be opened, edited, and saved via pen user interface at any time later. It is possible to open a text file and have the content read out loud – like Text Reader. To use it, select New file or open an existing file. When scanning, new text is added at text cursor position. It is possible to delete text. Use navigation buttons to select a character and press OK button to delete it. To erase complete words or text lines, press OK button repeatedly. Files can be renamed. Go to Open file and position cursor on the file to be renamed. Scan a word (max 9 characters) and press OK button to rename the file. Press MENU button to access function specific settings.

## Definitions

ReaderPen contains one or more monolingual dictionaries for the supported languages. Select this function and scan one or more words. Use navigation buttons to select the word you want to look up and the word's definition. Subject to settings, accessible by pressing the MENU button, definitions can be read out loud by the pen. If you run into a difficult word when using Text Reader, it is also possible to look up this word in a dictionary without having to change working mode. Press the MENU button and select Definition. Press the MENU button to access other function-specific settings.

## USB connectivity

When ReaderPen connects to a computer, a couple of additional functions are made available. When connected, the user is prompted to select one out of three options.

## U-Disk

In this mode ReaderPen connects to computers as a portable disk. This mode is used to i) access or download text files used by the Scan to File function, ii) import usage statistics to Connect Desktop app or iii) use ReaderPen as a portable drive.

## Keyboard

In this mode ReaderPen doubles as keyboard. When connected to a computer in Keyboard mode, anything you scan with ReaderPen is directly and automatically input to any text field where the text cursor is positioned. It is thus possible to scan text directly to text editors, like MS Word, Google Docs and others, and spreadsheets. In this mode, it is important that the computer system keyboard (e.g. MAC OSX and Windows) is set to same language as the ReaderPen. Press MENU button to access language settings.

## Charge

When Charge is selected, ReaderPen works in stand-alone mode just as if not connected to the computer at all. This mode has no options or settings.

## How to scan

Look at the front page of this guide for reference on how to hold the pen. For best scanning result the pen shall be held almost straight up. Make sure no buttons except Scan Trigger is pressed during a scan.

The pen scans one (1) text line each time and this text line shall be centered in between the two white nibs in the front end. Scanning start and stop points are aligned with the edge of the transparent window. When the Scan Trigger gets in touch with the paper, the scan light lits up. Start moving the pen straight along the text line at a steady pace, avoid stops, do not rotate the pen, and keep the text line in between the nibs.

The left/Right-hand setting *\*must\** be correct, but it is possible to scan both from left to right and from right to left at any time. Give it a try...

- Scan this line from left to right.
- Scan this line from right to left.

For more details check [www.cpen.com](http://www.cpen.com) or [youtube.cpen.com](https://www.youtube.com/c/cpen).

## Get started

1. Press and hold the power button for about 3 seconds, then release it. Should the display not light up, then charge the battery for about 30 minute and then give it a second try.
2. At first use, a guide will help you set up your preferences. This includes settings for
  - Talking Menu (reads menu out loud)
  - Menu language (user interface language)
  - Scan language (the language of the text to scan)
  - Voice (as some languages supports more than one accent)
  - Preferred dictionary
  - Left/Right-handed (hand holding the pen) It is possible to manually run this guide in case required. Go to Settings, scroll down to Run wizard and press OK button to confirm.

When preferences are set, select Text Reader at the top of the main menu and press OK button. A blank screen appears. Now you are ready to scan and have text read out to you. Press OK button to have the text read out to you as many times as you want. Or press MENU button to access options which includes reading speed, volume, reading pauses, reading language and option to look up words in dictionary.

## Technical specification

Refer to [www.cpen.com](http://www.cpen.com) for information about supported languages, upgradability, battery, etc.

## Documents / Resources

	<p><a href="#">C-PEN C610R Reader Pen</a> [pdf] User Guide C610R, Reader Pen, C610R Reader Pen</p>
---	--

## References

- [⏪ The original pen scanner brand for home, work and study - C-Pen](#)
- [⏪ YouTube](#)
- [⏪ The original pen scanner brand for home, work and study - C-Pen](#)
- [⏪ ReaderPen - Supports independent reading and learning - C-Pen](#)
- [🌐 YouTube](#)