

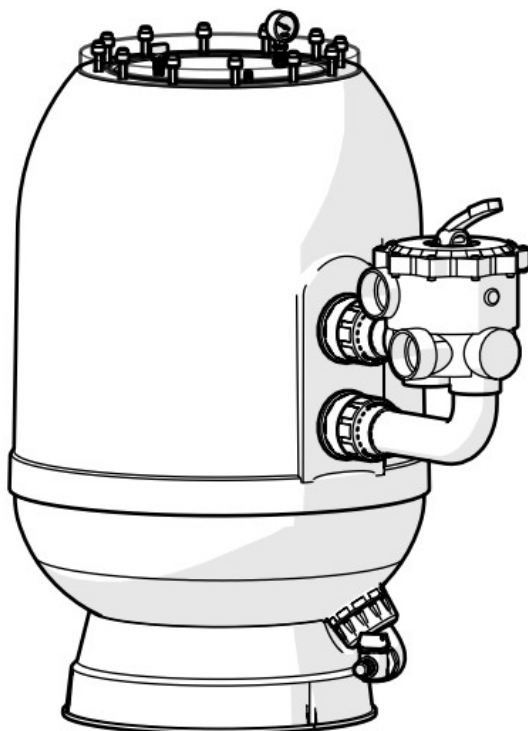

Owner's Manual



Contents [[hide](#)]

1 NEVADA Advanced Pool Filtration System

2 Introduction

3 Assembly:

4 Operation:

5 Start-Up:

6 Maintenance:

7 Specifications and Dimensions:

8 Documents / Resources

8.1 References

NEVADA Advanced Pool Filtration System

Caution: We recommend that you read this instruction manual carefully before installing the filter and keep all the documentation for future reference.



WARNING!

The use of the equipment in other configurations than those listed here or in different type of work is not permitted.

Different uses, improper, and / or incorrect, compared to those expressly indicated in the manual will automatically void any responsibility of the Manufacturer, as not foreseen, and therefore not specifically contemplated in the risk analysis.



it is necessary to read the contents of this manual before starting any operation.

This symbol emphasizes this need. Keep this manual for future reference.



WARNING! Hazardous pressure.

This equipment operates under hazardous pressure during start-up, normal operation and after pump shut off which could cause personal injury and property damages. before servicing the circulation system all valves and pump switch must be in off position, filter air release plug opened. before running the pump all valves must be opened to allow system water to go back to the pool. do not change the selector valve position while system pump is running. do not close back the air release plug until a stream of water is discharged.



WARNING! risk of electrical shock.

Do not carry out electrical installations and wiring near the filter's work area unless it has

a suitable IP protection rating to avoid the risk of any temporary splashes deriving from normal maintenance operations on the filter.



WARNING! suction entrapment hazard.

This is a high performing filter that requires a larger pump of which can cause hair and body suction entrapment at the suction sump if not installed in the right way. To reduce the risk of entrapment hazard it must be installed dual suction fittings respecting distances to avoid dual blockage by a user. Refer to European standards EN16713-2 for the requirement of the circulation equipment and installation.

Introduction

Thank you for choosing NEVADA sand filter by CPA S.R.L. for your project, this filter was designed to reach the highest level of filtration performance according to DIN EN 16713-1 and UNI10637:2024 up to this date.

This filter is designed and manufactured to be used in swimming pool and garden pond filtration only.

If the explanations given here are not clear or incomplete, and one or more parts of the manual itself are not perfectly understandable, it is necessary to contact the manufacturer to obtain all the necessary additional information.

Contents:

The filter box contains the following:

1. Filter body preassembled
2. Methacrylate transparent cover (placed with its O-Ring in its place on the filter)
3. Cover kit bag, including:
 - 12pcs x Nickel plated brass nuts M8
 - 12pcs x V4A washers
 - 12pcs x Plastic nut covers
 - V4A Pressure gauge adaptor kit including gasket+ washer+ nut
 - Plastic air release valve.

Drain valve kit.

The selector valve is packed in a different box.

Assembly:

PLEASE ENSURE THAT YOUR FILTER IS INTACT AND DOES NOT HAVE ANY DAMAGES FROM TRANSPORTATION.

3.1- Remove the methacrylate transparent cover from the filter while in the box and put it in a safe place carefully!

Avoid dropping or scratching it!

For the correct installation of the filter it is necessary that the filter base rests completely on a clean surface that supports the weight of the filter full of sand and water, the floor must be perfectly leveled.



3.2- Complete the valve filter connection with the appropriate kit supplied with the filter by doing the gluing operations, taking care not to dirty the O-rings and unions with the glue, check that the six-way valve is perfectly leveled.

3.3- Fit the drain kit together using Teflon on the threads and PVC cement on the solvent parts to fix them.



3.4- Make the connections provided on the six-way valve; Filter, Pump, Drain, Return. Also connect a 25mm hose to the drain kit coupler just installed previously

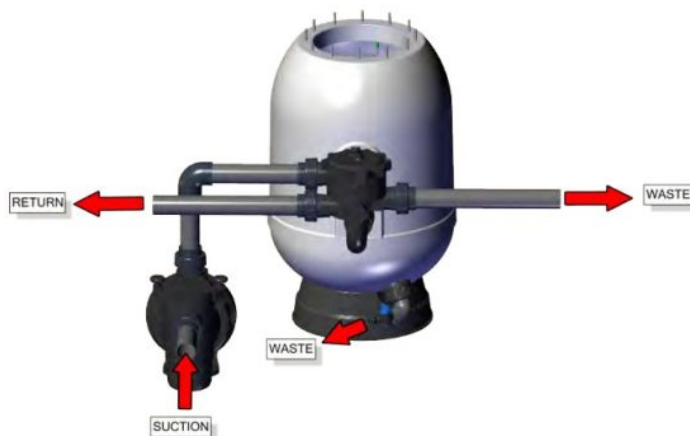

*Pump design in this drawing is only indicative, any brand can be used.

3.5- Release partially the union on the upper diffuser kit from inside the filter to a point where you can turn the diffuser to one of the sides to a 45° and then re-tighten it slightly.



3.6- Control that all the internals and filter arms are in good conditions.

After making sure that drain valve is closed and all unions are tightened properly, fill the filter tank with water to the half, then start emptying the required media according the table indicated here below.

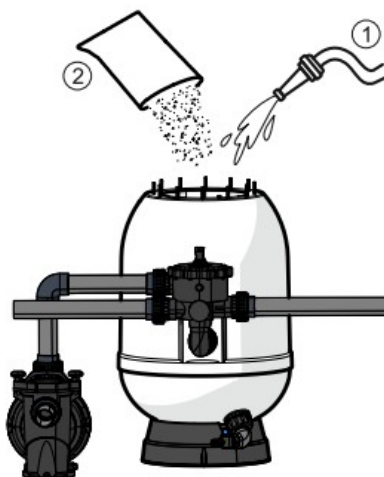

Required filtration media quantity

Model	Diameter (mm)	Quartz Sand (0,4-0,8mm) kg	Glass Media (0,6-1,2mm) kg
NEVADA	500	150	130
NEVADA	600	220	190
NEVADA	750	345	300
NEVADA	900	500	425

3.7- Filter closure:

Use Teflon to fix the pressure gauge onto the supplied adaptor

– Put the adaptor's flat gasket in its seat on the top side of the transparent lid
Pressure gauge washer and nut go on the bottom side of the cover, DO NOT OVERTIGHTEN!

The O-Ring onto the plastic black air release plug, thread it in its place on the top lid side and keep it loose.

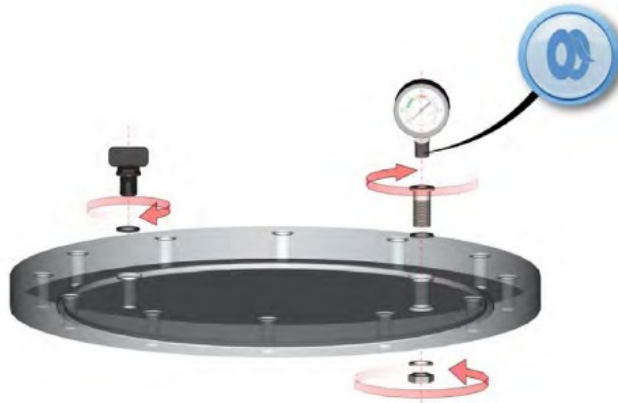

3.8- Ensure that the O-Ring at the bottom of the transparent lid is clean and fit into its seat.

Place the lid on the filter making sure that there are no dust or filtration media left on the surface touching the O-Ring.



– Insert the washers through the bolts and into their seats, and place the 12 brass nickle plated nuts supplied with

– Use a torque wrench with a hex nut socket of 13mm to tighten the nuts in cross order as indicated in the pattern sequence shown below

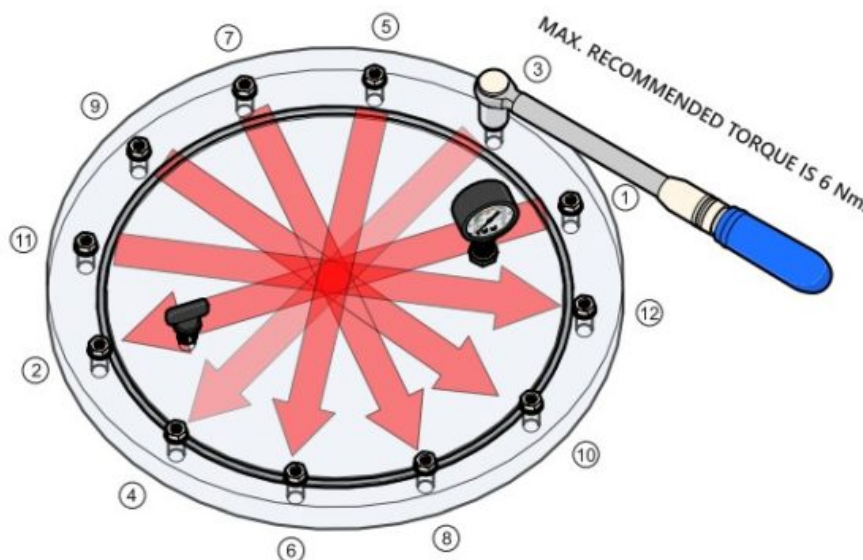

WARNING: Once the operations have been completed, start the filter and check that

there are no water leaks

NOTES: The manufacturer is not responsible for any damage caused by the filtration media filling.

IMPORTANT: The presence of the risk of flooding of premises; in the event of failure to comply with the standards, the filter manufacturer will not be held responsible for any damage.

Operation:

The equipment mainly performs the water filtration function as described in this manual. For the correct functioning of the filter and the correct management of the system to which it is connected, other functions are foreseen.

These functions take place through a different setting of the 6-way valve connected to the filter (supplied with the filter).

The valve has 6 positions: Filtration, Backwash, Rinse, Waste, Circulation & Closed.

The operating conditions for each position are detailed below.



CAUTION:

The selection of the 6-way valve lever must be carried out **ONLY AND EXCLUSIVELY** with the pump **TURNED OFF**.

Filtration

It is the normal operating position, performs the function of filtering the pool water between the inlet and the outlet of the filter.

Observe the pressure gauge regularly, it is recommended to proceed with the backwash operation when the pressure exceeds 1,1 kg/cm².



Backwash

It is used to clean the filtration media by removing the retained parts during normal operation.

Recommended operation time: 2-3min

It is recommended to do a backwash every week and immediately after a vacuum

cleaning of the pool.



Rinse

It is an operation to be carried out after backwashing to remove any impurities left inside the valve.

Recommended operating time: 1 min



Circulation

It is the position that allows the system to operate without the filter function. The water is bypassed directly to the **outlet**.



Waste

It is the position of by-passing the inlet water directly to the drain (e.i. pool emptying).



Closed

It is the position that closes all the valve passages.



Winterizing

It is an intermediate position (0) which, with an empty system, allows to prevent possible freezing failures.

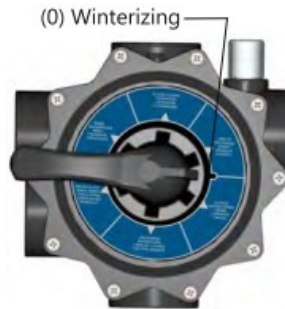

Start-Up:

- Once the sand filter has been loaded, it is necessary to backwash it and proceed as follows:
- Slightly unscrew the air vent plug located on the cover without removing it,
- Place the selector valve to the Backwash position to clean the filtration media the first time,
- Open the valves that control the suction lines and drain, turn on the pump for 2 minutes,
- Turn off the pump and place the selector valve handle in the Filtration position,
- Close the air release plug just after water starts coming out,
- Once this operation is done the filter will be ready to start the pool water filtration cycles.

IMPORTANT: Perform the position changes of the selector valve handle with the pump always in OFF position.

Maintenance:

To clean the external surface of the filter, do not use dissolvents, as this can damage it and eliminate the brightness of the same.

When necessary, the O-Rings and the damaged parts must be replaced.

Perform the necessary backwashes and rinses according to the operating instructions.

During winter, it will be necessary to carry out the following operations:

- Carry out a Backwash according to the previously indicated instructions.
- Empty the water from the filter.
- Remove the filter cover to keep it aired during the period of inactivity.
- When it is necessary to put the filter back into operation, just follow the commissioning instructions.

Safety Warnings:

- Do not run the system without water.
- Before performing any maintenance operation on the filter, disconnect the electric current from the pump.
- The filter must not be connected directly to the water supply network, the pressure of the same can be very high and exceeds the maximum working pressure of the filter.
- Do not use the filter circuit for filling and adjusting the pool water level.

Specifications and Dimensions:

- Max. Test Pressure: 2,5 Bar
- Max. Working Pressure: 1,5 Bar
- Max. Working Water Temp.: +50°C
- Head Loss in clean filter < 50 kPa

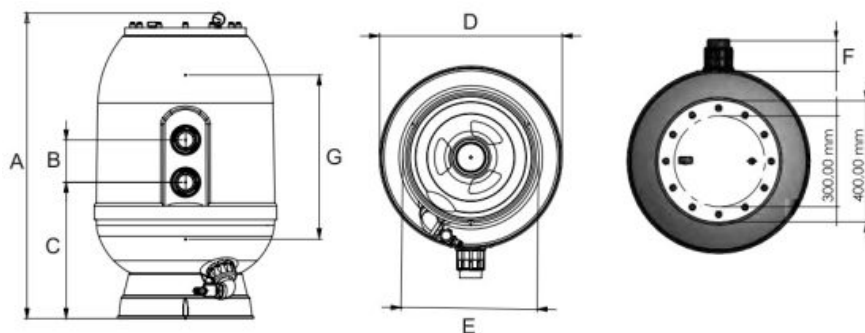

Code	ø mm	Flow m³/h	Conn.	Dimensions mm						G Filtration bed height mm	Glass media* kg	Quartz Sand** kg	Packaging dimensions LxWxH mm	Weight kg
				A	B	C	D	E	F					
1080519	500	10	50	946	125	450	520	450	90	600	130	150	550x550x1000	27
1080520	600	14	50	1010	125	530	620	450	90	600	190	220	650x650x1000	30
1080521	600	16	63	1010	140	485	620	450	100	600	190	220	650x650x1000	33
1080522	750	22	63	1115	140	565	770	720	100	600	300	345	800x800x1100	40
1080523	900	32	63	1150	140	585	930	720	100	600	425	500	950x950x1100	50
1080524	900	34	75	1150	270	515	930	720	110	600	425	500	950x950x1100	55



Disposal:

Do not throw the filter in the household waste, but hand it over to an official collection center for recycling.

The packaging material can be recycled.

For more information on recycling this product, contact the municipal office, the local waste disposal service or the shop where the product was purchased.

WE RESERVE THE RIGHT TO CHANGE ALL OR PART OF THE ARTICLES OR CONTENTS OF THIS DOCUMENT WITHOUT PRIOR NOTICE.



GUARANTEE INFORMATION

5-year guarantee on the filter container

For all other parts, the statutory liability for material defects applies for a period of 2 years in accordance

with Section 438 (1) No. 3 BGB

Produced in Italy in: Via Don D. Castelli, 71, 12060 Roddi CN

www.cpa-piscine.com

Documents / Resources

	<p>C P A Piscine NEVADA Advanced Pool Filtration System [pdf] Owner's Manual</p> <p>ML, Q0, R02, NEVADA Advanced Pool Filtration System, NEVADA, Advanced Pool Filtration System, Filtration System, System</p>
---	---

References

- [User Manual](#)

📁 C P A

Piscine

🔍 Advanced Pool Filtration System, C P A Piscine, Filtration System, ML, Nevada, NEVADA Advanced Pool Filtration System, Q0, R02, System

Leave a comment

Your email address will not be published. Required fields are marked *

Comment *

Name

Email

Website

☐ Save my name, email, and website in this browser for the next time I comment.

Post Comment

Search:

e.g. whirlpool wrf535swhz

Search

[Manuals+](#) | [Upload](#) | [Deep Search](#) | [Privacy Policy](#) | [@manuals.plus](#) | [YouTube](#)

This website is an independent publication and is neither affiliated with nor endorsed by any of the trademark owners. The "Bluetooth®" word mark and logos are registered trademarks owned by Bluetooth SIG, Inc. The "Wi-Fi®" word mark and logos are registered trademarks owned by the Wi-Fi Alliance. Any use of

these marks on this website does not imply any affiliation with or endorsement.