



BUTURE Beta03 Jump Starter User Guide

[Home](#) » [BUTURE](#) » BUTURE Beta03 Jump Starter User Guide 

Contents

- 1 [BUTURE Beta03 Jump Starter](#)
- 2 [JUMP START YOUR CAR](#)
- 3 [ABOUT THE FORCE START FUNCTION](#)
- 4 [TROUBLESHOOTING](#)
- 5 [CHARGE OTHER DEVIDES](#)
- 6 [LED LIGHTING](#)
- 7 [IMPORTANT SAFETY WARNING](#)
- 8 [WHERE TO GET MORE HELP](#)
- 9 [Documents / Resources](#)
 - 9.1 [References](#)
- 10 [Related Posts](#)

BUTURE

BUTURE Beta03 Jump Starter



JUMP START YOUR CAR

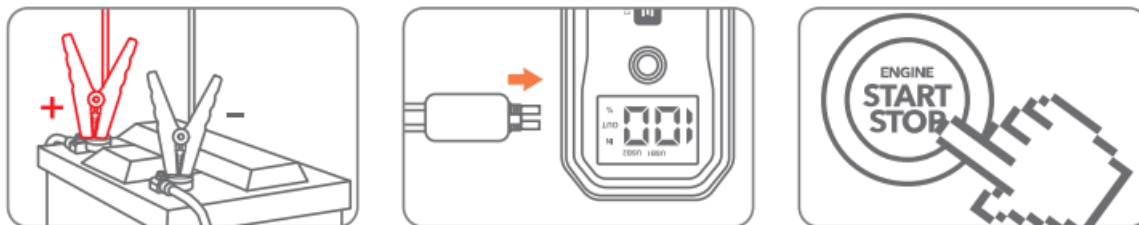

1. Insert the jumper cable into the jump starter (c':20% power).
2. Connect the clamps to the car battery (red to+, black to-).
3. Start your car engine.

ABOUT THE FORCE START FUNCTION

If three attempts fail when you correctly connect the clamps to your car, you can use the Force Start Function to enter boost mode.

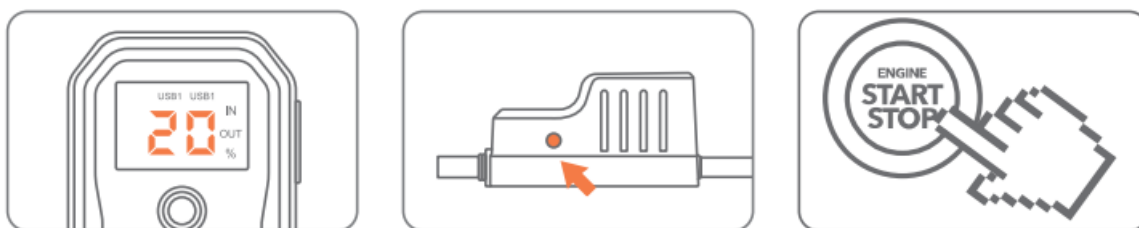

3 steps to fix the problem:

1. Check the clamps connection and the product's battery is above 20%.
2. Press the Force Start Button for 3 seconds.
3. The indicator will be green, and go back to start engine ignition.

Caution: When using this function, auto-detection and safety features will be disabled temporarily.

TROUBLESHOOTING

In any of the following situations, the smart clamp will turn protections on:

Indicator	Situations
Flashing red and green	Standby status
Solid green	Ready to start
Solid red	<ol style="list-style-type: none">1. Low voltage protection ---Recharge the product2. Over-heating protection ---Remove the clamps to let it cool3. Timeout protection ---Connection timed out. Start engine within 60s or remove the clip within 30s after a successful start
Solid red with discontinuous beep	<ol style="list-style-type: none">1. Reverse polarity protection ---Reverse the clips and ensure the correct connection2. Sticking fault ---Contact support@ibuture.com for replacement parts
Solid red with long beep	Short-circuit protection ---Don't connect the clips together or to the same metal
Other	Please contact support@ibuture.com with details

CHARGE OTHER DEVIDES

1. Plug the cable into any USB output.

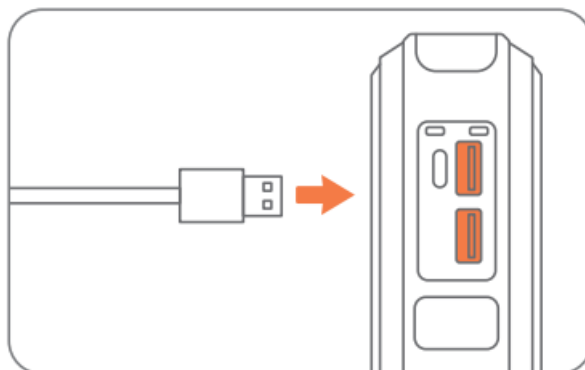

2. Press the power button.

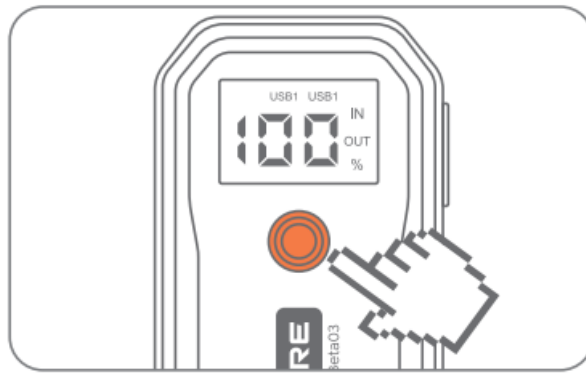

LED LIGHTING

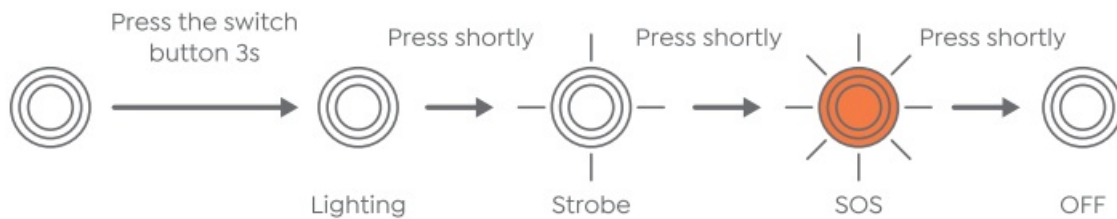

IMPORTANT SAFETY WARNING

1. Store in a cool and well-ventilated place out of reach of children and pets.
2. Do not place the product in a high-temperature environment for a long time. The operation temperature of this product is -20-60°C. The storage temperature should not exceed 50°C/122° F.
3. Only start vehicles with the smart jumper cable supplied by the manufacturer.
4. Do not use the product if the clamp or cable is damaged.
5. Do not connect the red and black clamps when the product is outputting.
6. Do not connect the red and black clamps to the same piece of metal.
7. Do not disassemble or modify this product.
8. Do not use detergent to clean this product.
9. Do not abuse this product and avoid heavy dropping or repeatedly hitting it.
10. Do not operate the product in explosive environments such as flammable liquids, gases, or dust.
11. Do not immerse the product in water.
12. Do not litter the product and it should be safely recycled.
13. Do not incinerate the product or be exposed to high temperatures, as they may explode.
14. Only use replacement parts or accessories provided or recommended by the manufacturer.

Scan And Download the Full Version Of the User Manual

<https://ibuture.com/pages/user-manuals>.

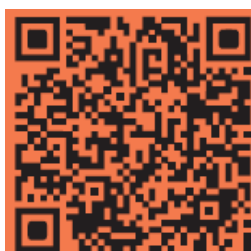

WHERE TO GET MORE HELP

- Support@ibuture.com
 - <https://ibuture.com>
 - @buture.official
 - @buture.official
-

Documents / Resources



[BUTURE Beta03 Jump Starter](#) [pdf] User Guide
Beta03 Jump Starter, Beta03, Jump Starter, Starter

References

- [User Manual](#)