



BURG WACHTER 27511 Scan and Lock 610 Padlock with Fingerprint Instruction Manual

[Home](#) » [BURG WACHTER](#) » BURG WACHTER 27511 Scan and Lock 610 Padlock with Fingerprint Instruction Manual 

Contents

- [1 BURG WACHTER 27511 Scan and Lock 610 Padlock with Fingerprint](#)
- [2 Features](#)
- [3 Ways to unlock](#)
- [4 Operating instructions: Fingerprint sensor](#)
- [5 Mit Fingerprint](#)
- [6 Opening with fingerprint](#)
- [7 Set administrator account](#)
- [8 Troubleshooting](#)
- [9 Warranty](#)
- [10 Documents / Resources](#)
 - [10.1 References](#)
- [11 Related Posts](#)

BURG

BURG WACHTER 27511 Scan and Lock 610 Padlock with Fingerprint



Features

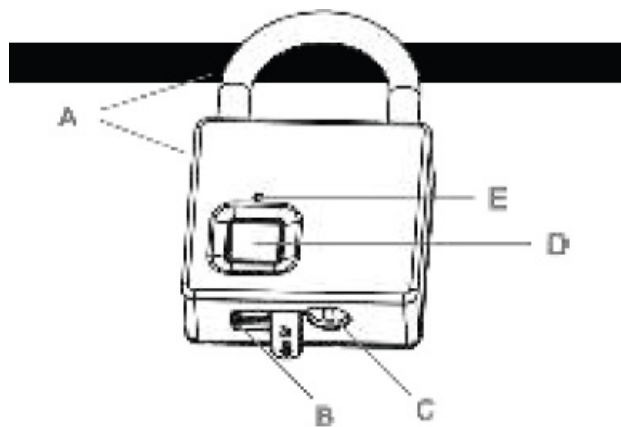

Easy Operation:

Up to 10 fingerprints can be programmed (1x administrator, 9x user)

Waterproof & Dustproof:

IP65, protected from rain and dust.

Unlocking in 1 second:

Quick-recognition technology, identify your fingerprint quickly.

Low Power Consumption:

After being fully charged, up to 1,800-2,000x locking and unlocking possible.

Ways to unlock

Note:

Pull the shackle after release via the fingerprint or open it upwards using the key.

Operating instructions: Fingerprint sensor

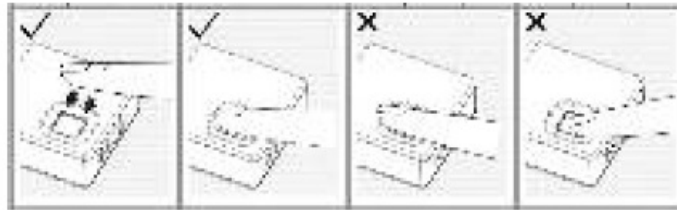

Mit Fingerprint

- To activate: press the shackle once



- To open: place your finger on the sensor for around 1 sec.

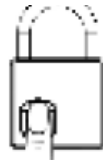

- To activate, press the shackle down once

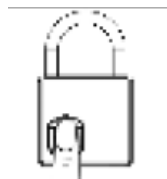

- Press fingerprint sensor around 3s



- Input administrator fingerprint, 10 times

Opening with fingerprint

Beeps : LED : Explanation

1. Blue flashing
2. Two beeps

Note: At the factory and in delivery condition, the lock can be opened with any fingerprint. The lock is individualized when it is set-up by the administrator.

Set administrator account

Beeps: LED : Explanation

Blue flashing

- One beep Blue flashing, 1x Input finger again
- Four beeps Red flashing Finger not registered, input again
- Long beep Blue shining Programming finished
- One beep Red shining Restart programming with 1st step

Action

- To activate: press the shackle down once
- Press fingerprint sensor around 3s
- Place administrator fingerprint
- Place user fingerprint, 10 times

Troubleshooting

Symptoms	Reasons	Solution
The light is off when you press the sensor	Battery discharged	Charging the fingerprint padlock
	In standby status	Please press the shackle
Any finger can unlock	The lock is in factory setting, any finger can be used to open it.	Set administrator account
Cannot unlock	Sensor does not identify finger	Sensor surface or fingerprint dirty; please clean

Warnings

Please note the following information:

1. The output voltage of the adapter must be 5 V when charging.
2. Do not insert any extraneous objects into the lock or the USB port.

Warranty

BURG-WÄCHTER products comply with the technical standards at the time of production and adhere to our own quality standards. The guarantee only covers defects which can be proved to have resulted from production or material defects at the time of purchase. The warranty ends after two years, further claims are excluded. Defects and damage caused by e.g. transport, incorrect operation, improper use, wear etc. are excluded from the warranty. A short description of any defects identified must be made in writing and the device returned to the place it was purchased, together with the original packaging. After the device has been tested, and within a appropriate period of time, the guarantor will decide whether or not to repair or exchange the item. For returns, all undamaged device parts must furthermore be in the factory setting due to your right of revocation. Failure to comply with this will invalidate the warranty.

Disposal of the device

Dear customer,

please help us to avoid unnecessary waste. Should you intend to dispose of this device at any time, please remember that many components of this device contain valuable materials that can be recycled.

Please be aware that electrical and electronic equipment and batteries marked in this way must not be disposed

of with household waste but collected separately. Please obtain information on the collecting points for electrical waste from the responsible authority of your city/ municipality.

BURG-WÄCHTER KG hereby declares that this device complies with the Directives 2014/30/EU, (EMC) and 2011/65/EU (RoHS).

The complete text of the EU Declaration of Conformity is available at the following Internet address:

www.burg.biz

Printing and typesetting errors as well as technical changes reserved.

Documents / Resources

	<p>BURG WACHTER 27511 Scan and Lock 610 Padlock with Fingerprint [pdf] Instruction Manual</p> <p>27511, Scan and Lock 610 Padlock with Fingerprint, 27511 Scan and Lock 610 Padlock with Fingerprint</p>
---	--

References

-  [BURG-WÄCHTER](#)

[Manuals+](#)