



18-3675 Series Bluetooth RC Buggy User Manual

Contents [[hide](#)]

[1 18-3675 Series Bluetooth RC Buggy](#)

[2 Documents / Resources](#)

[2.1 References](#)

18-3675 Series Bluetooth RC Buggy

6+

#18-36751/#18-36752/#18-36753/#18-36754/#18-36756

Warning! Not suitable for children under 36 months. Small parts. Choking hazard.

Please keep this owner's instruction manual for future reference.

It contains important information.

We reserve the right to improve/revise the product specifications without notice.

This toy is only to be connected to equipment bearing the symbol.

Class 1 LED Product

Contents:

- RC Vehicle With Built-in Rechargeable Battery (3.2V 100mAh / non replaceable) x 1
- USB Cable x 1
- Owner's Instruction Manual x 1

Download the << Shell Racing Legends >> APP



<https://assets.carbon12011ar.com/global/app-download.html>

Scan the QR Code Or search for « Shell Racing Legends >> APP in the App Store or on Google Play and download the app to your smartphone or tablet.

Follow the instruction for enabling Bluetooth in the smartphone settings and start up the App



Charging your Bluetooth Car

1. Open the charging port cover on the vehicle.
2. Make sure the switch is on the OFF/CHARGE position before charging.
3. Locate a USB certified port from any of the devices shown here.
4. Connect the USB charging plug with the USB certified port.
5. The LED indicator will start lighting in red to show it is charging.
6. Once the LED indicator turns off, the vehicle is fully charged.
7. Detach the USB plug from the USB certified port, then install the charging port cover on the vehicle.

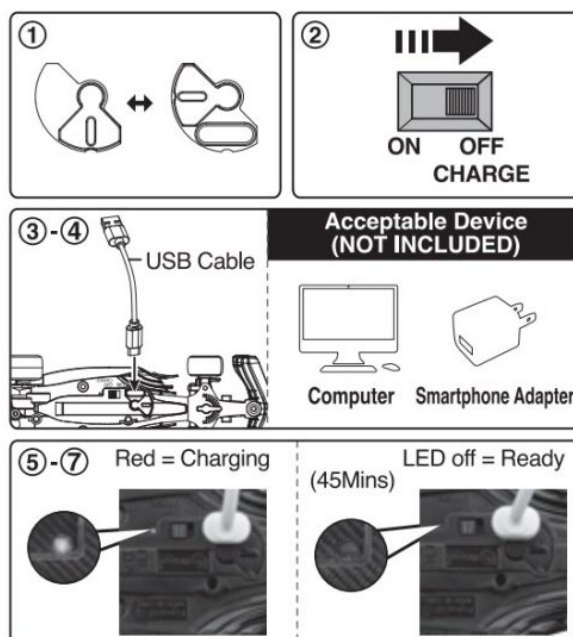

Connect to the car

1. Open the <<Shell Racing Legends>> App in mobile phone.
2. Turn on the power switch on the vehicle, then turn on the Bluetooth button on the phone screen to select the vehicle model to match signal.

The “Power LED” on the vehicle will flash less than 3 seconds then stay on, meaning the automatic signal matching between the vehicle and the phone is completed.

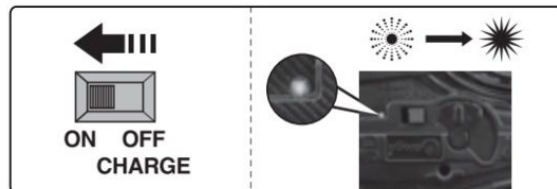

Wheel Alignment

If the vehicle does not run in a straight line, adjust the wheel alignment under the chassis.

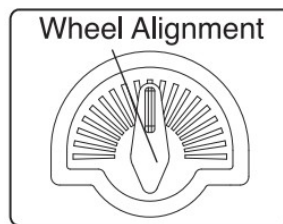

Performance Tips:

1. Do not drive the vehicle on grass, sand or go through water.
2. Do not drive the vehicle in windy or rainy weather.
3. Do not drive the vehicle into any hard object.
4. Keep fingers, hair and loose clothing away from the vehicle.
5. The operating range can be affected by a variety of factors:
 - a) Weak controller or vehicle batteries.
 - b) Interference from other items that emit radio frequency signals such as another R/C item on the same frequency, CB radios, cordless phones, high voltage transmitter, etc.
6. Outdoor usage is recommended in order to get optimal control range.
7. Remove the package, take out all accessories and assemble the product before giving it to children to play.
8. Only the supply USB cable should be used to connect the toy.

Cautions:

1. The Built-in rechargeable battery must be charged before use.
2. Do not overcharge the Battery. Do not charge for more than 1 hour except for the initial two charges.
3. Do not charge the Battery if it shows leakage, corrosion, or has loose or exposed wires or other damage.
4. Do not cover the vehicle with any sort of material while charging.
5. Do not touch the vehicle when it is hot. Wait until the vehicle cools before recharging.
6. Do not dispose of the Battery in fire.
7. Do not dismantle the Battery or USB, and do not cut the Battery or USB cables.
8. The USB Cable used with the toy shall be regularly examined for damage to the cord, plug, enclosure and other parts, and in the event of such damage, they must not be used until the damage has been repaired.
9. The USB cable is not a toy.
10. The Battery will be warm after charging, and hot after use in a Vehicle.
11. Rechargeable batteries are only to be charged by adults or by children at least 8 years old.

FCC Label Compliance Statement:

This device complies with part 15 of the FCC rules.

Operation is subject to the following two conditions:

1. This device may not cause harmful interference, and
2. This device must accept any interference received, including interference that may cause undesired operation.

Note: This equipment has been tested and found to comply with the limits for a Class B digital device, pursuant to Part 15 of the FCC Rules. These limits are designed to provide reasonable protection against harmful interference in a residential installation. This equipment generates, uses and can radiate radio frequency energy and, if not installed and used in accordance with the instructions, may cause harmful interference to radio communications. However, there is no guarantee that interference will not occur in a particular installation. If this equipment does cause harmful interference to radio or television reception, which can be determined by turning the equipment off and on, the user is encouraged to try to correct the interference by one or more of the following

measures:

Reorient or relocate the receiving antenna.

- Increase the separation between the equipment and receiver.

Connect the equipment into an outlet on a circuit different from that to which the receiver is connected.

- Consult the dealer or an experienced radio/TV technician for help.

Warning: Changes or modifications to this unit not expressly approved by the party responsible for compliance could void the user's authority to operate the equipment.

RSS-210 Compliance Statement:

This device contains licence-exempt transmitter(s)/receiver(s) that comply with Innovation, Science and Economic Development Canada's licence-exempt RSS(s). Operation is subject to the following two conditions:

1. This device may not cause interference;
2. This device must accept any interference, including interference that may cause undesired operation of the device.

Environmental notes:



The whole product also does not belong to household waste at the end of the product life.

You can return it at collection points for the recycling of electronic and electrical instruments.

The symbol on the item, instruction manual, hangtag or packing is showing this clearly. Materials should be recycled according to their respective markings.

Recycling of old devices or other re-use of materials contained therein represents an important contribution to environmental protection.

Please ask at your local community for the correct collection point.

Please retain this sheet and address for future use, as they contain important information.

Disposal of batteries

Batteries should not be disposed of in the household waste.

As the consumer you are legally obliged to return batteries containing harmful

substances and all other used batteries. You can hand in your old batteries at public collection points in your area or wherever batteries are sold.



You will find these chemical abbreviations along with a crossed-out refuse bin on batteries containing harmful substances:

Pb = Battery contains lead

Cd = Battery contains cadmium

Hg = Battery contains mercury

CE Declaration

Hereby, Dongguan Maestro Industries Limited, declares that the equipment Bluetooth remote control car (Model: 18-36751/18-36752/18-36753/18-36754/18-36756) is in compliance with the essential requirements and other Relevant provisions of directive 2014/53/EU

Frequency: Bluetooth® v5.0

Transmitting frequency band: 2.4-2.4835GHz

Max allowed transmitting power: <10mW

The declaration of conformity may be consult at:

Dongguan Maisto Industries Limited Chu Wei Tien, Feng Kang, Dongguan City, Guangdong, China

The full text of the EU declaration of conformity is available at the following internet address: www.maycheonggroup.com.hk/declaration-of-conformity

MAY CHEONG GROUP LTD

Job Item: BQ0698_24~insert

Item No.: 1/41 Bluetooth RC #18-36751 Carbon 12.011 S.R.L./ Shell Mexico

Finished by: LCC

Check by:

Date: 24/12/2024

DWN Name: HeJunMei

DIECUT

Test No.:

Material:



Documents / Resources



[burago 18-3675 Series Bluetooth RC Buggy \[pdf\]](#) User Manual
36752RC, PKG36752RC, 18-3675 Series Bluetooth RC Buggy, 18-3675
Series, Bluetooth RC Buggy, RC Buggy, Buggy

References

- [User Manual](#)

burago

18-3675 Series, 18-3675 Series Bluetooth RC Buggy, 36752RC, Bluetooth RC Buggy, Buggy, burago, PKG36752RC, RC Buggy

Leave a comment

Your email address will not be published. Required fields are marked *

Comment *

Name

Email

Website

☐ Save my name, email, and website in this browser for the next time I comment.

Post Comment

Search:

e.g. whirlpool wrf535swhz

Search

[Manuals+](#) | [Upload](#) | [Deep Search](#) | [Privacy Policy](#) | [@manuals.plus](#) | [YouTube](#)

This website is an independent publication and is neither affiliated with nor endorsed by any of the trademark owners. The "Bluetooth®" word mark and logos are registered trademarks owned by Bluetooth SIG, Inc. The "Wi-Fi®" word mark and logos are registered trademarks owned by the Wi-Fi Alliance. Any use of these marks on this website does not imply any affiliation with or endorsement.