



## bulbeats B0CGX9GY4C Smart RGB Floor Lamp with Remote Instruction Manual

[Home](#) » [bulbeats](#) » bulbeats B0CGX9GY4C Smart RGB Floor Lamp with Remote Instruction Manual 

### Contents

- [1 bulbeats B0CGX9GY4C Smart RGB Floor Lamp with Remote](#)
- [2 Product Information](#)
- [3 Installation Guide](#)
- [4 ASSEMBLY INSTRUCTIONS](#)
- [5 Guarantee](#)
- [6 Documents / Resources](#)

# BULBEATS

bulbeats B0CGX9GY4C Smart RGB Floor Lamp with Remote



## Product Information

### LED Floor Lamp

The LED Floor Lamp is a versatile lighting fixture designed for use in residential and commercial spaces. It features a modern design with energy-efficient LED technology, providing bright and long-lasting illumination. The lamp is easy to install and does not require any tools for assembly.

### Important Safety Precautions

- Read all safety precautions and installation instructions carefully before installing.
- Do not handle any energized fixture or attempt to energize any fixture with wet hands or while standing on a wet or damp surface or in water.
- The fixture is designed for use in a 120VAC, 60Hz fused circuit. Do not use on a dimming circuit.

### Installation Instructions

1. Screw Tube (A) clockwise into Tube (B) until secure; pull any excess cord through Tube (B).
2. Repeat Step 1 for Tubes (C) and (D).
3. Screw Tube (D) clockwise into Base (E) until secure; pull any excess cord through Tube (D).
4. Unscrew the lamp holder nut counterclockwise and install the glass cover. Tighten the lamp holder nut clockwise. Note: The glass cover is fragile, please handle with care.
5. Install the tray with the arc side up. Pass the wire through the wire groove and M10 screw between Tube (B) and Tube (C). Tighten the (B) and (C) tube clockwise.
6. Ensure correct installation angle of lamp pole and chassis.

7. Tighten the existing bulb clockwise. Note: Do not over-tighten. The glass cover is fragile, please handle with care.
8. Use the Foot Switch to control the lamp's ON/OFF function.

**Guarantee:** If your product arrives in a damaged condition or does not work properly within 3 years, please contact our customer service at [bulbeats.cs@hotmail.com](mailto:bulbeats.cs@hotmail.com). We offer a 100% Satisfaction Guarantee and will provide a replacement or refund.

## Installation Guide

- **IMPORTANT:** Read all safety precautions and installation instructions carefully before installing
- Do not handle any energized fixture or attempt to energize any fixture with wet hand or while standing on a wet or damp surface or in water.
- The fixture is designed for use in 120VAC, 60Hz fused circuit. Do not use on a dimming circuit.
- Easy to install, no tools needed, assembly the products following instructions.

## ASSEMBLY INSTRUCTIONS

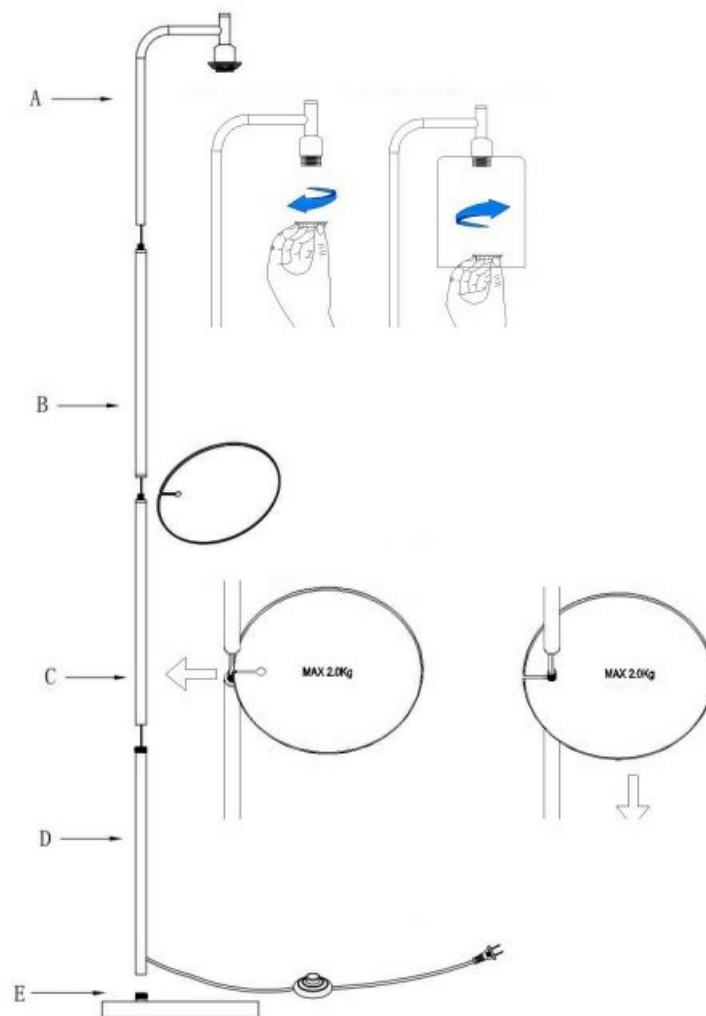

1. Screw Tube (A) clockwise into Tube (B) until secure; pull any excess cord through Tube (B).
2. Repeat Step 1 for Tubes (C),(D).
3. Screw Tube (D) clockwise into Base (E) until secure; pull any excess cord through Tube (D).
4. Unscrew the lamp holder nut counterclockwise, and is Install glass cover, tighten lamp holder nut clockwise.
  - **Note:** The glass cover is fragile, please don't knock it.

## 5. Install the tray

- As shown in the picture, pass the wire through the wire groove and M10 screw between Tube (B) and Tube (C), tighten the (B) and (C) tube clockwise.
- **Note:** Install the tray with the arc side up

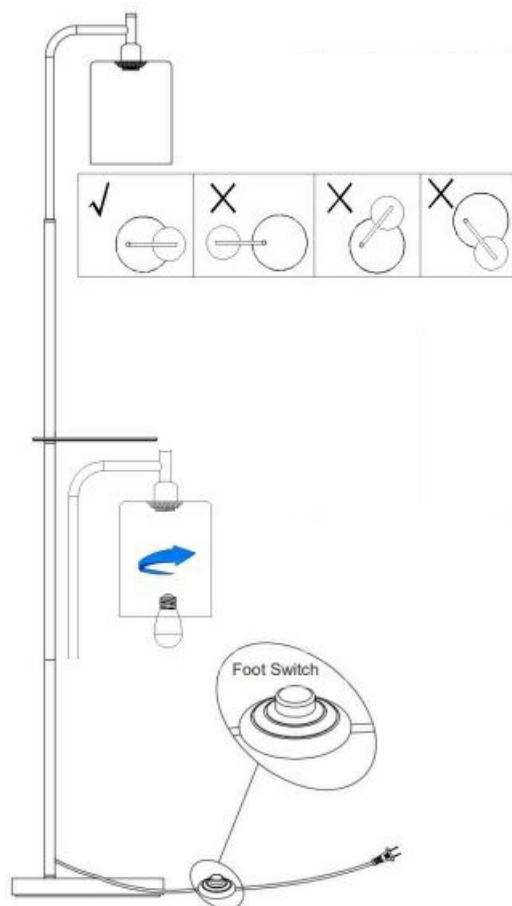

6. Correct installation angle of lamp pole and chassis.

7. Tighten the existing bulb clockwise.

- **Note:** Do not over-tighten,
- The glass cover is fragile, please don't knock it.

8. **Foot Switch:** control lamp ON/OFF.

## Guarantee

If your product does not arrive in good condition or does not work great 100% Satisfaction Guarantee within 3 years, please let us know we will give you replacement or refund. Customer service: [bulbeats.cs@hotmail.com](mailto:bulbeats.cs@hotmail.com)

## Documents / Resources

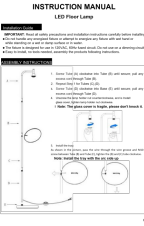
	<p><a href="#">bulbeats B0CGX9GY4C Smart RGB Floor Lamp with Remote</a> [pdf] Instruction Manual B0CGX9GY4C Smart RGB Floor Lamp with Remote, B0CGX9GY4C, Smart RGB Floor Lamp with Remote, Lamp with Remote</p>
---	--