



# Buddy Toys BPC 5311 Bouncer Loader Cat Instructions

[Home](#) » [buddy toys](#) » Buddy Toys BPC 5311 Bouncer Loader Cat Instructions 

## buddy toys

Model BPC 5311

### Contents

- [1 BPC 5311 Bouncer Loader Cat](#)
- [2 FEATURES AND FUNCTIONS](#)
- [3 STORAGE AND MAINTENANCE](#)
- [4 PARTS](#)
- [5 ASSEMBLY](#)
- [6 Documents / Resources](#)
  - [6.1 References](#)

### BPC 5311 Bouncer Loader Cat

Before using this product, please carefully read the information contained in this user's manual and on the packaging and keep it for future use. Changes in the text, design and technical specifications may be made without prior notice and we reserve the right to make such changes.

### FEATURES AND FUNCTIONS

- Minimum age for use: from 2 years of age
- Power source: Two 1.5V type-AAA batteries, not included.

#### **ATTENTION** – USING THE PRODUCT SAFELY

- The product must be assembled and put into operation by an adult!
- The packaging is not a part of the toy, after unpacking, keep all its parts out of reach of children.

- Do not leave children playing unsupervised. The product should be used with care taking into account the abilities of the user.
- Do not expose the product to sources of heat such as fire, direct sunlight.
- Do not modify the product in any way, do not tamper with its construction or connection. There is a risk of loss of functionality, an injury or damage to property.
- This product is designed only for domestic use.
- Never use the toy on a road, near motor vehicles, on slopes, near swimming pools and other similar locations.
- Do not use the toy in the dark or during poor light conditions.
- Always wear footwear and other protective aids such as a helmet, knee guards or gloves during use. Make sure that only one child plays with the toy.
- Do not exceed the maximum load capacity of the toy 25kg.
- Regularly inspect the technical condition of the toy.



### **BATTERY – SAFE OPERATION**

- Use only the battery types specified by the manufacturer.
- The handling and charging of batteries may only be performed by an adult.
- Do not expose the batteries to fire, direct sunlight or other sources of heat or open their cover.
- Remove rechargeable batteries from the product before recharging them.
- Do not combine standard and rechargeable batteries. Non-rechargeable batteries must not be charged.
- Make sure that the batteries are properly installed in the product and adhere to the correct polarity.
- You must immediately remove flat batteries from the product. Do not combine new and used batteries.
- If the product is not used for an extended period of time, remove all the batteries.
- It is forbidden to short-circuit the power supply terminals.
- A damaged or leaking battery must be replaced immediately.
- In the event that leaked electrolyte comes into contact with eyes, rinse the eyes out with clean water and immediately seek professional medical help.

### **STORAGE AND MAINTENANCE**

Store the product in a clean condition in a dry and dark place. Clean with a dampened lint-free cloth. Do not use aggressive or abrasive cleaning products for cleaning. After use, clean and dry using a dry cloth.



### **ECOLOGICAL DISPOSAL**

At the end of their lifetime, neither the electrical device, nor battery packs, nor used batteries may be disposed of as unsorted communal waste. Take the used products to appropriate local collection points in accordance with local municipal codes.



This product meets the basic requirements of EU directives that apply to it.



## PARTS

1.		2.		3.	
4.		5.		6.	
7.		8.		9.	



## ASSEMBLY

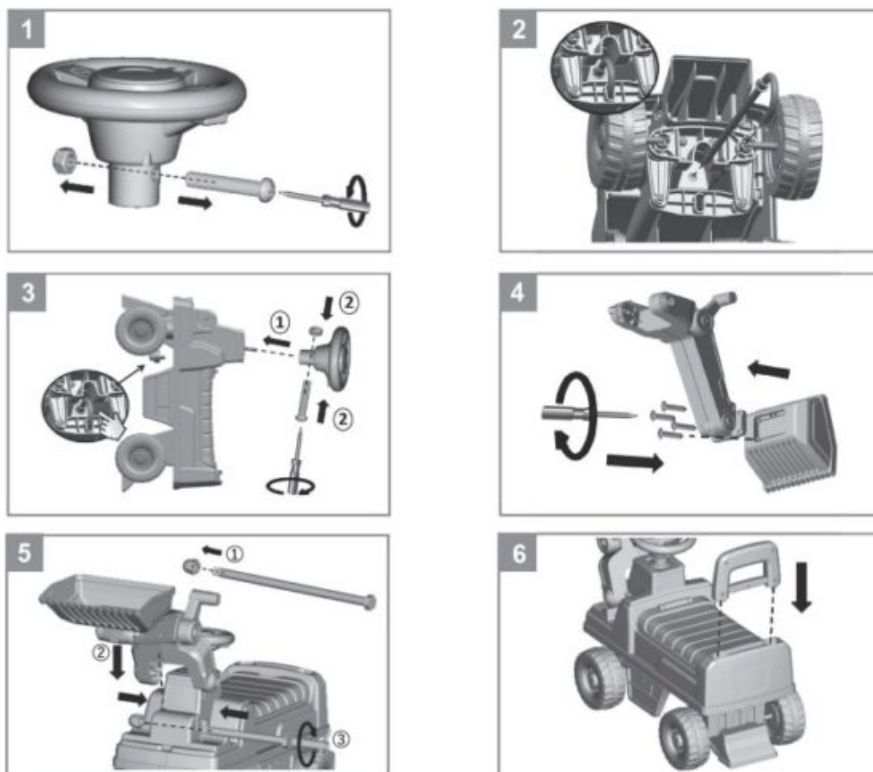

## BATTERY CHANGE

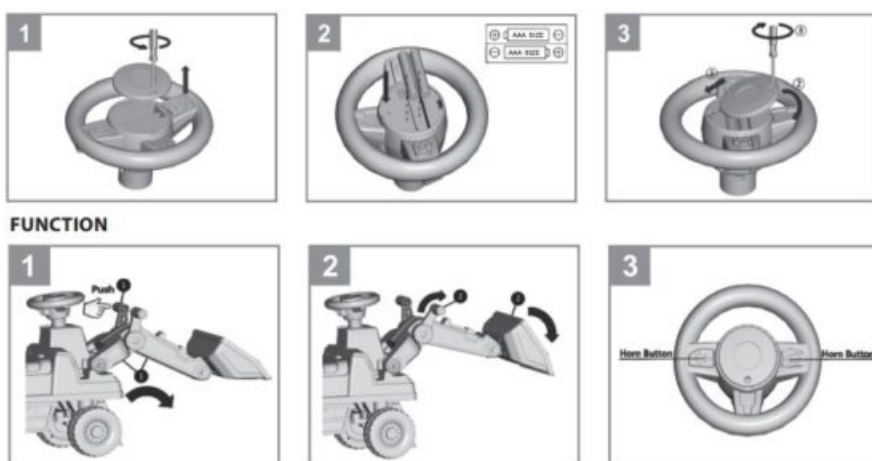

# buddy toys

Address: FAST ČR, a.s. U Sanitasu 1621,  
251 01 Říčany, Czech Republic  
Czech is the original language version.  
Version 03/2024

## Documents / Resources

<p><b>buddy toys</b> Model BPC 5311</p> <p>Technical specifications:</p> <ul style="list-style-type: none"> <li>Material: Plastic</li> <li>Weight: 1.5 kg</li> <li>Dimensions: 25 x 25 x 25 cm</li> <li>Age range: 3+ years</li> <li>CE mark</li> </ul>	<p><a href="#">Buddy Toys BPC 5311 Bouncer Loader Cat</a> [pdf] Instructions</p> <p>BPC 5311, BPC 5311, BPC 5311, BPC 5311 Bouncer Loader Cat, BPC 5311, Bouncer Loader Cat, Loader Cat</p>
---	---

## References

- [User Manual](#)

[Manuals+](#), [Privacy Policy](#)

This website is an independent publication and is neither affiliated with nor endorsed by any of the trademark owners. The "Bluetooth®" word mark and logos are registered trademarks owned by Bluetooth SIG, Inc. The "Wi-Fi®" word mark and logos are registered trademarks owned by the Wi-Fi Alliance. Any use of these marks on this website does not imply any affiliation with or endorsement.