



# bticino 334253 Intercom Easykit Plus 7 Inch Additional Monitor Instruction Manual

[Home](#) » [bticino](#) » bticino 334253 Intercom Easykit Plus 7 Inch Additional Monitor Instruction Manual 

## Contents

- 1 bticino 334253 Intercom Easykit Plus 7 Inch Additional Monitor
- 2 Warnings and consumer rights
- 3 Dimensional data
- 4 Assembly
- 5 Disassembling
- 6 Front view
- 7 Available functions
- 8 Back view
- 9 Wiring diagram
- 10 Diagram with additional monitor
- 11 Technical data
- 12 Product Specifications
- 13 Frequently Asked Questions (FAQ)
  - 13.1 1. What is the purpose of the Volume Adjustment feature?
  - 13.2 2. How do I release the door lock?
  - 13.3 3. Can I adjust the brightness of the display?
- 14 Documents / Resources
  - 14.1 References

**bticino 334253 Intercom Easykit Plus 7 Inch Additional Monitor**

## INSTRUCTION MANUAL

### Warnings and consumer rights



- Read carefully before use and keep for future reference.



- Touching the units with wet hands is forbidden.
- Using liquid cleaners or aerosols is forbidden.
- Blocking the ventilation openings is forbidden.
- Modifying the devices is forbidden.
- Removing protective parts from the devices is forbidden.
- Exposing the unit to water drops or splashes is forbidden.
- Installing the units near heat/cold sources is forbidden.
- Installing the units near harmful gases and powders is forbidden.
- Fastening the units on unsuitable surfaces is forbidden.



- Danger of electrical shock.



- Risk of devices falling because the surface on which they are installed collapses or inappropriate installation.
- Switch the power supply OFF before any work on the system.
- Remote operation may cause damage to people or property.



- Caution: Installation, configuration, starting-up and maintenance must be performed exclusively by qualified personnel.
- Check that the wall installation has been carried out correctly according to the installation instructions.
- Check that the unit installation complies with the standards in force.
- Connect the power supply wires as indicated.
- Use only the items indicated in the technical specifications for any system expansions.

## **Dimensional data**

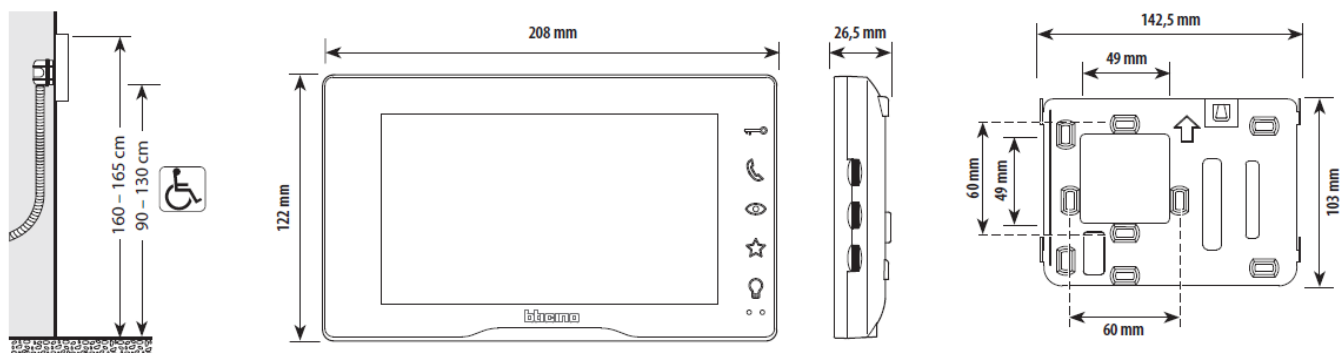

**Recommended height, unless different regulations are specified.**

## Assembly

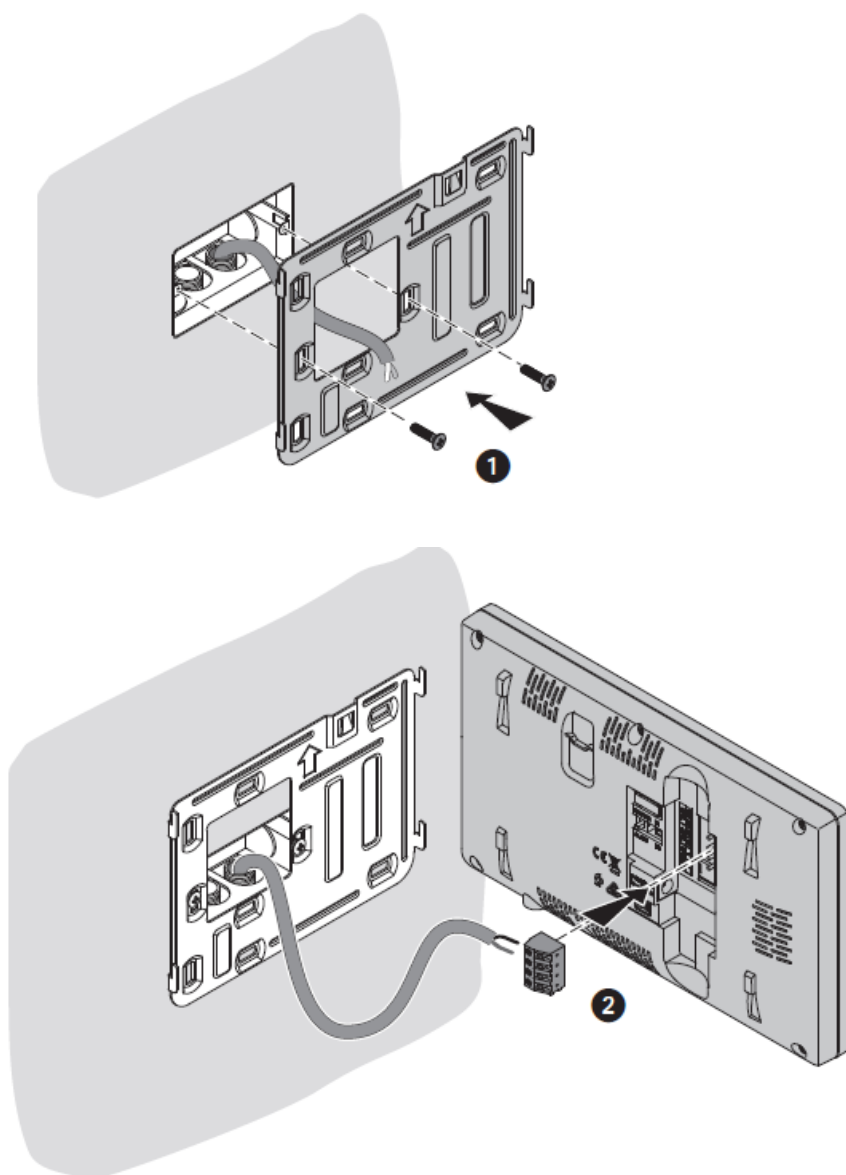

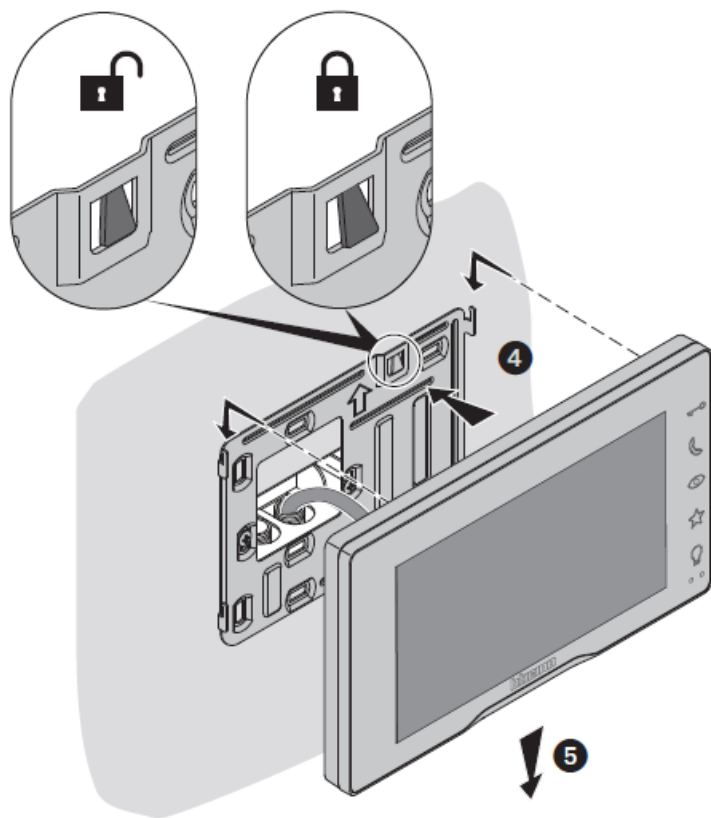
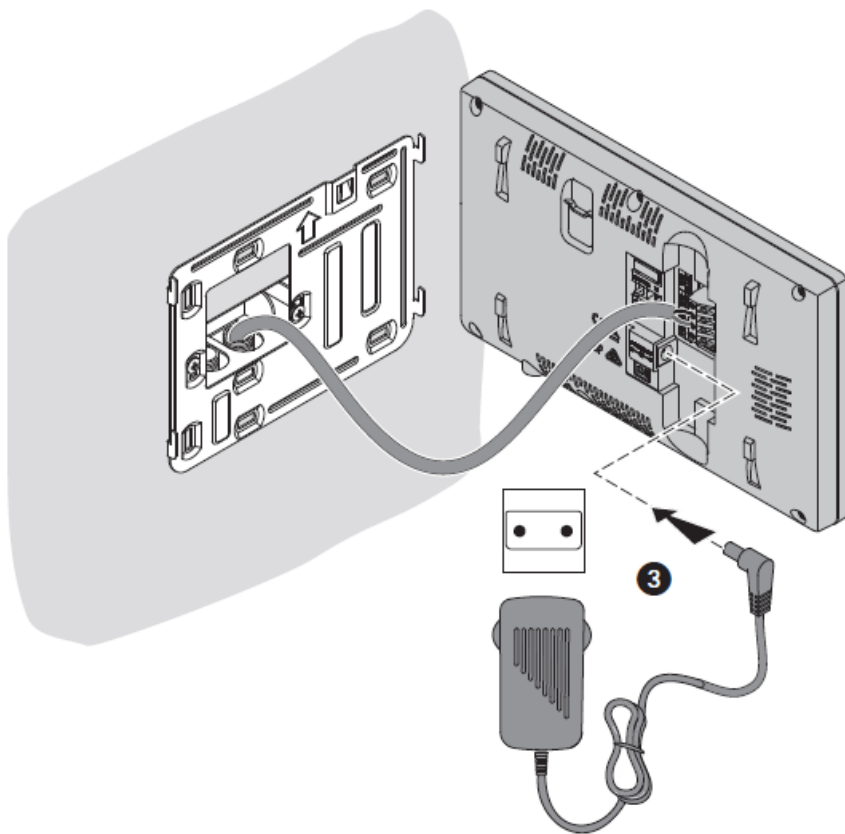

**Disassembling**

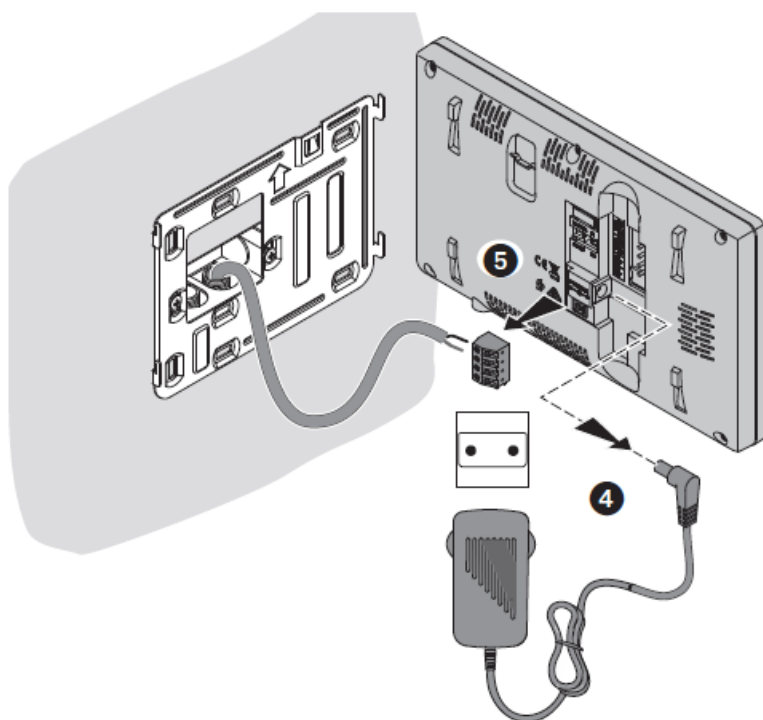
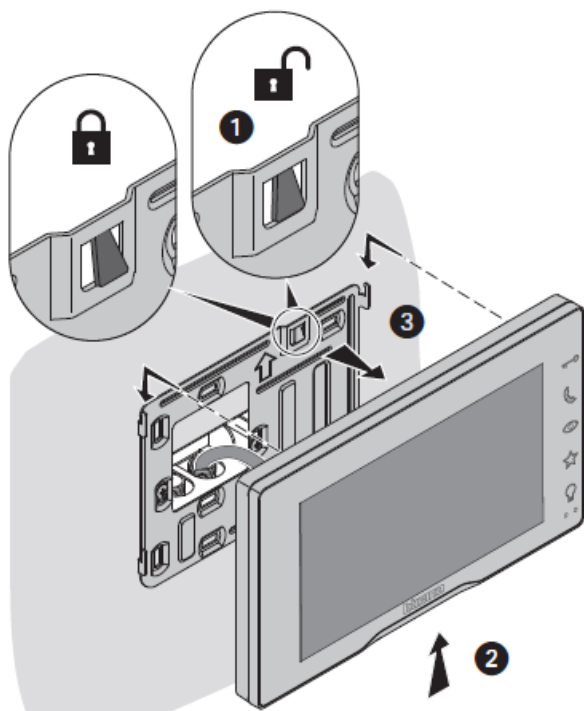

Front view

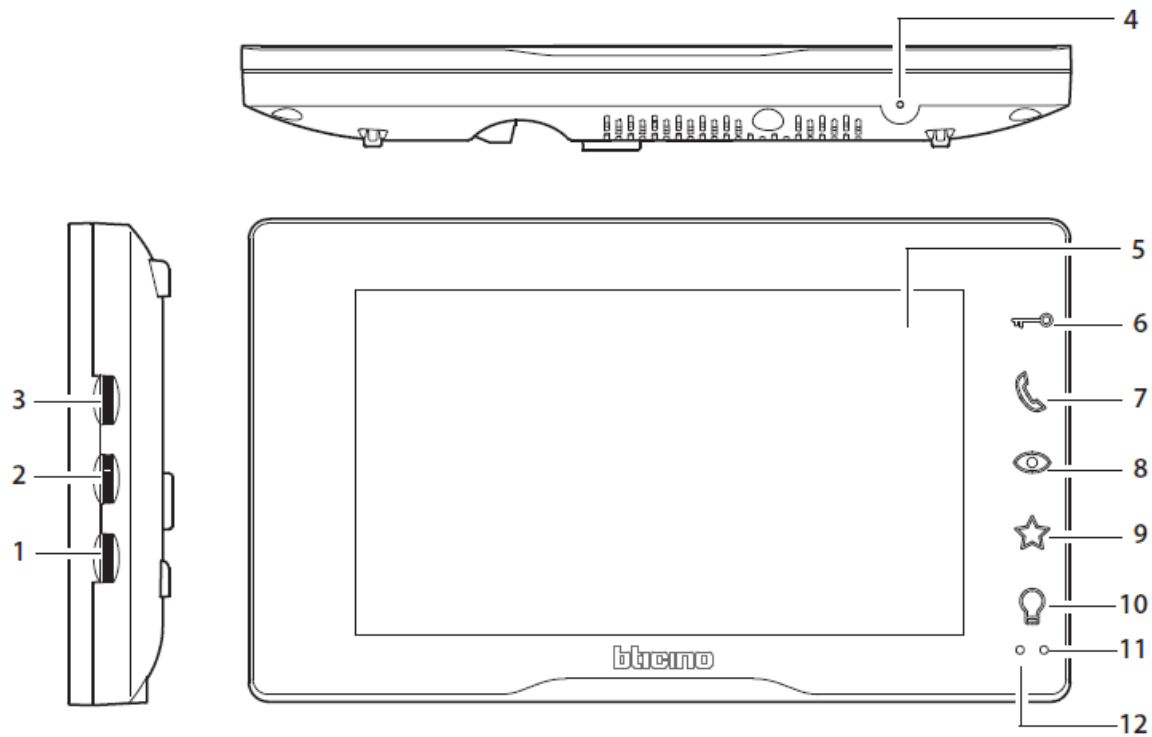

1. Colour adjustment
2. Brightness adjustment
3. Volume adjustment
4. Microphone
5. Display 7"
6. Door lock release pushbutton
7. Answer key / Intercom key (available only with additional internal unit)
8. Scrolling/entrance panel activation key
9. Gate lock release pushbutton
10. Light pushbutton
11. ON/OFF notification LED  
Blue = ON
12. Volume indication LED  
Red = minimum volume  
Blue = normal volume

## Available functions

- Door opening
- Gate opening
- Intercom
- Automatic switching on of the entrance panel
- Entrance panel scrolling
- Ringtone exclusion
- Light switching on
- Audio and video adjustments

**Note:** when idle, the door opening, gate opening and light control will act on the main Entrance Panel. However, during an audio video communication they will act on the communicating entrance panel.



[www.homesystems-legrandgroup.com](http://www.homesystems-legrandgroup.com)

## Back view

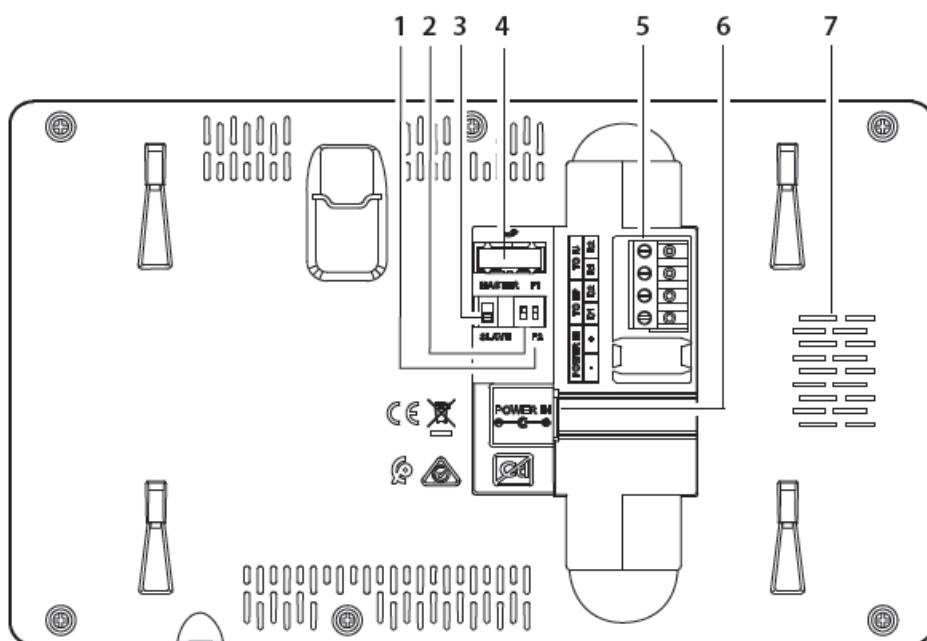

1. Micro switch for family 1 / family 2
2. Not used
3. Master / Slave micro switch
4. Not used
5. Removable connection clamps:  
D1 – D2 connection of the entrance panel or previous internal unit  
R1 – R2 connection of the additional internal unit
6. 30 Vdc; 30 W power supply
7. Speaker

## Wiring diagram

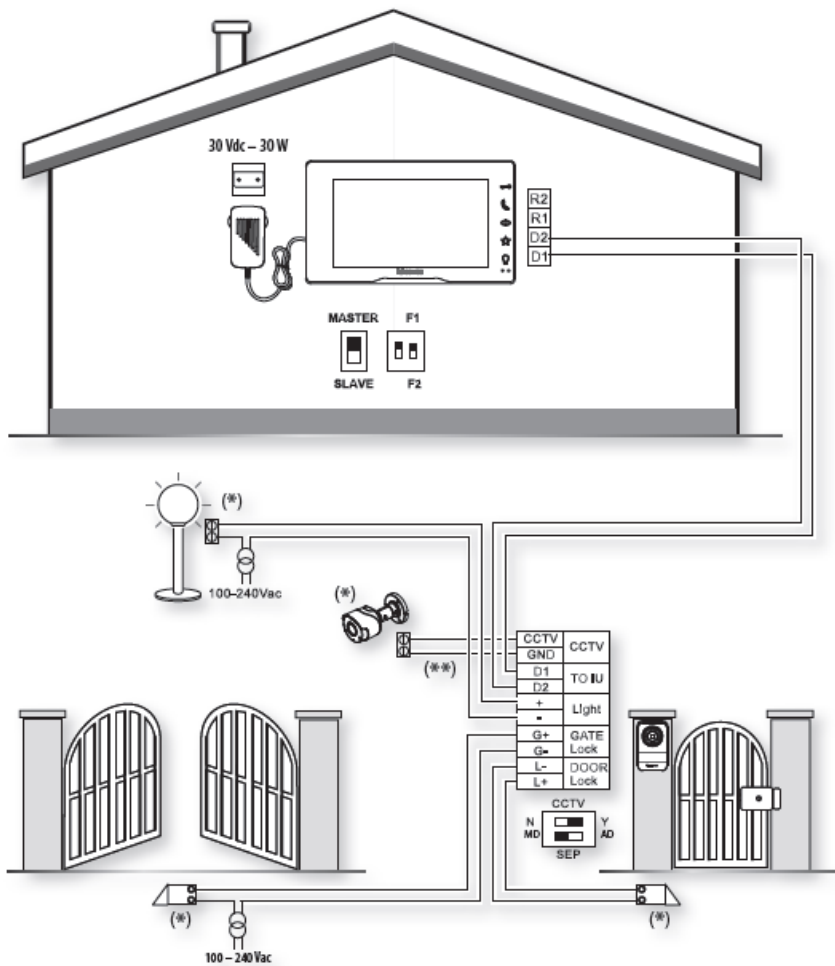

\* Can be purchased separately

\* \* Distance between CCTV camera and SEP (secondary entrance panel): coaxial 100 m

### Diagram with additional monitor

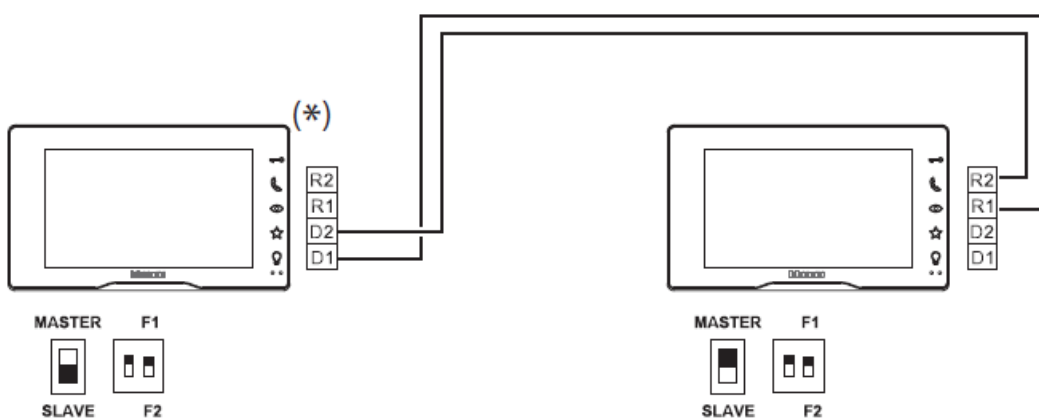
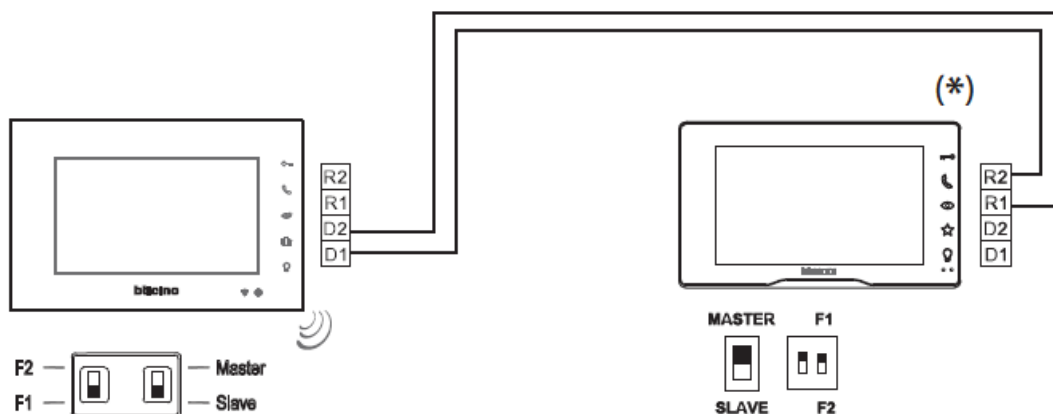

Diagram for connection as additional monitor(\*) for kits (\*\*):

317913 – 317914 – 318913 – 318914





### Diagram for connection as additional monitor(\*) for kits (\*\*):

310913 – 310914 – 316911 – 316913 – 317011 – 317013 – 317014 – 317113  
 317211 – 317213 – 318011 – 318012 – 318013 – 318015

### Technical data

- Power supply: 30 Vdc – 30 W
- Maximum cable section for each clamp: 2 x 0.5 mm<sup>2</sup>
- Operating temperature: 5 – 40 °C

### Distance between the last internal unit and the last entrance panel

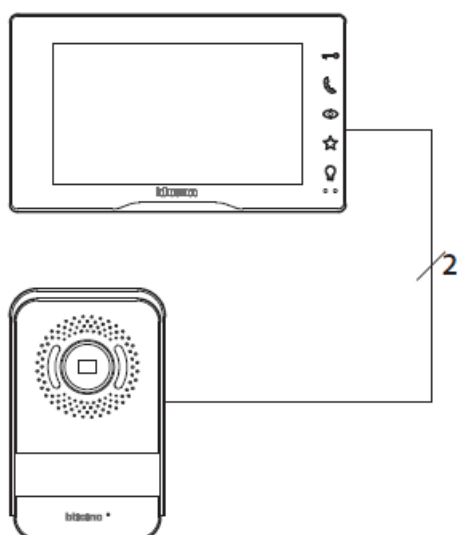

### Product Specifications

- Dimensions: 208 mm x 26.5 mm x 142.5 mm
- Weight: 49 mm
- Display Size: 60 mm x 49 mm

### Frequently Asked Questions (FAQ)

### 1. What is the purpose of the Volume Adjustment feature?

The Volume Adjustment feature allows users to control the audio output level of the device based on their preferences.

### 2. How do I release the door lock?

To release the door lock, simply press the Door Lock Release Pushbutton on the device.

### 3. Can I adjust the brightness of the display?

Yes, you can adjust the brightness of the display using the Brightness Adjustment feature available on the device.

---

## Documents / Resources

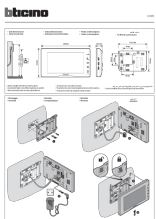
	<a href="#">bticino 334253 Intercom Easykit Plus 7 Inch Additional Monitor</a> [pdf] Instruction Manual 334253, LE14047AB, 334253 Intercom Easykit Plus 7 Inch Additional Monitor, Intercom Easykit Plus 7 Inch Additional Monitor, Easykit Plus 7 Inch Additional Monitor, 7 Inch Additional Monitor, Additional Monitor, Monitor
--	--

## References

- [b Bticino International](#)
- [Home - HS](#)
- [User Manual](#)

[Manuals+](#), [Privacy Policy](#)

This website is an independent publication and is neither affiliated with nor endorsed by any of the trademark owners. The "Bluetooth®" word mark and logos are registered trademarks owned by Bluetooth SIG, Inc. The "Wi-Fi®" word mark and logos are registered trademarks owned by the Wi-Fi Alliance. Any use of these marks on this website does not imply any affiliation with or endorsement.