



BTF CC-07 Mini Chainsaw Cordless Instruction Manual

[Home](#) » [BTF](#) » BTF CC-07 Mini Chainsaw Cordless Instruction Manual 



INSTRUCTION MANUAL
Cordless Chain Saw
CC-07

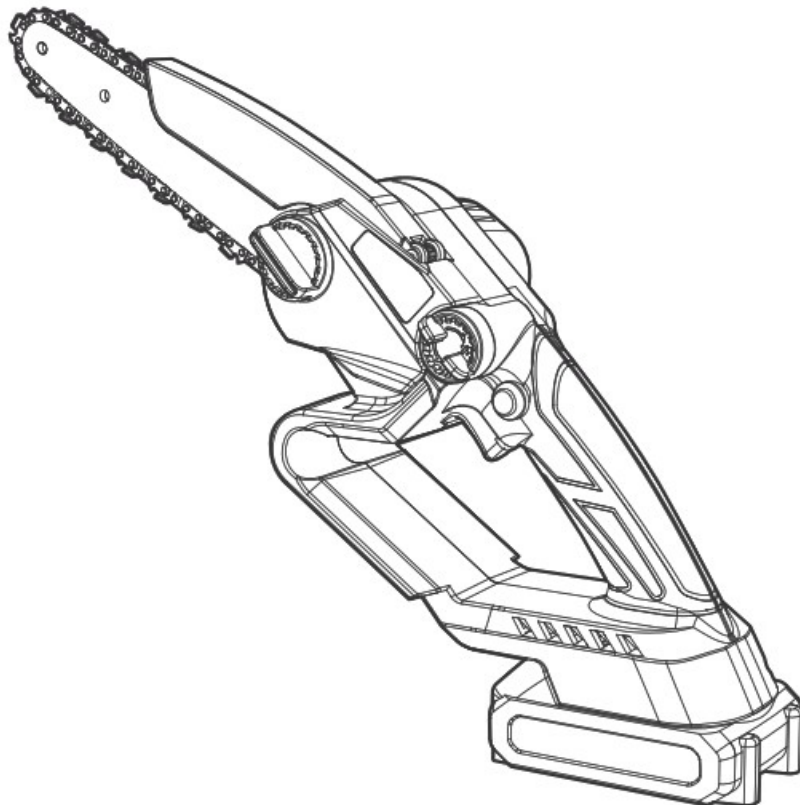

IMPORTANT: Read Before Using.
If you have questions or comments, contact us
Support@btftool.com
(Original instructions)

Contents

- [1 SPECIFICATIONS](#)
- [2 SAFETY WARNINGS](#)
- [3 PARTS DESCRIPTION](#)
- [4 FUNCTIONAL DESCRIPTION](#)
- [5 ASSEMBLY](#)
- [6 OPERATION](#)
- [7 MAINTENANCE](#)
- [8 TROUBLESHOOTING](#)
- [9 OPTIONAL ACCESSORIES](#)
- [10 Documents / Resources](#)
 - [10.1 References](#)
- [11 Related Posts](#)

SPECIFICATIONS

| | | |
|---|-----------------|--------------|
| Model: | | CC-07 |
| Total length (without guide plate and battery) | | 357mm |
| Rated voltage | | D.0 21V |
| Overheating protection | | 100 C |
| Primary overload protection | | 26A |
| Net weight | | 1.1 kg |
| Standard guide bar length | | 185 mm (6") |
| Recommended length of guide plate | | 185 mm (6") |
| sprocket | Number of teeth | 7 |
| | Tooth pitch | 0.325" |
| Chain speed | | 10 m/s |

- Due to our continuing program of research and development, the specifications herein are subject to change without notice.
- Specifications may differ from country to country.

*1: Weight, without the saw chain, guide bar, guide bar cover, oil and battery cartridge(s).

*2: The lightest and heaviest combination of weight, The weight may differ depending on the attachment(s), including the battery cartridge(s)

Saw chain, guide bar, and sprocket combination

 **WARNING:** Do not change the guide bar to a different length one. Inappropriate guide bar length may result in personal injury.

 **WARNING:** Use appropriate combination of the guide bar and saw chain. Otherwise personal injury may result.

SAFETY WARNINGS

General power tool safety warnings

 **WARNING:** Read all safety warnings, instructions, illustrations and specifications provided with this power tool. Failure to follow all instructions listed below may result in electric shock, fire and/or serious injury. Save all warnings and instructions for future reference. The term “power tool” in the warnings refers to your mains-operated (corded) power tool or battery-operated (cordless) power tool.

Work area safety

1. Keep work area clean and well lit. Cluttered or dark areas invite accidents.
2. Do not operate power tools in explosive atmospheres, such as in the presence of flammable liquids, gases or dust. Power tools create sparks which may ignite the dust or fumes.
3. Keep children and bystanders away while operating a power tool. Distractions can cause you to lose control.

Electrical safety

1. Power tool plugs must match the outlet.
Never modify the plug in any way. Do not use any adapter plugs with earthed (grounded) power tools. Unmodified plugs and matching outlets will reduce risk of electric shock.
2. Avoid body contact with earthed or grounded surfaces, such as pipes, radiators, ranges and refrigerators.
There is an increased risk of electric shock if your body is earthed or grounded.
3. Do not expose power tools to rain or wet conditions. Water entering a power tool will increase the risk of electric shock.
4. Do not abuse the cord. Never use the cord for carrying, pulling or unplugging the power tool. Keep cord away from heat, oil, sharp edges or moving parts. Damaged or entangled cords increase the risk of electric shock.
5. When operating a power tool outdoors, use an extension cord suitable for outdoor use. Use of a cord suitable for outdoor use reduces the risk of electric shock.
6. If operating a power tool in a damp location is unavoidable, use a ground fault circuit interrupter (GFCI) protected supply. Use of a GFCI reduces the risk of electric shock.
7. Power tools can produce electromagnetic fields (EMF) that are not harmful to the user. However, users of pacemakers and other similar medical devices should contact the maker of their device and/ or doctor for advice before operating this power tool.

Personal safety

1. Stay alert, watch what you are doing and use common sense when operating a power tool. Do not use a power tool while you are tired or under the influence of drugs, alcohol or medication. A moment of inattention while operating power tools may result in serious personal injury.
2. Use personal protective equipment. Always wear eye protection. Protective equipment such as a dust mask, non-skid safety shoes, hard hat or hearing protection used for appropriate conditions will reduce personal injuries.
3. Prevent unintentional starting. Ensure the switch is in the off-position before connecting to power source and/or

battery pack, picking up or carrying the tool. Carrying power tools with your finger on the switch or energising power tools that have the switch on invites accidents.

4. Remove any adjusting key or wrench before turning the power tool on. A wrench or a key left attached to a rotating part of the power tool may result in personal injury.
5. Do not overreach. Keep proper footing and balance at all times. This enables better control of the power tool in unexpected situations.
6. Dress properly. Do not wear loose clothing or jewellery. Keep your hair and clothing away from moving parts. Loose clothes, jewellery or long hair can be caught in moving parts.
7. If devices are provided for the connection of dust extraction and collection facilities, ensure these are connected and properly used. Use of dust collection can reduce dust-related hazards.
8. Do not let familiarity gained from frequent use of tools allow you to become complacent and ignore tool safety principles. A careless action can cause severe injury within a fraction of a second.
9. Always wear protective goggles to protect your eyes from injury when using power tools. The goggles must comply with ANSI Z87.1 in the USA.

It is an employer's responsibility to enforce the use of appropriate safety protective equipment by the tool operators and by other persons in the immediate working area.

Power tool use and care

1. Do not force the power tool. Use the correct power tool for your application. The correct power tool will do the job better and safer at the rate for which it was designed.
2. Do not use the power tool if the switch does not turn it on and off. Any power tool that cannot be controlled with the switch is dangerous and must be repaired.
3. Disconnect the plug from the power source and/or remove the battery pack, if detachable, from the power tool before making any adjustments, changing accessories, or storing power tools. Such preventive safety measures reduce the risk of starting the power tool accidentally.
4. Store idle power tools out of the reach of children and do not allow persons unfamiliar with the power tool or these instructions to operate the power tool. Power tools are dangerous in the hands of untrained users.
5. Maintain power tools and accessories. Check for misalignment or binding of moving parts, break-age of parts and any other condition that may affect the power tool's operation. If damaged, have the power tool repaired before use. Many accidents are caused by poorly maintained power tools.
6. Keep cutting tools sharp and clean. Properly maintained cutting tools with sharp cutting edges are less likely to bind and are easier to control.
7. Use the power tool, accessories and tool bits etc. in accordance with these instructions, taking into account the working conditions and the work to be performed. Use of the power tool for operations different from those intended could result in a hazardous situation.
8. Keep handles and grasping surfaces dry, clean and free from oil and grease. Slippery handles and grasping surfaces do not allow for safe handling and control of the tool in unexpected situations.
9. When using the tool, do not wear cloth work gloves which may be entangled. The entanglement of cloth work gloves in the moving parts may result in personal injury

Battery tool use and care

1. Recharge only with the charger specified by the manufacturer. A charger that is suitable for one type of battery

pack may create a risk of fire when used with another battery pack.

2. Use power tools only with specifically designated battery packs. Use of any other battery packs may create a risk of injury and fire.
3. When battery pack is not in use, keep it away from other metal objects, like paper clips, coins, keys, nails, screws or other small metal objects, that can make a connection from one terminal to another. Shorting the battery terminals together may cause burns or a fire.
4. Under abusive conditions, liquid may be ejected from the battery; avoid contact. If contact accidentally occurs, flush with water. If liquid contacts eyes, additionally seek medical help. Liquid ejected from the battery may cause irritation or burns.
5. Do not use a battery pack or tool that is damaged or modified. Damaged or modified batteries may exhibit unpredictable behaviour resulting in fire, explosion or risk of injury.
6. Do not expose a battery pack or tool to fire or excessive temperature. Exposure to fire or temperature above 130 °C may cause explosion.
7. Follow all charging instructions and do not charge the battery pack or tool outside the temperature range specified in the instructions. Charging improperly or at temperatures outside the specified range may damage the battery and increase the risk of fire.

Service

1. Have your power tool serviced by a qualified repair person using only identical replacement parts. This will ensure that the safety of the power tool is maintained.
2. Never service damaged battery packs. Service of battery packs should only be performed by the manufacturer or authorized service providers.
3. Follow instruction for lubricating and changing accessories.
4. Do not modify or attempt to repair the appliance or the battery pack except as indicated in the instructions for use and care.

General pruning saw safety warnings

1. Keep all parts of the body away from the saw chain when the pruning saw is operating. Before you start the pruning saw, make sure the saw chain is not contacting anything. A moment of inattention while operating pruning saws may cause entanglement of your clothing or body with the saw chain.
2. Hold the pruning saw by insulated gripping surfaces only, because the saw chain may contact hidden wiring. Saw chains contacting a “live” wire may make exposed metal parts of the pruner saw “live” and could give the operator an electric shock.
3. Wear eye protection. Further protective equipment for hearing, head, hands, legs and feet is recommended. Adequate protective equipment will reduce personal injury from flying debris or accidental contact with the saw chain.
4. Do not operate a pruning saw in a tree, on a ladder, from a rooftop, or any unstable support. Operation of a pruning saw in this manner could result in serious personal injury.
5. Always keep proper footing and operate the pruning saw only when standing on fixed, secure and level surface. Slippery or unstable surfaces may cause a loss of balance or control of the pruning saw.
6. When cutting a branch that is under tension, be alert for spring back. When the tension in the wood fibres is released, the spring loaded branch may strike the operator and/or throw the pruning saw out of control.

7. Use extreme caution when cutting brush and saplings. The slender material may catch the saw chain and be whipped toward you or pull you off balance.
8. Carry the pruning saw with the pruning saw switched off and away from your body. When transporting or storing the pruning saw, always fit the guide bar cover. Proper handling of the pruning saw will reduce the likelihood of accidental contact with the moving saw chain.
9. Follow instructions for lubricating, chain tensioning and changing the bar and chain. Improperly tensioned or lubricated chain may either break or increase the chance for kickback.
10. Cut wood only. Do not use pruning saw for purposes not intended. For example: do not use pruning saw for cutting metal, plastic, masonry or non-wood building materials. Use of the pruning saw for operations different than intended could result in a hazardous situation.
11. This pruning saw is not intended for tree felling. Use of the pruning saw for operations different than intended could result in serious injury to the operator or bystanders.
12. Causes and operator prevention of kickback: Kickback may occur when the nose or tip of the guide bar touches an object, or when the wood closes in and pinches the saw chain in the cut. Tip contact in some cases may cause a sudden reverse reaction, kicking the guide bar up and back towards the operator.
Pinching the saw chain along the top of the guide bar may push the guide bar rapidly back towards the operator.
Either of these reactions may cause you to lose control of the saw which could result in serious personal injury. Do not rely exclusively upon the safety devices built into your saw. As a pruning saw user, you should take several steps to keep your cutting jobs free from accident or injury. Kickback is the result of pruning saw misuse and/ or incorrect operating procedures or conditions and can be avoided by taking proper precautions as given below:
 - Do not overreach and do not cut above shoulder height. This helps prevent unintended tip contact and enables better control of the pruning saw in unexpected situations.
 - Only use replacement guide bars and saw chains specified by the manufacturer. Incorrect replacement guide bars and saw chains may cause chain breakage and/or kickback.
 - Follow the manufacturer's sharpening and maintenance instructions for the saw chain. Decreasing the depth gauge height can lead to increased kickback.
13. Follow all instructions when clearing jammed material, storing or servicing the pruning saw. Make sure the switch is off and the battery pack is removed.

Additional Safety Instructions

Personal protective equipment

1. Clothing must be close-fitting, but must not obstruct mobility.
2. Wear the following protective clothing during work:
 - A tested safety helmet, if a hazard is presented by falling branches or similar;
 - A face mask or goggles;
 - Suitable ear protection (ear muffs, custom or mouldable ear plugs). Octave band analysis upon request.
 - Firm leather safety gloves;
 - Long trousers manufactured from strong fabric;
 - Protective dungarees of cut-resistant fabric;
 - Safety shoes or boots with non-slip soles, steel toes, and cut-resistant fabric lining;A breathing mask, when carrying out work which produces dust (e.g. sawing dry wood).

Operation

1. Before starting work, check that the tool is in proper working order and that its condition complies with the safety regulations. Check in particular that:
 - The run-down brake is working properly;
 - The bar and the sprocket cover are fitted correctly;
 - The chain has been sharpened and tensioned in accordance with the regulations.
1. Do not start the tool with the chain cover being installed on it. Starting the tool with the chain cover being installed on it may cause the chain cover to throw out forward resulting in personal injury and damage to objects around the operator.
2. Do not stand directly under the branch that is being cut. Pay attention to the falling branches.
3. Do not operate the tool in bad weather or if there is a risk of lightning.
4. When you use the tool on muddy ground, wet slope, or slippery place, pay attention to your footing.

Electrical and battery safety



1. Avoid dangerous environment. Don't use the tool in damp or wet locations or expose it to rain. Water entering the tool will increase the risk of electric shock.
2. Do not dispose of the battery(ies) in a fire. The cell may explode. Check with local codes for possible special disposal instructions.
3. Do not open or mutilate the battery(ies). Released electrolyte is corrosive and may cause damage to the eyes or skin. It may be toxic if swallowed.
4. Do not charge battery in rain, or in wet locations.
5. Do not charge the battery outdoors.
6. Do not handle charger, including charger plug, and charger terminals with wet hands.
7. Do not replace the battery with wet hands.
8. Do not leave the battery in the rain, nor charge, use, or store the battery in a damp or wet place.
9. Do not wet the terminal of battery with liquid such as water, or submerge the battery. If the terminal gets wet or liquid enters inside of battery, the battery may be short circuited and there is a risk of overheating, fire, or explosion.
10. After removing the battery from the machine or charger, be sure to attach the battery cover to the battery and store it in a dry
11. place. If the battery cartridge gets wet, drain the water inside and then wipe it with a dry cloth. Dry the battery cartridge completely in a dry place before use.

SAVE THESE INSTRUCTIONS.

 **WARNING:** DO NOT let comfort or familiarity with product (gained from repeated use) replace strict adherence to safety rules for the subject product. MISUSE or failure to follow the safety rules stated in this instruction manual may cause serious personal injury.

Symbols

The followings show the symbols used for tool.

| | |
|---|--|
| v | volts |
|  | direct current |
|  | parts number of applicable saw chain and guide bar |

Important safety instructions for battery cartridge

- Before using battery cartridge, read all instructions and cautionary markings on (1) battery charger, (2) battery, and (3) product using battery.
- Do not disassemble or tamper with the battery cartridge. It may result in a fire, excessive heat, or explosion.
- If operating time has become excessively shorter, stop operating immediately. It may result in a risk of overheating, possible burns and even an explosion.
- If electrolyte gets into your eyes, rinse them out with clear water and seek medical attention right away. It may result in loss of your eyesight.
- Do not short the battery cartridge:
 - Do not touch the terminals with any conductive material.
 - Avoid storing battery cartridge in a container with other metal objects such as nails, coins, etc.
 - Do not expose battery cartridge to water or rain.

A battery short can cause a large current flow, overheating, possible burns and even a breakdown.
- Do not store and use the tool and battery cartridge in locations where the temperature may reach or exceed 50 °C (122 °F).
- Do not incinerate the battery cartridge even if it is severely damaged or is completely worn out. The battery cartridge can explode in a fire.
- Do not nail, cut, crush, throw, drop the battery cartridge, or hit against a hard object to the battery cartridge. Such conduct may result in a fire, excessive heat, or explosion.
- Do not use a damaged battery.
- The contained lithium-ion batteries are subject to the Dangerous Goods Legislation requirements.

For commercial transports e.g. by third parties, forwarding agents, special requirement on packaging and labeling must be observed.

For preparation of the item being shipped, consulting an expert for hazardous material is required. Please also observe possibly more detailed national regulations.

Tape or mask off open contacts and pack up the battery in such a manner that it cannot move around in the packaging.
- When disposing the battery cartridge, remove it from the tool and dispose of it in a safe place. Follow your local regulations relating to disposal of battery.
- Use the batteries only with the products specified by BTF. Installing the batteries to non-compliant products may result in a fire, excessive heat, explosion, or leak of electrolyte.
- If the tool is not used for a long period of time, the battery must be removed from the tool.
- During and after use, the battery cartridge may take on heat which can cause burns or low temperature burns. Pay attention to the handling of hot battery cartridges.
- Do not touch the terminal of the tool immediately after use as it may get hot enough to cause burns.

16. Do not allow chips, dust, or soil stuck into the terminals, holes, and grooves of the battery cartridge. It may cause heating, catching fire, burst and malfunction of the tool or battery cartridge, resulting in burns or personal injury.
17. Unless the tool supports the use near high-voltage electrical power lines, do not use the battery cartridge near high-voltage electrical power lines. It may result in a malfunction or breakdown of the tool or battery cartridge.
18. Keep the battery away from children.

⚠ CAUTION: Only use genuine BTF batteries. Use of non-genuine BTF batteries, or batteries that have been altered, may result in the battery bursting causing fires, personal injury and damage. It will also void the BTF warranty for the BTF tool and charger.

Tips for maintaining maximum battery life

1. Charge the battery cartridge before completely discharged. Always stop tool operation and charge the battery cartridge when you notice less tool power.
2. Never recharge a fully charged battery cartridge. Overcharging shortens the battery service life.
3. Charge the battery cartridge with room temperature at 10 °C – 40 °C (50 °F – 104 °F). Let a hot battery cartridge cool down before charging it.
4. When not using the battery cartridge, remove it from the tool or the charger.
5. Charge the battery cartridge if you do not use it for a long period (more than Two months).

PARTS DESCRIPTION

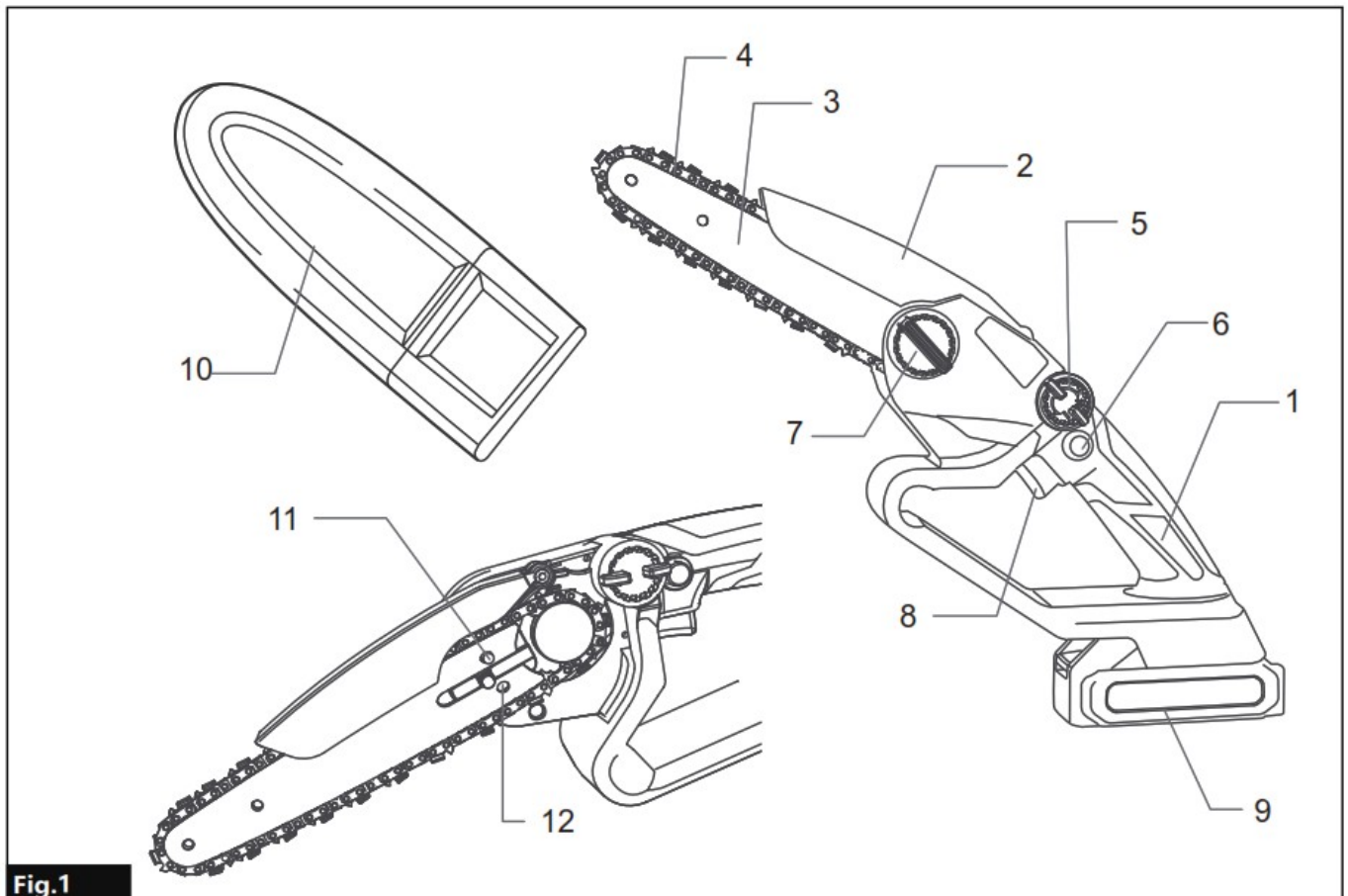

| | | | | | |
|----|--------------------|----|-----------------------|----|-------------------|
| 1 | Comfortable handle | 2 | Safety cover | 3 | Guide bar |
| 4 | Saw chain | 5 | Chain tensioning knob | 6 | Lock-off lever |
| 7 | Sprocket cover | 8 | Switch trigger | 9 | Battery cartridge |
| 10 | Guide bar cover | 11 | Pin | 12 | Hole |

FUNCTIONAL DESCRIPTION

⚠ CAUTION: Always be sure that the tool is switched off and the battery cartridge is removed before adjusting or checking function on the tool.

Installing or removing battery cartridge

Indicating the remaining battery capacity Only for battery cartridges with the indicator

⚠ CAUTION: Always switch off the tool before installing or removing of the battery cartridge.

⚠ CAUTION: Hold the tool and the battery cartridge firmly when installing or removing battery cartridge. Failure to hold the tool and the battery cartridge firmly may cause them to slip off your hands and result in damage to the tool and battery cartridge and a personal injury.

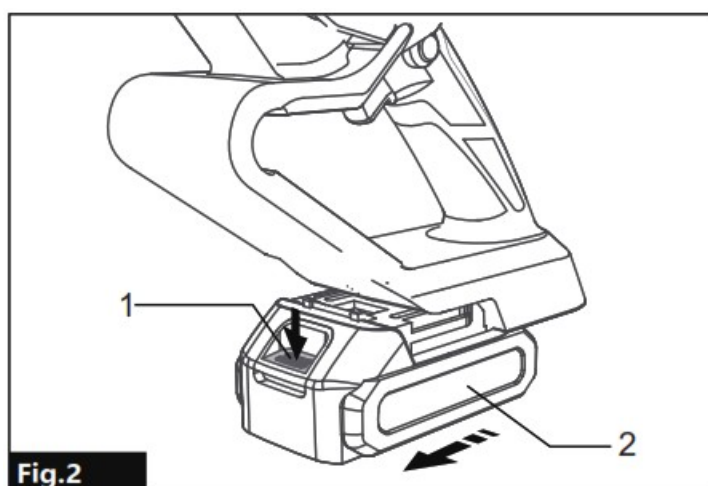

► 1. Button 2. Battery cartridge

To remove the battery cartridge, slide it from the tool while sliding the button on the front of the cartridge. To install the battery cartridge, align the tongue on the battery cartridge with the groove in the housing and slip it into place. Insert it all the way until it locks in place with a little click.

⚠ CAUTION: Always install the battery cartridge fully until the red indicator cannot be seen. If not, it may accidentally fall out of the tool, causing injury to you or someone around you.

⚠ CAUTION: Do not install the battery cartridge forcibly. If the cartridge does not slide in easily, it is not being inserted correctly.





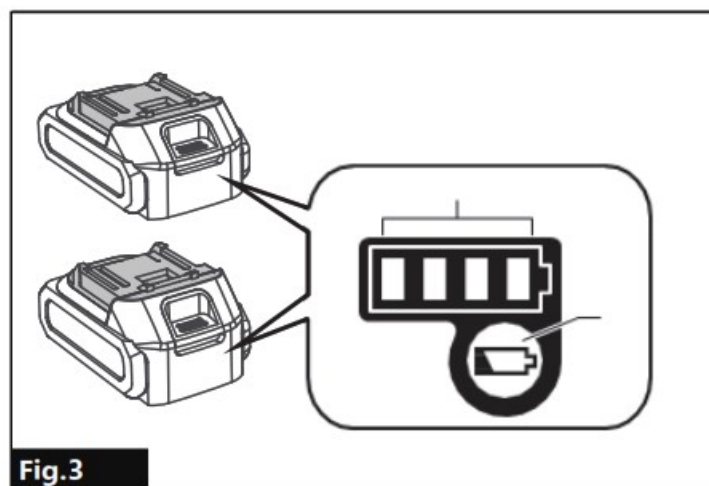



Indicating the remaining battery capacity

Only for battery cartridges with the indicator



► 1. Indicator lamps 2. Check button

Press the check button on the battery cartridge to indicate the remaining battery capacity. The indicator lamps light up for a few seconds.

| | | | Remaining capacity |
|--|--|---|--------------------|
|  Lighted |  Off |  Blinking | |
|  | | | 75% to 100% |
|  | | | 50% to 75% |
|  | | | 25% to 50% |
|  | | | 0% to 25% |
|  | | | Charge the battery |

⚠ NOTE: Depending on the conditions of use and the ambient temperature, the indication may differ slightly from the actual capacity.

⚠ NOTE: The first (far left) indicator lamp will blink when the battery protection system works.

Tool / battery protection system

Overload protection

When the tool or battery is operated in a manner that causes it to draw an abnormally high current, the tool automatically stops. In this situation, turn the tool off and stop the application that caused the tool to become overloaded. Then turn the tool on to restart.

Overload protection

When the tool or battery is overheated, the tool stops automatically. In this case, let the tool and battery cool

before turning the tool on again.

Overload protection

When the battery capacity is not enough, the tool stops automatically. In this case, remove the battery from the tool and charge the battery.

Switch action

⚠ WARNING: For your safety, this tool is equipped with lock-off lever which prevents the tool from unintended starting. NEVER use the tool if it runs when you simply pull the switch trigger without pressing the lock-off lever. Return the tool to our authorized service center for proper repairs BEFORE further usage.

⚠ WARNING: NEVER tape down or defeat purpose and function of lock-off lever.

⚠ CAUTION: Before installing the battery cartridge into the tool, always check to see that the switch trigger actuates properly and returns to the “OFF” position when released.

⚠ NOTICE: Do not pull the switch trigger hard without pressing the lock-off lever. This can cause switch breakage.

To prevent the switch trigger from being accidentally pulled, a lock-off lever is provided. To start the tool, depress the lock-off lever and pull the switch trigger.

Release the switch trigger to stop.

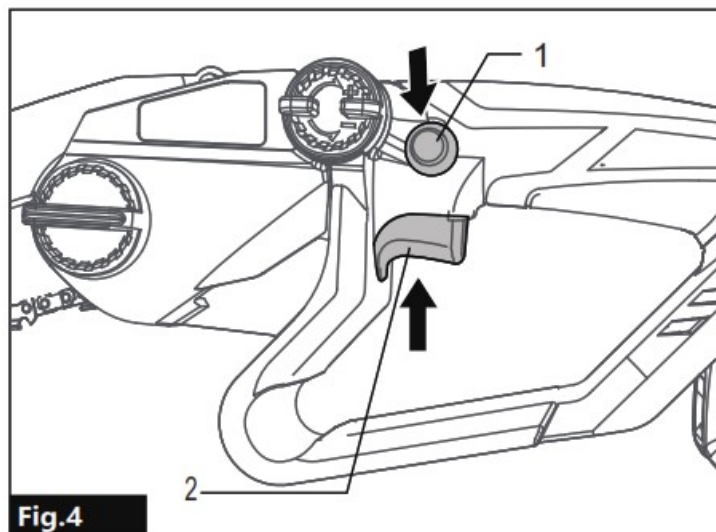

1. Lock-off lever 2. Switch trigger

Run the tool, and then release the switch trigger completely. The saw chain must come to a standstill within a few seconds.

Checking the run-down brake

⚠ CAUTION: If the saw chain does not stop within a few seconds in this test, stop using the tool and consult our authorized service center.

ASSEMBLY

⚠ CAUTION: Always be sure that the tool is switched off and the battery cartridge is removed before carrying out any work on the tool.

⚠ CAUTION: Do not touch the saw chain with bare hands. Always wear gloves when handling the saw chain.

Removing or installing saw chain

⚠ CAUTION: The saw chain and the guide bar are still hot just after the operation. Let them cool down enough before carrying out any work on the tool.

⚠ CAUTION: Carry out the procedure of installing or removing saw chain in a clean place free from sawdust

and the like.

Removing the saw chain

To remove the saw chain, perform the following steps:

1. Turn the lever counterclockwise until the sprocket cover comes off.

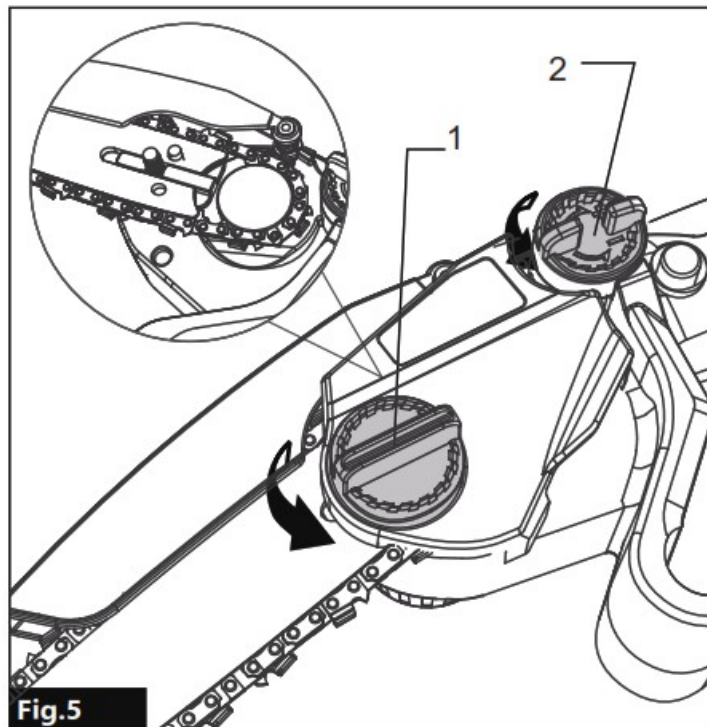

1. Lever 2. Chain tensioning knob

2. Turn the Chain tensioning knob counterclockwise then remove the saw chain from the tool body.

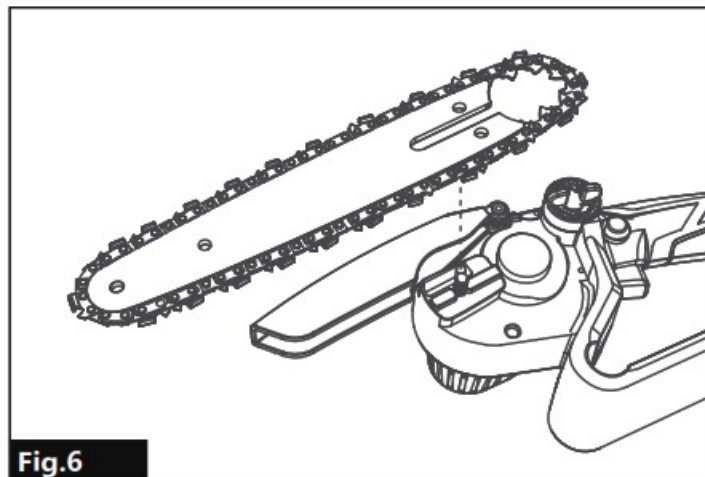

3. Remove the guide bar from the tool body

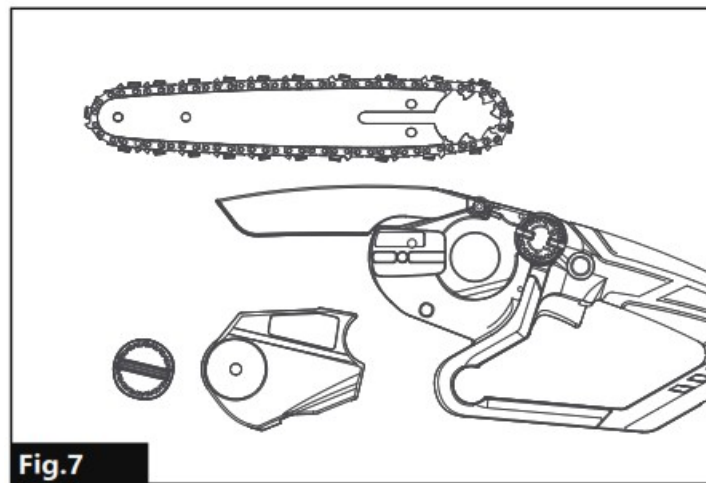

Installing the saw chain

To install the saw chain, perform the following steps:

1. Turn the lever counterclockwise until the sprocket cover comes off.

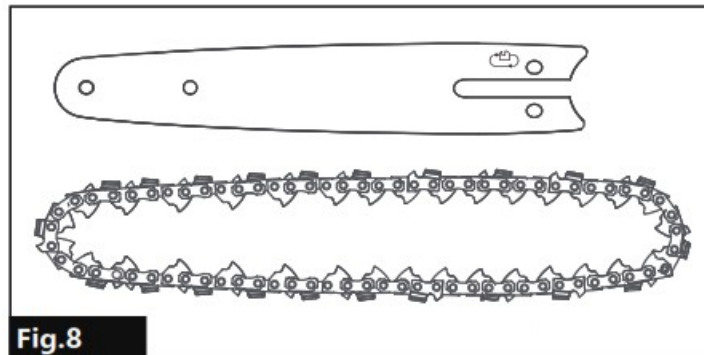

2. Check the direction of the saw chain. Match the direction of the saw chain with that of the mark on the tool body.

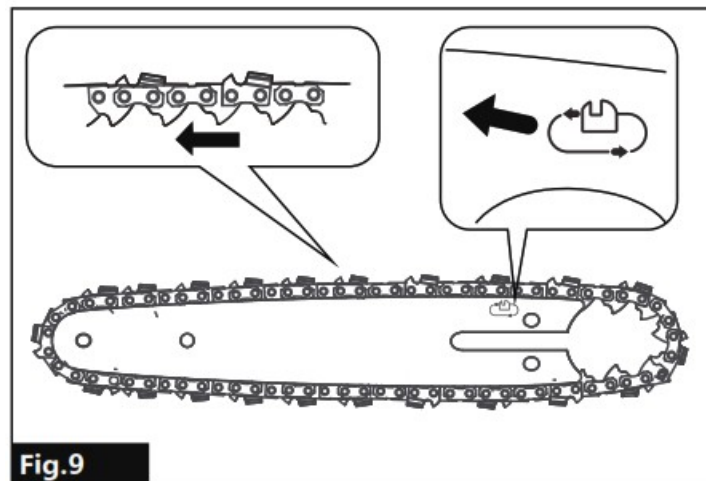

3. Align the hole on the guide bar with the pin on the tool body, and then place the guide bar as shown in the figure.

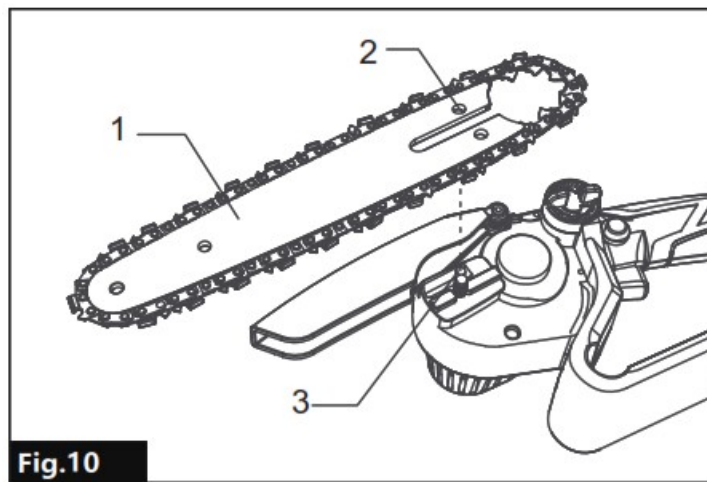

1. Guide bar 2. Hole 3. Pin

4. Slide the guide bar toward the sprocket to lock the pin.

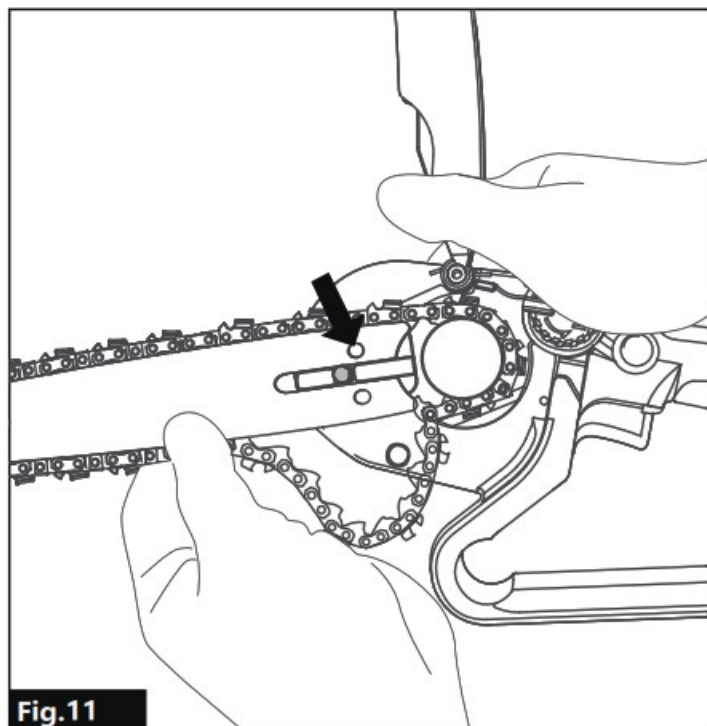

1. Guide bar 2. Pin

5. Turn the Chain tensioning knob clockwise to tight the chain lightly.

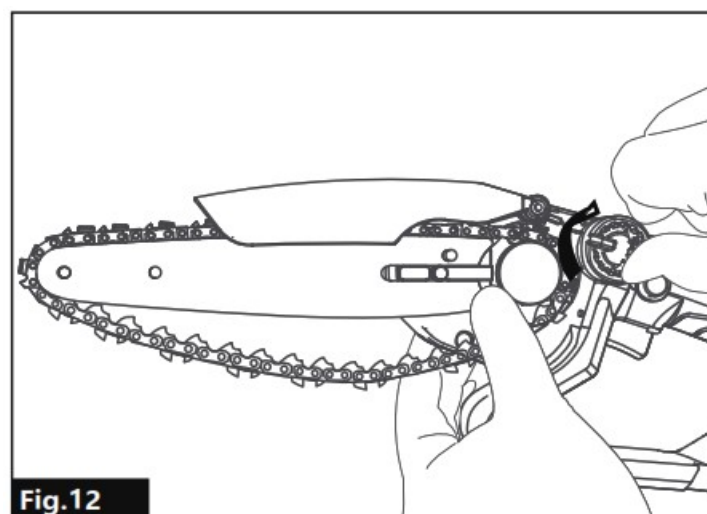

6. The tension is correct when the chain snaps back after being pulled 1/8" (3 mm) away from the guide bar 4 with light force from the index finger and thumb as shown

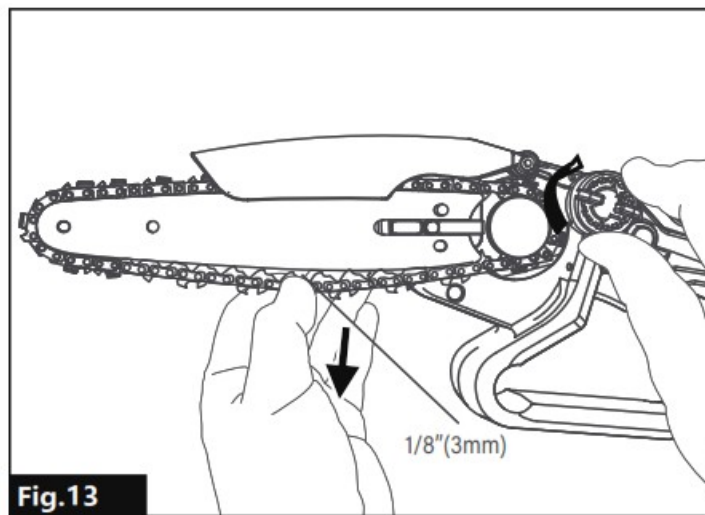

Fig.13

7. Place the sprocket cover so that the bolt and pin on the tool body meet their counterparts on the sprocket cover.

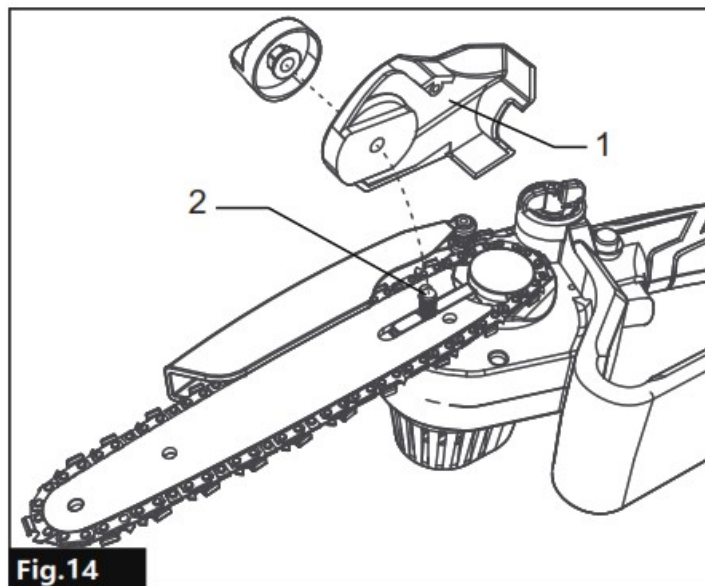

Fig.14

1. Sprocket cover 2. Bolt

Adjusting saw chain tension

Turn the Chain tensioning knob counterclockwise/clockwise a little to loosen/tight the chain lightly, The chain tension is adjusted, no tools required.

1. Turn the Chain tensioning knob clockwise to tight the chain lightly.

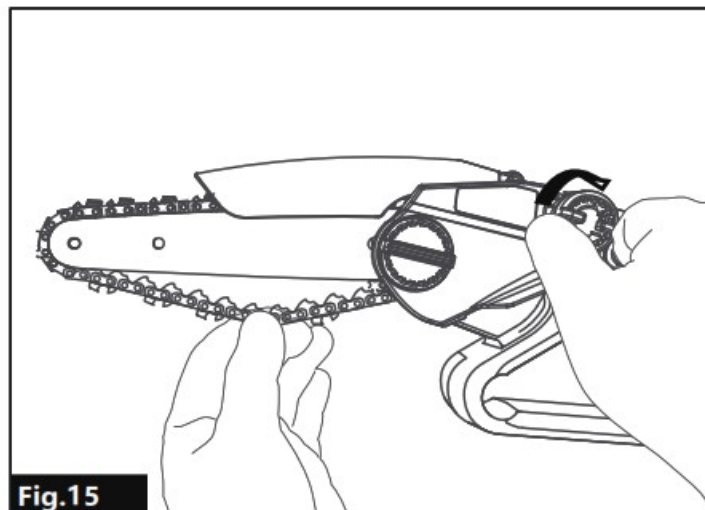
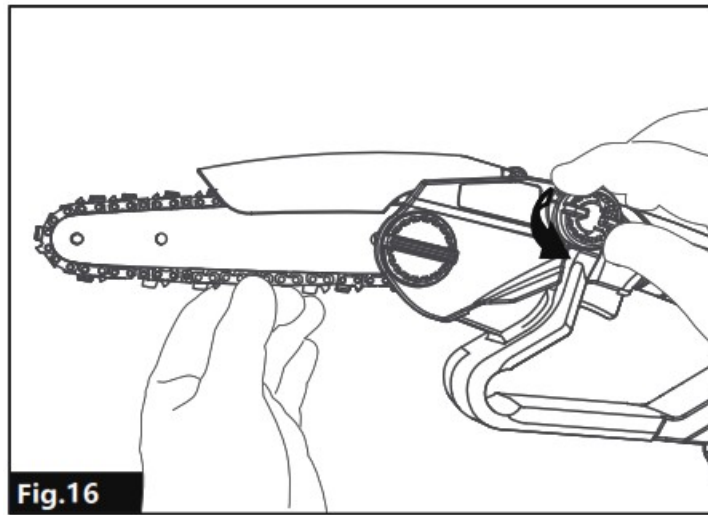

Fig.15

2. Turn the Chain tensioning knob counterclockwise to loosen the chain lightly.



OPERATION

Lubrication

⚠ CAUTION: Do not operate this tool without oil. Oil the saw blade promptly before using the chain saw.

⚠ CAUTION: Prevent the oil from coming into contact with the skin and eyes. Contact with the eyes causes irritation. In the event of eye contact, flush the affected eye immediately with clear water, then consult a doctor at once.

⚠ CAUTION: Never use waste oil. Waste oil contains carcinogenic substances. The contaminants in waste oil cause accelerated wear of the oil pump, the bar and the chain. Waste oil is harmful to the environment.

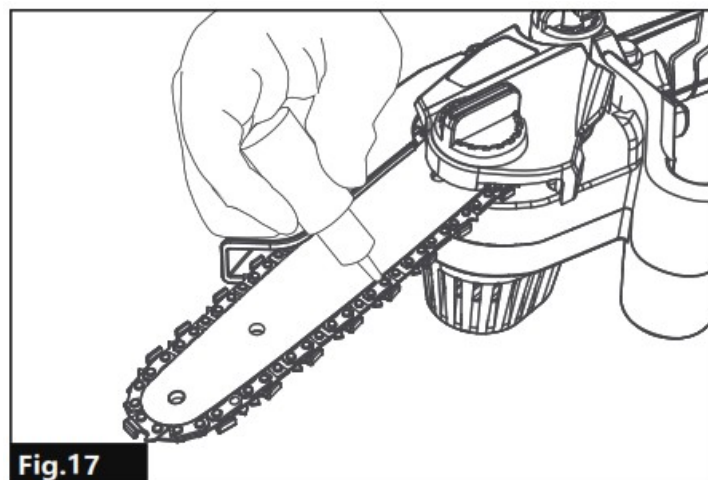

⚠ NOTICE: Use the saw chain oil exclusively for BTF tools or equivalent oil available in the market.

⚠ NOTICE: Never use oil including dust and particles or volatile oil.

⚠ NOTICE: When pruning trees, use botanical oil. Mineral oil may harm trees.

⚠ NOTICE: Before the cutting operation, make sure that the provided oil tank cap is screwed in place.

⚠ CAUTION: Before the cutting operation, make sure that the branch to be cut is in contact with the root of guide bar and the support part of tool body.

Otherwise, the tool may be pulled toward the tip of guide bar and the guide bar may wobble, and may result in an injury.

Working with the tool

⚠ CAUTION: Keep all parts of the body away from the saw chain when the tool is operating.

⚠ CAUTION: Hold the tool firmly with both hands when the tool is operating.

⚠ CAUTION: Do not overreach. Keep proper footing and balance at all times.

NOTICE: Never toss or drop the tool.

NOTICE: Do not cover the vents of the tool.

Before starting the tool, bring the root of guide bar and the support part of tool body in contact with the branch to be cut as shown in the figure. While contacting the branch with the tool and guide bar, start the tool and saw the branch by moving the tool down along the branch.

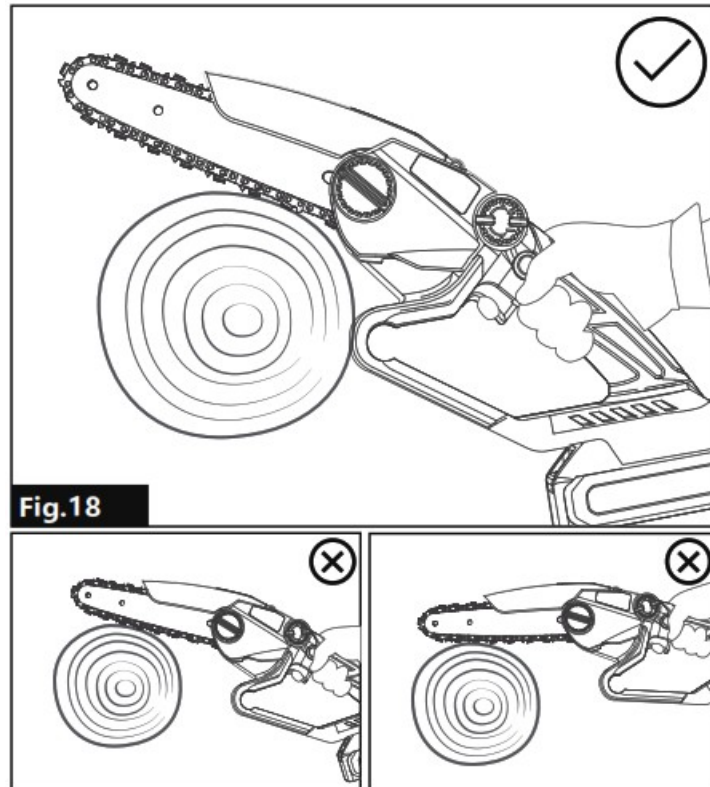

Carrying tool

Before carrying the tool, always remove the battery cartridge from the tool. Then attach the guide bar cover.

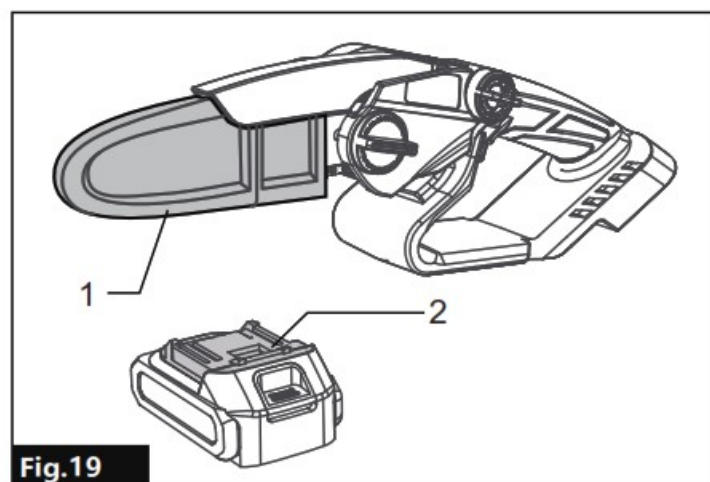

1. Guide bar cover 2. Battery cover

⚠ WARNING: If you are using CC-06, do not use the holster for 100 mm (4") guide bar length, and be sure to use the holster for 150 mm (6") guide bar length. If you use the holster for 100 mm (4") guide bar length, the guide bar of your tool will not fit completely in the holster and it is very dangerous.

MAINTENANCE

Lubrication

⚠ CAUTION: Always be sure that the tool is switched off and the battery cartridge is removed before attempting to perform inspection or maintenance.

⚠ CAUTION: Always wear gloves when performing any inspection or maintenance.

NOTICE: Never use gasoline, benzine, thinner, alcohol or the like. Discoloration, deformation or cracks may result.

To maintain product SAFETY and RELIABILITY, repairs, any other maintenance or adjustment should be performed by BTF Authorized or Factory Service Centers, always using BTF replacement parts.

Sharpening the saw chain

Sharpen the saw chain when:

- Mealy sawdust is produced when damp wood is cut;
- The chain penetrates the wood with difficulty, even when heavy pressure is applied;
- The cutting edge is obviously damaged;
- The saw pulls to the left or right in the wood. (caused by uneven sharpening of the saw chain or damage to one side only)

Sharpen the saw chain frequently but a little each time. Two or three strokes with a file are usually sufficient for routine reshaping. When the saw chain has been reshaped several times, have it sharpened in our authorized service center

File and file guiding

____ Use a special round file (optional accessory) for saw chains to sharpen the chain. Normal round files are not suitable.

____ Diameter of the round file for each saw chain is as follows:

- Chain blade 80TXL : 4.0 mm (5/32")

____ The file should only engage the cutter on the forward stroke. Lift the file off the cutter on the return stroke.

____ Sharpen the shortest cutter first. Then the length of this shortest cutter becomes the standard for all other cutters on the saw chain. Guide the file as shown in the figure.

Cleaning the guide bar

Chips and sawdust will build up in the guide bar groove. They may clog the bar groove and impair the oil flow. Clean out the chips and sawdust every time when you sharpen or replace the saw chain.

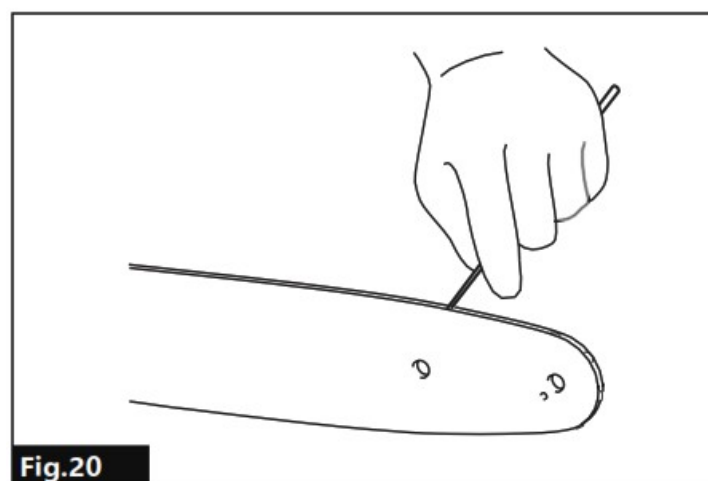

Sharpening the saw chain

Chips and saw dust will accumulate inside of the sprocket cover. Remove the sprocket cover and saw chain from the tool then clean the chips and saw dust.

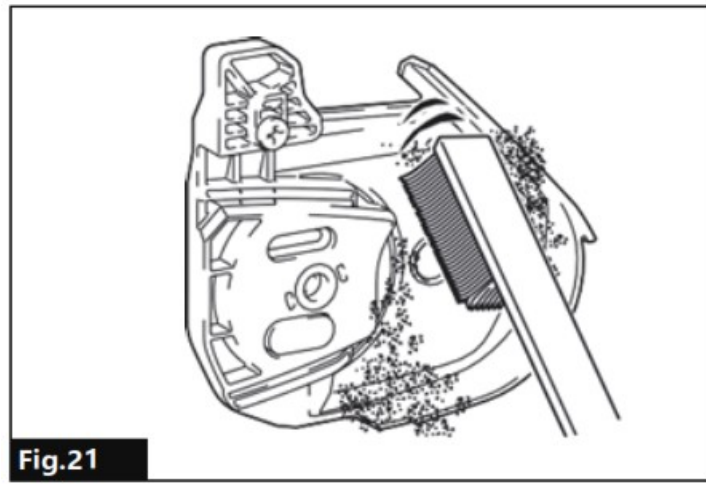

NOTICE: Make sure that the sprocket is installed as shown in the figure.

Storing the tool

1. Clean the tool before storing. Remove any chips and sawdust from the tool after removing the sprocket cover.
2. After cleaning the tool, run it under no load to lubricate the saw chain and guide bar.
3. Cover the guide bar with the guide bar cover.
4. Empty the oil tank.

Instructions for periodic maintenance

| Check item / Operating time | | Before operation | Everyday | Every week | Ever 3 month | Annually | Before storage |
|-----------------------------|-------------------------------------|------------------|----------|------------|--------------|----------|----------------|
| Whole tool | Inspection. | ✓ | – | – | – | – | – |
| | Cleaning. | – | ✓ | – | – | – | – |
| | Check at authorized service center. | – | – | – | – | ✓ | ✓ |
| Saw chain | Inspection. | ✓ | – | – | – | – | – |
| | Sharpen if necessary. | – | – | – | – | – | ✓ |
| Guide bar | Inspection. | ✓ | ✓ | – | – | – | – |
| | Remove from the tool. | – | – | – | – | – | ✓ |
| Chain lubrication | Check the oil feed rate. | ✓ | – | – | – | – | – |
| Switch trigger | Inspection. | ✓ | – | – | – | – | – |
| Lock-off lever | Inspection. | ✓ | – | – | – | – | – |
| Screws and nuts | Inspection. | – | – | ✓ | – | – | – |

TROUBLESHOOTING

Before requesting repairs, perform your own inspection. If you encounter an issue not addressed in the manual, avoid attempting to disassemble the tool. Instead, contact BTF Support and consistently utilize BTF replacement parts for any necessary repairs.

| Malfunction status | Cause | Action |
|---|--|--|
| The tool does not start. | Battery cartridge is not installed. | Install a charged battery cartridge. |
| | Battery problem (low voltage). | Recharge the battery cartridge. If recharging is not effective, replace the battery cartridge. |
| The chainsaw is unable to cut through branches. | The chain has been installed in reverse, resulting in no cutting effect. | Please refer to the instruction manual for proper installation guidance. |
| The motor stops running after a little use. | Battery's charge level is low. | Recharge the battery cartridge. If recharging is not effective, replace the battery cartridge. |
| No oil on the chain. | The chain is dry; no oil is present. | Apply lubrication to the chain. |
| | Oil guide groove is dirty. | Clean the groove. |
| Bounce or move erratically. | The chain is not sharp. | Use a small file to sharpen the chain. For the correct sharpening angle of 30°. |
| The tool does not reach maximum RPM. | Battery cartridge is installed improperly. | Follow the instructions in this manual to properly install the battery cartridge. |
| | Battery power is dropping. | Charge the battery cartridge. If recharging doesn't work, replace the battery cartridge. |
| | The drive system does not work correctly. | Contact the Support for repairs. |
| Abnormal vibration: Stop the tool immediately! | Loose guide bar or saw chain. | Make adjustments to the guide bar and saw chain tension. |
| | Tool malfunction. | Contact the Support for repairs. |
| The saw chain cannot be installed. | The pairing of the saw chain and sprocket is incorrect. | Refer to the specifications section to ensure you use the appropriate combination of saw chain and sprocket. |

OPTIONAL ACCESSORIES

⚠ CAUTION: These accessories or attachments are recommended for use with your BTF tool specified in this manual. The use of any other accessories or attachments might present a risk of injury to persons. Only use accessory or attachment for its stated purpose.

If you need any assistance for more details regarding these accessories, ask your local BTF Service Center support@btftool.com

- Saw chain
- Guide bar
- Guide bar cover
- oil bottle
- Tool box
- BTF genuine battery and charger
- Gloves
- Safety goggles

NOTICE: The level of risk associated with these exposures depends on how frequently you engage in such activities. To minimize your exposure to these substances, it is advisable to work in well-ventilated areas and employ approved safety equipment, including specialized dust masks designed to filter out minuscule particles.

BTF LIMITED WARRANTY

Please refer to the annexed warranty sheet for the most current warranty terms applicable to this product. If annexed warranty sheet is not available, refer to the warranty details set forth at below website for your respective country.

United States of America: www.btftool.com

Canada: www.btftool.ca

Other countries: www.btftool.com

WARNING

Dust generated during tasks like power sanding, sawing, grinding, drilling, and various construction activities can contain substances recognized by the State of California as having the potential to cause cancer, birth defects, or other reproductive harm. Some instances of these substances include:

- Lead from lead-based paints,
- Crystalline silica from bricks, cement, and other masonry materials,
- Arsenic and chromium from chemically-treated lumber.

The level of risk associated with these exposures depends on how frequently you engage in such activities. To minimize your exposure to these substances, it is advisable to work in well-ventilated areas and employ approved safety equipment, including specialized dust masks designed to filter out minuscule particles.

BTF Corporation

www.btftool.com

Documents / Resources

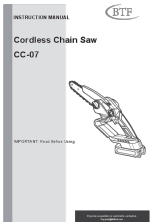
| | |
|---|--|
|  | <p>BTF CC-07 Mini Chainsaw Cordless [pdf] Instruction Manual</p> <p>CC-07 Mini Chainsaw Cordless, CC-07, Mini Chainsaw Cordless, Chainsaw Cordless, Cordless</p> |
|---|--|

References

- [Tech Tech Website in Black Bright Yellow Classy Neons Style](#)
- [User Manual](#)

[Manuals+](#), [Privacy Policy](#)

This website is an independent publication and is neither affiliated with nor endorsed by any of the trademark owners. The "Bluetooth®" word mark and logos are registered trademarks owned by Bluetooth SIG, Inc. The "Wi-Fi®" word mark and logos are registered trademarks owned by the Wi-Fi Alliance. Any use of these marks on this website does not imply any affiliation with or endorsement.