

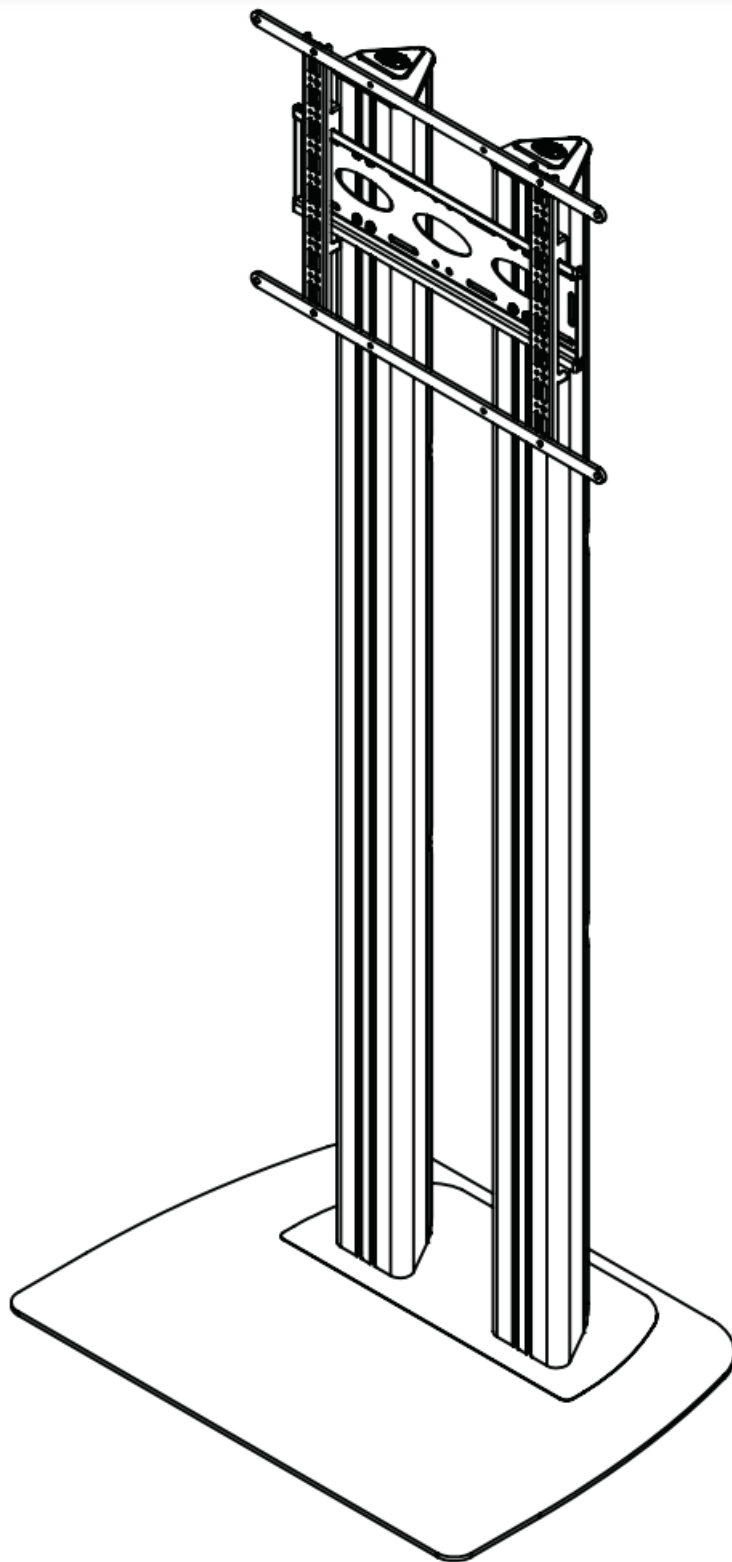

BTECH BT8583 Large Flat Screen Twin Column Floor Stand Installation Guide

[Home](#) » [BTECH](#) » BTECH BT8583 Large Flat Screen Twin Column Floor Stand Installation Guide 

BT8583 Large Flat Screen Twin Column Floor Stand



Contents

- [1 SPECIFICATIONS](#)
- [2 INSTALLATION SAFETY INSTRUCTIONS](#)
- [3 PARTS LIST](#)
- [4 INSTALLATION INSTRUCTIONS](#)
- [5 DIMENSIONS](#)
- [6 Customer Support](#)
- [7 Documents / Resources](#)
- [8 Related Posts](#)

SPECIFICATIONS

- Recommended for screens up to: 75" (190cm)
- Max load: 70kg (1541bs)
- Suitable for screens with VESA" fixings up to 600 x 400mm
- Universal design suitable to mount screens in a landscape or portrait orientation
- Integrated cable management
- Dimensions:
H.1826 x W.800 x D.600mm (H.71.90" x W.31.50" x D.23.62")
- simple 'hook on' installation with all mounting hardware included.



INSTALLATION SAFETY INSTRUCTIONS



CAUTION This stand is intended for use only with the maximum weights indicated. Use with equipment heavier than the maximum indicated may result in instability causing possible injury.

Do not attempt to install this product until all instructions and warnings have been read and properly understood. Please keep these instructions for future reference.

Please check carefully to make sure there are no missing or defective parts – defective parts must never be used. B-Tech AV Mounts, its distributors and dealers are not liable or responsible for damage or injury caused by improper installation, improper use or failure to observe these safety instructions. In such cases, all guarantees will expire.

General

B-Tech AV Mounts recommends that a professional AV installer or other suitably qualified person install this product. Great care must always be taken during installation as most AV equipment is of a fragile nature, possibly heavy and easily damaged if dropped.

If you do not fully understand the instructions or are not sure how to install this product safely, then please consult a professional for advice and/or to install this product for you. Failure to mount this product correctly may cause serious injury or death, both during installation and at anytime thereafter.

Do not mount any AV equipment that exceeds the specific weight limit of the product you are installing.

This weight limit will be clearly stated on each product and its packaging and will vary from product to product.

Product location

Please pay careful attention to where this product is located. Designed for indoor use, this mount is suitable for public or home installation. Check load capacity of the floor prior to installation as some surfaces are not suitable for installation. When verifying the stability of the structure, consider the following external factors: The strength of the floor, exposure to sudden and severe wind and danger arising from contact with people and/ or objects (eg installations in passageways, emergency exits), if located in a public or frequently populated area ensure that the product is out of the immediate reach of people. When drilling holes it is essential to avoid contact with electrical cables and water or gas pipes contained within.

Fixing hardware

It is highly recommended that all fixing screws be used where supplied and that the purpose of all other fixing hardware is fully understood. In some cases more AV equipment fixing hardware will be supplied to accommodate different models of equipment and set up configurations. The installer must be satisfied that any supplied fixing hardware is suitable for each specific installation.

If any fixing screws or included hardware are deemed not sufficient for a safe installation then please consult a professional or your local hardware store.

Hazard limitation

When routing cables take advantage of any built in cable management features that the product might provide and ensure that all cables are tidy and secure. Check to see that any moving aspect of the product can do so unhindered by any cabling. Some products have moving parts and the potential to cause injury through the crushing or trapping of fingers or other body parts. Particular attention to the nature of moving parts is required especially when assembling installing and adjusting during set up. Immediately after installation double-check that the work done is safe and secure. Double-check all necessary fixings are present and are of ample tightness.

It is recommended that periodic inspections of the product and its fixing points are made as frequently as possible (no more than 6 months apart) to ensure that safety is maintained.

If in doubt consult a professional AV installer or other suitably qualified person.

PARTS LIST

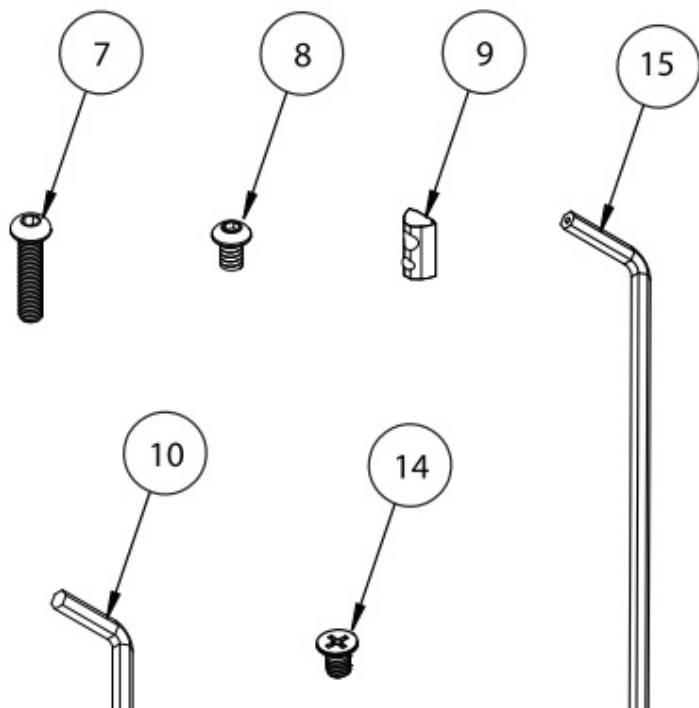
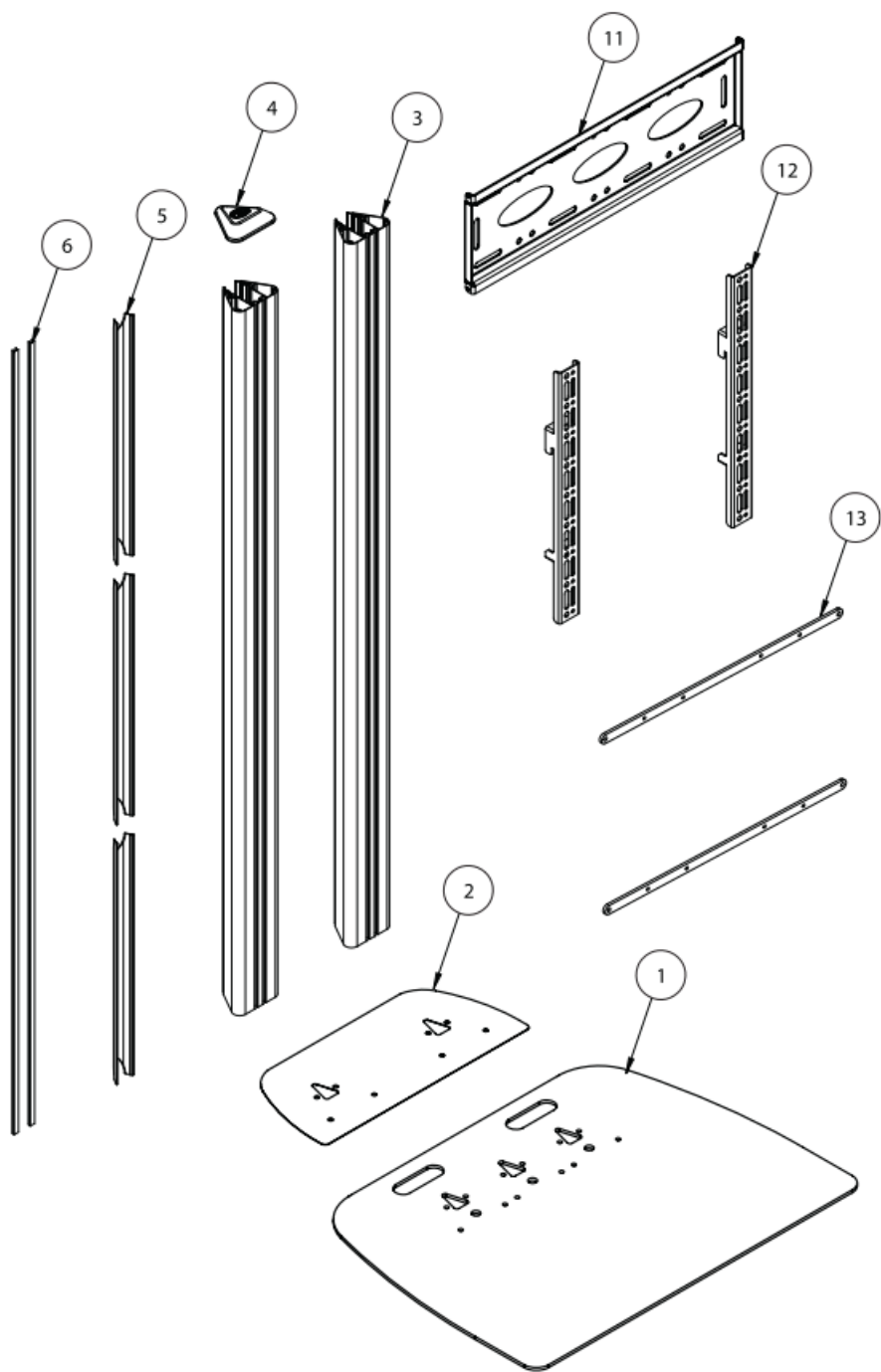

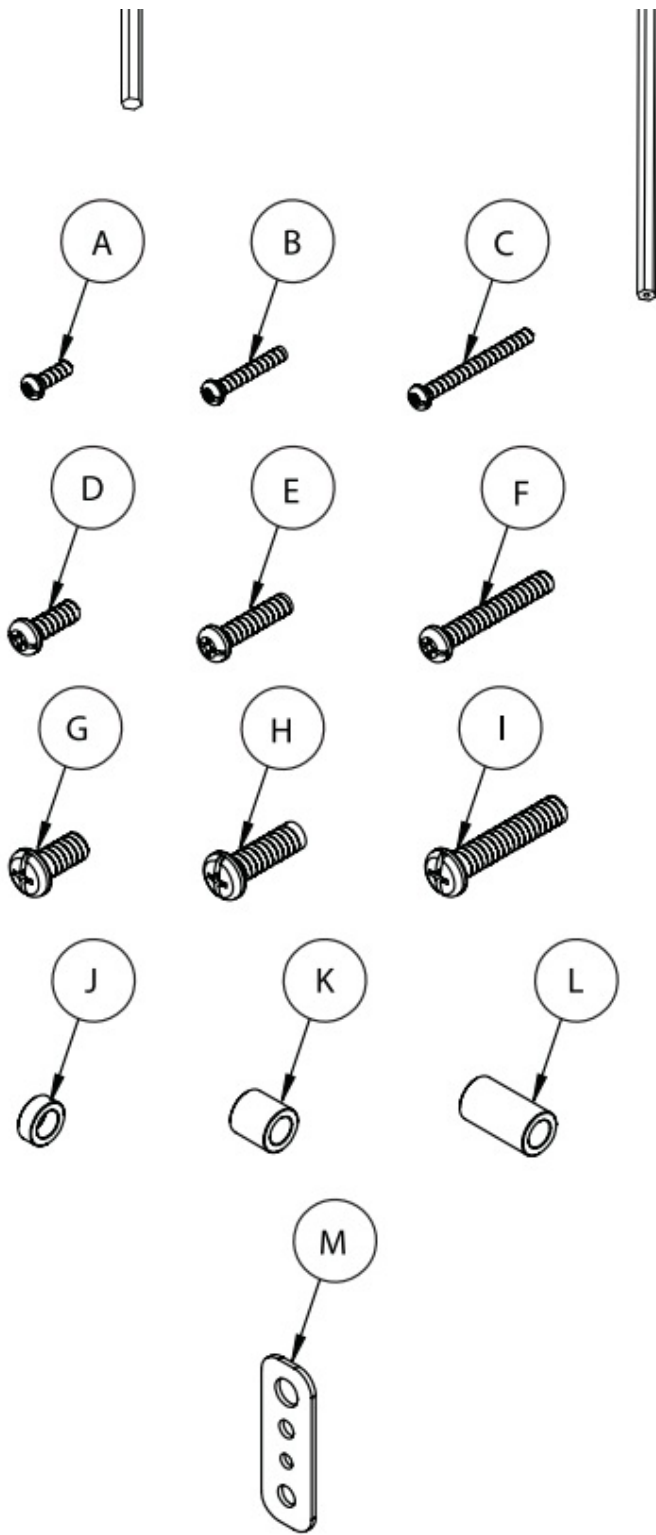

ITEM	PART NAME	QTY
1	FLOOR BASE	1
2	COVER PLATE	1
3	VERTICAL COLUMN 1 .BM	2

4	COLUMN CAP	2
5	REAR COVER	6
6	PLASTIC SLOT INSERT	4
7	MB x 35mm HEX SCREW	8
8	MBx 12mm HEX SCREW	10
9	MB SLIDING INSERT	10
10	SAF HEX KEY	2
11	MOUNTING PLATE	1
12	INTERFACE ARMS	2
13	600mm ADAPTOR ARM	2
14	MB x 12mm CSK SCREW	4
15	4AF LONG HEX KEY	1
INTERFACE KIT		
A	M4 x 12mm SCREW	4
B	M4 x 25mm SCREW	4
C	M4 x 40mm SCREW	4
D	M6 x 16mm SCREW	4

E	M6 x 25mm SCREW	4
F	M6 x 40mm SCREW	4
G	MB x 16mm SCREW	4
H	MB x 25mm SCREW	4
I	MB x 40mm SCREW	4
J	MB 5mm SPACER	4
K	MB 13mm SPACER	4
L	MB 24mm SPACER	4
M	MULTIWASHER	4

Suitable for loads up to 70kg (154lbs)

INSTALLATION TOOLS REQUIRED

Crosshead screwdriver



Level (Optional)



INSTALLATION INSTRUCTIONS

ATTACH COLUMNS TO BASE

Fix item 3 to items 1 & 2 using item 7.

Note: Use the double sided tape on the bottom of the *item 2* to fix the cover in place on *item 1*.

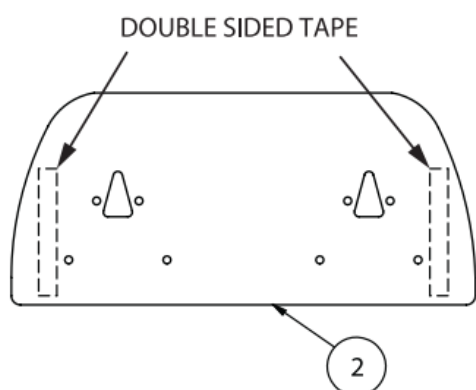

M8 x 35mm
HEX SCREW

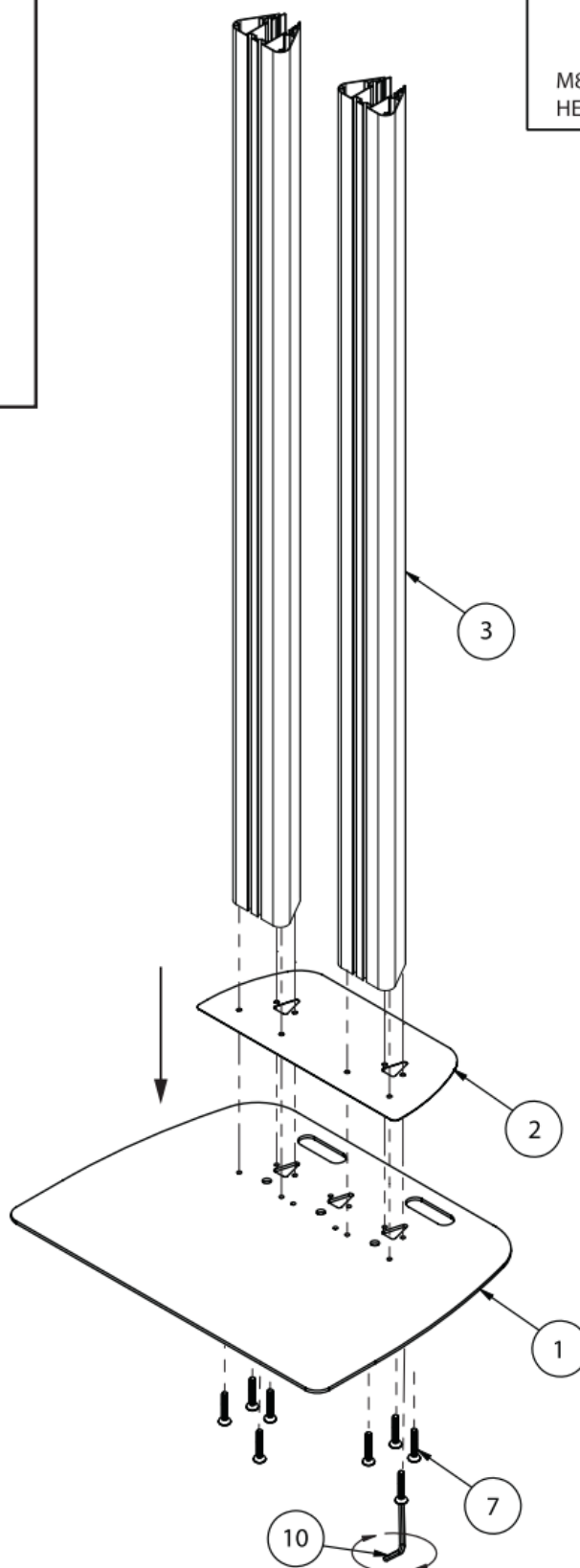

ATTACH MOUNTING PLATE TO COLUMNS

i. Insert 4x item 9 into item 3 (2 in each channel).

Note: Position item 9 in the columns at the preferred height for the screen mount.

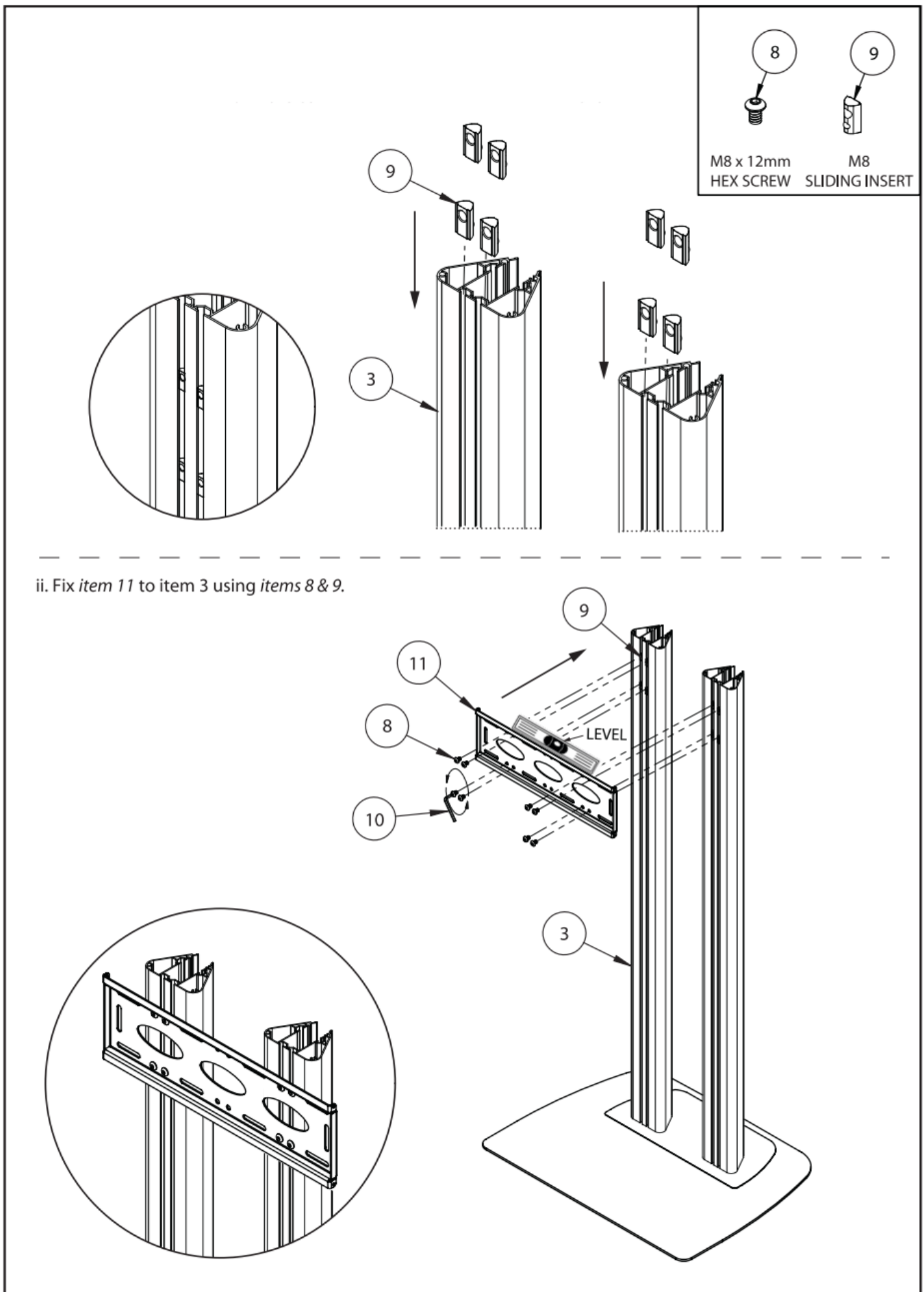

FIX INTERFACE ARMS TO SCREEN

Fix items 12 to the back of the screen using the interface kit (items A-M).

Note: Ensure the arms are facing the correct way round and the same holes are used on both arms.

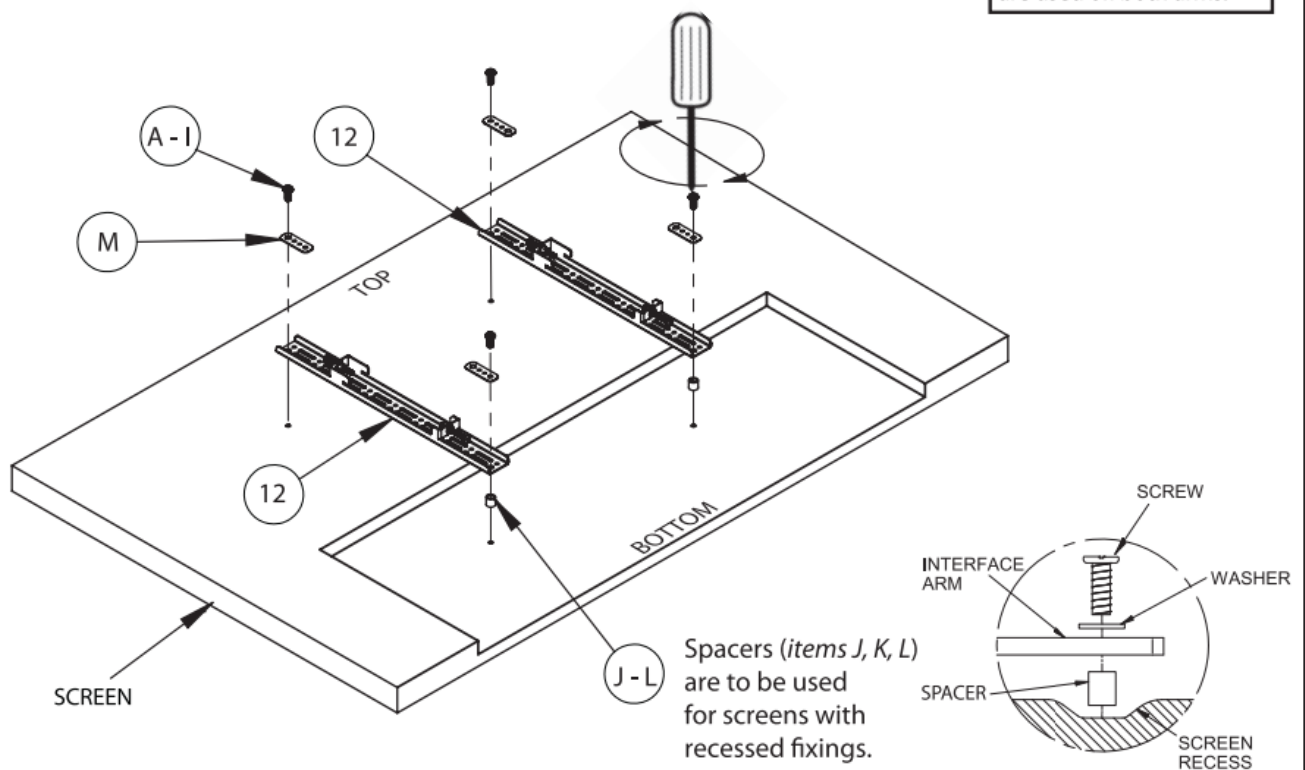

OPTIONAL ADAPTOR ARMS

FOR SCREENS WITH VESA 600 x 400 FIXINGS

- Attach item 13 to item 12 using item 14.
- Fix item 13 to the back of the screen using the screen interface kit (items A - I).

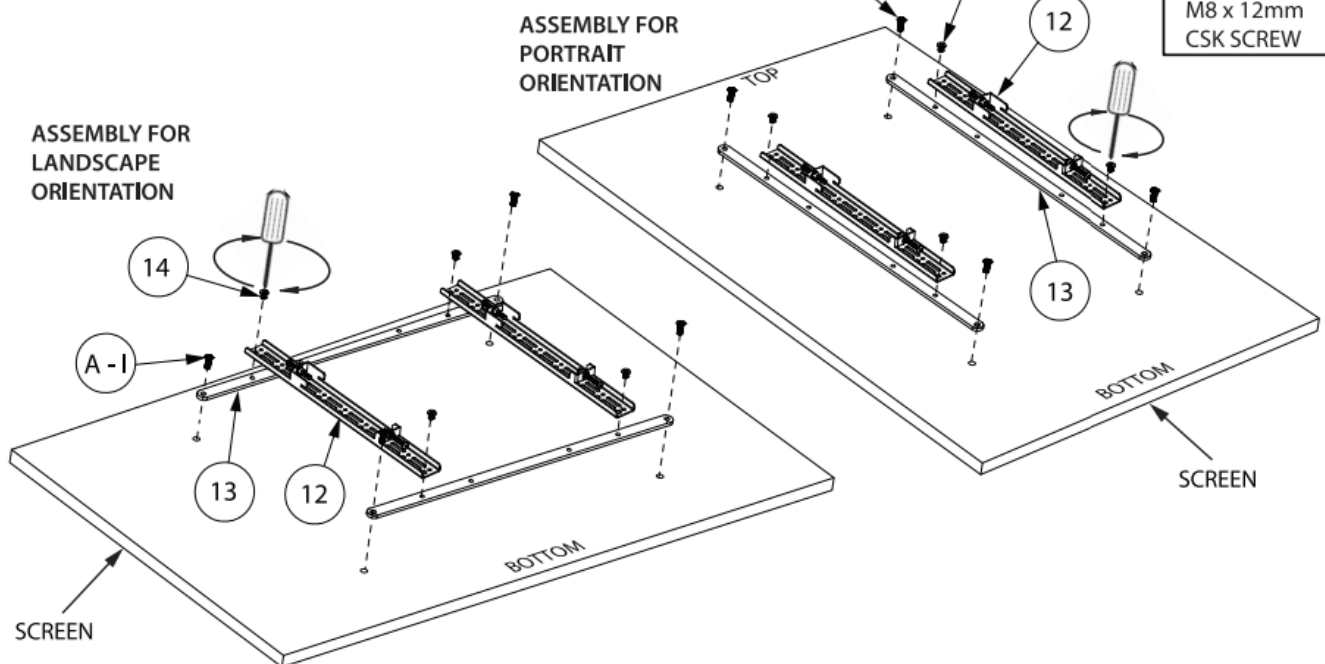

MOUNT SCREEN ONTO STAND

Hook screen onto item 11.

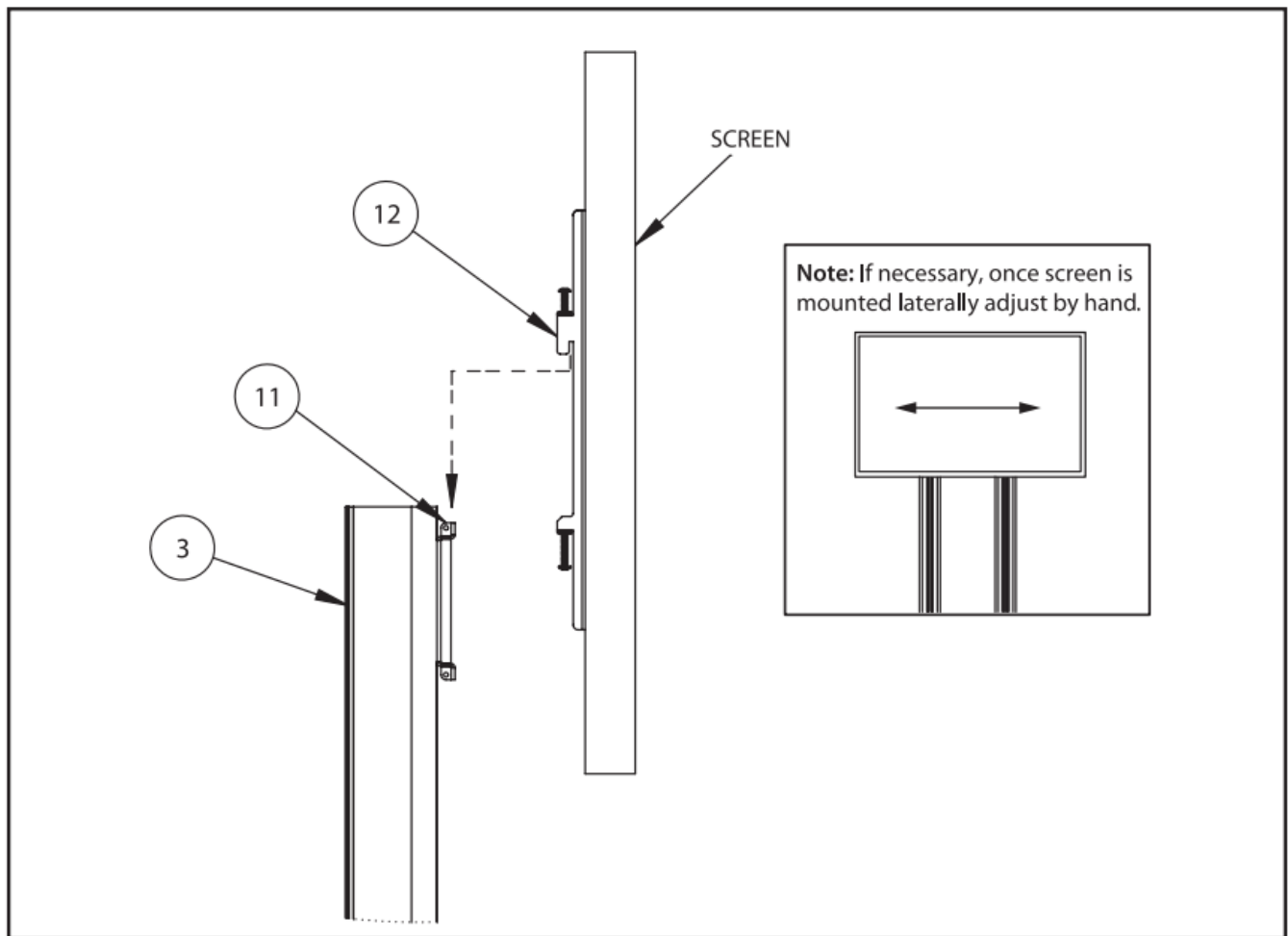

SECURE SCREEN TO MOUNTING PLATE

Lock screen onto item 11 using the safety screws at the bottom of item 12.

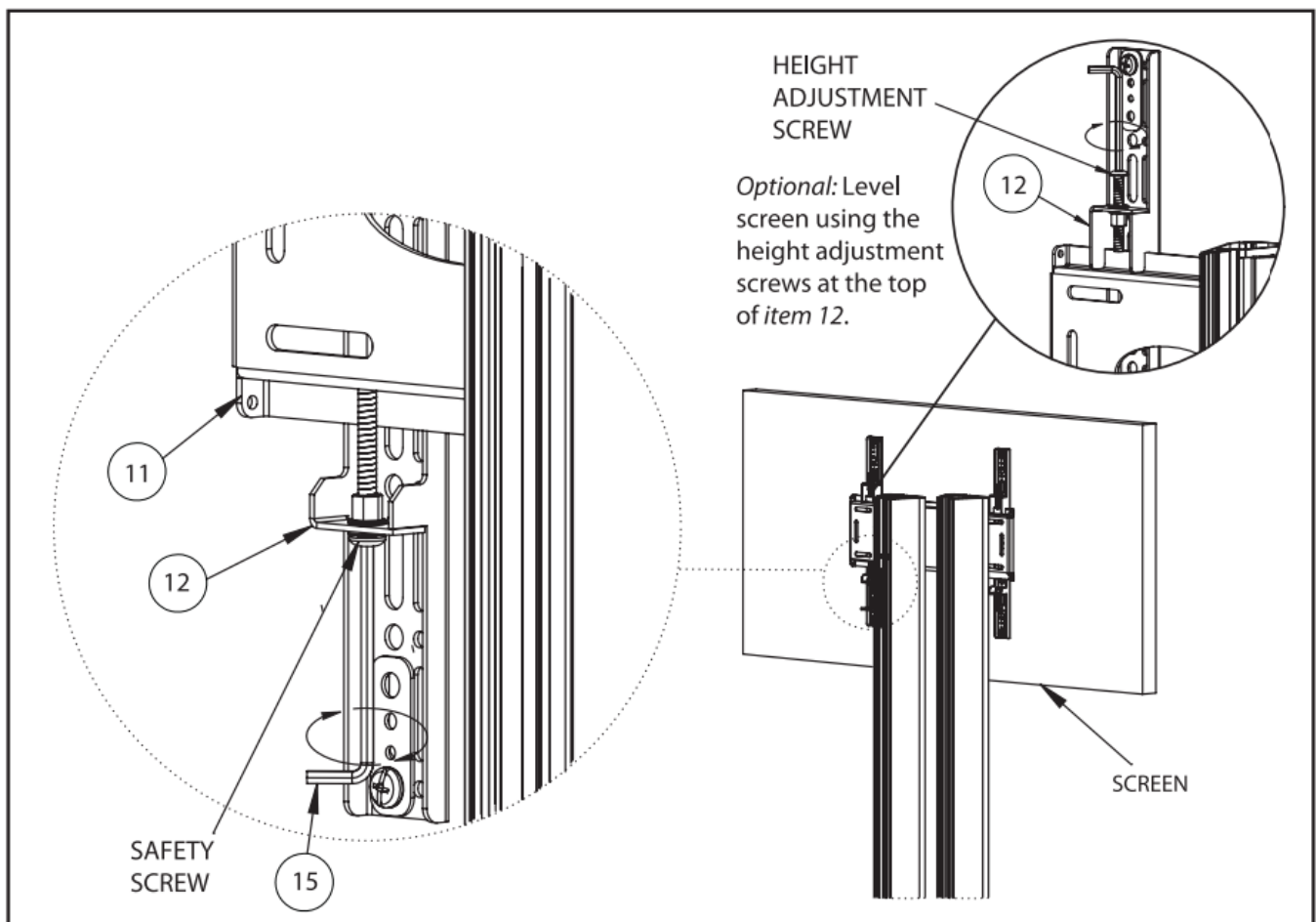

ATTACH COVERS

- i. Route screen cables through the back of of item 3 and attach item 5.
- ii. Fit item 4 to the top of item 3.

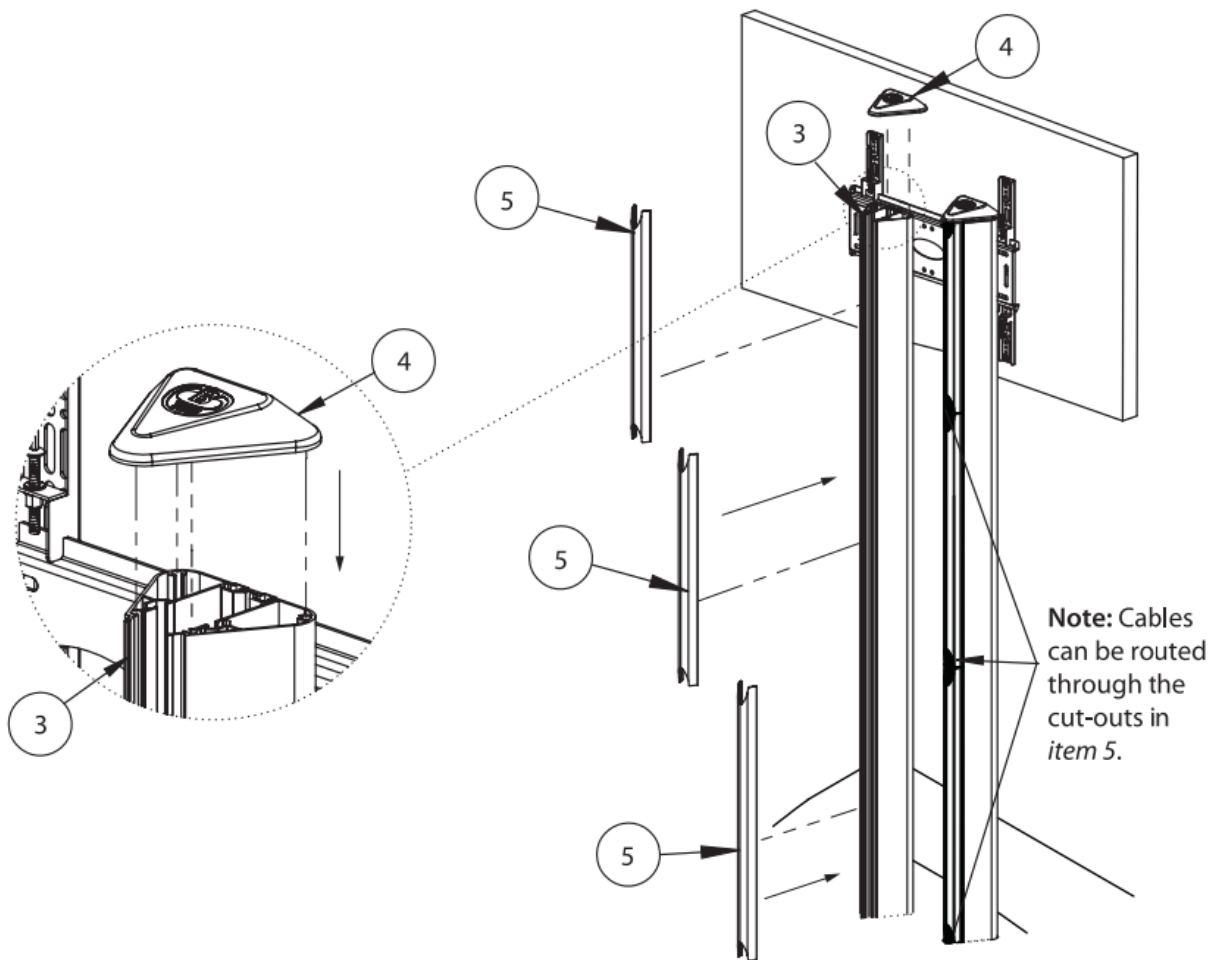

- iii. Insert *item 6* into the front slots on *item 3*.

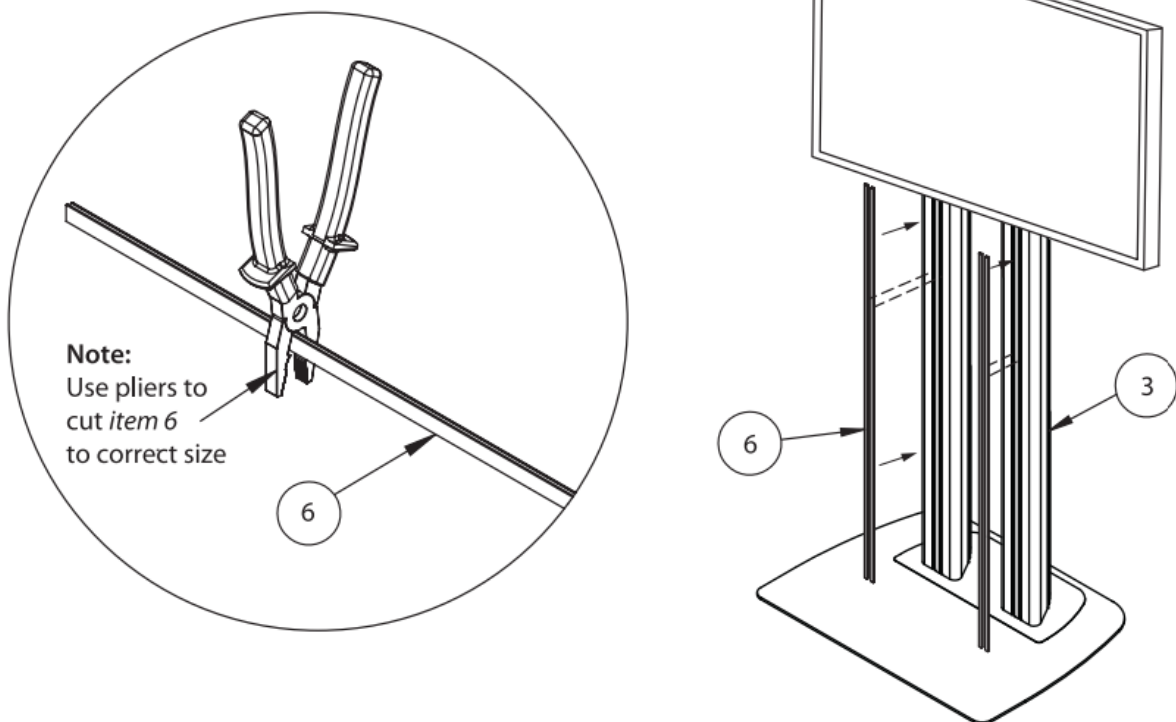

DIMENSIONS

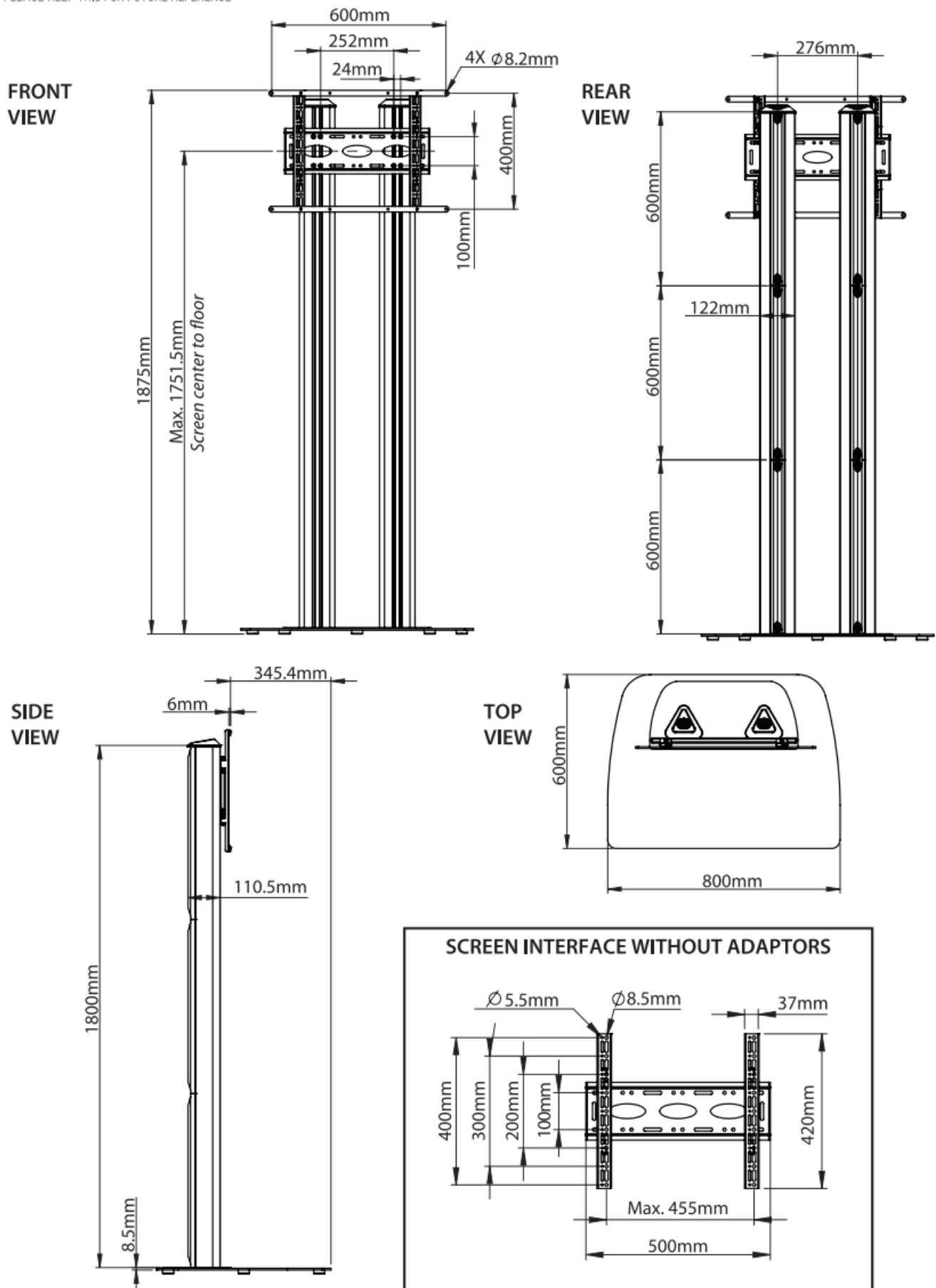

THESE INSTRUCTIONS ARE INTENDED AS A GUIDE ONLY AND B-TECH ACCEPTS NO LIABILITY FOR THE ACCURACY OF THE INFORMATION CONTAINED IN THIS DOCUMENT.

2021 B-Tech International Design and Manufacturing Ltd. All rights reserved.
B-Tech AV Mounts is a division of B-Tech International Design and Manufacturing Ltd.
B-Tech AV Mounts and the B-Tech logo are registered trade marks.
All other brands and product names are trademarks of their respective owners.
Photographs are for illustrative purposes only. E&OE.
AMA-BT8583-V1 .1-0822-BTECH MADE IN VIETNAM



CONTACT:

info@btechavmounts.com



@ For More Information Visit

www.btechavmounts.com



Documents / Resources

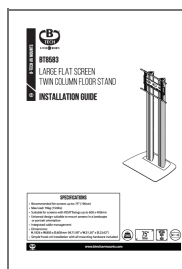

[BTECH BT8583 Large Flat Screen Twin Column Floor Stand](#) [pdf] Installation Guide
BT8583, BT8583 Large Flat Screen Twin Column Floor Stand, Large Flat Screen Twin Column
Floor Stand, Flat Screen Twin Column Floor Stand, Twin Column Floor Stand, Floor Stand