



# BSR idware GmbH RK25 Series Rugged Mobile Computer User Guide

[Home](#) » [BSR idware GmbH](#) » BSR idware GmbH RK25 Series Rugged Mobile Computer User Guide 



## RK25 Mobile Computer Quick Start Guide

### Contents

- [1 Open Your Box](#)
- [2 Overview](#)
- [3 Install & Remove Battery](#)
- [4 Install SIM, SAM, SD card](#)
- [5 Charging & Communication](#)
- [6 Documents / Resources](#)

## Open Your Box

- ☒ RK25 Mobile Computer (28-Key Model or 25-Key Model)
- ☒ AC Adapter (Optional)
- ☒ Micro USB Cable (Optional)
- ☒ Snap-on Charging & Communication Cable (Optional)
- ☒ Hand Strap (Optional)
- ☒ Quick Start Guide

**BSR idware GmbH**  
JakobeHaringer-Str.3  
A-5020 Salzburg  
<https://www.bsr.at>  
[sales@bsr.at](mailto:sales@bsr.at)

## Overview

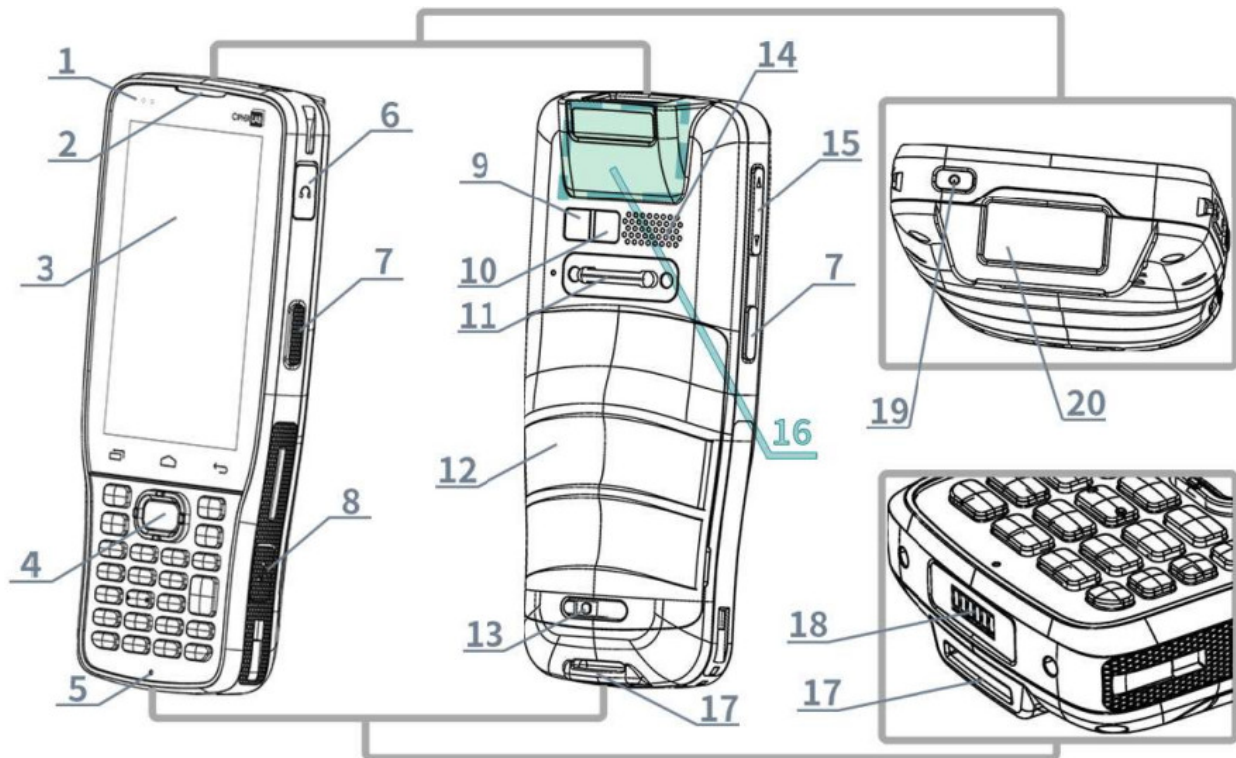

- |                   |                                   |
|-------------------|-----------------------------------|
| 1. Status LED     | 11. Wrist Band Hole               |
| 2. Receiver       | 12. Battery (with battery cover)  |
| 3. Touchscreen    | 13. Battery Cover Latch           |
| 4. Scan Key       | 14. Speaker                       |
| 5. Microphone     | 15. Volume Buttons                |
| 6. Headset Jack   | 16. NFC Detection Area            |
| 7. Side-Trigger   | 17. Wrist Band Hole               |
| 8. Micro USB Port | 18. Charging & Communication Pins |
| 9. Camera         | 19. Power Button                  |
| 10. Camera Flash  | 20. Scan Window                   |

### Communication with NFC

**Step 1:** On the mobile computer, launch an NFC enabled application.

**Step 2:** Hold the mobile computer without covering NFC detection area.

**Step 3:** Simply move the mobile computer in proximity with the NFC tag or device until the application indicates data transfer is complete.

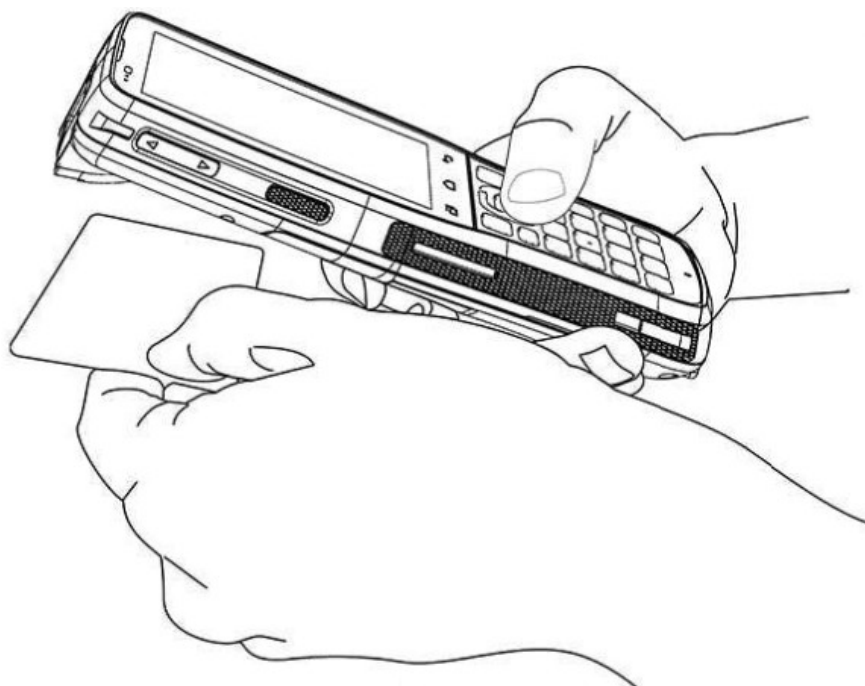

## Install & Remove Battery

Please follow the steps to remove and install the main battery.

**Step 1:** Keep pressing down the lock button on battery latch.

**Step 2:** Slide the battery latch rightward to the “Unlock” position.

The battery cover slightly tilt up and is ready to be removed.

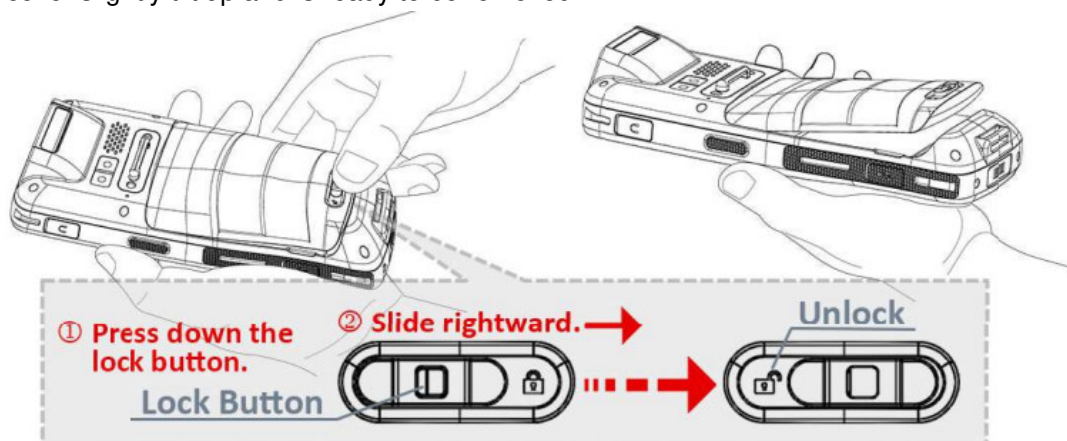

### Step 3:

By holding the two sides of the battery cover, lift up the main battery (which is with the battery cover) from its lower end to remove it.

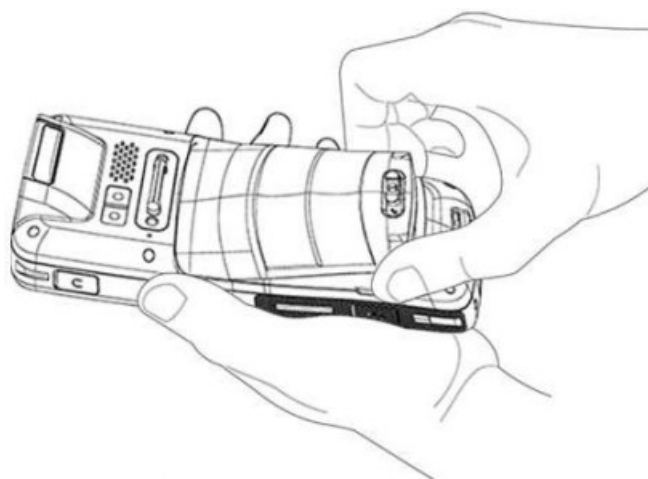

### Step 4:

Insert a fully-charged main battery from its upper end, and then press down the lower edge of the battery.

① Insert it from the upper end.

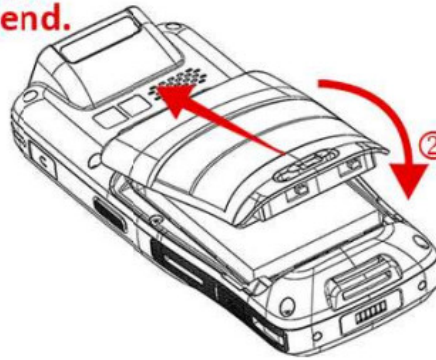

② Press down the lower end.

**Step 5:** Slide the battery latch leftward to “Lock” position.

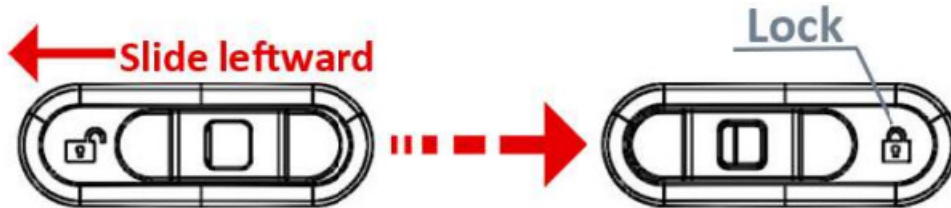

**Note:** Please insert a charged battery, and make sure the battery latch is at the “Lock” position before powering on the device.

## Install SIM, SAM, SD card

**Step 1:** Remove the battery which is with the battery cover.

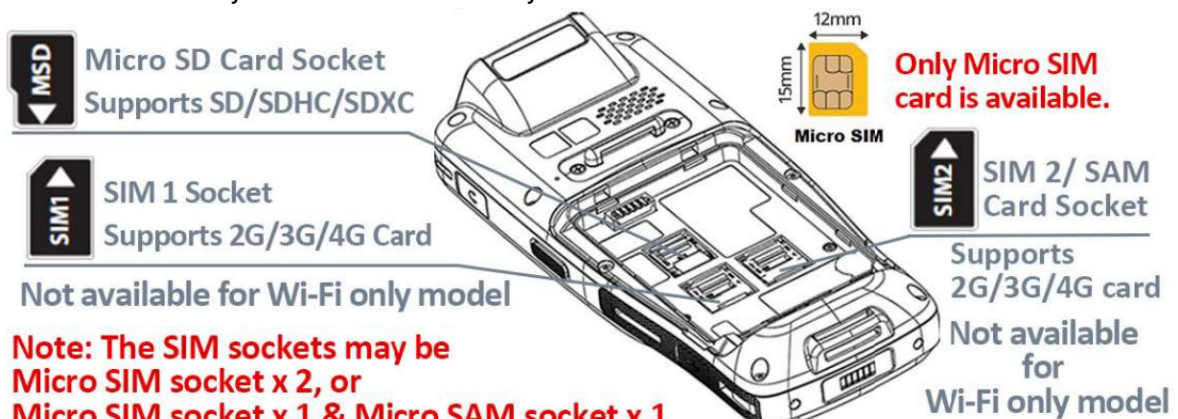

**Step 2:** Slide the hinged cover backward, and swing the top to open the socket.

**Step 3:** Place the card into the socket with its metal contacts downward.

**Step 4:** Close the hinged cover, and then push it toward to lock.



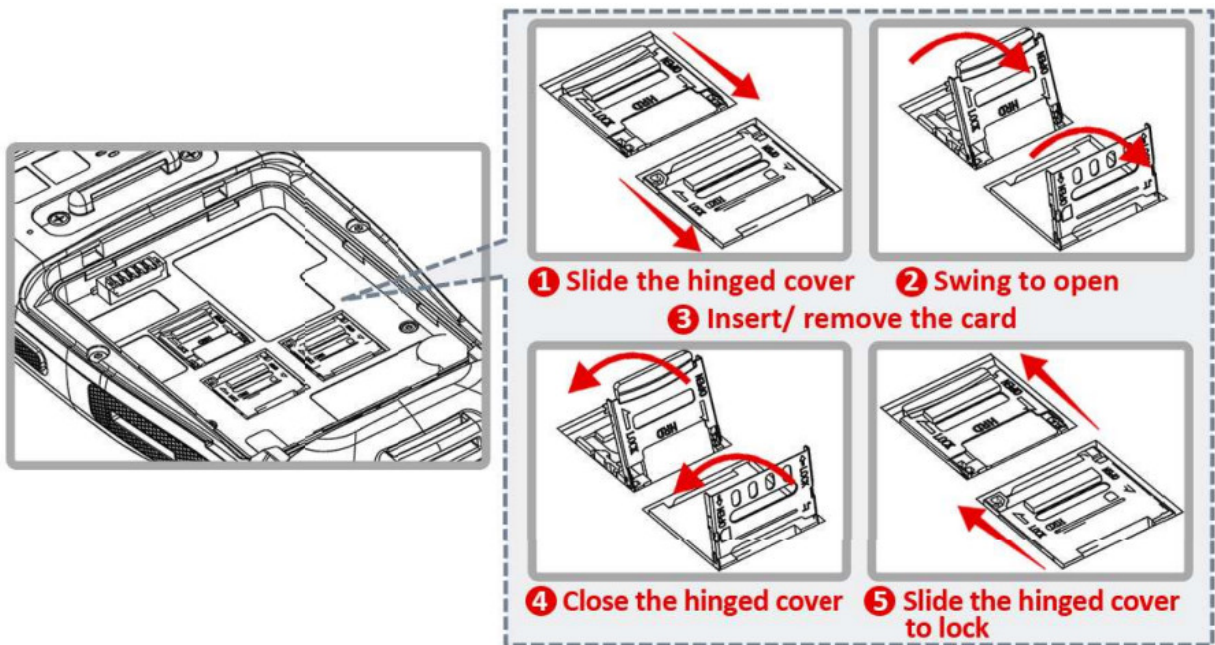

**Step 5:** Place the battery cover back and push the battery latch to the “Lock” position.

## Charging & Communication

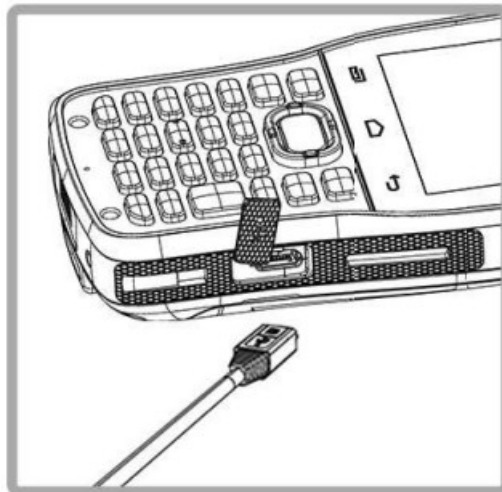

### By USB cable:

Insert a micro USB cable into its port on the right side of the RK25 mobile computer. Connect another end to PC/ Laptop for charging/ data transmission.

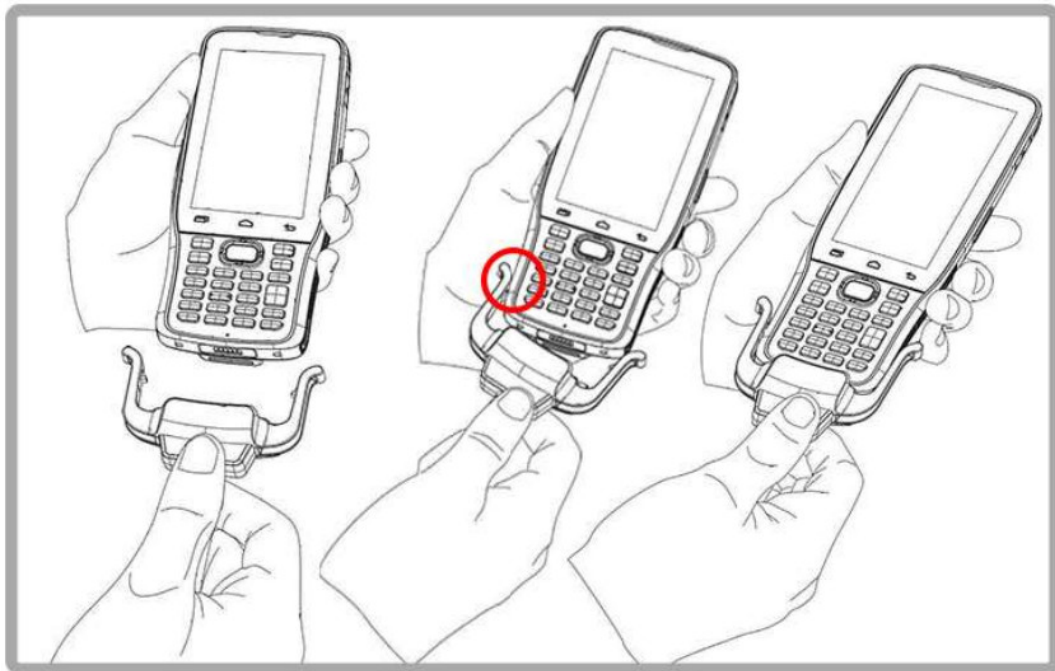

#### By Snap-on Charging & Communication cable:

Hold the snap-on cup toward the bottom of the RK25 mobile computer, and push the snap-on cup upwards to make it attach to the RK25 mobile computer.

Connect the USB plug to the approved adapter for external power connection, or plug it to the USB port of PC/laptop for charging/data transmission.

Important Charging Information	
<b>Power Supply</b>	Input: AC 100-240 V, 50/60 Hz Output: DC 5V, 2A, CipherLab approved BSMI, CCC, FCC, CE, RCM, PSE, PSB, BIS, KC
<b>Battery Pack</b>	3.8V, 4000mAh rechargeable Li-polymer battery CipherLab proprietary
<b>Charging Time</b>	Approx. 4 hours via adapter

[www.cipherlab.com](http://www.cipherlab.com)



P/N: SRK25AQQ01011

Copyright© 2018 CipherLab Co., Ltd.

#### Documents / Resources

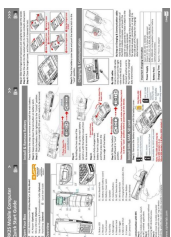

[BSR idware GmbH RK25 Series Rugged Mobile Computer](#) [pdf] User Guide

RK25 Series Rugged Mobile Computer, RK25 Series, Rugged Mobile Computer, Mobile Computer, Computer