



BRYDGE 10.2 Max Plus Wireless Keyboard Case for iPad User Manual

[Home](#) » [Brydge](#) » BRYDGE 10.2 Max Plus Wireless Keyboard Case for iPad User Manual 

Contents

- 1 BRYDGE 10.2 Max Plus Wireless Keyboard Case for iPad
- 2 POWER
- 3 PAIR
- 4 TRACKPAD GESTURES
- 5 ATTACH PROTECTIVE CASE
- 6 INSERT/REMOVE KEYBOARD
- 7 CHARGE
 - 7.1 KEYBOARD SHORTCUTS
- 8 WARRANTY
- 9 Documents / Resources
- 10 Related Posts

B R Y D G E

BRYDGE 10.2 Max Plus Wireless Keyboard Case for iPad



POWER

TO TURN ON: Press the power key for one second until the LED flashes green.

TO TURN OFF: Press and hold the power key for three seconds until the LED flashes red.

NOTE: The Brydge 10.2 MAX+ includes Instant-On™, which means that reconnecting no longer takes seconds. Once paired, your keyboard will instantly connect to your iPad for up to 4 hours before entering sleep mode without impacting power consumption.

PAIR

TO PAIR: Press and hold the Bluetooth™ key for three seconds until the LED flashes blue.

On your iPad, under Settings > Bluetooth™ select Brydge 10.2 MAX+.

When successfully paired, the blue LED will turn off and your keyboard and trackpad will be active.

UPDATE FIRMWARE

Download Brydge Connect from the App Store for the latest firmware updates.

SETTINGS

AssistiveTouch settings must be off for gestures to work properly.

To do this, go to iPad Settings > Accessibility > Touch > AssistiveTouch > OFF

TRACKPAD GESTURES

Open Today View

Use two fingers to swipe right.



Zoom in and out

Pinch open to zoom in. or pinch closed to zoom out



Scroll Up or Down

Swipe two fingers up or down.



Go Home

Use one finger to swipe the pointer past the bottom of the screen.



Open Search

Swipe down with two fingers.



Switch between open apps

Swipe left or right with three fingers.



Open the App Switcher

Swipe up with three fingers. pausing before you rn your fingers.



Scroll Left or Right

Swipe two fingers left or right.



Open Control Center

Use one finger to swipe to the top right corner.

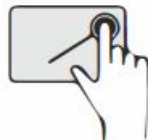

ATTACH PROTECTIVE CASE

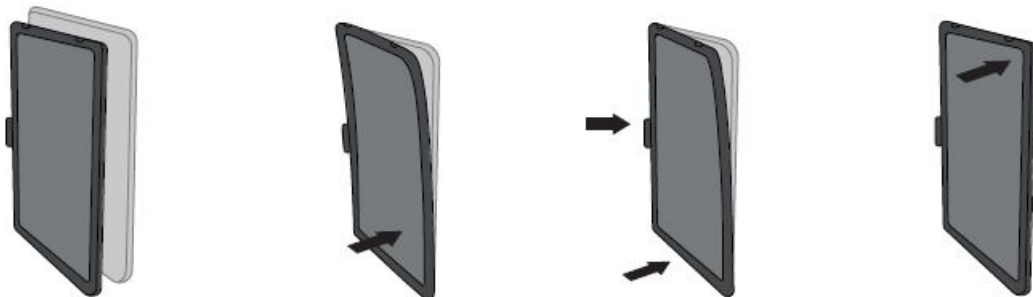

REMOVE PROTECTIVE CASE

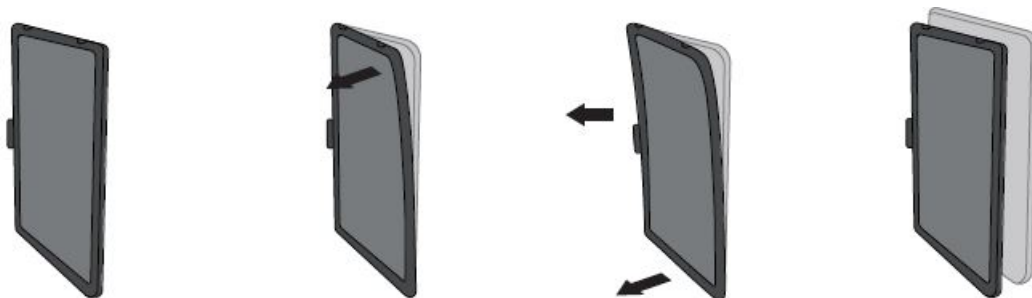

INSERT/REMOVE KEYBOARD

IMPORTANT

Before attaching your keyboard, ensure your iPad is inserted into the supplied protective case.

- **BEFORE INSERTING:** Place your Brydge on a flat surface and set the hinges upright to 90 degrees.

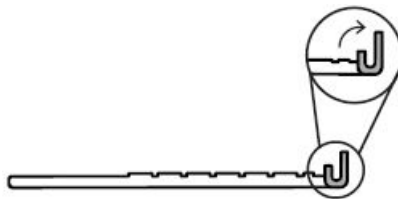

- **TO INSERT:** Insert your iPad (in protective case) into the hinges with the home button on the left.

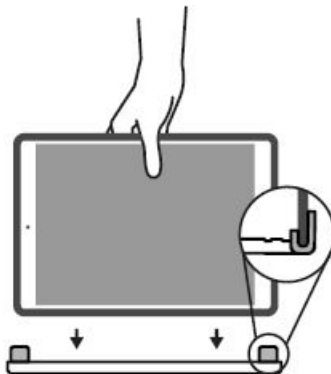

- **TO REMOVE:** Place your Brydge on a flat surface. Place your hand towards the back of the keyboard and pull up.



CHARGE

TO CHECK BATTERY LIFE: In Today View, go to the BATTERIES section to check battery life. If not available, swipe left on your Home Screen to show Today View. scroll to the bottom and click edit. Scroll down to Batteries. and click the green+· icon to add.

NOTE: If battery life is below 15%, backlit key functionality will be disabled to conserve battery.

TO CHARGE: Insert the charging cable into the keyboard and plug the other end into a power source. A solid red LED indicates the Brydge is charging.

When the keyboard is fully charged. the red LED will turn off. A full charge can take up to three hours.

KEYBOARD SHORTCUTS

- Copy
Command+ C
- Paste
Command+ V
- Cut

- Command+ X
- Underline
Command+ U
- Italic
Command+ I
- Home Screen
Command+ H
- Switch App
Command + Tab
- Show Dock
Command + Option + D
- Search
Command + Space
- Undo
Command+ Z

Switch Language

Ctrl +Shift+ Spacebar (Spacebar allows you to toggle through available languages)

WARRANTY

Thank you for purchasing a Brydge product. This product comes with a 1-year limited hardware warranty on the terms and conditions set out in this document and at www.brydge.com/warranty. All Brydge warranties are non-transferrable and are only available to the original end-user of the product. Warranties do not apply to products purchased from online vendors unauthorized to sell Brydge-branded product. If a defect arises during the warranty period, cease using the product and contact Brydge. To obtain warranty service, visit www.brydge.com/support or call +1 (435) 604-0481. Brydge, at its sole discretion and option, will

1. repair the product at no charge using new parts or parts that are equivalent to new in performance and reliability or
2. replace or exchange the product with a product of equivalent functionality and value. Brydge offers free return shipping on any approved warranty claims. A shipping label will be provided to you if you are within the United States. If you are outside the United States. Brydge will reimburse your return shipping to a maximum of US\$15.00 after providing a copy of the shipping receipt.

Australia Only: Our goods come with guarantees that cannot be excluded under the Australian Consumer Law. You are entitled to a replacement or refund for a major failure and compensation for any other reasonably foreseeable loss or damage. You are also entitled to have the goods repaired or replaced if the goods fail to be of acceptable quality and the failure does not amount to a major failure.

Brydge Technologies LLC | 1912 Sidewinder Dr .. Suite 104, Park City, UT 84060 USA

HAVE A QUESTION? Visit www.brydge.com/support

MODEL: BRY801

SKU: BRY8012

Documents / Resources



[BRYDGE 10.2 Max Plus Wireless Keyboard Case for iPad](#) [pdf] User Manual
10.2 Max Plus Wireless Keyboard Case for iPad