



brother QL-810Wc Series Label Printer with Wireless Networking Instruction Manual

[Home](#) » [Brother](#) » brother QL-810Wc Series Label Printer with Wireless Networking Instruction Manual 



D02JDX001A
QL-810Wc / QL-820NWBc / QL-1110NWBc

Contents

- [1 QL-810Wc Series Label Printer with Wireless Networking](#)
- [2 Coin Cell Battery replacement instructions \(QL-820NWBc\)](#)
- [3 Documents / Resources](#)
 - [3.1 References](#)
- [4 Related Posts](#)

QL-810Wc Series Label Printer with Wireless Networking

These derivative models are similar to the original models as listed in the table. For operating instructions and troubleshooting, see the original models' documentation at support.brother.com.

Your model	Original model
QL-810Wc	QL-810W
QL-820NWBc	QL-820NWB
QL-1110NWBc	QL-1110NWB

The following specifications are different from the original models' specifications:

Description	QL-810Wc	QL-820NWBc	QL-1110NWBc
USB port for USB flash drives	N/A	Not Supported	Not Supported
Wireless connection with Ad-hoc mode	Not Supported	Not Supported	Not Supported
Security protocol WPA3TM – WPA3-SAE (TKIP+AES), WPA3-SAE (AES)	Supported	Supported	Supported
Security protocol LEAP	Not Supported	Not Supported	Not Supported
Bluetooth [®] version	N/A	5.	5.
Bluetooth profile – BIP	N/A	Not Supported	Not Supported

Coin Cell Battery replacement instructions (QL-820NWBc)

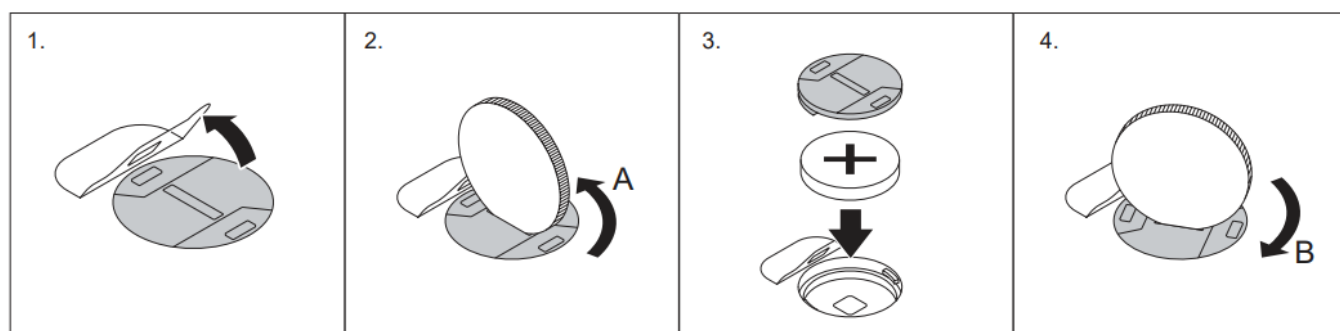

1. Gently lift the safety cover away from the battery cover and keep it in the raised position, as shown.
DO NOT remove the safety cover.
2. Use a coin or similar object to turn the battery cover in the direction shown in illustration A, and then remove the battery cover.
3. Insert the new battery, making sure the + and – symbols facing the correct direction.
4. Replace the battery cover and, using a coin or similar object, slowly turn the battery cover in the direction shown in illustration B until it locks into place.

Information for compliance with Commission Regulation 801/2013

	QL-810Wc	QL-820NWBc	QL-1110NWBc
Power consumption*	1.3 W	1.6 W	1.8 W

* All network ports activated and connected.

brother

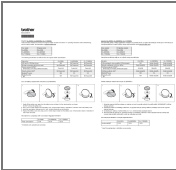

Documents / Resources

	brother QL-810Wc Series Label Printer with Wireless Networking [pdf] Instruction Manual QL-810Wc, QL-820NWb, QL-1110NWb, D02JDX001A Label Printer, QL-810Wc Series Label Printer with Wireless Networking, QL-810Wc Series Label Printer, Label Printer, Label Printer with Wireless Networking, Wireless Networking
---	--

References

-  [United States | Brother support website](#)