



Brookstone P101201 15A Power Rating WiFi Smart Plug User Guide

[Home](#) » [Brookstone](#) » Brookstone P101201 15A Power Rating WiFi Smart Plug User Guide 

Brookstone®

P101201 15A Power Rating WiFi Smart Plug
User Guide



SCORE AND FOLD AS SHOWN ON THIS PICTURE



Contents

1 INSTRUCTION MANUAL GUIDE INSIDE PAGES

2 Troubleshooting Smart Plug connection

3 Documents / Resources

3.1 References

INSTRUCTION MANUAL GUIDE INSIDE PAGES

PLEASE READ ALL INSTRUCTIONS CAREFULLY AND RETAIN FOR FUTURE USE

Important Notes

- Supports only 2.4 GHz Wi-Fi network
- It is recommended to use indoor only

Getting Started

- Remove the Wi-Fi Smart Plug from the box
- Remove any packaging from the product
- Please retain all packaging until you have checked and counted all the parts and the contents against the parts list

Key Features

- The Wi-Fi Smart Plug makes it easy to control “non-smart” devices in your home
- Allows you to turn numerous wired appliances in your home into an automated one that can be controlled by a simple tap on your phone, or voice commands via
- Google and Amazon, Easy to install and set-up
- Schedule on/off time for home automation
- Output Voltage: 15A Max, 1875W Resistive, 10A Max,
- 1250W Tungsten, 16 HP
- Wi-Fi Standard 802.11 b/g/n

- Wi-Fi Channel 1-14 2.4GHz
- Works with the Brookstone App
- Works with your Apple, Google, and Amazon devices App available on IOS and Android

Package Contents

- Wi-Fi Smart Plug
- Instruction Manual
- Quick Start Guide

Safety Instructions

- Keep the Smart Plug away from extreme heat sources or fire,
- Do not use the Smart Plug if it has been dropped or damaged in any way.
- Repairs to electrical equipment should only be performed by a qualified electrician. Improper repairs may place the user at serious risk,
- Keep the Smart Plug free from dust, lint, etc.
- Do not use this Smart Plug for anything other than its intended use,
- Keep the unit out of reach of children.
- This product is not a toy

Compatibility.

This Wi-Fi Smart Plug is compatible with the Brookstone App, and with the devices using iOS 8.0 and above with Wi-Fi option, or Android 5.0 and above with Wi-Fi option.

This device does not currently support 5GHz Wi-Fi bands. Please see that your phone is connected to 2.4GHz Wi-Fi band of your router.

Operating Instructions

Search and download Brookstone App from Apple App Store or Google Play, or SCAN QR CODE, or VISIT: <https://brookstonesmarthome.com/brookstone-indoor-15a-smart-plug> Open the App, and it will ask you to register your device. Select your country, enter your email, get Verification Code and input your password to confirm. Insert the Smart Plug into the power outlet. Wait for 10-30 seconds until the Blue LED light on the ON/OFF button blinks continuously.



Wi-Fi Smart Plug parts and description

1. Smart Plug grounded receptacle
2. ON/OFF LED Illuminated Switch

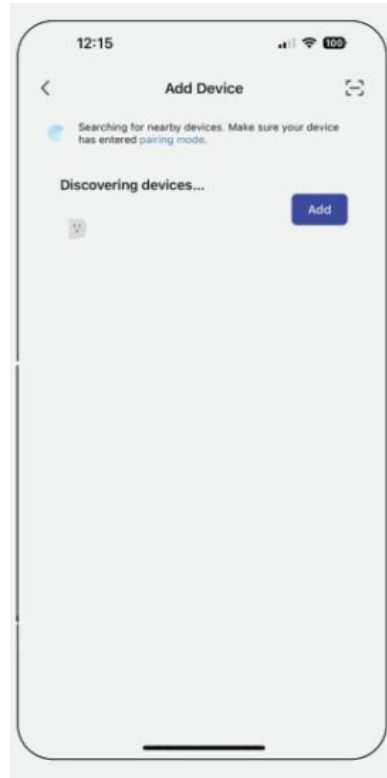
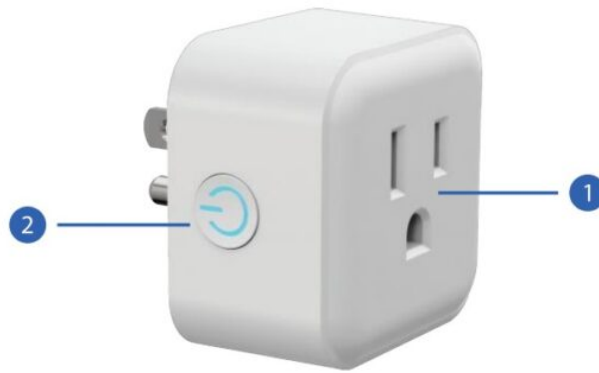

Adding a new Wi-Fi Smart Plug to your network via App

Launch the “Brookstone” App and press “Add device” icon, the app will discover the device, click “Add”, a window will show

to input your Wi-Fi information. To add an additional Smart Plug or other Brookstone devices tap the plus (+) icon in the upper right corner. Repeat previous steps.

Troubleshooting Smart Plug connection

In the event that the Smart Plug does not automatically connect, please check that your phone is turned on and you gave permission for the App to access the Wi-Fi.

Make sure the Smart Plug LED indicator is flashing. If the Wi-Fi signal is not flashing, you will need to press and hold ON/OFF Switch. Make sure the Wi-Fi network is a 2.4GHz network, the device will not connect to a 5GHz network.

Test your Wi-Fi network connection with other devices such as your phone or computer to make sure it is operated properly. Use your phone to check range, it is recommended to have at least 2 signal bars showing for proper connection. Your Wi-Fi network password is case sensitive, make sure you are entering it correctly.

There could be a temporary issue with your Internet connection (e.g., service disruption). Please try again in a few minutes.

Make sure your Bluetooth and Wi-Fi router is turned ON. The Smart Plug may not have power, make sure the wall switch and breaker is in the ON position.

Make sure the Smart Plug is getting a good signal from your Wi-Fi router.



App Main Functions

1. Location management.
2. Add a new device,
3. Location weather information.
4. Display management.
5. Me, Your personal information: Home Management; FAQ & Feedback,
6. Smart scene with conditions of other smart devices.
7. Home device list.

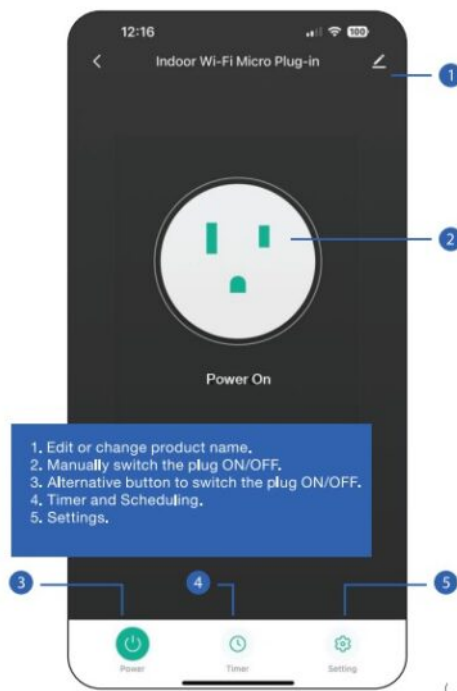

Schedule Page

1. Countdown. Set a timer.
2. Schedule page is activated (highlighted icon). You are able to program day & time to turn it ON/OFF.
3. Random. Create a random schedule for the Smart Plug to turn it On/Off.

4. Astronomical. Sunrise & sunset settings.
5. Add new Schedule.

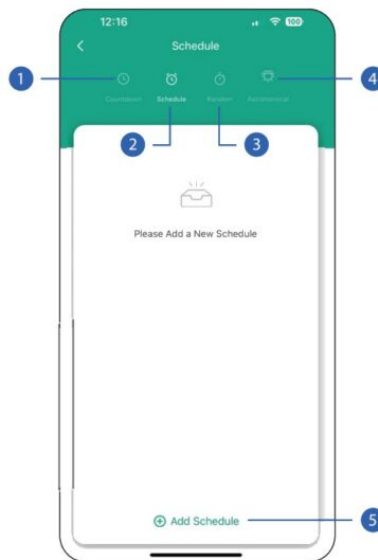

Add Schedule Page

1. Time setting.
2. Date setting.
3. Smart Plug notification & activation.
4. Saving a new schedule.

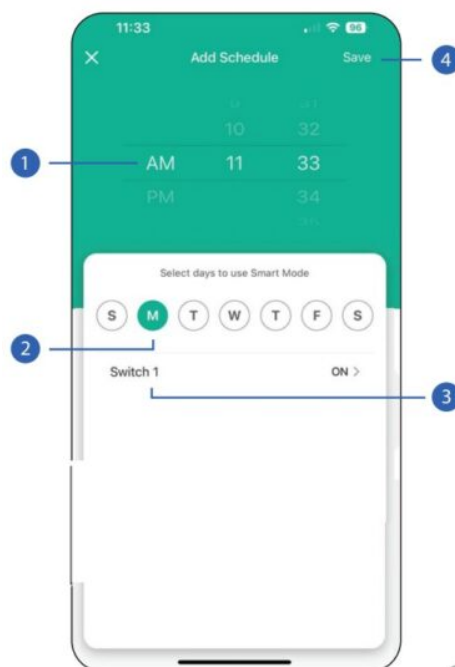

Create Scene Page, see page 6, # 6 icon on the bottom to setup an action or group of actions to occur at the same time.

1. Launch action to run.
2. Weather dependable scene.
3. Device status dependable scene.
4. Save new Scene settings.

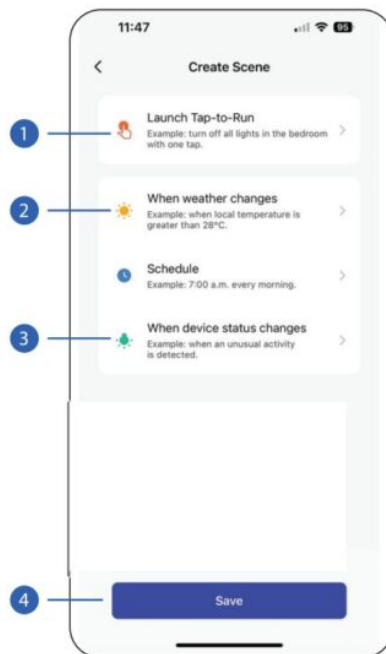

Me Page, see page 6, # 5 icon on the bottom

1. Edit your picture & name.
2. Additional settings & updates.
3. Alexa & Google Assistant connection settings.
4. Save your address location for weather & time settings.
5. Notifications on app's status & conditions.
6. Frequently Asked Questions.
7. Home Page.
8. Open Scene setting page.
9. Me setting page is activated (highlighted icon).

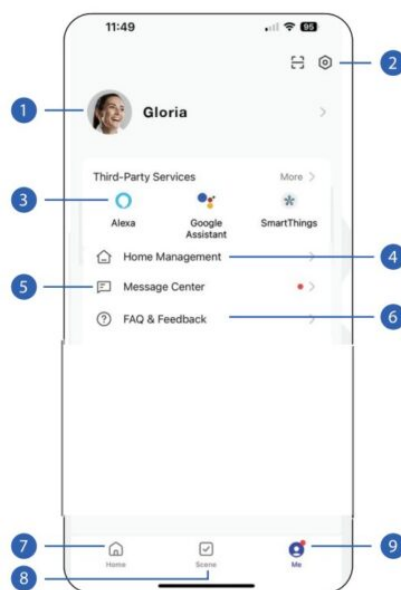

Setting Page, see page 7, # 5 icon on the bottom

1. Run Log. Shows you the log of your device.

2. Light Mode. Control how the LED light on your device operates.
3. Relay Status. Recognizes the current status of the switch & allows you to schedule the alternative action.



This product works with Google and Amazon Alexa® devices. In order to use this feature you need to ENABLE this Device/Skill with your device. Please check with your device instructions to enable the Brookstone Smart Home Skill. You will be asked to enter your login information to your app, to sync it correctly.



WARNING: This product can expose you to chemicals, including DEHP, which is known to the State of California to cause cancer, birth defects or other reproductive harm. For more information go to www.P65Warnings.ca.gov

©2024 BYTECH NY INC. Brooklyn, NY 11223. The BROOKSTONE® trademarks, names and logos are owned by BKST Brand Holdings LLC. ©2024. All rights reserved.

Manufactured, marketed and distributed by Bytech NY INC. under license. Made in Vietnam.

12 Months Warranty

Please Visit our website www.Bytechintl.com/warranty

Alexa® is a registered trademark of Amazon, Inc., Google Play and Google Assistant are registered trademarks of Google, Inc. App Store® is a registered trademark of their respective owners.

of Apple, Inc. Wi-Fi™™ is a trademark of Wi-Fi Alliance™. All trademarks and registered trademarks are property Customer service contact information: 2585 West 13th Street, Brooklyn, NY 11223 [718-449-3700](tel:718-449-3700)

www.bytechintl.com

DO NOT PRINT "PRINTER SLUG" LAYER!

<p>CATEGORY: DESCRIPTION: Indoor 15A WIFI Plug FILE NAME: BR-PL-WF-001-WT REV,3 Manual & Quick Start</p>	<p>ADDITIONAL PRINTING PROCESSES: SPOT UV COAT FINISH: MATTE VARNISHING OVER THE ENTIRE BOX</p>
<p>PRESS WORK: TRIM TO SIZE, SCORE & FOLD WHEN SPECIFIED SCALE: 100% DIELINE OVERALL DIMENSIONS (in Millimeters) WIDTH: HEIGHT:</p>	<p>VARNISHING TECHNIQUE: PRESS SPEC COLOR REFERENCES <input type="checkbox"/> DIELINE <input type="checkbox"/> SPOT UV GLOSS <input type="checkbox"/> EMBOSSING (RELIEF) <input type="checkbox"/> DEBOSSING (SUNKEN) <input type="checkbox"/> FOLDING LINE</p>
<p>PRINTING MATERIALS & THICKNESS & SIZE SUBSTRATE TYPE: ART PAPER SBS C2S 80gsm Minimum Brightness of 85% White!</p>	
<p>PRINTING TYPE: DOUBLE PARALLEL FOLD</p>	<p>ADDITIONAL PANTONE COLORS (NOT CMYK) SOLID COLOR NAME: NEON COLOR NAME: METALLIC COLORS:</p>
<p>APPROVAL CHECKLIST: PRIMARY DESIGNER: 10SIF DATE: 05.03.24, 09.13.24, 09.23.24 SECONDARY DESIGNER: DATE: PROOF READ: DATE: APPROVED BY: DATE: AUTHORIZATION SIGNATURES:</p>	<p>FILE SAVED AS: .ai FULLY EDITABLE -OLai OUTLINED .pdf = Acrobat .jpg Flat image</p>

QUICK START GUIDE OUTSIDE PAGES

That's It! It's Simple!



Brookstone

©2024 BYTECH NY INC. Brooklyn, NY 11223. The BROOKSTONE® trademarks, names and logos are owned by BKST Brand Holdings LLC. ©2024. All rights reserved. Manufactured, marketed and distributed by Bytech NY INC. under license. Made in Vietnam.

Alexa is a registered trademark of Amazon, Inc., Google Play and Google Assistant are registered trademarks of Google, Inc.

App Store is a registered trademark of Apple, Inc. Wi-Fi™ is a trademark of Wi-Fi Alliance™.

All trademarks and registered trademarks are property of their respective owners.

Customer service contact information: 2585 West 13th Street, Brooklyn, NY 11223 [718-449-3700](tel:718-449-3700)

www.bytechintl.com

QUICK START GUIDE

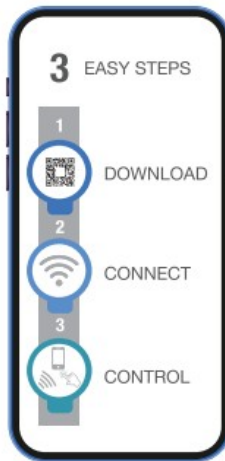

AS EASY AS 1-2-3

1. Insert the Smart Plug into the power outlet.
2. Download and Install the Brookstone App.

SCAN QR CODE OR VISIT: <https://brookstonesmarthome.com/brookstone-indoor-15a-smart-plug>



3. Open the App and add the Wi-Fi Smart Plug.



This device complies with part 15 of the FCC Rules.

Operation is subject to the following two conditions: (1) This device may not cause harmful interference, and (2) this device must accept any interference received, including interference that may cause undesired operation.

Any Changes or modifications not expressly approved by the party responsible for compliance could void the user's authority to operate the equipment.

Note: This equipment has been tested and found to comply with the limits for a Class B digital device, pursuant to part 15 of the FCC Rules. These limits are designed to provide reasonable protection against harmful interference in a residential installation. This

equipment generates uses and can radiate radio frequency energy and, if not installed and used in accordance with the instructions, may cause harmful interference to radio communications. However, there is no guarantee that interference will not occur in a particular installation. If this equipment does cause harmful interference to radio or television reception, which can be determined by turning the equipment off and on, the user is encouraged to try to correct the interference by one or more of the following measures:

- Reorient or relocate the receiving antenna.
- Increase the separation between the equipment and receiver.

- Connect the equipment into an outlet on a circuit different from that to which the receiver is connected.
- Consult the dealer or an experienced radio/TV technician for help.

This equipment complies with FCC radiation exposure limits set forth for an uncontrolled environment. This equipment should be installed and operated with minimum distance 20cm between the radiator & your body.

Documents / Resources

	Brookstone P101201 15A Power Rating WiFi Smart Plug [pdf] User Guide P101201, P101201 15A Power Rating WiFi Smart Plug, 15A Power Rating WiFi Smart Plug, Power Rating WiFi Smart Plug, Rating WiFi Smart Plug, WiFi Smart Plug, Smart Plug, Plug
---	--

References

- [User Manual](#)

[Manuals+](#), [Privacy Policy](#)

This website is an independent publication and is neither affiliated with nor endorsed by any of the trademark owners. The "Bluetooth®" word mark and logos are registered trademarks owned by Bluetooth SIG, Inc. The "Wi-Fi®" word mark and logos are registered trademarks owned by the Wi-Fi Alliance. Any use of these marks on this website does not imply any affiliation with or endorsement.