

BRONCO BFT2100 Front Bumper Frame Tie In Brackets Installation Guide

[Home](#) » [BRONCO](#) » BRONCO BFT2100 Front Bumper Frame Tie In Brackets Installation Guide 



Contents

- [1 BFT2100 Front Bumper Frame Tie In Brackets](#)
- [2 Documents / Resources](#)

BFT2100 Front Bumper Frame Tie In Brackets

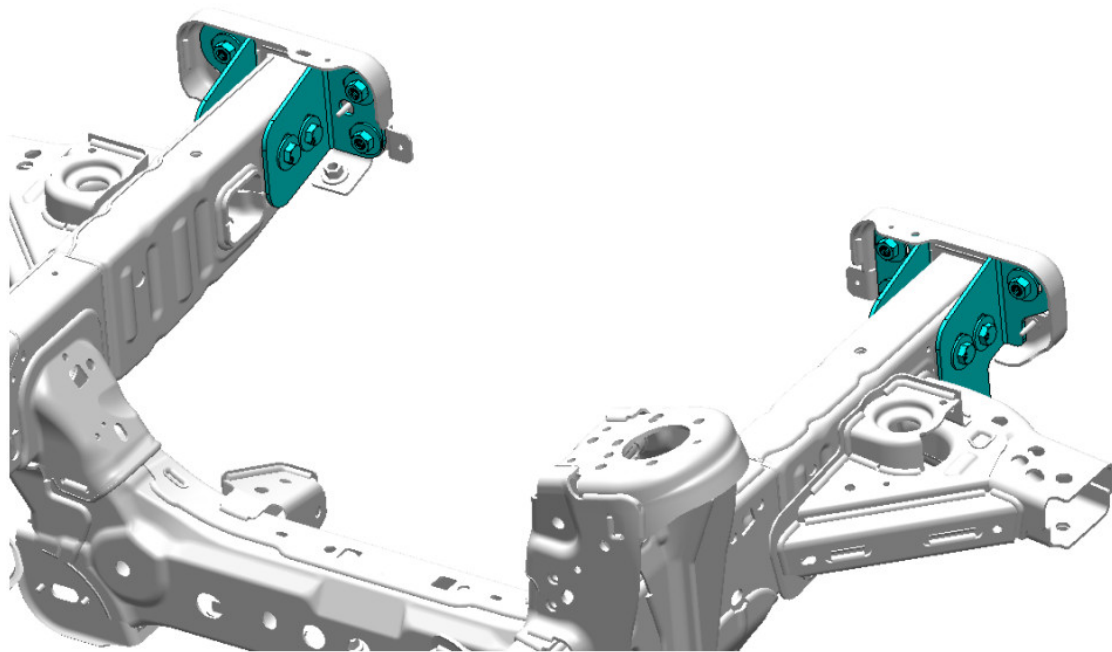

VERIFY YOU HAVE ALL THE COMPONENTS BEFORE STARTING THE INSTALLATION. REFER TO THE ENGINEERING DRAWINGS AT THE END OF THIS DOCUMENT FOR A COMPLETE PARTS LIST

Start by removing the “U” shaped nut bracket located behind the frame face plate. This bracket was originally used to mount your bumper and is replaced by the individual M12 nuts and washers provided.

For additional support we recommend adding a Ø1/2" hole in this location. Use the Frame Tie in Bracket as a template to mark the hole location and drill.

This hole is already in the correct location. However it will need to be enlarged. Use a Ø1/2" drill bit to enlarge this hole.

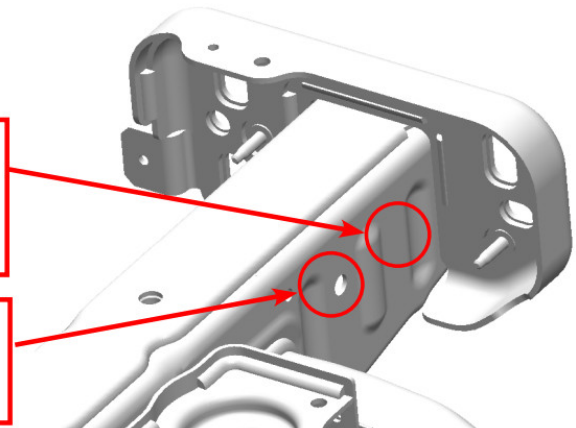

Repeat this procedure on both sides of both frame rails. Be sure to clean the areas and paint any raw metal to prevent rusting. Position the Frame Tie in Brackets as shown, making sure they are flush up against the back of the frame face plate. Tighten both mounting bolts on each Frame Tie in Bracket and then proceed with your bumper installation.

Inner Frame Tie in Bracket

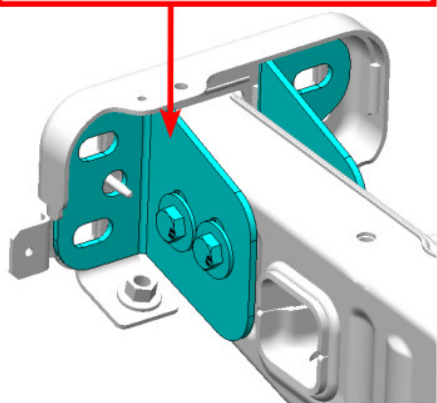

Outer Frame Tie in Bracket

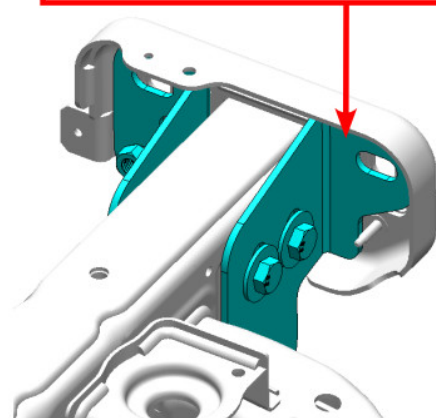

ITEM NO	PART NUMBER	DESCRIPTION	QTY.
1	2BFT2021-01	INNER FRAME TIE IN BRACKET – PS	1
2	2BFT2021-02	OUTER FRAME TIE IN BRACKET – PS	1
3	2BFT2021-03	INNER FRAME TIE IN BRACKET – DS	1
4	2BFT2021-04	OUTER FRAMAE TIE IN BRACKET – DS	1
5	HB12175M40ZPCL88	HEX BOLT M12-1.75 x 40mm ZINC PLATE CL8.8	8
6	HN12175MZPCL8	HEX NUT M12 X 1.75mm ZINC PLATE CL8	14
7	FW5022ZP	FLAT WASHER Ø1/2" X 1.375" ZINC PLATE	22

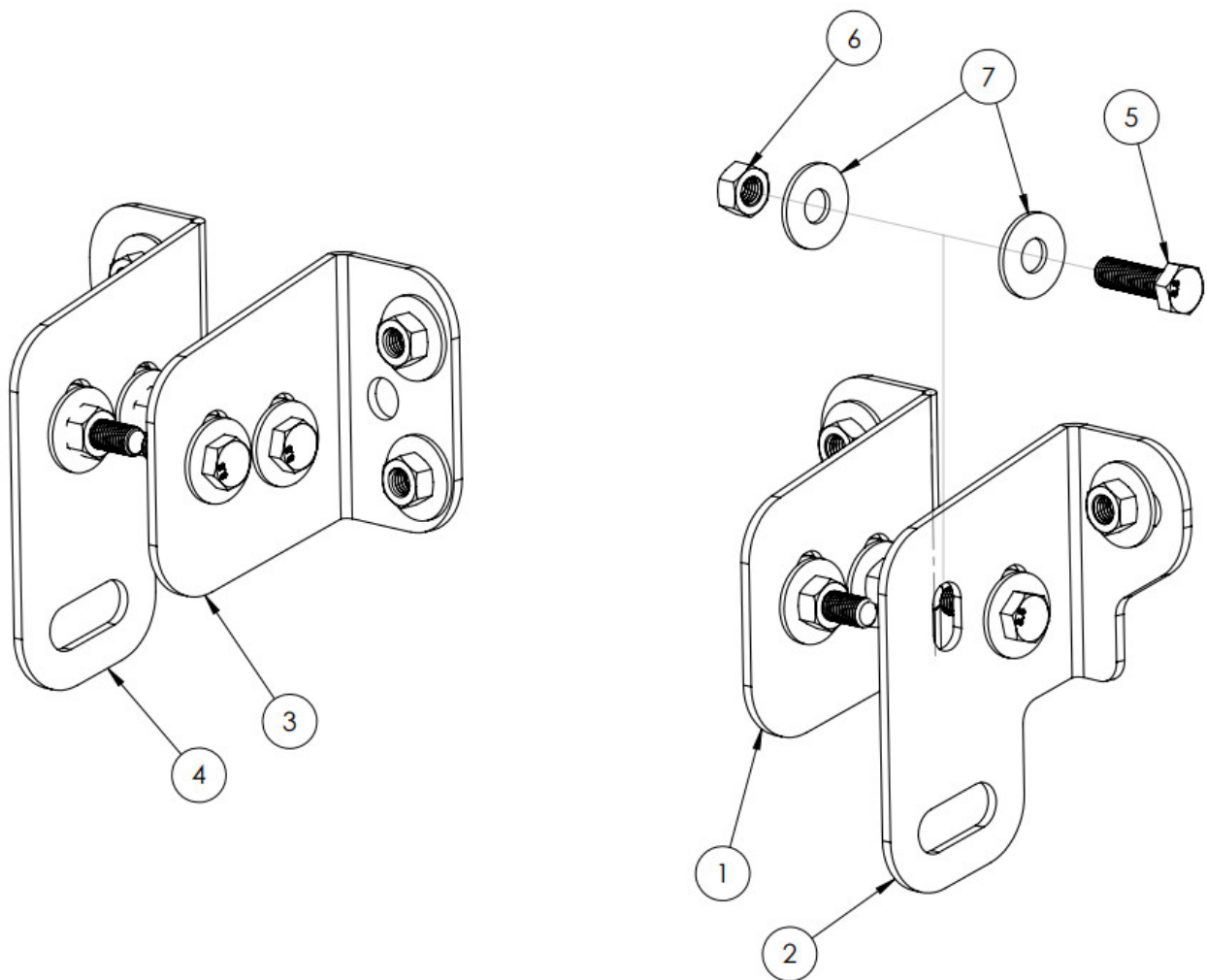

NOTES:

1. BFT2100 = BARE STEEL OPTION
2. BFT2101 = BLACK POWDER COAT
3. WEIGHT = APPROX 6.25 LBS

UNLESS OTHERWISE SPECIFIED:		NAME	DATE
DIMENSIONS ARE IN INCHES TOLERANCES: ± 0.010 ANGULAR: MACH $\pm 1^\circ$ TWO PLACE DECIMAL ± 0.015 THREE PLACE DECIMAL ± 0.005	DRAWN	MCH	12/21/2021
	CHECKED		
	ENG APPR.		
	MFG APPR.		
PROPRIETARY AND CONFIDENTIAL THE INFORMATION CONTAINED IN THIS DRAWING IS THE SOLE PROPERTY OF LOD LLC. ANY REPRODUCTION IN PART OR AS A WHOLE WITHOUT THE WRITTEN PERMISSION OF LOD LLC IS PROHIBITED.	MATERIAL: N/A		
	FINISH: SEE NOTES		
	ECO: —		

LOD LLC.



DESCRIPTION:

2021 BRONCO FRONT FRAME TIE IN BRACKETS

DWG. NO.

BFT2100

BFT2101

REV A

SHEET 1 OF 1

SHEET SIZE: B

SCALE: 1:2.5



BRONCO
BLACK-OPS SERIES
FRONT BUMPER FRAME TIE
IN BRACKETS
SHIPPING SHEET

Packaged by:

On:

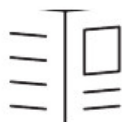

INSTRUCTION
SHEET



BOLT KIT
BFT2100-BK
(x1)

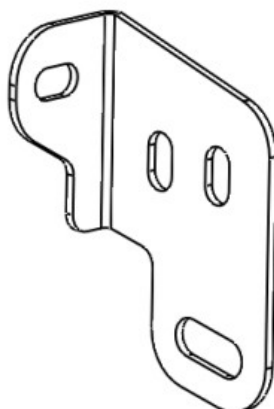

OUTER FRAME TIE IN
BRACKET - DS
2BFT2021-04
(x1)

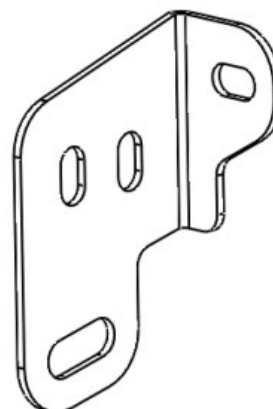

OUTER FRAME TIE IN
BRACKET - PS
2BFT2021-02
(x1)

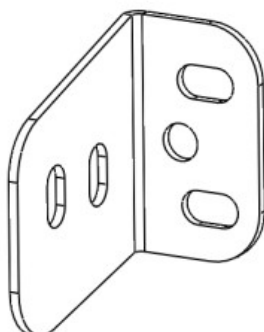

INNER FRAME TIE IN
BRACKET - DS
2BFT2021-03
(x1)

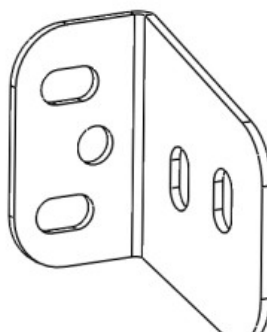

INNER FRAME TIE IN
BRACKET - PS
2BFT2021-01
(x1)





BRONCO
BLACK-OPS SERIES
FRONT BUMPER FRAME TIE
IN BRACKETS
BFT2100-BK

Bolt Kit

Packaged by:

On:

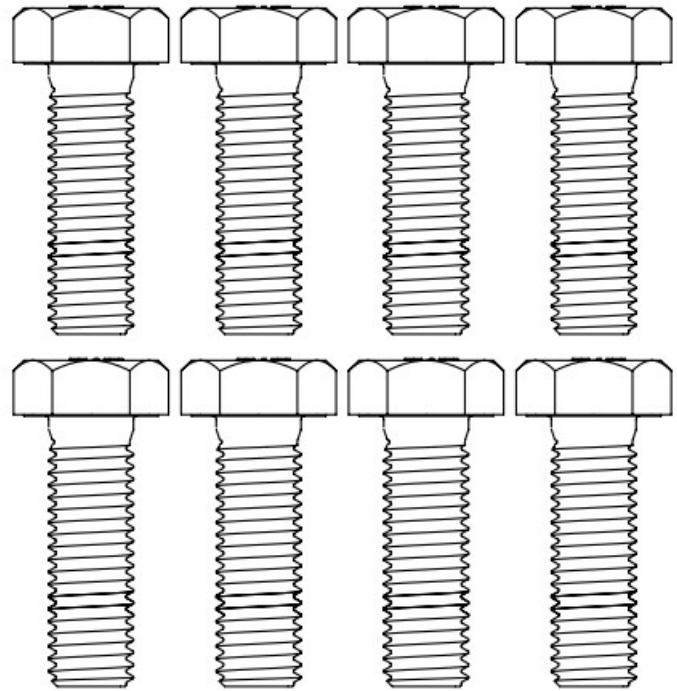

HEX BOLT M12-1.75 X 40MM LG
(1138708)
(x8)

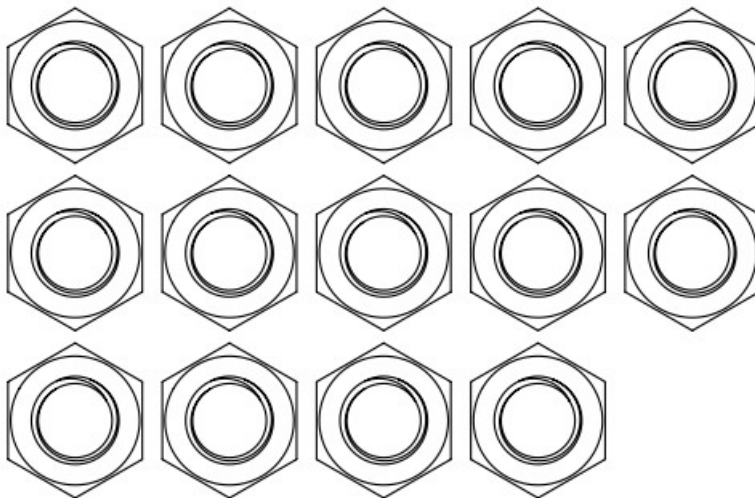

HEX NUT M12-1.75
(40309)
(x14)



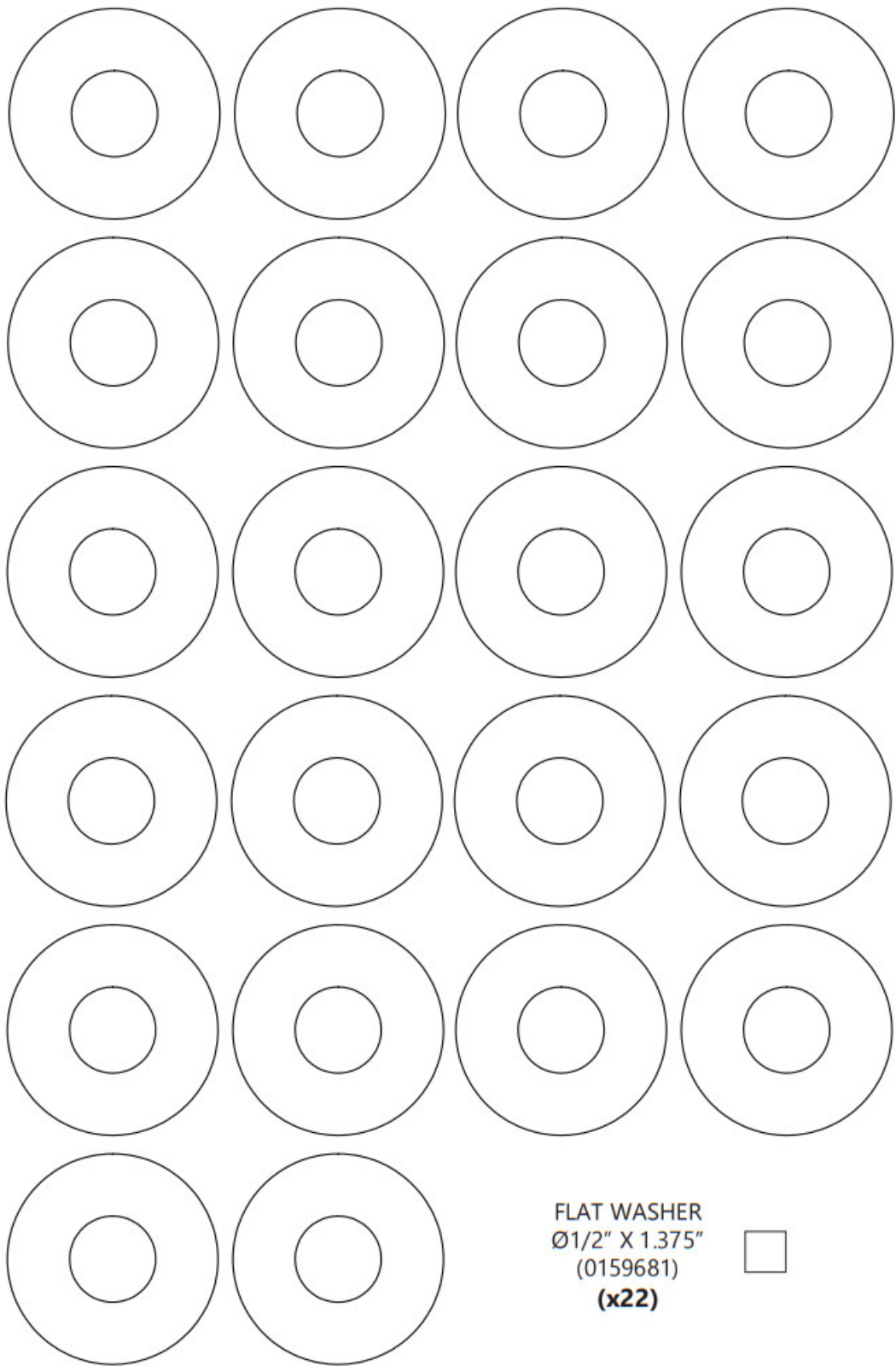

BFT2100 – Rev 1
12/27/21

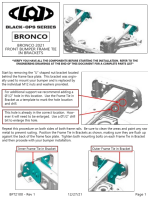

[BRONCO BFT2100 Front Bumper Frame Tie In Brackets](#) [pdf] Installation Guide
BFT2100 Front Bumper Frame Tie In Brackets, BFT2100, Front Bumper Frame Tie In Brackets, Bumper Frame Tie In Brackets, Frame Tie In Brackets, Tie In Brackets, In Brackets