



BROILMASTER SKFB2 Solid Surface Shelf With Stainless Mounting Bracket Owner's Manual

[Home](#) » [Broilmaster](#) » **BROILMASTER SKFB2 Solid Surface Shelf With Stainless Mounting Bracket Owner's Manual** 

Contents

- [1 BROILMASTER SKFB2 Solid Surface Shelf With Stainless Mounting Bracket](#)
- [2 IMPORTANT INFORMATION](#)
- [3 SKFB2 & SKFPB2 HARDWARE PACK – B101658](#)
- [4 SOLID SURFACE DROP-DOWN SIDE SHELF INSTALLATION](#)
- [5 SOLID SURFACE DROP-DOWN SIDE SHELF INSTALLATION](#)
- [6 HOW TO ORDER REPAIR PARTS](#)
- [7 Warranty Parts](#)
- [8 Documents / Resources](#)

BROILMASTER®

BROILMASTER SKFB2 Solid Surface Shelf With Stainless Mounting Bracket



IMPORTANT INFORMATION

IMPORTANT

Thank you for choosing a Broilmaster Premium Gas Grill. This shelf kit has been designed to fit perfectly and function flawlessly – to provide years of service.

Please read the entire manual and compare the parts list to the parts provided with this kit before you begin the installation. If this shelf kit is missing any parts, contact your Broilmaster dealer. Keep this manual in a safe place to help you identify and order repair parts if they are ever required.

This manual covers the SKFPB2, SKFB2 and DPA153 folding shelves. Refer to the illustration for your shelf, and follow the instructions carefully.

CAUTION

These side shelves are designed to support approximately 25 pounds. Exceeding this weight limit may cause damage and void the warranty.

CAUTION

Parts may have sharp edges. Wear leather work gloves and handle parts carefully during unpacking, assembly and installation.

Thank you for purchasing a Broilmaster Grill Accessory.

- Broilmaster takes pride in its reputation as the The Most Durable Grill Known to Man.
- From its thick aluminum casting to its massive cooking grids, your Broilmaster is built to last. In fact we still make replacement parts for Broilmaster grills built more than 30 years ago.
- Visit www.broilmaster.com and click on the Hall of Fame to see a sampling of our long-time customers. We hope you enjoy years of great meals prepared on your Broilmaster. And we hope to add your photo to the Hall of Fame one day.

Thank You!

Broilmaster is a registered trademark of Empire Comfort Systems, Inc.

- 918 Freeburg Ave.
- Belleville, Illinois 62220
- Telephone 800-851-3153

ASSEMBLY INSTRUCTIONS

Before You Begin Compare the parts in the box to the parts list provided in this manual. If any are missing, contact your Broilmaster dealer before beginning assembly.

CAUTION

Parts may have sharp edges. For your safety wear leather work gloves and handle parts carefully during unpacking and assembly.

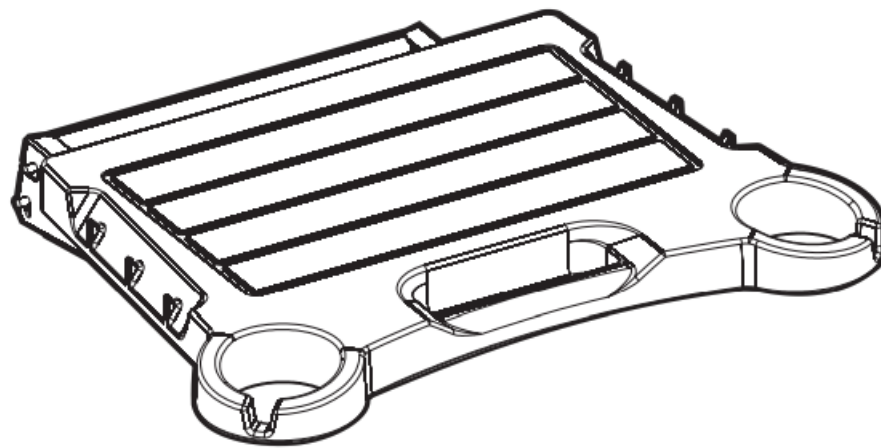
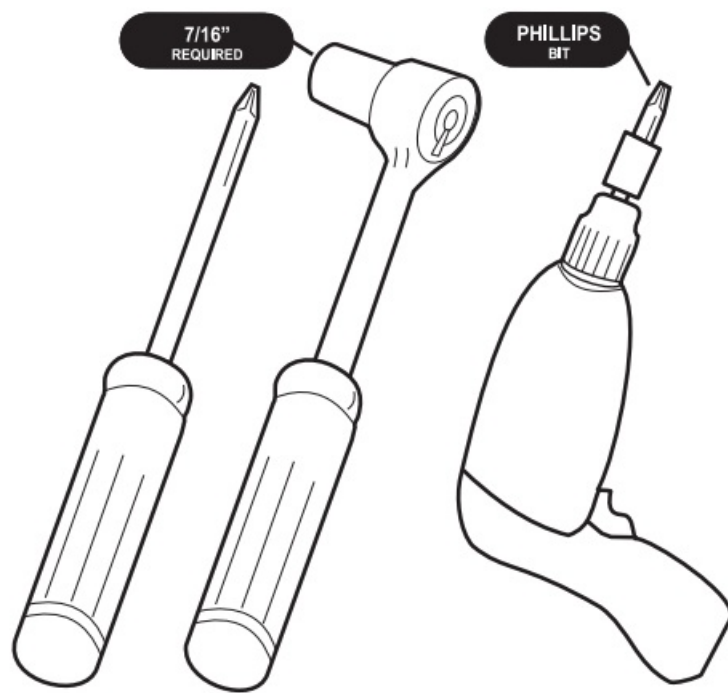

SKFB2-1, SKFPB2-1
SOLID SURFACE DROP-DOWN SHELF KIT

SKFB2 & SKFPB2 PARTS DIAGRAM

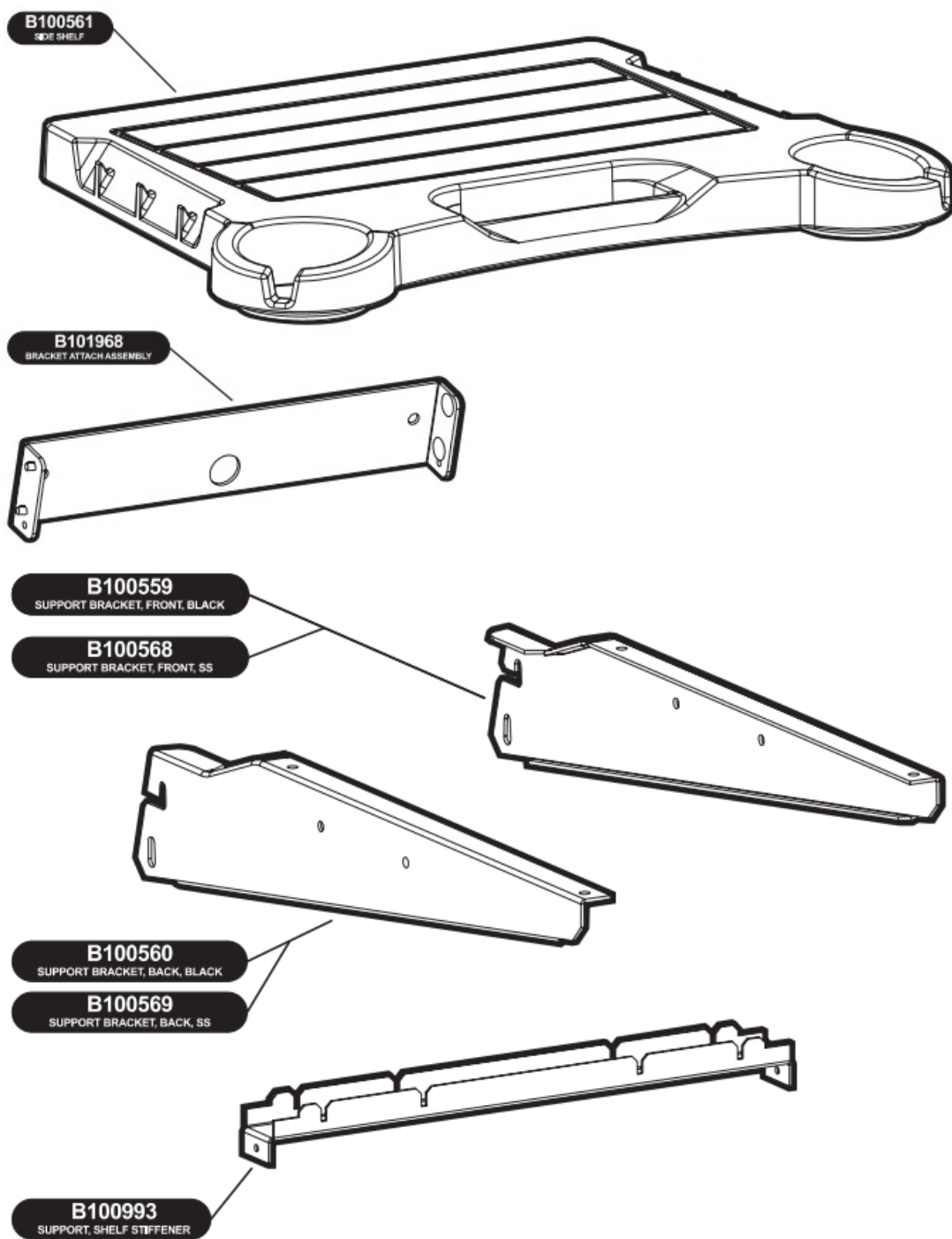

SKFB2 & SKFPB2 HARDWARE PACK – B101658

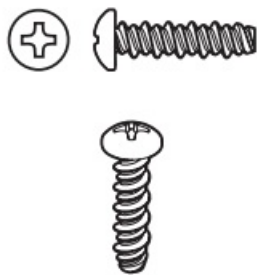

PHILLIPS PAN HEAD SCREW,
10-16 X 3/4
B100563
(4)

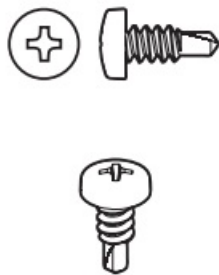

SELF-DRILLING PHILLIPS PAN HEAD SCREW,
SS, 10-16 X 1/2
R4059
(2)

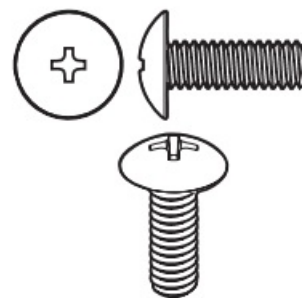

PHILLIPS TRUSS HEAD SCREW,
SS, 1/4-3/4
B072217
(2)

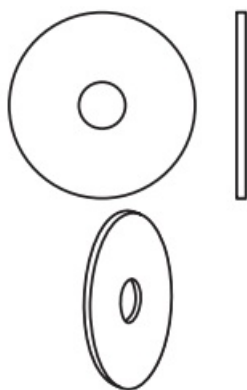

FLAT WASHER,
SS, 1/4 ID X 1
OD
B101640
(2)



LOCK WASHER,
1/4 ID X 1/2 OD
B076333
(2)

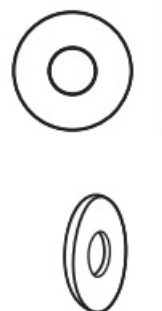

FLAT WASHER,
1/4 ID X 5/8 OD
B076332
(2)



HEX NUT,
SS, 1/4-20
B076331
(2)



Standard hardware items such as bolts, screws, washers, and nuts can be purchased at your local hardware store. Do not order individual pieces of standard hardware. A replacement hardware pack may be ordered using the hardware pack part number at the top of the page.

SOLID SURFACE DROP-DOWN SIDE SHELF INSTALLATION

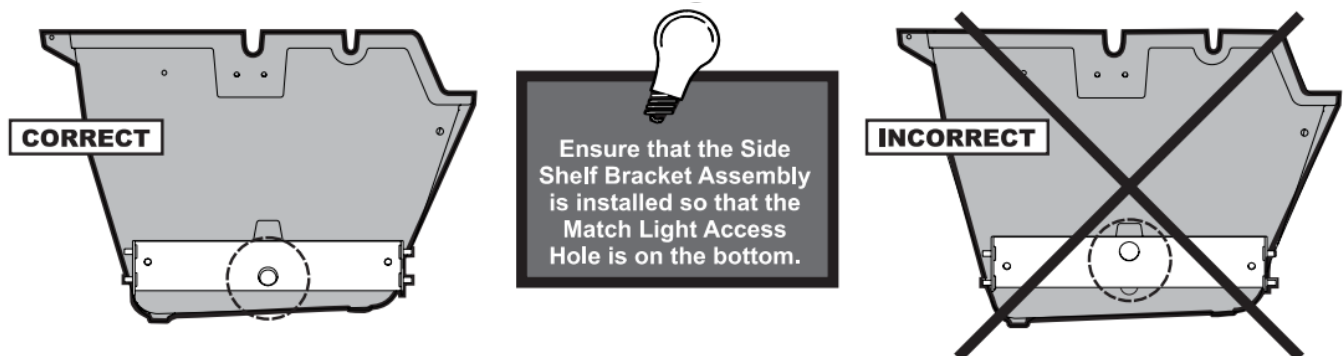
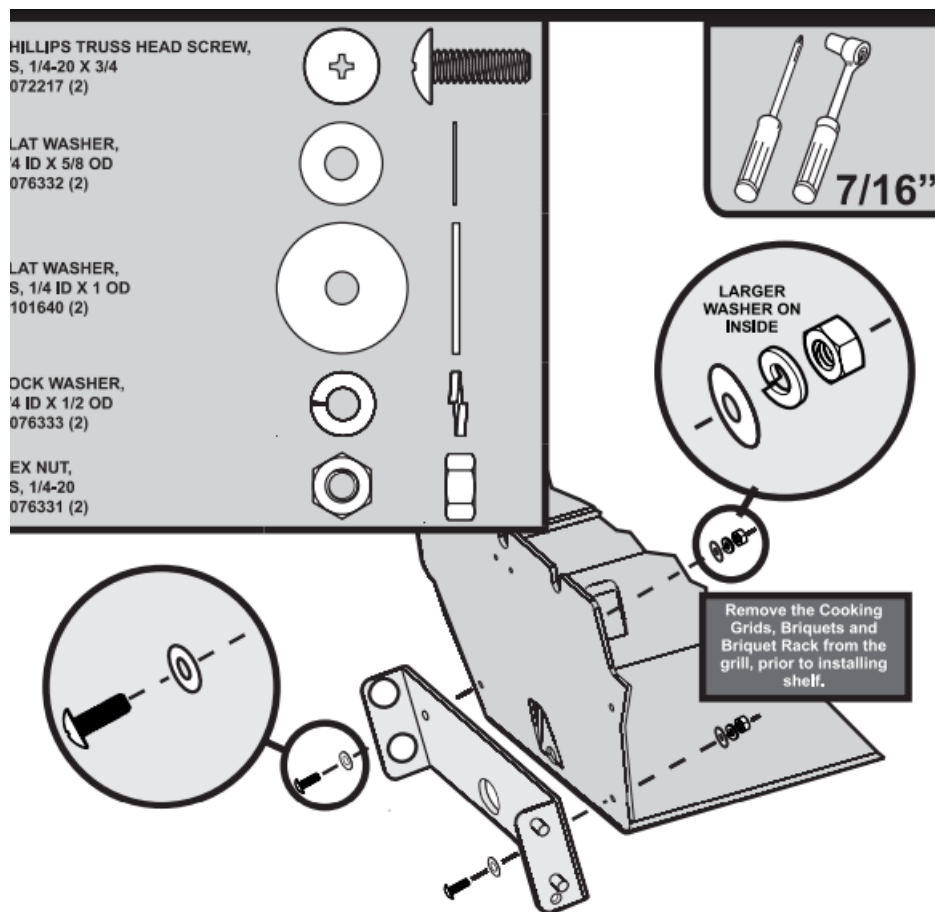

SOLID SURFACE DROP-DOWN SIDE SHELF INSTALLATION

PHILLIPS TRUSS HEAD SCREW, SS, 1 /4-20 X 3/4

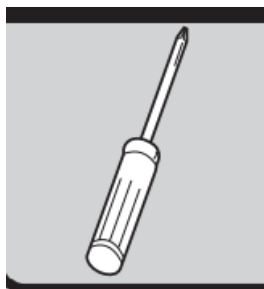

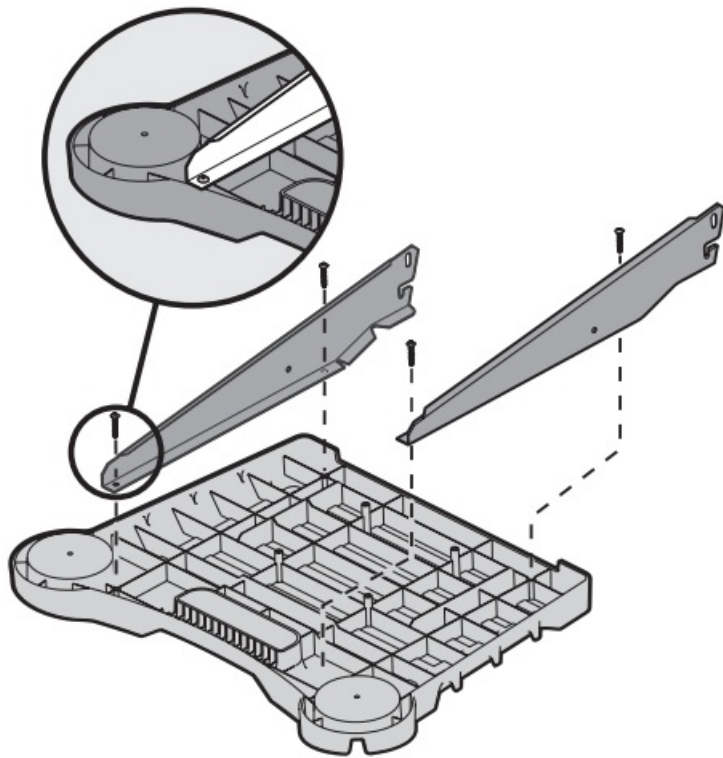

SELF-DRILLING PHILLIPS PAN HEAD SCREW, SS, 10-16 X 1/2

R4059 (2)

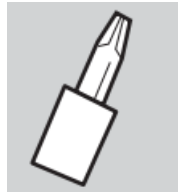

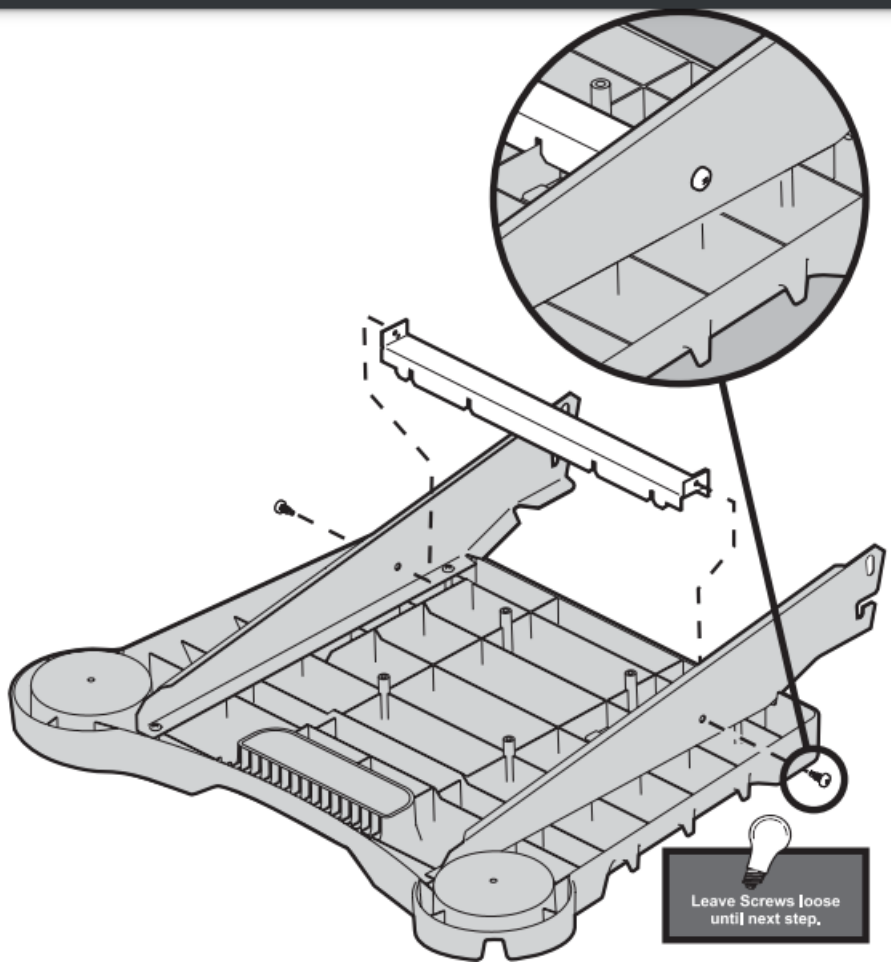

SOLID SURFACE DROP-DOWN SIDE SHELF INSTALLATION



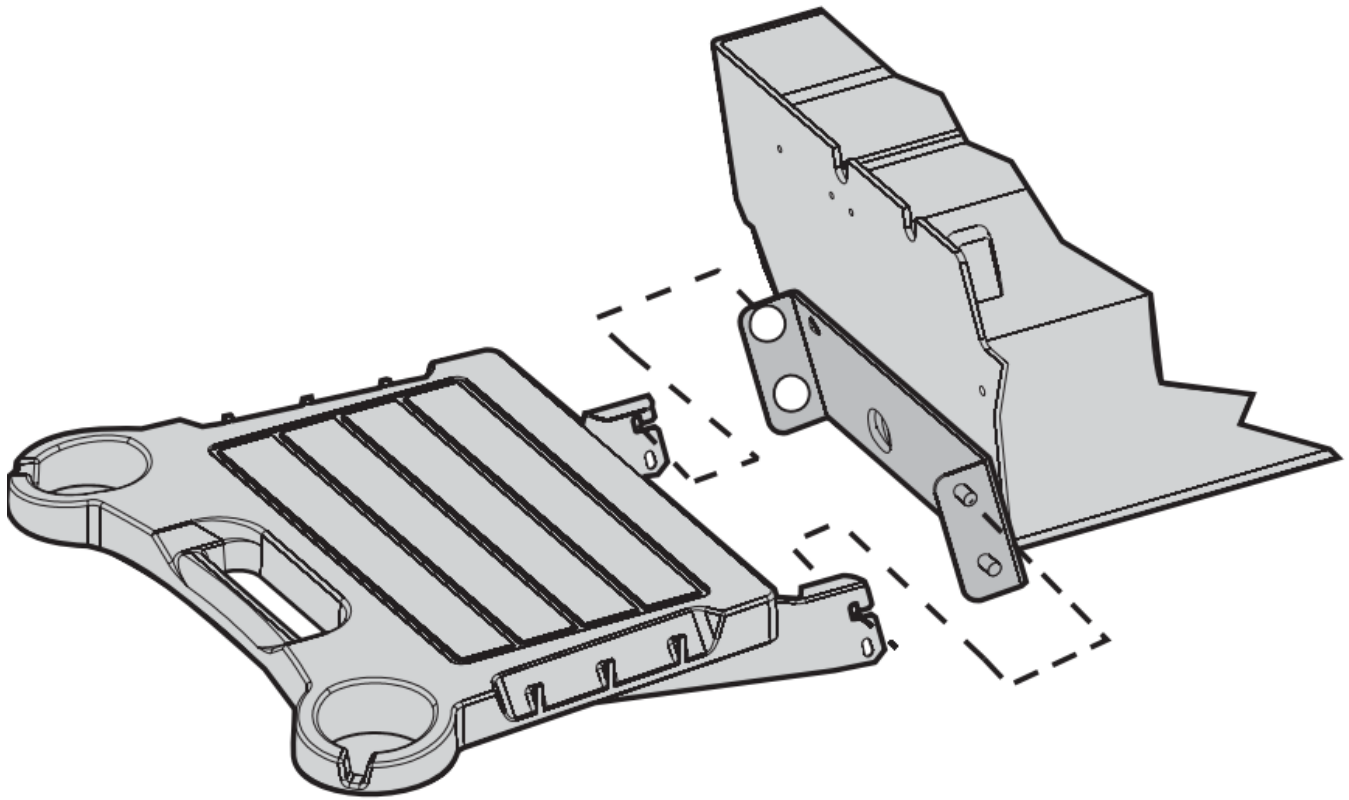

Hang the side Brackets on the lower Pins of the Bracket attach assembly. Tighten the two 10-16 x 1/2 Phillips screws from previous step. Replace components removed from grill after installing shelf.

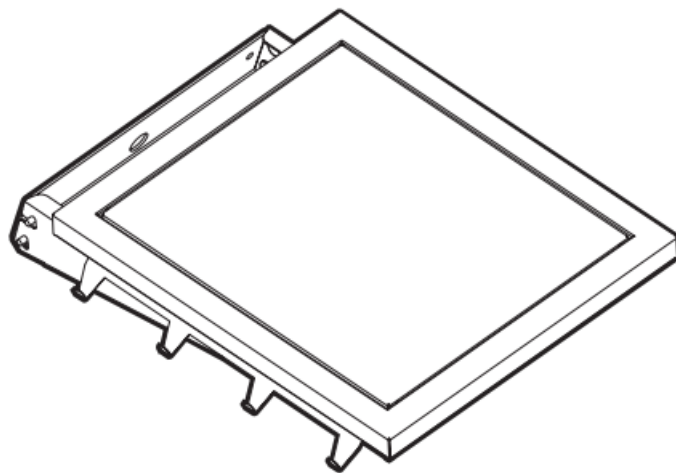

DPA153 PARTS DIAGRAM

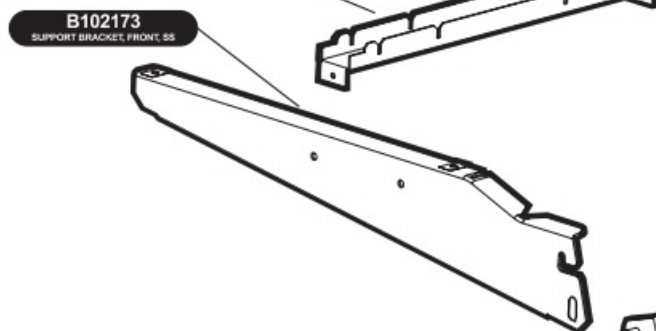
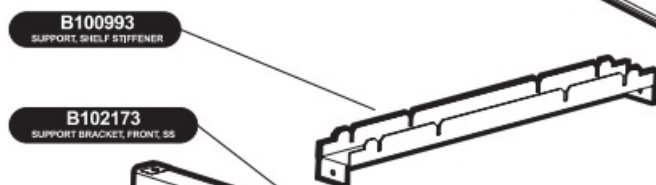
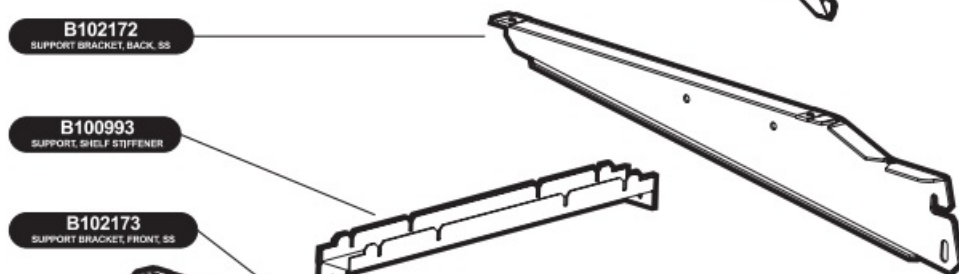
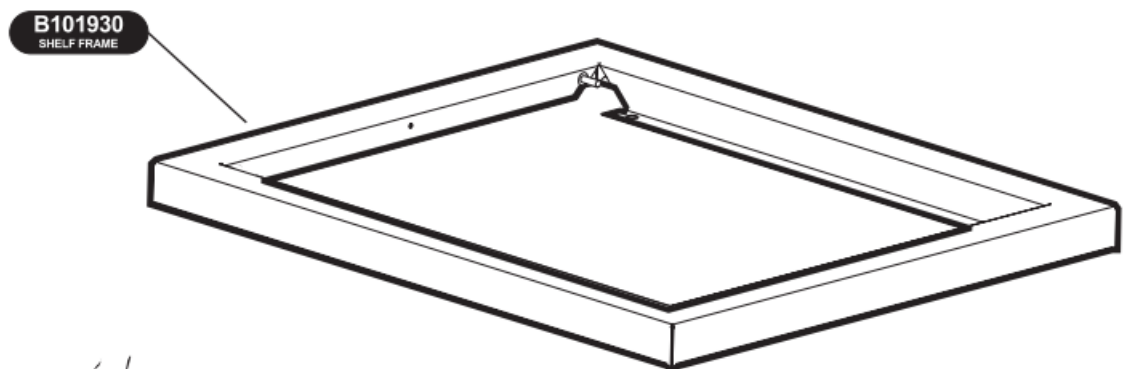
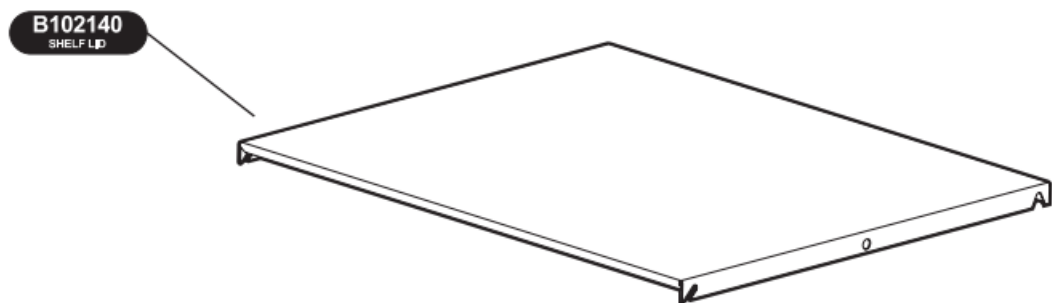

DPA153 HARDWARE PACK – B102154

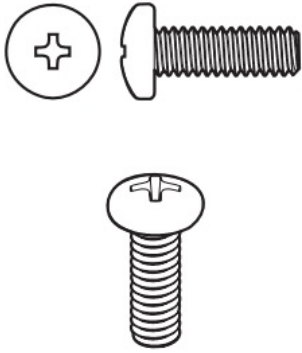

PHILLIPS PAN HEAD SCREW,
SS, 1/4-20 X 3/4
B072217
(2)

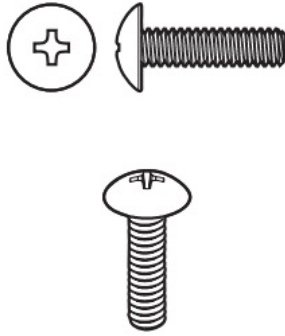

PHILLIPS TRUSS HEAD SCREW,
10-24 X 3/4
B076522
(4)

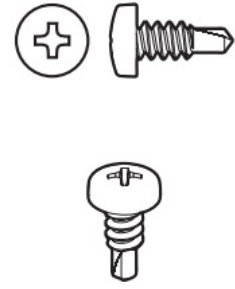

SELF-DRILLING PHILLIPS PAN HEAD SCREW,
SS, 10-16 X 1/2
R4059
(4)

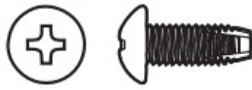

PHILLIPS PAN HEAD TYPE F SCREW,
SS, 10-32 X 1/2
R11387
(2)

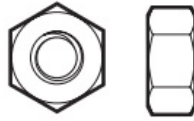

HEX NUT,
SS, 1/4-20
B076331
(2)



LOCK WASHER,
1/4 ID X 1/2 OD
B076333
(2)

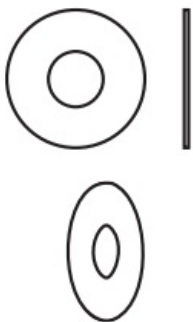

FLAT WASHER,
SS, 1/4 ID X 5/8
OD
B076332
(2)



U-CLIP, NUT
SS, 10-24
SPEED
B072223
(4)

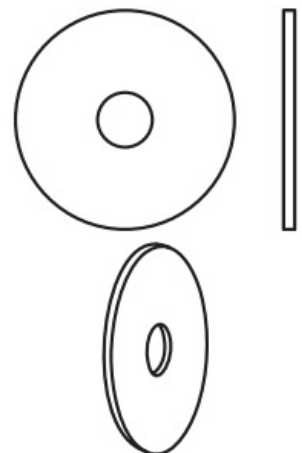

FLAT WASHER,
SS, 1/4 ID X 1
OD
B101640
(2)

Standard hardware items such as bolts, screws, washers, and nuts can be purchased at your local hardware store. Do not order individual pieces of standard hardware. A replacement hardware pack may be ordered using the hardware pack part number at the top of the page.

STAINLESS STEEL DROP-DOWN SIDE SHELF INSTALLATION

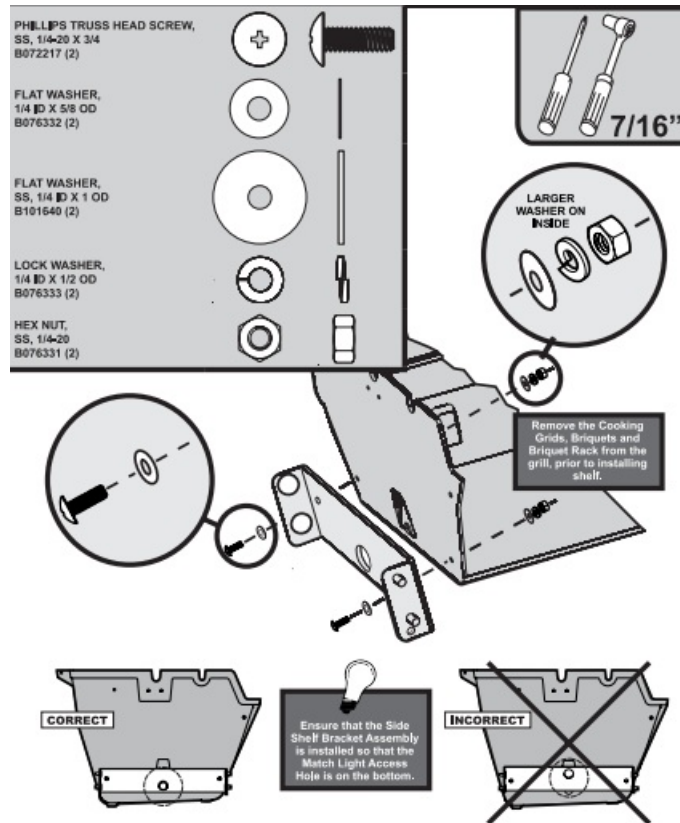

STAINLESS STEEL DROP-DOWN SIDE SHELF INSTALLATION

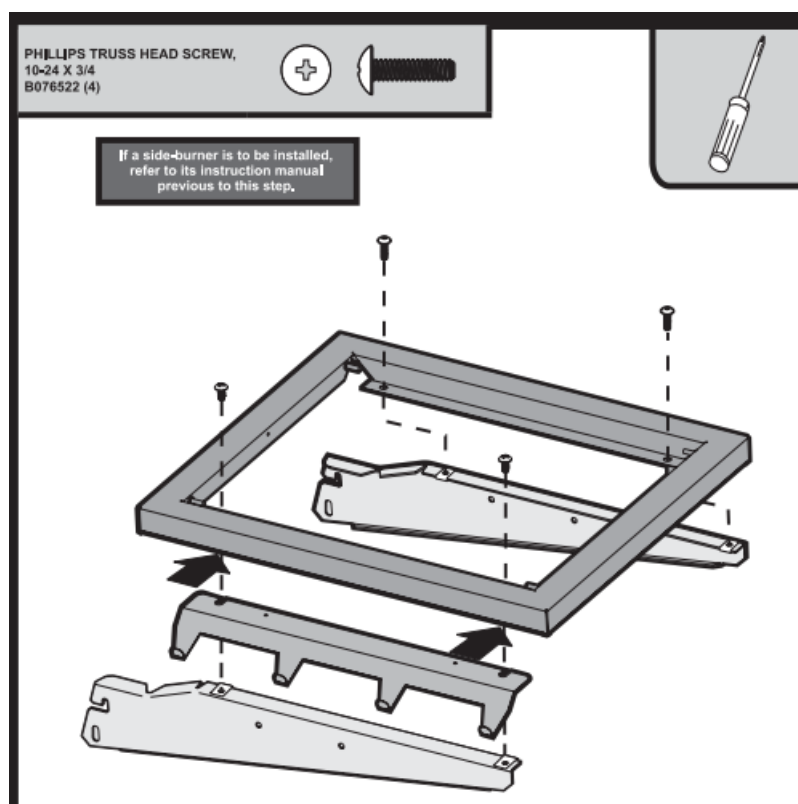

STAINLESS STEEL DROP-DOWN SIDE SHELF INSTALLATION

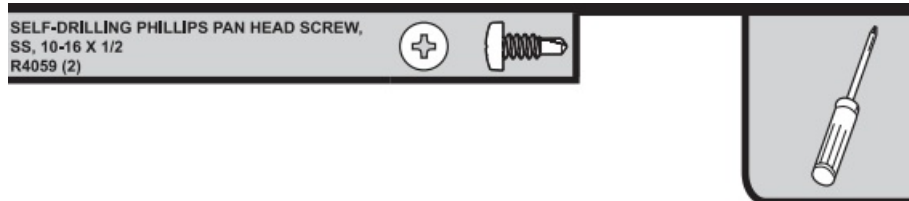

STAINLESS STEEL DROP-DOWN SIDE SHELF INSTALLATION

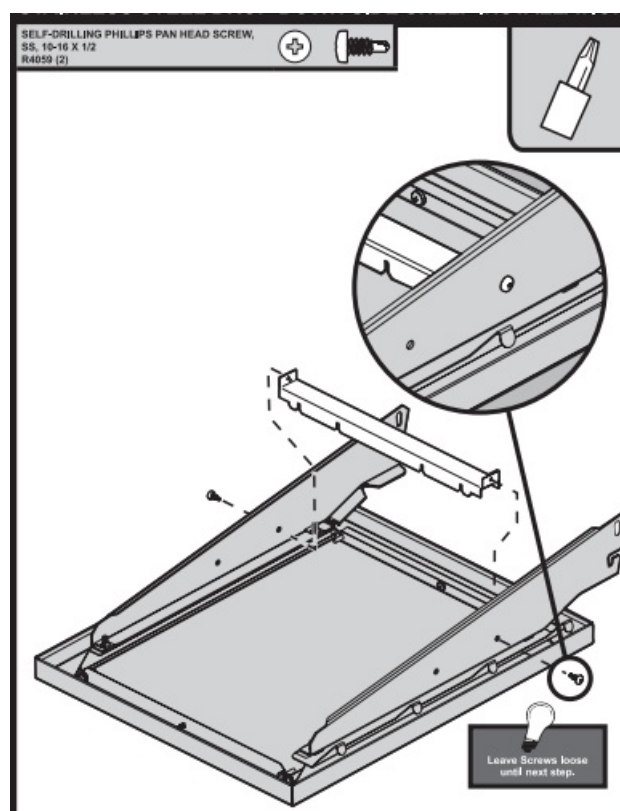

STAINLESS STEEL DROP-DOWN SIDE SHELF INSTALLATION

STAINLESS STEEL DROP-DOWN SIDE SHELF INSTALLATION

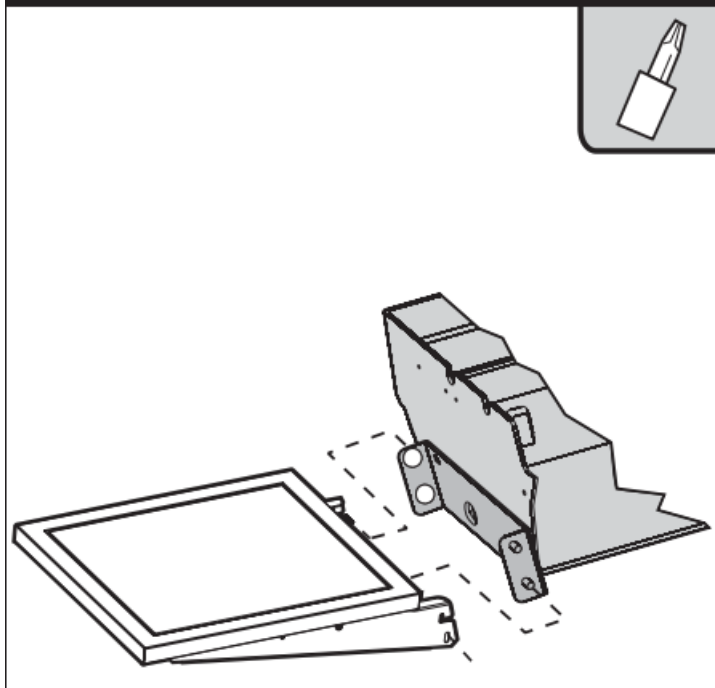

MASTER PARTS DISTRIBUTOR LIST

- To order parts under warranty, please contact your local Broil master dealer. See the dealer locator at www.broilmaster.com.
- To provide warranty service, your dealer will need your name and address, purchase date and serial number, and the nature of the problem. Please keep your receipt to establish ownership and date of purchase.
- To order parts after the warranty period, please contact your dealer or one of the Master Parts Distributors listed below.
- The Master Parts Distributor list changes from time to time. For the current list go to www.broilmaster.com and click on the Parts button.

Note: Master Parts Distributors are independent businesses that stock the most commonly ordered repair parts.

Dey Distributing

1401 Willow Lake Boulevard Vadnais Heights, MN 55101

- **Phone:** 651-490-9191
- **Toll Free:** 800-397-1339
- **Website:** www.deydistributing.com
- **Parts:** Heater, Hearth and Grills
- East Coast Energy Products
- 10 East Route 36
- West Long Branch, NJ 07764
- **Phone:** 732-870-8809
- **Toll Free:** 800-755-8809
- Fax: 732-870-8811
- **Website:** www.eastcoastenergy.com
- **Parts:** Heater, Hearth and Grills

Victor Division of F. W. Webb Company

200 Locust Street

- Hartford, CT 06114
- **Phone:** 860-722-2433
- **Toll Free:** 800-243-9360
- **Fax:** 860-293-0479
- **Toll Free Fax:** 800-274-2004
- **Websites:** www.fwwebb.com & www.victormfg.com
- **Parts:** Heater, Hearth and Grills

HOW TO ORDER REPAIR PARTS

Parts Not Under Warranty

Parts can be ordered through your Service Person, Dealer, or a Master Parts Distributor. See this page for the Master Parts Distributors list. For best results, the service person or dealer should order parts through the distributor. Parts can be shipped directly to the service person/dealer.

Warranty Parts

- Warranty parts will need a proof of purchase and can be ordered by your Service Person or Dealer. Proof of purchase is required for warranty parts.
- All parts listed in the Parts List have a Part Number. When ordering parts, first obtain the Model Number and Serial Number from the name plate on your equipment. Then determine the Part Number (not the Index Number) and the
- Description of each part from the following illustration and part list. Be sure to give all this information ...
- Model Number/ Dealer _____
- Part Description _____
- Serial Number I Dealer Phone Number _____
- Part Number _____
- Type of Gas (Propane or Natural) _____
- Do not order bolts, screws, washers or nuts. They are standard hardware items and can be purchased at any local hardware store.
- Shipments contingent upon strikes, fires and all causes beyond our control.
- Your Broilmaster Premium Gas Grill is identified by model number, serial number, and gas type. This information is provided on a product identification label located on the grill's control panel. For your convenience, complete this section for future reference when contacting your dealer.

BROILMASTEir

PREMIUM GRILLS

BROILMASTER

A Division of Empire Comfort Systems, Inc.

- 918 Freeburg Ave.
- Belleville, Illinois 62220
- V1s1T ouR WEB s1TE AT www.broilmaster.com

- If you have a general question about our products, please e-mail us at info@empirecomfort.com. If you have a service or repair question, please contact your dealer.

Documents / Resources



[BROILMASTER SKFB2 Solid Surface Shelf With Stainless Mounting Bracket](#) [pdf] Owner's Manual

SKFB2 Solid Surface Shelf With Stainless Mounting Bracket, SKFB2, Solid Surface Shelf With Stainless Mounting Bracket, Stainless Mounting Bracket, Mounting Bracket