



BROAN FG7MQ060 Fully Modulating Variable Speed Condensing Owner's Manual

[Home](#) » [Broan](#) » BROAN FG7MQ060 Fully Modulating Variable Speed Condensing Owner's Manual 

Contents

- 1 BROAN FG7MQ060 Fully Modulating Variable Speed Condensing
- 2 Product Information
- 3 Product Usage Instructions
- 4 Fully Modulating
- 5 WARRANTY
- 6 FEATURES and BENEFITS
- 7 DIMENSIONS
- 8 MODEL IDENTIFICATION CODE
- 9 LOCATION OF FURNACE COMPONENTS
- 10 SPECIFICATIONS
- 11 AIRFLOW DATA
- 12 ACCESSORIES
- 13 GENERAL TERMS OF LIMITED WARRANTY
- 14 Documents / Resources
 - 14.1 References
- 15 Related Posts



BROAN FG7MQ060 Fully Modulating Variable Speed Condensing



Product Information

- **Technical Specifications**

- **Model:** FG7MQ
- **Type:** Fully Modulating, Variable Speed, Condensing Upflow/Horizontal Gas Furnaces
- **Induced Draft:** 97.0 AFUE
- **Input:** 60,000 – 120,000 Btuh

- **Features and Benefits**

- Modulating heating operation
- 100% fired and tested
- Best packaging in the industry
- 30-second blower delay
- 30-second post purge
- Hot surface igniter
- Color-coded wire harness
- Flexible category IV venting system

- **High Static Blowers**

- Low Boy Height

- **Tubular primary heat exchanger**

- 90-second fixed cooling cycle blower-off delay (TDR)
- LP convertible
- Diagnostic lights for easy troubleshooting without counting flashes

- Incorporates integrated control board
- Two-piece door design
- Blower Compartment
- Sealed Vestibule
- iQ Drive Thermostat

• Dimensions

- **A:** 22 1/4 inches
- **B:** 28 inches
- **C:** 23 1/2 inches

Location of Furnace Components

Item	Component Name	Specifications
1	FG7MQ Model Numbers	-060D-VB -080D-VC -100D-VC -120D-VD
2	Airflow Data	Gas Input Rate (Btuh): 45,000 Target CFM for Selected Circulating Air Temperature Rises (F): 50: Full – Minimum 55: Full – Minimum 60: Full – Minimum
3	Accessories	Description: FG7MQ Kits SKU: 212D-0509

Product Usage Instructions

• Installation

- Choose a suitable location for the furnace.
- Ensure proper ventilation and clearance around the unit.
- Connect the flexible category IV venting system.
- Follow the wiring diagram to connect the color-coded wire harness.
- Install the furnace in an up-flow or horizontal configuration based on your needs.
- Secure the two-piece door design.

• Operation

- Set the desired temperature on the iQ Drive Thermostat.
- The modulating heating operation will automatically adjust the furnace output to maintain the desired temperature.

• Maintenance

- Regularly clean or replace the air filters to ensure proper airflow.
- Inspect the blower compartment for any debris or obstructions and clean if necessary.
- Check for any signs of wear or damage on the components and replace them as needed.
- Refer to the user manual for detailed maintenance instructions.

• FAQ

- **Q:** Can I convert the furnace to use LP gas?
- **A:** Yes, the FG7MQ model is LP convertible. Refer to the user manual for instructions on how to convert the furnace.
- **Q:** How do I troubleshoot issues with the furnace?
- **A:** The furnace has diagnostic lights that make troubleshooting easy. Refer to the user manual for a guide on interpreting the diagnostic lights.
- **Q:** What is the warranty coverage for this product?
- **A:** The general terms of the limited warranty can be found on our website at www.broanhvac.net.

Fully Modulating

Fully Modulating, Variable Speed, Condensing Upflow/Horizontal Gas Furnaces Induced Draft – 97.0 AFUE Input 60,000 – 120,000 Btuh

The high-efficiency upflow gas furnace may be installed free-standing in a utility room, or basement, or enclosed in an alcove or closet. Upflow/horizontal units come ready for upflow or horizontal application. The extended flush jacket provides a pleasing “appliance appearance.” Design certified by CSA for application in Canada and the United States.

WARRANTY

- 10-year all-parts warranty.
- 10 Year Quality Pledge to replace the unit if the heat exchanger fails within the first 10 years of operation, to the original owner.
- Consumer product registration required for 10 year
- All Parts Warranty and Quality Pledge within a limited period after the installation. See the current warranty document or visit our consumer website listed on the back of this document for warranty details.
- When registered, this product is upgraded to a limited lifetime heat exchanger warranty.

FEATURES and BENEFITS

- **ISEER:** Energy efficient brushless DC (ECM) motor gives up to 1 SEER point efficiency gain in cooling.
- **Modulating heating operation Includes:** Modulating gas valve from 100% to 50% input in 5% increments. Time proportioning modulation down to 15%. Variable speed inducer and blower.
- **100% fired and tested:** All units and each component are tested on the manufacturing line.
- **Best packaging in the industry:** Unique corner post design assures the product will arrive to the homeowner dent-free.
- **30-second blower delay:** At start-up assures a warm duct temperature at furnace start-up. Adjustable blower-off settings (60, 90, 120 and 180 seconds).
- **30-second post purge:** Increases the life of heat exchanger.
- **Color-coded wire harness:** Designed to fit the components, all with quick-connect fittings for ease of service and replacement.
- **Flexible category IV venting system:** May be vertically or horizontally vented using either a one-pipe or two-pipe system for maximum installation flexibility.
- **High Static Blowers:** All models are equipped with high static blowers.

- **Low Boy Height:** Easy to apply in low ceiling applications, works well with taller high SEER coils, easier to handle and install.
- **Tubular primary heat exchanger:** Heavy gauge aluminized steel heat exchanger and stainless steel secondary heat exchanger ensure a long life.
- **90-second fixed cooling cycle blower-off delay (TDR):** increases cooling performance when matched with a NORDYNE coil.
- **LP convertible:** Simple burner orifice change for ease of convertibility.
- **Diagnostic lights for easy troubleshooting without counting flashes:** Dedicated light for flame signal strength and 2 lights in combination to indicate all other fault codes with easy-to-recognize states without counting flashes.
- **Incorporates integrated control board:** with connections for electronic air cleaner and humidifier.
- **Two-piece door design:** Enhances furnace appearance and uses captured screws to prevent losing door screws.
- **Blower Compartment:** Sealed door to reduce air leakage and insulated for ultra-quiet operation.
- **Sealed Vestibule:** Reduces burner and inducer sound levels.
- **iQ Drive Thermostat:** Provides modulation down to 15% and is required for furnace operation.

DIMENSIONS

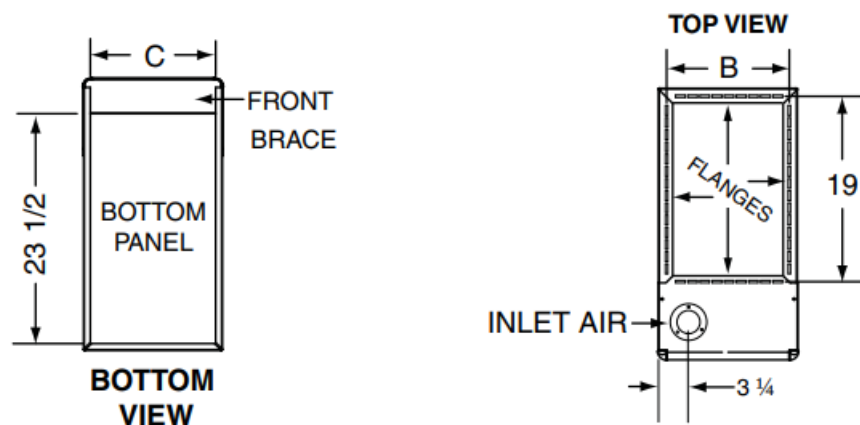

*MQ Model #'s	Dimension "A"	Dimension "B"	Dimension "C"
060\$-6"	$17 \frac{1}{2}$	$15 \frac{7}{8}$	$16 \frac{1}{8}$
080\$-6#	21	$19 \frac{3}{8}$	$19 \frac{5}{8}$
100\$-6#			
120\$-6\$	$24 \frac{1}{2}$	$22 \frac{7}{8}$	$23 \frac{1}{8}$

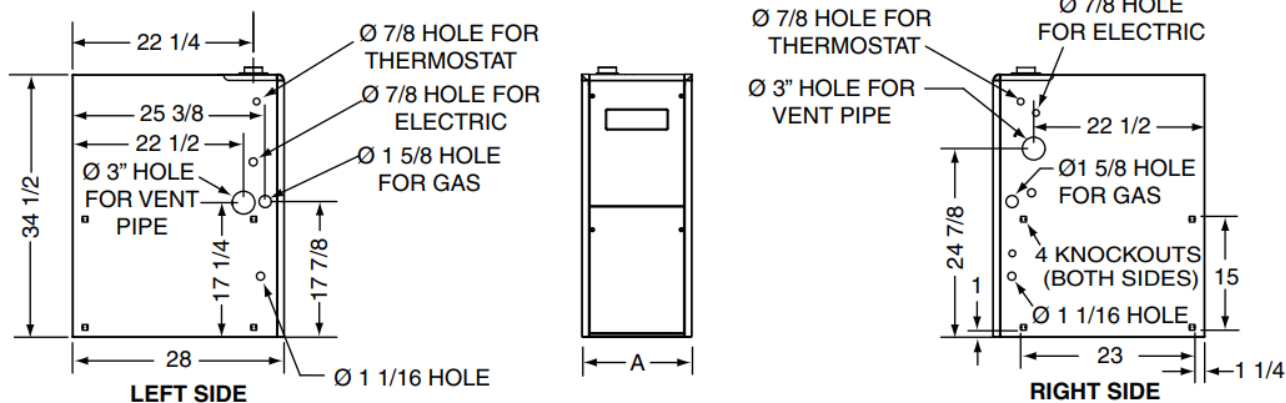

FG7MQ 97+ Modulating Upflow/Horizontal Series

MODEL IDENTIFICATION CODE

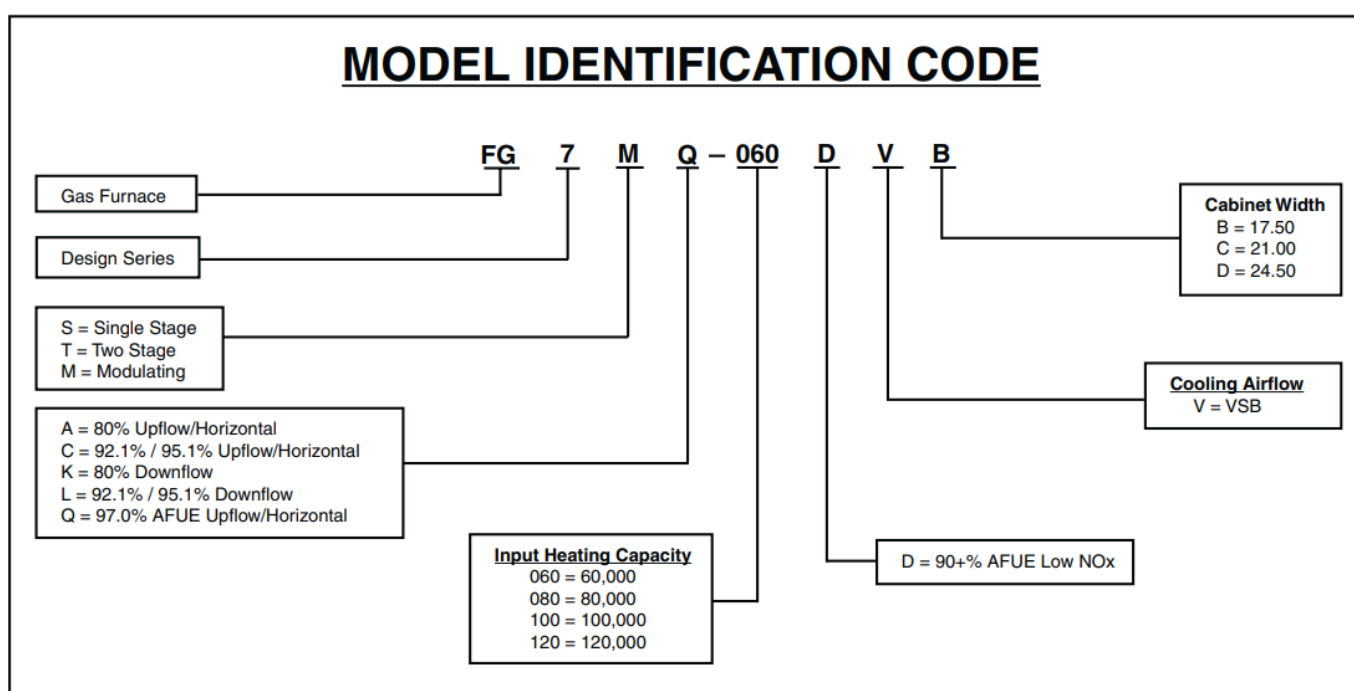

LOCATION OF FURNACE COMPONENTS

ITEM	COMPONENT NAME
1.	"LOWER ISSEMBLY
2.	"LOWER \$OOR 3WITCH
3.	"URNER ISSEMBLY
4.	&INISH &LANGE
5.	&LAME 2OLL-/UT 3WITCH
6.	&LAME 3ENSOR
7.	&URNACE #ONTROL "OARD
8.	'AS -ANIFOLD
9.	'AS 6ALVE
10.)GNITER
11.)NDUCER ISSEMBLY
12.)NDUCER ,IMIT 3WITCH
13.	-OTOR #HOKE (# AND \$ CABINETS ONLY)
14.	-OTOR #ONTROL "OARD
15.	-OTOR #ONTROL "OX
16.	0RESSURE 3WITCHES
17.	4RANSFORMER

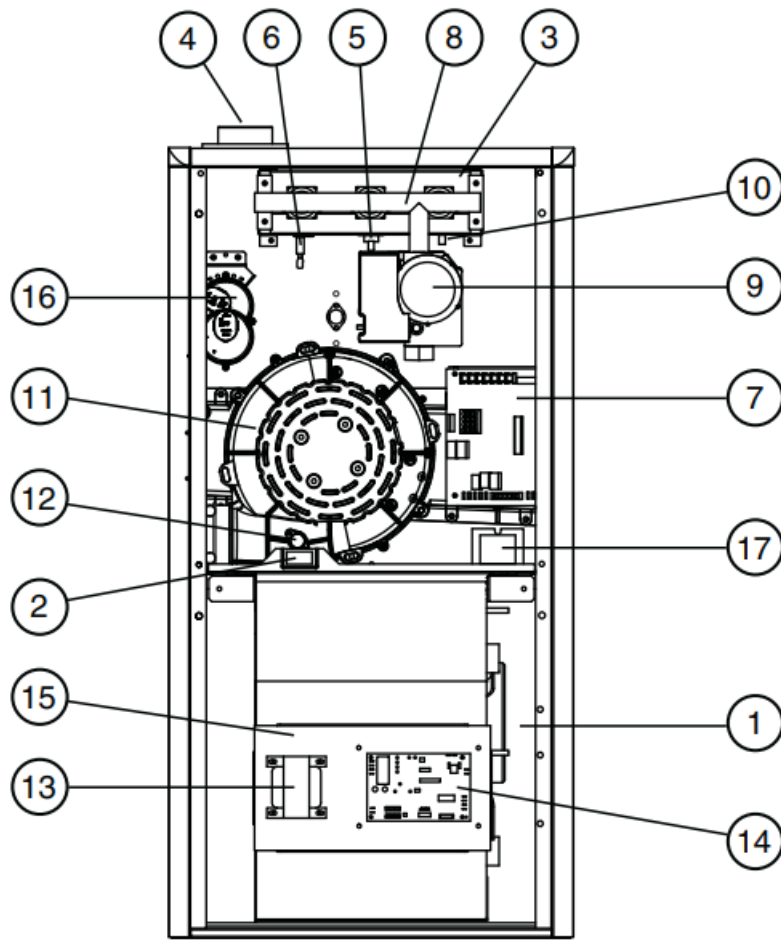

SPECIFICATIONS

FG7MQ MODEL NUMBERS:	-060D-VB	-080D-VC	-100D-VC	-120D-VD
INPUT – “TUH (A)	60,000 / 30,000	80,000 / 40,000	100,000 / 50,000	120,000 / 60,000
EATING #APACITY – “TUH	58,200 / 29,100	77,600 / 38,800	97,000 / 48,500	116,400 / 58,200
AFUE	97.0	97.2	97.4	97.0
“LOWER \$ X 7	11 X 8	11 X 10	11 X 10	11 X 10
-OTOR (.0. – 3PEED – 4YPE	1/2 – 6ARIABLE	3/4 – 6ARIABLE	3/4 – 6ARIABLE	1 – 6ARIABLE
-OTOR &,!	6.2	8.7	8.7	11.70
2ATED %XT. 30 –)N. 7.#.	0.5	0.5	0.5	0.5
4EMPERATURE 2ISE 2ANGE – Ž&	30-60	35-65	35-65	40-70
3HIPPING 7EIGHTS	130LBS	140LBS	150LBS	165LBS

NOTE: All models are 115V, 60 Hz. Gas Connections are 1/2" N.P.T. AFUE = Annual Fuel Utilization Efficiency (a) Ratings to 2,000 ft. Over 2,000 ft. reduce 4% for each 1,000 ft. above sea level.

AIRFLOW DATA

Gas Input Rate (Btu/h)	Target CFM for Selected Circulating Air Temperature Rises, F								
	45		50		55		60		Constant
	Full Input	Minimum Input	Full Input	Minimum Input	Full Input	Minimum Input	Full Input	Minimum Input	
60,000	1,110	635	1,000	560	940	515	850	470	950
80,000	1,480	850	1,345	740	1,255	685	1,140	625	1,300
100,000	1,850	1,050	1,680	925	1,565	855	1,460	780	1,760
120,000	2,225	1,270	2,020	1,115	1,890	1,025	1,730	940	2,100

NOTE: This table lists the High and Low target CMs for each maximum input rate and temperature rise. If the target CFM is more than 1,600 CFM, it is recommended that two return air openings into the furnace be used.

ACCESSORIES

FG7MQ KITS	
Description	SKU
2" #ONCENTRIC VENT KIT	904177
3" #ONCENTRIC VENT KIT	904176
2" 3IDE WALL VENT KIT	904617
3" 3IDE WALL VENT KIT	904347
5.3. ,0 #ONVERSION KIT (0 TO 10,000 FT.) FOR 53 AND #ANADA	904950
"OTTOM RETURN ILTER 20 PER BOX, "" CABINET	904916
"OTTOM RETURN ILTER 20 PER BOX, "# CABINET	904917
"OTTOM RETURN ILTER 20 PER BOX, "\$ CABINET	904918
3IDE RETURN ILTER KIT	541036
.EUTRALIZER KIT	902377

GENERAL TERMS OF LIMITED WARRANTY

- NORDYNE will furnish a replacement for any part of this product that fails in normal use and service within the first ten years of installation, per the terms of the warranty

