



BRITA Filter Purity Remote Display User Manual

[Home](#) » [BRITA](#) » BRITA Filter Purity Remote Display User Manual 



Filter Purity Remote Display User Manual

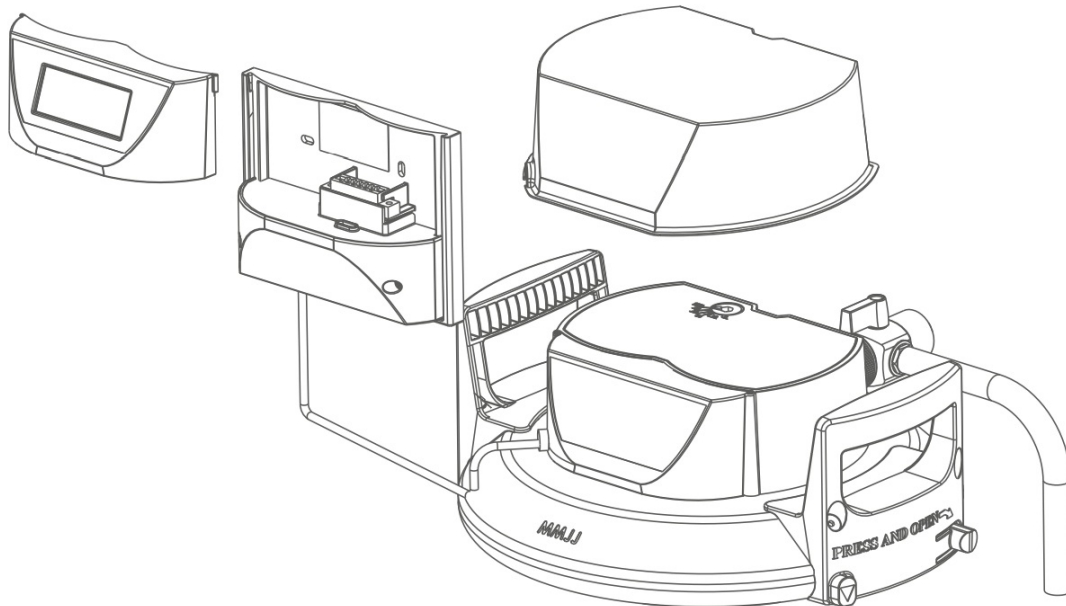

**Remote Display
Handbook
version 03/2023**

Contents

- [1 Filter Purity Remote Display](#)
- [2 Definition of terms](#)
- [3 Conformity declaration](#)
- [4 General information](#)
- [5 Safety notes](#)
- [6 Installation](#)
- [7 Commissioning](#)
- [8 Repair](#)
- [9 Troubleshooting](#)
- [10 Decommissioning](#)
- [11 Technical data](#)
- [12 Order number](#)
- [13 Documents / Resources](#)
 - [13.1 References](#)
- [14 Related Posts](#)

Filter Purity Remote Display

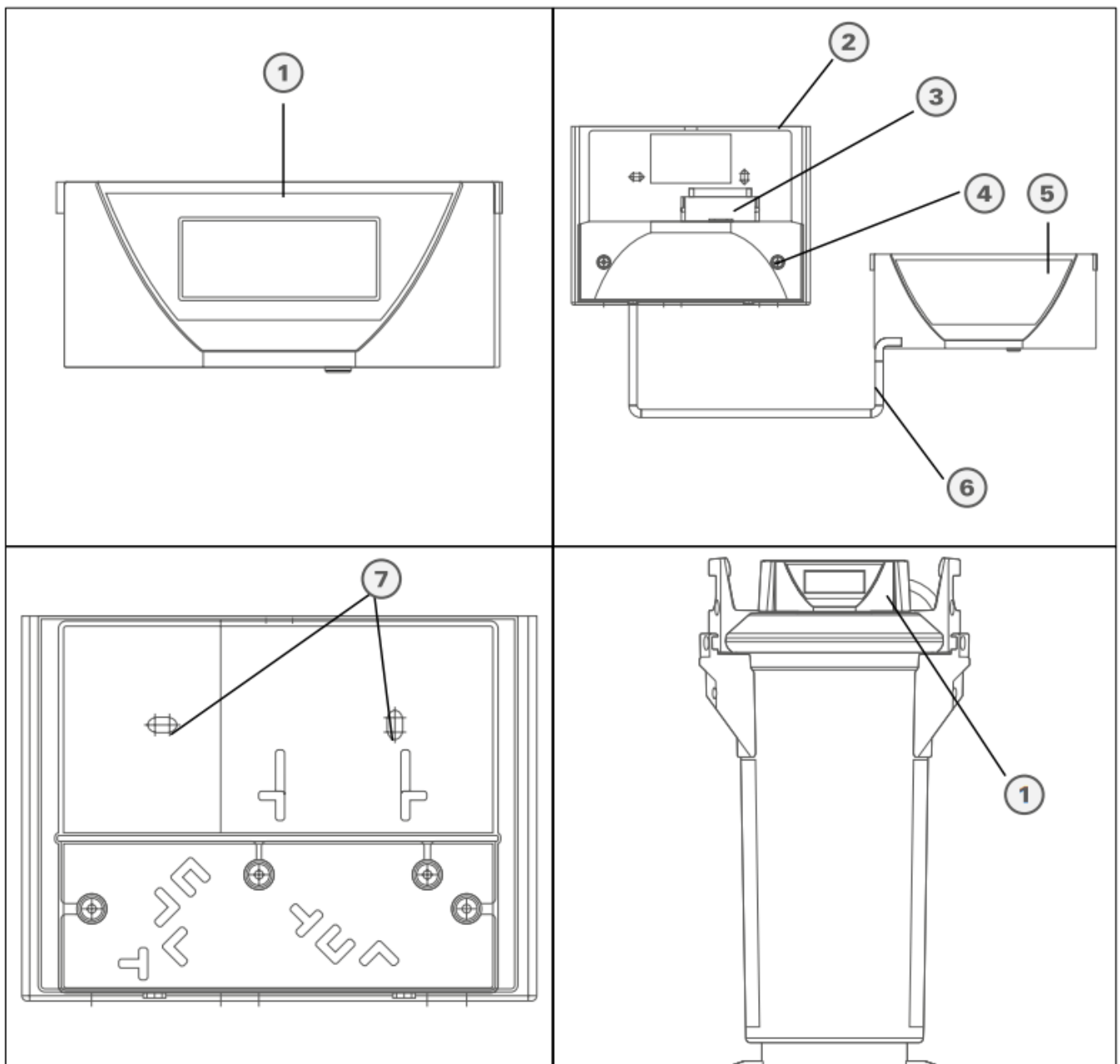

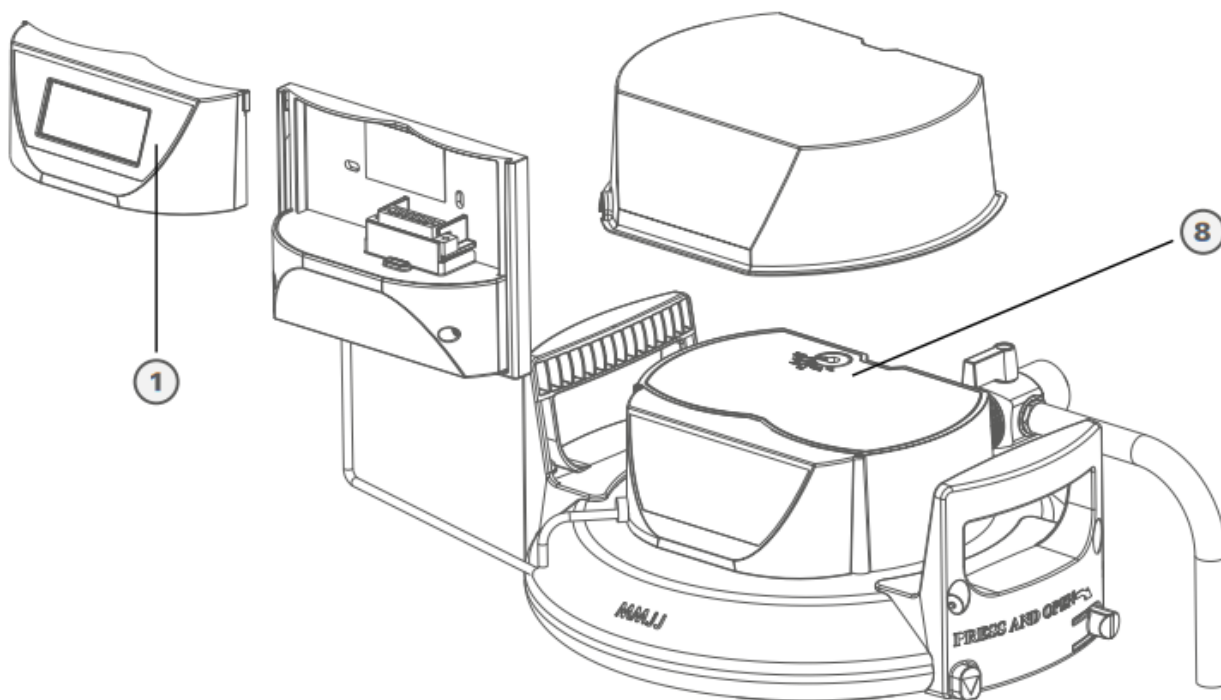

Definition of terms

1. Display Unit
2. Remote Display
3. Terminal Strip
4. Housing Screws
5. Dummy plug
6. Cable PURITY-Remote Display
7. Fixing Hole
8. Connecting fittings

Conformity declaration

The Remote Display complies with the prescribed CE regulations. You can request the Declarations of Conformity needed for this from the responsible BRITA office.

General information

3.1 General function and application

The Remote Display allows the operating parameters of the PURITY filter system to be read at a highly visible range of max. 2 m. The Remote Display has been specifically developed for use with the BRITA PURITY filter system with a measuring and display unit and may only be operated in conjunction with this system. When mounted, the Remote Display is protected against condensation.

Note: All guarantee rights shall become void if the BRITA Remote Display is used with other filter systems.

3.2 Guarantee provisions

The BRITA Remote Display is subject to the statutory guarantee of 2 years. A guarantee claim may only be submitted if all instructions in this Handbook are followed and observed. The sensor housing and the electronics cover in the display unit must never be opened. If this instruction is not observed, all guarantee claims shall become void.

3.3 Storage/Transport

The Remote Display, including all of the parts contained in the packaging, and the Handbook must be kept in a safe, dry place out of the reach of children. Please note the details in the "Technical data" table concerning the ambient conditions and dimensions of the Remote Display during storage or transport. We recommend that you keep the original packaging of the Remote Display for future storage purposes. The handbook should be seen as part of the product and thus kept for the whole service life of the Remote Display and passed on to subsequent owners.

3.4 Recycling/Disposal

By disposing of this product and its packaging in the correct manner you are helping to prevent potential negative impacts on people and the environment that could be caused by incorrect disposal. The display unit, the battery for the display unit and the remote display must not be burnt and must not be disposed of in domestic waste.



Please ensure that these are disposed of correctly, in accordance with local regulations.

Safety notes

This Handbook contains instructions that you must observe for your personal safety and in order to avoid damage to property; if they are contravened, BRITA shall not accept liability for any damage incurred. The instructions are highlighted and printed as follows, depending on the degree of danger:



Caution:

means that damage to property can occur if the relevant precautionary action is not taken.



Note:

is important information about the product, handling the product or the relevant part of the documentation to which particular attention should be drawn.

4.1 Qualified personnel

The installation and maintenance of the appliance may be carried out only by trained or authorised personnel.

4.2 Correct use

The appliance may be installed only for the applications intended in this Handbook. Safe operation of the product is subject to the correct installation, operation and maintenance described in this Manual.

4.3 Liability exclusion

Please install exactly in accordance with the Handbook. BRITA shall not accept liability for any damage, including subsequent damage arising from the incorrect use of the product or inability to use the product, even if BRITA was aware of the possibility of such damage.

4.4 Specific safety information



Caution: Observe the Operating Instructions of the connected BRITA filter system!



Caution: Protect the appliance against sunlight and mechanical damage, do not assemble near sources of heat or naked flames!



Caution: Prior to changing the filter, remove the dummy plug 5 from the filter head in order to prevent damage to the connecting cable and the plug.

4.5 Safety-technical assembly notes



Note: The cable should not be laid parallel to cables conducting electricity and should not be bent.

Installation

5.1 Delivery scope

Prior to installation, remove the entire delivery scope from the packaging and check that everything is there:

1 x Remote Display with dummy plug and cable

1 x Handbook

3 x double-sided adhesive tape

If parts of the delivery scope are missing, please contact your local BRITA office.

5.2 The Remote Display can be installed in 2 ways:

5.2.1 Installation using standard commercial double-sided adhesive tape

- Attach 2 strips of the double-sided adhesive tape to the back of the Remote Display.
- Stick the BRITA Remote Display in the desired position.



Note: The mounting surface must be free from grease, dust and dirt.

- Continue from Section 6.

5.2.2 Installation using screws (Screws are not included in the delivery scope)



Note: For this type of fixing, we recommend two flat-headed screws with a max. shaft diameter of 4 mm.



Caution: Please ensure that there are no water pipes or electrical cables behind the mounting surface.

- Fasten the screws in a way appropriate to the mounting surface.
- Hang the Remote Display on the screws using the fixing holes drilled on the back of the housing.

Commissioning

6.1 Commissioning the Remote Display

The Remote Display can be commissioned only with a PURITY filter system with a measuring and display unit.



Caution: The system may be installed only by trained and authorised personnel (cf. Section 4.1) and the ambient conditions of the “Technical data” section must be observed.



Caution: Make sure that the cables are not bent and that laying does not lead to any risks of tripping.

- Remove the display 1 unit from the PURITY filter system.
- Insert the dummy plug 5 in the connecting fitting 8 of the PURITY filter system.
- Now plug the original display 1 unit on the wall mounting.

6.2 Commissioning exhaustion signal

When the filter is exhausted, the remaining capacity is indicated by a flashing display on the display unit. The exhaustion message appears when there is a remaining capacity of less than 10 % or when the remaining monthly limit is less than one month. **Example:** Prescribed monthly limit 12 months, exhaustion message after 11 months. The monthly limit can be freely selected from 2–12 months (cf. PURITY Handbook). The exhaustion message is displayed until the cartridge is changed.

The remote display also offers the option of picking up the exhaustion signal and, for example, exploiting it in a machine controller.

Doing so ensures that the filter cartridge can be replaced remotely from the installation site in line with capacity levels and schedules.

For more information on this function, please contact your BRITA office.

6.3 Commissioning with a new PURITY filter system and when changing the filter

When installing a new PURITY filter system with a measuring and display unit or during a filter change in conjunction with the Remote Display, please proceed as follows:

- Commission your new PURITY filter system or change the filter taking account of your PURITY Handbook.



Note: During the flushing process, the display unit 1 must have been placed on the base module lid.

- After the flushing and bleeding process, remove the display unit 1 from the connecting fitting 8 .
- Place the dummy plug 5 of the Remote Display 2 on the connecting fitting of the PURITY filter system.
- Place the removed display unit 1 on the Remote Display 2 .

- The system is now ready for operation and you can read the operating parameters on the Remote Display 2. If you want to dispose of the packaging material after installation, please note Section 3.4.

6.4 Commissioning when a PURITY filter system is already installed

If you have a PURITY filter system that has already been commissioned, please proceed as follows:

- Remove the display unit 1 from the PURITY filter system.
- Place the dummy plug 5 of the Remote Display 2 in the connecting fitting 8 of the PURITY filter system.
- Place the removed display unit 1 in the Remote Display 2 .
- The system is now ready for operation and you can read the operating parameters on the Remote Display 2. If you want to dispose of the packaging material after installation, please note Section 3.4.

Repair



Caution: Repair may be carried out only by trained and authorised personnel (cf. Section 4.1).

7.1 Cleaning

Regularly clear the Remote Display 2 of dust and dirt.

- Use a soft, clean and dry cloth for cleaning.



Note: Do not use any abrasive chemicals, cleaning solutions or astringent cleaning agents.

Troubleshooting

8.1 No visible metering function for the water quantity (residual capacity is not updated)

Cause: Faulty plugged connection or hose.

Troubleshooting: Please check that the plugged connections are firm or check the hose for leaks.

Decommissioning

If you want to decommission the appliance, proceed as follows:

- Remove the display unit 1 from the Remote Display 2.
- Remove the dummy plug 5 from your PURITY filter system.
- Place the previously removed display unit 1 on the PURITY filter system.

If you want to dispose of the Remote Display 2 , please note the information on recycling in Section 3.4.

Technical data

Remote Display	138/48/103 mm (L/W/H)
Cable length PURITY- Remote Display	Approx. 2 m
Ambient temperature storage/transport	-20 °C–60 °C
Ambient temperature operation	4 °C–40 °C

Order number

Article	Article number
Remote Display	274100



<p>BRITA SE Heinz-Hankammer-Str. 1 65232 Taunusstein Germany Tel. +49 6128 746-5765 professional@brita.net www.brita.net</p>	<p>BRITA Belux B.V. De Keyserlei 58 2018 Antwerpen Belgium Tel. +31 40 281 39 59 sales.professional@brita.net www.brita.be</p>
<p>BRITA WasserFilter-Systeme AG Gassmatt 6 6025 Neudorf/LU Switzerland Tel. +41 41 932 42 30 info-ppd@brita.net www.brita.ch</p>	<p>BRITA Italia S.r.l. Via Zanica, 19K 24050 Grassobbio (BG) Italy Tel. +39 35 19 96 46 39 Fax +39 35 19 96 22 56 professionalitalia@brita.net www.brita.it</p>

<p>BRITA Water Filter Systems Ltd. Brita House 9 Granville Way Bicester Oxfordshire OX26 4JT United Kingdom Tel. +44 844 742 4990 UK001_clientservices@brita.net www.brita.co.uk</p>	<p>BRITA Iberia, S.L.U. C/ Valencia 307 2º-4ª 08009 Barcelona Spain Tel. +34 93 342 75 70 Fax +34 93 342 75 71 csbrita@brita.net www.brita.es</p>
<p>BRITA France SARL 52 Boulevard de l'Yerres 91030 ÉVRY cedex France Tél. +33 1 69 11 36 40 infopro@brita.net www.brita.fr</p>	<p>BRITA Polska Sp. z o.o. Ołtarzew, ul. Domaniewska 6 05 – 850 Ożarów Mazowiecki Poland Tel. +48 22 721 24 20 Fax +48 22 721 24 49 bok@brita.net www.brita.pl</p>
<p>BRITA Benelux B.V. High Tech Campus 5 5656 AE Eindhoven Netherlands Tel. +31 40 281 39 59 sales.professional@brita.net www.brita.nl</p>	<p>BRITA Nordic A/S Centervej 32 4180 Sorø Denmark Tel. +45 70 27 32 66 britanordic@brita.net www.brita.dk</p>

BRITA Professional



Filter Service App

The new Filter Service App is your ideal assistant. This unique, comprehensive tool helps determine the right type and size of filter for your precise needs. It provides detailed installation guidance for service engineers, calculates when cartridges will need replacing – and has a wealth of other, innovative capabilities.

Download it for free on



or visit <https://professional.brita.net/app>

Information in the instruction for use are subject to change BRITA is a registered trademark of BRITA SE, Germany.



Documents / Resources

	<p>BRITA Filter Purity Remote Display [pdf] User Manual Filter Purity Remote Display, Purity Remote Display, Remote Display, Display</p>
--	--

References

- [BRITA waterfilter | BRITA®](#)
- [BRITA Wasserfilter | BRITA®](#)
- [BRITA water filter | BRITA®](#)
- [BRITA water filter and BRITA water filter systems | BRITA®](#)
- [BRITA filtro de agua | BRITA®](#)
- [BRITA filtre à eau | BRITA®](#)
- [BRITA filtri per l'acqua | BRITA®](#)
- [BRITA water filter | BRITA®](#)
- [BRITA waterfilter | BRITA®](#)
- [BRITA filtr do wody | BRITA®](#)
- [BRITA Professional Filter Service](#)