



## BRISTAN BNA568 Bath Filler and Pop Up Waste with Overflow User Guide

[Home](#) » [BRISTAN](#) » BRISTAN BNA568 Bath Filler and Pop Up Waste with Overflow User Guide 

# BRISTAN

BNA568 Bath Filler and Pop Up Waste with Overflow  
User Guide



**IMPORTANT:** Please keep these instructions for future reference and request of replacement parts

### Introduction

Thank you for choosing Bristan, the UK's leading taps, and showers expert. We have designed this product with your enjoyment in mind. To ensure that it works to its full potential, it needs to be fitted correctly. These fitting instructions have been created to give you all of the information you need and, if you need any further help, please do not hesitate to give us a call on 0330 026 6273.

### Installation

1. Identify all components that are present prior to installation.

2. Fit the waste body (8) and flange (6) to the bath securing using screw (4) and washer (2); ensure sealing washer (7) is placed through the bath before this is done as shown on the diagram. Use a pure Silicon sealant where necessary.
3. Fit the overflow/filler elbow (19) to the bath ensuring overflow washer (18) is in place. Secure to bath using o-ring (21), washer (22), and retaining nut (25). Use a pure Silicon sealant where necessary.
4. Connect flexible tube (16) to the waste body (8) using the plastic nut (14).
5. Connect the overflow elbow (17) to the flexible tube (15).
6. Fit the handle (26 & 27) to the control spindle by pushing on firmly.
7. Connect water supplies to inlets. The elbows (19) are 3/4" BSP. Two flexible connectors are supplied that can be used to connect the elbows to 22mm pipework, depending on the installation. A blanking plug is also supplied to close off one inlet if mixed water is to be connected to the overflow filler.
8. Check all joints and connections for leaks.

Contents:

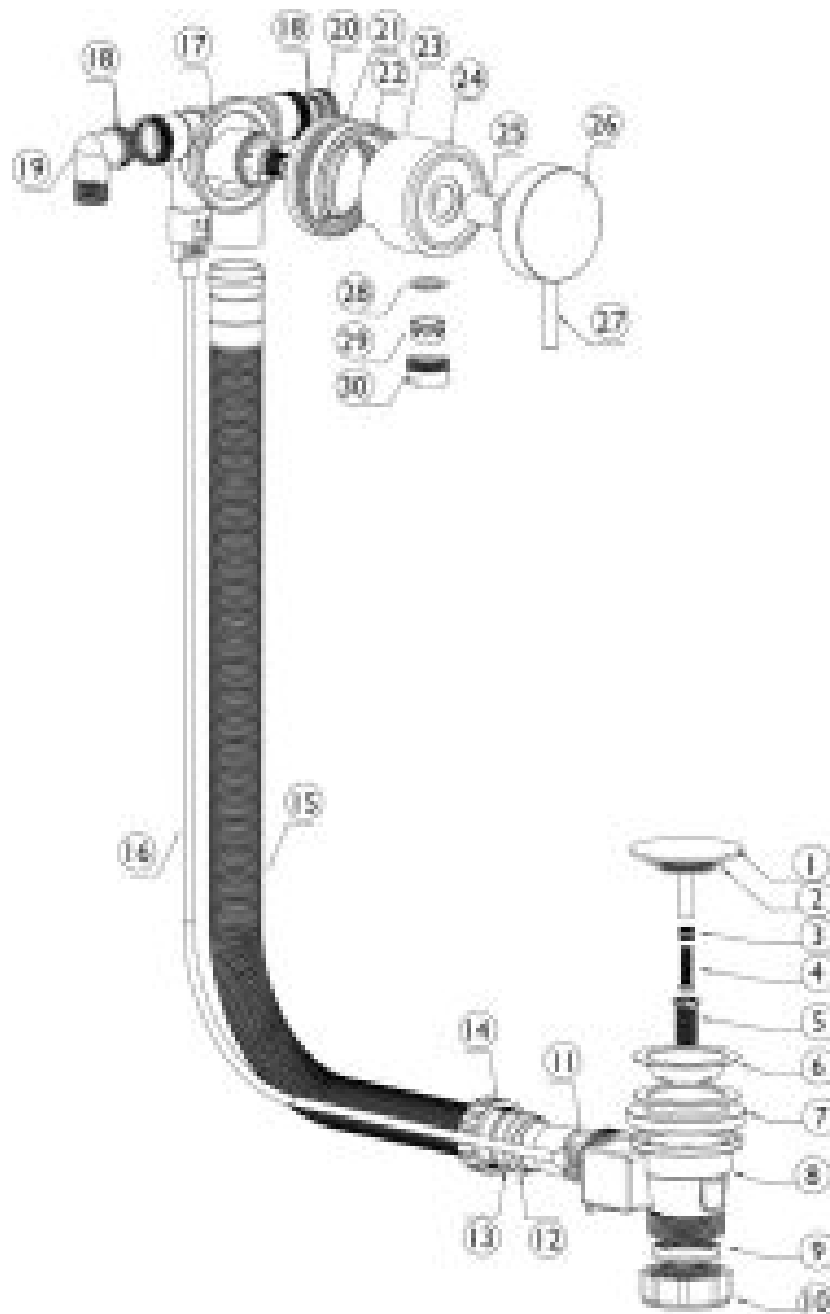

1. Cover	16. Pop-Up Assembly
2. Sealing Washer	17. Overflow Elbow
3. Adjusting Nut	18. O Ring
4. Adjusting Screw	19. Filler Elbow
5. Flange Screw	20. End Stop
6. Flange	21. Rubber Washer
7. Sealing Washer	22. Washer
8. Waste Body	23. Washer
9. Conical Washer	24. Filler Outer
10. Plastic Nut	25. Lock Nut
11. Plastic Bush	26. Handle Cover
12. Conical Washer	27. Handle Lever
13. Plastic Washer	28. Rubber Washer
14. Plastic Nut	29. Bubbler
15. Plastic Tube	30. Outlet Nozzle

## Cleaning & Maintenance

Your fitting has a high-quality finish and should be treated with care to preserve the visible surfaces. All finishes will wear if not cleaned correctly. The only safe way to clean your product is to wipe it with a soft damp cloth. Stains can be removed using washing-up liquid. All bathroom cleaning products (powders and liquids) will damage the surface of your fitting, even the non-scratch cleaners.

**NOTE:-** Never use abrasive detergents or disinfectants or those containing alcohol, hydrochloric, or phosphoric acid.

At Bristan, we want to make things as easy as possible for our customers. That's why we offer solid guarantees on all our products, effective from the date of purchase, to give you peace of mind.

To start your free guarantee, simply scan the QR code and register your product. Alternatively, visit [www.bristan.com/register](http://www.bristan.com/register) to register your product via a computer.



<http://www.bristan.com/register>

For full guarantee terms and conditions visit, [www.bristan.com/guarantees](http://www.bristan.com/guarantees)

*We Know & We Care*

This booklet covers product codes  
W BATH09 C – Chrome  
Helpline  
0330 026 6273  
Bristan Group Limited  
Birch Coppice Business Park, Dordon, Tamworth, Staffordshire B78 1SG  
A Masco Company  
Website: [www.bristan.com](http://www.bristan.com)  
Telephone: 0330 026 6273  
Email: [enquire@bristan.com](mailto:enquire@bristan.com)  
FI ( BATH FILL)  
REV. D4

## Contents

- [1 Documents / Resources](#)
- [2 Related Posts](#)

## Documents / Resources

	<a href="#">BRISTAN BNA568 Bath Filler and Pop Up Waste with Overflow</a> [pdf] User Guide BNA568, Bath Filler and Pop Up Waste with Overflow
--	--