

BRILONER®
BRILONER MAL
7490 LED Table
Lamp Set of

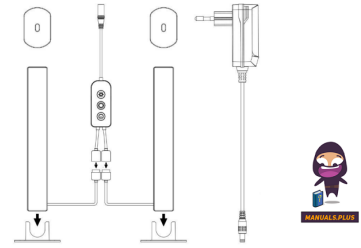

BRILONER MAL 7490 LED Table Lamp Set of 2 Instruction Manual

[Home](#) » [BRILONER](#) » BRILONER MAL 7490 LED Table Lamp Set of 2 Instruction Manual 

Contents

- 1 BRILONER MAL 7490 LED Table Lamp Set of 2
- 2 Product Information
- 3 Frequently Asked Questions
- 4 PROWER
- 5 WiFi Tuya Smart APP
- 6 Mounting instructions
- 7 Safety directions
- 8 Documents / Resources
 - 8.1 References

BRILONER®

BRILONER MAL 7490 LED Table Lamp Set of 2

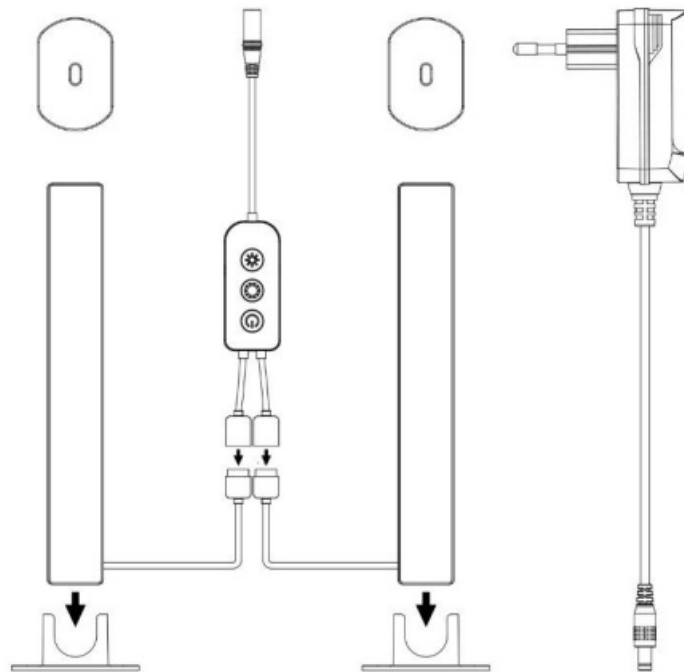

Product Information

Specifications

- Model: MAL7490
- Manufacturer: Briloner Leuchten GmbH & Co. KG
- Protection Class Rating: IP20
- Energy Efficiency Class: G
- Reference Setting: 6500K

Frequently Asked Questions

Is this product suitable for outdoor use?

No, this product is intended for indoor use only in private households.

Can I replace the operating device myself?

Yes, the operating device can be replaced by the end customer.

How do I control the product?

The product can be controlled using the buttons/switches A1/A2/A3 located on the article. Switch A1 controls the light on/off function.

PROWER

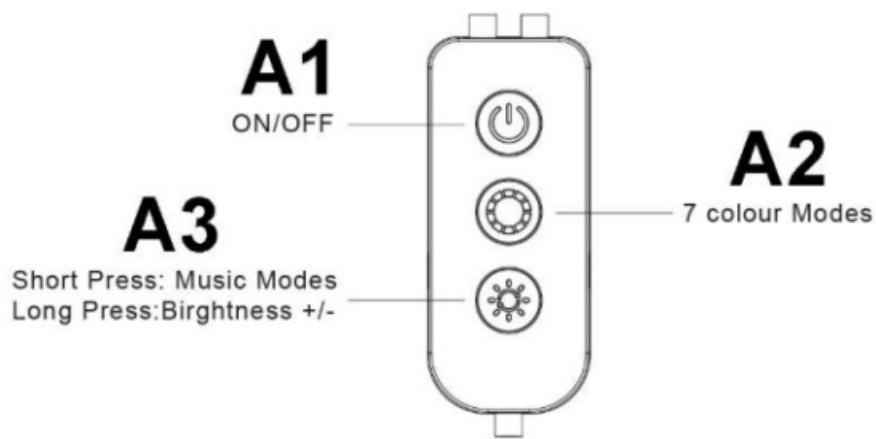

WiFi Tuya Smart APP



Mounting instructions

1. Wall mounting

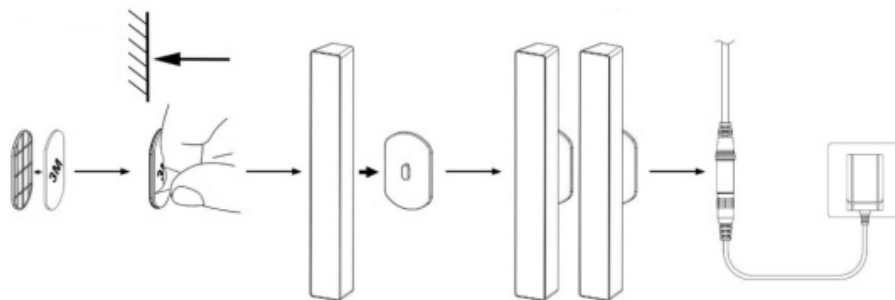

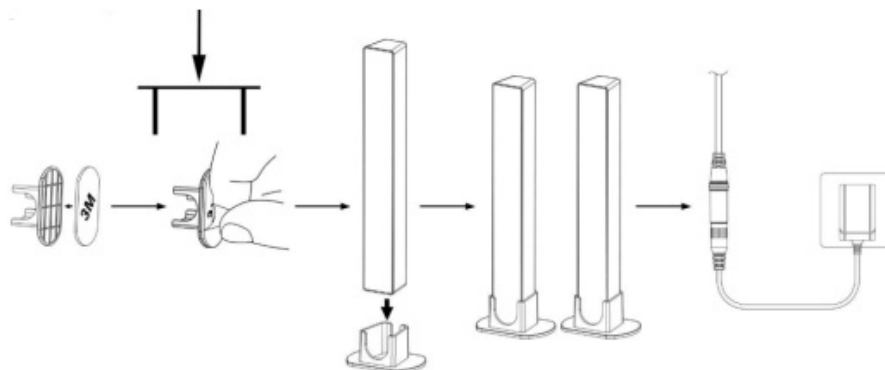

2. Put it on the table



Safety directions

Please read this information carefully before installing or using this product. Please keep this user manual for further reference.

1. The manufacturer does not accept any responsibility for injuries or damage resulting from improper use of the light.
2. Maintenance of the lights is limited to the surfaces. For electrical safety reasons, this product must not be cleaned with water or other liquids. Use only a dry, lint-free cloth for cleaning.
3. Caution! Risk of electric shock. Before connecting to the mains, always check the entire light for possible damage. Never use the light if you notice any damage.
4. Caution! Disconnect the mains cable from the power supply before assembling or disassembling. Switch off the earth leakage circuit breaker/automatic circuit breaker or unscrew the fuse. Turn the switches to "OFF".
5. Caution! Before drilling the mounting holes, make sure that no gas, water or electricity pipes and wires can be drilled through or damaged in your chosen mounting location.
6. When mounting, ensure that the attachment material is suitable for the subsurface and that this surface is capable of carrying the weight of the fixture. The manufacturer is not liable for improper installation of the item on the relevant subsurface.
7. The symbol of the crossed-out garbage can on the product or the packaging means that the product must not be disposed with ordinary household waste. At the end of its useful life, the product must be returned to a point of acceptance for the recycling of electric and electronic device. Please ask your local municipality for the point of acceptance. Disposing of this product in line with local regulations helps to mitigate the effects on the environment and health which might otherwise occur as a result of hazardous substances, combinations or components.
8. Do not install the light on a damp or conductive subsurface. Please make sure that no cables get damaged during the installation work.
9. U Attention! During operation, lamp parts and illuminants can reach temperatures of more than 60°C. Do not touch during operation!
10. Place the lamp on horizontal surfaces only.
11. The lights have a protection class rating of "IP20" and are solely intended for indoor use only of private households.
12. Do not look directly into the light source (illuminant, LED, etc.).
13.  The included or insertable LED light bulb contained in this luminaire shall only be replaced by the manufacturer or his service agent or a similar qualified person.
14.  The operating device (transformer, ballast, control unit, etc.) can be replaced by the end customer.
15. This product contains a light source of energy efficiency class "G", based on the EU regulation 2019/2015. Reference setting: "6500K".
16. LED colour deviation when using different chargers may occur. The light colour and luminous strength of the LED's can also change as a result of life span level from the lamp.
17. This article is not suitable for use with dimmable electric circuits. It can be controlled using the button/switch "A1" / A2 / A3" on the article.
18. The switch "A1" switches the light on or off.
19. Repeated activation of the "A2" button switches on a succession of "7" preset colour LED's.
20. Briefly pressing the "A3" button switches on the following function: Select sound effects.
21. Pressing down on the "A3" button will dynamically brighten or dim the light.
22. "Briloner Leuchten" hereby declares that the radio equipment type "7490" complies with the directive "2014/53/EU". The complete text of the EU Declaration of Conformity is available at the following web address:
<https://www.briloner.com/eu-konformitaetserklaerung>

23. This product works with an operating frequency of “2,4 GHz” and a transmission power of “max. 16,5 dBm”.
24. This article is not suitable for use with dimmable electric circuits. It can be controlled using a smartphone with WiFi /WLAN connection.
25. The relevant app: “Tuya Smart“ is available for this purpose. This can be downloaded for Apple products in the App Store and for Android products in the Play Store. As a first-time user, you must register and create a new account. If you already have an account, log in with your access data. The article must be in learning mode (as a rule the delivery standard) in order to register the article in the “Tuya Smart“App. The article can also be manually set for learning mode in order to register the article in the “Tuya Smart“App.
The learning procedure for WiFi modules connected by plug connectors between transformer and lighting fixture is started (before the module) by “3x“disconnecting the plug connector several times. This applies only for versions without a cord switch. The learning mode is indicated by continual blinking of the article.
26. After registration of the article in the “Tuya Smart“App the article is then controllable and ready for operation using compatible speech-controlled systems“(Amazon Alexa / Google Home)“. The skill required for “(Amazon Alexa / Google Home)“with the “Tuya Smart“designation then needs to be activated in the App.
27. This light fixture has a 2.4 GHz Bluetooth interface. To use this function, the light fixture must be connected to the local WiFi network in the “Tuya Smart“ app. The Bluetooth interface is only enabled in the event of network errors and is considered a backup function. It is typically not enabled and can only be used in a network (WiFi) outage when the light fixture is consequently offline. Disabling the WiFi network on a mobile phone or tablet will not suffice to enable the function. Only individual lights can be controlled in Bluetooth mode.
28. This LED product may only be operated with the enclosed power supply unit or control gear.
29. To assemble the components with adhesive surfaces, remove the protection foil on the rear side and press the component firmly on the intended position. Make sure that the assembly location is clean, dry and free of grease.

Documents / Resources

	<p>BRILONER MAL 7490 LED Table Lamp Set of 2 [pdf] Instruction Manual MAL 7490 LED Table Lamp Set of 2, MAL 7490, LED Table Lamp Set of 2, Table Lamp Set of 2</p>
---	--

References

- [User Manual](#)

[Manuals+.](#) [Privacy Policy](#)

This website is an independent publication and is neither affiliated with nor endorsed by any of the trademark owners. The “Bluetooth®” word mark and logos are registered trademarks owned by Bluetooth SIG, Inc. The “Wi-Fi®” word mark and logos are registered trademarks owned by the Wi-Fi Alliance. Any use of these marks on this website does not imply any affiliation with or endorsement.