

Breezary Ceiling Fan with Light User Manual

Contents

1 INSTALLATION & USER MANUAL

1.1 CEILING FAN WITH LIGHT

1.2 Safety Information

1.3 Dimension Reference

1.4 Hardware Included

1.5 Fan Parts Included

1.6 Exploded review

1.7 Installation Instructions

1.7.1 Step1 MOUNTING

1.7.2 Step 2 INSTALL MOUNTING BRACKET

1.7.3 Step 3 ELECTRICAL CONNECTION

1.7.4 Step 4 ENGAGE HEMISPHERE

1.8 Troubleshooting Guide

2 Documents / Resources

2.1 References

3 Related Posts

INSTALLATION & USER MANUAL

CEILING FAN WITH LIGHT

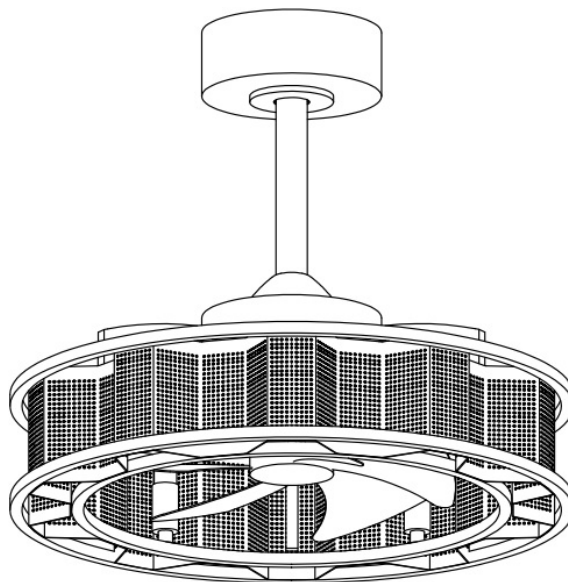

Customer Service: support@breezary.com

Safety Information

READ AND SAVE THESE INSTRUCTIONS.

1. To reduce the risk of electric shock, ensure electricity has been turned off at the circuit breaker or fuse box before you begin.
2. All wiring must be in accordance with the National Electrical Code “ANSI/NFPA 70” and local electrical codes. Electrical installation should be operated qualified licensed electrician.
3. The outlet box and support structure must be securely mounted and capable of reliably supporting a minimum of 35 lbs (15.9 kg). Use only UL Listed outlet boxes marked ” Acceptable for Fan Support of 35 lbs. (15.9 kg) or less. “
4. Do not place objects in the path of the blades.
5. To clean the fixture, turn off the power, wait for it to cool, and wipe the fixture with a dry soft cloth.
6. After making electrical connections, spliced conductors should be turned upward and pushed carefully up into the outlet box. The wires should be spread apart with the grounded conductor and the equipment grounding conductor on one side of the outlet box and ungrounded conductor on the other side of the outlet box.
7. All setscrews must be checked and retightened where necessary before installation.



WARNING: To reduce the risk of electrical shock or fire, not use this fan with any solid-state fan speed control device. It will permanently damage the electronic circuitry.



WARNING: To reduce the risk of personal injury, do not bend the blade brackets when installing the rackets balancing the blades.



WARNING: To reduce the risk of fire, electric shock or personal injury, mount to outlet box marked “acceptable for fan support of 35 lbs. (15.9 Kg) or less” and use screws provided with the outlet box.



WARNING: To avoid possible electrical shock, turn the electricity off at the main fuse box before wiring.



WARNING: To reduce the risk of electrical shock, this must be installed with an isolating wall control / switch.



CAUTION: To reduce the risk of personal injury, use only the screws provided with the outlet box.



CAUTION: Please use carefully when working around or cleaning the fan to avoid injury or damage of fan.



CAUTION: The fan must be mounted with a minimum of 7 ft (2.1 m) clearance from the trailing edge of the blades to the floor.



CAUTION: Changes or modifications not expressly approved by the party responsible for compliance could void the user’s authority to operate the equipment.

Dimension Reference

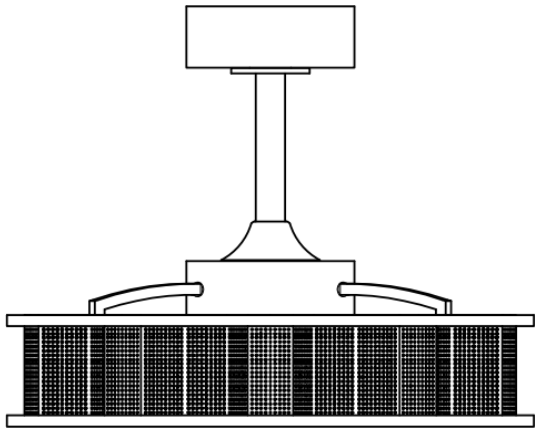

Hardware Included

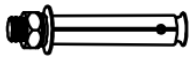

Expansion Screw 2pcs

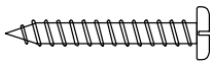

Wood Screw 4pcs



Wire Nut 3PCS



Flat washer 4pcs

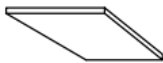

Balanced patch 1pcs

Fan Parts Included

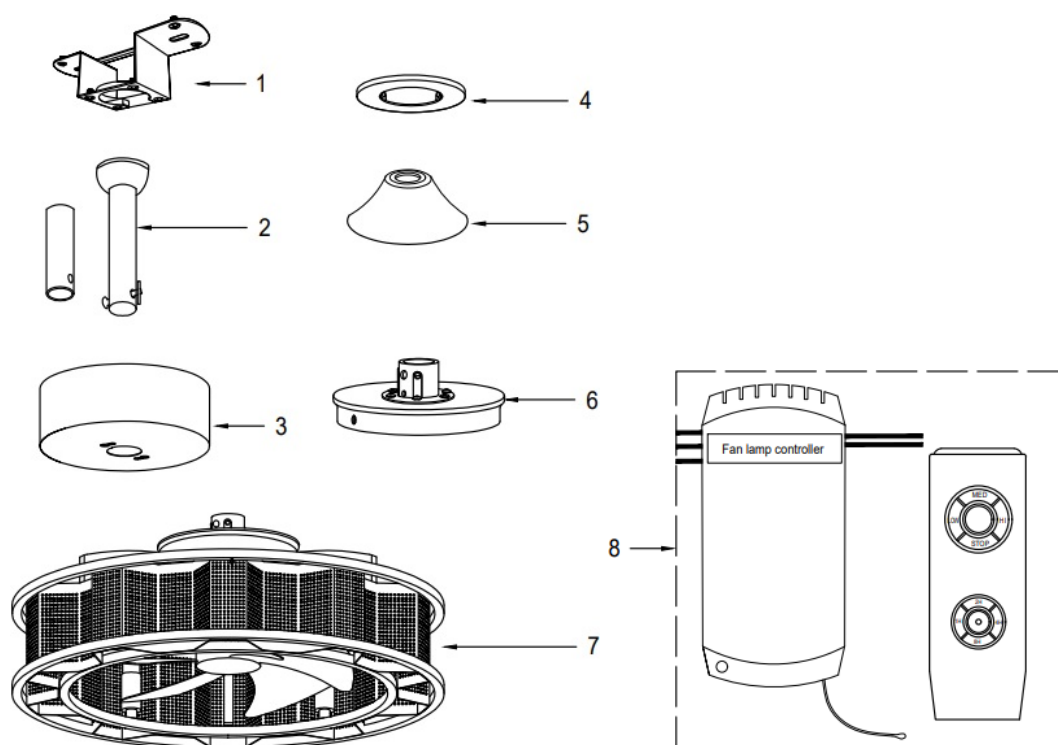

	Quantity
1. Mounting Bracket	1
2. Down Rod	1+1
3. Canopy	1
4. Canopy Cover	1
5. Metal Cover	1
6. Lamp Drum Cover	1
7. Lamp Body	1
8. Remote Control (Batteries Not Included)	1

Exploded review

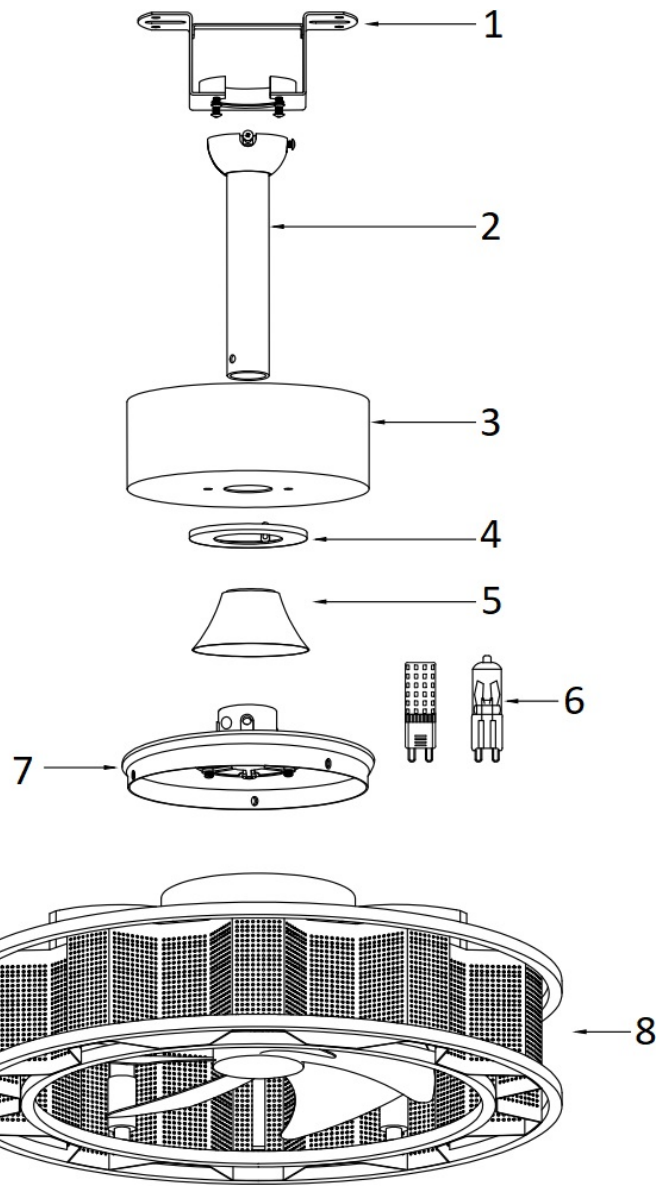

1. Mounting Bracket
2. Downrod
3. Canopy
4. Canopy Cover
5. Metal Cover
6. Choose one from two for g9 light sources G9 Base Bulbs (not included)
7. Lamp Drum Cover
8. Lamp Body



NOTE:

The illustration shown is not scale or its actual con guration may vary. Product/parts are subject to change with out notice.

Installation Instructions

- Take out fan motor housing.
- Align the lamp drum cover with the hole position on the motor and tighten it with screws. (Fig.1a)
- Remove cotter pin and bolt from yoke. (Fig.1b)
- Loosen jam screw in yoke until it is flush with the inside surface. (Fig.1c)
- Insert the down rod into the connection of the lamp body and lock the bolt with a cotter pin. (Fig.1d)
- Route wires exiting the motor through the yoke cover, canopy, and down rod. (Fig.1e)
- Insert bolt through the hole in and down rod. Be careful not to damage or cut the fan wires. (Fig.1f)
- Secure the down rod in position by tightening the jam screws. The side yoke cover is down and it will flush with the motor housing.



Warning:

For your safety, please turn off the power of the fuse box or circuit breaker before all your actions.

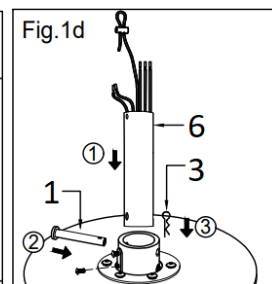
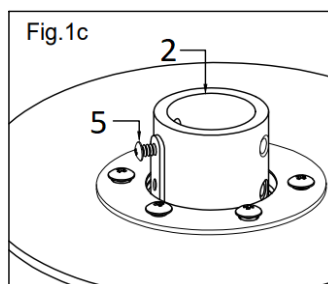
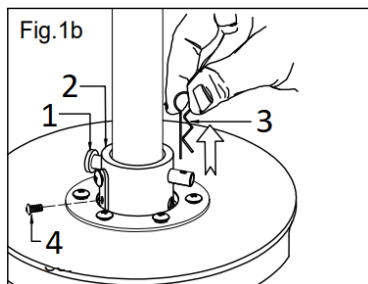
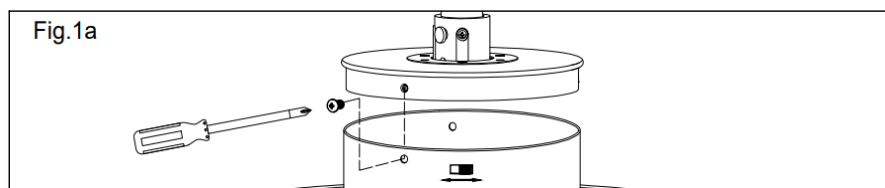

1. Bolt
2. Yoke
3. Cotter Pin
4. Down Rod Setscrew
5. Jam Screw
6. Down Rod

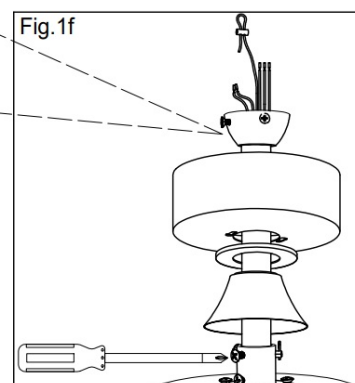
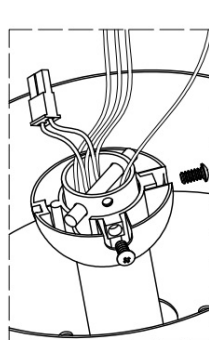
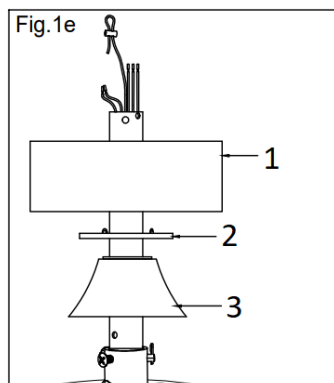

1. Canopy
2. Canopy Cover

3. Metal Cover

Step 2 INSTALL MOUNTING BRACKET

- Attach the J-hook through the center of the outlet box and to the ceiling joist. (Fig.2a)
- Attach the mounting bracket and rubber spacer to the metal outlet box. (Fig.2b)

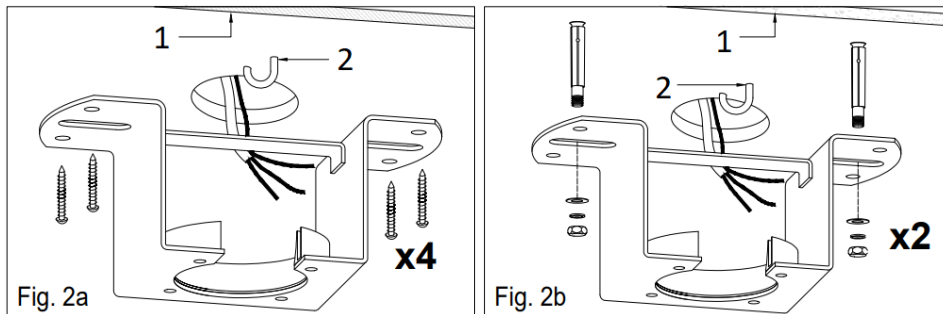

1. Ceiling
2. J-Hook

- Hang the safety cable on the J-hook.(Fig.2c)

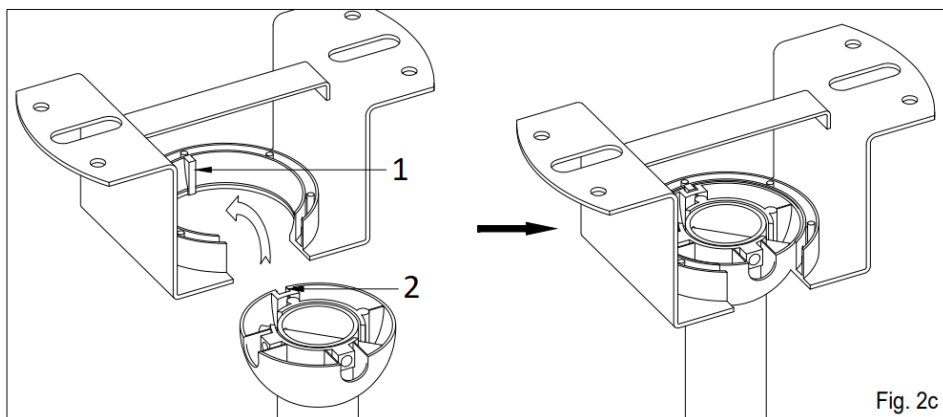

1. Seat Tab
2. Groove Could

WARNING : Failure to seat tab in groove could cause damage to electrical wires and possible shock or fire hazard.

- Hang the safety cable onto the J-hook.

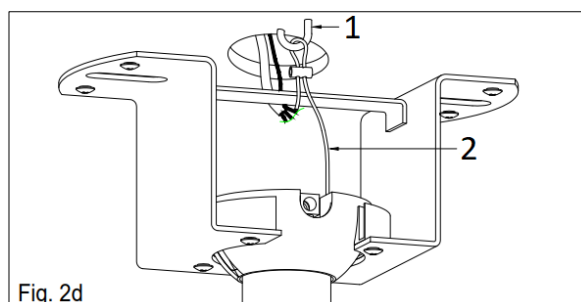

1. J-Hook
2. Safety Cable

Step 3 ELECTRICAL CONNECTION

Use wire connectors to connect household supply and receiver wires according to the diagram and the following steps:

- Connect the white wire with the “Public Zero Line” label to the white fan wire.
- Connect the black wire with the “TO Motor L” label to the black fan wire.
- Connect the blue wire with the “For Light L” label to the blue fan wire.
- Connect the green wire from the down rod and mounting bracket to the Bare / Green(ground) supply wire.
- Connect the blue wire with the “AC IN L” label to the black supply wire.
- Connect the white wire with the “AC IN N” label to the white supply wire.

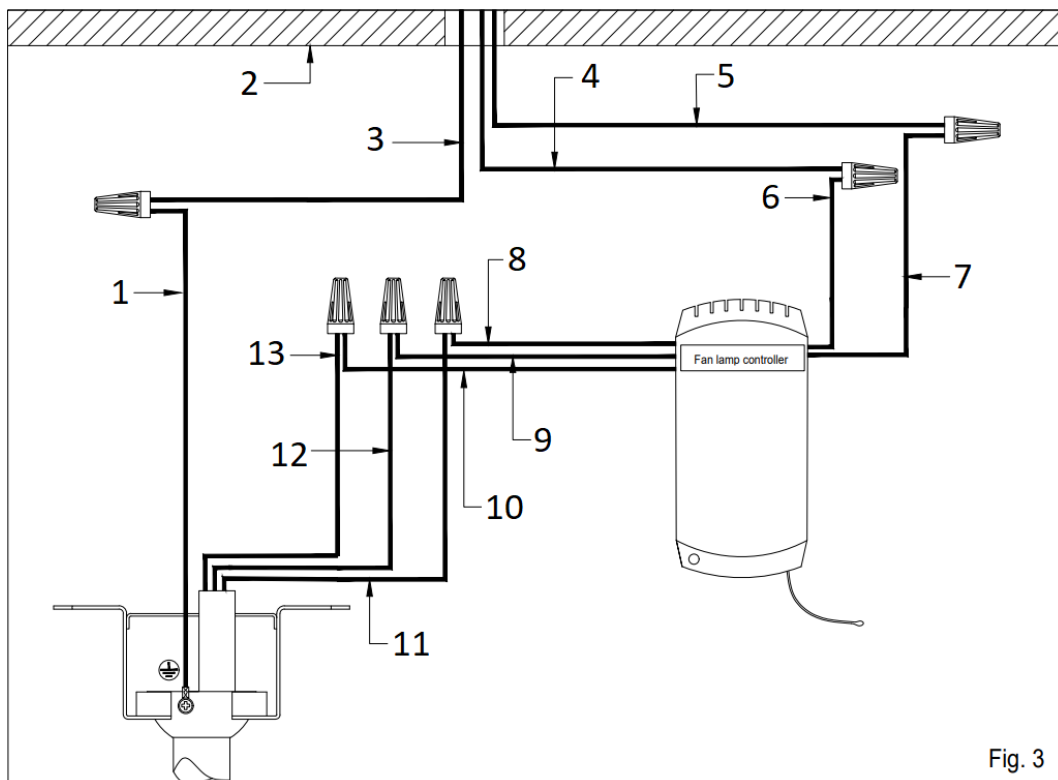

Fig. 3

1. Green Wire
2. Ceiling
3. Ground Wire
4. Zero Wire
5. Fire Wire
6. AC IN N
(White)
7. AC IN L
(Blue)
8. Public Zero Line
(White)
9. TO Motor L
(Black Wire)
10. For Light L

(Blue Wire)

11. White Wire

12. Black Wire

13. Blue Wire

FUNCTION INSTRUCTION OF EMITTER

Learning code and matching mode is used between the emitter and receiver.

- Open the battery cover on the hand-held remote and install a battery, pair of AAA of emitter (1.5V) that are not included.
- If the emitter can not control the fan, learning code matching mode is used between the emitter and receiver.
- When the emitter cannot control the receiver, please check whether the battery switch touching normally or not, and correct the positive and negative. full or empty of power.
- When the emitter cannot control the receiver, please check if is there any existence of similar remote-controlled products nearby, then check whether they work, because a remote-controlled products with the same frequency will disturb each other.
- Please take out the battery from the emitter when left unused for a long time.
- When installing the fan, the fan ceiling cover doesn't press the antenna(or other wire). It is easy to break down the wire and short-circuited.
- This product has a good pairing code before they go out, if need to match, please click the following method to match: Power on the black receiver while holding down the remote "MED" and "LOW" buttons for 3 seconds to 5 seconds, and hear "di" di" sounds, with success.

(1) Speed Controller

(2) light On/off

(3) Fan Off

(4) Timer

(5) Battery AAA (1.5V) pair (Not included)

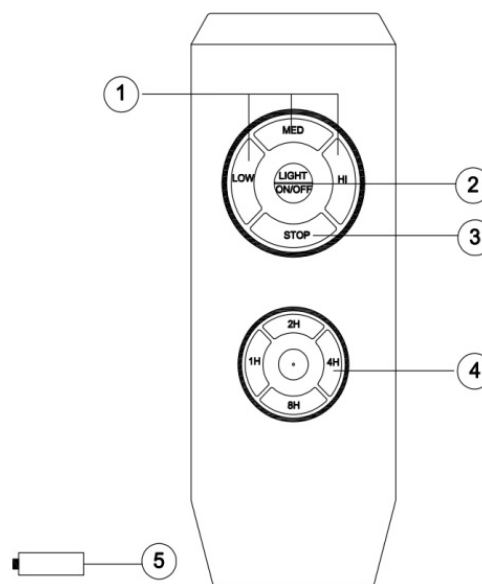

Step 4 ENGAGE HEMISPHERE

– After wiring finished, leave the receiver in the bracket and secure it the the electrical tape then secure the canopy to the bracket.

Push all connected wires up into ceiling box.

When installing the canopy, ensure the antenna is not pressed by the canopy.

Ensure to connect all ground wires accordingly.

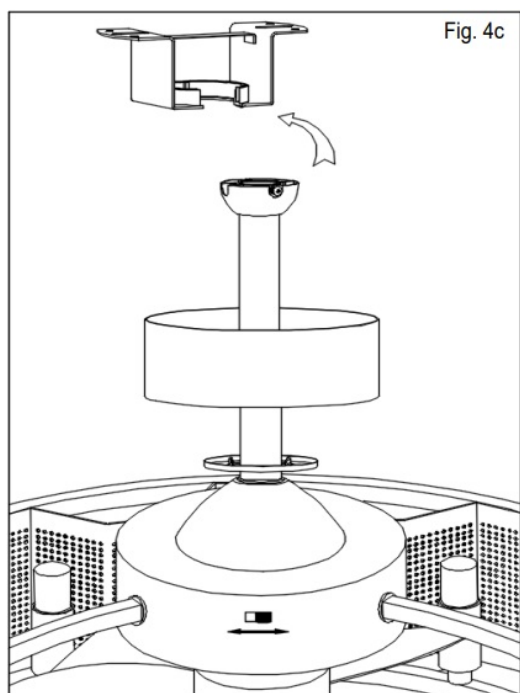

Fig. 4c

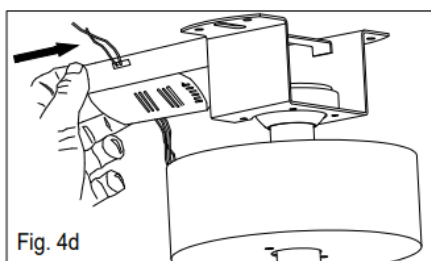

Fig. 4d

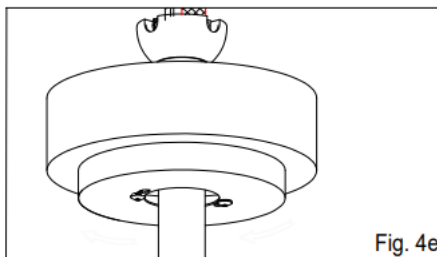

Fig. 4e

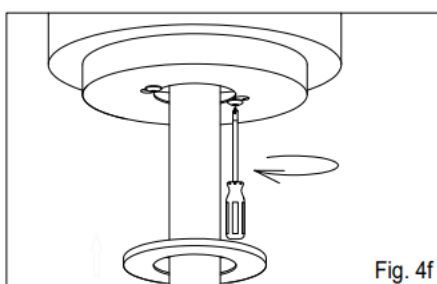

Fig. 4f

OPERATING YOUR FAN

Turn on the power and check the operation of the fan. The included remote controls the fan speed as follows: HI-High, MED-Medium, LOW-Low, STOP-Off

The appropriate speed settings for warm or cool weather depends on factors such as the room size, ceiling height, and number of fans.

The slide switch (XX) controls the direction of the blades: forward (switch down) or reverse(switch up).

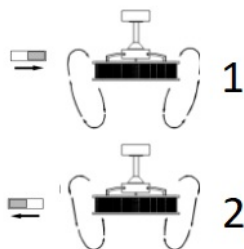
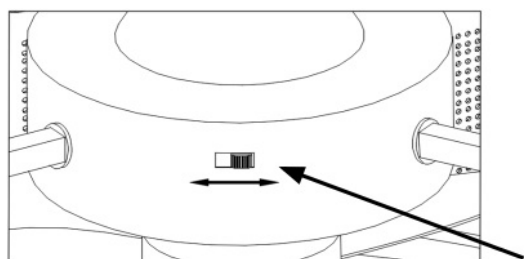

1. (Clockwise)
2. (Counterclockwise)



NOTE: Wait for the fan to stop before reversing the direction of the blade rotation

A. Clockwise, to push a breeze downward and make the room feel cooler.

B. Counterclockwise, to circulate warm air evenly and make a room more comfortable.

Troubleshooting Guide

If you have difficulty operating your new ceiling fan it may be the result of incorrect assembly, installation, or wiring. In some cases these installation errors may be mistaken for defects. If you experience any faults please check this troubleshooting guide.

	P r o b l e m	Suggested Remedy
1	If fan does not work	<ul style="list-style-type: none">• Check the main and branch circuit fuses or breakers.• Check the line wire connections to the fan and switch wire connections in the switch housing.• Check the battery in the remote control. Ensure you are in the normal range of 10-20 feet.
2	If fan sounds noisy.	<ul style="list-style-type: none">• Ensure all motor housing screws are snug.• Ensure the screws that attach the fan blade bracket to the motor hub are tight.• Ensure the wire nut connections are not rattling against each other or the interior wall of the switch housing.• Allow a 24-hour “breaking in” period. Most noises associated with a new fan disappear during this time.• If you are using the ceiling fan light kit, ensure the screws securing the glassware are tight. check that the light bulbs are also secure.• Ensure the canopy is a short distance from the ceiling. It should not touch the ceiling.• Ensure your outlet box is secure and rubber is orator pads were used between the mounting plate and outlet box.

3	If fan wobble exists.	<ul style="list-style-type: none"> • Check that all blades are screwed firmly into blade holders. • Check that all blade holders are tightened securely to motor. • Make sure that canopy and mounting bracket are tightened securely to ceiling junction box and junction box is mounted firmly to ceiling joist. • Most fan wobble problems are caused when blade levels are unequal. Check this level by selecting a point on the ceiling above the tip of one of the blades keeping measure within 1/8 in. Rotate the fan until the next blade is positioned for measurement. Repeat for each blade. If all blade levels are not equal you can adjust blade levels by the following procedure. To adjust a blade tip down insert a washer (not supplied) between the blade and blade holder at the screw closest to the motor. To adjust a blade tip up insert washer (not supplied) between the blade and blade holder at the two screws farthest the motor. • If blade wobble is still noticeable interchanging two adjacent (side by side) blades can redistribute the weight and possibly result in smoother operation.
4	If light does not work.	<ul style="list-style-type: none"> • Check blue wire from fan to make sure it is connected to hot wire from the house. • Check for loose or disconnected wires in fan switch housing. • Check for loose or disconnected wires in light kit. • Check for faulty light bulbs. CAUTION: Make sure main power is turned off before entering switch housing. • If the fan light shuts off shortly after being switched on it may be due to excessive current demand. Turn off power to the fan and replace the light bulbs with lower wattage bulbs. Turn on power to the fan using the pull chain, wall switch, or remote control (whichever is installed on the particular fan).

Documents / Resources

	<p>Breezary Ceiling Fan with Light [pdf] User Manual Ceiling Fan with Light, Ceiling, Fan with Light, Light</p>
---	---

References

-  [Breezary Ceiling Fan - Online Ceiling Fan Store](#)