



Contents [[hide](#)]

- [1 BRC Solar V1 BRConnect Gateway](#)
- [2 SAFETY INSTRUCTIONS](#)
- [3 PRODUCT OVERVIEW](#)
- [4 INTENDED USE](#)
- [5 LED OVERVIEW](#)
- [6 INSTALLATION](#)
- [7 POWER MANAGER APP](#)
- [8 OPERATION AND MAINTENANCE](#)
- [9 REPLACEMENT AND REPAIR](#)
- [10 FAQs](#)
- [11 Can I open the housing of the BRConnect myself?](#)
 - [11.1 Documents / Resources](#)
 - [11.1.1 References](#)



BRC Solar V1 BRConnect Gateway



Specifications

- WLAN-Standard: WiFi 4; 802.11n
- WLAN-Frequency Range: 2.4 GHz

Product Overview

A) Assembly

The BRConnect includes components such as an LED, a 24V DC connection, a reset button, a LAN Ethernet socket, and cable bushings for strings 1, 2, and 3.

B) Intended Use

The BRConnect is designed for specific technical use following the manufacturer's instructions. Any deviation from the intended use is considered improper and may void the warranty.

Safety Instructions

Follow all safety instructions provided by BRC Solar GmbH. Do not attempt to open the housing of the BRConnect. Keep the instruction manual accessible for all activities related to the product.

Required Tools & Accessories

- Hammer
- Drill
- Pencil
- Torx T20 screwdriver
- Spirit level
- Ethernet cable
- 230V socket

Installation Steps

1. Mount the BRConnect using the wall mount provided.
2. Connect the power supply to the BRConnect.
3. Route cables through the appropriate cable bushings as per the string connections.
4. Ensure proper alignment and secure installation.

Troubleshooting

If you encounter any issues during installation or operation, refer to the troubleshooting section of the instruction manual or contact customer support.

SCOPE OF DELIVERY

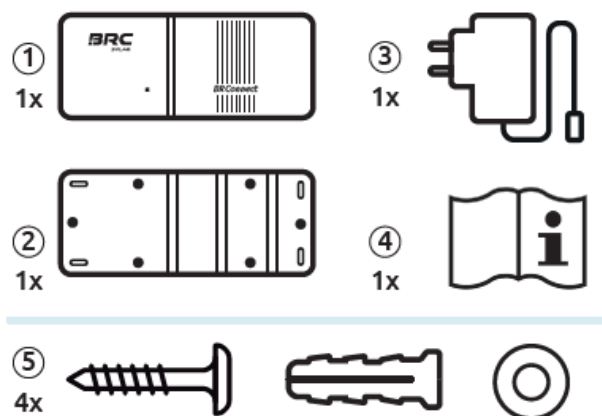

1. BRConnect
2. Wall mount
3. Power supply
4. Instruction manual
5. Mounting kit

Required tools

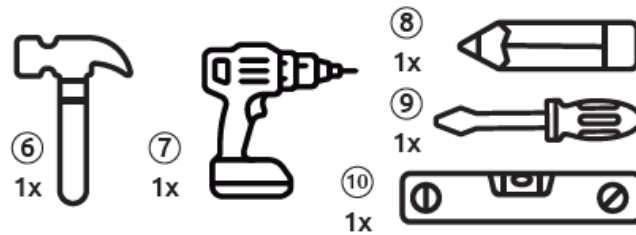

- Hammer
- Drill
- Pencil
- Torx T20 screwdriver
- Spirit level
- Ethernet cable
- 230V socket

Operating accessories



WEBSITE WWW.BRC-SOLAR.DE



SAFETY INSTRUCTIONS

A) GENERAL

- The BRCConnect may only be operated in accordance with the intended use and the specified technical data.
- Please note all instructions from BRC Solar GmbH given in the instruction manual, as well as the warning notices on the BRCConnect. The warning notices on the BRCConnect must always be clearly legible and must not be removed, changed, or manipulated.

- Applicable local laws, regulations, directives, and standards must be given priority for operation, installation, uninstallation, and maintenance. The safety instructions in the instruction manual are not complete and only serve as supplementary information.

B) ELECTRICAL SPECIALISTS

- All work related to the product may only be carried out by qualified electricians. The electrician must comply with national and regional regulations.
- Please read and follow all instructions carefully before installation. If there are any uncertainties or you need detailed information, call our service hotline.
- Electrical work may only be carried out in compliance with the 5 safety rules of electrical engineering. Only install an intact BRConnect with a complete scope of delivery. Only use the accessories included in the delivery, especially the power supply.
- Do not make any modifications to the BRConnect.
- Pay particular attention to running voltage-free string cables through the BRConnect during assembly to prevent electric shocks.

C) END USER

- Under no circumstances should you carry out any work on the BRConnect yourself.
- Do not open the housing.
- Please keep the instruction manual so that it is available for all activities related to the product.

PRODUCT OVERVIEW

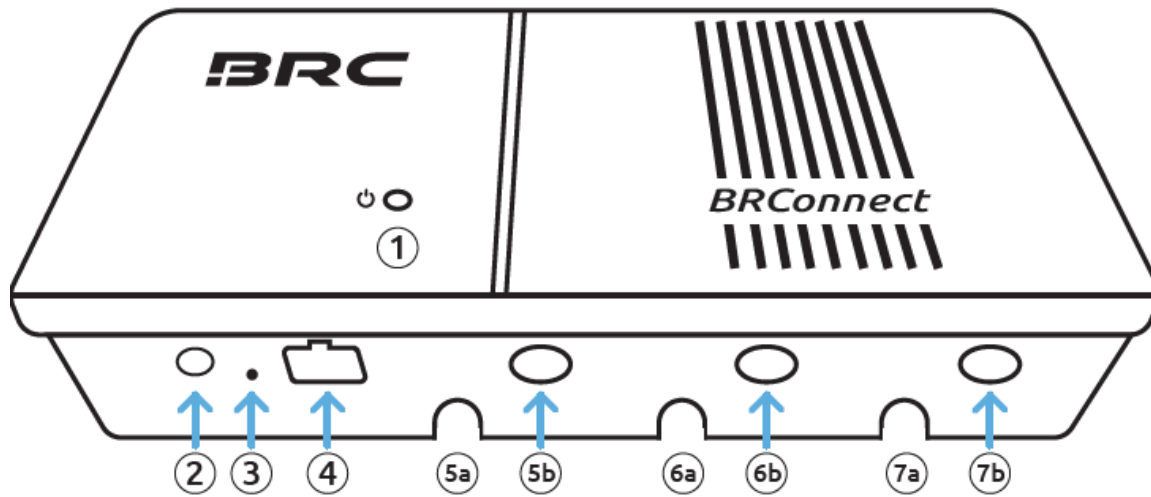

1. LED / LED
2. 24V DC connection
3. reset button
4. LAN Ethernet socket
5. cable bushing of string 1
 - S1- string –
 - S1+ string +
6. cable bushing of string 2
 - S2- string –
 - S2+ string +
7. cable bushing of string 3
 - S3- string
 - S3+ string +

INTENDED USE

- The BRConnect is a gateway that, in combination with the M600-M and the BRC Power Manager, is used for data monitoring of the photovoltaic system at the module level. Data from the
- M600-M is communicated to the BRConnect using powerline communication via DC cables and processed there. The end user can view this data via the BRC Power Manager App, making it possible to monitor the photovoltaic system.
- In order to use the product as intended, a fixed installation is required, which must be carried out by a qualified electrician in accordance with the explanations under point 4.
- When setting up the BRConnect, please ensure compliance with the specified





technical data. Pay particular attention to the following information:

- The BRConnect is rated protection class IP40 and is therefore intended for indoor use. Please keep the device away from liquids, humidity, and heat sources, as well as direct sunlight. The product is designed for operation at ambient temperatures of – 20°C to + 55°C.
- The product is only approved for operation up to 2,000m above sea level.
- The BRConnect has Ethernet and WiFi interfaces to provide the data to the BRC Power Manager.

WiFi standard	WiFi 4; 802.11n
WiFi frequency range	2.4 GHz

- If the use deviates from the use explained here, this is considered improper use. The manufacturer assumes no liability for damage caused by improper use. The information in the limited product warranty applies (<https://brc-solar.de/downloads/>).

LED OVERVIEW

LED Signal / LED signal	/ Explanation
 no light	BRConnect has no power supply or is defective, check power supply . Otherwise contact support hotline.
 lights up blue	Visible immediately after starting (approx. 7-8 sec), then switches to Bluetooth connection mode and can be seen again as normal state after successful setup via Power Manager App.
 slowly flashes blue	Waiting for Bluetooth connection with mobile phone/tablet. Open Power Manager App, follow the app instructions (see page 8) up to step 6. Now the search for BRConnect is running = flashing frequency 1 second on, 1 second off.
 lights up green	Bluetooth connection with mobile phone/tablet established. Set string information in Power Manager App. Enter the IP address and WiFi settings via the Power Manager App or plug in the Ethernet cable.
 slowly flashes green	Establishing connection to local network (no action necessary, check local network connection if the status persists) = flashing frequency 1 second on, 1 second off.
 quickly flashes green	Network connection active , establishing connection to cloud (no action necessary, check internet connection if the status persists) = flashing frequency 200ms on, 200ms off.
 lights up yellow	Warning , functionality limited, please disconnect BRConnect from the power supply and reconnect it to restart. If the signal persists, please contact support.
 lights up red	Error , BRConnect may be defective. Please disconnect BRConnect from the power supply and reconnect it to restart. If the signal persists, please contact support.

INSTALLATION

1. Attach the wall mount: Mark the position with a pencil and spirit level, drill 4 holes (size 6mm,) and sink

4 dowel pins, mount the wall mount with 4 screws, washers, and a screwdriver.

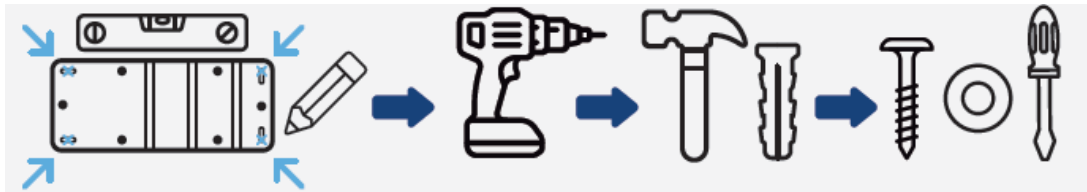

2. Clip BRConnect onto the designated pins of the wall mount: To do this, press evenly on both sides until you hear a click.

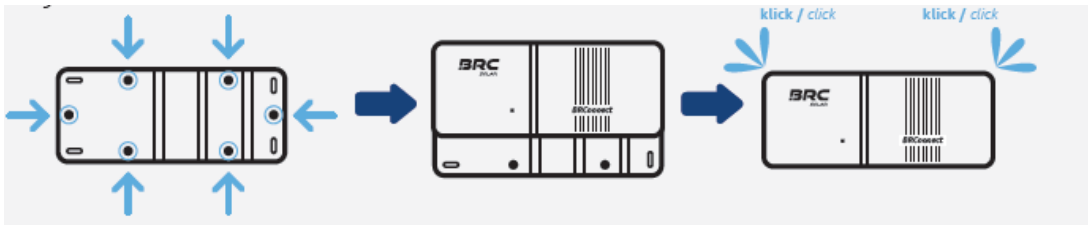

3. Pass the string cable through the cable bushing: Make sure that the string cable is voltage-free when passing through.

Pay attention to the correct connection arrangement of the string cables; otherwise, errors or inoperability may occur. Note the sticker on the top and peel it off.

Connect the string cable to the inverter with the DC-switch off: Pay attention to the correct polarity.

Connect the string cable to the PV system, then switch on the DC side of the inverter.

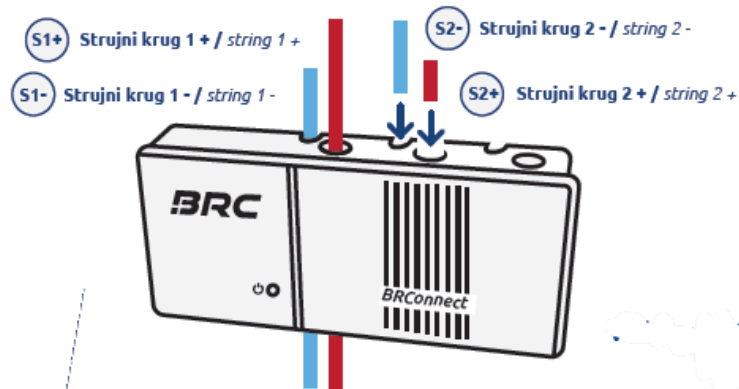

4. Connect 24V and Ethernet: BRConnect LED lights up briefly in blue, then flashes slowly in blue and waits for Bluetooth connection.

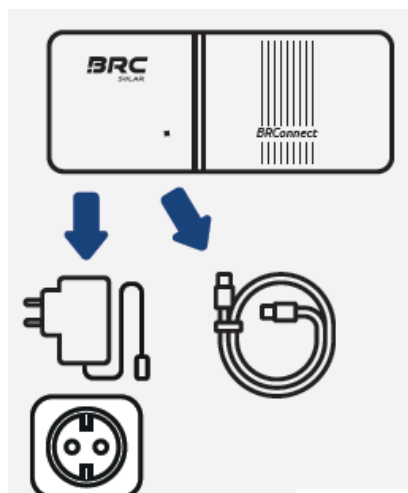

POWER MANAGER APP

1. install App: Available on App Store and Play Store.
2. Register, log in, and click the plus symbol to set up a new plant. An internet connection is required for this.
3. Fill in the general information and the owner information.
4. Enter solar module and inverter data and select whether a battery storage or a wallbox is integrated.
5. Select Start configuration to continue the setup, or Save & configure later.

The screenshot displays the 'Anlagen' (Plants) setup screen in the Power Manager App. At the top, there's a header with the title 'Anlagen' and a plus icon. Below this, there are four icons: a funnel, a refresh symbol, a magnifying glass, and a plus sign. The main content area is divided into several sections:

- Allgemeine Angaben** (General Information): Fields for 'Anlagenname*' (Plant Name), 'Alias Name*', and 'Straße*' (Address).
- Eigentümer der Anlage** (Owner of the Plant): A section with a checkmark indicating 'Eigentümer hat der Datenschutzerklärung zugestimmt*' (Owner has agreed to the privacy policy). It includes fields for 'Auftragsnummer' (Order number) and 'E-Mail'.
- Komponenten** (Components): A section with two sub-sections:
 - Solarmodul** (Solar Module): Fields for 'Hersteller*' (Manufacturer) and 'Typ*' (Type).
 - Wechselrichter** (Inverter): Fields for 'Hersteller*' (Manufacturer) and 'Typ*' (Type).
- Batteriespeicher** (Battery Storage): A section with a toggle for 'Ist ein Batteriespeicher vorhanden?' (Is a battery storage present?). It includes fields for 'Hersteller*' (Manufacturer), 'Typ*' (Type), and 'Kapazität in kWh' (Capacity in kWh).
- Wallbox**: A section with a toggle for 'Ist eine Wallbox vorhanden?' (Is a wallbox present?).

At the bottom, there's a confirmation screen asking 'Möchtest du die Anlage sofort in Betrieb nehmen?' (Do you want to start the plant immediately?). It has two buttons: 'In Betrieb nehmen' (Start) and 'Speichern & Später einrichten' (Save & Configure later).

The optimizers must already be installed, and the BRConnect must be powered for further setup.



6. BRConnect automatically waits for a Bluetooth connection after starting. Select the BRConnect via the app and connect.
7. Enter how many optimizers (M600-M) are connected per string.
8. Connect the BRConnect to the internet via WiFi or Ethernet. The app will then search for the available optimizers.
9. Create a string plan using drag & drop and place the optimizers.
10. Successful completion of the setup.

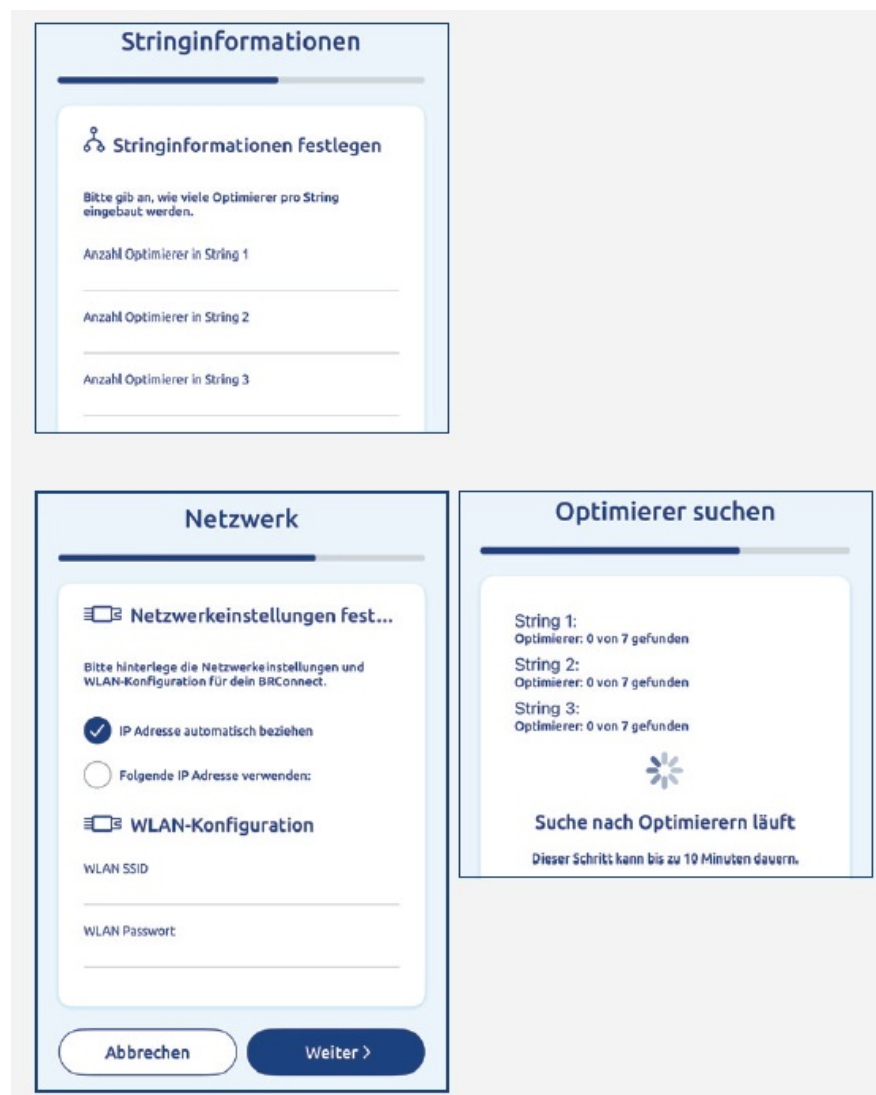



OPERATION AND MAINTENANCE

Only clean the BRConnect with a dry, lint-free cloth. Do not use cleaning agents or solvents. The BRConnect is maintenance-free. If a problem persists, contact support.

REPLACEMENT AND REPAIR

The steps for dismantling the BRConnect must be carried out in the reverse order of installation

- Switch off the DC side of the inverter.
- Ensure that the string cables are voltage-free.
- Remove the power supply to disconnect the BRConnect from the circuit. Remove the Ethernet cable.
- Release the string cables from the cable bushings.
- Dismount the BRConnect by evenly removing it straight from the wall mount.

Repairs must not be carried out.

DISPOSAL

- The transport packaging can be recycled through local waste disposal.
- After use, the BRConnect and all associated components are to be disposed of as electronic waste in accordance with the laws applicable in the country.

PRODUCT COMPLIANCE AND CONTACT

- BRC Solar GmbH, located at Gehrstraße 7 in D-76275 Ettlingen, Germany, declares that the product BRConnect complies with the basic requirements of the national directives if the installation instructions are observed and the product is used as intended. A complete declaration of conformity can be found on the website.

(www.brc-solar.de)Off BRC Solar GmbH.



www.brc-solar.de

FAQs



Can I open the housing of the BRConnect myself?

No, under no circumstances should you attempt to open the housing of the BRConnect. Contact qualified personnel for any maintenance needs.

What should I do if I deviate from the intended use of the BRConnect?

Any deviation from the intended use is considered improper and may void the warranty. Contact customer support for guidance on alternative use cases.

Documents / Resources

	BRC Solar V1 BRConnect Gateway [pdf] Instructions V1 BRConnect Gateway, V1, BRConnect Gateway, Gateway
	BRC Solar V1 BRConnect Gateway [pdf] User Manual V1 BRConnect Gateway, V1, BRConnect Gateway, Gateway

References

- [User Manual](#)

 BRC
SOLAR

 BRC SOLAR, BRConnect Gateway, gateway, V1, V1 BRConnect
Gateway

Leave a comment

Your email address will not be published. Required fields are marked *

Comment *

Name

Email

Website

☐ Save my name, email, and website in this browser for the next time I comment.

Post Comment

Search:

Search

[Manuals+](#) | [Upload](#) | [Deep Search](#) | [Privacy Policy](#) | [@manuals.plus](#) | [YouTube](#)

This website is an independent publication and is neither affiliated with nor endorsed by any of the trademark owners. The "Bluetooth®" word mark and logos are registered trademarks owned by Bluetooth SIG, Inc. The "Wi-Fi®" word mark and logos are registered trademarks owned by the Wi-Fi Alliance. Any use of these marks on this website does not imply any affiliation with or endorsement.