



Contents [[hide](#)]

- [1 BRC Solar B154B RConnect Gateway](#)
- [2 SCOPE OF DELIVERY](#)
- [3 SAFETY INSTRUCTIONS](#)
- [4 PRODUCT OVERVIEW](#)
- [5 INSTALLATION](#)
- [6 POWER MANAGER APP](#)
- [7 OPERATION AND MAINTENANCE](#)
- [8 Documents / Resources](#)
 - [8.1 References](#)



BRC Solar B154B RConnect Gateway



SCOPE OF DELIVERY

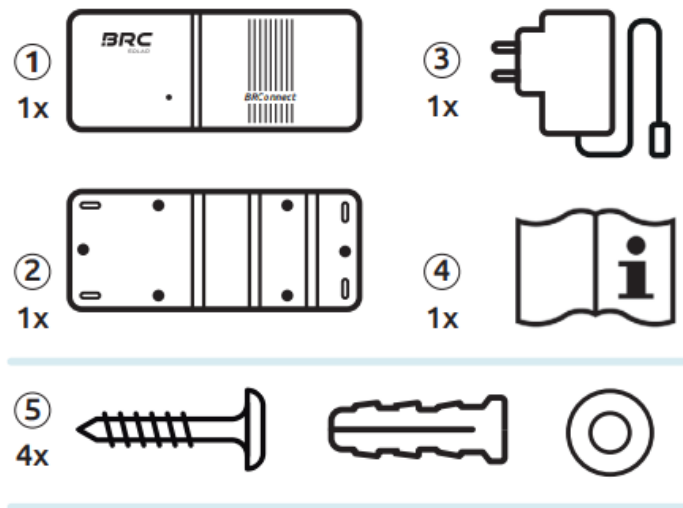

Scope of supply

1. BRConnect
2. Wall mount
3. Power supply
4. Instruction manual
5. Mounting kit

Required tools

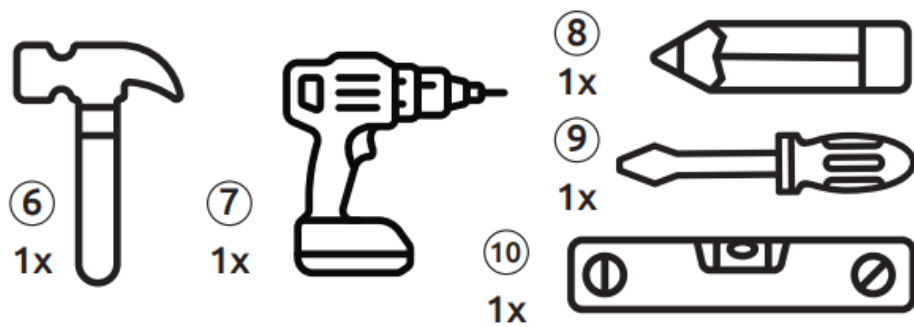

Operating accessories



6. Hammer
7. Drill
8. Pencil
9. Torx T20 screwdriver,
10. Spirit level

11. Ethernet cable

12. 230V socket

SAFETY INSTRUCTIONS

GENERAL

- The BRConnect may only be operated in accordance with the intended use and the specified technical data.
- Please note all instructions from BRC Solar GmbH given in the instruction manual, as well as the warning notices on the BRConnect. The warning notices on the BRConnect must always be clearly legible and must not be removed, changed, or manipulated.
- Applicable local laws, regulations, directives, and standards must be given priority for operation, installation, uninstallation, and maintenance. The safety instructions in the instruction manual are not complete and only serve as supplementary information.

ELECTRICAL SPECIALISTS

- All work related to the product may only be carried out by qualified electricians. The electrician must comply with national and regional regulations.
- Please read and follow all instructions carefully before installation. If there are any uncertainties or you need detailed information, call our service hotline.
- Electrical work may only be carried out in compliance with the 5 safety rules of electrical engineering.
- Only install an intact BRConnect with a complete scope of delivery. Only use the accessories included in the delivery – especially with regard to the power supply.
- Do not make any modifications to the BRConnect. Pay particular attention to running voltage-free string cables through the BRConnect during assembly to prevent electric shocks.

END USER

- Under no circumstances should you carry out any work on the BRConnect yourself.
- Do not open the housing.

- Please keep the instruction manual so that it is available for all activities related to the product.

PRODUCT OVERVIEW

ASSEMBLY

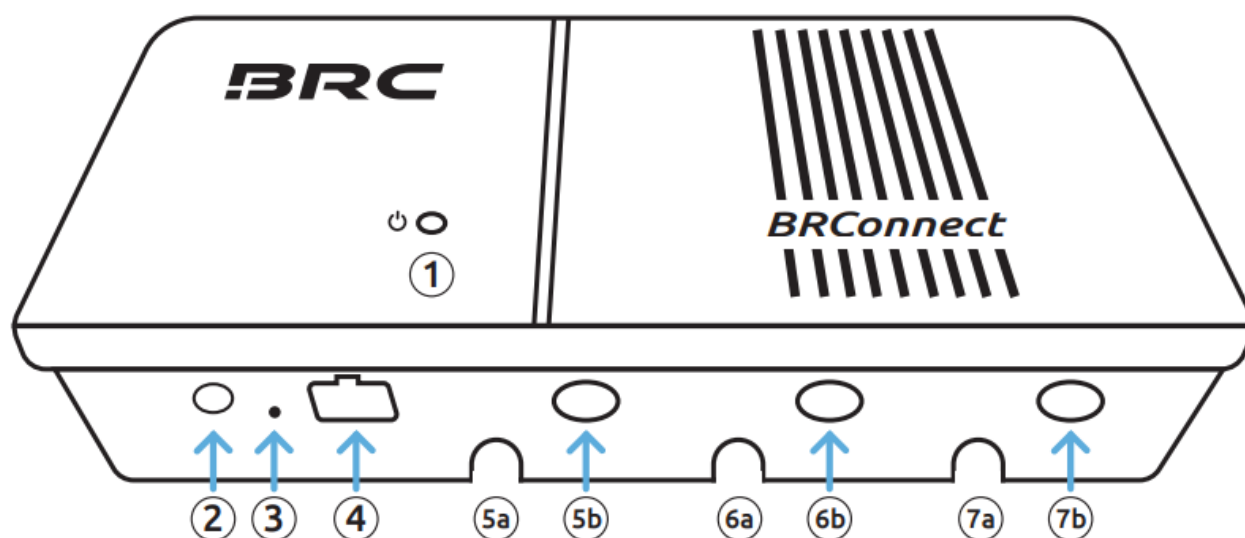

- | | |
|--|--|
| ① LED / LED | ⑥ Passage de câble pour le brin 2 /
cable bushing of string 2 |
| ② Connexion 24V CC / 24V DC connection | ⑥a B2- Brin - / string - |
| ③ Bouton de réinitialisation / reset button | ⑥b B2+ Brin + / string + |
| ④ Prise LAN Ethernet / Lan ethernet socket | ⑦ Passage de câble pour le brin 3 /
cable bushing of string 3 |
| ⑤ Passage de câble pour le brin 1 /
cable bushing of string 1 | ⑦a B3- Brin - / string - |
| ⑤a B1- Brin - / string - | ⑦b B3+ Brin + / string + |
| ⑤b B1+ Brin + / string + | |

INTENDED USE

- The BRConnect is a gateway that, in combination with the M600-M and the BRC Power Manager, is used for data monitoring of the photovoltaic system at the module level.
- Data from the M600-M is communicated to the BRConnect using powerline communication via DC cables and processed there.
- The end user can view this data via the BRC Power Manager App, making it possible to monitor the photovoltaic system.
- In order to use the product as intended, a fixed installation is required, which must be

- carried out by a qualified electrician in accordance with the explanations under point 4.
- When setting up the BRConnect, please ensure compliance with the specified technical data. Pay particular attention to the following information:
 - The BRConnect is rated protection class IP40 and is therefore intended for indoor use. Please keep the device away from liquids, humidity and heat sources as well as direct sunlight.
 - The product is designed for operation at ambient temperatures of – 20°C to + 55°C.
 - The product is only approved for operation up to 2,000m above sea level.
 - The BRConnect has Ethernet and WiFi interfaces to provide the data to the BRC Power Manager.

WiFi standard	WiFi 4; 802.11n
WiFi frequency range	2.4 GHz

- If the use deviates from the use explained here, this is considered improper use. The manufacturer assumes no liability for damage caused by improper use. The information in the limited product warranty applies (<https://brc-solar.de/downloads/>).

LED OVERVIEW

Signal LED / LED signal	Explication / Explanation
Pas de lumière / no light 	Le BRConnect n'a pas d'alimentation ou est défectueux, vérifiez l'alimentation. Sinon, contactez le support. / <i>BRConnect has no power supply or is defective, check power supply. Otherwise contact support hotline.</i>
Leuchtet blau / lights up blue 	Visible immédiatement après le démarrage (env. 7-8 secondes), puis passe en mode de connexion Bluetooth et, après une configuration réussie, est à nouveau visible en tant qu'état normal via l'application Power Manager. / <i>Visible immediately after starting (approx. 7-8 sec), then switches to Bluetooth connection mode and can be seen again as normal state after successful setup via Power Manager App.</i>
Clignote lentement en bleu / slowly flashes blue 	En attente de connexion Bluetooth avec le téléphone/tablette. Ouvrez l'application Power Manager et suivez les étapes jusqu'à l'étape 6. La recherche du BRConnect commence = clignotement 1 seconde allumée, 1 seconde éteinte. / <i>Waiting for Bluetooth connection with mobile phone/tablet. Open Power Manager App, follow the app instructions (see page 8) up to step 6. Now the search for BRConnect is running = flashing frequency 1 second on, 1 second off.</i>
Brille en vert / lights up green 	La connexion Bluetooth avec le téléphone/tablette est établie. Définir les informations de la chaîne dans l'application Power Manager. Saisir l'adresse IP et les paramètres WLAN via l'application Power Manager ou connecter un câble Ethernet. / <i>Bluetooth connection with mobile phone/tablet established. Set string information in Power Manager App. Enter the IP address and WiFi settings via the Power Manager App or plug in the Ethernet cable.</i>
Clignote lentement en vert / slowly flashes green 	Connexion au réseau local en cours (aucune action nécessaire, si l'état persiste, vérifier la connexion au réseau local) = fréquence de clignotement 1 seconde allumée, 1 seconde éteinte. / <i>Establishing connection to local network (no action necessary, check local network connection if the status persists) = flashing frequency 1 second on, 1 second off.</i>
Clignote rapidement en vert / quickly flashes green 	Connexion au réseau active, connexion au cloud en cours (aucune action nécessaire, si l'état persiste, vérifier la connexion Internet) = fréquence de clignotement 200 ms allumée, 200 ms éteinte. / <i>Network connection active, establishing connection to cloud (no action necessary, check internet connection if the status persists) = flashing frequency 200ms on, 200ms off.</i>
Brille en jaune / lights up yellow 	Avertissement, fonctionnalité limitée, veuillez déconnecter BRConnect de l'alimentation et le reconnecter pour redémarrer. Si le signal persiste, veuillez contacter le support. / <i>Warning, functionality limited, please disconnect BRConnect from the power supply and reconnect it to restart. If the signal persists, please contact support.</i>
Brille en rouge / lights up red 	Erreur, BRConnect éventuellement défectueux. Veuillez déconnecter BRConnect de l'alimentation et le reconnecter pour redémarrer. Si le signal persiste, veuillez contacter le support. / <i>Error, BRConnect may be defective. Please disconnect BRConnect from the power supply and reconnect it to restart. If the signal persists, please contact support.</i>

INSTALLATION

- Attach the wall mount: Mark the position with a pencil and spirit level, drill 4 holes (size 6mm), and sink 4 dowel pins. Mount the wall mount with 4 screws, washers, and a screwdriver

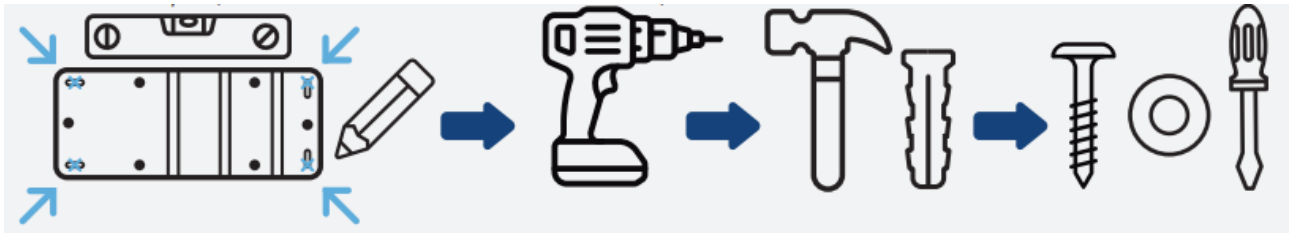

- Clip BRConnect onto the designated pins of the wall mount: To do this, press evenly on both sides until you hear a click.

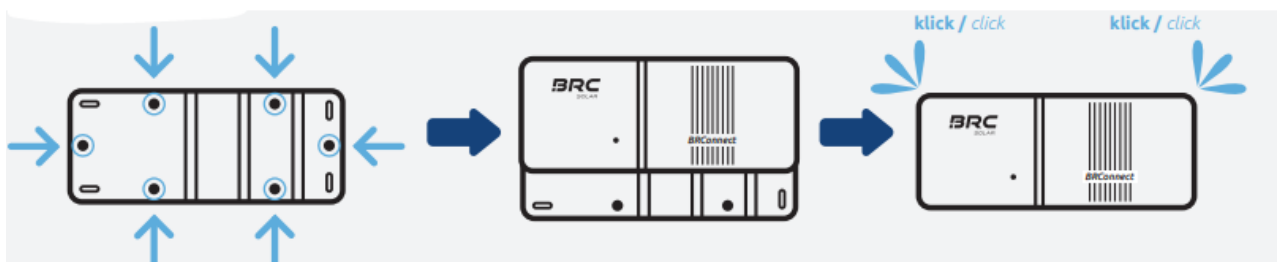

- Pass the string cable through the cable bushing: Make sure that the string cable is voltage-free when passing through. Pay attention to the correct connection arrangement of the string cables; otherwise, errors or inoperability may occur. Note the sticker on the top and peel it off. Connect the string cable to the inverter with the DC switch off: Pay attention to the correct polarity. Connect the string cable to the PV system, then switch on the DC side of the inverter.

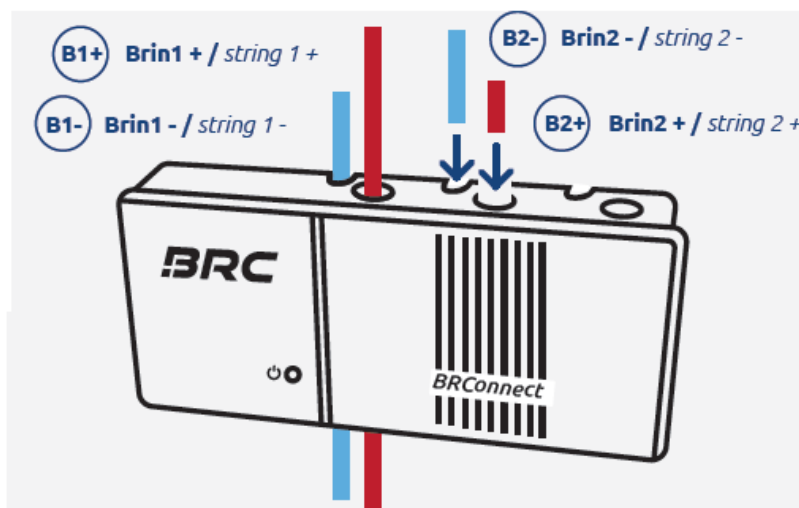

- Connect 24V and Ethernet: BRConnect LED lights up briefly in blue, then flashes slowly in blue and waits for Bluetooth connection.

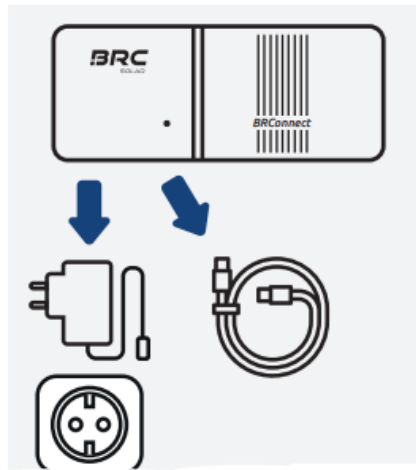

- Video instructions for assembly and app setup



POWER MANAGER APP

- Install App: Available on App Store and Play Store.

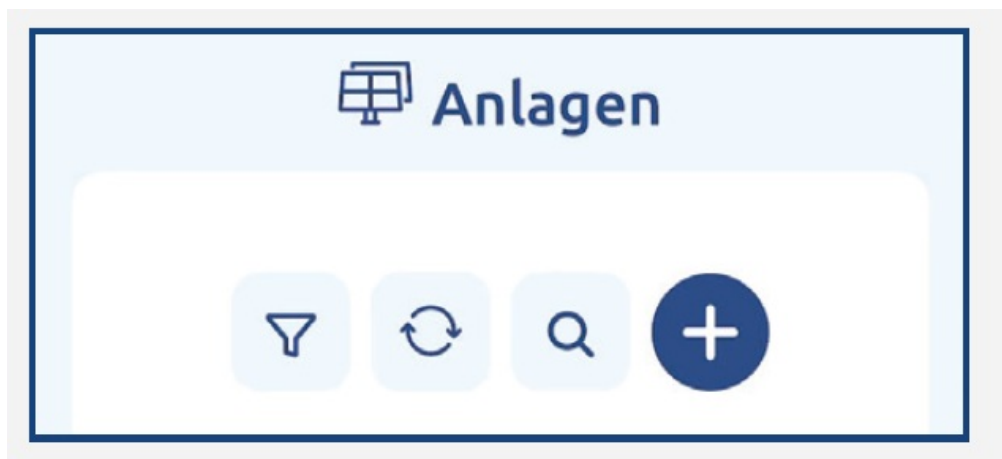

- Register, log in, and click the plus symbol to set up a new plant. Internet connection is required for this.
- Fill in general information and owner information

<p> Allgemeine Angaben</p> <p>Anlagenname*</p> <hr/> <p>Alias Name*</p> <hr/> <p>Straße*</p> <hr/>	<p> Eigentümer hat der Datenhinterlegung zugestimmt*</p> <p> Eigentümer der Anlage</p> <p>Auftragsnummer</p> <hr/> <p>E-Mail</p> <hr/>
---	---

- Enter solar module and inverter data and select whether a battery storage or a wallbox is integrated.

- Select Start configuration to continue the setup, or Save & configure later.

- The optimizers must already be installed, and the BRConnect must be powered for further setup
- BRConnect automatically waits for Bluetooth connection after starting. Select the BRConnect via the app and connect.

- Enter how many optimizers (M600-M) are connected per string.

- Connect the BRConnect to the internet via WiFi or Ethernet. The app will then search for the available optimizers.

- Create a string plan using drag & drop and place the optimizers.

- Successful completion of the setup.



OPERATION AND MAINTENANCE

- Only clean the BRConnect with a dry, lint-free cloth. Do not use cleaning agents or solvents.
- The BRConnect is maintenance-free. If a problem persists, contact support.

REPLACEMENT AND REPAIR

- The steps for dismounting the BRConnect must be carried out in the reverse order of installation (see Chapter 4):
- Switch off the DC side of the inverter.
- Ensure that the string cables are voltage-free.
- Remove the power supply to disconnect the BRConnect from the circuit.
- Remove the Ethernet cable.
- Release the string cables from the cable bushings.
- Dismount the BRConnect by evenly removing it straight from the wall mount.
- Repairs must not be carried out.

DISPOSAL

- The transport packaging can be recycled through local waste disposal.
- After use, the BRConnect and all associated components are to be disposed of as electronic waste in accordance with the laws applicable in the country.

PRODUCT COMPLIANCE AND CONTACT

- BRC Solar GmbH, located at Gehrstraße 7 in D-76275 Ettlingen, Germany, declares that the product BRConnect complies with the basic requirements of the national directives if the installation instructions are observed and the product is used as intended. A complete declaration of conformity can be found on the website (www.brc-solar.de) of BRC Solar GmbH.

Power Manager App

- Power Manager App Apple App Store



- Power Manager App Google Play Store



www.brc-solar.de

Documents / Resources

	BRC Solar B154B RConnect Gateway [pdf] User Manual B154B RConnect Gateway, B154B, RConnect Gateway, Gateway
---	--

References

- [User Manual](#)

Leave a comment

Your email address will not be published. Required fields are marked *

Comment *

Name

Email

Website

☐ Save my name, email, and website in this browser for the next time I comment.

Post Comment

Search:

e.g. whirlpool wrf535swhz

Search

[Manuals+](#) | [Upload](#) | [Deep Search](#) | [Privacy Policy](#) | [@manuals.plus](#) | [YouTube](#)

This website is an independent publication and is neither affiliated with nor endorsed by any of the trademark owners. The "Bluetooth®" word mark and logos are registered trademarks owned by Bluetooth SIG, Inc. The "Wi-Fi®" word mark and logos are registered trademarks owned by the Wi-Fi Alliance. Any use of these marks on this website does not imply any affiliation with or endorsement.