

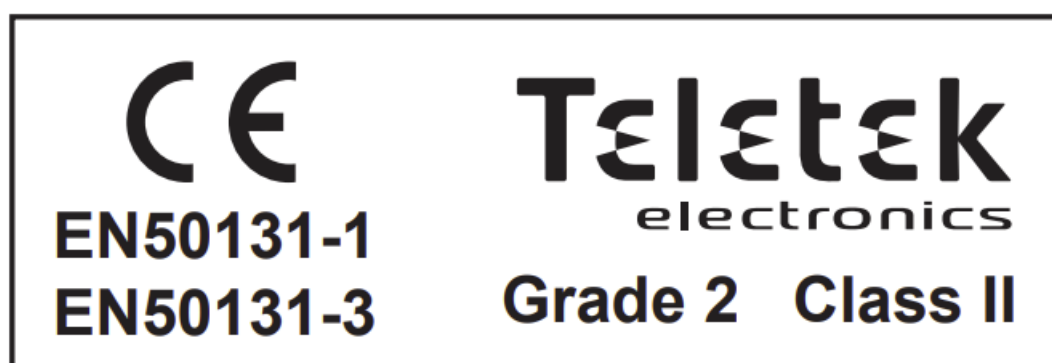

## BRAVO KBD Wireless Control Keyboard User Manual

[Home](#) » [BRAVO](#) » BRAVO KBD Wireless Control Keyboard User Manual 

**BRAVO KBD Wireless Control Keyboard**



**Attention!** This manual contains information on limitations regarding product use and function and information on the limitations as to liability of the manufacturer. The entire manual should be carefully read!

## Contents

- 1 General Description
- 2 Functional Features
- 3 Package contents
- 4 Technical Characteristics
- 5 BRAVO KBD Elements
- 6 Installation Instruction
  - 6.1 Mounting Bracket
  - 6.2 Batteries Compartment
  - 6.3 Enrollment to the BRAVO System Configuration
  - 6.4 Resetting of BRAVO KBD
  - 6.5 Sound Signalization of BRAVO KBD
  - 6.6 Access Codes for Programming and Management
  - 6.7 LED Indication for System Status
- 7 User Operation
  - 7.1 Arming with a code
  - 7.2 Quick Arming without a code
  - 7.3 Disarming
  - 7.4 Blocking the keyboard
  - 7.5 Sending of a panic alarm
  - 7.6 Clear the indication for event memory
- 8 User Programming
  - 8.1 How to change own code
  - 8.2 How to set a new User code
  - 8.3 How to change a user code
  - 8.4 How to delete a user code
  - 8.5 How to disable Trouble Sounds signalization of BRAVO KBD
  - 8.6 How to change the buzzer sound level of BRAVO KBD
  - 8.7 How to change the intensity backlight of buttons of BRAVO KBD
  - 8.8 Direct entry into “Device enrollment” mode with BRAVO KBD
  - 8.9 Changing Batteries
- 9 Documents / Resources
- 10 Related Posts

## General Description

BRAVO KBD is a wireless control LED keyboard for operation with BRAVO panels. The keyboard is equipped with a wide-angle detection dual sensor for automatic activation of the buttons backlight in case of movement in front of it. The built-in light sensor detects the amount of ambient light in the room and controls the keyboard backlight activation for improving the battery life and conserve more energy.

## Functional Features

- Arming (Full or Stay Arming Mode) and Disarming of the system
- LED indication for system status – armed, disarmed, technical trouble, memory events
- Supports operation with up to 6 User codes and 1 Manager
- Built-in sensors for buttons backlight activation and ambient light
- Wall mounting bracket

## Package contents

In the packing box of BRAVO KBD are included the following additional parts:

- 2 pcs anchors (ø6×30) and 2 pcs screws (3.5×30) suitable for mounting on brick wall. Note: In case the device needs to be mounted on other type of surface, it is required to use supporting elements that hold 900N downwards force.
- 2 pcs battery, type CR123A, placed into keyboard battery holder · 1 pc mounting bracket (on the back of keyboard)

## Technical Characteristics

Certified	RED directive
Battery (type CR123A)*	2 x 3 V/ 1500mAh
Battery life	~1.5 years
Operation frequency	~868 MHz
Communication type	Two-way
Radio distance (open space)	Up to 400m
Indication type	LED
Working temperature	-20°C – +55°C
Mounting height	1.5 – 3.6 m (2.1 m)
Dimensions	102 x 84 x 25 mm
Weight (including batteries)	~140g

\* **ATTENTION:** Use only Panasonic batteries approved by the manufacturer, type CR123A 3V/ 1500mAh! Use only IEC 60086-4 tested batteries!

## BRAVO KBD Elements

- **Front view**

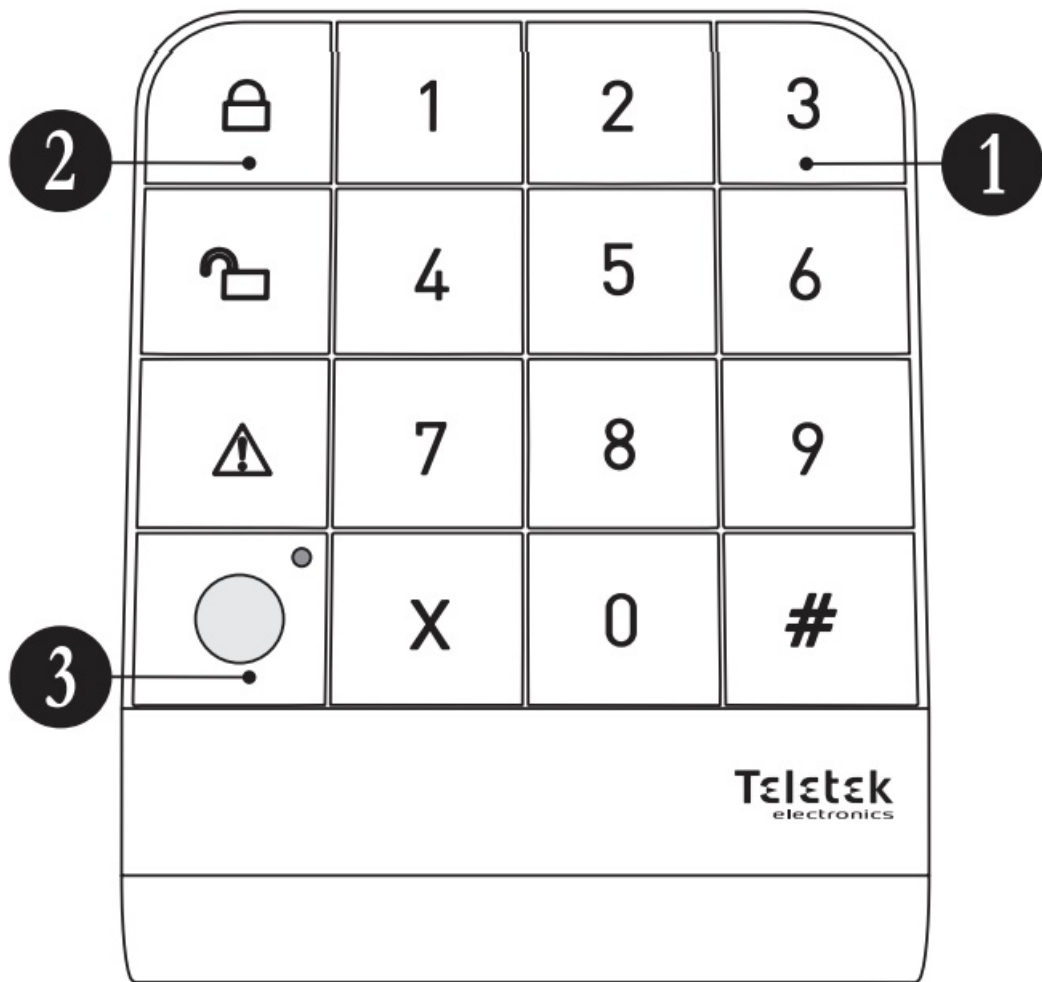

- Side view

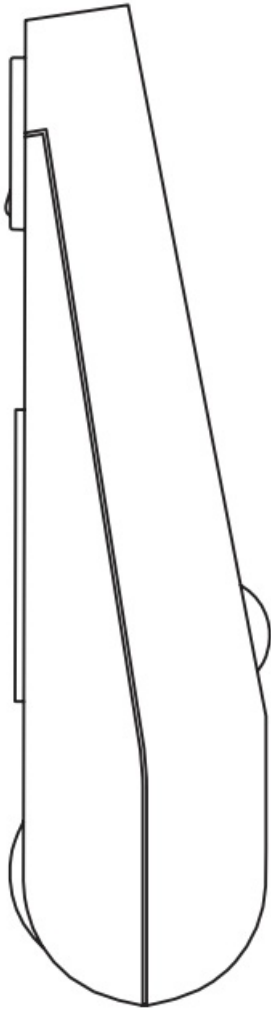

- **Rear view**

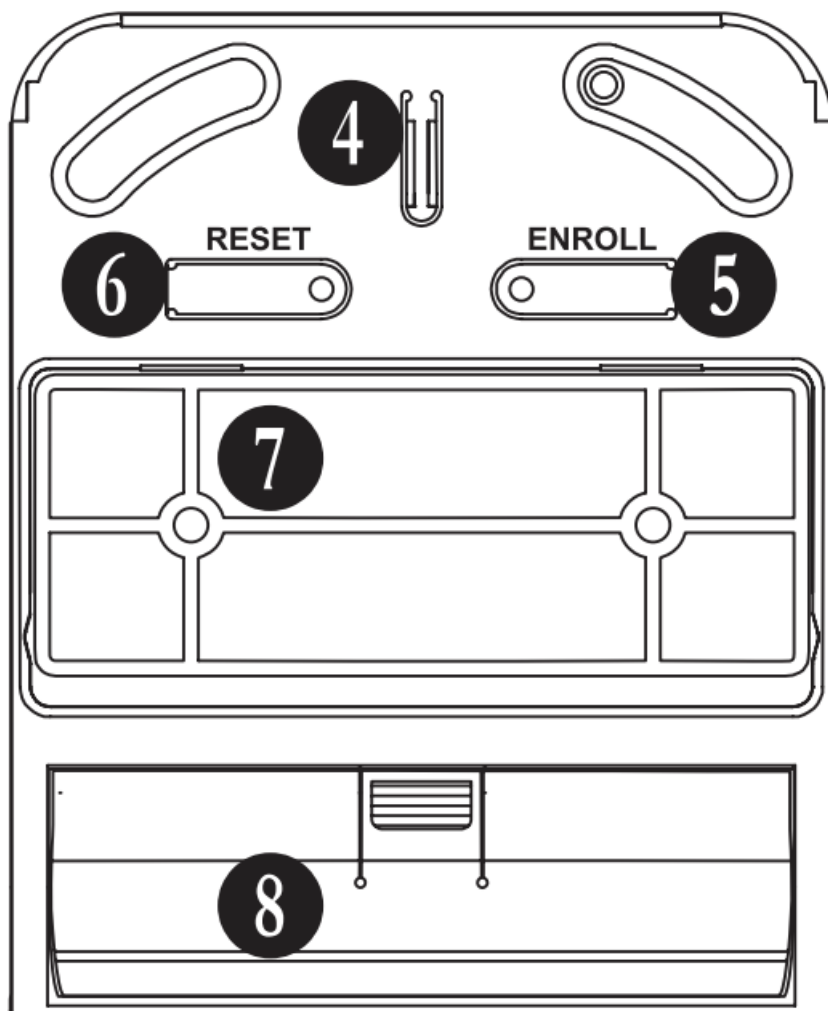

# 1. – Operation buttons:

**0-9** – Digit buttons for entering of user codes, address numbers, values

**#** – Enter into keyboard programming menus; confirmation of entered codes or values

**X** – Cancel the operation; step back in programming menus; exit from programming menus

# 2. – System status buttons and indication – see on the next page

# 3. – Built-in sensors for buttons backlight activation and ambient light

# 4. – Tamper switch

# 5. – ENROLL Button

# 6. – RESET Button

# 7. – Mounting bracket

# 8. – Battery compartment

## Installation Instruction

**IMPORTANT NOTES:** The BRAVO KBD wireless keyboard should be installed in a minimum distance of at least 2 meters far from other sources of radio signals (power lines, Wi-Fi or Bluetooth routers, wireless telephone stations, etc.) The minimum distance between the BRAVO panel and enrolled BRAVO KBD keyboard must be 1 meter to guarantee the proper operation of the system. **You should consider also that the presence of electromagnetic disturbances may trigger the near field sensor of BRAVO KBD and to turn on the background lights of the device!**

**SAFETY PRECAUTIONS:** Keep new and used batteries away from children! If the battery compartment does not close securely, stop using the product and keep it away from children's reach. If swallowed, the coin-sized and

other type batteries can cause serious injuries and burns in just 2 hours. In case of any doubt for swallowing of a battery, seek for medical help immediately!

### Mounting Bracket

1. – Slide down the mounting bracket to unlock the side pins.
2. – Pull up the bracket outside the rear back cover.
3. – Use the screws from the kit to mount the bracket on the place of installation.
4. – When the enrollment of the keyboard is finished, place it to the bracket as first match the side pins into the holes and then pull down to lock.

### Batteries Compartment

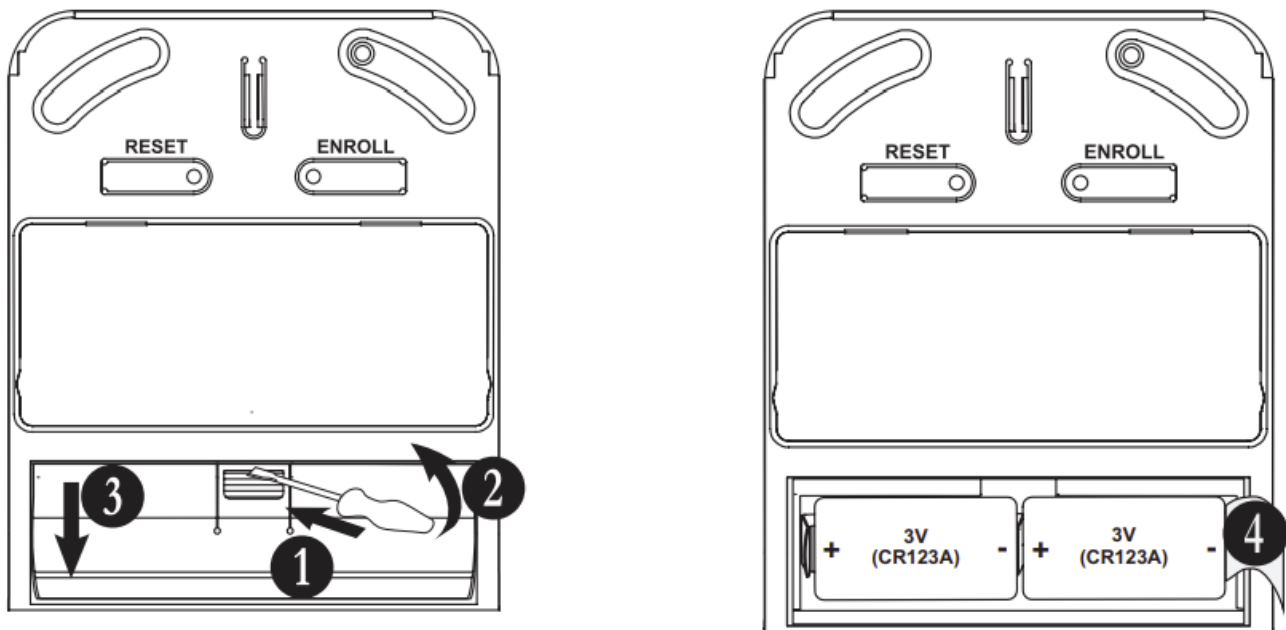

1. – Use a flat screw-drive to press slightly the clip of the batteries compartment.
2. – Pull up the screw-driver to open.
3. – Press the cover of the compartment downwards.
4. – Pull up the protective folio of the batteries to power up the keyboard and to start enrollment to the system configuration. 5 – Close the batteries compartment.

### Enrollment to the BRAVO System Configuration

#### The BRAVO panel supports operation with only one BRAVO KBD!

- Prepare the BRAVO KBD keyboard for enrollment to the system – remove the cover of the batteries compartment and pull out the protection folio. Close the cover. The system status indicators are blinking one-by-one in series – the keyboard is ready to be enrolled.
- Enter in “Device enrollment” mode of the panel.
- The system enters in the menu for detectors enrollment. Press the “Programming” button of the panel to move to the menu for key fobs enrollment – this is the menu for enrolling the keyboard. The LED indicator under the



key-fob icon is lighting on and the position 1 is blinking. The numbers of the free positions (with no key fobs enrolled) are lighting in green, and those with already enrolled key fobs – in red. The currently selected position number is blinking.

- Use the buttons with arrows to select a number of a free position – the number is blinking in green.
- Press a random digit button or the ENROLL button on the rear cover of the keyboard. The icon for arming starts blinking in red.
- The panel confirms the successful enrollment with a sound signal, and the selected position number is blinking in red. The keyboard will also confirm the enrollment with three short beeps and blinking of the icon for disarming in green.
- After exit from “Device enrollment” mode, the keyboard is ready to use

### **Resetting of BRAVO KBD**



The resetting of a device is restoring of its default factory settings. To reset the *BRAVO KBD*: With batteries on, press the “RESET” button on rear cover for 3-5 seconds until you see 3 green blinks from the icon for disarming. The system status indicators are blinking one-by-one in series the keyboard is not enrolled to the system.

### **Sound Signalization of BRAVO KBD**

<b>Sound</b>	<b>Description</b>
Button	Single short beep indicating the pressing of a key.
Confirmation	Three sound signals, indicating the system confirmation for executed operation; entry/exit the programming menus.
Cancellation	A single long beep, incorrect operation or rejection.
Entry time	Continuous beep, indicating intrusion into an entrance zone when the system is armed.
Exit time	Short beeps, indicating the system is armed and the user is required to leave the entrance zone. Ten seconds before the exit time is over beep frequency increases.
Technical trouble	Two short beeps at every 20 sec, indicating a technical trouble. To stop the signalization – press the ATTENTION button on the BRAVO panel. You can disable the Trouble Signalization of the keyboard at address 20.
Memory event	“Alarm” melody in case of memory event presence, after disarming the system.
Chime	Short beeps with subsequently increasing period, indicating intrusion into an entry-exit type zone with an activated chime option, when the system is disarmed.
Arming	Two short sound signals indicating system ARMING followed by the signalization for exit time.
Disarming	Three short sound signals indicating system DISARMING.

Type	Code	Functions
Engineer	7777 (default)	<ul style="list-style-type: none"> <li>• Direct entry into “Device enrollment” mode.</li> <li>• Changing own code.</li> <li>• Keyboard settings.</li> </ul>
Manager	0000 (default)	<ul style="list-style-type: none"> <li>• -Arming/Disarming the system.</li> <li>• Setting, changing and deleting user access codes.</li> <li>• Changing own code.</li> <li>• Keyboard settings.</li> <li>• Clearing the memory event indication.</li> </ul>
User (1-6)	—	<ul style="list-style-type: none"> <li>• Arming/Disarming the system</li> <li>• Changing own code.</li> <li>• Keyboard settings.</li> <li>• Clearing the memory event indication.</li> </ul>

#### LED Indication for System Status

Icon	Description	Color	State	Description
	Arming button	Red	Lights on	System is Armed
			Blinking	<ul style="list-style-type: none"> <li>• Enrolling to panel</li> <li>• Entry in programming mode</li> </ul>
	Disarming button	Green	Lights on	System is Disarmed
			Blinking	<ul style="list-style-type: none"> <li>• Confirmation for enrollment</li> <li>• Entry at address in programming mode</li> </ul>
	Warning indicator for troubles and memory events*	Yellow	Lights on	System is disarmed, trouble event presence
			Blinking	Selected device (from the panel)
		Red	Lights on	System is armed/disarmed, memory event presence
			Blinking	Disabled value in programming mode; set user code at address

**\*Note:** In case of presence of a technical trouble and a memory event at the same time, the indication for memory event is with higher priority.

## User Operation

### Arming with a code

The user can perform Full or Stay Arming of BRAVO panel.

To perform Full arm, enter in sequence: **Manager or User code** –  – **1** – Exit time starts running

To perform Stay arm, enter in sequence: **Manager or User code** –  – **2** – Exit time starts running

### Quick Arming without a code

The quick arming without a code is available when the option “Keyboard quick Arm Buttons” is Enabled (via ProsTE software) for the BRAVO panel to which the BRAVO KBD is enrolled.

To perform Quick Full arm, enter in sequence:  – 1 – Exit time starts running

To perform Stay arm, enter in sequence:  – 2 – Exit time starts running

### Disarming

The disarming is performed with entering of valid Manager or User code.

### Blocking the keyboard

In case of entering of three wrong (not valid) user codes in sequence, confirmed with #, the keyboard will be blocked for operation for 90 seconds.

### Sending of a panic alarm

In case of emergency situation, the User can activate a panic alarm, pressing and holding for 3-5 sec the buttons combination (the panics type – silent or audible – are set via ProsTE software):

**1+3 Police panic alarm** (silent by default)



**4+6 Medical panic alarm** (silent by default)

**7+9 Fire alarm panic alarm** (audible)

The keyboard will confirm with three short sound signals.

### Clear the indication for event memory

The presence of a memory for an alarm event is indicated with lighting on red icon  . The indication will stay active until the next arming, but can be cleared manually after entry in memory events review menu on the BRAVO panel and introducing a manager or user code:

Button  on BRAVO panel – Manager or User code – 

### User Programming

**Attention:** The programming is accessible when the system is disarmed!

Address	Description	Default	Rights
00	Changing own code.	—	Engineer, Manager, Users
01	Set, change, delete User code 1.	—	Manager
02	Set, change, delete User code 2.	—	
03	Set, change, delete User code 3.	—	
04	Set, change, delete User code 4.	—	
05	Set, change, delete User code 5.	—	
06	Set, change, delete User code 6.	—	
20	Enable/Disable Trouble Sounds signalization of the keyboard.	Enabled	Engineer, Manager, Users
21	Keyboard buzzer sound volume (1-9). Set “0” to disable the sound volume.	5	
22	Keyboard backlight intensity (1-9). Set “0” to disable the backlight activation.	5	

#### How to change own code

This setting is accessible for all type access codes: Engineer, Manager, User. To change your own code, enter in sequence:

Code – # – 00 –  +  +  are blinking enter new code #  
For exit press “X” button.

#### How to set a new User code

This setting is accessible with Manager access code only. The presence of a set code for a User is indicated with a blinking  icon see “How to change a user code”.  
To set a new code for User 1 (in the example), enter in sequence:

**Manager code – # – 01** -  +  are blinking – enter code #  
For exit press “X” button.

#### How to change a user code



This setting is accessible with Manager access code only.  
To change the code for User 1 (in the example), enter in sequence:

**Manager code – # – 01 –  +  +  are blinking enter new code #**  
For exit press “X” button.

#### How to delete a user code

This setting is accessible with Manager access code only.  
To delete the code for User 1 (in the example), enter in sequence:

**Manager code – # – 01 –  +  +  are blinking press and hold “0” button to delete the code – 3 short beeps will confirm the operation**

At next entry at address 01, only icons  +  are blinking, which means no code combination for User 1 is set. For exit press “X” button.

#### How to disable Trouble Sounds signalization of BRAVO KBD

This setting is accessible for all type access codes: Engineer, Manager, User. The Trouble sounds signalization from BRAVO KBD keyboard is Enabled by default. The option is disabled when is indicated with a blinking  icon at address 20. To disable the Trouble sound signalization, enter in sequence:

**Code – # – 20 –  +  are blinking – press any key –  +  +  are blinking – #**  
For exit press “X” button.

#### How to change the buzzer sound level of BRAVO KBD

This setting is accessible for all type access codes: Engineer, Manager, User. The buzzer sound level can be set in range from 1 (lowest) to 9 (the highest). The buzzer sound can be entirely muted with setting 0 (no sound). To change the buzzer sound level, enter in sequence:

**Code – # – 21 –  +  are blinking set sound level 1-9 – #**  
For exit press “X” button.

#### How to change the intensity backlight of buttons of BRAVO KBD

This setting is accessible for all type access codes: Engineer, Manager, User. The backlight intensity of the digit buttons can be set in range from 1 (lowest) to 9 (the highest). The backlight can be entirely turned off with setting 0. To change the intensity of the backlight of the buttons, enter in sequence:

**Code – # – 22 –  +  are blinking – set intensity 1-9 – #**  
For exit press “X” button.

#### Direct entry into “Device enrollment” mode with BRAVO KBD

For direct entry into the “Device enrollment” mode of BRAVO panel, enter in sequence:

**Engineer code – # – the panel is in “Device enrollment” mode**  
For exit press “X” button of the keyboard.

#### Changing Batteries

It is recommended first to bypass the keyboard from the panel. Then remove the cover of the battery compartment and change the batteries with new ones. After that de-bypass the keyboard from the panel.

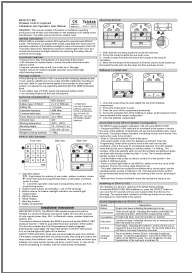
	<p><a href="#">BRAVO KBD Wireless Control Keyboard</a> [pdf] User Manual</p> <p>KBD Wireless Control Keyboard, KBD, KBD Keyboard, Wireless Control Keyboard, Wireless Keyboard, Keyboard</p>
---	--