



BRAUN BC09-DCF Alarm Clock Radio Controlled Instructions

[Home](#) » [Braun](#) » BRAUN BC09-DCF Alarm Clock Radio Controlled Instructions 

Contents

- [1 BRAUN BC09-DCF Alarm Clock Radio Controlled](#)
- [2 Product Information](#)
- [3 Product Usage Instructions](#)
- [4 Battery precautions](#)
- [5 Getting started](#)
- [6 Function keys](#)
- [7 Product Description](#)
- [8 Display details](#)
- [9 RC signal strength indicator](#)
- [10 Setting](#)
- [11 Using the alarm and snooze function](#)
- [12 Battery replacement](#)
- [13 Guarantee](#)
- [14 EU Declaration of Conformity](#)
- [15 Documents / Resources](#)
 - [15.1 References](#)
- [16 Related Posts](#)

BRAUN

BRAUN BC09-DCF Alarm Clock Radio Controlled



Product Information

Product Specifications

- **Model:** BC09-DCF
- **Display:** LCD
- **Power Source:** Battery
- **Guarantee:** 2 years against material and workmanship defects (except battery)

Product Usage Instructions

Setting the Clock Time and Alarm Time

1. Slide the TIME SETTING / NEUTRAL / ALARM SETTING switch to the TIME SETTING position.
2. Use the + or – key to adjust the hour and minute values for the clock time.
3. Slide the TIME SETTING / NEUTRAL / ALARM SETTING switch to the ALARM SETTING position.
4. Use the + or – key to adjust the hour and minute values for the alarm time.
5. Slide the TIME SETTING / NEUTRAL / ALARM SETTING switch to the NEUTRAL position to exit the setting mode and return to normal display.

Changing Display Format

When the TIME SETTING / NEUTRAL / ALARM SETTING switch is in the NEUTRAL position:

- Press the + key to switch between 12-hour and 24-hour display format.

Adjusting Setting Values

In TIME SETTING or ALARM SETTING mode:

- Press and release the + key to increase the setting value.
- Press and hold the + key to speed up the setting.
- Press and release the – key to decrease the setting value.
- Press and hold the – key to speed up the setting.

Enabling/Disabling the Alarm

- Shift the ALARM ON / OFF slider up to enable the alarm.
- Shift the ALARM ON / OFF slider down to disable the alarm.

Backlight and Snooze Function

Using the SNOOZE / LIGHT touch button:

- Tap the button to turn on the backlight for 10 seconds.
- Tap the button to stop the alarm and activate the 5-minute snooze function.

Resetting the Unit

Use a pin to press the RESET key and reset all values to default. This should be done in case of a malfunction.

Testing RC Signal Reception

- Press the RCC key to receive the RC signal and test reception.
- Press and hold the RCC key for over 3 seconds until “OFF” is displayed to disable the automatic RC function.

Frequently Asked Questions (FAQ)

• Q: How do I change between the 12-hour and 24-hour display format?

A: When the TIME SETTING / NEUTRAL / ALARM SETTING switch is in the NEUTRAL position, press the + key to switch between the formats.

• Q: How do I adjust the setting values?

A: In TIME SETTING or ALARM SETTING mode, press and release the + key to increase the value, or press and release the – key to decrease the value. Press and hold either key to speed up the setting.

• Q: How do I enable or disable the alarm?

A: Shift the ALARM ON / OFF slider up to enable the alarm or down to disable it.

• Q: How do I turn on the backlight and activate the snooze function?

A: Tap the SNOOZE / LIGHT touch button to turn on the backlight for 10 seconds. To activate the snooze function, tap the button to stop the alarm.

• Q: How do I reset the unit?

A: Press the RESET key using a pin to reset all values to default. This should be done in case of a malfunction.

• Q: How do I test the RC signal reception?

A: Press the RCC key to receive the RC signal and test reception. Press and hold the RCC key for over 3 seconds until “OFF” is displayed to disable the automatic RC function.

Guarantee

2-year guarantee against material and workmanship defects (except battery). The guarantee is valid in those

countries where the alarm clock is officially being sold. A broken or cracked lens screen is not covered under the Guarantee.

FAQ

If you have any problems with your product, please check your local service center on the [Braun Clocks](#) or [Braun Watches](#) websites. You can also contact +44 808 175 3235 (calls free within the UK) or +44 208 208 1833.

WARNING!

This product is covered by the Waste Electrical and Electronic Equipment (WEEE) directive. It should not be discarded with normal household waste but taken to your local collection center for recycling.

EU Declaration of Conformity:

We ZEON LIMITED UK, the manufacturer of Braun Watches & Clocks under license from the Procter & Gamble Company, hereby declare that model BC09-DCF conforms to Directive 2014/53/EU. The full text of the EU Declaration of Conformity can be viewed on our website at www.braun-clocks.com.

Battery precautions

1. Do not use rechargeable batteries.
2. Use only alkaline AA batteries of the same or equivalent type.
3. Insert batteries with the correct polarity.
4. Keep batteries away from children.
5. Dispose of exhausted batteries according to local legal requirements. Do not dispose of them by throwing them away with normal household rubbish.
6. Avoid short-circuiting the contacts in the battery compartment and battery terminals.
7. Remove batteries from the unit if it will not be used for long period.
8. Exhausted batteries should be removed from the battery compartment to prevent over-discharge, which can cause leakage and may cause damage to the clock.

Getting started

1. Remove the battery door.
2. Insert 1xAA size new battery as indicated in the battery compartment, and press the “reset” key to reset the clock. The display will turn on after a few seconds.
3. After 6 seconds, the Clock will automatically start scanning for the radio-controlled time signal.
4. Close the battery door.

Radio-controlled operation DCF version (Germany & European countries)

This Braun digital alarm clock is set and controlled automatically by a DCF radio signal. The DCF radio time code signal is broadcast from Frankfurt, Germany. The coverage of the DCF signal is the whole of Germany. The time code signal can be received up to 1500km from Frankfurt. This covers most of Central and Western Europe.

Function keys

TIME SETTING / NEUTRAL / ALARM SETTING switch

- Slide the switch to the TIME SETTING position to set the clock time.

- Slide the switch to the ALARM SETTING position to set the alarm time.
- Slide the switch to the NEUTRAL position to exit the setting mode and return to normal display.

+ Key

- When the setting switch is in the NEUTRAL position, press the
- + key to change between the 12 and 24-hour display format.
- In TIME SETTING or ALARM SETTING mode press to increase the setting value. Press and hold to speed up the setting.

– Key

- In TIME SETTING or ALARM SETTING mode press to decrease the setting value. Press and hold to speed up the setting.

ALARM ON / OFF slider

- Shift the ALARM ON / OFF slider up to enable the alarm.
- Shift the ALARM ON / OFF slider down to disable the alarm.

SNOOZE / LIGHT touch button

- Tap to turn on the backlight for 10 seconds.
- Tap to stop the alarm and activate the 5-minute snooze function.

RESET key

- Press by using a pin to reset all values to default. In case of a malfunction, the unit has to be reset.

RCC key

- Press to receive the RC signal to test the reception.
- Press and hold the RCC key for over 3 seconds until “OFF” is displayed to disable the automatic RC function.

Product Description

Product description (Image 1)

- LCD display
- SNOOZE / LIGHT touch button
- ALARM ON / OFF slider
- TIME SETTING / NEUTRAL / ALARM SETTING switch
- + Key
- – Key

- Battery compartment
- RESET key
- RCC key

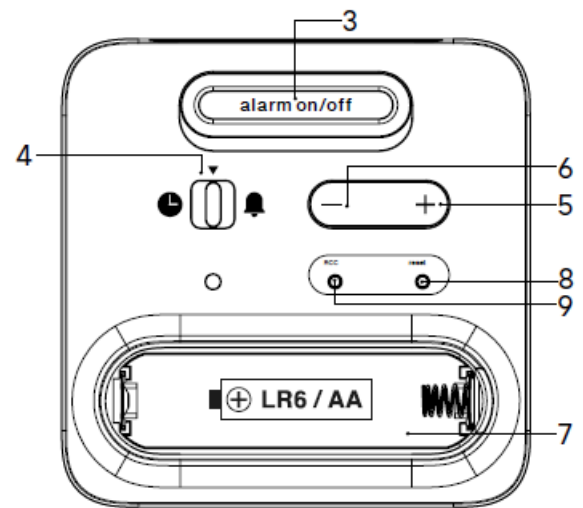
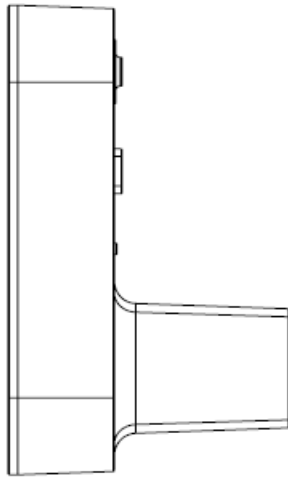
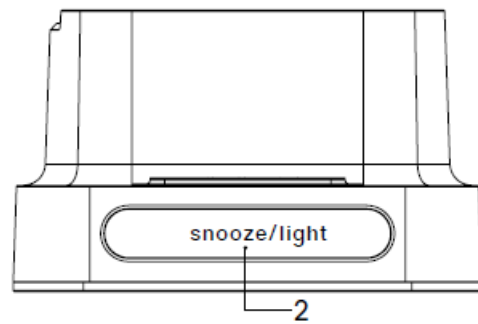
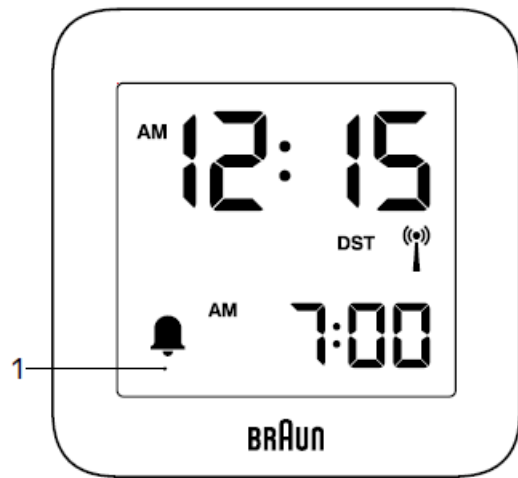

Display details

Display details (Image 2)

- A. Time
- B. AM / PM indicator (for 12 hour format)
- C. Alarm time
- D. Alarm icon
- E. DST indicator
- F. RC signal strength indicator

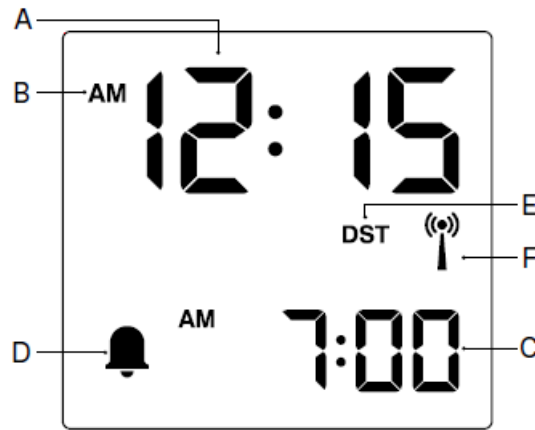

RC signal strength indicator

RC signal strength indicator (Image 3)

The signal indicator displays signal strength in 3 levels. Wave segment flashing means the time signals are being received. Press and hold the RCC key for over 3 seconds until “OFF” is displayed to disable the automatic RC function.

3.



Note:

You may use the RCC key to receive the time signal manually. The receive mode stops automatically after 6 minutes.

Setting

Setting the time

- Slide the TIME SETTING / NEUTRAL / ALARM SETTING switch to the TIME SETTING position.
- Press the '+' or '-' key to set the desired value. Press and hold the '+' or '-' key to speed up the setting.
- Slide the TIME SETTING / NEUTRAL / ALARM SETTING switch to the NEUTRAL position to return the normal display and save the settings.

Setting the alarm

- Slide the TIME SETTING / NEUTRAL / ALARM SETTING switch to the ALARM SETTING position.
- Press the '+' or '-' key to set the desired value. Press and hold the '+' or '-' key to speed up the setting.
- Slide the TIME SETTING / NEUTRAL / ALARM SETTING switch to the NEUTRAL position to return the normal display and save the settings.

Using the alarm and snooze function

- Enable the alarm by shifting the ALARM ON / OFF slider up (so the green detail is visible). The bell icon will appear on the LCD display.

- Tap the SNOOZE / LIGHT touch button to stop the alarm and activate the snooze function. When the snooze function is activated, the bell icon will flash.
- To disable the alarm and snooze function, shift the ALARM ON / OFF slider down. The bell icon will disappear.

Note:

When the snooze function is activated, the alarm will automatically start again after 5 minutes. The snooze function will not stop unless the ALARM ON / OFF SLIDER is shifted down.

Battery replacement

When the LCD becomes dim, replace it with a new battery at once.

Important

- For the best reception performance, please read the following instructions.
- We strongly recommend you start your clock at night. Allow the clock to receive the signal automatically overnight.
- Place the unit away from interfering sources such as TV sets, computers, microwaves, etc.
- Avoid placing the unit on or next to metal surfaces.
- Avoid closed areas such as airports, basements, cement office buildings, or factories.

Note:

Exposure to an electrostatic environment may cause the clock to reset. In this event please follow the instructions as described in this manual to set the clock again.

Guarantee

- 2-year guarantee against material and workmanship defects (except battery). The guarantee is valid in those countries where the alarm clock is officially being sold.
- A broken or cracked lens screen is not covered under the Guarantee.

Braun helpline

Should you have a problem with your product, please check your local service center at:

- www.braun-clocks.com
- www.braun-watches.com
- or contact +44 808 175 3235 (calls free within the UK)
- or +44 208 208 1833.

WARNING!

This product is covered by the Waste Electrical and Electronic Equipment (WEEE) directive. It should not be discarded with normal household waste but taken to your local collection center for recycling.

EU Declaration of Conformity

We ZEON LIMITED UK, manufacturer of Braun Watches & Clocks under license from the Procter & Gamble Company hereby declare that model BC09-DCF conforms to Directive 2014/53/ EU. The full text of the EU

Declaration of Conformity can be viewed on our website at www.braun-clocks.com.



- **Frequency band:** 77.5KHz
- **Transmit power:** 0 dBm

Certain trademarks are used under license from The Procter & Gamble Company or its affiliates.

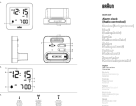
Documents / Resources

| | |
|---|--|
|  | <p>BRAUN BC09-DCF Alarm Clock Radio Controlled [pdf] Instructions BC09-DCF Alarm Clock Radio Controlled, BC09-DCF, Alarm Clock Radio Controlled, Clock Radio Controlled, Radio Controlled</p> |
|---|--|

References

-  **[Braun-Clocks: Braun Shop online | Buy Braun Clocks & Watches](#)**
-  **[Emit Collection | Buy Online Watches & Accessories Store](#)**
- **[User Manual](#)**