



## BRAUN BC07-DCF Alarm Clock User Manual

[Home](#) » [Braun](#) » BRAUN BC07-DCF Alarm Clock User Manual 

### Contents

- [1 BRAUN BC07-DCF Alarm Clock](#)
- [2 Battery precautions](#)
- [3 Battery installation](#)
- [4 Radio-controlled clock operation](#)
- [5 Alarm/snooze function](#)
- [6 Guarantee](#)
- [7 Documents / Resources](#)
  - [7.1 References](#)
- [8 Related Posts](#)

# BRAUN

### BRAUN BC07-DCF Alarm Clock



## Battery precautions

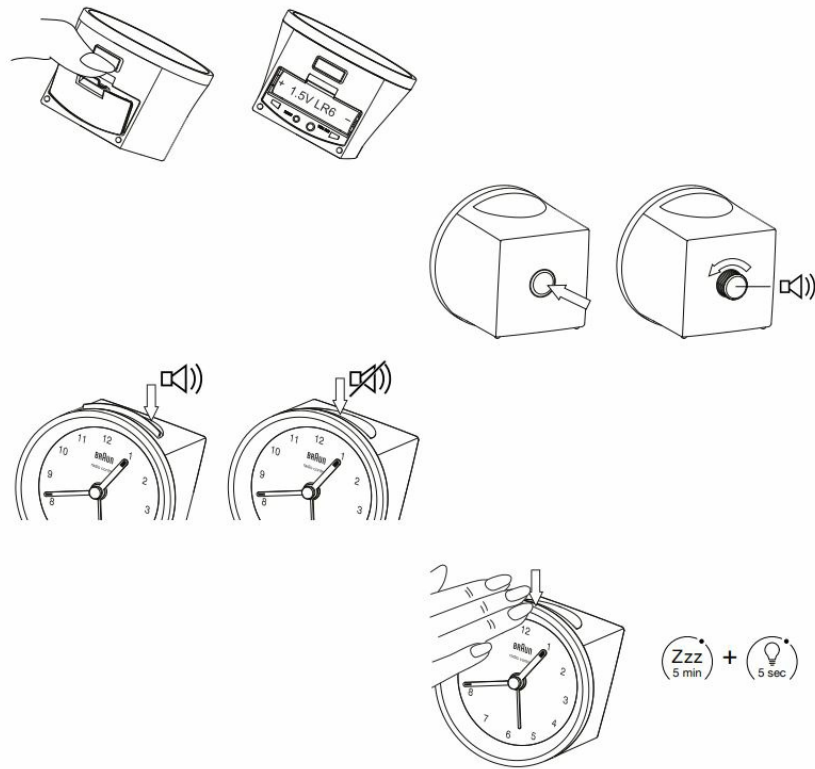

1. Do not use rechargeable batteries.
2. Use only alkaline AA batteries of the same or equivalent type.
3. Insert batteries with the correct polarity
4. Keep batteries away from children.
5. Dispose of exhausted batteries according to local legal requirements. Do not dispose of them by throwing them away with normal household rubbish.
6. Avoid short-circuiting the contacts in the battery compartment and battery terminals.
7. Remove batteries from the unit if it will not be used for a long period of time.
8. Exhausted batteries should be removed from the battery compartment to prevent over-discharging, which can cause leakage and may cause damage to the clock.

## Battery installation

1. Insert 1xAA (1.5V) battery observing the correct polarity, as shown on the diagram.
2. Replace the battery cover. Radio-controlled operation DCF version

### (Germany & European countries)

This Braun alarm clock is set and controlled automatically by a DCF radio signal. The DCF radio time code signal is broadcast from Frankfurt, Germany. The coverage of the DCF signal is the whole of Germany. The time code signal can be received up to 1500km from Frankfurt. This covers most of Central and Western Europe.

## Radio-controlled clock operation

1. We strongly recommend you start your clock at night. Once the battery is installed properly, the clock automatically sets itself to 12 o'clock and then begins receiving the signal.

2. Once it has received the DCF signal and processed it accordingly (which takes 3 to a maximum of 12 minutes), the clock will automatically display the correct time.
3. If the clock still has not set itself after 12 minutes, reception is faulty or not possible at the chosen location. Repeat the setting at a different location by pressing the RESET button.
4. A time check is carried out during every odd hour and the time is compared with the radio signal and will be corrected if necessary. Each time it will take 3 -12 minutes to receive the radio signal.

### **Important**

For the best reception performance, please read the following instructions.

1. Place the unit away from interfering sources such as TV sets, computers, microwaves, etc.
2. Avoid placing the unit on or next to metal surfaces.
3. Avoid closed areas such as airports, basements, cement office buildings or factories.

**Note:** Exposure to an electrostatic environment may cause the clock to reset. In this event please follow the instructions as described in this manual to set the clock again.

### **Manual time setting**

1. Press and hold the TIME SET button for 3 – 4 seconds to enter the time setting.
2. Press the TIME SET button for 1 second to advance 1 minute, or
3. Press and hold the TIME SET button for more than 2 seconds to speed up the time setting to the desired time.
4. If the TIME SET button is not pressed for 8 seconds, the clock is set.

**Important:** Once the desired time is set manually, the clock will correct itself to a radio-controlled time once a valid signal is received.

### **Alarm setting**

To set the alarm follow the below procedures:

1. Press the ALARM SET knob located at the back of the clock, the rotating switch will pull outwards.
2. Turn the knob in the direction of the arrow until desired alarm time is shown, only turn in the direction of the arrow to avoid damaging the movement.
3. Press the ALARM TAB located on the top to activate the alarm, a green bar will be shown at the front.
4. Press back the ALARM SET knob located at the back of the clock.

### **Alarm/snooze function**

When the alarm time is reached, the alarm will sound for a maximum of 2 minutes if the ALARM is ON and the SNOOZE / The LIGHT button is not pressed. It is reactivated 12 hours later at the same time. Press the alarm tab on the top to stop the alarm. The SNOOZE / LIGHT button is located at the bottom of the clock housing and can be activated when pressing on the clock body downwards. To activate the snooze function again press the clock body downwards and the alarm will stop with the light turned on for 5 seconds and resume after approximate 5-minute intervals. The snooze function can be repeated 3 – 7 times.

### **Illumination**

1. To be able to read the face of your alarm clock when it is dark, briefly press on the top of the alarm clock to activate the SNOOZE/LIGHT button at the bottom.
2. The illumination function is activated for 5 seconds.

### Reset function

The clock has a hand-setting help function. By pressing the reset button at any time, the hands will automatically move to the 12 o'clock position and then receive a signal.

**Note:** Pressing the SNOOZE/LIGHT button while the clock is being reset to 12 o'clock or while the clock is receiving Radio Control Signal can cause interference with Radio Control reception

### Guarantee

2-year guarantee against material and workmanship defects (except battery). The guarantee is valid in those countries where the alarm clock is officially being sold. Broken or cracked lens screens are not covered under the Guarantee. Braun helpline Should you have a problem with your product, please check your local service center at: [www.braun-clocks.com](http://www.braun-clocks.com) or [www.braun-watches.com](http://www.braun-watches.com) or contact +44 808 175 3235 (calls free within the UK) or +44 208 208 1833.

### WARNING!

This product is covered by the Waste Electrical and Electronic Equipment (WEEE) directive. It should not be discarded with normal household waste but taken to your local collection center for recycling.

### EU Declaration of Conformity

We ZEON LIMITED UK, manufacturer of Braun Watches & Clocks under license from the Procter & Gamble Company hereby declare that model BC07-DCF conforms to Directive 2014/53/ EU. The full text of the EU Declaration of Conformity can be viewed on our website at [www.braun-clocks.com](http://www.braun-clocks.com)

Frequency band: 77.5KHz



Transmit power : 0 dBm

Certain trademarks used under license from The Procter & Company or its affiliates

### Documents / Resources

	<a href="#">BRAUN BC07-DCF Alarm Clock</a> [pdf] User Manual BC07-DCF Alarm Clock, BC07-DCF, Alarm Clock, Clock
---	--

### References

-  [Braun-Clocks: Braun Shop online | Buy Braun Clocks & Watches](#)
-  [Braun-Clocks: Braun Shop online | Buy Braun Clocks & Watches](#)
-  [Emit Collection | Buy Online Watches & Accessories Store](#)