

BrainCo CL1A Zentopia Portable EEG Feedback Device User Guide

[Home](#) » [BrainCo](#) » BrainCo CL1A Zentopia Portable EEG Feedback Device User Guide 

BrainCo

Quick Start Guide

Contents

- 1 [Charging](#)
- 2 [Indicator Statuses](#)
- 3 [Product specifications](#)
- 4 [Packing list](#)
- 5 [Product overview](#)
- 6 [Device connection](#)
- 7 [Wearing](#)
- 8 [Documents / Resources](#)
 - 8.1 [References](#)

Charging

Charge this product with a USB-C charger. The indicator will be normally green when the battery is fully charged.

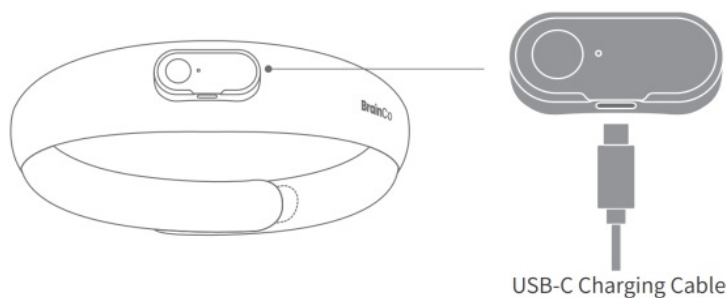

Precautions for charging:

1. For charging safety, please use the USB-C charging cable that is supplied along with the product, or a standard 5V charger. Keep this product dry during charging.
2. Charge this product at 1°C to 45°C.
3. If this product becomes hot during charging, please disconnect the charger immediately and contact our customer service center.

Indicator Statuses

Bluetooth connection

Indicator Color	Indicator Status	Headband Status
Blue	Flashing slowly	Waiting for mobile terminal connection
Blue	Flashing fast	Pairing
Green	Normally ON for 30s or OFF after successfully wearing	Connected successfully

Charging status

Green	Flashing slowly	Charging
Green	Normally ON	Charging Completed
Red	Flashing	Low battery protection (battery < 10%)

Others

Blue	Normally ON	Firmware upgrading
Red to green	Flashing red to green	Failure in firmware upgrading
Red	Flashing	Anomaly in charging
Red-blue	Flashing alternately	Internal software failure

Product specifications

Product name	Zentopia
Device name	Portable EEG Feedback Device
Model	CL1A
Dimensions	655mm*140mm*42.5mm
Weight	50g
Battery capacity	95mAh
Charging time	About 2.5h
Battery life	About 10h
Connection mode	BLE 5.0
Charging interface	USB-C

Packing list



Product overview

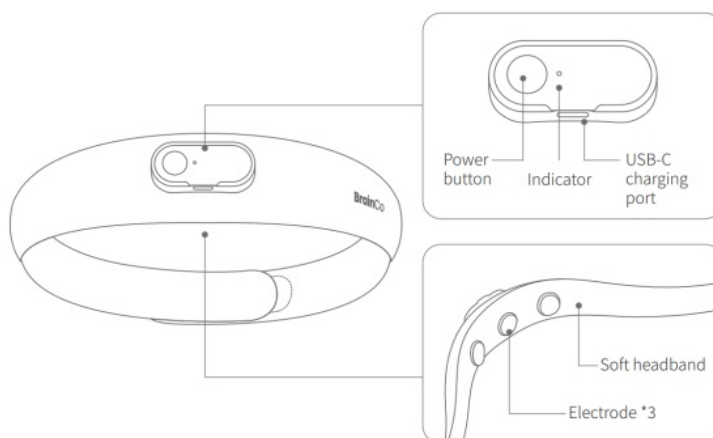

Device connection

1. Downloading and registration

- Scan the QR code below to download and install the App.
- Open the App and complete the registration or login. (Note: Make sure your phone's Bluetooth is enabled before connection.)



<https://web.static.brainco.tech/download?appid=zen-clear>

2. Pairing connection

- a) Power-on: Press and hold the power button for 5s and release it when the indicator is ON.
- b) Pairing: Press and hold the power button for 5s. The indicator will be flashing blue in the pairing status.
(! If the headband is used for the first time, the pairing mode will be automatically enabled after power-on.)
- c) Power-off: Press and hold the power button for 2s and release it when the indicator is OFF.



- d) Connection: Find the Bluetooth name of the device, and add the device for pairing according to the instructions on the App interface. Click the Bluetooth name to complete the pairing.

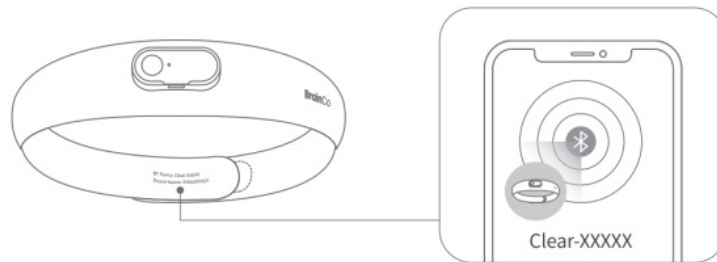

Wearing

1. Make sure that the device faces forward (with the BrainCo logo in front). Hold the middle part with both hands, and attach the device centrally on the forehead. (Note: For accurate signal reading, please wipe the forehead with a wet tissue before wearing the device, so that the forehead is clean without any hair.)

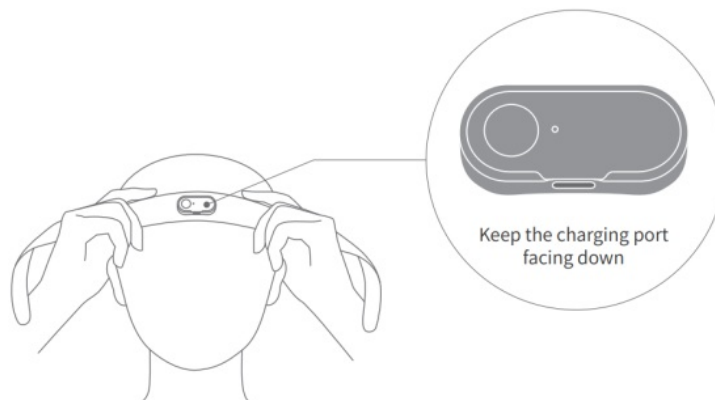

2. Tighten the headband properly into an appropriate position, until all electrodes are in full contact with the skin.

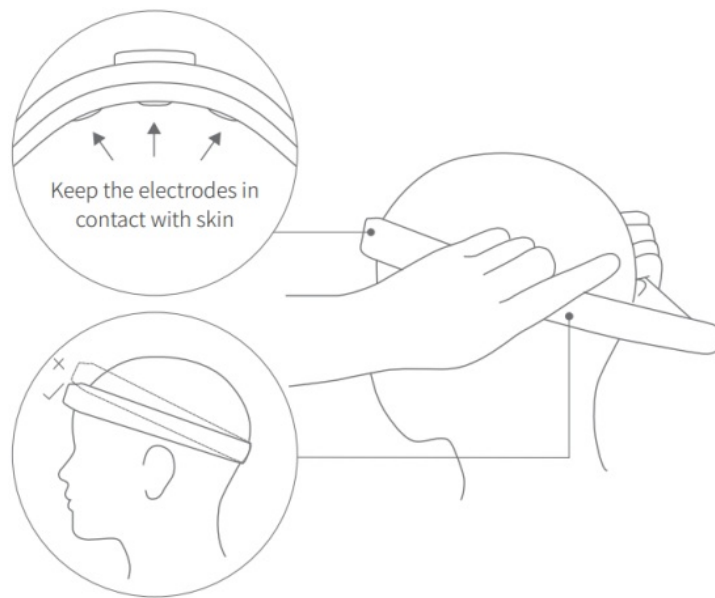

Scan the QR code to download the App



<https://web.static.brainco.tech/download?appid=zen-clear>

Documents / Resources

<p>Quick Start Guide</p> <p>Quick Start Guide 15</p> <p>BrainCo CL1A Zentopia Portable EEG Feedback Device 15</p> <p>CL1A, CL1A Zentopia Portable EEG Feedback Device, Zentopia Portable EEG Feedback Device, Portable EEG Feedback Device, EEG Feedback Device, Feedback Device, Device 15</p>	<p>BrainCo CL1A Zentopia Portable EEG Feedback Device [pdf] User Guide</p> <p>CL1A, CL1A Zentopia Portable EEG Feedback Device, Zentopia Portable EEG Feedback Device, Portable EEG Feedback Device, EEG Feedback Device, Feedback Device, Device</p>
---	---

References

- [User Manual](#)

[Manuals+](#), [Privacy Policy](#)

This website is an independent publication and is neither affiliated with nor endorsed by any of the trademark owners. The "Bluetooth®" word mark and logos are registered trademarks owned by Bluetooth SIG, Inc. The "Wi-Fi®" word mark and logos are registered trademarks owned by the Wi-Fi Alliance. Any use of these marks on this website does not imply any affiliation with or endorsement.