



## bracketron BT2-934-2 PwrUp Mi-T Grip Dash or Window and Vent Mount Instruction Manual

[Home](#) » [Bracketron](#) » bracketron BT2-934-2 PwrUp Mi-T Grip Dash or Window and Vent Mount Instruction Manual 

### Contents

- [1 bracketron BT2-934-2 PwrUp Mi-T Grip Dash or Window and Vent Mount](#)
- [2 PARTS INCLUDED](#)
- [3 ASSEMBLY](#)
- [4 INSTALLATION](#)
- [5 DEVICE REPLACEMENT](#)
- [6 CHARGING ALIGNMENT](#)
- [7 LIMITED WARRANTY](#)
- [8 FCC WARNING](#)
- [9 Documents / Resources](#)
- [10 Related Posts](#)



**bracketron BT2-934-2 PwrUp Mi-T Grip Dash or Window and Vent Mount**



### IMPORTANT NOTE

PLEASE READ INSTRUCTIONS COMPLETELY BEFORE USING THIS DEVICE

### PARTS INCLUDED

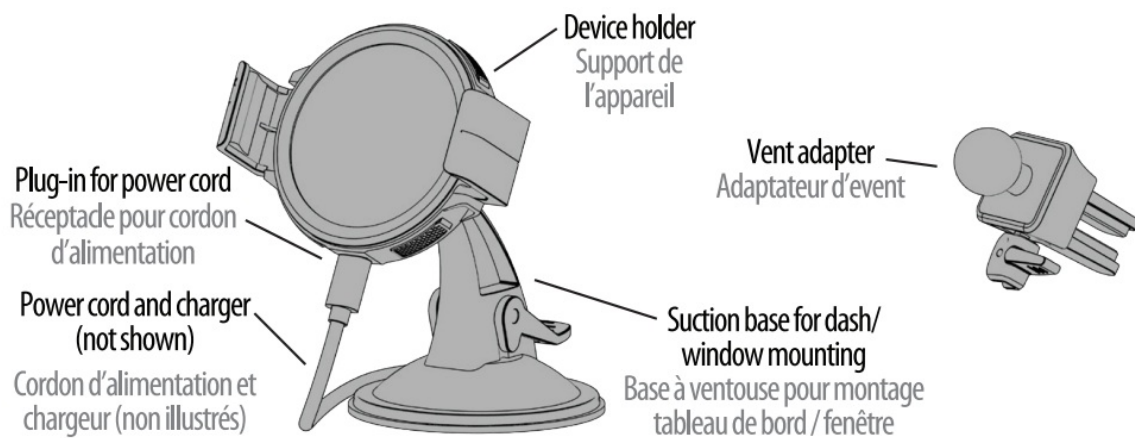

### ASSEMBLY

1. Insert the ball on the mount into the socket on the device holder and
2. Fasten with nut. Ball joint can be adjusted for best viewing angle.
  - Be sure to plug power cord into bottom of device holder or phone will not charge.
  - Join the device holder with either the dash/window mount or vent adapter:

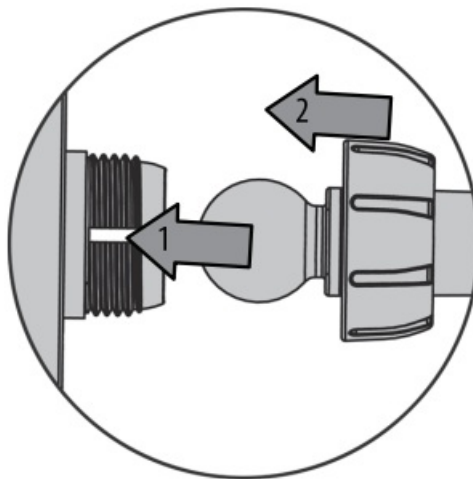
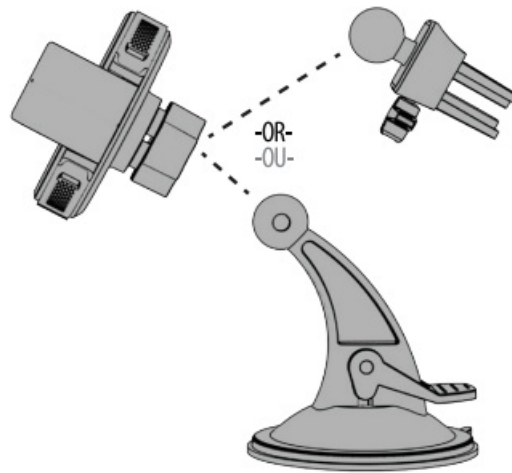

## INSTALLATION

- **Dash Mount:** Clean mounting location with water or alcohol as necessary and let dry. Apply at room temperature. Peel cover off suction cup and press firmly while locking suction lever into down position. To release the mount from your dash, lift up the suction lever and pull up on the release tab. After repeated applications, suction cup may lose its stickiness. Simply wash with warm water and air dry to restore original condition.
- **Vent Adapter:** Flip the tightening lever to its middle position (perpendicular to the vent adapter), then slide jaws of vent mount onto vent slat. Once inserted all the way into the vent, flip the tightening lever to whichever position ("I" or "II") provides the best grip on the vent slat.

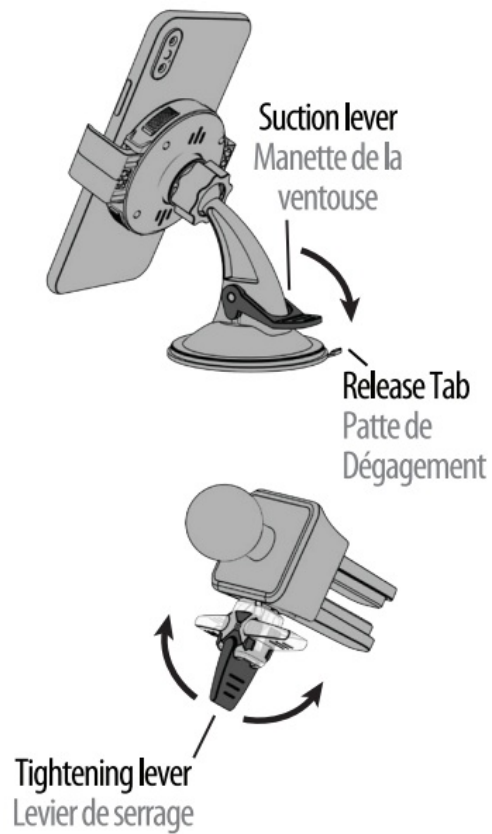

## DEVICE REPLACEMENT

- To insert your smartphone: (1) use the side of your device to expand one of the expanding arms until there is enough room for your phone. Then (2) lower the other edge of the phone into the mount and (3) let go of the phone.
- To release phone, simply pull it forward out of the mount.

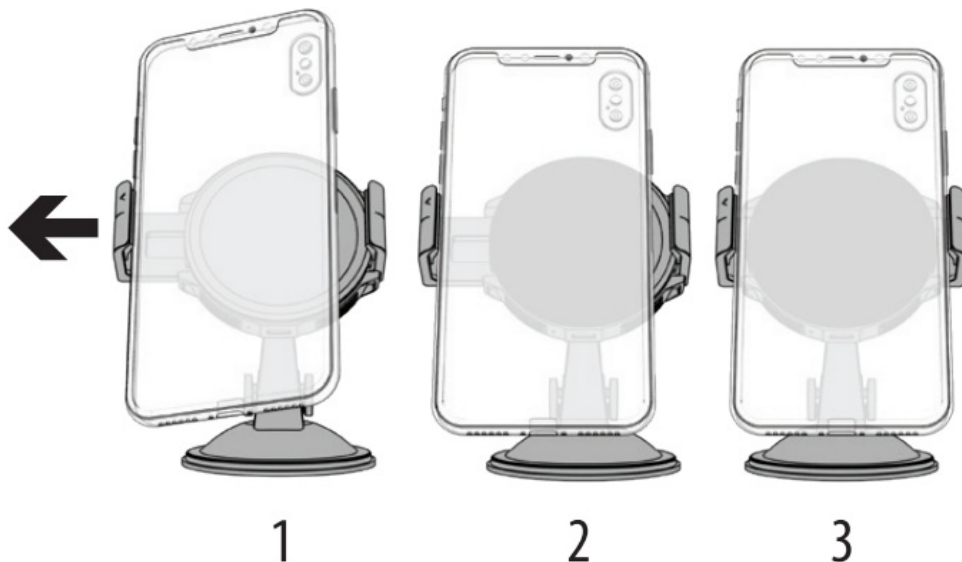

## CHARGING ALIGNMENT

Once the phone is inserted, some vertical adjustment might be needed, depending on the device. Your phone will start charging when it is in proper alignment.

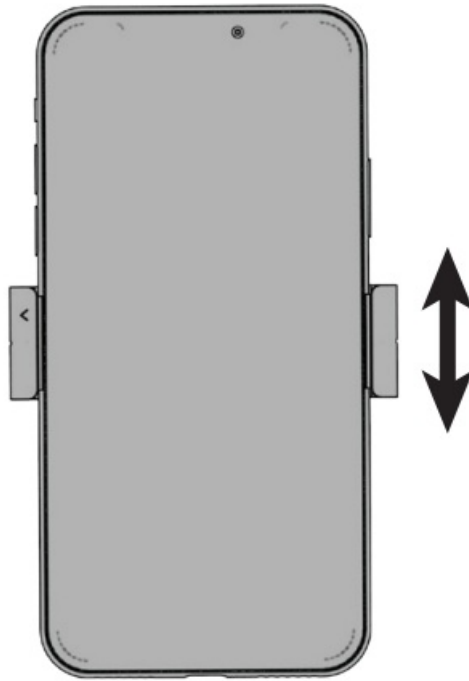

### **IMPORTANT!**

DO NOT RETURN PRODUCT TO THE RETAILER, IF YOU NEED ASSISTANCE OR REPLACEMENT PARTS CALL US TOLL FREE: 1-866-237-4443 HOURS MON-FRI 9AM-5PM(CT)

### **LIMITED WARRANTY**

Bracketron, Inc. warrants this product against defects in material or workmanship for a period of one (1) year from the date of purchase. Bracketron, at its option, may repair or replace with new or refurbished product, any product which Bracketron determines to be defective. "Refurbished" means any product that has been returned to its original specifications. To obtain warranty services, you must deliver the product, freight prepaid, to Bracketron, Inc. at 5624 Lincoln Dr., Edina, MN 55436. A dated purchase receipt **MUST** accompany the returned product. This Limited Warranty shall apply to any repair or replacement product for the remainder of the original Limited Warranty or for a period of ninety (90) days – whichever is longer. **BRACKETRON SHALL NOT BE LIABLE FOR ANY INCIDENTAL OR CONSEQUENTIAL DAMAGES FOR BREACH OF ANY EXPRESS OR IMPLIED WARRANTY ON THIS PRODUCT. FURTHER, EXCEPT TO THE EXTENT PROHIBITED BY APPLICABLE LAW, ANY IMPLIED WARRANTY OF MERCHANTABILITY OR FITNESS FOR A PARTICULAR PURPOSE ON THIS PRODUCT IS LIMITED IN DURATION TO THE DURATION OF THIS WARRANTY.**

### **FCC WARNING**

- This device complies with part 15 of the FCC Rules. Operation is subject to the following two conditions:
  1. this device may not cause harmful interference
  2. this device must accept any interference received, including interference that may cause undesired operation.
- Any changes or modifications not expressly approved by the party responsible for compliance could void the user's authority to operate the equipment.
- **NOTE:** This equipment has been tested and found to comply with the limits for a Class B digital device, pursuant to Part 15 of the FCC Rules. These limits are designed to provide reasonable protection against harmful interference in a residential installation. This equipment generates, uses and can radiate radio frequency energy and, if not installed and used in accordance with the instructions, may cause harmful interference to radio communications. However, there is no guarantee that interference will not occur in a particular installation.

- If this equipment does cause harmful interference to radio or television reception, which can be determined by turning the equipment off and on, the user is encouraged to try to correct the interference by one or more of the following measures:
  - Reorient or relocate the receiving antenna.
  - Increase the separation between the equipment and receiver.
  - Connect the equipment into an outlet on a circuit different from that to which the receiver is connected.
  - Consult the dealer or an experienced radio/TV technician for help.
- To maintain compliance with FCC's RF Exposure guidelines, This equipment should be installed and operated with minimum distance between 20cm the radiator your body: Use only the supplied antenna.

## Documents / Resources

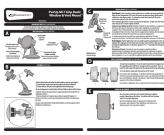
	<p><a href="#">bracketron BT2-934-2 PwrUp Mi-T Grip Dash or Window and Vent Mount</a> [pdf] Instruction Manual</p> <p>BT2-934-2, BT29342, 2ASVW-BT2-934-2, 2ASVWBT29342, PwrUp Mi-T Grip Dash or Window and Vent Mount, BT2-934-2 PwrUp Mi-T Grip Dash or Window and Vent Mount, BT2-934-2 PwrUp Mi-T Grip Dash</p>
---	---