



BOWMANN EWB6068CB Ice Cube Maker User Guide

[Home](#) » [BOWMANN](#) » BOWMANN EWB6068CB Ice Cube Maker User Guide 

BOWMANN EWB6068CB Ice Cube Maker



Contents

- 1 **IMPORTANT**
- 2 **Unpacking the Appliance**
- 3 **Overview of the Components/ Scope of Delivery**
- 4 **Warnings for the Use of the Appliance**
- 5 **Notes for Use**
- 6 **Operation**
- 7 **Cleaning and Maintenance**
- 8 **Storage**
- 9 **Troubleshooting**
- 10 **Technical Data**
- 11 **Disposal**
- 12 **CUSTOMER SUPPORT**
- 13 **Documents / Resources**
 - 13.1 **References**
- 14 **Related Posts**

IMPORTANT

Be sure to read the separately enclosed safety instructions first.

Instruction Manual

Thank you for choosing our product. We hope you will enjoy using the appliance.

Read the instruction manual and the separately enclosed safety instructions very carefully before using this appliance. Keep these documents, including the warranty certificate, receipt and, if possible, the box with the inner packaging in a safe place. If you pass the appliance on to a third party, always include all the relevant documents.

Symbols in this Instruction Manual

Important information for your safety is specially marked. It is essential to comply with these instructions in order to avoid accidents and prevent damage to the appliance:



WARNING:

This warns you of dangers to your health and indicates possible injury risks.



CAUTION:

This refers to possible hazards to the appliance or other objects.

Unpacking the Appliance



CAUTION:

When unpacking the appliance and removing the packaging, make sure that the appliance is not tilted more than 45°, otherwise the cooling compressor may be damaged.

1. Remove the appliance from its packaging.
2. Remove all packaging material, such as foils, filling material, cable ties and cardboard packaging. Also remove the tape in the water tank that is attached to fix moving parts.
3. Check the scope of delivery for completeness.
4. If the contents of the packaging are incomplete or if damage can be detected, do not operate the appliance. Return it to the dealer immediately.
5. There may still be dust or production residues on the appliance. We recommend that you clean the appliance as described under "Cleaning and Maintenance".

Overview of the Components/ Scope of Delivery

1. Lid
2. Freezing unit
3. Ice cube slider
4. Air inlet
5. Air outlet
6. Filter sieve
7. Water drainage opening
8. Housing
9.  button (switching on/off)
10. **Control lamps:**
 - ICE FULL** (ice cube container full)
 - ADD WATER** (water shortage)
 - LARGE** (large ice cubes)
 - SMALL** (small ice cubes)
11. Water tank
12. Ice cube tray
13. Sensor for the ice cube level in the container
14. Ice scoop

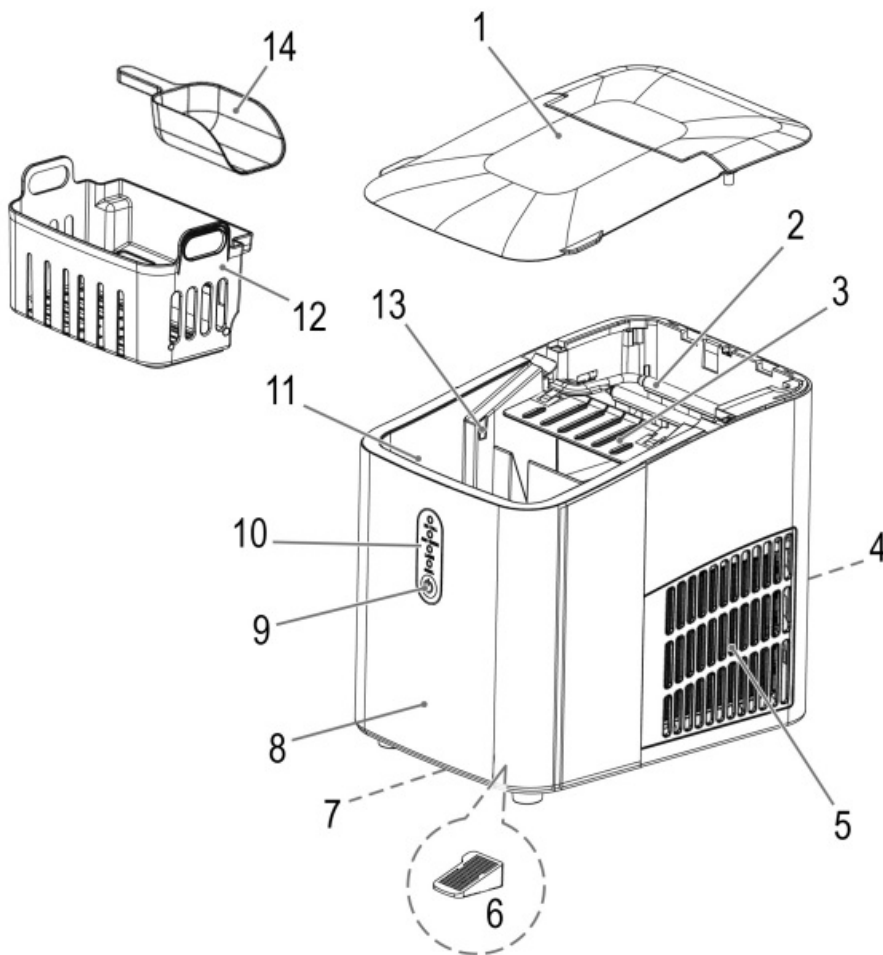

Warnings for the Use of the Appliance



WARNING:

The appliance contains the refrigerant isobutane (R600a) in the refrigerant circuit, a natural gas with high environmental compatibility, which is flammable. When transporting and setting up the appliance, make sure that the appliance does not fall down. The refrigerant circuit should not be damaged.

If the Refrigerant Circuit is Damaged:

- Avoid open flames and sources of ignition at all costs.
- Pull the appliance's mains plug out of the socket.
- Ventilate the room in which the appliance is located.



CAUTION:

- Be sure to observe the waiting time of 2 hours when using the appliance for the first time or after transport, so that the refrigerant can settle. Otherwise, the refrigeration compressor would be damaged.
- If you interrupt ice cube production with  the button, wait at least 3 minutes before switching the appliance on again to avoid damaging the compressor.
- Do not disconnect the appliance from the mains while the cleaning programme is running!

- Never operate the appliance without the filter sieve!

Notes for Use

Location

- Place the appliance on a stable, horizontal, water-resistant and level surface. Keep a distance of at least 10cm from walls or objects.
- Do not place the appliance on or in the immediate vicinity of heat sources such as stoves, radiators, etc.

Electrical Connection

- Check that the mains voltage you intend to use matches that of the appliance. You will find the information on the type plate.
- Only connect the appliance to a properly installed earthed socket.

Standby Mode (Ready state)

The control lamp SMALL flashes.

Eco Save (Energy Saving Mode)

The appliance switches off when the ice cube container is full. You benefit from increased safety and lower power consumption.

Interruption of Operation

After an interruption due to lack of water, full ice cube container, manual stop or power failure, the compressor starts with a delay of 3 minutes after it is switched on again.

Ice Cubes

- You can choose between two sizes:
 - **SMALL** (small)
 - **LARGE** (large)
- Ice cubes from the first production cycle should not be used for hygienic reasons.
- The best results are achieved at a water temperature between 7°C and 20°C and an ambient temperature between 16°C and 25°C.
- Depending on the water and ambient temperature, the first ice cubes are smaller. Only in the following cycles do the ice cubes become larger.
- Due to the rapid freezing, the ice cubes may look “milky”. This is air trapped in the water. This does not affect the quality of the ice cubes.
- If you want ice cubes with a clear appearance, use drinking water that has previously been boiled and cooled.

Operation

When using the appliance for the first time or if you have not used it for a long time, clean the appliance as described in the chapter “Cleaning and Maintenance”. Use the appliance’s cleaning programme.

Making Ice Cubes

1. Make sure that the water drain opening at the bottom of the appliance is tightly closed.
2. Open the lid and remove the ice cube container.
3. There is a filter at the bottom of the water tank. Make sure that it is firmly inserted.
4. There is an arrow in the water tank below the **MAX** mark. Fill approx. 1 litre of fresh water into the water tank, up to a maximum of below the arrow (minimum quantity: 500ml). Only use drinking water to make ice cubes.
5. Reinsert the ice cube container and close the lid.
6. Insert the mains plug into the socket.
7. Press the button once. The control lamps **LARGE** and **SMALL** flash alternately. The appliance is in ice cube size selection mode.
8. When the control lamp of the desired ice cube size lights up, press the button again. The compressor switches on. Ice cube production starts.
 - Keep the lid closed during ice cube production.
 - One ice cube production cycle takes between 8 and 10 minutes

Interrupting Ice Cube Production

Press the  button to stop ice cube production. The control lamp SMALL flashes.

- If operation is interrupted manually, the water that is not needed is returned to the water tank. Only then does the appliance switch off. Half finished ice cubes remain stuck on the cooling bars. As soon as they have thawed a little, they detach and fall off.
- Please note that ice splinters can form and block the ice cube slide. In this case, after switching on, the mechanism is moved back and forth until it is free again.
 - If you want to remove the ice splinters yourself, first pull the mains plug out of the socket.
- Note the waiting time of at least 3 minutes if you want to continue the operation.
- You can change the size of the ice cubes as long as the compressor is switched off.

ICE FULL Control Lamp (Ice Cube Container Full)

As soon as the ice cube container is full, production stops. The **ICE FULL** control lamp lights up. The compressor switches off.

1. Remove the ice cubes. If necessary, use the enclosed ice scoop. When removing the ice cube container, some water drips through the holes at the bottom.
2. After the ICE FULL control lamp goes out, ice cube production starts again automatically after a while.

ADD WATER Control Lamp (Water Shortage)

The control lamp indicates when there is not enough water in the water tank. Ice cube production is automatically interrupted.

1. Open the lid.
2. Empty the ice cube container.
3. Refill with drinking water as described in **“Making Ice Cubes”**. As there may still be residual water in the

appliance, observe the **MAX** marking in the water tank.

4. Reinsert the ice cube container and close the lid.

5. Press the  button. The **ADD WATER** control lamp goes out. The appliance is in standby mode again. You can continue with the operation.

Ending Operation

1. Press the  button to stop ice cube production. The control lamp SMALL flashes.
2. Unplug the mains plug from the socket.
3. Remove the ice cube container.
4. Drain the remaining water as described in “**Cleaning and Maintenance**”.
5. Leave the lid of the appliance open so that no fungal cultures or bacteria can form.

Cleaning and Maintenance



WARNING:

- Switch off the appliance before maintenance and cleaning. Pull the mains plug out of the socket.
- Never immerse the appliance in water for cleaning. It could cause an electric shock or fire.



CAUTION:

- Do not use a wire brush or other abrasive objects.
- Do not use harsh or abrasive cleaners.
- Do not use chemicals, acids, petrol or oil.

Cleaning Programme

With this programme, the water system is rinsed several times. The process takes about 5 minutes.

Important! The appliance should **not** be disconnected from the mains during the cleaning programme

1. There is an arrow in the water tank below the **MAX** mark. Fill approx. 1 litre of fresh water into the water tank, up to a maximum of below the arrow.
2. While the appliance is in standby mode, press and hold the  button for about 2 seconds. The appliance starts the cleaning programme. The four control lamps flash alternately.
3. The appliance automatically switches to standby mode when the cleaning programme is finished.
4. Drain the water from the appliance. Dispose of the water.

Draining Residual Water

Drain the residual water after each use of the appliance or at the end of the day.

1. Place the appliance on the edge of a table. Hold a bowl under the water drain opening.
2. Pull out the plug at the bottom.
3. After the residual water has drained off, put the plug back in the opening.

Ice Cube Container

Remove the ice cube container. Clean it in warm rinse water with a little hand dishwashing liquid. Rinse with clean water.

Filter Sieve

Clean the filter sieve at regular intervals to remove limescale deposits.

1. Pull the filter sieve off the bottom of the water tank.
2. Rinse the filter sieve under running water. You can use a nylon brush to help.
3. Put the filter sieve back on the pins at the bottom of the water tank.



CAUTION:

Never use the appliance without the filter sieve!

Housing and Interior

- Clean the housing and the inside of the appliance with a damp cloth. Make sure that no moisture gets into the air inlet or air outlet openings.
- Use a diluted solution of vinegar and water.
- Wipe the inside of the appliance dry.

Storage

- Allow the interior of the appliance to dry completely before closing the lid and storing the appliance.
- We recommend storing the appliance in its original packaging if you do not intend to use it for a long period of time
- Always store the appliance out of the reach of children in a well-ventilated and dry place.

Troubleshooting

Problem	Possible Cause	Remedy
The appliance has no function.	The appliance has no power supply.	Check the power socket with another appliance.
		Insert the mains plug correctly.
		Check the house fuse.
	The appliance is defective.	Contact our service or a specialist.
The compressor makes abnormal noises.	The mains voltage is too low.	Switch off the appliance and check the mains voltage.
The ADD WATER control lamp lights up.	Water shortage.	Refill with water as described in the chapter "Operation" "Making ice cubes".
The ICE FULL control lamp lights up.	The ice cube container is full.	Empty the ice cube container.
The ice cubes are too small.	The ambient temperature is too high.	Move the appliance to a cooler place. Ensure sufficient air circulation around the appliance.
	The water temperature is too high.	Stop the ice cube production. Drain some water and refill with cold water (max. 20°C).
	Ice cube size incorrectly selected.	Select the LARGE size with the < > button while the appliance is in ice cube size selection mode.
	Smaller ice cubes are normal for the first few cycles.	
The ice cubes are too big and stick together.	The water temperature or the ambient temperature is too low.	Stop the ice cube production. Drain some water and refill with lukewarm water (max. 35°C).
The ice cube container is full, but the ICE FULL control lamp does not light up.	The sensor for "ice cube container is full" is damaged.	Contact our service or a specialist.
The appliance is operating but not producing ice cubes.	Blockage or leakage of the refrigerant pipe.	Contact our service or a specialist.
	The compressor is damaged.	
	The fan motor is defective.	

Technical Data

Model:..... EWB 6068 CB

Power supply:..... 220–240V~, 50Hz

Power consumption:120W

Ice cube production:..... 8–10kg/24 hours

Water container volume:.....approx. 1 litre

Refrigerant: R600a/14g

Insulation blowing gas:.....C5 H10 (Cyclopentane)

Climate class:.....SN/N

Protection class:.....

Net weight: approx. 6.5kg

The right to make technical and design modifications in the course of continuous product development remains

reserved.

This appliance has been tested according to all applicable, current CE directives and built according to the latest safety regulations.

Disposal

Meaning of the “Dustbin” Symbol



■ Protect our environment: do not dispose of electrical equipment in the domestic waste. Please return any electrical equipment that you will no longer use to the collection points provided for their disposal.

This helps avoid the potential effects of incorrect disposal on the environment and human health.

This will contribute to the recycling and other forms of re-utilisation of electrical and electronic equipment.

Information concerning where the equipment can be disposed of can be obtained from your local authority. Your dealer and contractual partner is also obliged to take back the old appliance free of charge.

CUSTOMER SUPPORT

Warranty Card

24 months warranty according to warranty declaration

C. Bomann GmbH

Internet: www.bomann-germany.de

Made in P.R.C



BOMANN®

Documents / Resources



[BOWMANN EWB6068CB Ice Cube Maker](#) [pdf] User Guide

EWB6068CB Ice Cube Maker, EWB6068CB, Ice Cube Maker, Cube Maker, Maker

References

- [User Manual](#)

