



# SP10 Smart Plug Bototek Mini WiFi Plugs Work User Manual

[Home](#) » [bototek](#) » SP10 Smart Plug Bototek Mini WiFi Plugs Work User Manual 

## Contents

- [1 SP10 Smart Plug Bototek Mini WiFi Plugs Work](#)
- [2 Parameters](#)
- [3 Download & Registration](#)
- [4 Add devices in Easy Mode](#)
- [5 Add devices in AP mode](#)
- [6 Notices](#)
- [7 Quick Guide of Using Google Home](#)
- [8 Set up Google Home with Google Home APP](#)
- [9 Link Smart Life account in Home Control](#)
- [10 Quick Guide of Using Amazon Echo](#)
- [11 Set up Echo with Amazon ALEXA APP](#)
- [12 Control your smart device through Echo](#)
- [13 Warranty](#)
- [14 Documents / Resources](#)
  - [14.1 References](#)
- [15 Related Posts](#)



**SP10 Smart Plug Bototek Mini WiFi Plugs Work**



## Parameters

- **Product Name:** Mini Smart Plug
- **Model:** SPIO
- **Rated Voltage:** 100V-240V AC 50Hz-60Hz
- **Rated Current:** 10A [Max]
- **Max. Power:** 1100W
- **Material:** PC
- **Support System:** Android & IOS

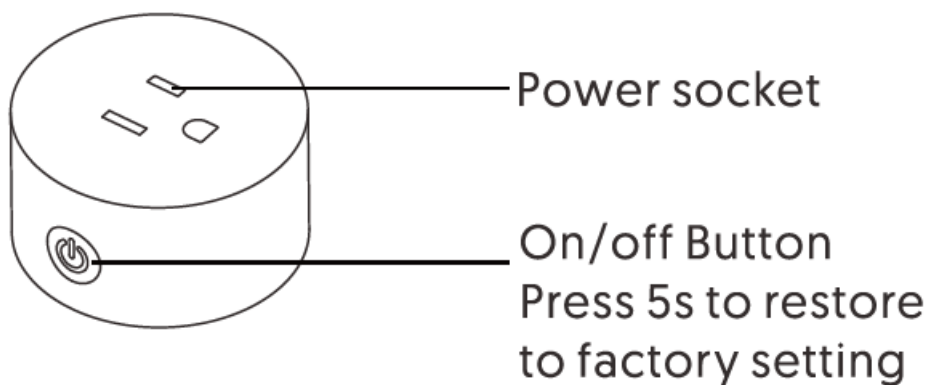

## Download & Registration

- Scan the QR code to download "Smart Life" APP, you can also search "Smart Life" from app store or Google play to install the APP.
- Run the "Smart Life " APP, tap "Register" to register a "Smart Life" account with your phone number or email. Then sign in the APP.



### **Add devices in Easy Mode**

1. Make sure your smart device is energized and your mobile phone is connected to your WiFi (2.4 GHz). Long press the power button for 5 seconds until the indicator light begin to flash quickly [2 times per second about), this means the device is already for configuration.
2. Launch your 'Smart Life' APP and tap+on the top right of the APP. Select device type. Tap it and "Confirm indicator light rapidly blink". These will automatically fetch the password of the Wi-Fi network that your mobile phone connects to. Then tap "Confirm" to connect to the device.
3. When appears "Successfully added 1 device", it means the connection is complete and your device will be listed in your APP list.

### **Add devices in AP mode**

1. If failed in Easy Mode, users could add device in AP mode.
2. Long press the power button for more than 5 seconds until the indicator light flash quickly. then long press it for another 5 seconds until the indicator light flash slowly.
3. Tap "+" on the top right of the APP, select Device type. Then tap "AP Mode" on the top right, "Confirm indicator light slowly blink" and "Confirm", Tap "Connect now" to go to the WLAN Settings interface in your mobile phone and select the Wi-Fi network named "SmartLife\_XXXX" to connect it.
4. Return to the Smart Life APP, the connection will start automatically.
5. When appears "Successfully added 1 device", it means the connection is complete.

Now you can control your smart plug via your mobile phone APP anytime and anywhere [make sure your mobile phone and smartplug are all connected to the network.] You can share your devices with your friends or family after you add your devices succesfully. More functions you will enjoy refer to the picture.

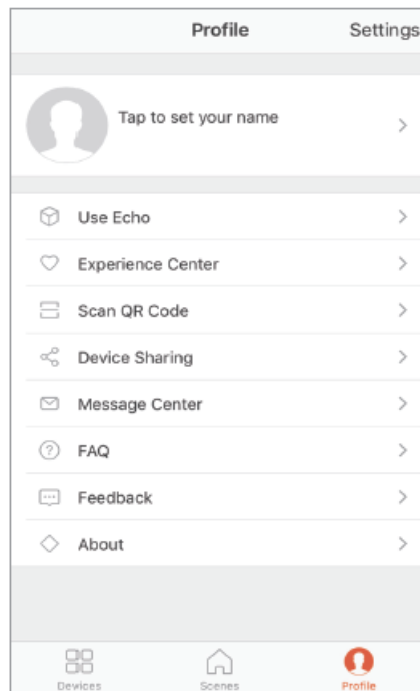

## Notices

1. Please check if there is damage caused by transportation, if yes, please contact supplier for replacement.
2. Please follow the instruction and notice to keep products in a good and safe use condition.
3. Put the socket in proper condition and out of reach of the children.
4. Plug in fully to the socket while using
5. The total power of being electric connected appliances could not be bigger than the maximum power of the socket.
6. Do not disassemble or install the socket, otherwise there may cause security risks.

## Quick Guide of Using Google Home

### Preparation

- A Google Home device, or an Android phone with Google Assistant.
- Latest Google Home APP [Android Only) and a Google account
- The device display language must be set to English US.
- Smart Life APP and a related account Smart device

Sign in the Smart Life account, add the device, then change the name to a easily recognized word or phrase, like “bedroom light”.

### Set up Google Home with Google Home APP

1. Run the Google Home APP and sign in a Google account. Then connect the Google Home APP with your Google Home device according to the Instruction of Google Home.
2. Choose the Wi-Fi network you want to connect to your Google Home. Then connect it to your Google Home according to the Instruction. Make sure your Google Home APP and Google Home are in the same Wi-Fi network.

## Link Smart Life account in Home Control

Attention: Due to the Google Home APP's known bug, you could use only one Google Home account to control "Home Control Action". If you sign in Google Home APP with several Google account you signed in can be used for "Home Control".

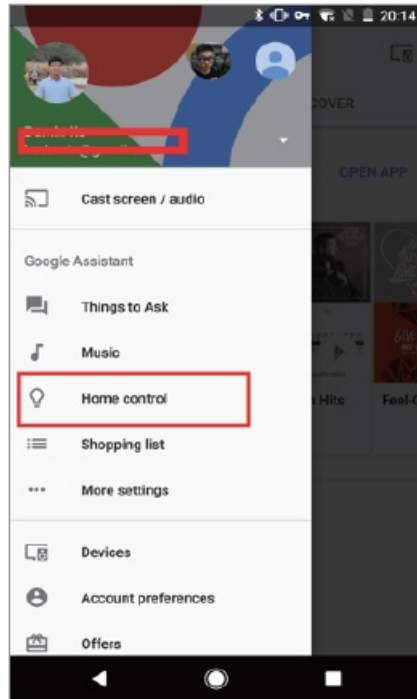

Tap "Home Control" in the hamburger menu on the Google Home App's Home Page, then tap "+". Find "Smart Life" in the list. In the new window, select your Smart Life account region, type your Smart Life account and password, then tap "Link Now". After you assign rooms for devices will be listed in the Home Control page.

## Control your smart devices through Google Home

Now you can control your smart device through Google Home. Take bedroom light as the example, the supported voice commands are as below: OK Google, turn on/off bedroom light.

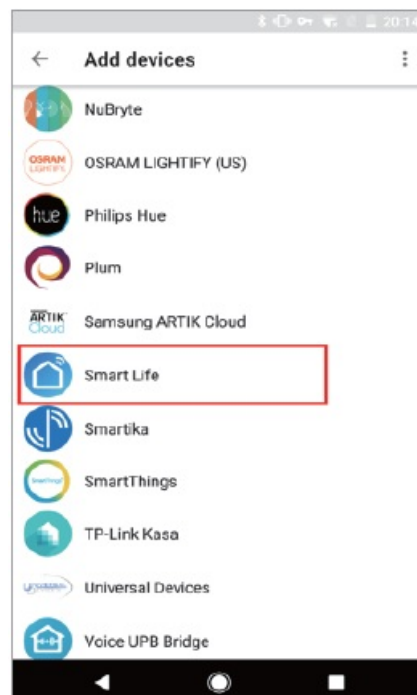

## Quick Guide of Using Amazon Echo

## **Preparation**

- Amazon Alexa APP and account.
- Smart Life APP and account.
- An Echo device, (Echo, Echo Dot and Echo Tap.)
- Smart device.

Sign in the Smart Life account, add the device, then change the name to a easily recognized word or phrase, like “bedroom light”.

## **Set up Echo with Amazon ALEXA APP**

1. Sign in with Amazon account. Tap the Homepage on the top left, tap “Setting” and “Set up a new device”. Then follow the instructions.
2. Select an Echo device, long press the dot button on the top of your Echo device until the orange light shows up and tap “Continue”. Then select your Wi-Fi network and connect it to your device according to the instructions. This may take several minutes.

### **Enable our skill in Alexa APP**

3. Tap the Homepage, select “Skills”, then search “Smart Life”. Select “Smart Life” and tap “Enable Skill” to enable the Smart Life Skill.
4. You will be redirected to the account link page. Type your Smart Life account and password, do not forget to select the country/region where your account belongs to. Then tap “Link Now” to link your Smart Life account. When “Alexa has been successfully linked with Smart Life” shows up. you can leave this page. [Note: If a Smart Life account has been linked before, you can use it directly, or you can also tap “Disable Skills” to remove it).

## **Control your smart device through Echo**

Echo need to discover you smart device before the control.



You can say “Alexa, discover device” to Echo, or you can also tap “Discover Device” on APP to discover the smart devices. Discovered devices will be shown in the list.

**(Note:** Every time you change the name of devices on Smart Life APP, Echo must re discover devices before the control.)

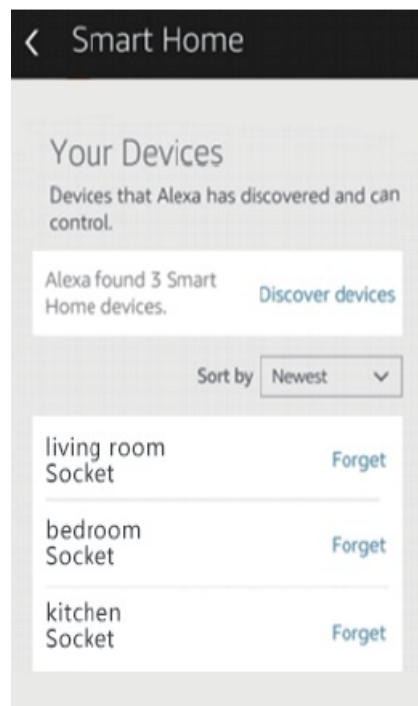

Now you can control your smart devices through Echo. You can use following commands to control your devices [e.g., bedroom light) Alexa, turn on/off bedroom light. You can also set up groups in Alexa APP. Tap “Create group”, give your group a name like “my smart lights”, select devices to add them in this group, then tap “Save”. Now you can control your devices by group. If you say ” Alexa turn on my smart lights”, all the lights will be turned on.

## Warranty

This product carries a one-year warranty from purchase date. Please feel free to let us know what we can do to

assist you when you have any product problem. bototek customer service email addresses:  
[bototektech@outlook.com](mailto:bototektech@outlook.com)

**Documents / Resources**

	<a href="#">bototek SP10 Smart Plug Bototek Mini WiFi Plugs Work</a> [pdf] User Manual SP10 Smart Plug Bototek Mini WiFi Plugs Work, SP10, Smart Plug Bototek Mini WiFi Plugs Wo rk, Plug Bototek Mini WiFi Plugs Work, Bototek Mini WiFi Plugs Work, Mini WiFi Plugs Work, W iFi Plugs Work, Plugs Work, Work
---	---

**References**

-  [Amazon.com. Spend less. Smile more.](#)