

BOTEX WDMX Battery TX IP



BOTEX WDMX Battery TX IP User Guide

[Home](#) » [BOTEX](#) » BOTEX WDMX Battery TX IP User Guide 

Contents

- [1 BOTEX WDMX Battery TX IP](#)
- [2 Product Information](#)
- [3 Product Usage Instructions](#)
- [4 Safety instructions](#)
- [5 Features](#)
- [6 Connections and controls](#)
- [7 Operation](#)
- [8 Technical specifications](#)
- [9 Environment](#)
- [10 Documents / Resources](#)
 - [10.1 References](#)



BOTEX WDMX Battery TX IP

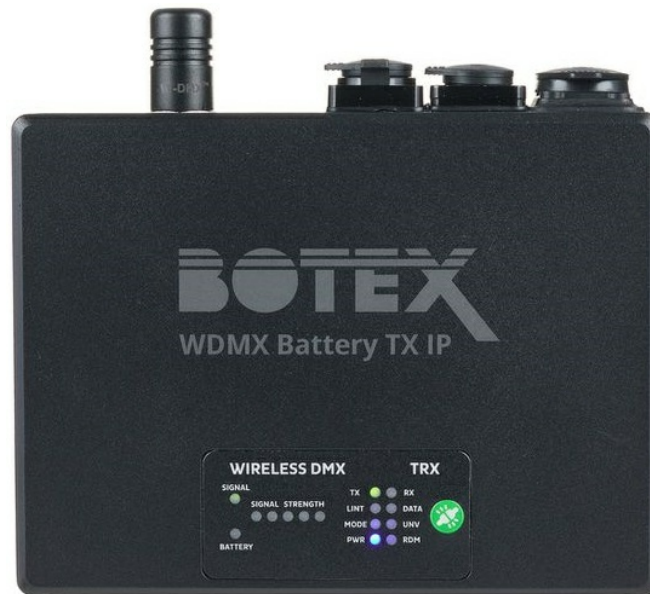

Product Information

Specifications:

- **Product Name:** WDMX Battery TX IP
- Quick Start Guide included
- High voltage present – do not remove covers
- Electromagnetic field emission during operation
- Radio interference due to electromagnetic signals

Product Usage Instructions

Safety Instructions:

1. Do not remove any covers as high voltage is present inside the device.
2. Always use a properly insulated, triple-core mains cable to prevent short circuits.
3. Ensure devices are securely installed to prevent falling and potential injuries.
4. Keep the device away from other electrical receivers to avoid interference.
5. Observe correct battery polarity to prevent fires and damage.
6. Remove batteries if the device will not be used for an extended period to prevent leakage damage.
7. Use a suitable mat or felt slide under rubber feet to prevent staining of floors.
8. Avoid using liquid cleaners or exposing the device to impurities.

Instructions for Use:

1. Ensure all safety equipment and covers are intact before using the device.
2. Keep the device at a safe distance from other electronic devices to prevent interference.
3. Check battery polarity before insertion and remove batteries if not in use for a long time.
4. Securely install the device following country-specific standards and regulations.
5. Regularly check for any signs of damage or wear and tear on the device.

Frequently Asked Questions (FAQ)

- **Q: Can I use the device near radios or TV sets?**

A: It is not recommended as it may cause interference. Keep a safe distance between the device and such receivers.

- **Q: How do I prevent staining from the rubber feet?**

A: Place a suitable mat or felt slide under the rubber feet to avoid direct contact with the floor.

Quick start guide

This document contains important information on the safe use of the product. Read and follow the safety instructions and all other instructions. Keep the document for future reference. If you pass the product on to others, please include this document. Contents are subject to change. Please refer to the latest version of the documentation, which is available for download at www.thomann.de.

Safety instructions

Intended use

This device is intended for the wireless transmission of DMX signals in lighting systems. Any other use or use under other operating conditions is considered to be improper and may result in personal injury or property damage. No liability will be assumed for damage resulting from improper use. This device may be used only by persons with sufficient physical, sensory, and intellectual abilities and the necessary knowledge and experience. Other persons may use this device only if they are supervised or instructed by a person who is responsible for their safety.

- **Risk of injury and choking hazard for children!**

Children can suffocate on packaging material and small parts. Children can injure themselves when handling the device. Never allow children to play with the packaging material and the device. Always store packaging material out of the reach of babies and small children. Always dispose of packaging material properly when it is not in use. Never allow children to use the device without supervision. Keep small parts away from children and make sure that the device does not shed any small parts (such as knobs) that children could play with.

- **Risk of death from electrical current!**

The device contains parts where high voltage is present. Never remove any covers. There are no user-serviceable parts inside the device. Do not use the device if covers, safety equipment or optical components are missing or damaged.

- **Risk of death from electrical current!**

A short circuit can cause fires and loss of life. Always use a properly insulated, triple-core mains cable. Do not modify the mains cable. If the insulation is damaged, immediately switch off the power supply and have it repaired. If in doubt, contact a qualified electrician.

- **Incorrect handling of lithium batteries can result in injury!**

In the event of a short circuit, overheating or mechanical damage, lithium batteries can cause severe injuries. Handle lithium batteries correctly and professionally. Store lithium batteries in a cool and dry place in their original packaging. Keep lithium batteries away from sources of heat. Never open lithium batteries. Only charge rechargeable lithium batteries with a suitable charger. Remove the lithium batteries before disposing of the device. Cover the poles of used lithium batteries with adhesive tape to prevent short circuits. Electrolytes can escape from damaged lithium batteries. Put the damaged lithium battery in air-tight packaging. Collect the electrolyte with absorbent paper. Wear rubber gloves while doing so.

- **Risk of injury from falling devices that were inadequately secured!**

If devices are not properly secured during their installation, they can cause severe injury and considerable damage by falling. Make sure that the standards and regulations that apply in your country are always observed during installation and operation. Always secure the device with a secondary safety attachment, such as a safety cable or a safety chain.

- **Interference with neighbouring electrical receivers due to electromagnetic field!**

The device emits an electromagnetic field during operation. Using the device near receiver devices (e.g. radios or TV sets) may cause interference. If the device interferes with neighbouring receivers during operation, increase the distance between the device and the receivers with interference.

- **Radio interference due to electromagnetic fields!**

The device emits electromagnetic radio signals. Overlapping radio waves can cause interference with the device and other devices. Do not use the device in locations where the use of wireless devices is prohibited.

- **Risk of fire due to incorrect polarity!**

Incorrectly inserted batteries can cause fires and destroy the device and the batteries. Observe the markings on the batteries and the device. Ensure that proper polarity is observed when inserting batteries.

- **Possible damage due to leaking batteries!**

Batteries can leak and cause permanent damage to the device. Remove the batteries from the device if it is not going to be used for an extended period.

- **Possible damage to lithium-ion batteries through incorrect storage!**

Deep discharge can permanently damage lithium-ion batteries or cause them to lose some of their capacity. Charge the lithium-ion batteries before longer breaks in use and before storage. Ensure that the device is switched off for storage. Store the device at room temperature or cooler in an environment as dry as possible. Recharge the lithium-ion batteries about every three months if they are stored for a longer time to avoid permanent damage due to too deep self-discharge. Fully charge the lithium-ion batteries at room temperature immediately before use.

- **Possible staining due to plasticiser in rubber feet!**

The plasticiser contained in the rubber feet of this product may react with the coating of the floor and cause permanent dark stains after some time. If necessary, use a suitable mat or felt slide to prevent direct contact between the device's rubber feet and the floor.

- **General handling**

- To prevent damage, never exert force while operating the device.
- Never immerse the device in water. Wipe only with a clean and dry cloth. Do not use liquid cleaners such as benzene, thinners or flammable cleaning agents

- **Keep the device away from impurities!**

Keep the device away from containers with liquid. Should liquid enter the device, this could lead to its destruction or fire. Ensure that no metallic parts enter the device.

Features

- Battery-powered outdoor WDMX transceiver/wireless solution WDMX module
- Suitable for outdoor use
- Can be configured as a transmitter and receiver
- Flexible assembly on truss with M10 thread, omega bracket and velcro
- Latency-free wireless transmission of DMX signals up to 700 m
- High reliability

- Easy and simple operation
- Power supply: Seetronic Power Twist TR1
- DMX input/output: Seetronic XLR panel socket, 3-pin
- RDM
- Battery life: 80 hours as a transmitter, up to 440 hours as a receiver
- IP66

Connections and controls

1. [POWER IN] | Power Twist input
2. [DMX IN] | XLR panel socket, 3-pin
3. [DMX OUT] | XLR panel socket, 3-pin
4. Antenna
5. [SWITCH] | On and off switch

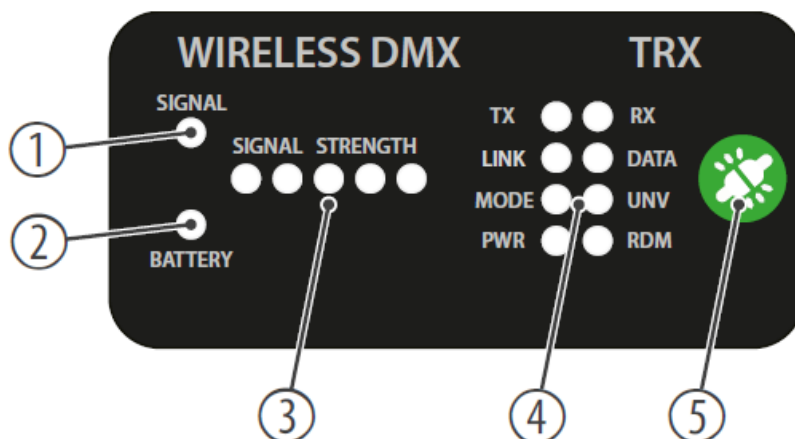
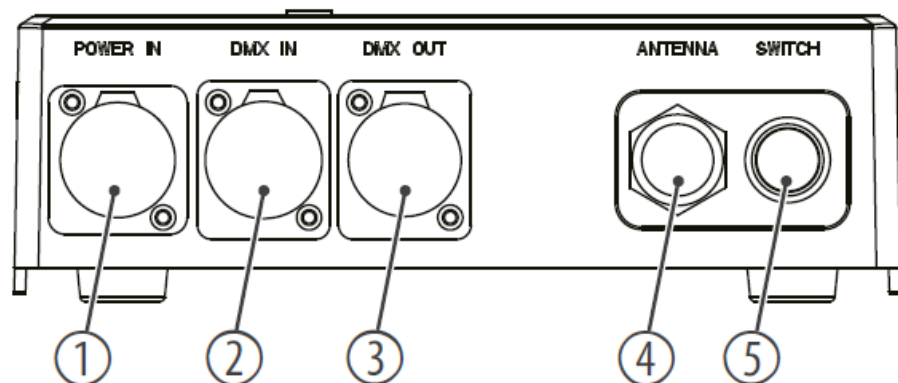

1. [SIGNAL] | Indicator LED

Lights up if there is a connection.

2. [BATTERY] | Indicator LED

- **Lights up green:** The battery is fully charged.
- **Lights up red:** The battery is charging.

3. [SIGNAL STRENGTH] | Indicator LEDs

Depending on whether the device is operating as a transmitter or receiver:

- **Transmitter:** Indicates the set transmission power.
- **Receiver:** Indicates the quality of the received signal.

4. Indicator LEDs

- [TX] | The Device is operating as a transmitter.
- [RX] | Device is operating as a receiver.
- [LINK] | Device is operating as a transmitter:
- On: The device is ready to establish a connection.

The device operates as a receiver:

- Off: The device is not connected to a receiver.
- On: The device is connected to a receiver.
- Flashing: The device is paired with a receiver, but there is no connection.
- [DATA] | Off No data transmission.
- Lights up green: DMX data in use.
- Lights up red: RDM data in use.
- [MODE] | Indicates radio mode.
- [UNV] | No function
- [PWR] | Lights up when the device is on
- [RDM] | Flashes when RDM signals are being received.

5. Connect button

Operation

Connecting the device (only as a transmitter)

1. Briefly press the connect button.
 - The [LINK] LED flashes.
 - The device connects to all receivers that are ready for connection.

Breaking the connection

1. Hold down the connect button for 3 seconds.

Switching the device between receiver (RX) and transmitter (TX)

1. Briefly press the connect button 5 times.
2. Hold down the connect button for 3 seconds.
3. Press the connect button to switch between RX and TX.
 - The selection is indicated by flashing the relevant LED.
4. Hold down the connect button to confirm the selection.

Technical specifications

- Number of DMX channels 512
- **Input connections**
 - Power supply Lockable input socket (Power Twist TR1)
 - DMX control 1 × XLR panel socket, 3-pin

- **Output connections**

- Power supply Lockable output socket (Power Twist TR1)
 - DMX control 1 × XLR panel socket, 3-pin

- Frequency range 2.4 GHz...5.8 GHz

- **W-DMX**

- Max. transmission power 24 dBm
 - Max. range 700 m without obstacles

- Power consumption 100 mW...450 mW

- Supply voltage 100 – 240 V ~ 50/60 Hz

- **Battery**

- Battery type Rechargeable lithium-ion battery
 - Voltage 3.67 V
 - Capacity 3,100 mAh
 - Charging time 4 h
 - Operating time Approx. 80 has a transmitter, approx. 440 has a receiver

- International Protection Rating IP66

- Mounting options Hanging, standing

- Installation properties Omega bracket with M10 thread

- Dimensions (W × H × D), with antenna 185 mm × 170 mm × 59.6 mm

- Weight 1.8 kg

- Ambient conditions

- Temperature range 0 °C...40 °C
 - Relative humidity 20%...80% (non-condensing)

Environment



- Environmentally friendly materials have been chosen for the packaging. These materials can be sent for normal recycling. Ensure that plastic bags, packaging, etc. are disposed of properly. Do not dispose of these materials with your normal household waste, but make sure that they are collected for recycling. Follow the instructions and markings on the packaging.



- Batteries must not be thrown away or burnt, but must instead be disposed of in line with the local regulations on the disposal of hazardous waste. Use the available collection sites. Only dispose of lithium batteries when they are empty. Remove lithium batteries from the device before disposal if this is possible without destroying it. Protect used lithium batteries against short circuits, for example by tapping the poles. Dispose of the built-in lithium batteries together with the device. Check for an appropriate collection facility. Dispose of the batteries and rechargeable batteries at the appropriate collection points or through your local waste facility.



- This product is subject to the European Waste Electrical and Electronic Equipment Directive (WEEE) as amended. Do not dispose of your old device with your normal household waste; instead, deliver it for controlled disposal by an approved waste disposal firm or through your local waste facility. If in doubt, consult your local waste management facility. You can also return the device to a retailer

if they offer to take the device back for free or if they are legally obliged to do so. When disposing of the device, comply with the rules and regulations that apply in your country. You can also return your old device to Thomann GmbH at no charge. Check the current conditions on www.thomann.de. Proper disposal protects the environment as well as the health of your fellow human beings. This is because the proper handling of old devices negates the potential negative effects of hazardous substances and because it conserves resources by recycling them. Also, note that waste avoidance is a valuable contribution to environmental protection. Repairing a device or passing it on to another user is an ecologically valuable alternative to disposal. If your old device contains personal data, delete that data before disposing of it.

-  Observe the disposal note regarding documentation in France.

Thomann GmbH • Hans-Thomann-Straße 1 • 96138 Burgebrach • www.thomann.de • info@thomann.de.

Documents / Resources

	BOTEX WDMX Battery TX IP [pdf] User Guide WDMX Battery TX IP, Battery TX IP, TX IP, IP, WDMX Battery, Battery
---	--

References

- [🇹 Buy musical instruments online from the market leader – Thomann UK](#)
- [User Manual](#)

[Manuals+](#), [Privacy Policy](#)

This website is an independent publication and is neither affiliated with nor endorsed by any of the trademark owners. The "Bluetooth®" word mark and logos are registered trademarks owned by Bluetooth SIG, Inc. The "Wi-Fi®" word mark and logos are registered trademarks owned by the Wi-Fi Alliance. Any use of these marks on this website does not imply any affiliation with or endorsement.