



## BOSS RC-5 Loop station Owner's Manual

[Home](#) » [Boss](#) » BOSS RC-5 Loop station Owner's Manual

### Contents [ [hide](#) ]

- 1 BOSS RC-5 Loop station
- 2 INTRODUCTION
- 3 Connections
- 4 Basic Operation
- 5 Use of Battery
- 6 Changing the Battery
- 7 Main Specifications
- 8 Documents / Resources
- 9 Related Posts



**BOSS RC-5 Loop station**



## INTRODUCTION

Before using this unit, carefully read the sections entitled: "USING THE UNIT SAFELY" and "IMPORTANT NOTES" (supplied on a separate sheet). After reading, keep the document(s) where it will be available for immediate reference.

## Panel Descriptions

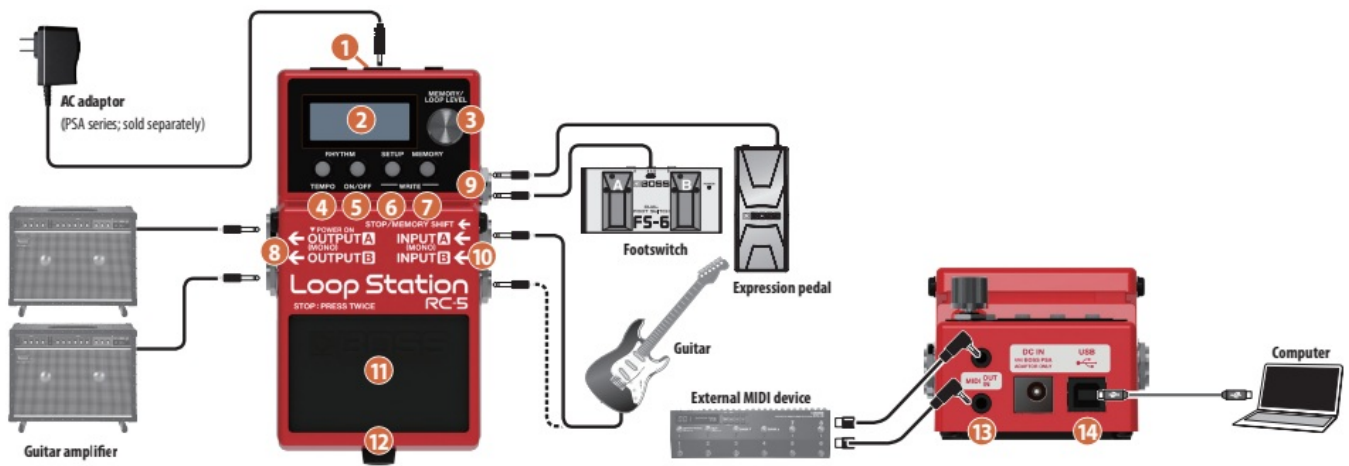

1	DC IN jack	<p>Accepts connection of an AC Adaptor (PSA series; sold separately). By using an AC Adaptor, you can play without being concerned about how much battery power you have left.</p> <ul style="list-style-type: none"> <li>* Use only the specified AC adaptor (PSA-series).</li> <li>* If the AC adaptor is connected while a battery is installed, the power supply is drawn from the AC adaptor.</li> </ul>
2	Display	<p>Shows various information of the RC-5.</p> <p>During recording/playback/overdubbing, the color of the screen changes according to the status.</p> <ul style="list-style-type: none"> <li>* Never strike or apply strong pressure to the display.</li> </ul>
3	[MEMORY/LOOP LEVEL] knob	<p>(*) on the power is called the "Play screen." <b>01 01</b></p> <p>The screen that appears after you turn <b>Memory</b></p> <p><b>Turn while pressing</b> Changes a value in larger steps.</p>
4	RHYTHM [TEMPO] button	<p>Press to specify the tempo (40.0–300.0) of the rhythm.</p> <p>You can also set the tempo by pressing the button at the desired interval (tap tempo).</p>

5	<b>RHYTHM</b> <b>[ON/OFF] button</b>	<p><b>Sounding a rhythm</b></p> <p>The rhythm switches on (lit)/off (unlit)/ready to play rhythm (blink)c each time you press the button.</p> <p>You can record while listening to a rhythm at the tempo you specify.</p> <p>Long-press the button (two seconds or longer) to select rhythm settings mode.</p>
6	<b>[SETUP] button</b>	Lets you make settings that affect the entire RC-5 (the function of a foot switch or expression pedal connected to this unit, and system settings).
7	<b>[MEMORY] button</b>	<p>Lets you make settings related to loop playback and recording, rhythm settings, and memory name settings.</p> <p>If the track of the selected memory is already recorded, the button is lit green.</p>

Name	Explanation
8 OUTPUT jacks A (MONO), B	<p>Connect these jacks to your amp or monitor speakers. If you're using a mono setup, use only the A (MONO) jack.</p> <p>Even sound that is input in stereo is output in mono.</p> <p><b>Turning the power on/off</b></p> <p>The OUTPUT A (MONO) jack doubles as the power switch. Power to the unit is turned on when you plug into the OUTPUT A (MONO) jack; the power is turned off when the cable is unplugged.</p>
9 STOP/MEMORY SHIFT jack	<p>Connect a separately sold footswitch or expression pedal to this jack.</p> <p>This lets you control a variety of functions: you can use a footswitch to stop recording/playback/overdubbing or to switch memories, and you can use an expression pedal to operate various parameters.</p> <p>* Use only the specified expression pedal (FV-500H, FV-500L, EV-30, and Roland EV-5; sold separately). By connecting any other expression pedals, you risk causing malfunction and/or damage to the unit.</p> <p><b>NOTE</b></p> <p>When connecting an external pedal, you must turn off the power before connecting or disconnecting cables. Failure to observe this precaution will cause malfunctions.</p>
10 INPUT jacks A (MONO), B	<p>Connect your guitar/bass or effect unit to these jacks.</p> <p>Use the A (MONO) jack and B jack when connecting a stereo-output effects unit. Use only the A (MONO) jack if you're using a mono source.</p>
11 Pedal switch	<p>This pedal switches you between phrase recording, playback, and overdubbing. Press the pedal twice in succession to stop playback.</p> <p><b>Undo/Redo</b></p> <p>Hold down the pedal two seconds or longer during playback or overdubbing to Undo (cancel the recording or the last overdubbing). Hold down the switch once again for two seconds or longer to Redo (cancel the Undo).</p> <p><b>Clear</b></p> <p>Hold down the pedal two seconds or longer while stopped, the recorded phrase is cleared.</p>
12 Thumbscrew	<p>When this screw is loosened, the pedal will open, allowing you to change the battery.</p> <p>➔ "Changing the Battery"</p>
13 MIDI IN, OUT connectors	<p>Connect an external MIDI device here.</p> <p>To make these connections, use TRS/MIDI connecting cables (sold separately: BMIDI-5-35).</p> <p>This lets you control an external MIDI device from this unit via MIDI.</p>
14 USB port	<p>You can connect your computer here and use it to back up or recover data.</p>

For more information, refer to "Reference Manual" (PDF).

- Access the following URL. [https://roland.cm/boss\\_om](https://roland.cm/boss_om)
- Choose "RC-5" as the product name.



## Connections

- To prevent malfunction and equipment failure, always turn down the volume, and turn off all the units before making any connections.
- Do not use connection cables that contain a built-in resistor.
- Before turning the unit on/off, always be sure to turn the volume down. Even with the volume turned down, you might hear some sound when switching the unit on/off. However, this is normal and does not indicate a malfunction.
- To prevent malfunction and equipment failure, always turn down the volume, and turn off all the units before making any connections.
- Do not use connection cables that contain a built-in resistor.
- Before turning the unit on/off, always be sure to turn the volume down. Even with the volume turned down, you might hear some sound when switching the unit on/off. However, this is normal and does not indicate a malfunction.

## Basic Operation

### Getting ready to record

Turn the [MEMORY/LOOP LEVEL] knob to select a memory (1–99)

Screen	Status
Blue	Empty track
White	Track contains data

**Track:** Record and play back audio from an instrument such as guitar.

**Memory:** The one track, together with the “rhythm” settings, are collectively called a “memory.” The RC-5 can store up to 99 memories

### Creating a loop phrase

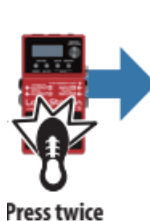

**Stop**  
Screen: Lit white  
**During overdubbing or loop playback, you can stop by pressing the pedal twice in succession.**  
\* Press the pedal twice within one second.

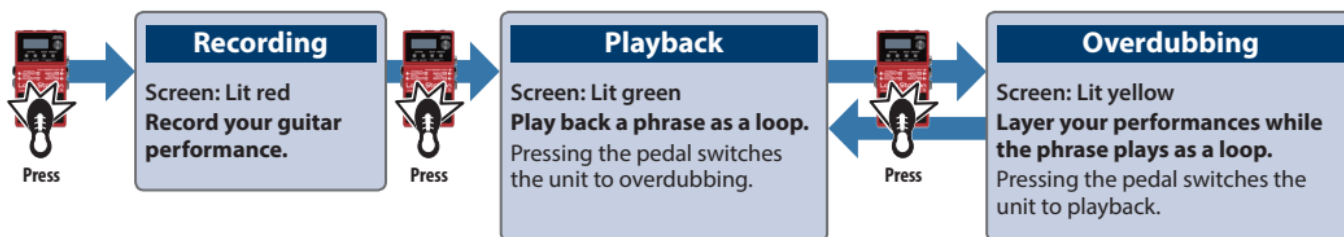

**Technique for stopping** Example: When you want to stop at the end of a measure with a 4/4 time signature Press the pedal one time at the beginning of the fourth beat, then press it once again at the beginning of the first beat of the next measure.

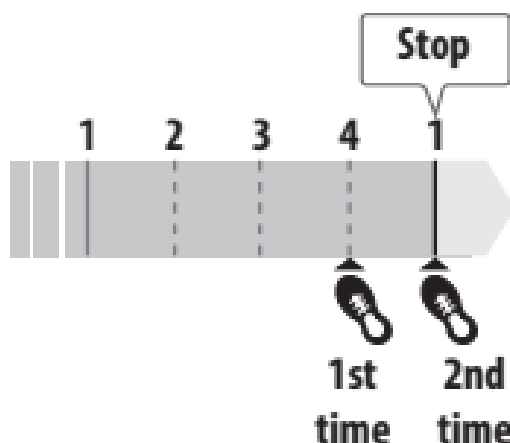

## Saving a Memory (WRITE)

If you select a different memory or turn off the power after recording or editing the settings, the recorded content or edited settings will be lost. If you want to keep the data, you must save it.

- Press the [SETUP] button and [MEMORY] button simultaneously. The UTILITY screen appears



- Turn the [MEMORY/LOOP LEVEL] knob to select "WRITE," and press the [MEMORY/LOOP LEVEL] knob



- Turn the [MEMORY/LOOP LEVEL] knob to select the savedestination memory. This procedure is not required if the memory number is acceptable as is. If you decide to cancel, press one of the RHYTHM [TEMPO]–[MEMORY] buttons.
- Press the [MEMORY/LOOP LEVEL] knob. The memory will be saved.

## Settings for the Entire RC-5 (SETUP)

- Press the [SETUP] button.
  - The SETUP screen appears.



2. Turn the [MEMORY/LOOP LEVEL] knob to select the item that you want to edit, and press the [MEMORY/LOOP LEVEL] knob.

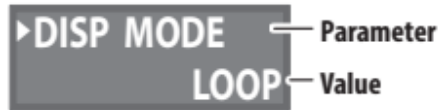

3. Turn the [MEMORY/LOOP LEVEL] knob to select the parameter that you want to edit, and press the [MEMORY/LOOP LEVEL] knob.



4. Turn the [MEMORY/LOOP LEVEL] knob to change the value.
5. Press the [SETUP] button to return to the play screen.

## Use of Battery

- Batteries should always be installed or replaced before connecting any other devices. This way, you can prevent malfunction and damage.
- If operating this unit on batteries, please use alkaline batteries.
- If you handle batteries improperly, you risk explosion and fluid leakage. Make sure that you carefully observe all of the items related to batteries that are listed in “USING THE UNIT SAFELY” and “IMPORTANT NOTES” (supplied on a separate sheet).

## Changing the Battery

- Hold down the pedal and loosen the thumbscrew , then open the pedal upward.
  - The pedal can be opened without detaching the thumbscrew completely.
- Remove the old battery from the battery housing , and remove the battery snap connected to it.
- Connect the battery snap to the new battery, and place the battery inside the battery housing.
  - Be sure to carefully observe the battery's polarity (+ versus -).
- Slip the coil spring onto the spring base on the back of the pedal, and then close the pedal.
  - Carefully avoid getting the battery snap cord caught in the pedal, coil spring, and battery housing.
- Insert the thumbscrew into the guide bush hole and tighten it securely..

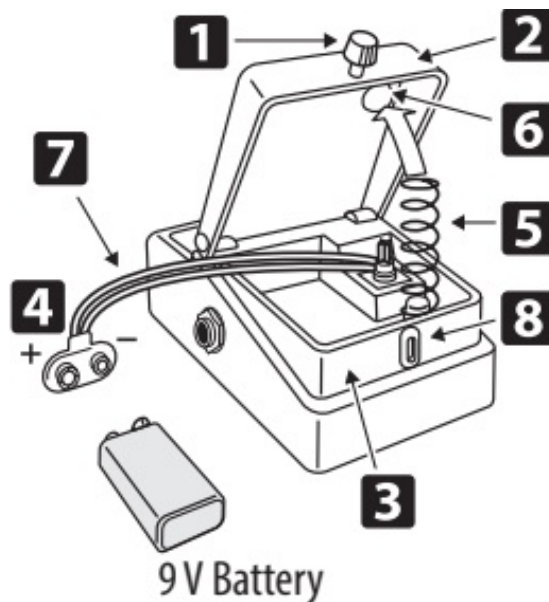

## Main Specifications

<b>Power Supply</b>	Alkaline battery (9 V, 6LR61 or 6LF22) AC adaptor (PSA series: sold separately)	
<b>Current Draw</b>	170 mA * Expected battery life under continuous use (These figures will vary depending on the actual conditions of use.) Alkaline: Approx. 2 hours	
<b>Dimensions</b>	73 (W) x 129 (D) x 56 (H) mm	2-7/8 (W) x 5-1/8 (D) x 2-1/4 (H) inches
<b>Weight</b>	450 g/1 lb (including battery)	
<b>Accessories</b>	Leaflet ("USING THE UNIT SAFELY," "IMPORTANT NOTES," and "Information") Alkaline battery (9 V, 6LR61 or 6LF22)	
	AC adaptor: PSA series	
	Footswitch: FS-5U	
<b>Options</b>	Dual Footswitch: FS-6, FS-7	
<b>(sold separately )</b>	Expression Pedal: FV-500H, FV-500L, EV-30, Roland EV-5	
	TRS/MIDI connecting cable:	
	BMIDI-5-35, BMIDI-1-35, BMIDI-2-35, BCC-1-3535, BCC-2-3535	

## Documents / Resources

	<a href="#">BOSS RC-5 Loop station</a> [pdf] Owner's Manual RC-5 Loop station, Loop station
---	--