

BOSE[®]
Sound Dock Digital
Music System



BOSE Sound Dock Digital Music System Instruction Manual

[Home](#) » [Bose](#) » BOSE Sound Dock Digital Music System Instruction Manual 

Contents

- 1 [BOSE Sound Dock Digital Music System](#)
- 2 [Product Usage Instructions](#)
- 3 [IMPORTANT SAFETY INSTRUCTIONS](#)
- 4 [FCC STATEMENT](#)
- 5 [Unpacking and setting up](#)
- 6 [Using your iPod/iPhone](#)
- 7 [Using the remote](#)
- 8 [Maintaining the system](#)
- 9 [Troubleshooting](#)
- 10 [Warranty](#)
- 11 [Technical Information](#)
- 12 [FAQ](#)
- 13 [Documents / Resources](#)
 - 13.1 [References](#)
- 14 [Related Posts](#)

BOSE[®]

BOSE Sound Dock Digital Music System



Product Usage Instructions

- It is important to follow safety instructions to ensure proper operation and to prevent hazards:
- Avoid exposure to rain or moisture.
- Avoid dripping or splashing liquids on the system.
- Keep liquids away from the system to prevent failures or fire hazards.
- Follow all safety instructions in the owner's guide.
- Avoid installing near heat sources.
- Protect the power cord from damage.
- Use only manufacturer-specified attachments and accessories.
- Do not overload wall outlets or extension cords.

IMPORTANT SAFETY INSTRUCTIONS

Please read this owner's guide

Please take the time to carefully follow the instructions in this owner's guide.



It will help you set up and operate your system properly and enjoy all of its advanced features. Please save this owner's guide for future reference.

- **WARNING:** To reduce the risk of fire or electrical shock, do not expose the product to rain or moisture.
- **WARNING:** Do not expose the apparatus to dripping or splashing, and do not place objects filled with liquids, such as vases, on or near the apparatus.
- As with any electronic product, use care not to spill liquids into any part of the system. Liquids can cause a failure and/or a fire hazard.

CAUTION

- RISK OF ELECTRICAL SHOCK DO NOT OPEN

CAUTION: TO REDUCE THE RISK OF ELECTRIC SHOCK, DO NOT REMOVE COVER (OR BACK). NO USER-SERVICEABLE PARTS INSIDE. REFER SERVICING TO QUALIFIED PERSONNEL.

-  The lightning flash with arrowhead symbol, within an equilateral triangle, alerts the user to the presence of uninsulated dangerous voltage within the system enclosure that may be of sufficient magnitude to constitute a risk of electric shock.
-  The exclamation point within an equilateral triangle alerts the user to the presence of important operating and maintenance instructions in this owner's guide.

WARNINGS and CAUTIONS

- Keep the remote control battery away from children. It may cause a fire or chemical burn if mishandled. Do not recharge, disassemble, heat above 100° C (212° F), or incinerate. Dispose of used batteries promptly. Replace only with a battery of the correct type and model number.
- There is a danger of explosion if the battery is incorrectly replaced. Replace only with a Duracell, Eveready, Energizer, Maxell, Toshiba, Sanyo, CR2032, or DL2032 3-volt lithium battery.
- Make no modifications to the system or accessories. Unauthorized alterations may compromise safety, regulatory compliance, and system performance.
- Do not place any naked flame sources, such as lighted candles, on or near the apparatus.
- **NOTE:** The product label is located on the bottom of the product.
- **NOTE:** This product must be used indoors. It is neither designed nor tested for use outdoors, in recreation vehicles, or on boats.
- **NOTE:** This product is intended to be used only with the power supply provided.
- **NOTE:** Where the mains plug or appliance coupler is used as the disconnect device, such a disconnect device shall remain readily operable.



- Please dispose of used batteries properly, following any local regulations. Do not incinerate.
-  This product conforms to all EU Directive requirements as applicable by law. The complete Declaration of Conformity can be found at www.Bose.com/compliance.

1. Read these instructions for all components before using this product.
2. Keep these instructions for future reference.
3. Heed all warnings – on the product and in the owner's guide.
4. Follow all instructions.
5. Do not use this apparatus near water or moisture – Do not use this product near a bathtub, washbowl, kitchen sink, laundry tub, in a wet basement, near a swimming pool, or anywhere else that water or moisture are present.
6. Clean only with a dry cloth – and as directed by Bose Corporation.
Unplug this product from the wall outlet before cleaning.
7. Do not block any ventilation openings. Install by the manufacturer's instructions – To ensure reliable operation of the product and to protect it from overheating, put the product in a position and location that will not interfere with its proper ventilation. For example, do not place the product on a bed, sofa, or similar surface that may block the ventilation openings. Do not put it in a built-in system, such as a bookcase or a cabinet, that may keep air from flowing through its ventilation openings.

8. Do not install near any heat sources, such as radiators, heat registers, stoves, or other apparatus (including amplifiers) that produce heat.
9. Protect the power cord from being walked on or pinched, particularly at plugs, convenience receptacles, and the point where they exit from the apparatus.
10. Only use attachments/accessories specified by the manufacturer.
11. Use only with the cart, stand, tripod, bracket, or table specified by the manufacturer or sold with the apparatus.
When a cart is used, use caution when moving the cart/ apparatus combination to avoid injury from tip-over.



12. Unplug this apparatus during lightning storms or when unused for long periods to prevent damage to this product.
13. Refer all servicing to qualified service personnel. Servicing is required when the apparatus has been damaged in any way: such as power supply cord or plug is damaged; liquid has been spilled or objects have fallen into the apparatus; the apparatus has been exposed to rain or moisture, does not operate normally, or has been dropped – Do not attempt to service this product yourself. Opening or removing covers may expose you to dangerous voltages or other hazards. Please call Bose to be referred to an authorized service center near you.
14. To prevent the risk of fire or electric shock, avoid overloading wall outlets, extension cords, or integral convenience receptacles.
15. Do not let objects or liquids enter the product, as they may touch dangerous voltage points or short-out parts that could result in a fire or electric shock.
16. See the product enclosure for safety-related markings.
17. Use proper power sources – Plug the product into a proper power source, as described in the operating instructions or as marked on the product.

FCC STATEMENT

Information about products that generate electrical noise

If applicable, this equipment has been tested and found to comply with the limits for a Class B digital device, pursuant to Part 15 of the FCC rules.

These limits are designed to provide reasonable protection against harmful interference in a residential installation. This equipment generates, uses, and can radiate radio frequency energy and, if not installed and used in accordance with the instructions, may cause harmful interference to radio communications. However, this is no guarantee that interference will not occur in a particular installation. If this equipment does cause harmful interference to radio or television reception, which can be determined by turning the equipment off and on, you are encouraged to try to correct the interference by one or more of the following measures:

- Reorient or relocate the antenna in the device receiving the interference.
- Increase the separation between the equipment and receiver.
- Connect the equipment to an outlet on a different circuit than the one to which the receiver is connected.
- Consult the dealer or an experienced radio/TV technician for help.

This product complies with the Canadian RSS-310 Class B specification.

SOUNDDOCK® SERIES II DIGITAL MUSIC SYSTEM

- Thank you for your purchase. Congratulations on your choice of the SoundDock® Series II digital music system from Bose.
- Designed specifically to work with your iPod or iPhone, this system provides high-quality audio performance that invites your music to come out and play.
- Whether the music is from your iPod/iPhone or from another connected device, you'll find that it attracts a wide audience of people who love the sound.

Unpacking and setting up

- Check the carton for all of the parts shown.
- Save the carton for possible future use.
- It provides the best means to repack the system for transporting it outside your residence.

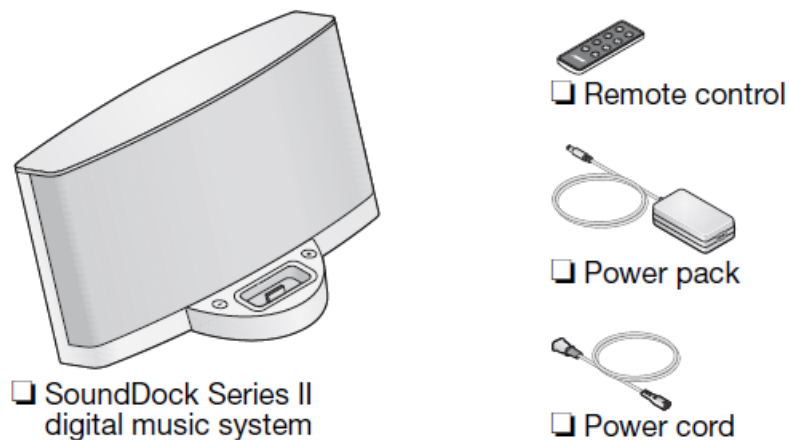

1. Place the system on a firm and level surface.
2. Plug the power pack into the DC POWER connector on the rear of the system.
3. Plug the small end of the power cord into the connector on the power pack.
4. Plug the other end of this cord into a wall outlet. You will hear a short tone indicating a power connection has been made.

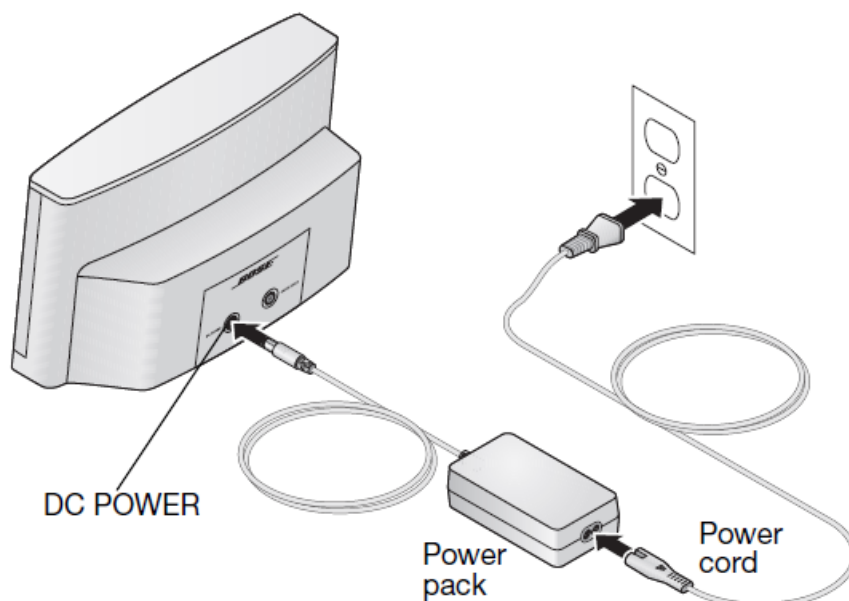

Using your iPod/iPhone

You can use the system right away with the universal dock adapter already installed. Or you can replace the installed adapter with the insert supplied with your iPod/iPhone.

With either the adapter or your insert in place:

1. Set your iPod/iPhone to play, then firmly insert it into the dock.

The system begins to play immediately.

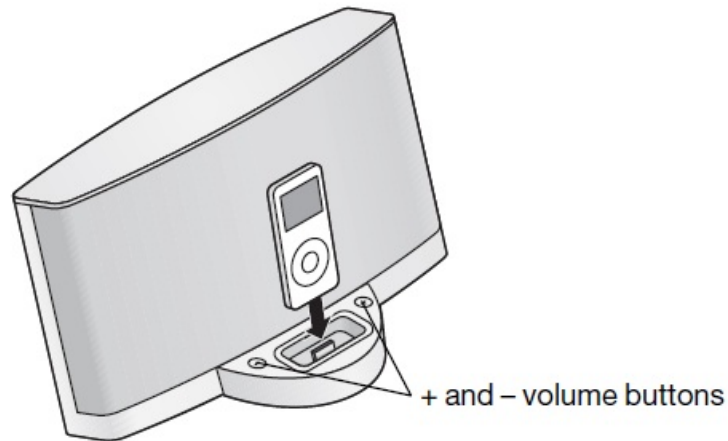

2. Adjust the volume using the buttons on the system dock or the remote control volume buttons.

Note: Whenever you press either button, a small light on the front of the system flashes briefly.

To replace the universal adapter:

1. Insert a fingernail into the adapter slot and pull up to remove the adapter from the well of the dock. Or use an object that fits into the slot to gently pry out the adapter.



2. Place your insert into the well and press on the edges until they are flush with the dock.

Using the remote

- Touch any button (except Off) to turn on the SoundDock system.

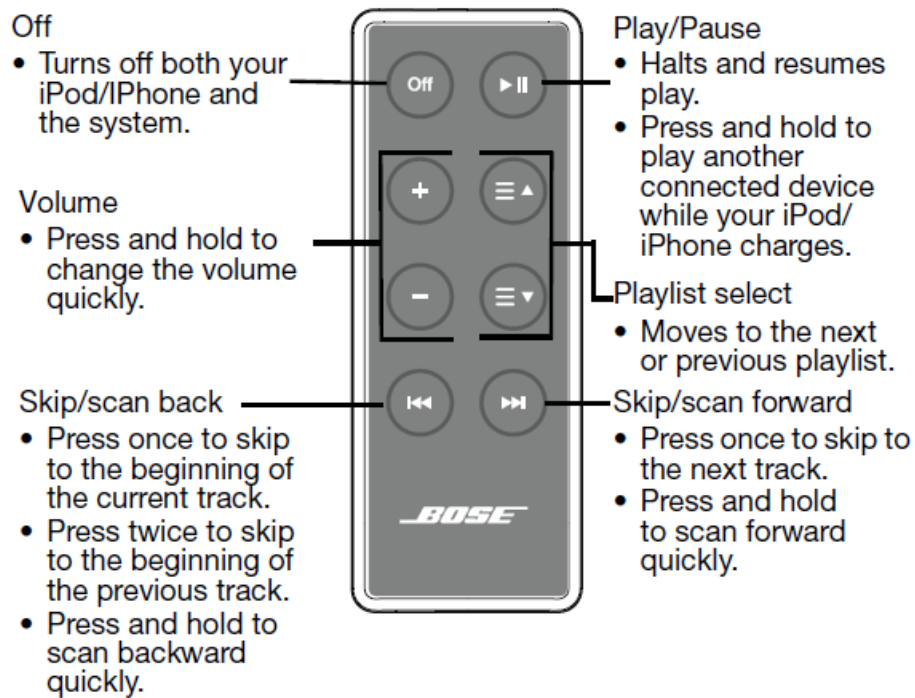

Note: Each time you press a button on the remote control, a small light on the front of the system flashes briefly.

Using another audio device

You can play another audio by connecting it to the system. This requires a cable with a 3.5mm mini plug at one end.

1. Set the audio device to slightly below full volume, then plug it into the AUDIO INPUT connector.

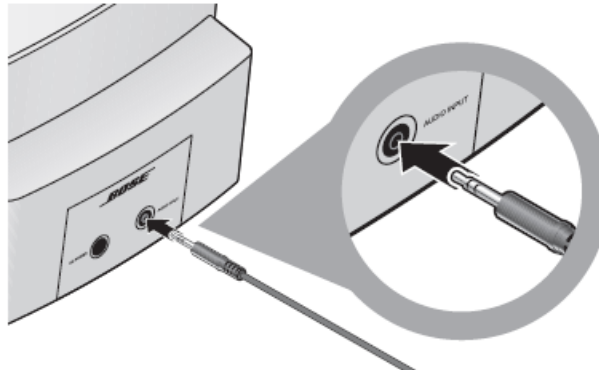

2. If your iPod/iPhone is in the system dock and charging, press and hold the Play/Pause button for three seconds to hear the other device.
3. Adjust the volume using the buttons on the system dock or the remote control volume buttons.
Other buttons on the remote do not control this other device. To return to listening to your iPod/iPhone, press the Play/Pause button once.

Maintaining the system

- Changing the remote control battery is the only regular maintenance that is required. You may also clean the system.

Replacing the remote battery

When the remote stops operating or its range seems reduced, it is time to change the remote battery.

1. Using a coin, turn the battery cover slightly counterclockwise.
2. Remove the cover and insert the new battery (CR2032 or DL2032) flat side up, with the + symbol in view.



3. Reseat the cover and turn it clockwise to lock it into place.



WARNINGS

- Keep the remote control battery away from children. It may cause a fire or chemical burn if mishandled. Do not recharge, disassemble, heat above 140°F (60°C), or incinerate.
- Dispose of used batteries promptly. Replace only with a battery of the correct type and model number.
- There is a danger of explosion if the battery is incorrectly replaced.
- Replace only with Duracell, Eveready, Energizer, Maxell, Toshiba, • • • • • or DL2032 3-volt lithium.

Cleaning the system

Wipe the system using a soft, dry cloth. You can also lightly vacuum the grille.

- Do not use solvents, chemicals, or sprays.
- Do not allow liquids to spill or objects to drop into any openings.

Troubleshooting

Problem	What to do
Your iPod/iPhone does not dock properly	<ul style="list-style-type: none"> • Remove your iPod/iPhone from the dock and check for obstructions on the connectors in the dock and on your iPod/iPhone. Then, reseat it in the dock. • Remove your iPod/iPhone from the dock, wait five seconds, then firmly reset it. You may need to do this a few times.
No sound	<ul style="list-style-type: none"> • Increase the volume setting for the system. • Increase the volume on the iPod/iPhone or your second audio device if it is playing. • Make sure the system is plugged in, your iPod/iPhone or other audio device is turned on, and the audio is playing. • Press the Play/stop button on the remote control. Press and hold this button to hear a second device while the iPod/iPhone is charging. • Unplug the power cord for one minute, then plug it back in. This resets the system (you should hear a tone when the system is powered back on). • Make sure you have the latest version of software on your iPod/iPhone.
Your iPod/iPhone does not navigate playlists using the remote	<ul style="list-style-type: none"> • Make sure there are no empty playlists on your iPod/iPhone.

Problem	What to do
<p>Your iPod/iPhone does not respond to the SoundDock® remote control buttons shown:</p> 	<ul style="list-style-type: none"> • Remove your iPod/iPhone from the dock, wait five seconds, then firmly reseat the iPod/iPhone. • Try the remote from a different location. If it works there, check for interference from bright room lights or sunlight. Wipe off the small lens on the front end of the remote with a clean, dry cloth. • Make sure there is a clear pathway between the remote lens and your SoundDock system. • Remove and reinsert the battery as shown on page 5. • Replace the remote control battery as shown on page 5.
Your SoundDock does not respond to any controls	<ul style="list-style-type: none"> • Unplug the power cord for one minute, then plug it back in. This resets the system (you should hear a tone when the system is powered back on). • Contact your local Bose® dealer about the problem.
Your iPod/iPhone does not charge	<ul style="list-style-type: none"> • Remove your iPod/iPhone from the dock and check for any connection obstructions. Reseat the iPod/iPhone firmly. • Make sure your iPod is a compatible model (one that does not have four buttons above the click wheel).

Warranty

Your Bose® SoundDock Series II digital music system is covered by a limited transferable warranty. Details of the limited warranty are provided on the product registration card that is included in the carton. Please refer to the card for instructions on how to register. Failure to do so will not affect your limited warranty rights.

What you must do to obtain Limited Warranty Service:

1. Return the product with proof of purchase from an authorized Bose dealer, using the following procedures:
2. Contact the Bose organization in your country/region (visit Global.Bose.com/register for Bose contact information in your country/region) for specific return and shipping instructions;
3. Label and ship the product, freight prepaid, to the address provided by the Bose organization in your country, and place any necessary return authorization number prominently on the outside of the carton. Cartons not bearing a return authorization number, where required, will be refused.

Customer Service

- For questions about the SoundDock system, contact your local Bose® dealer.
- To contact Bose directly, see the address list included in the carton.

Technical Information

- **Power rating:** 100-240V  50-60Hz, 1.5A, 81-100VA
- **System size and weight:** 6.65"H x 11.91"W x 6.48"D (16.89 cm x 30.26 cm x 16.47 cm) 4.56 lb (2.1 kg)

Compatibility

- The SoundDock digital music system is compatible with all iPhones and most iPod models.
- Not compatible with 3rd generation with dock connector (iPod has four buttons above the touch wheel).

SoundDock and the SoundDock system design are registered trademarks of Bose Corporation in the U.S. and other countries.

- iPod is a trademark of Apple Inc., registered in the U.S. and other countries.
- iPhone is a trademark of Apple Inc. All other marks are the property of Bose Corporation.
- "Made for iPod" means that an electronic accessory has been designed to connect specifically to an iPod and has been certified by the developer to meet Apple performance standards.
- "Works with iPhone" means that an electronic accessory has been designed to connect specifically to the iPhone and has been certified by the developer to meet Apple performance standards.
- Apple is not responsible for the operation of this device or its compliance with safety and regulatory standards.

©2009 Bose Corporation, The Mountain, Framingham, MA 01701-9168 USA AM325319 Rev.00



FAQ



- **Q: Can this product be used outdoors?**

- **A:** No, this product is designed for indoor use only.
- **Q: What should I do with used batteries?**
- **A:** Please dispose of used batteries properly following local regulations. Do not incinerate them.
- **Q: Can I use any power supply with this product?**
- **A:** No, this product is intended to be used only with the power supply provided.

Documents / Resources

	BOSE Sound Dock Digital Music System [pdf] Instruction Manual Sound Dock Digital Music System, Digital Music System, Music System
---	--

References

-  [Product registration](#)
-  [One moment, please...](#)
- [User Manual](#)

[Manuals+](#), [Privacy Policy](#)

This website is an independent publication and is neither affiliated with nor endorsed by any of the trademark owners. The "Bluetooth®" word mark and logos are registered trademarks owned by Bluetooth SIG, Inc. The "Wi-Fi®" word mark and logos are registered trademarks owned by the Wi-Fi Alliance. Any use of these marks on this website does not imply any affiliation with or endorsement.