



Bose Soundtouch 10 User Manual

[Home](#) » [Bose](#) » [Bose Soundtouch 10 User Manual](#) 



Contents

- [1 Bose Soundtouch 10 User Manual](#)
- [2 Related Posts](#)

Bose Soundtouch 10 User Manual

Owner's Guide

SoundTouch™

Your SoundTouch™ wireless music system provides clear, room-filling sound streamed wirelessly over your home Wi-Fi® network. With SoundTouch™, you can stream Internet radio, music services, and your music library.

If you have Wi-Fi at home, you're ready to enjoy your favorite music in any room you want.

System benefits

- Enjoy wireless access to Internet radio, music services and your music library.
- Access your favorite music easily with your personalized Presets.
- Wireless setup using your smartphone or tablet.
- Works with your existing home Wi-Fi network.
- Stream music from Bluetooth® enabled devices.
- Free SoundTouch™ app for your computer, smartphone, or tablet.
- Simply add additional systems at any time for a multi-room listening experience.
- Wide selection of Bose® audio systems lets you choose the right solution for any room.

Hardware features

- Six Presets on the system and its remote deliver your music with just one touch.
- AUX connector enables playback from an audio device.
- Remote control for point-and-click control from up to 20 feet away.
- Thumbs up/Thumbs down buttons on remote control for customized listening.

SoundTouch™ app

- Set up and control your system from your smartphone, tablet, or computer.
- Use the SoundTouch™ app to easily personalize Presets to your favorite music.
- Explore Internet radio, music services and your music library.
- Manage system settings.

Unpacking the system

Carefully unpack the carton and confirm that the following parts are included.

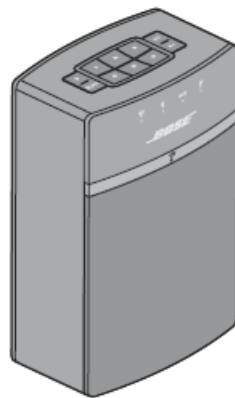

SoundTouch™ wireless music system



Remote control



USB cable
(computer setup only)



Power cord

** May ship with multiple power cords. Use the power cord for your region.

Note: If part of the system is damaged, do not use it. Contact your authorized Bose® dealer or Bose customer service. Refer to the quick start guide in the carton for contact information.

Save the carton and packing materials for transporting or storing the system.

Connecting the system to power

Before you set up the system on your network, connect the system to power.

1. Plug the power cord into the POWER connector on the system.

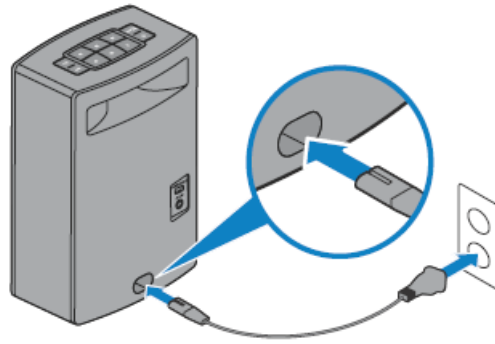

2. Plug the other end of the power cord into an AC (mains) power outlet.

Adding the system to your Wi-Fi® network

After you connect the system to power, you must download and install the SoundTouch™ app onto a smartphone or tablet that is connected to your network. The app guides you through connecting the system to your network (see page 11).

Note: If you do not have a smartphone or tablet, you can use a computer for setup.

Add the system to an existing SoundTouch™ account

If you have already set up SoundTouch™ for another system, you do not need to download the SoundTouch™ app again.

1. On your smartphone or tablet, select the SoundTouch™ icon to launch the app.
2. Select EXPLORE > SETTINGS > Systems > ADD SYSTEM to add another system. The app guides you through setup.

Setting up the System

Download and install the SoundTouch™ app

If this is your first time setting up a SoundTouch™ system, you must install the app. On your smartphone or tablet, download the SoundTouch™ controller app.



- iOS users: download from the App Store
- Android™ users: download on the Google Play™ store
- Amazon Kindle Fire users: download from the Amazon Appstore for Android

Connect the system to your home Wi-Fi® network

After you install the app, add the system to your network:

1. On your smartphone or tablet, select to launch the app. The app guides you through connecting the system to your Wi-Fi® network.
2. Follow the instructions in the app to complete setup, including creating a SoundTouch™ account, adding a music library and music services.

Connecting the system to a new network

If your network information changes, you must add the system to the new network. You can do this by manually putting the system in to setup mode.

1. On the button pad, press and hold **2** and **<**— until the Wi-Fi indicator glows amber.



2. On your smartphone, tablet or computer, open the app.
3. From the EXPLORE panel, select SETTINGS > Systems.
4. Select your system.
5. Select CONNECT TO A WI-FI NETWORK. The app guides you through setup.

Powering on the system

On the button pad or the remote control, press Power (Button).

Tip: You can also press a Preset or **Bluetooth | AUS** to power on the system.

Understanding the system status indicators

The front of the system has a series of indicators that show system status. Lights under the indicators glow according to system state (see page 13).

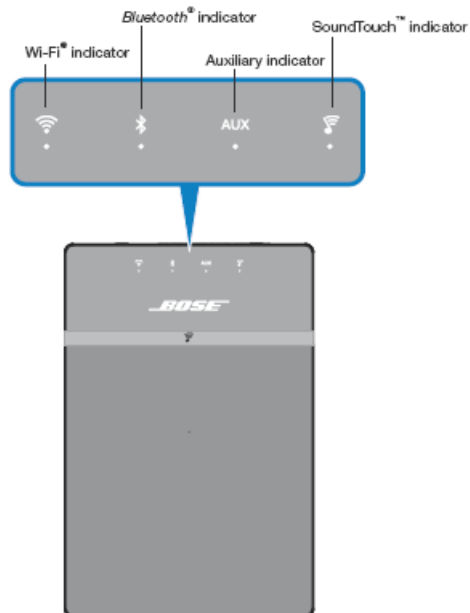

Using the System

Wi-Fi® indicator ()

Shows the Wi-Fi connection status of the system.

Indicator activity	System state
Blinking white	Connecting to Wi-Fi network
Solid white (dim)	Power saving mode and connected to Wi-Fi network
Solid white (bright)	System is on and connected to Wi-Fi network
Blinking amber	Disconnected from Wi-Fi network
Solid amber	System is in setup mode

Bluetooth® indicator ()

Shows the connection status of a Bluetooth® enabled device.

Indicator activity	System state
Blinking blue	Ready to connect
Blinking white	Connecting
Solid white	Connected

AUX indicator (AUX)

Indicator activity	System state
Solid white	System is ready to play content from an external media player







SoundTouch™ indicator ()

Indicator activity	System state
Blinking white	Connecting to a SoundTouch™ source
Solid white	System is playing a SoundTouch™ source
Solid amber	System, source, or station unavailable Preset empty or invalid

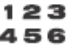
System control buttons

The system controls reside on the button pad and on the remote control. You can also control the system using the SoundTouch™ app (see page 16).

- Button pad: enables you to power the system, set and play your Presets, adjust the volume, and activate the Bluetooth® and auxiliary sources.
- Remote control: enables the same functionality as the button pad, plus: skip backward/skip forward, play/pause, and Thumbs up/Thumbs down.

Button	Description
	Power: Press to power on/off the system
	Six Preset buttons: <ul style="list-style-type: none">• Press and hold to set a Preset to what is currently playing• Press a Preset to play it
 AUX	Bluetooth/Auxiliary button: <ul style="list-style-type: none">• Press to toggle between the Bluetooth and auxiliary source• Indicator on the front of the system indicates source (see page 12)
	Volume Up/Volume Down: Press to increase/decrease volume
	Skip Backward/Skip Forward: Press to skip tracks (remote control only)
	<ul style="list-style-type: none">• Play/Pause: Press to toggle play or pause audio• Mute/Unmute: Press to mute or unmute a device connected to AUX (remote control only)
	<ul style="list-style-type: none">• Press to like/dislike the currently playing selection (for use with participating music services) (remote control only)

Using Bluetooth the AUX button

This multifunction button enables you to play more music on your system.

- Stream music from a connected Bluetooth® enabled device
- Connect an audio device to the AUX connector

Press to toggle between Bluetooth () and auxiliary () sources.

Bluetooth® wireless technology

Your system has Bluetooth wireless technology which lets you stream music from Bluetooth enabled devices to your system. Your system stores eight previously connected devices in its pairing list.

See page 19 for more information.

Auxiliary source

The auxiliary source lets you play music from an audio device connected to your system's AUX connector. You need a stereo cable with a 3.5 mm stereo cable plug (not provided).

Using the SoundTouch™ app

The SoundTouch™ app is a software application that enables you to set up and control SoundTouch™ from your smartphone, tablet, or computer. Using the app, your smart device acts as a rich remote for your SoundTouch™ system.

The app enables you to manage your SoundTouch™ settings, add music services, explore local and global Internet radio stations, set and change Presets, stream music to the system, view what is playing, plus much more.

After you set up the system on your network using the SoundTouch™ app, you are ready to explore streaming music and personalize your Presets.

Getting help SoundTouch.com

Provides access to the owner support center, which includes: owner's manuals, articles, tips, tutorials, a video library, and the owner community where you post questions and answers.

1. Open a browser.
2. In the address field, type SoundTouch.com

In-app help

Provides help articles for using SoundTouch™.

1. On your device, select to open the app.
2. From the EXPLORE panel, select HELP.

Controlling the system from another smartphone, tablet, or computer

Once you set up the SoundTouch™ system on your home Wi-Fi® network, you can control the system from any smartphone, tablet, or computer on the same network.

1. Connect the device to the same network as your system.
2. On the device, download and install the SoundTouch™ app:
 - If you are using a smartphone or tablet, see page 11.
 - If you are using a computer, open a browser and go to: SoundTouch.com/app

Note: See page 28 for more information on setting up using a computer.

How Presets work

You can personalize six Presets to your favorite streaming music services, stations, playlists, artists, albums or songs from your music library. You can access your music, at any time, with a simple touch of a button on the SoundTouch™ system or its remote control.

Tip: You can also access your Presets using the SoundTouch™ app on your computer, smartphone, or tablet.

What you need to know

- You can set Presets from the app, the button pad and the remote control.
- If the Preset source is your iTunes or Windows Media Player music library, ensure the computer storing your music library is on and connected to the same network as the SoundTouch™ system.
- You cannot set Presets to a Bluetooth® stream or audio device connected to the AUX connector.

Playing a Preset

Once you personalize your Presets using the app, press a Preset on the button pad or on the remote control to play it. If you have not set your Presets, launch the app and set your Presets. For help, refer to the in-app help.

If using the remote control, aim the remote toward the system while pressing a

Preset on the remote.

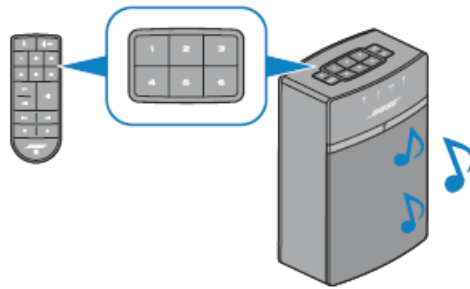

Note: If no music plays and the SoundTouch™ indicator on the system blinks amber, see “Setting a Preset” on page 18.

Setting a Preset

1. Stream music to the system using the app.
2. While the music is playing, press and hold a Preset on the button pad or remote control (about 2 seconds).

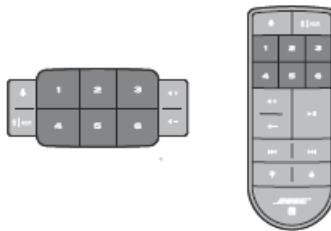

Pairing a Bluetooth® enabled device

enabled smartphones, tablets, computers or other audio devices to your SoundTouch™ system. You can even stream music from Bluetooth enabled devices that are not part of your SoundTouch™ ecosystem, such as a guest’s smartphone or tablet. Before you can stream music from a Bluetooth enabled device, you must pair the device with your system.

1. On the system’s button pad or remote control, press and release **Bluetooth | AUX** until the Bluetooth indicator blinks blue.

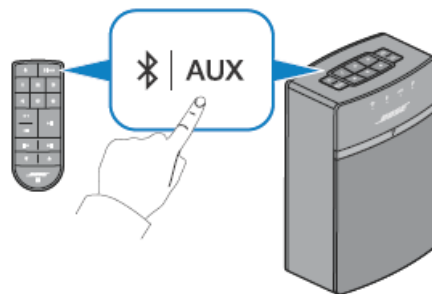

Bluetooth®

On your Bluetooth® enabled device, turn on the Bluetooth feature.

Tip: The Bluetooth feature is usually found in Settings. A gear icon (**Setting**) often represents Settings on the Home screen.

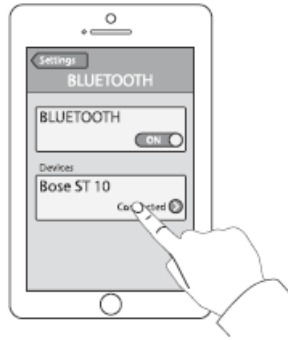

3. Select Bose ST 10 from the device list.

Once paired, your SoundTouch™ system's name appears connected in the device list.

4. On your Bluetooth enabled device, play music to stream to your system.

If you cannot pair your device You may need to clear the system's Bluetooth pairing list (see page 21). After you clear the list, try pairing again (see page 19).

See "Troubleshooting" on page 25 for more information.

Connecting to a paired Bluetooth® enabled device

You can stream audio from a Bluetooth® enabled device to your system.

Note: If there are multiple devices stored in the system's pairing list, it may take a minute or two for the paired device to connect. Your system's Bluetooth indicator indicates connection status. See "Understanding the system status indicators" on page 12.

Using the button

1. On the system's button pad or remote control, press and release until the Bluetooth indicator blinks blue.

The system connects to the last device that streamed to your system.

2. Once connected, on the Bluetooth enabled device, play music to stream to your system.

Tip: If a paired device is connected, you do not need to press .

If you cannot stream audio from a paired device

Your SoundTouch™ system may have lost connection to the device. The system's Bluetooth indicator glows white when connected. If the paired device is out of range of your system, move the device within range.

Using the Bluetooth® feature on the paired device

1. On the Bluetooth enabled device, turn on the Bluetooth feature.

2. Select your SoundTouch™ system from the device list.

3. Once connected, on the Bluetooth enabled device, play music to stream to your system.

Using the Bluetooth® feature on the paired device

1. On the Bluetooth enabled device, turn on the Bluetooth feature.

2. Select your SoundTouch™ system from the device list.

3. Once connected, on the Bluetooth enabled device, play music to stream to your system.

Clearing the system's Bluetooth® pairing list

When you pair a Bluetooth enabled device to your system, the connection is stored in the system's pairing list. You may need to clear the pairing list if you cannot connect to a device. Once you clear the list, you need to pair previously-paired devices again.

On the button pad or remote control, press and hold (about 10 seconds) until the Bluetooth indicator double-blinks white.



Using a cable to connect an audio device

You can connect the audio output of a smartphone, tablet, computer or other type of audio device to your system's AUX connector. The AUX connector accepts a 3.5 mm stereo cable plug (not provided).

1. Using a stereo cable, connect your audio device to the AUX connector on the system.

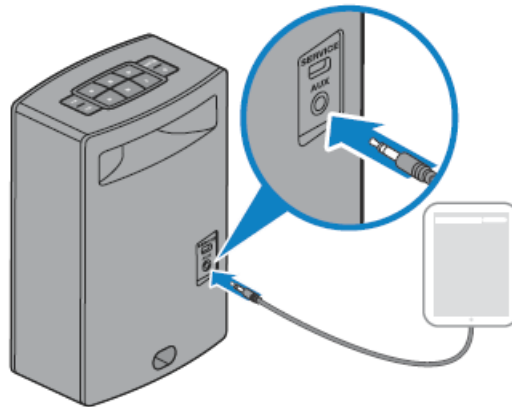

2. On the system's button pad or remote control, press and release until the AUX indicator glows white.
3. Start playing music on the audio device.

Updating system software

update the system within the app. However, you can also update system software using the button pad.

1. Press to power the system on.
2. On the button pad, press and hold 4 and (about 5 seconds).



Disabling Wi-Fi® capability

Disabling Wi-Fi® also disables the Bluetooth® feature.

1. Press to power the system on.
2. On the button pad, press 3 and hold and (about 5 seconds).



The Wi-Fi indicator turns off when Wi-Fi is disabled.

Re-enabling Wi-Fi® capability

Re-enabling Wi-Fi® also re-enables the Bluetooth® feature.

While the system is on, press and hold and (about 5 seconds).

The Wi-Fi indicator glows when Wi-Fi is enabled.

Resetting the system

Factory reset clears all source, volume, and network settings from the system and returns it to original factory settings.

1. Press to power the system on.
2. On the button pad, press and hold 1 and (about 10 seconds).

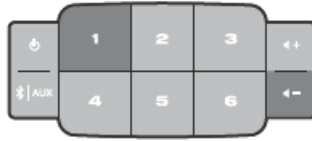

Questions about your Bose Soundtouch 10? Post in the comments!

[785169_og_soundtouch-10-wireless-system_en](#) [PDF]