

BOSCH LC3 Ceiling Loudspeaker Range



# BOSCH LC3 Ceiling Loudspeaker Range Instruction Manual

[Home](#) » [Bosch](#) » BOSCH LC3 Ceiling Loudspeaker Range Instruction Manual 

## Contents

- [1 BOSCH LC3 Ceiling Loudspeaker Range](#)
- [2 Installation Overview](#)
- [3 Technical Specifications](#)
- [4 FAQ](#)
- [5 Documents / Resources](#)
  - [5.1 References](#)
- [6 Related Posts](#)



## BOSCH LC3 Ceiling Loudspeaker Range



## Installation Overview

The LC3 Ceiling Loudspeaker Range includes models LC3-UC06, LC3-UC06-LZ, and LC3-CBB. This document provides installation instructions for these models.

### Installation Procedure

1. **Ceiling cut-out template:** A template is provided to mark the ceiling before cutting out the section where the loudspeaker will be installed. The cut-out diameter should be 167 mm / 6.57 inches.

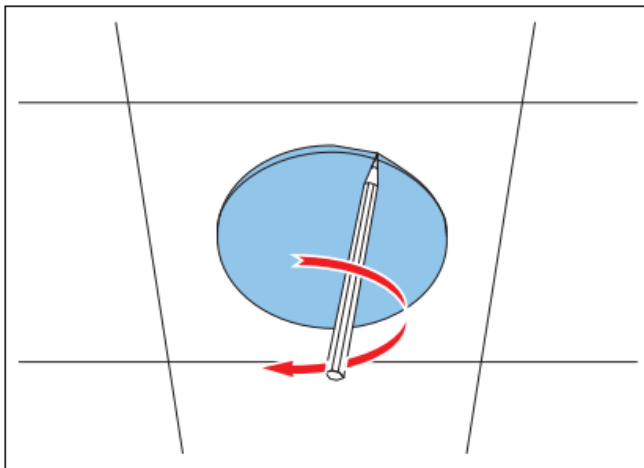
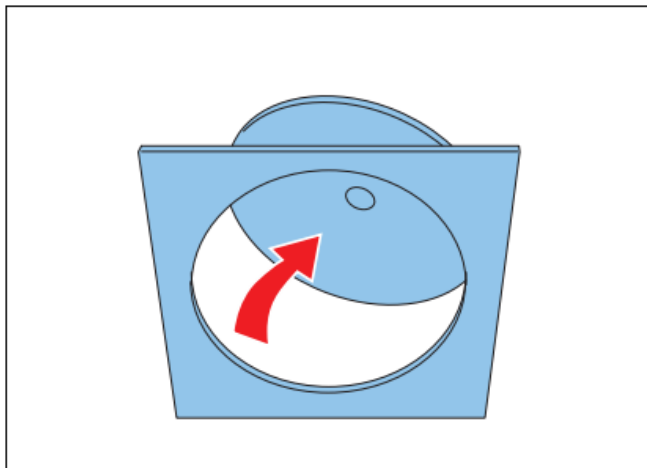

2. **Ceiling thickness:** The minimum ceiling thickness should be 5 mm / 0.19 inches, and the maximum should be 25 mm / 0.98 inches.

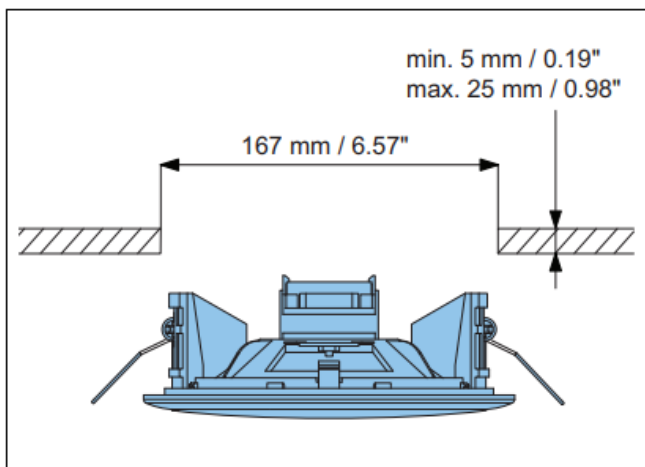
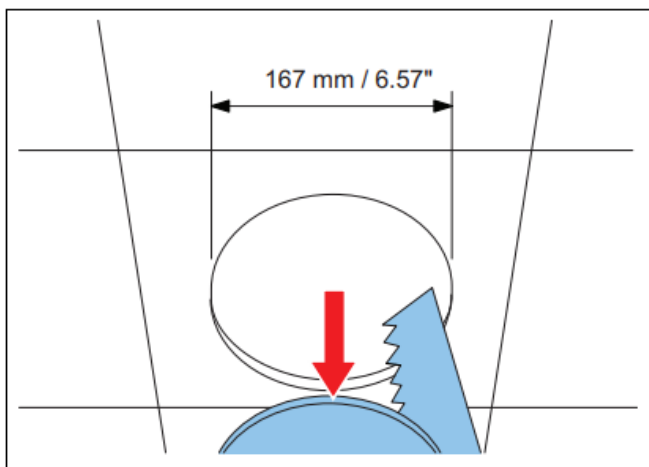

3. **Connection LC3-UC06-LZ (4Ω):** Illustration shows the connection process for the LC3-UC06-LZ model.

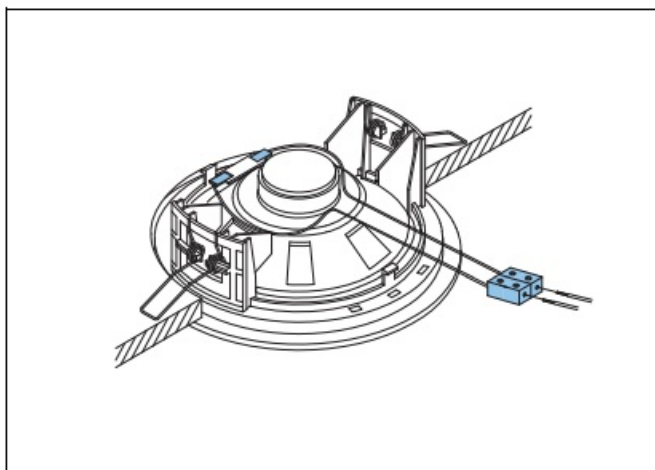

4. **Connection LC3-UC06 (100 V):** Diagrams provide guidance on connecting the LC3-UC06 model for 100 V systems.

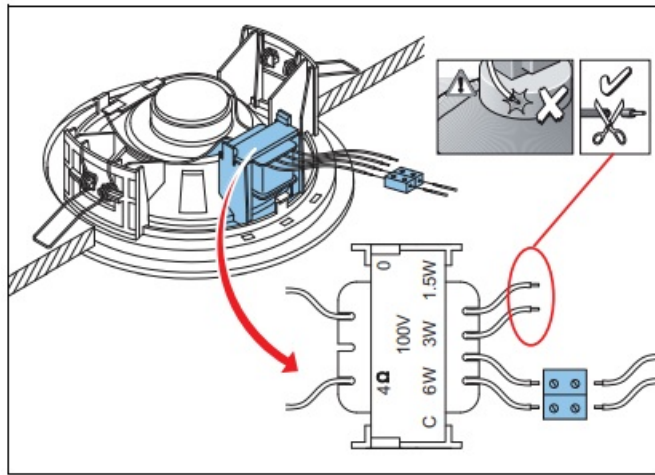

5. **Connection LC3-UC06 + LC3-CBB (optional):** Instructions for connecting the LC3-UC06 with the optional LC3-CBB back-box.

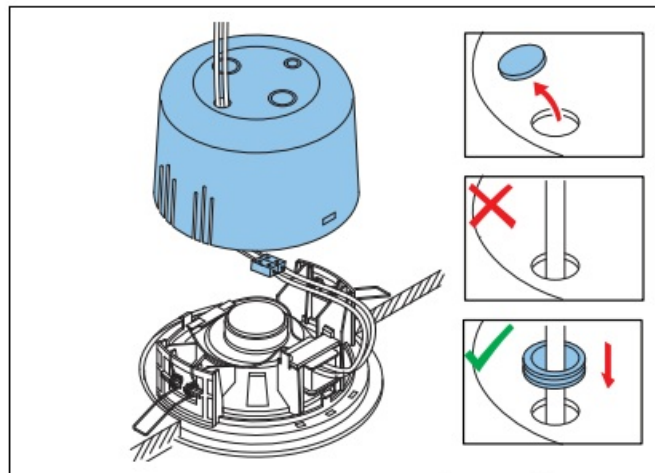

6. **LC3-UC06 + LC3-CBB (optional)**

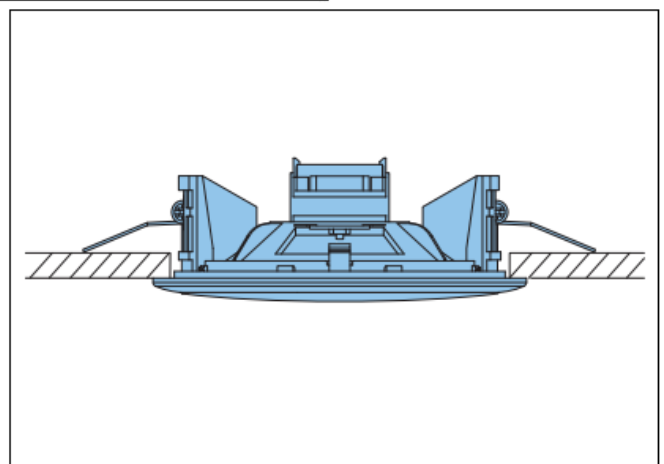
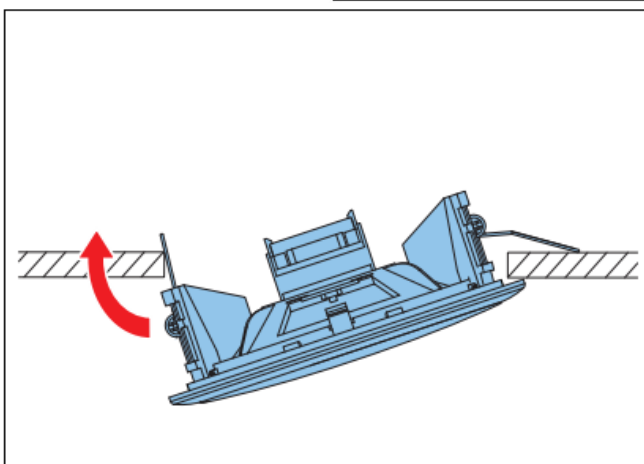
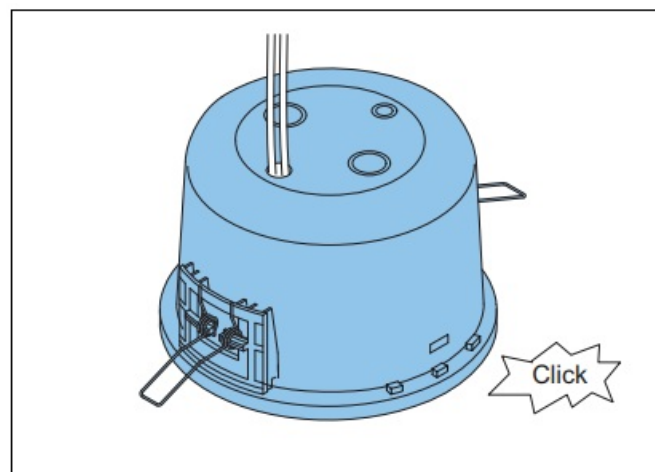

7. **Dimensions LC3-UC06 + LC3-CBB (optional):** Detailed dimensions are given for installation when including the optional LC3-CBB back-box.

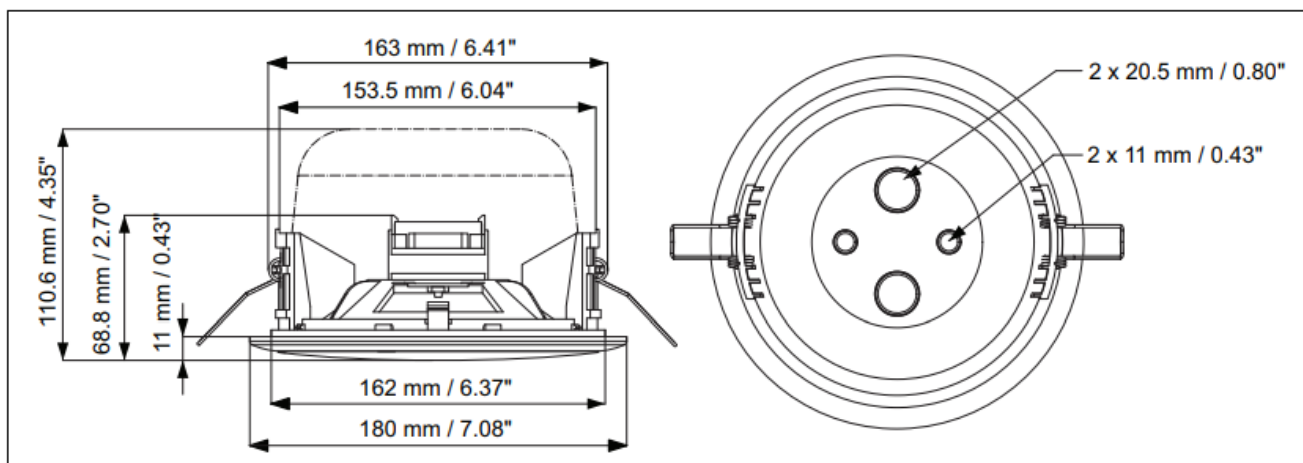

Dimensions LC3-UC06 + LC3-CBB (optional)

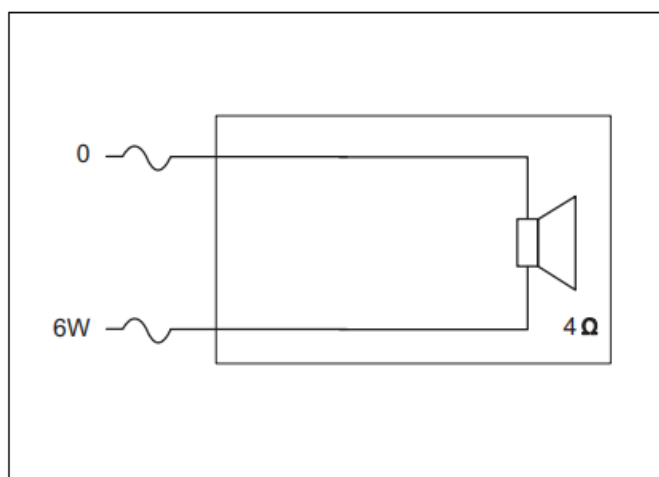

Circuit diagram LC3-UC06-LZ (4Ω)

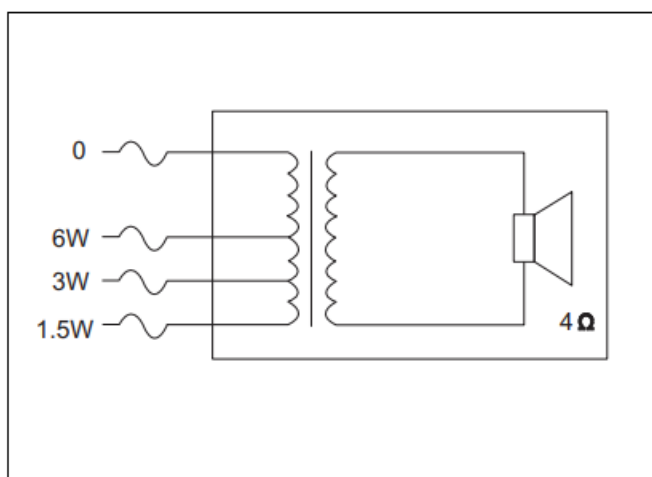

Circuit diagram LC3-UC06 (100 V)

## Frequency response

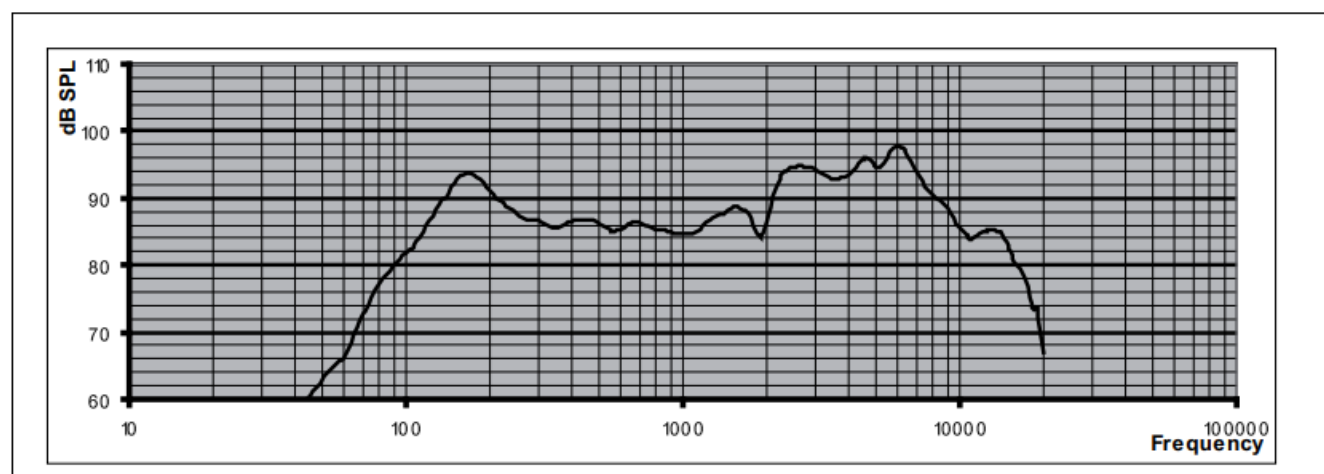

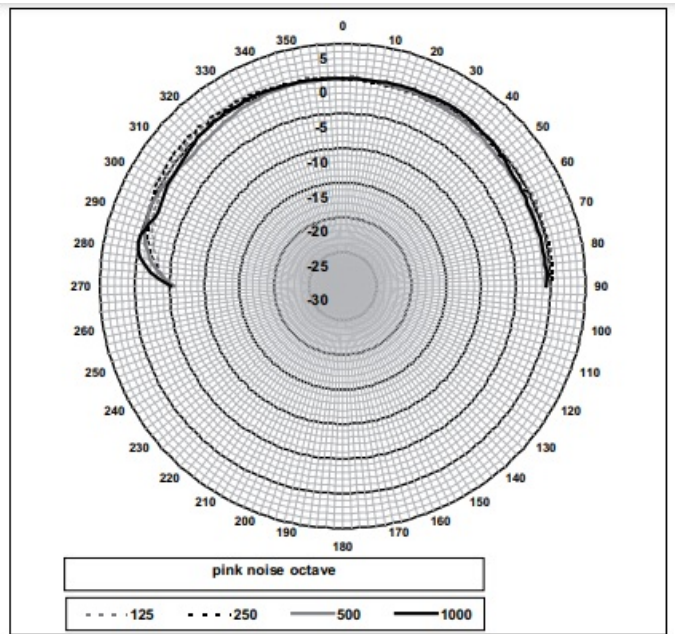
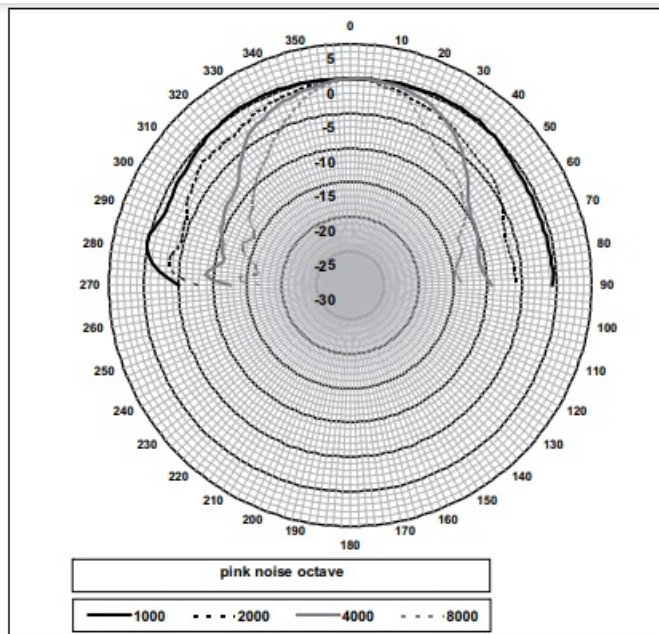

## Technical Specifications

Electrical*	LC3-UC06	LC3-UC06-LZ
Description	Ceiling Loudspeaker	Ceiling Loudspeaker
Maximum power	9 W	9 W
Rated power	6 W (6/3/1.5 W)	6 W
Sound pressure level 94dB / 86 dB (SPL) at rated power / 1 W (1 kHz, 1 m)		94dB / 86 dB (SPL)
Sound pressure level 103dB / 95 dB (SPL) at rated power / 1 W (4 kHz, 1 m)		103dB / 95 dB (SPL)
Opening angle at	180 / 85 degrees 1 kHz / 4 kHz (-6 dB):	180 / 85 degrees
Effective frequency	90 Hz to 20 kHz range (-10 dB)	90 Hz to 20 kHz
Rated voltage	100 V	4.9 V
Rated impedance	1667 Ohm	4 Ohm
Connector	Flying leads: 150 mm (5.90 in)	Flying leads: 150 mm (5.90 in)

<b>Mechanical</b>	<b>LC3-UC06</b>	<b>LC3-UC06-LZ</b>	<b>LC3-CBB</b>
Description	Ceiling Loudspeaker	Ceiling Loudspeaker	Back-Box
Diameter	180 mm (7.08 in)	180 mm (7.08 in)	148 mm (5.82 in)
Mounting cut-out	167 mm (6.57 in)	167 mm (6.57 in)	–
Max. ceiling thickness	5 to 25 mm (0.19 to 0.98 in)	5 to 25 mm (0.19 to 0.98 in)	–
Max. depth	59 mm (2.32 in)	59 mm (2.32 in)	96.3 mm (3.79 in)
Material (frame, front grille)	ABS	ABS	ABS
Weight	475 g (1.04 lb)	337 g (0.74 lb)	110 g (0.24 lb)
Color	White (RAL 9010)	White (RAL 9010)	White (RAL 9010)

## Environmental

- Operation temperature: -25°C to +55°C (-13°F to +131°F)
- Storage temperature: -40°C to +70°C (-40°F to +158°F)
- Relative humidity: < 95%

## Certification and Approvals

- Safety: According to EN 60065
- UL compliance: According to UL 94 V 0

## FAQ

- **What is the diameter for the ceiling cut-out?**
  - The cut-out diameter should be 167 mm / 6.57 inches.
- **What are the electrical specifications for the LC3-UC06 and LC3-UC06-LZ?**
  - Both models have a maximum power of 9 W and a rated power of 6 W. They differ in rated impedance, with the LC3-UC06 at 1667 Ohm for 100 V systems, and the LC3-UC06-LZ at 4 Ohm.
- **Can the LC3-CBB back-box be used with both LC3-UC06 and LC3-UC06-LZ?**
  - Yes, the LC3-CBB is an optional back-box that can be used with both models.
- **What are the operating and storage temperature ranges for the loudspeakers?**
  - The operating temperature range is -25°C to +55°C (-13°F to +131°F), and the storage temperature range is -40°C to +70°C (-40°F to +158°F).

## Contact Information

### Bosch Security Systems B.V.

- Torenallee 49 5617 BA Eindhoven

Netherlands

- Website: [www.boschsecurity.com](http://www.boschsecurity.com)

Bosch Security Systems B.V., 2017

---

Documents / Resources

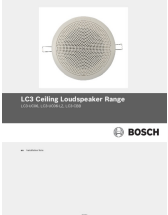
	<p><a href="#">BOSCH LC3 Ceiling Loudspeaker Range</a> [pdf] Instruction Manual</p> <p>LC3 Ceiling Loudspeaker Range, LC3, Ceiling Loudspeaker Range, Loudspeaker Range, Range</p>
---	--

References

- [User Manual](#)

[Manuals+](#), [Privacy Policy](#)

This website is an independent publication and is neither affiliated with nor endorsed by any of the trademark owners. The "Bluetooth®" word mark and logos are registered trademarks owned by Bluetooth SIG, Inc. The "Wi-Fi®" word mark and logos are registered trademarks owned by the Wi-Fi Alliance. Any use of these marks on this website does not imply any affiliation with or endorsement.