



BOSCH FMR-5000-C Remote Keypad Installation Guide

[Home](#) » [Bosch](#) » BOSCH FMR-5000-C Remote Keypad Installation Guide 

BOSCH FMR-5000-C Remote Keypad Installation Guide



Contents

- [1 Installations Instructions](#)
- [2 Product Overview](#)
- [3 Functional Description](#)
- [4 Installation](#)
- [5 Wiring](#)
- [6 Technical Data](#)
- [7 Documents / Resources](#)
 - [7.1 References](#)
- [8 Related Posts](#)

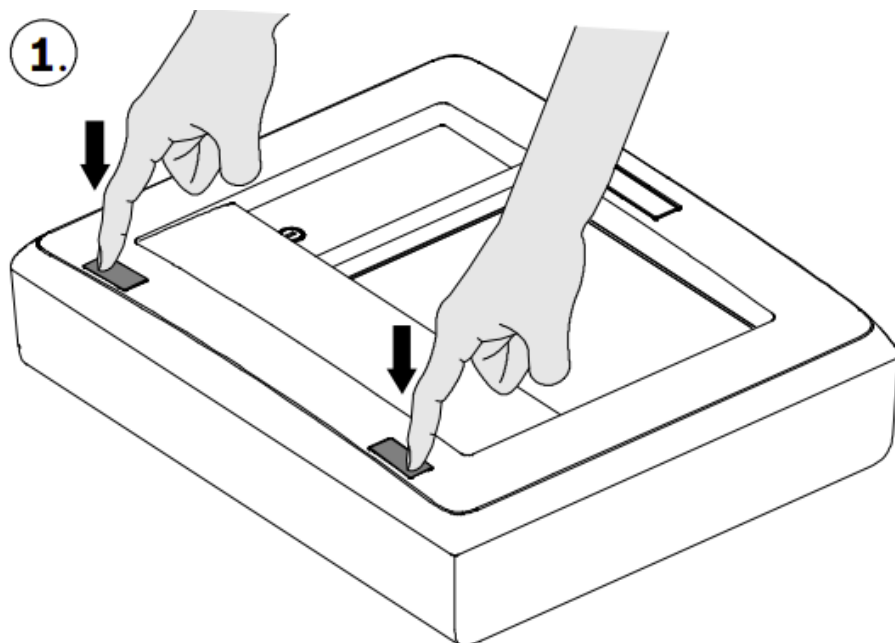
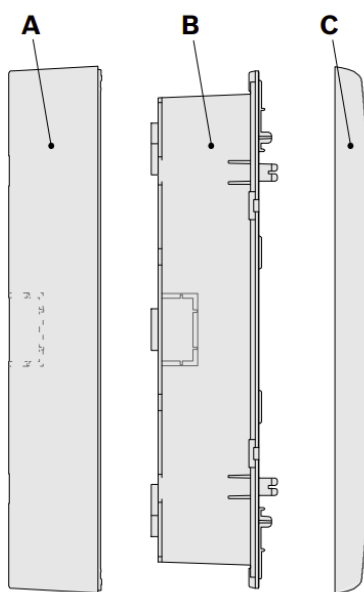
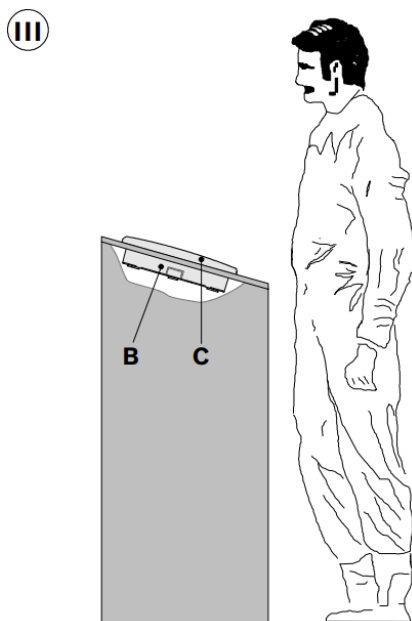
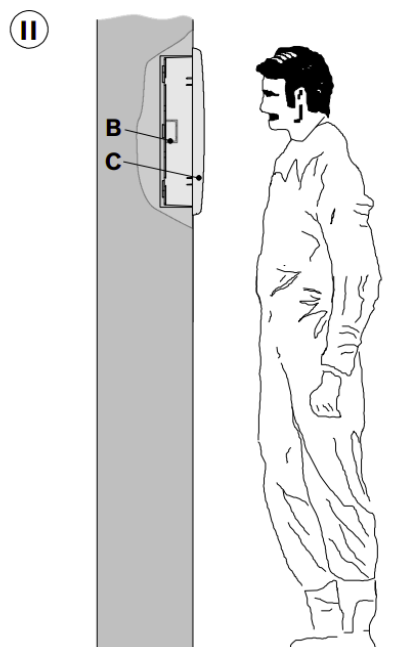
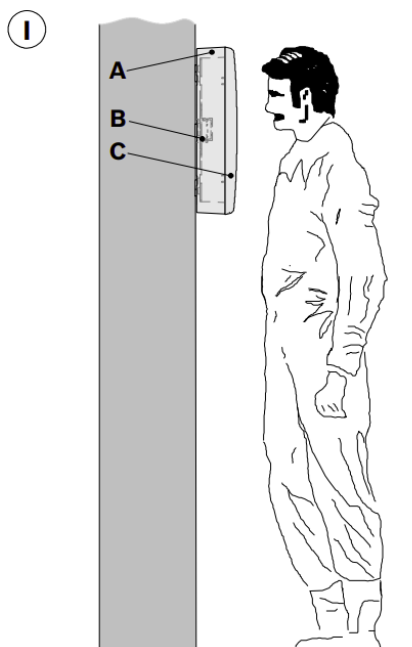

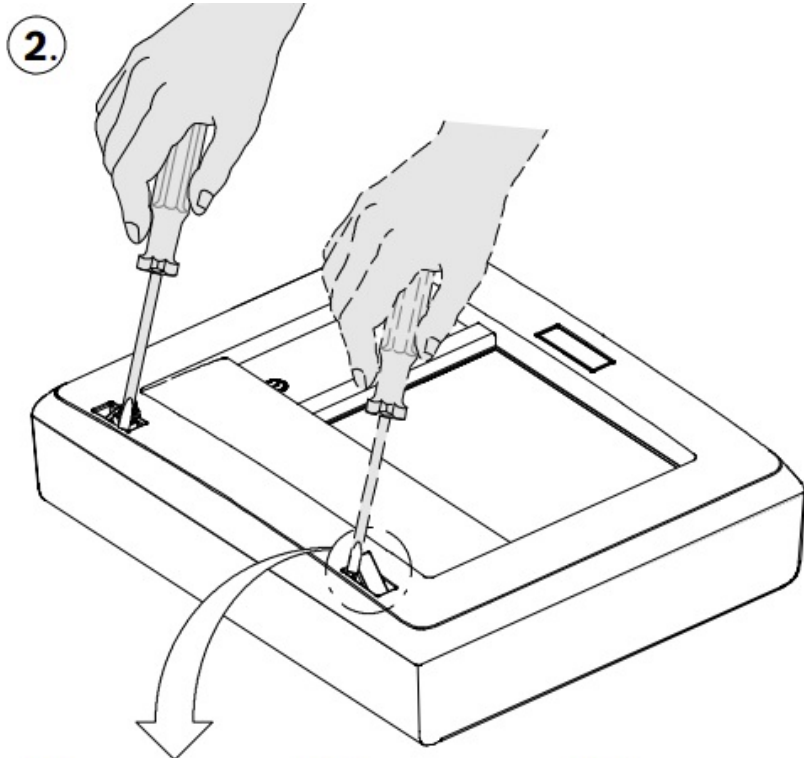

2.1



2.2

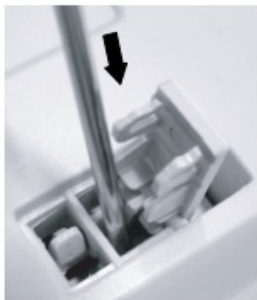

2.3



3.

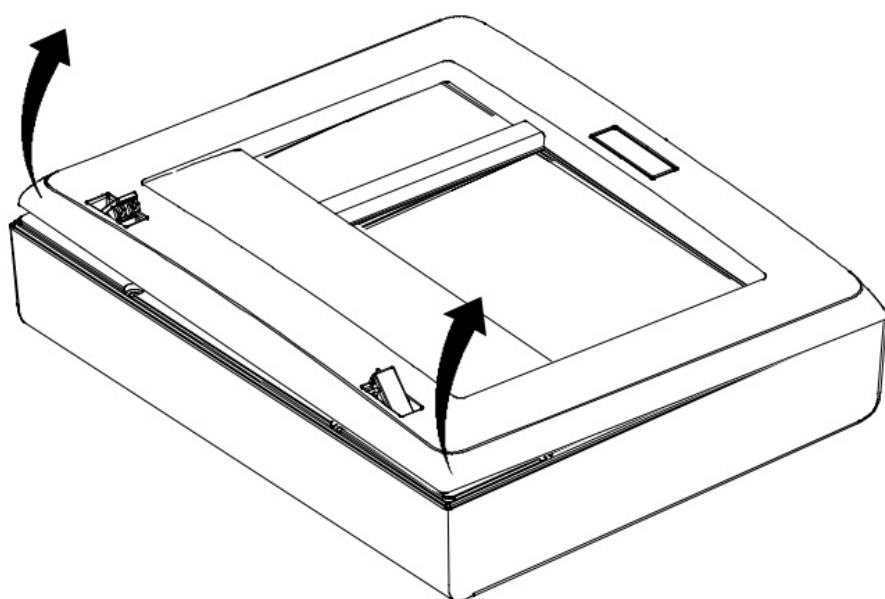

4.

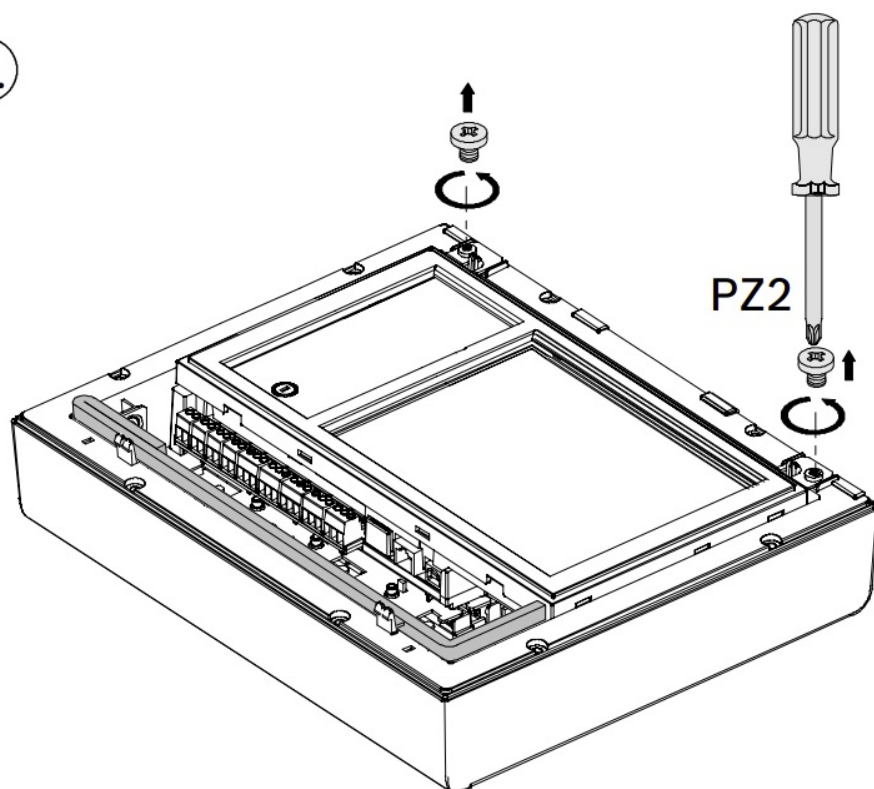

5.

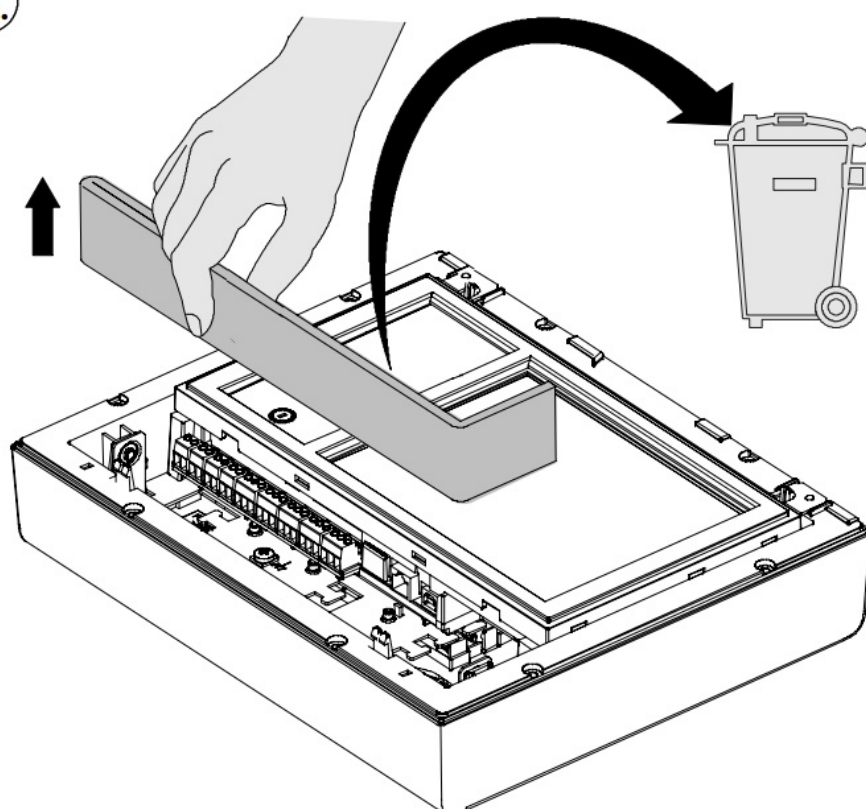

6.

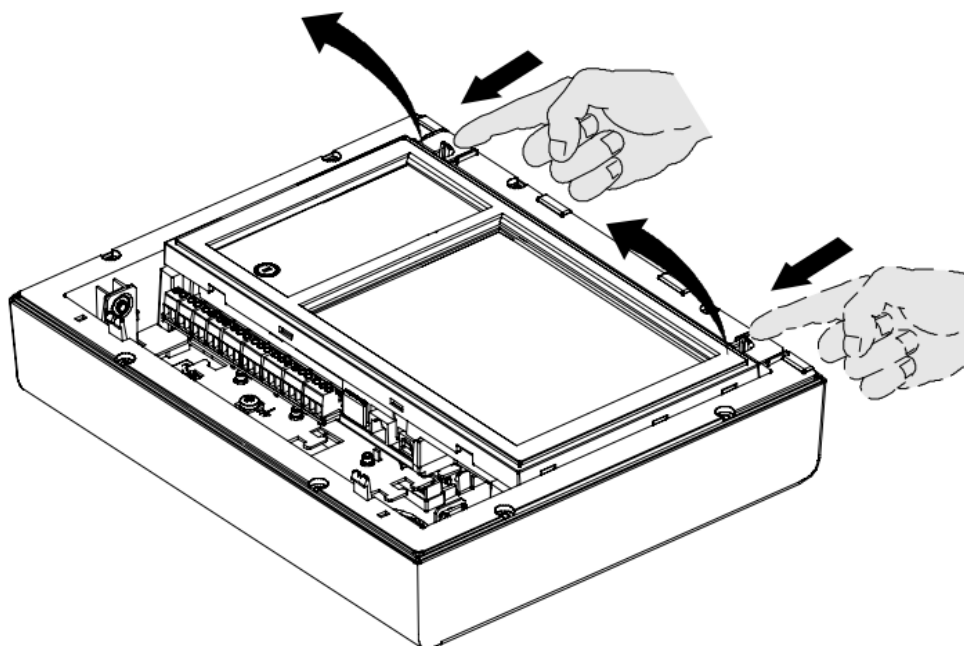

7.

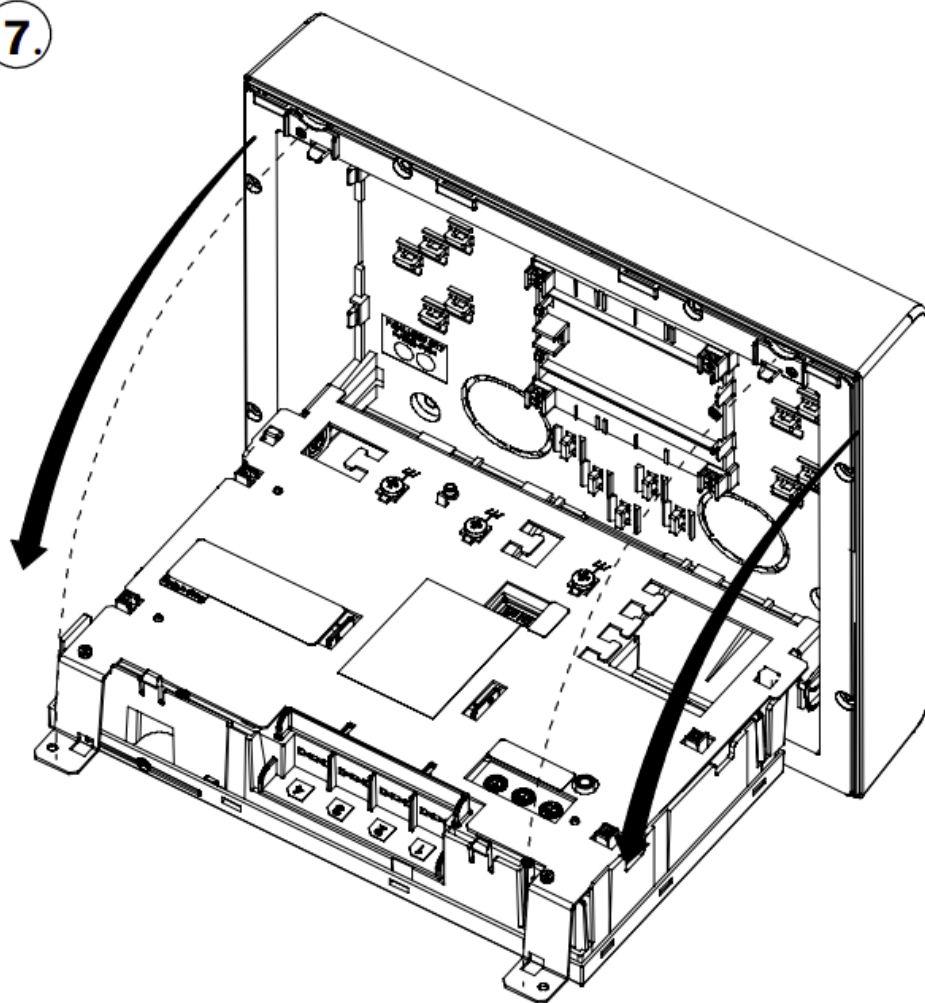

8.

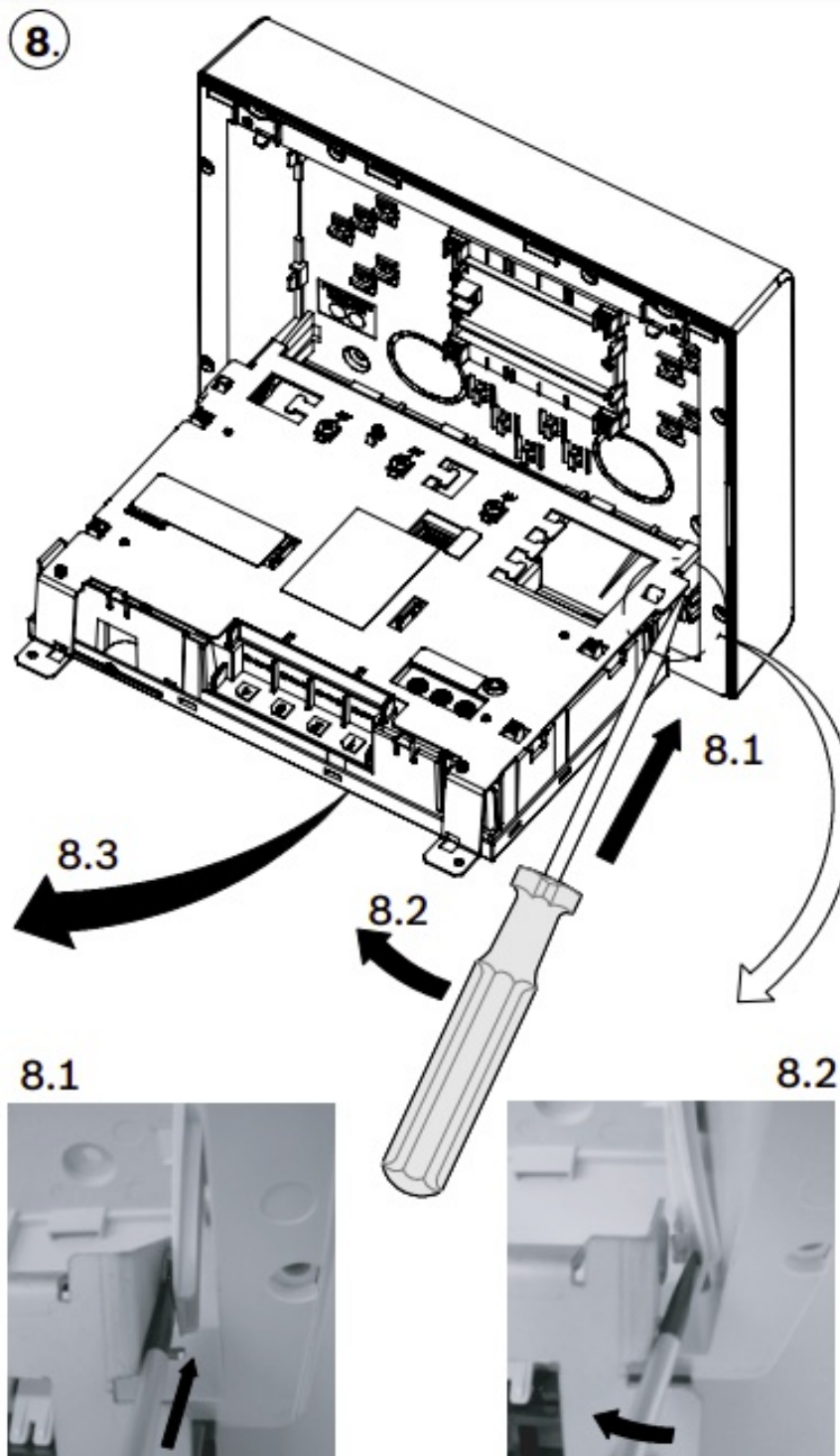

9.

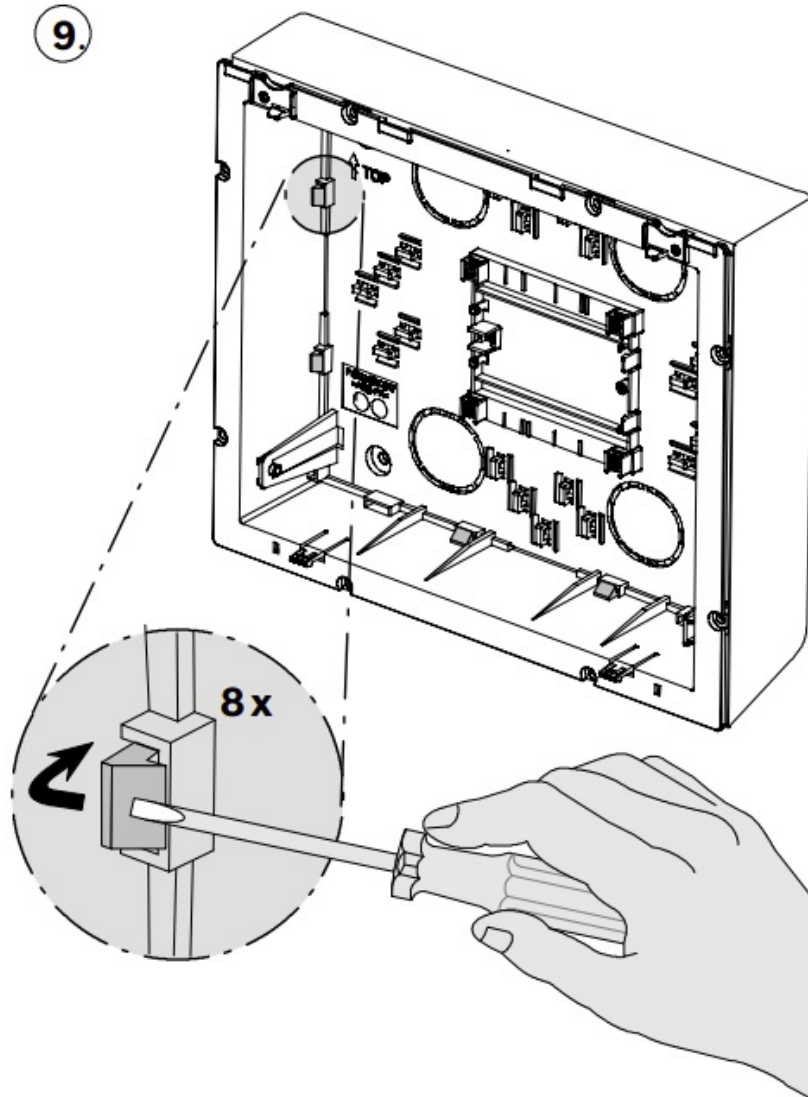

10.

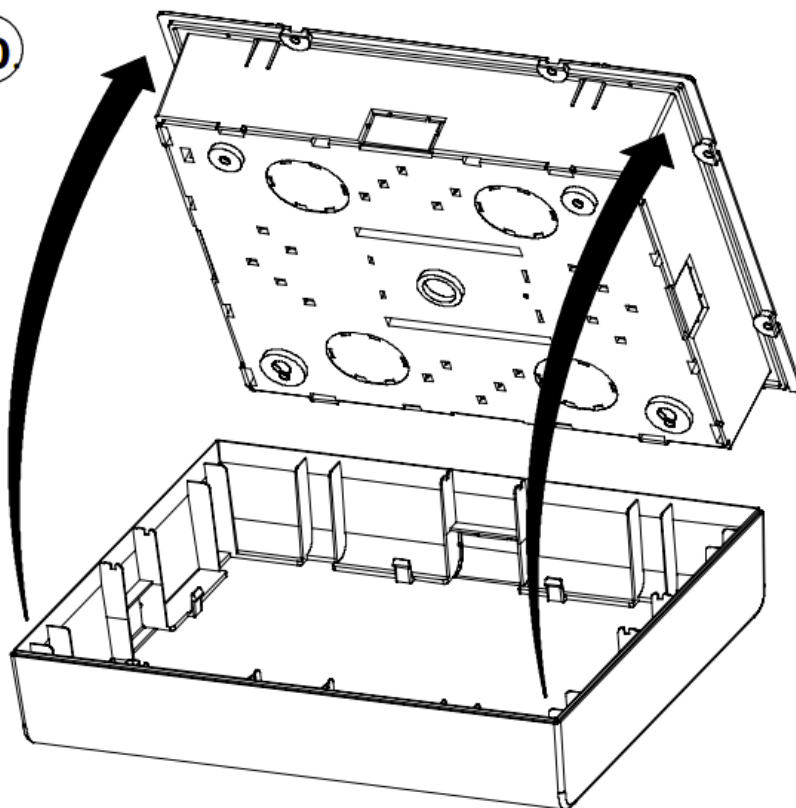

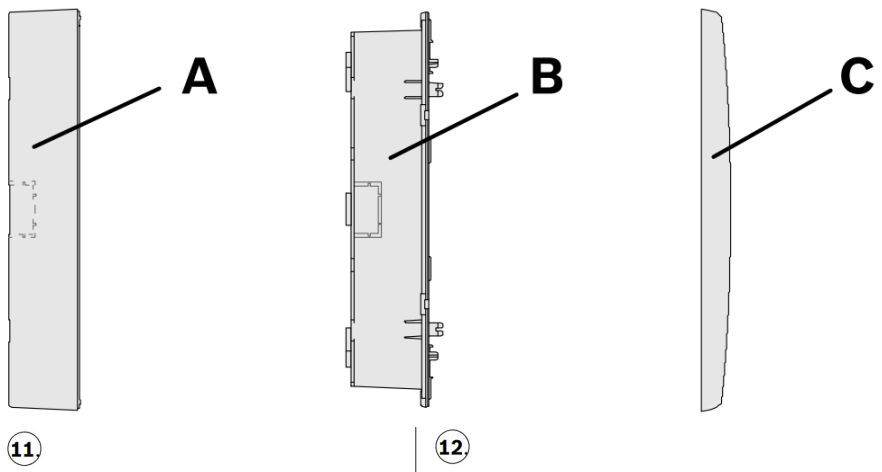

11

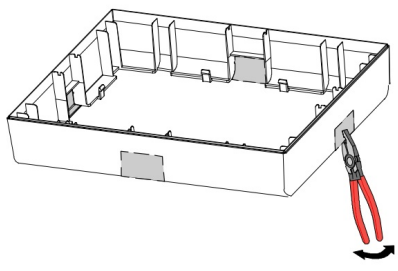

12

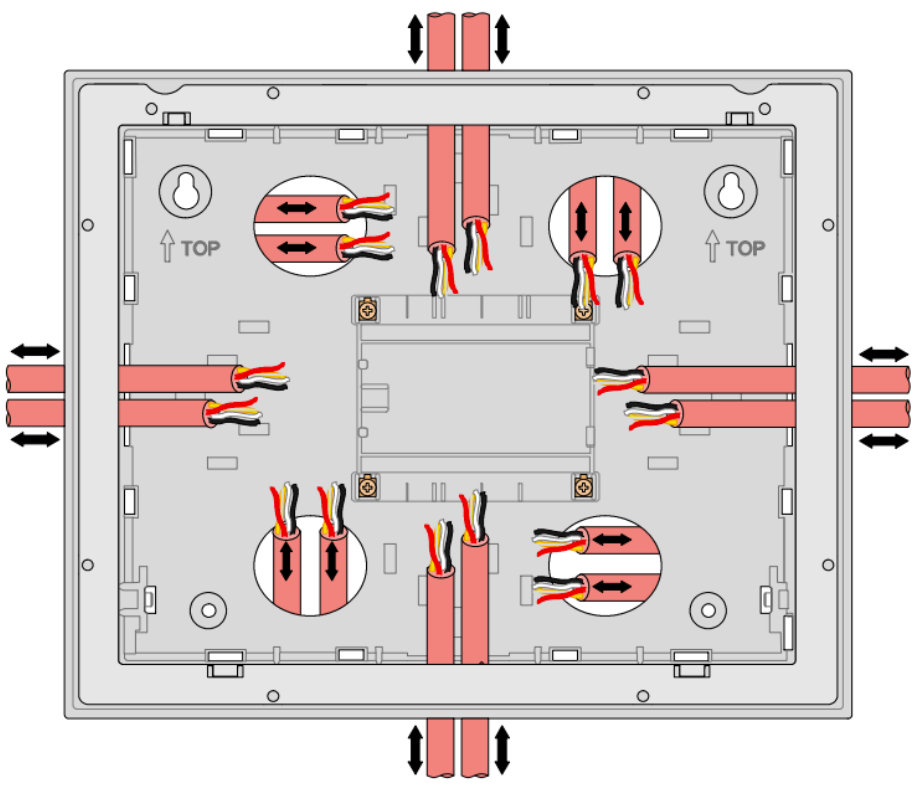
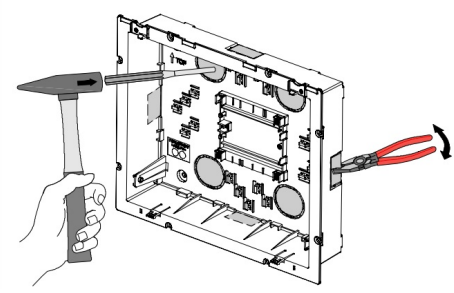

Product Overawe

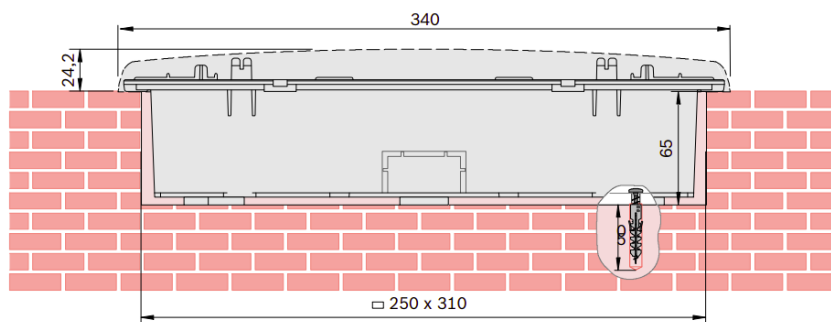
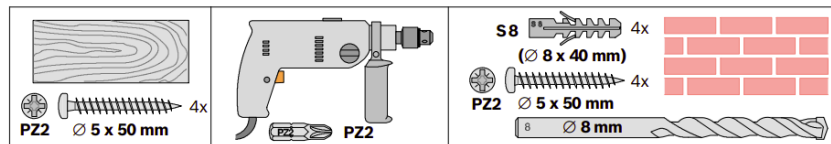
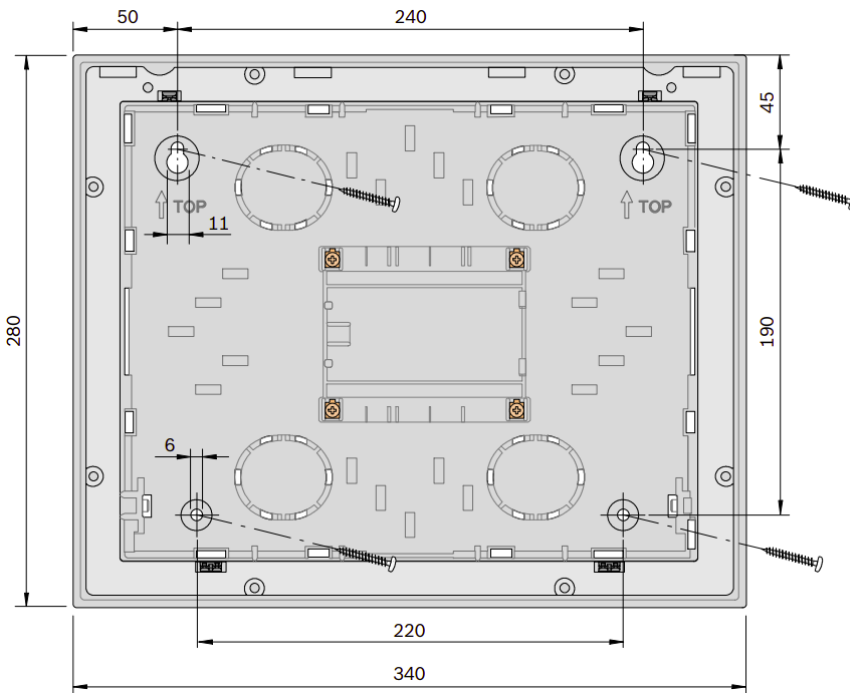
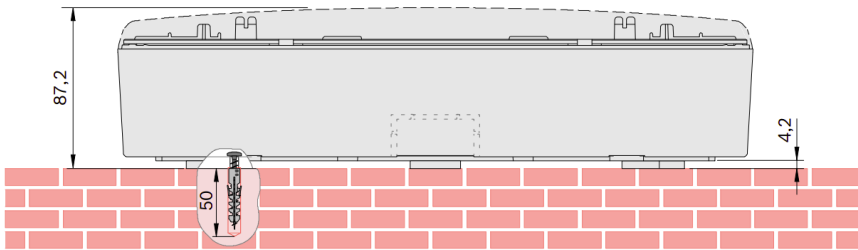
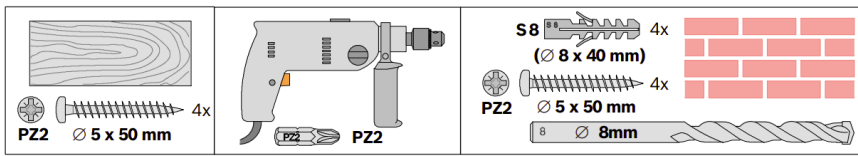

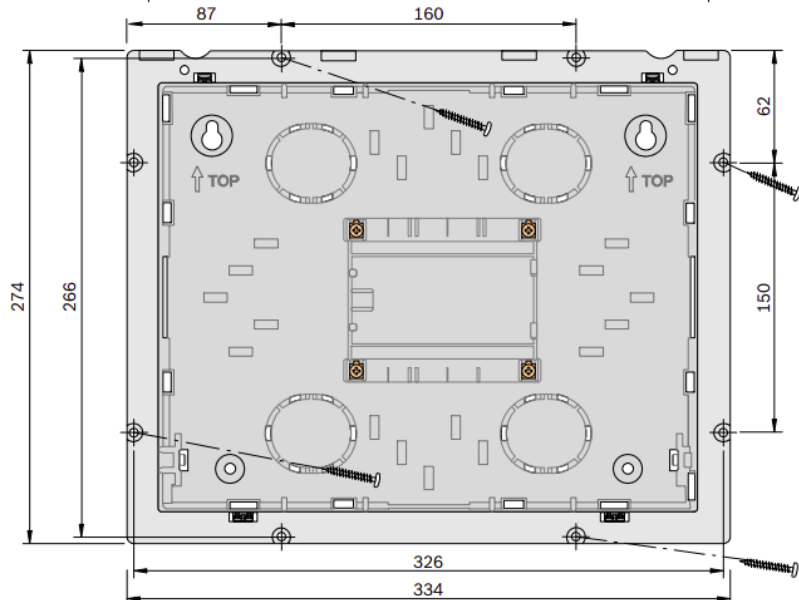
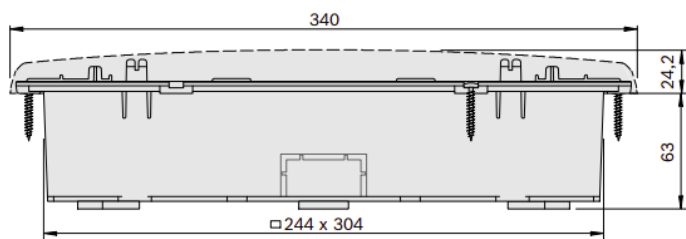
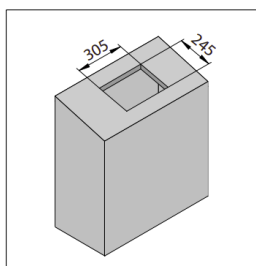
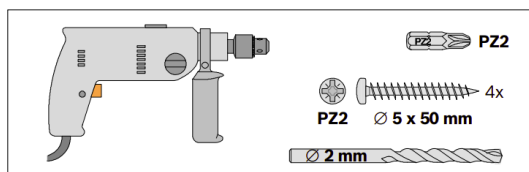
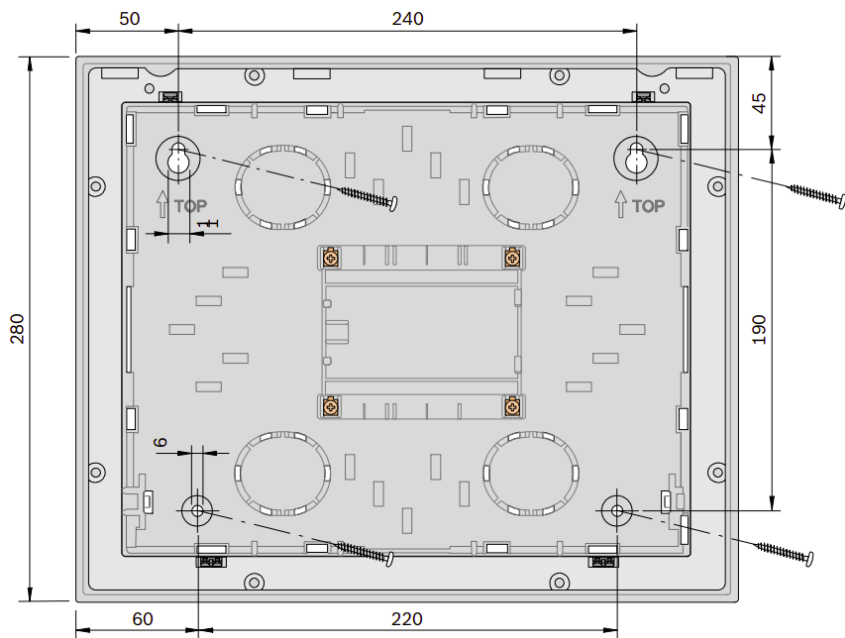

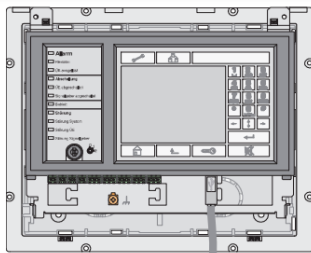
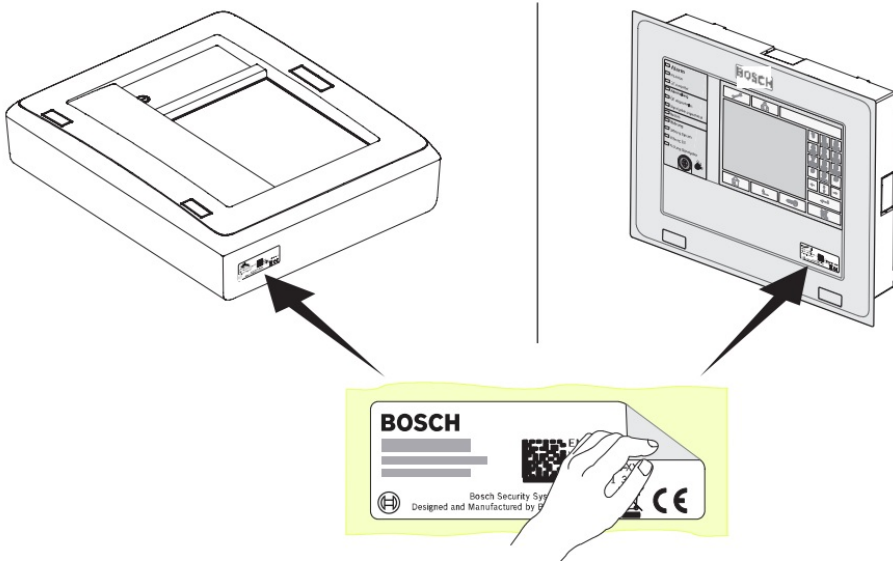

USB

≤ 2 m

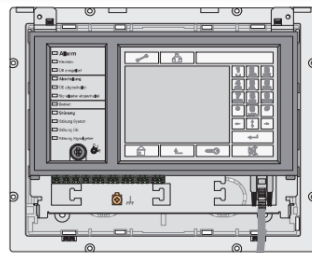

RS232

≤ 2 m



1.

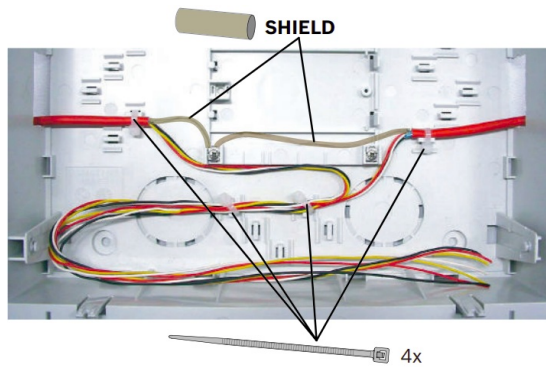
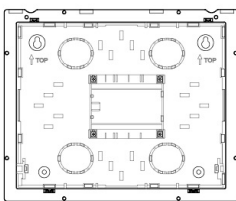

2.

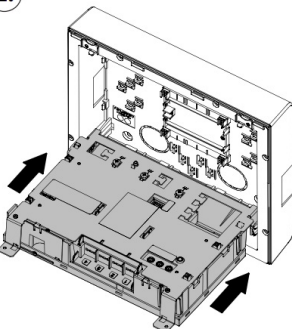

3.

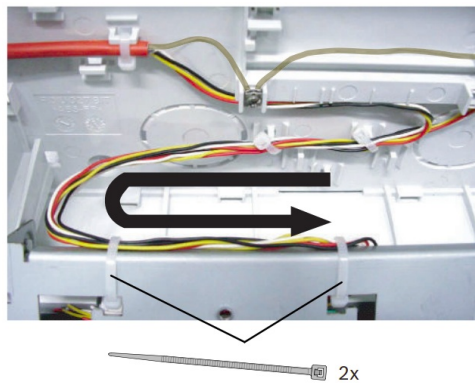

4.

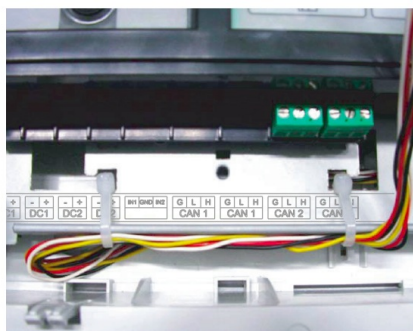
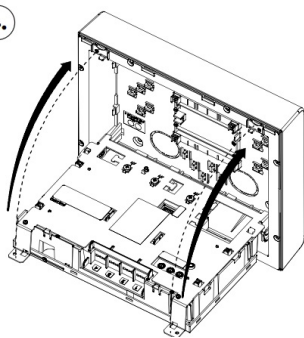

FPA-5000

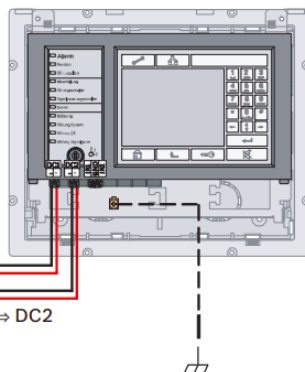
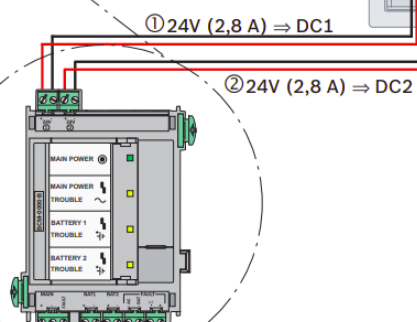
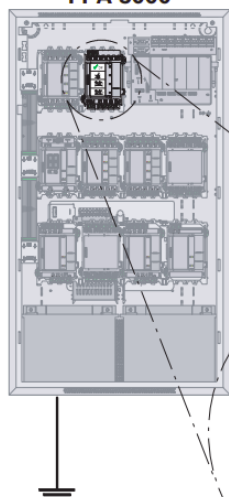

FPP-5000

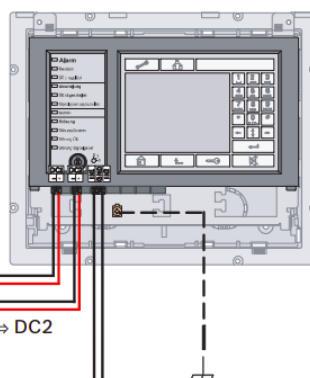
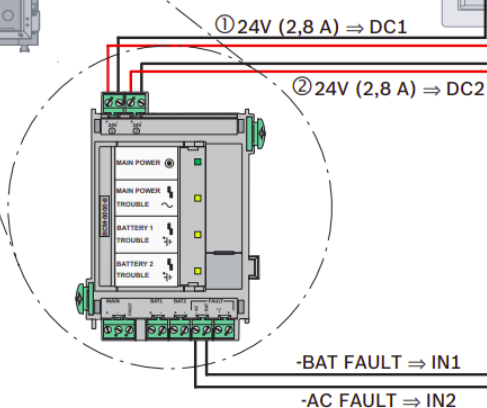
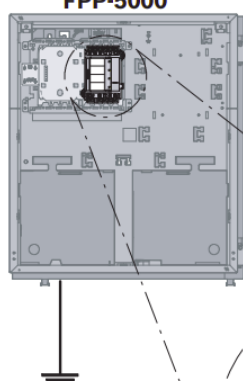

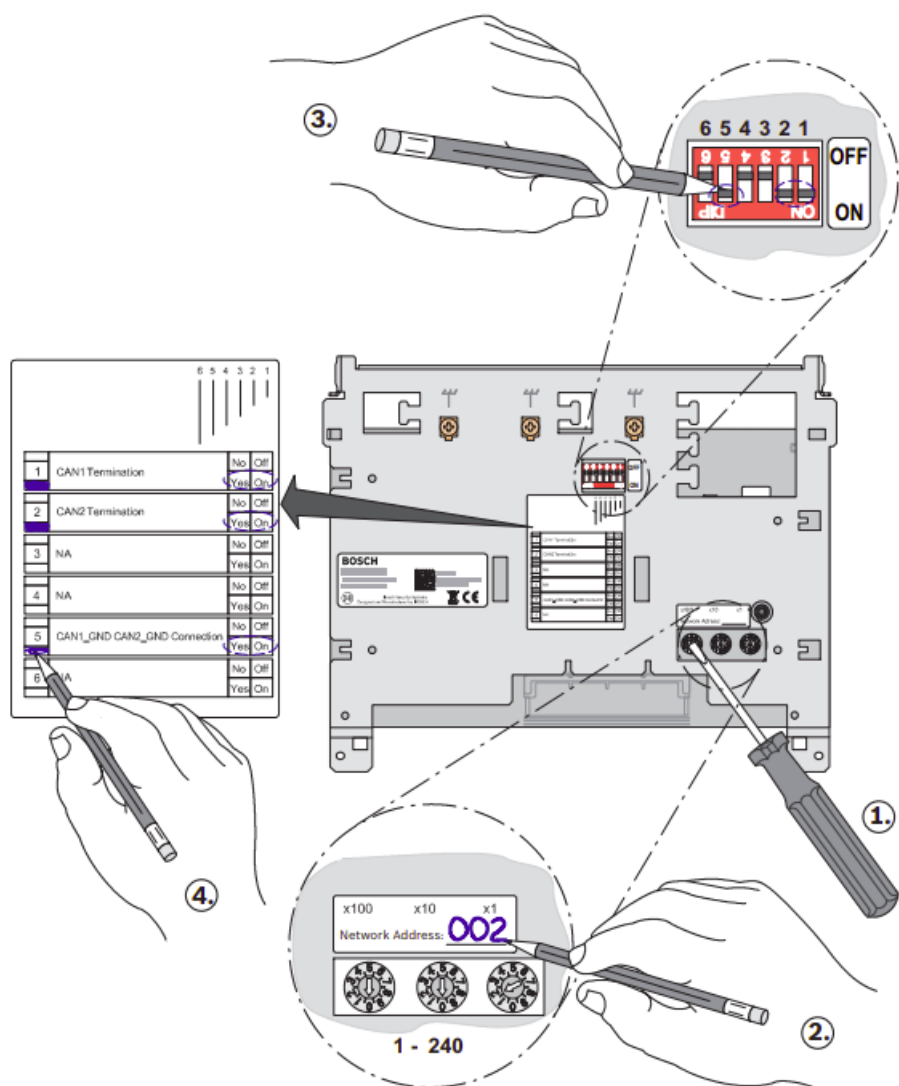

WARNING!

Live components and stripped cable! Risk of injury from electric shock. The system must be current-free during connection work.



NOTICE!

Installation must only be performed by authorized and specialized personnel!

Functional Description

The Remote Keypad can be used to perform the same operating procedures as the control panel, enabling variable operation of a networked system. It has the following functional elements (see Figure 1, Page 4):

Pos .	Designation	Function
A	Touch screen	Operating the networked system through virtual buttons and variable display windows
B	22 fixed buttons	Standard entries
C	11 LEDs	Indicating the operating status
D	Key switch	2 switch settings, freely programmable, e.g. for switching between day/night mode or connecting/disconnecting for local alarm signaling
E	Reboot button	Remote Keypad HW reset
F	6-pin DIP switch	Configuration
G	3 rotary switches	Address setting

Installation

Follow the mounting instructions according to the mounting variant for your application.

Before mounting the housing, remove the operating unit. This prevents the touch screen being damaged and facilitates installing the lower mounting screws.

Wiring

- Connect the shield wires to the screw terminal (Figure 11, Page 13 (step 1)).
- Fasten the cables with cable ties (Figure 11, Page 13, step 1 to 4).

The Remote Keypad has

- 2 CAN interfaces (CAN1/CAN2) for networking
- 2 Ethernet interfaces (ETH1/ETH2) for networking
- 2 signal inputs (IN1/IN2)
- 1 USB and 1 RS232 interface

Consider the maximum cable length of 2 m when using the USB and RS232 interfaces (see Figure 10, Page 12).



NOTICE!

You will find detailed information about the CAN and Ethernet networking of the fire panels in the Networking Guide available for download at www.boschsecurity.com.



CAUTION!

If Ethernet networking is planned, the Remote Keypad must be grounded.

Address Setting and Configuration

1. Assign a unique physical address to each Panel Controller and Remote Keypad by setting the rotary switches and write it down on the label (see Figure 13, Page 15, step 1 and 2).
2. For configuration, set the 6-pin DIP switch (see Figure 13, Page 15, step 3).
3. Mark the setting on the provided label (step 4).

Technical Data

LCD Display / touch screen	LCD display with 320 x 240 pixels, touch screen with 127,5 mm x 170 mm active surface
Operating and display elements	22 buttons, 1 key switch, 11 LEDs, 1 Reboot button
Interfaces	CAN1, CAN2, ETH1, ETH2, USB, RS232
Signal inputs	IN1/IN2
Permissible length of CAN cable for system networking	Lmax = 1000 m, depending on configuration, cable type and topology
Power supply connection	DC1 (power supply), DC2 (redundant power supply)
Input voltage	12 V DC to 30 V DC, from FPA-5000 or FPP-5000
Maximum line resistance of power supply	18 Ω
Maximum current consumption	– Standby operation: 140 mA at 24 V DC- alarm: 230 mA at 24 V DC During an
Permissible operating temperature	-5 °C to +50 °C
Permissible storage temperature	-20 °C to +70 °C
Housing material and color	ABS plastic, light gray (similar RAL 7035)
Dimensions (H x W x D)	280 mm x 340 mm x 87 mm
Weight	Approx. 3 kg

Bosch Sicherheitssysteme GmbH

Robert-Bosch-Ring 5

85630 Grasbrunn

Germany

www.boschsecurity.com

© Bosch Sicherheitssysteme GmbH, 2012



BOSCH

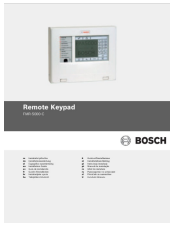

[BOSCH FMR-5000-C Remote Keypad](#) [pdf] Installation Guide
FMR-5000-C, FMR-5000-C Remote Keypad, Remote Keypad, Keypad

References

- [Home | Bosch Security and Safety Systems | Global](#)
- [Home | Bosch Security and Safety Systems | Global](#)
- [Home | Bosch Security and Safety Systems | Global](#)

Manuals+.