



bonsaii C261-C 8 Sheet Document Shredder Instructions

[Home](#) » [Bonsaii](#) » **bonsaii C261-C 8 Sheet Document Shredder Instructions** 



If there is a problem with your shredder, check below for the symptoms and steps to resolve. If you continue to have problems, contact customer support at our Service Center.

DO NOT ATTEMPT TO REPAIR BY OPENING THE SHREDDER HEAD. This will completely void the product warranty.

Contents

- 1 STOP WORKING**
- 2 Shredder does not feed or shred paper**
- 3 PAPER JAM**
- 4 Documents / Resources**
 - 4.1 References**

STOP WORKING

1. Check power outlet

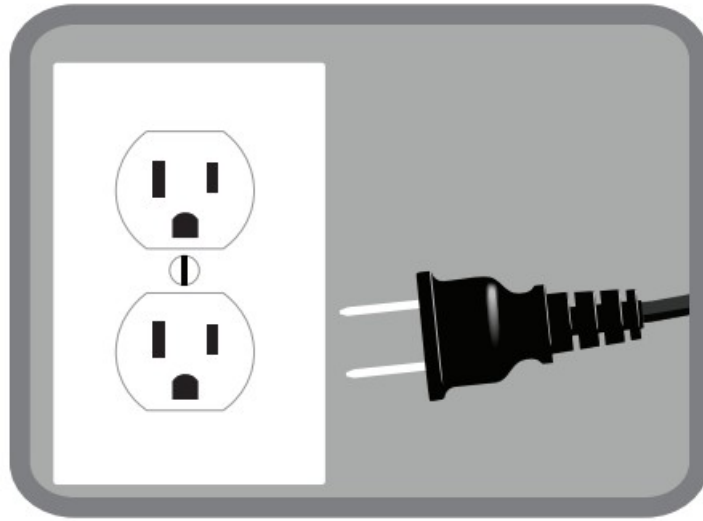

2. Shredder head correctly installed

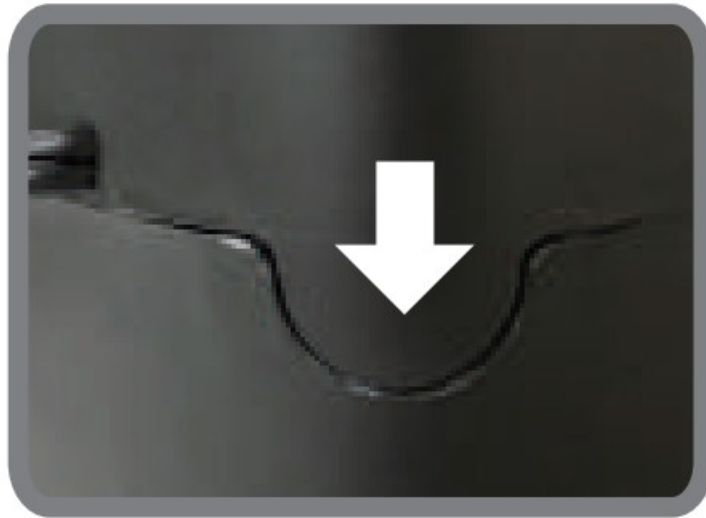

1. Please check whether you use the machine with the supply voltage that matches the machine label, or plug in again correctly.
2. Check if the head unit portion of the shredder is correctly seated onto the included wastebasket.

Shredder does not feed or shred paper

Overheat

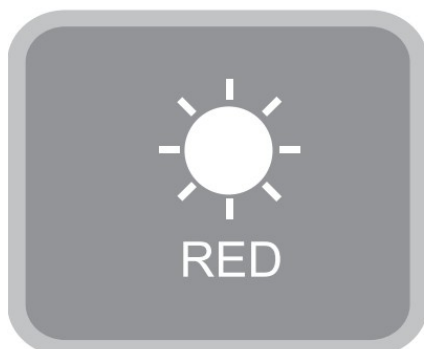

Cool down



If the heat lamp is red, turn off the shredder and let it cool for 40 minutes. Set the machine switch to "AUTO" mode, when the indicator light green, you can reuse the shredder.

PAPER JAM

1. Empty if bin full.

Carefully remove paper on shredder head bottom

2. Reverse for 5 sec



3. Then pull paper side to side

4. Push to "FWD" mode

5. Reduce sheets

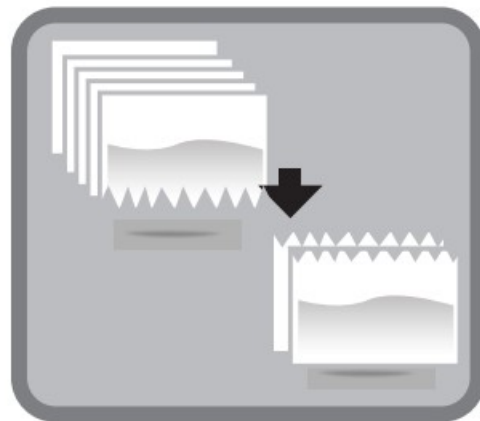

Solution

1. When the waste bin is full, empty the shredded materials in the bin.
2. Set switch to reverse for 5 sec.
3. Pull paper side to side to remove jammed paper (as much as possible).
4. Set the switch to the "FWD" position.
5. Reduce the number of sheets being fed (count pages to be sure not to exceed the maximum sheet count).

With stubborn situations where the reverse function does not help, follow the steps below:

1. Turn off shredder
2. Apply shredder oil and wait for 30min
3. Set switch to Auto

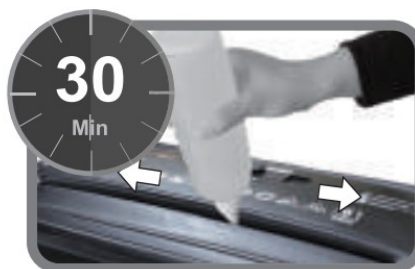

Solution :

1. Turn off shredder.
2. Apply shredder oil to the feed slot. Let oil soak in to paper and machine for 30 minutes.
3. Set the control switch to Auto.
4. Use a stiff paper card to push out the jammed paper.

Shredder does not feed or shred credit card or small piece of paper

- Position credit card or small piece of paper over the credit card section of the Feeder (center position).
- Push down firmly.

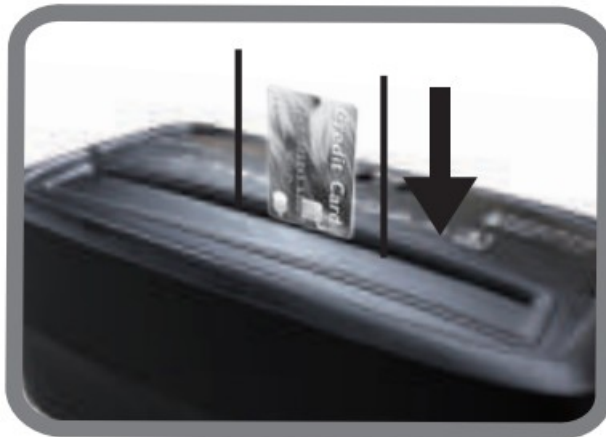

Documents / Resources

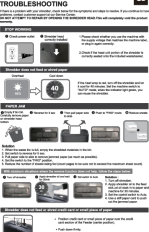
	<p>bonsaii C261-C 8 Sheet Document Shredder [pdf] Instructions C261-C, C261-C 8 Sheet Document Shredder, 8 Sheet Document Shredder, Document Shredder, Shredder</p>
---	---

References

- [User Manual](#)