



Bol com A5 Q9 100% LED Screen Power Display User Manual

[Home](#) » [bol.com](#) » Bol com A5 Q9 100% LED Screen Power Display User Manual 

Contents

- [1 Bol com A5 Q9 100% LED Screen Power Display](#)
- [2 Product Information](#)
- [3 Product Usage Instructions](#)
- [4 Introduction](#)
- [5 Product Description](#)
- [6 Specifications](#)
- [7 Documents / Resources](#)
- [8 Related Posts](#)



Bol com A5 Q9 100% LED Screen Power Display



Product Information

- Input: 5V=2A (Lightning), 5V=3A, 9V=2A, 12V=1.5A (Type-c interface/PD)
- Output: 5V/2A, 9V/2.22A, 12V/1.5A (Type-c interface/PD), 5W/7.5W/15W (Wireless output)

Product Usage Instructions

To use the product, follow these steps

1. Make sure the power bank is charged and has sufficient battery capacity.
2. Identify the appropriate input port based on your device's charging cable:
 - If your device uses a Lightning cable, connect it to the 5V/2A (Lightning) input port.
 - If your device uses a Type-C interface with Power Delivery (PD) support, connect it to the 5V/3A, 9V/2A, or 12V/1.5A (Type-c interface/PD) input port based on the required voltage.
3. Connect your device to the power bank using a compatible charging cable.
4. Ensure that the power bank is turned on if it has a power switch.
5. Monitor the charging progress on your device's screen or LED indicators.
6. To use the wireless charging feature, place your Qi-compatible device on top of the power bank's wireless charging pad.
7. Once your device is fully charged, disconnect it from the power bank.
8. If you're done using the power bank, disconnect all cables and turn it off (if applicable).

Introduction

The mobile power supply adopts an aluminum + plastic material shell, supports the apple, and the Type-C input, uses the built-in Type-C PD to Connect to other mobile devices, and a magnetic suction wireless charger can charge the battery for the equipment.

Product Description

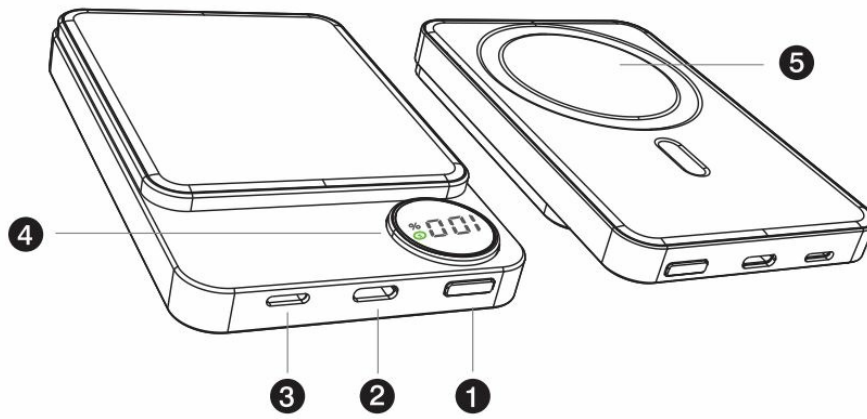

Power switch

1. (click to open the mobile power supply, the use of the quick charger/ the wireless charger will display symbols 3.
2. Type C interface/PD (input/output)
3. The Apple Line interface
4. LED display to check the power
5. Magnetic suction wireless charger

Specifications

- Input: 5V=2A(Lightning)
- Input: 5V=3A 9V=2A 12V=1.5A (Type-c interface/PD)
- Output: 5V/2A 9V/2.22A 12V/1.5A (Type-c interface/PD)
- Output: 5W/7.5W/15W (Wireless output)
- Battery: lithium polymer battery
- Number of cycles to be recharged: 500 times
- Suitable environmental temperature: 0°C-40°C

User manual

1. The built-in Type-C and Apple input ports can be connected to battery products.
2. Use the built-in Type-C PD for other mobile devices and magnetic suction outlet connection wireless charger can charge the battery for the equipment.
3. Click to open the mobile power supply equipment, and the use quick charger/wireless charger will display symbols 3

Common Problems and Solutions

Fault	Reason	Resolvent
Charge the product for a long time The LED screen does not display full	1., the charging time is not enough 2. charger or this product malfunction	1. Our product capacity of 5000 cumulative charge more than 5 hours, The capacity of 10000 cumulative charge more than 8 hours. 2. consultation with distributors or after sales service
Unable to check the remaining power of this product	1., the remaining power is zero 2. power button or indicator light failure 3. the power failure of this product	1. recharge 2. consultation with distributors or after sales service
When charging for other equipment, the product can charging or powering, but not full of it	The power consumption of this product is exhausted	Recharge the product again
This product still has a certain amount of electricity, the use of its external power supply, the emergence of this product suddenly stop working and unable to display power	External short-circuit or excessive load, Cause automatic protection of this product	Recharge the product to activate it

Matters needing attention

The first use of this product, cycle, charge and discharge once, can better improve the service life of the product! Please read all the instructions carefully before using the product! Please do not disassemble the product, or it will cause the warranty invalid!

Documents / Resources

	Bol com A5 Q9 100% LED Screen Power Display [pdf] User Manual A5 Q9 100 LED Screen Power Display, A5 Q9, 100 LED Screen Power Display, LED Screen Power Display, Screen Power Display, Power Display, Display
---	--