



## **Taille S Connected and Secure Parcel Box**



# **boks Taille S Connected and Secure Parcel Box Installation Guide**

[Home](#) » [boks](#) » **boks Taille S Connected and Secure Parcel Box Installation Guide** 

### **Contents**

- [1 boks Taille S Connected and Secure Parcel Box](#)
- [2 Packaging content](#)
- [3 Assembly](#)
- [4 Technical support](#)
- [5 Technical features](#)
- [6 CE Declaration of Conformity](#)
- [7 Documents / Resources](#)
  - [7.1 References](#)
- [8 Related Posts](#)



**boks Taille S Connected and Secure Parcel Box**



**Packaging content**

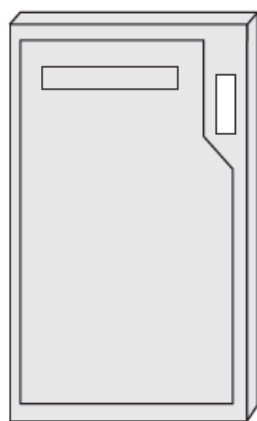

**A1** **A2**



**B**

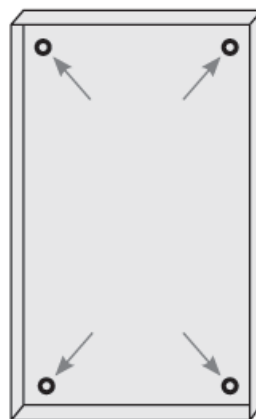

**C**

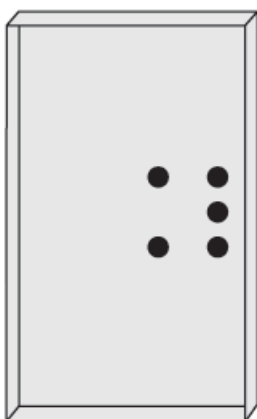

**D**

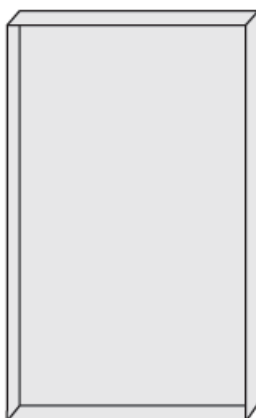

**E**

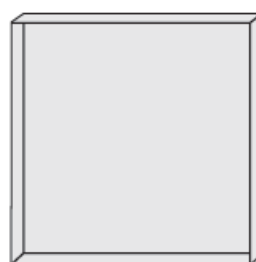

**F**



**G**

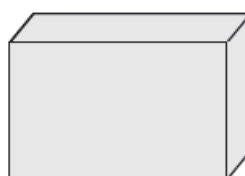

**H**

- **A1.** Front face
- **A2.** Door
- **B.** Base (with 4 mounting holes)
- **C.** Rear panel (with 4 mounting holes)
- **D.** Right side panel
- **E.** Left side panel
- **F.** Roof
- **G.** Keyboard + Batteries
- **H.** Mounting kit

H ①



- Screwdriver handle
- Manche de tournevis
- Mango de destornillador
- Schroevendraaierhandvat
- Schraubendrehergriff
- Manico del cacciavite



- Phillips head bit
- Embout cruciforme
- Punta cruciforme
- Kruiskopbit
- Kreuzschlitz-Schraubendreherbit
- Punta a croce



- Hex bit
- Embout hexagonal
- Punta hexagonal
- Zeskantbit
- Sechskant-Schraubendreherbit
- Punta esagonale



- Flexible
- Flexible
- Flexible
- Flexibel
- Flexibel
- Flessibile

H ②



(x54)

- Nuts
- Écrous
- Tuercas
- Moeren
- Muttern
- Dadi

H ③



(x4)

- Brackets
- Équerres
- Escuadras
- Hoeksteunen
- Winkel
- Staffe



(x4)

- S hooks
- Crochets en S
- Ganchos en S
- S-haken
- S-Haken
- Ganci a S

H ④

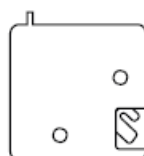

- Electric lock
- Serrure électrique
- Cerradura eléctrica
- Elektrisch slot
- Elektrisches Schloss
- Serratura elettrica

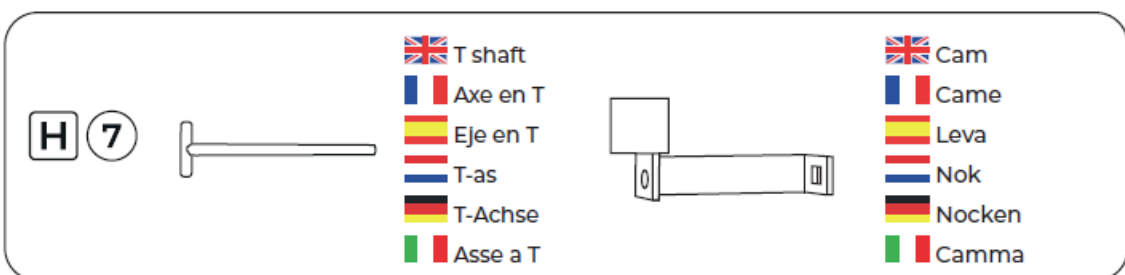
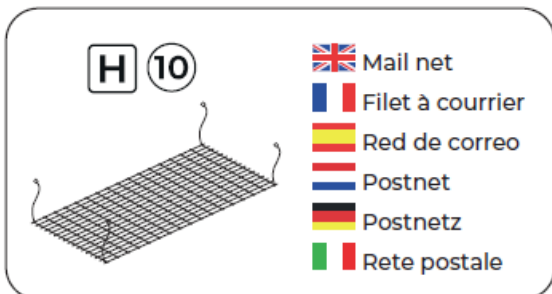
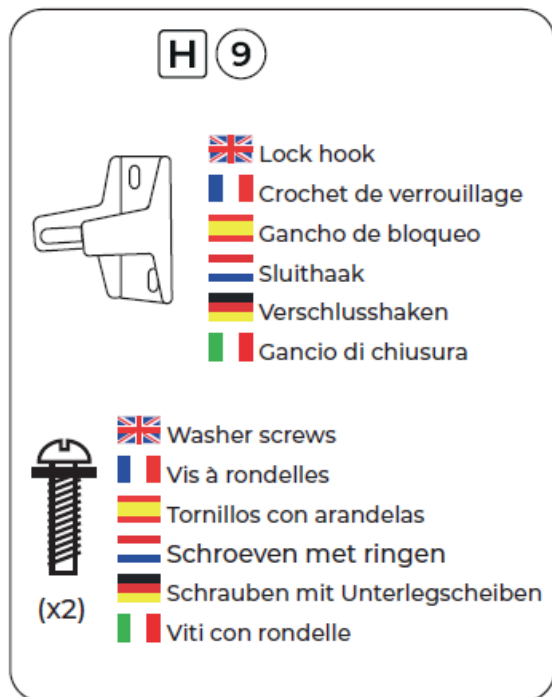
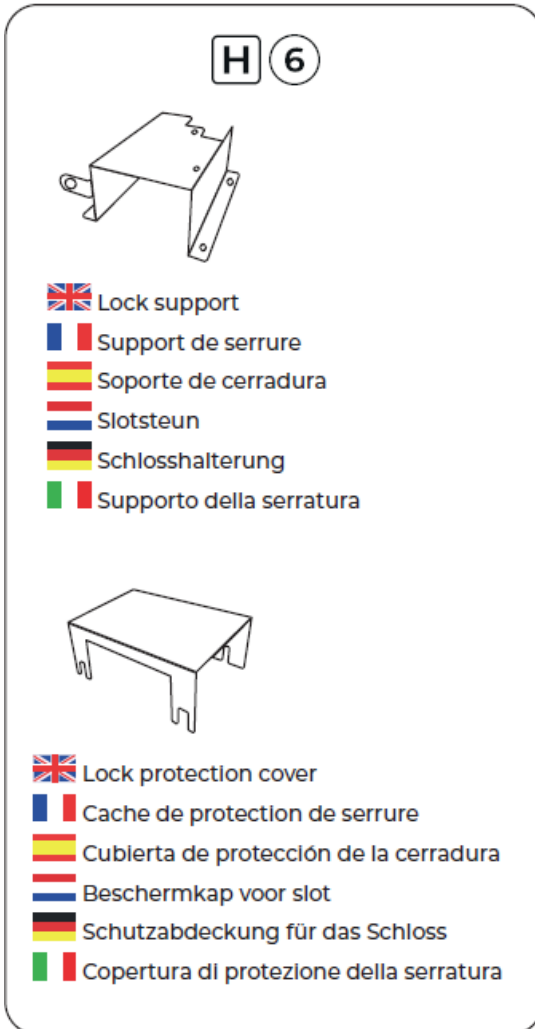
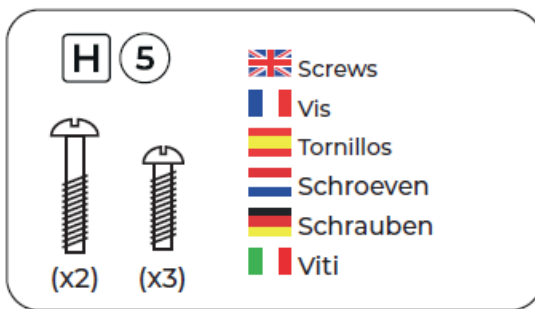

### Read before starting the assembly

- Follow the steps in this guide without skipping any: you will need to switch from the assembly guide to the Boks mobile app and back to ensure efficient and safe assembly
- Do not overtighten the nuts, as this may break or tear the studs
- Allow about 30 minutes for a complete assembly
- If possible, perform the assembly on a smooth surface (such as a table) to avoid scratching the paint
- Have a smartphone connected to the internet

## Assembly

### Keyboard power supply



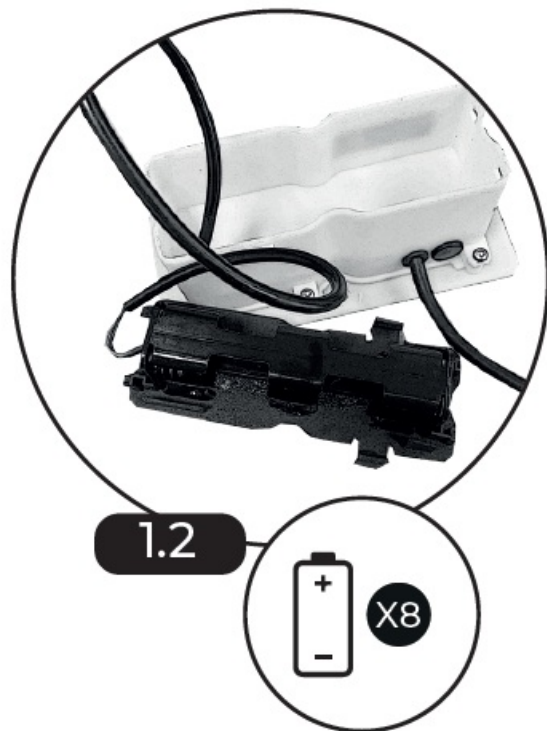
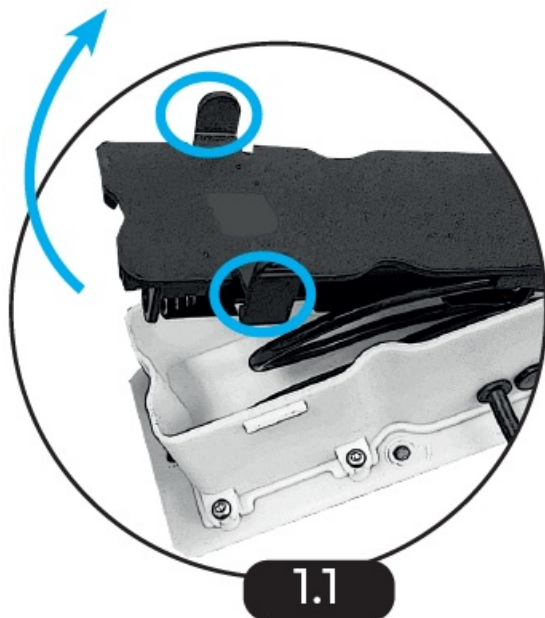

### Creating a Boks account

Do not skip this step: it is essential for the proper functioning of your Boks



Removing the door

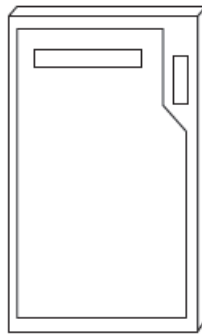

A1 A2

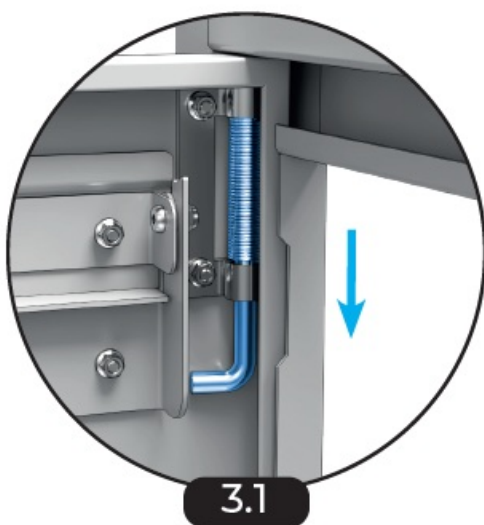

**Fixing the keyboard to the front face**

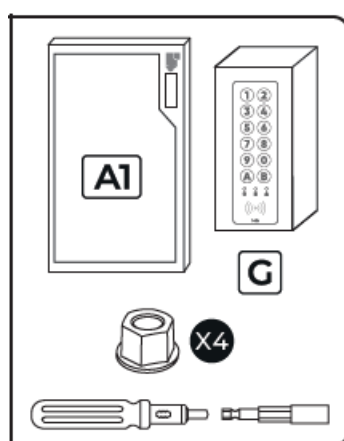

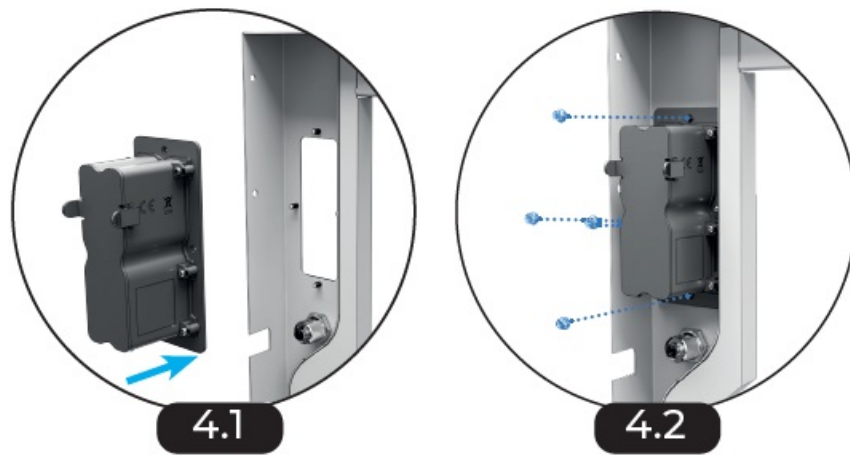

The plastic casing of the keyboard should rest flat against the metal for a good seal, but avoid overtightening the nuts as this could deform the casing

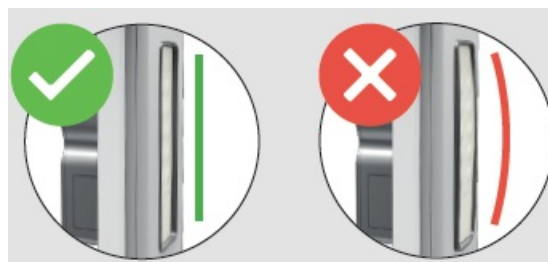

**Fixing the electric lock support on the right side**

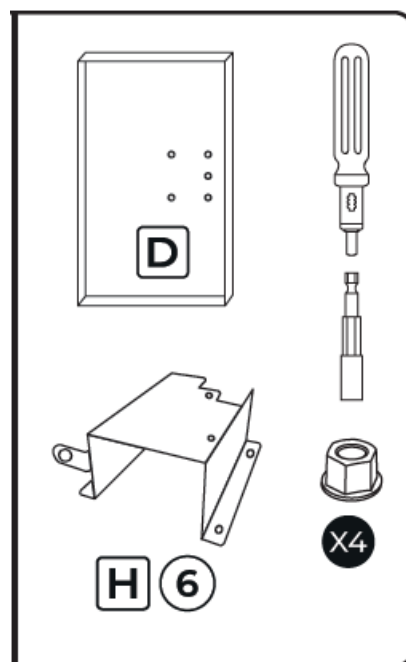

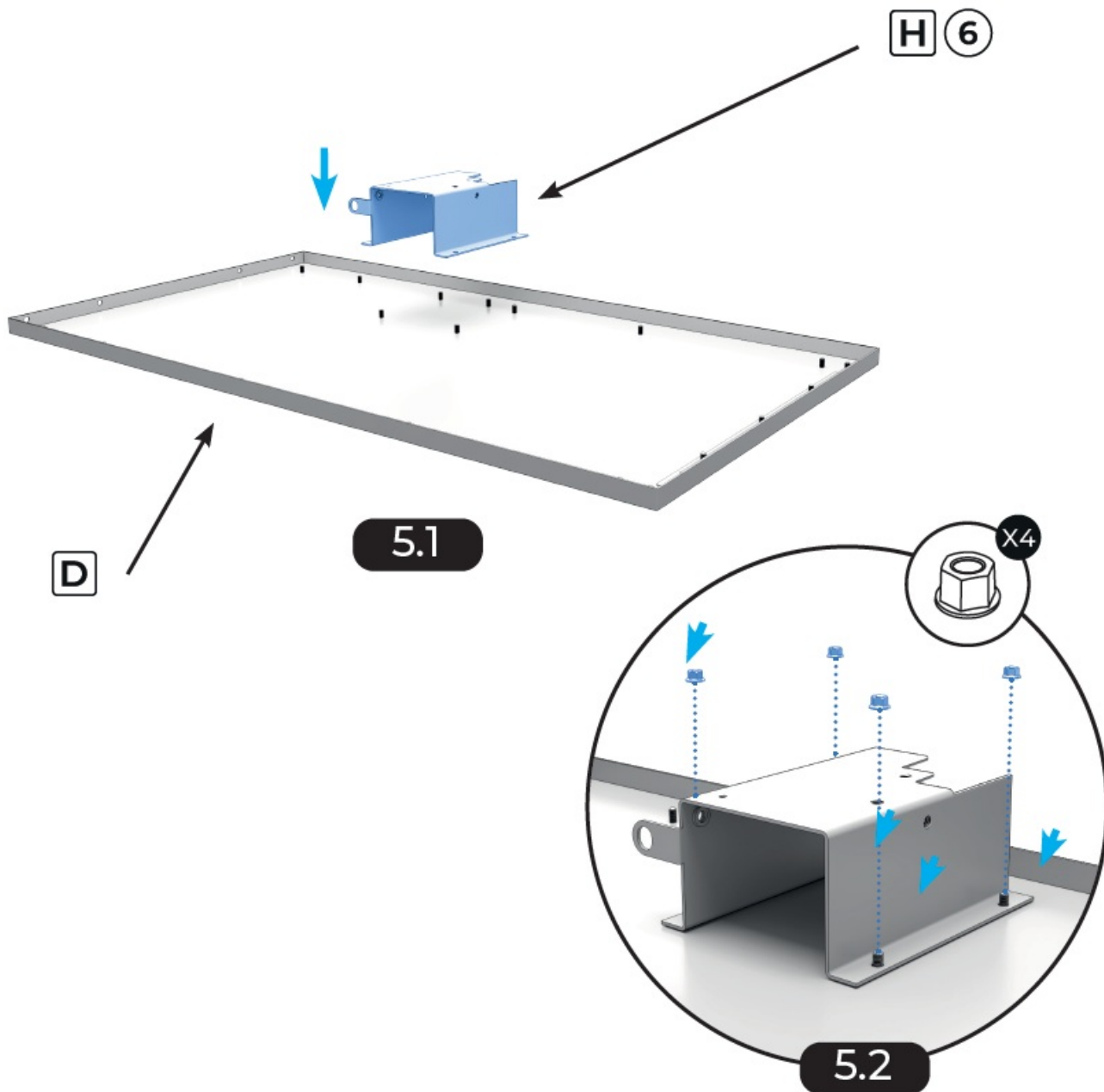

Fixing the electric lock and its protection cover

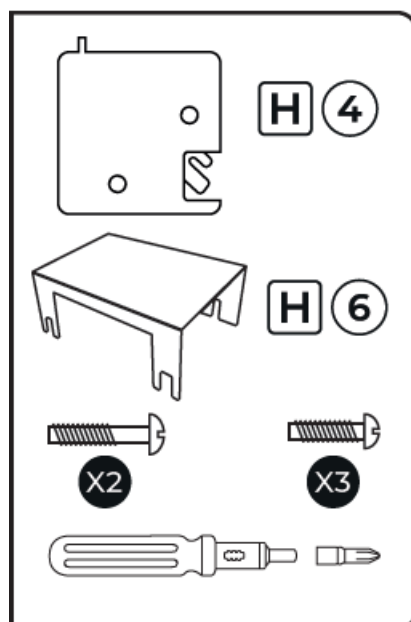

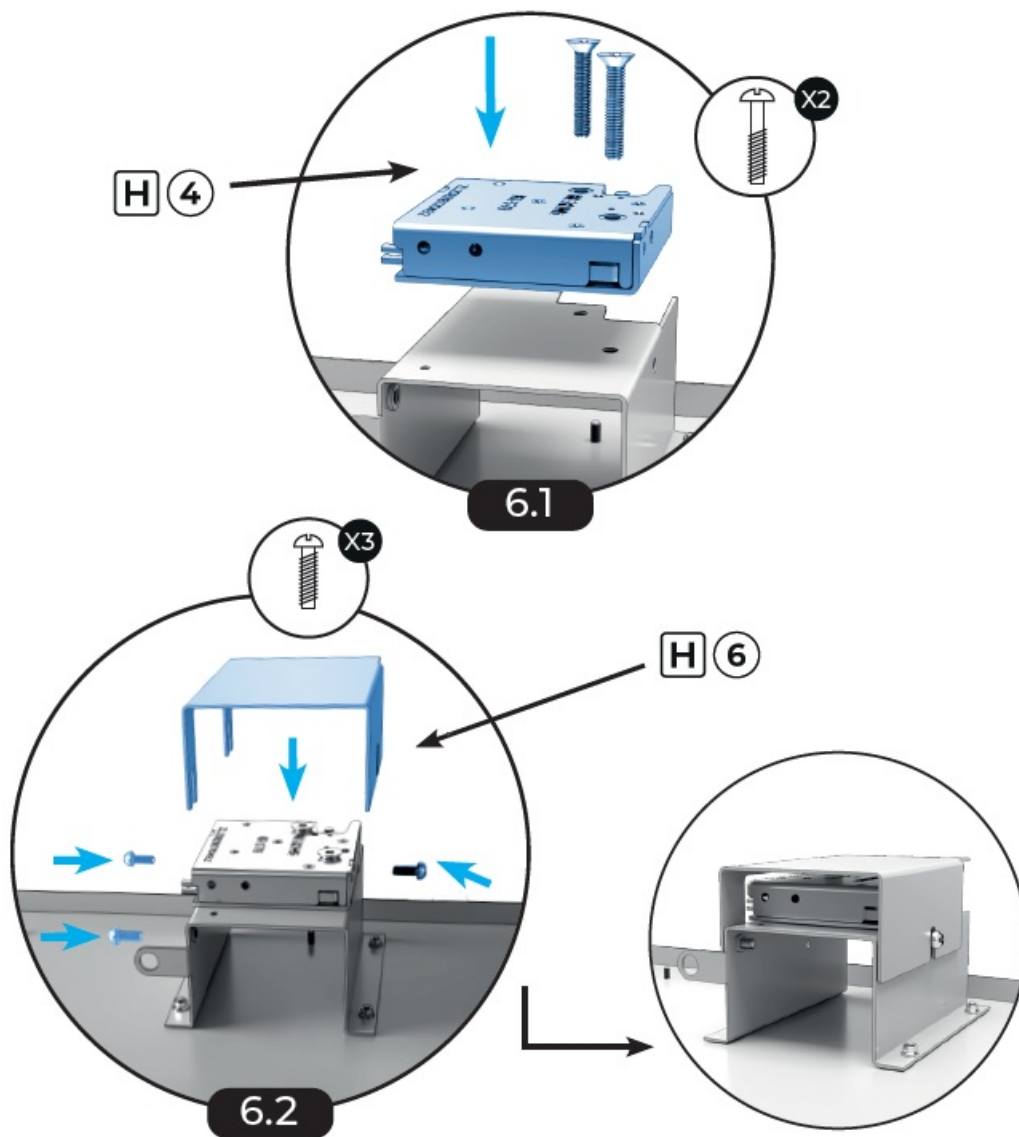

#### Assembling the base to the front face

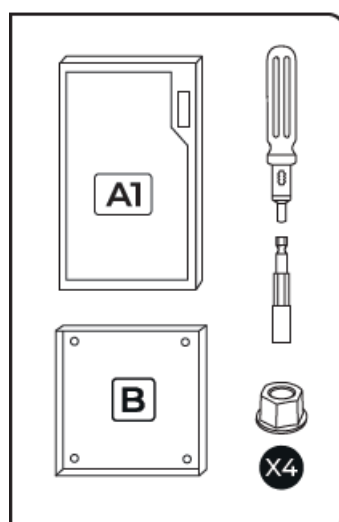

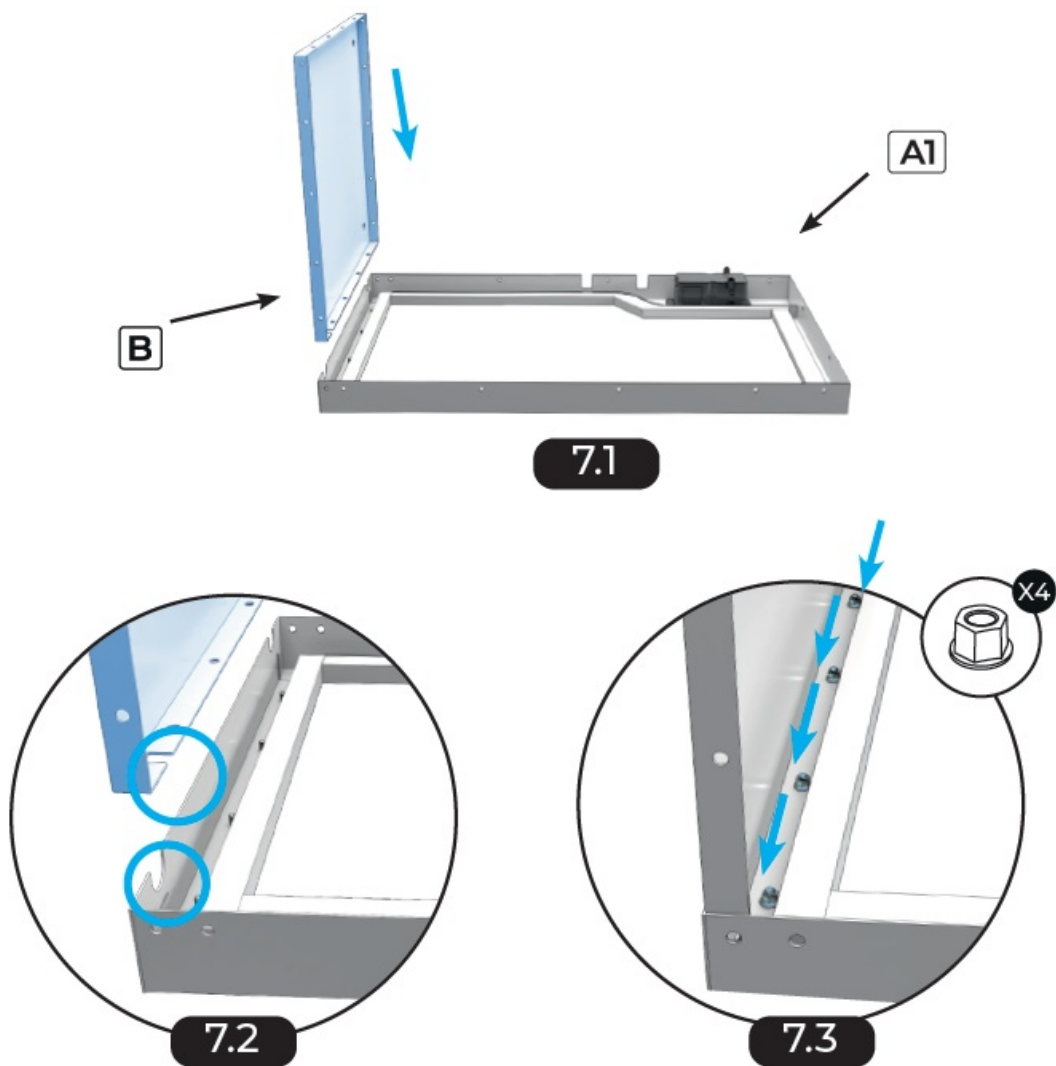

### Assembling the rear panel

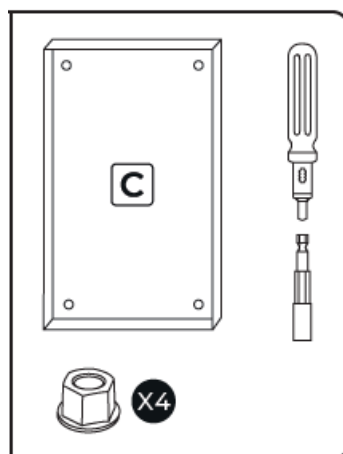

If you purchased a rear panel with an integrated hatch, simply replace the standard rear panel with the one equipped with the hatch, using the same mounting method



8.1

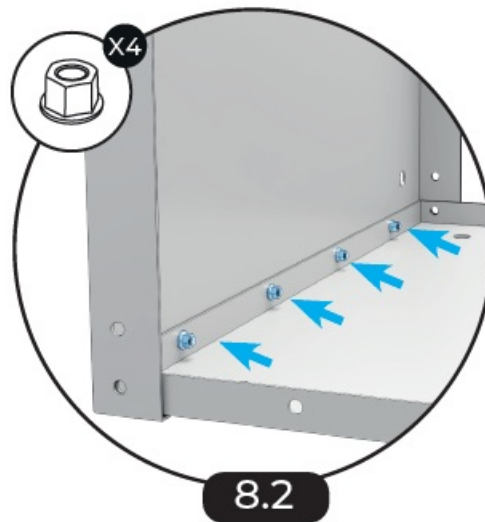

8.2

**Assembling the right side panel**

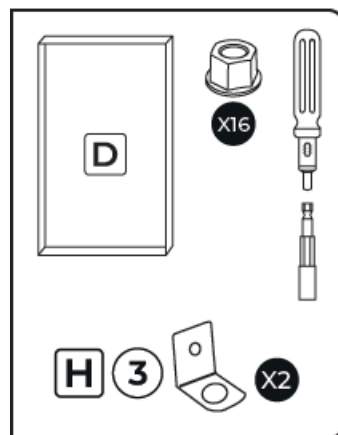

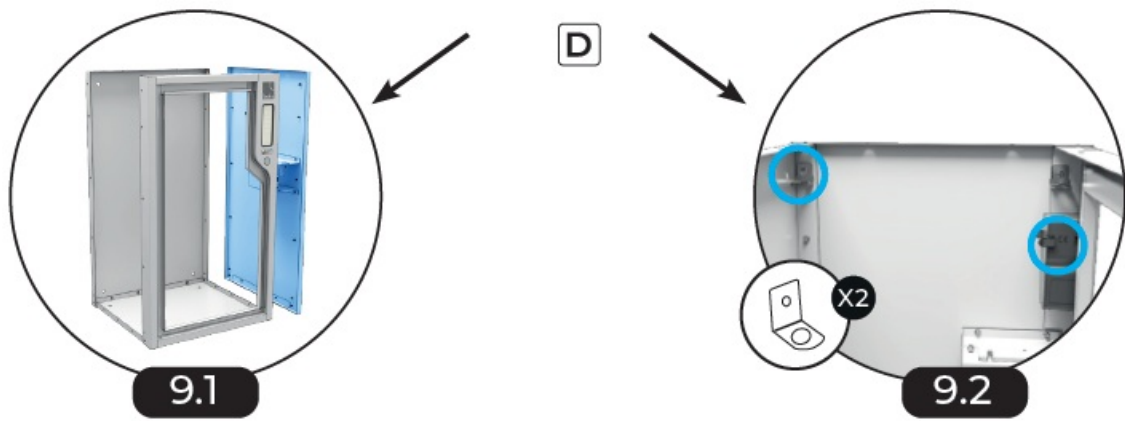

Place 2 brackets at the same level as the 2 upper studs

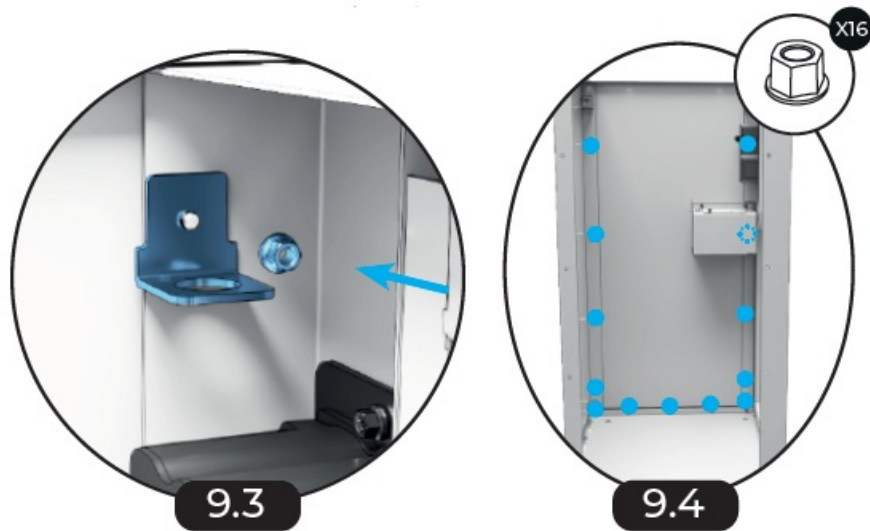

Fixing the manual opening system

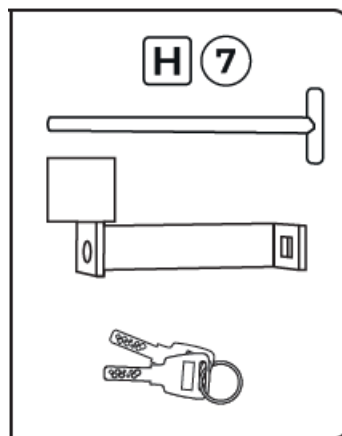

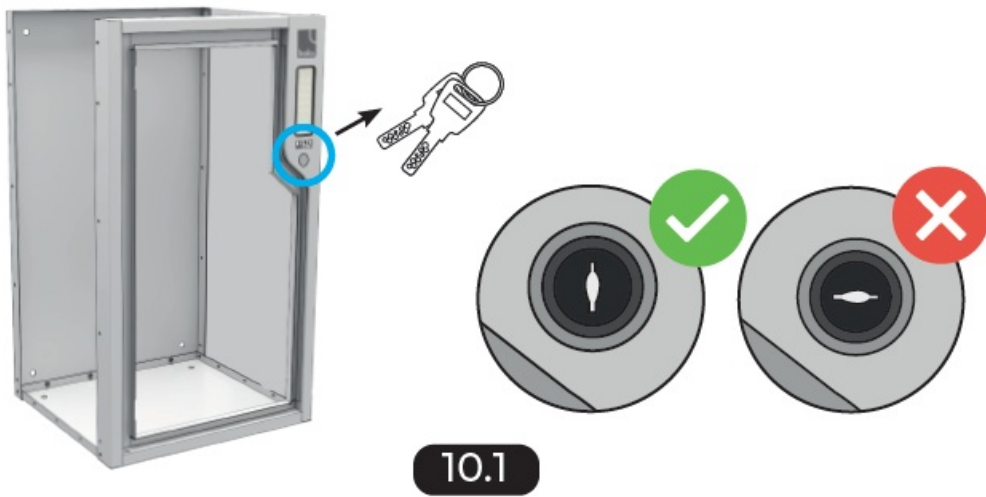

Remember to remove the key before continuing to prevent the cylinder from freely rotating

**Remove the nut (1) and keep the washer (2)**

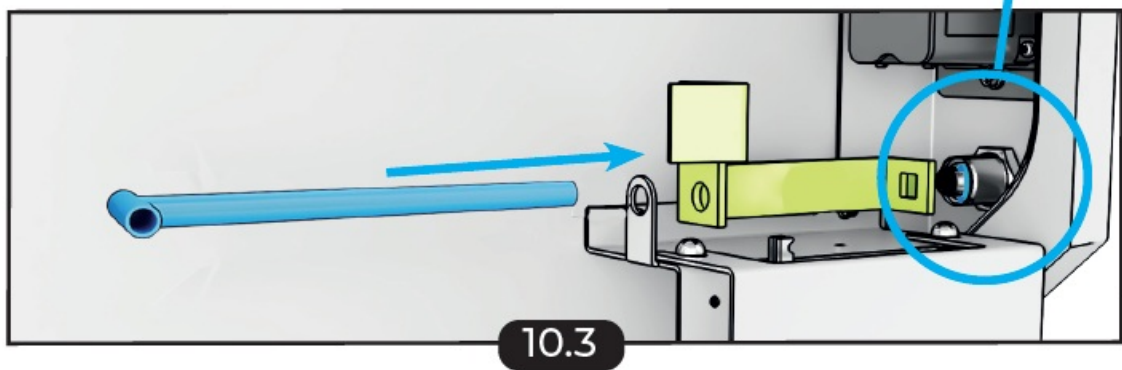
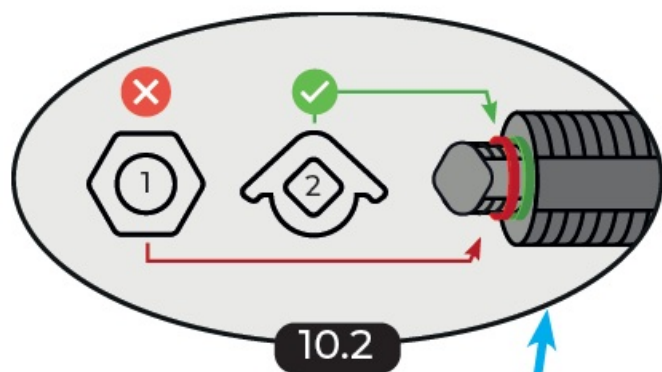

Insert the T shaft into the lock support and into the cam (positioned vertically as shown in the illustration)

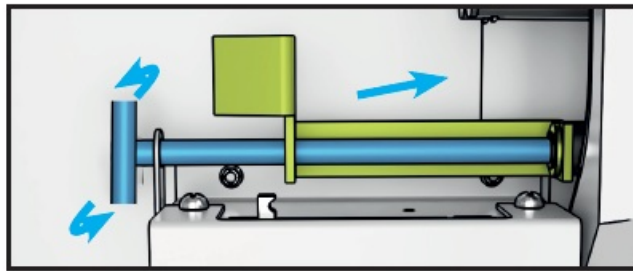
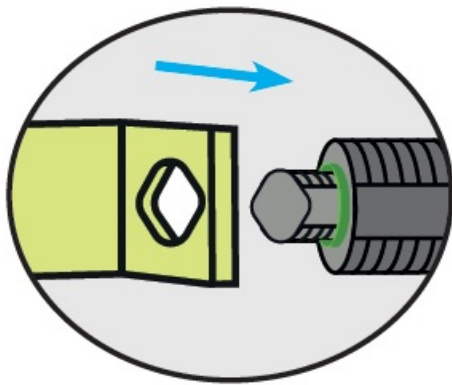

## Connecting the lock to the keyboard

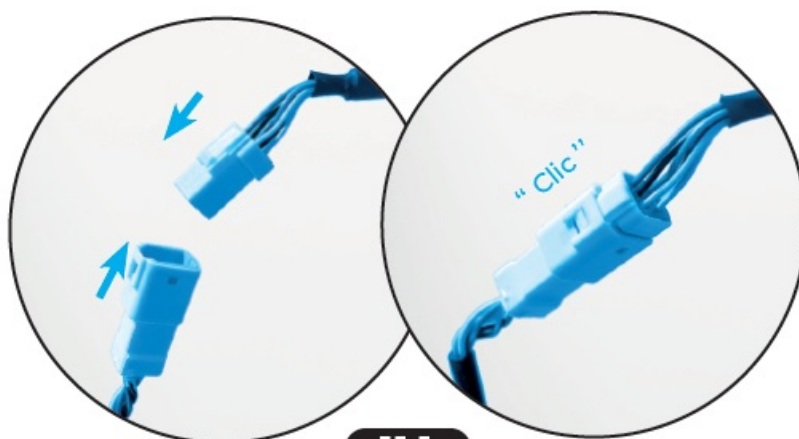

11.1

## Your Boks beeps?

This is normal, it indicates that the lock is open: push the tab to close the electric lock and disable the beep while you finish the assembly.

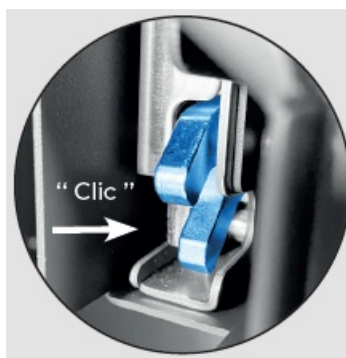

## Fixing the lock hook to the door

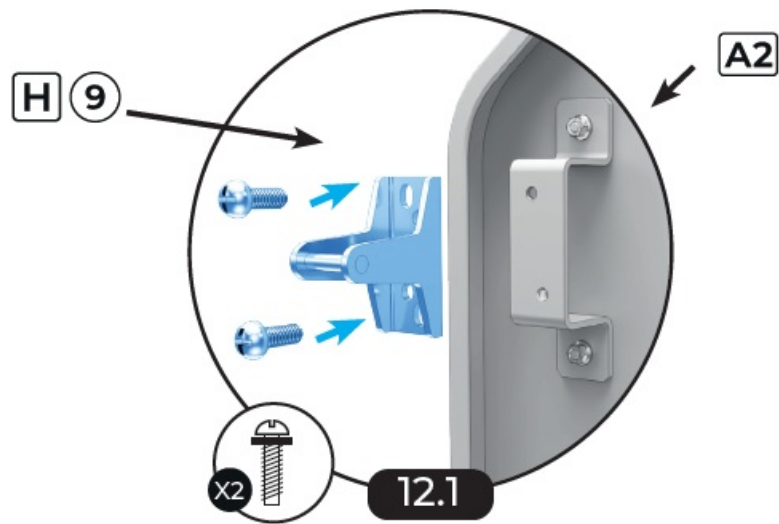
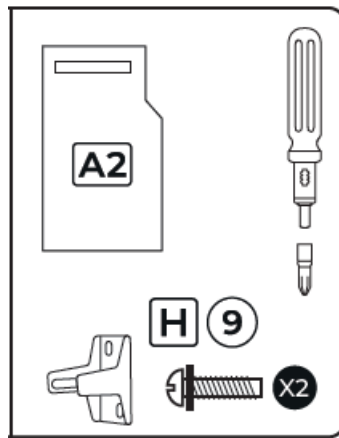

**Installing the door**

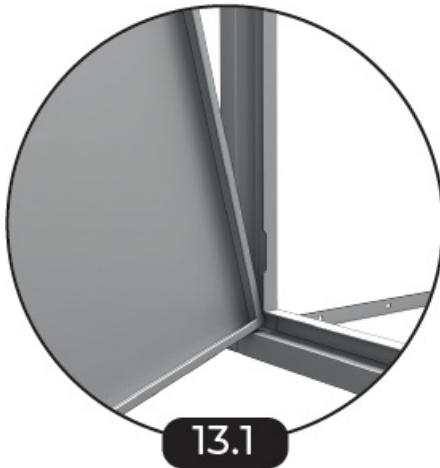
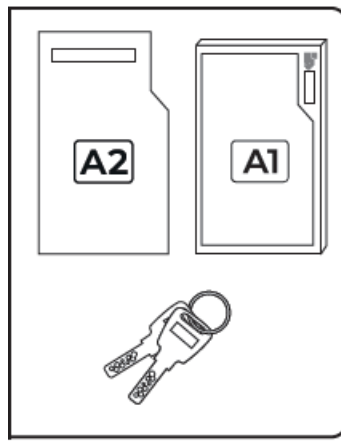

### Opening tests

Do not skip this step: it is essential for the proper functioning of your Boks

Go back to the app and let it guide you to test opening your Boks



### Assembling the left side panel

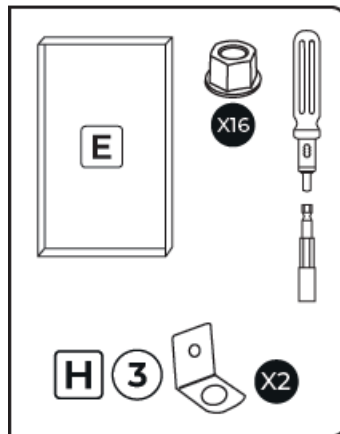

Place 2 brackets at the same level as the 2 upper studs

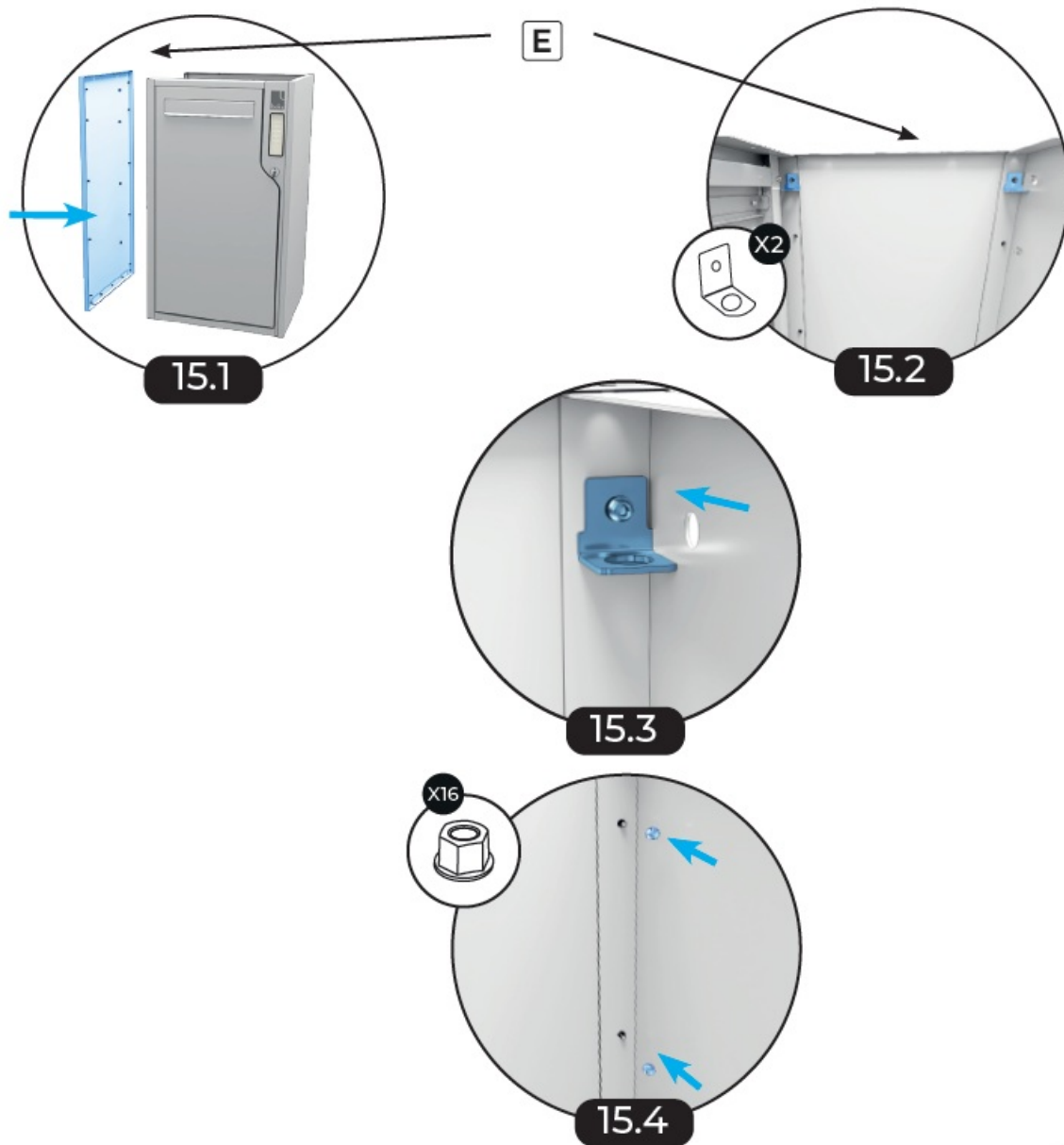

## Assembling the roof

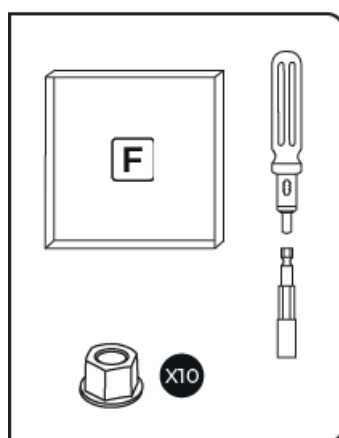

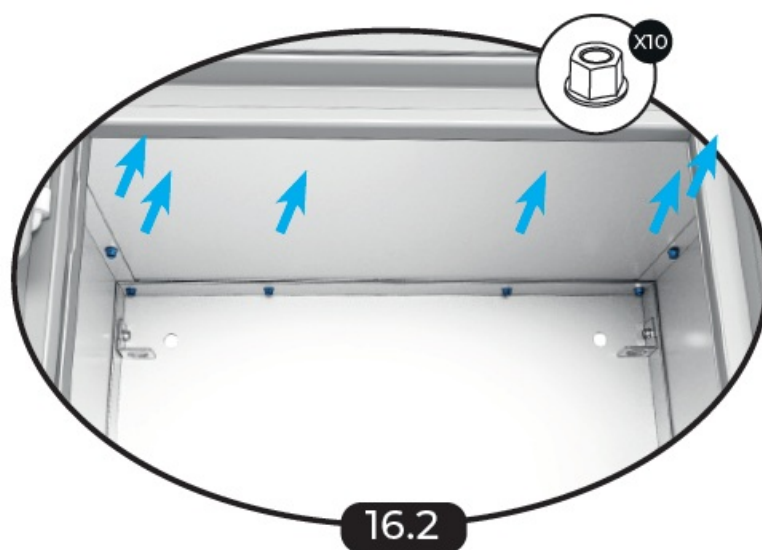
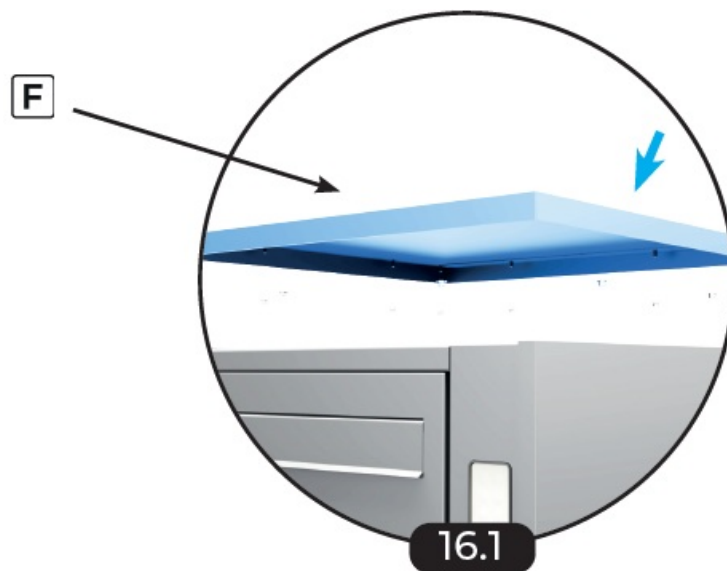

Installing the mail net

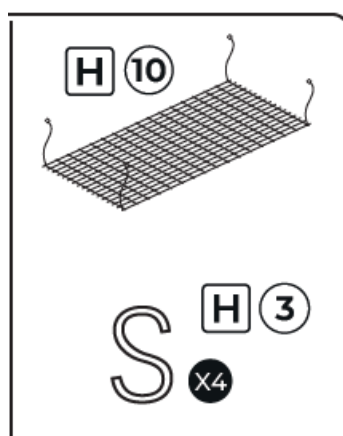



**Validating the assembly**



Do not skip this step: it is essential for the proper functioning of your Boks

**Fixing the Boks**



Select a fixing method: from the back (wall, door, gate, etc.) or the base (low wall, elevated surface, etc.)

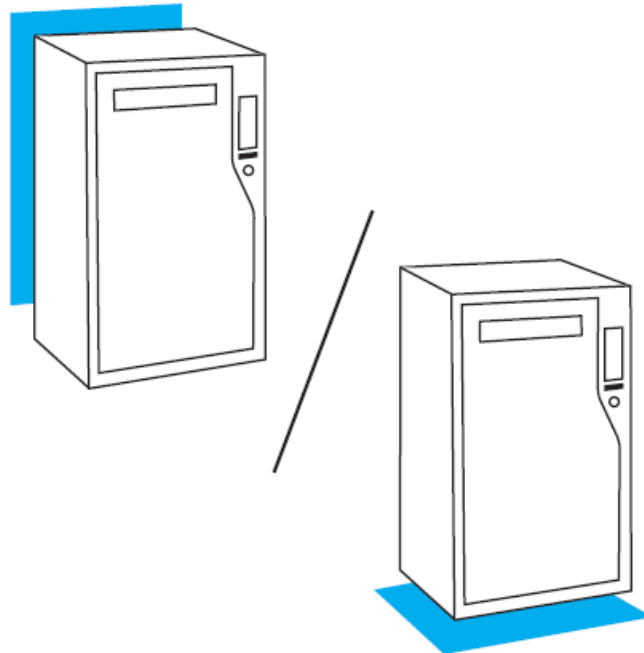

Mark the drilling points with a pencil, then drill and fix using your drill and the 4 universal anchors and screws provided (drilling diameter: 6 mm in hard material – 5 mm in friable material)

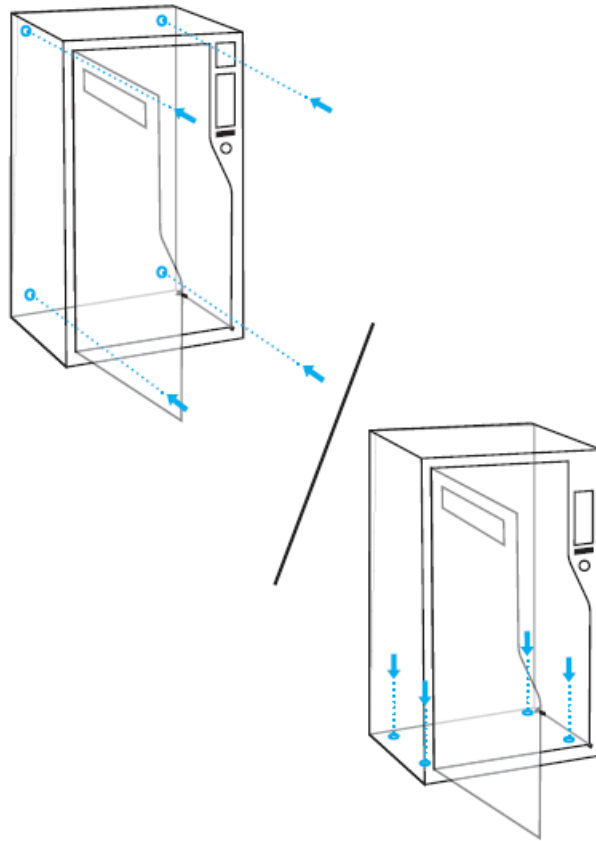

Add elevation feet for base fixing

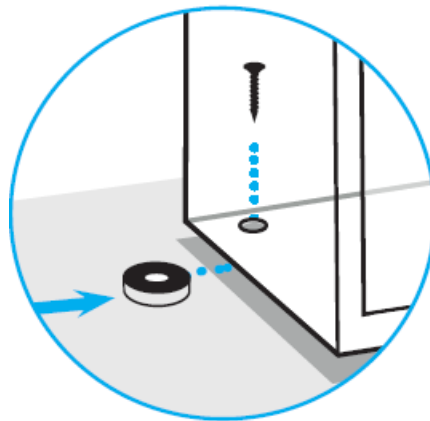

Insert the protection cap into the lock cylinder

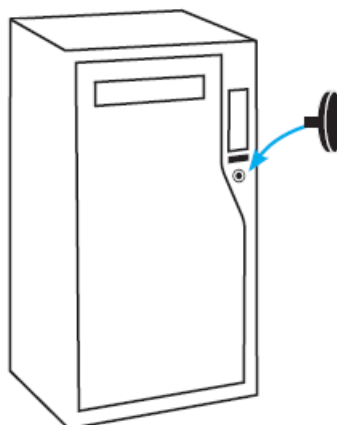

Be careful, your keys are unique, we do not have any copies. In case of loss, you will have to replace the cylinder (contact us for more information).

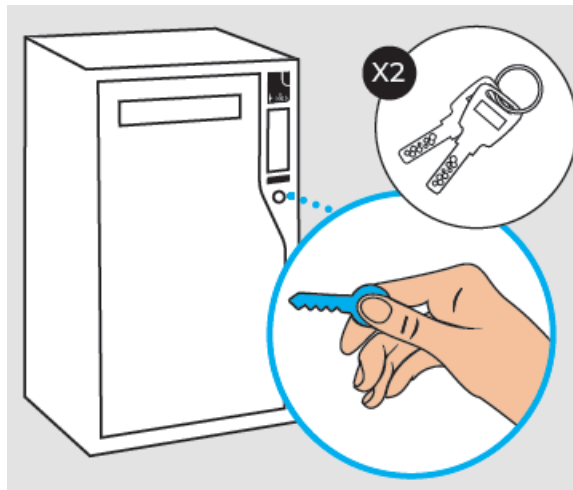

## Technical support

Are you having a problem with your Boks?

Please visit our Support section on the Boks website. Scan the QR-code or go to the address below.



[www.boks.link/assistance](https://www.boks.link/assistance)

## Technical features

<b>Dimensions</b>	H70 x W40 x D37 cm
<b>Capacity</b>	98 L
<b>Security</b>	Electromechanical safety lock (pull-out resistance: 3000N/300kg) Burglar-proof internal hinges
<b>Resistance</b>	Weather-resistant Anti-UV, anti-corrosion
<b>Connectivité</b>	Bluetooth 4.0 (no WiFi, 4G, or ethernet connection)
<b>Materials</b>	12/10 mm sheet steel (+ epoxy paint)
<b>Power supply</b>	AAA batteries (autonomy 2 years – no electrical connection)
<b>Mounting</b>	2 options: wall or floor (8 anchor points available)
<b>Accessories</b>	Fixing kit (4 universal anchors) 4 removable feet (for floor mounting)

## CE Declaration of Conformity

- The undersigned, Boks, declares that the radio equipment complies with Directive 2014/53/EU.
- The full text of the EU Declaration of Conformity is available at the following internet address:  
<https://boks.link/conformite>.

## Important information for the disposal of batteries and accumulators

- According to the European Directive 2006/66/EC on batteries and accumulators, every user had to return all used and exhausted batteries and accumulators. Disposal of household waste is prohibited.
- As the products in our range also contain batteries and accumulators, we would like to point out the following: used batteries and accumulators are not household waste and can be returned free of charge to the nearest collection point. in your municipality and wherever batteries and accumulators of the type concerned are sold. In addition, End users can also return batteries and accumulators to the retailer from whom they were purchased (legal take-back obligation).

**Created by Boks in France ©2022 All Rights Reserved.**

- Boks, 17 Rue Robert Borios 31000 Toulouse, France.
- IOS is a trademark or registered trademark of Cisco in the U.S. and other countries and is used under license. App Store is a service mark of Apple Inc., registered in the U.S. and other countries.
- Android, Google Play, and the Google Play logo are trademarks of Google LLC.
- Actual product appearance may differ from the image displayed/Image non contractuelle.

[www.boks.app](http://www.boks.app).

## Documents / Resources

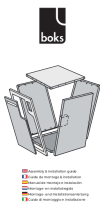
	<p><a href="#">boks Taille S Connected and Secure Parcel Box</a> [pdf] Installation Guide Taille S Connected and Secure Parcel Box, Taille S, Connected and Secure Parcel Box, Secure Parcel Box, Parcel Box</p>
---	--

## References

- [User Manual](#)

[Manuals+](#), [Privacy Policy](#)

This website is an independent publication and is neither affiliated with nor endorsed by any of the trademark owners. The "Bluetooth®" word mark and logos are registered trademarks owned by Bluetooth SIG, Inc. The "Wi-Fi®" word mark and logos are registered trademarks owned by the Wi-Fi Alliance. Any use of these marks on this website does not imply any affiliation with or endorsement.