



BN-LINK BND-60/U97A Short Period Repeat Cycle Timer User Manual

[Home](#) » [BN-LINK](#) » BN-LINK BND-60/U97A Short Period Repeat Cycle Timer User Manual 

Contents

- [1 BN-LINK BND-60/U97A Short Period Repeat Cycle Timer](#)
- [2 PRODUCTS VIEW](#)
- [3 RATING](#)
- [4 WARNING](#)
- [5 APPLICATIONS](#)
- [6 BRIEF INTRODUCTION](#)
- [7 HOW TO INSTALL](#)
- [8 OPTIONAL SETTINGS](#)
- [9 TROUBLESHOOTING](#)
- [10 BN-LINK INC](#)
- [11 Documents / Resources](#)
- [12 Related Posts](#)



BN-LINK BND-60/U97A Short Period Repeat Cycle Timer



PRODUCTS VIEW

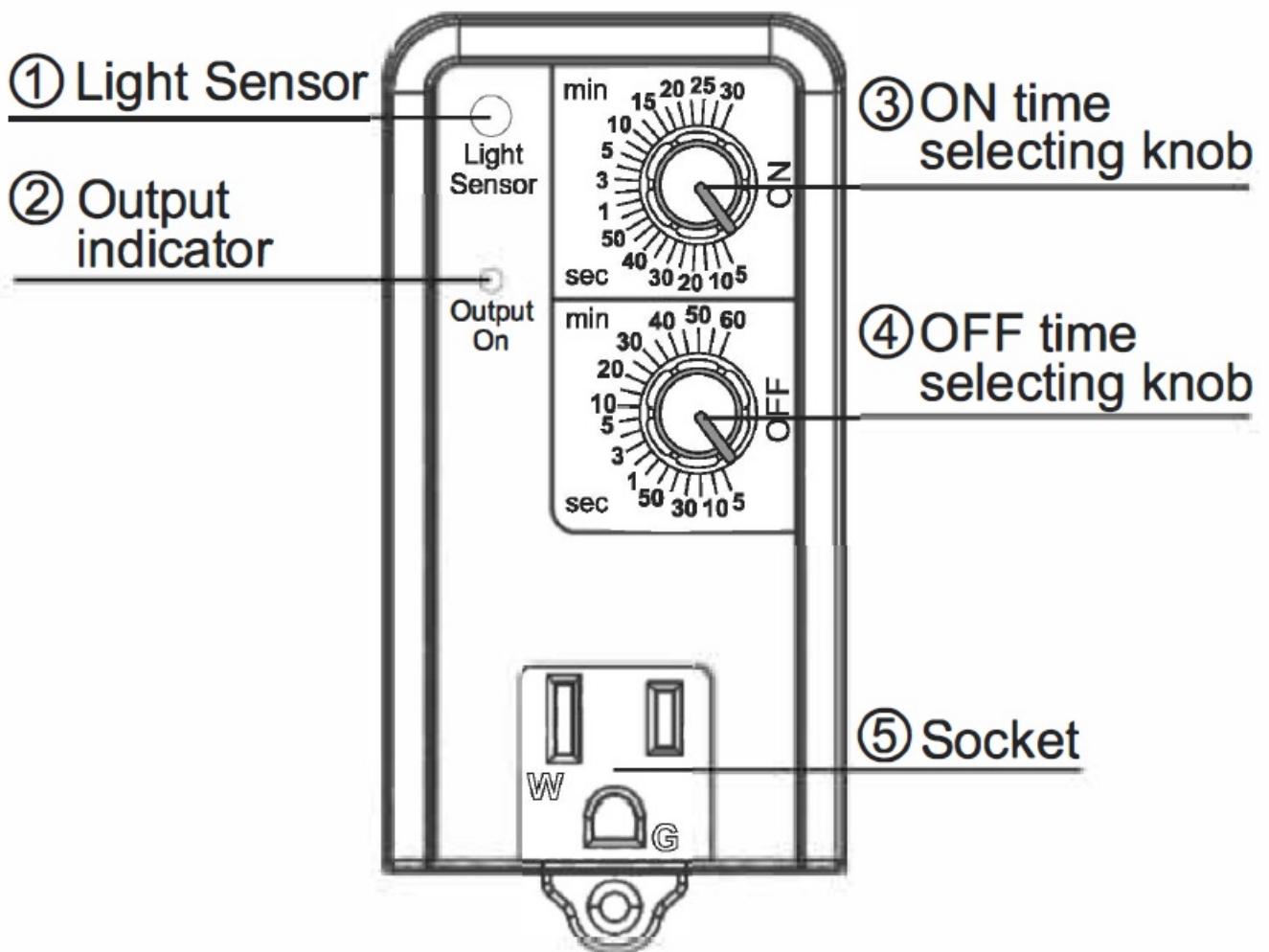

1. **Light Sensor:** Functions during the day or during the night.
2. **Output indicator:** Light illuminates when there is power output in the socket.
3. **ON time selecting knob:** To set the “ON” duration for the equipment.
4. **OFF time selecting knob:** To set the “OFF” duration for the equipment.
5. **Socket:** Only intended to be used with a grounded device.

RATING

- **Supply voltage:** 125V-60Hz
- **Max. loading:** 15A/1875W Resistive
- 15A/1875W Tungsten, 15A/1875W Ballast, 1 HP, TV-5
- **Operating temperature:** 5F-122F(-15°C-50°C)
- **Storage temperature:** -4F-140°F(-20°C-60°C) Protection class: IP20

WARNING

- Electrical shock hazard
- Use a grounded outlet
- Follow local electrical codes
- For indoor use only
- Keep children away
- Unplug the timer before cleaning
- Fully insert plug
- Do not use it in wet locations
- Do not exceed the electrical rating

APPLICATIONS

- Co2 systems
- Heating systems
- Humidifiers
- Cooling systems
- Indoor sprinklers
- Aquariums
- Ventilators
- Nebulizers
- Hydroponic pumps

DANGER

To reduce the risk of electric shock, this product has a grounding-type plug that has a third (grounding) pin. This plug will only fit into a grounding-type power outlet. If the plug does not fit into the outlet, contact a qualified electrician to install the proper outlet. Do not change the plug in any way.

BRIEF INTRODUCTION

MAIN FEATURES

- With Day/Night Sensor
- ON—5 seconds to 30 minutes
- OFF—5 seconds to 60 minutes
- Functions during the day, during the night, or 24 daily

HOW TO INSTALL

Set ON/OFF Duration ON

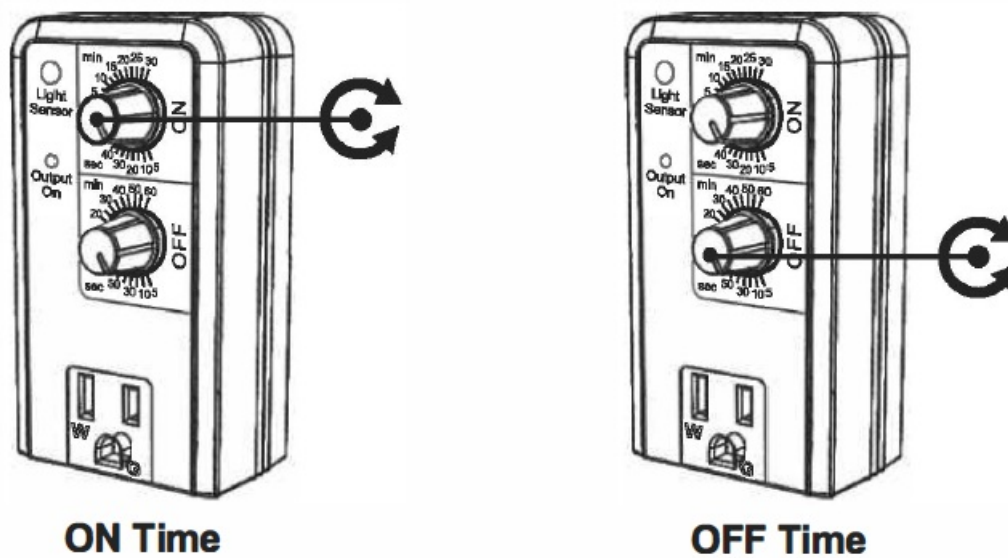

- ON Time: Duration for which equipment will run.
- OFF Time: Duration in between ON times.

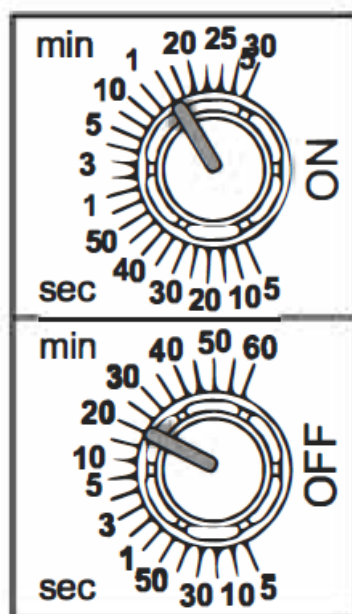

For example

If a device is required to run for 15 minutes and stop for 20 minutes, turn the ON time dial till the white line aligns the 15-minute mark and turn the OFF time dial till the white line aligns the 20-minute mark.

Plug into 125VAC outlet

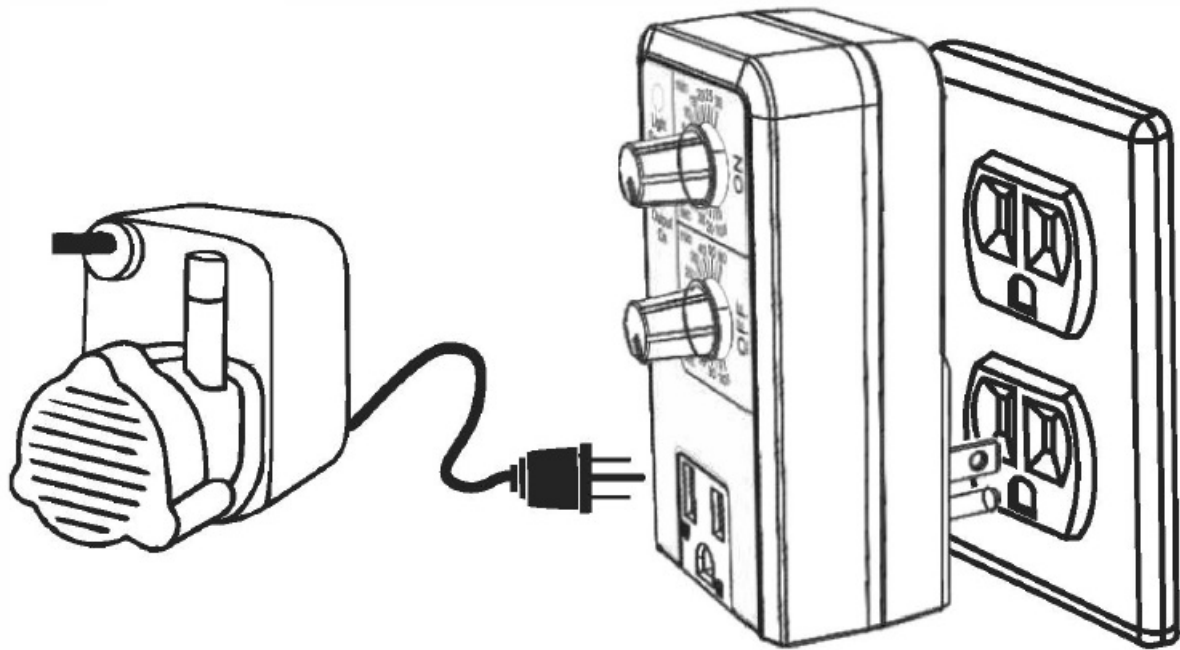

For example

Use with irrigation pump (or other loads)

OPTIONAL SETTINGS

Change To 24-hour Control

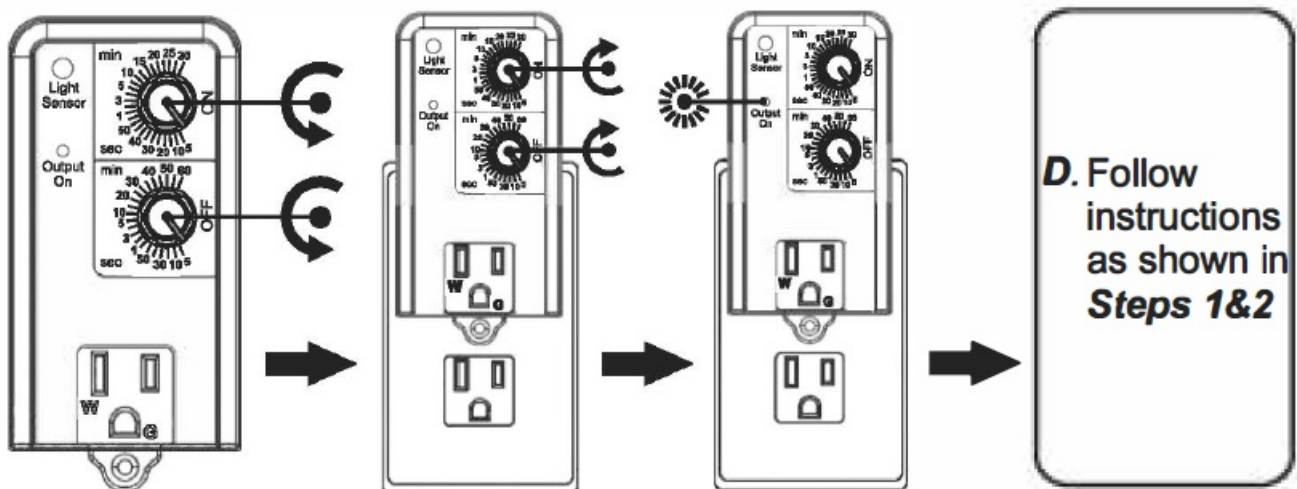

- Set both values to minimum
- Plug in then set both values to maximum within 5 seconds
- Output light turns on or off according to the actual setting

Change To Day Control

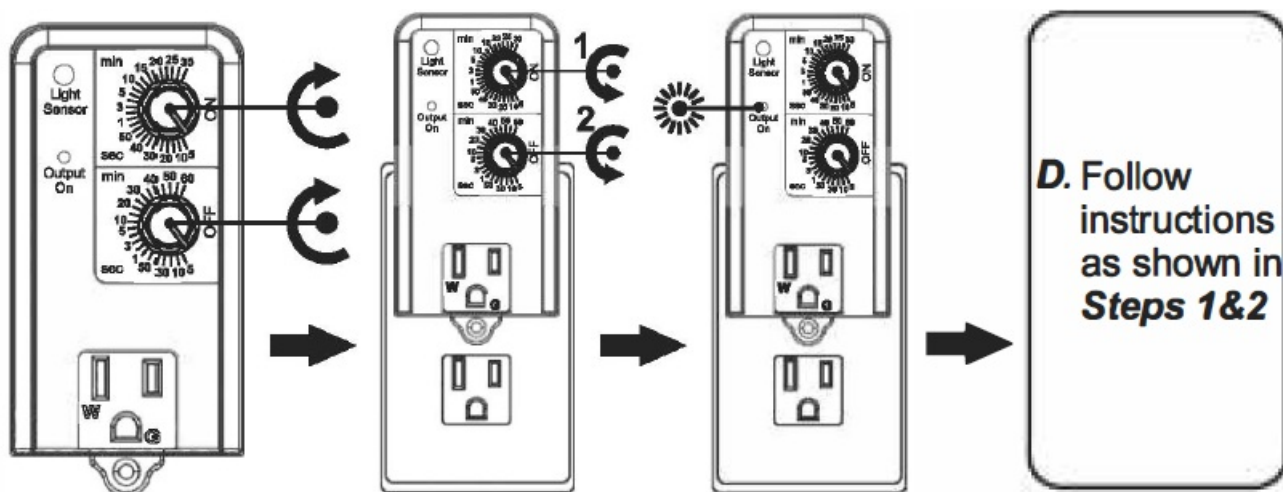

- Set both values to maximum
- Plug in, then the set-top value to minimum followed by button value to a minimum within 5 seconds
- Output light turns on or off according to the actual setting

Change To Night Control

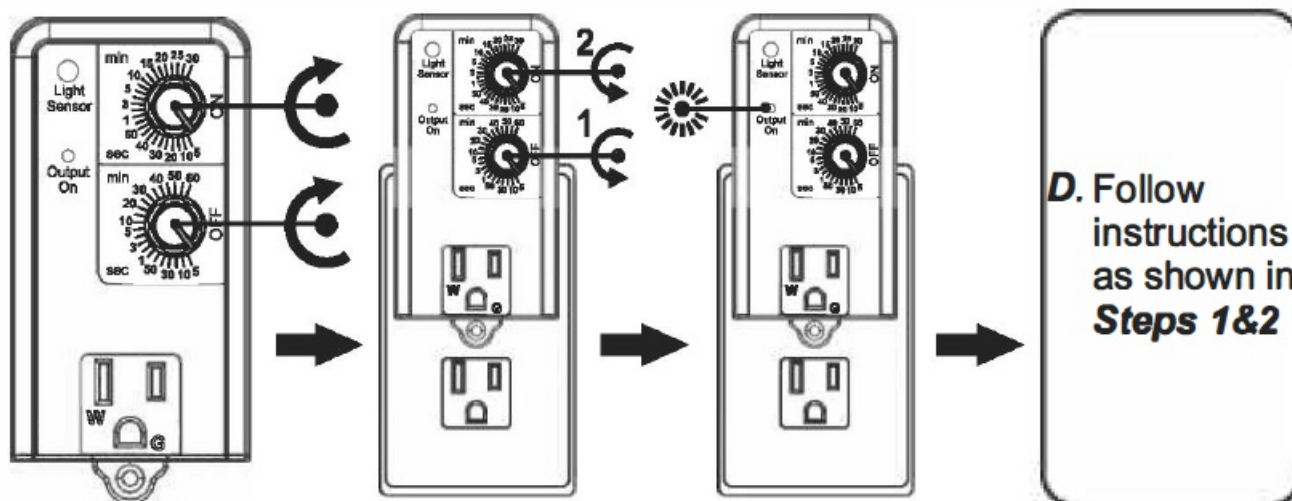

- Set both values to maximum
- Plug in, then set bottom value to minimum followed by the top value to a minimum within 5 seconds
- Output light turns on or off according to the actual setting

TROUBLESHOOTING

PROBLEM:

The timer does not work during the day.

POSSIBLE CAUSES AND SOLUTIONS

1. The timer is set to Night Control mode. Please switch to Night Control mode.
2. Please remove dust or other obstacles from the light sensor located in the upper left corner.
3. The on a timer is too short and the off-time is too long. Please check the dials.
4. **PROBLEM:** timer does not work.

POSSIBLE CAUSES AND SOLUTIONS:

Check the power supply to the timer.

PROBLEM: limer does not work at night.

POSSIBLE CAUSES AND SOLUTION

1. limer is set to Day Control mode. Please make sure the timer is in Night Control mode.
2. Please make sure the front of the timer is not exposed to light.
3. The on time is too short and the off-time is too long. Please check the dials.

PROBLEM: limer works day and night in Day Control mode.

POSSIBLE CAUSES AND SOLUTION

1. limer is set to 24-hour Control mode. Please make sure the timer is in Night Control mode.
2. Please make sure the timer is located with sufficient light in the day.
3. Please remove dust or other obstacles from the light sensor located in the upper left corner

PROBLEM:

The ON time is too long or too short.

POSSIBLE CAUSES AND SOLUTIONS

Please turn the dial next to the previous scale

PROBLEM: The timer does not work properly: it turns on and then turns off in a short moment.

POSSIBLE CAUSES AND SOLUTIONS

1. Please make sure the front of the timer is not exposed to light.
2. Please make sure the light controlled by the timer will not light up the front of the timer

BN-LINK INC

- 12991 Leffingwell Avenue, Santa Fe Springs
- **Customer Service Assistance:** 1.909.592.1881
- **E-mail:** support@bn-link.com
- [Http://www.bn-link.com](http://www.bn-link.com)
- Hours: 9 AM – 5 PM PST, Mon – Fri
- Designed in California and Made in China

Documents / Resources

 <p>BN-LINK PRODUCT BND-60/U97A</p> <p>SHORT PERIOD REPEAT CYCLE TIMER</p> <p>UL LISTED E114000</p> <p>Product Name: BND-60/U97A Model: BND-60/U97A Manufacturer: BN-LINK Country of Origin: China</p>	<p>BN-LINK BND-60/U97A Short Period Repeat Cycle Timer [pdf] User Manual</p> <p>BND-60 U97A Short Period Repeat Cycle Timer, BND-60, U97A, Short Period Repeat Cycle Timer, BND-60 Short Period Repeat Cycle Timer, U97A Short Period Repeat Cycle Timer</p>
---	--