

## BME express Regal 2 OH 2 File Shelf Instruction Manual

[Home](#) » [BME express](#) » BME express Regal 2 OH 2 File Shelf Instruction Manual 



### Contents

- [1 BME express Regal 2 OH 2 File Shelf Instruction Manual](#)
- [2 General information](#)
- [3 Assembly information](#)
- [4 Assembling instruction](#)
- [5 Care](#)
- [6 Assembly information](#)
- [7 Assembling instruction](#)
- [8 Documents / Resources](#)
- [9 Related Posts](#)

**BME express Regal 2 OH 2 File Shelf Instruction Manual**

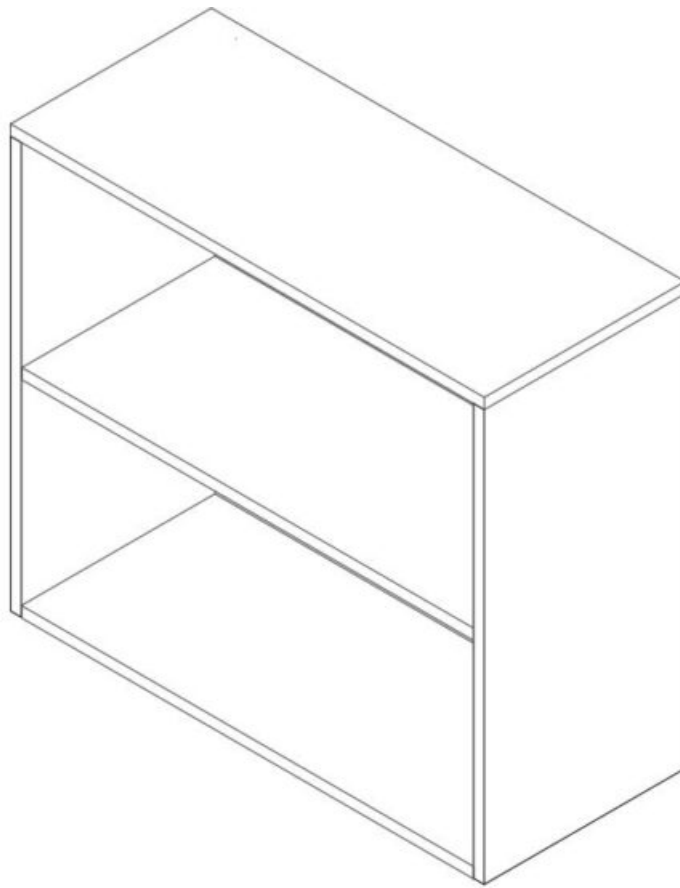

**Regal 2 OH 2**

**Important:**

Read carefully before assembling/keep and store Instruction for reference

**Warning notice**

Intended use:

Please make sure that you only use your furniture for the purpose it was designed for. Correct use and regular maintenance are essential for ensuring your furniture remains in working order for the long-term.

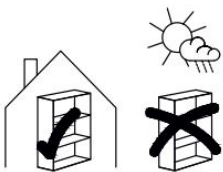

**Area of use:**

The storage furniture you have purchased is suitable for use in general private living quarters. It is not suitable for areas that are wet, outside or used for commercial purposes.

**WARNING**

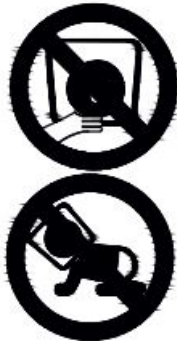
**Risk of swallowing and choking:**

Small parts and packaging material may be swallowed.

WARNING! Bags and film coverings are not toys! Please keep away from babies and small children! Do not put them over your head, risk of suffocation!

**PRECAUTION,****risk of injury:**

Small children must keep away from the assembly area. They must refrain from climbing up on the furniture.

**General information****ATTENTION**

Direct sunlight: results in discoloration.

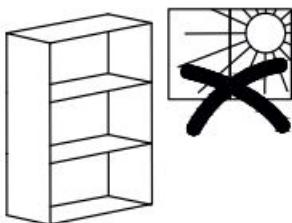
**Protective covers:**

Protective covers, e.g. felt pads, prevent damage to floors that are easily scratched (e.g. parquet).

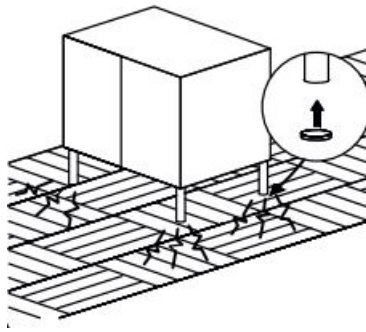

**ATTENTION,  
Temperature:**

Do not place hot or cold objects directly on the surface. Use the appropriate protection, e.g. saucer.

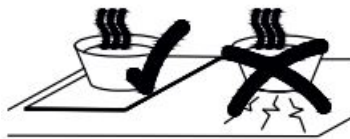

**PRECAUTION,**

this piece of furniture can tip over.

To prevent this it must be secured to the wall or ceiling with brackets. The type of bracket depends on the quality of the wall and/or ceiling (e.g. concrete, plaster, brick, wood) and must be mounted by a specialist.

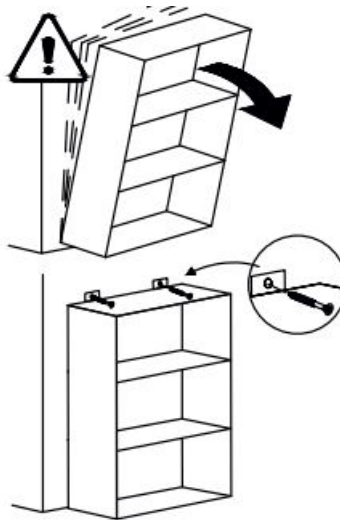

**Max. load:  
15 kg**

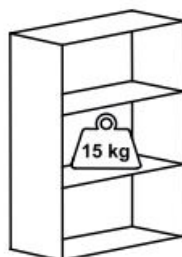

**Assembly information**

**Damages during assembly:**

These can be avoided if you use a clean soft surface (e.g. carpet). Only place parts on a soft surface when unpacking or during the assembly. Make sure that larger parts can- not tip over.

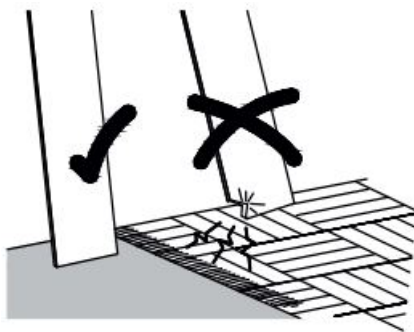
**People:**

Number of people required for the assembly.

**Assembly time:**

Approximate time in hours.

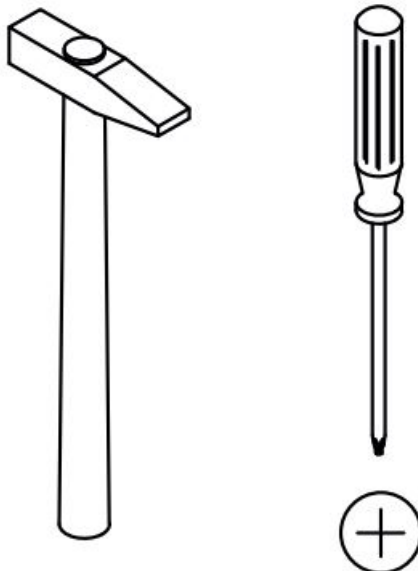
**Tools required:**

## Components/ small parts:

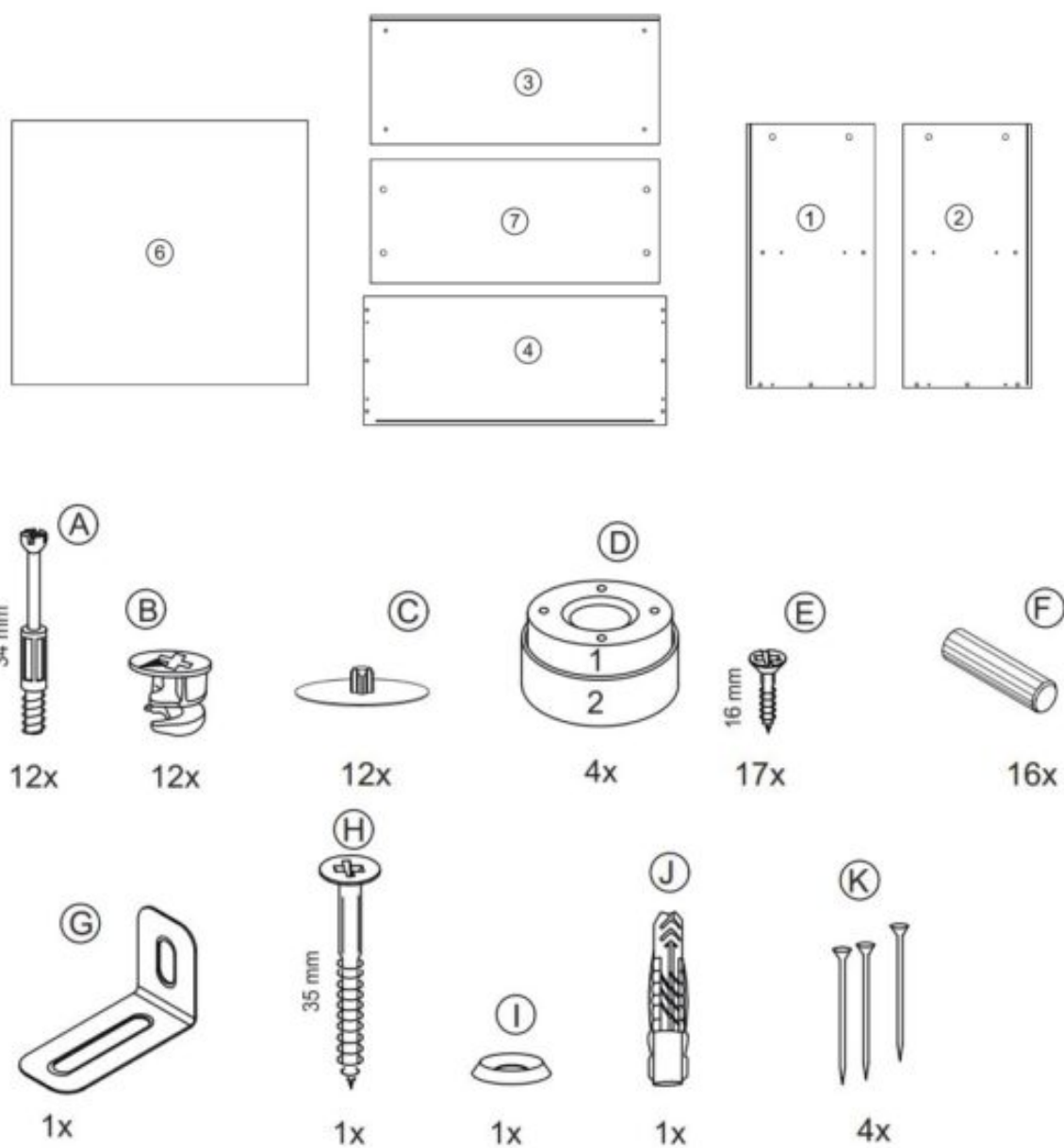

## Assembling instruction

1

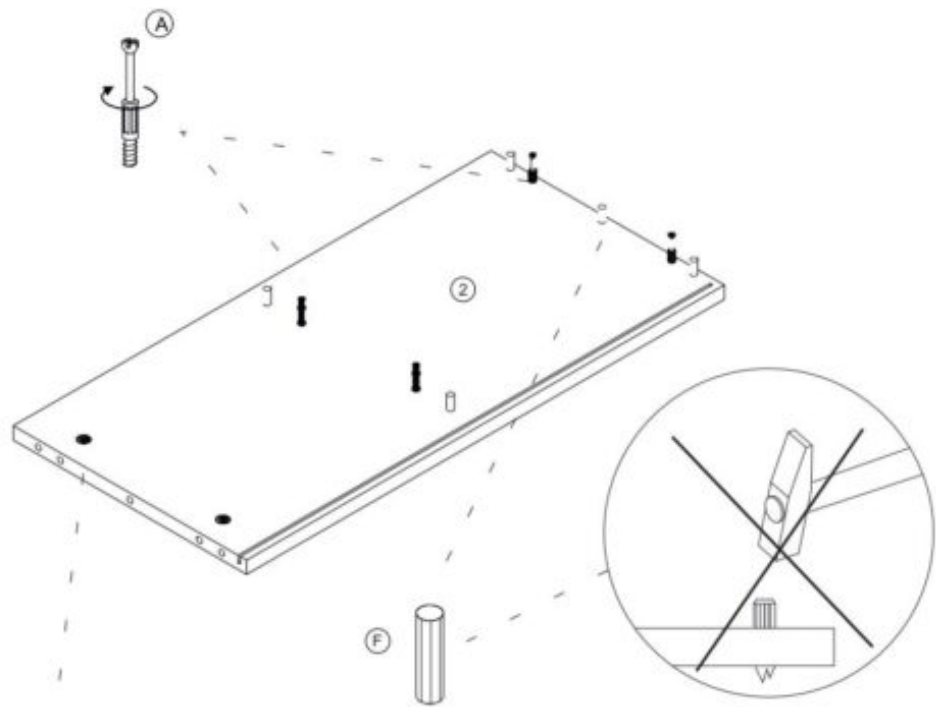

B

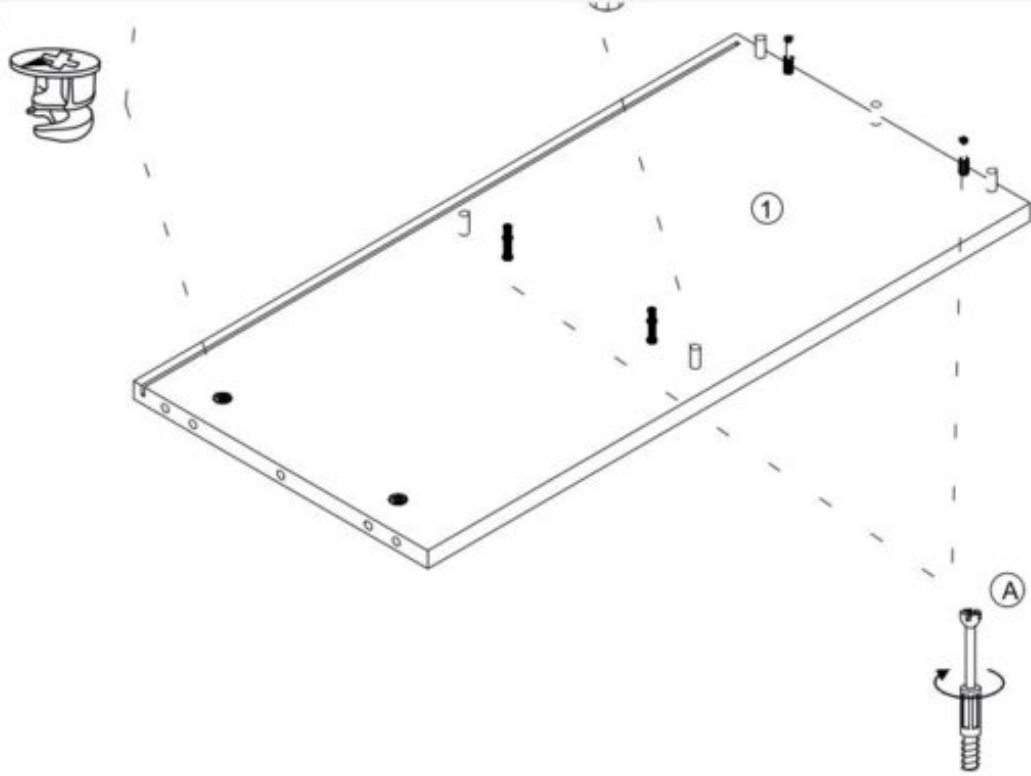

2

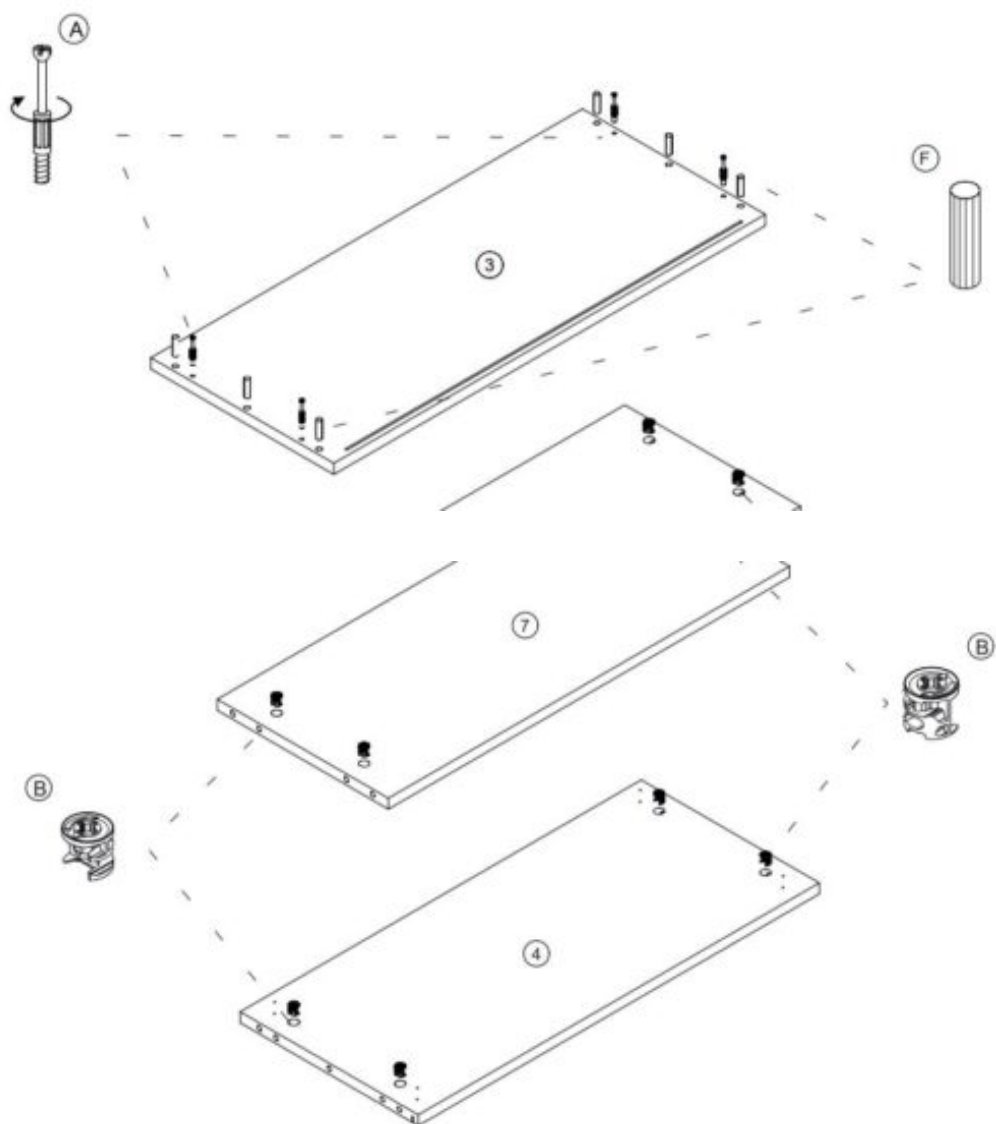

3

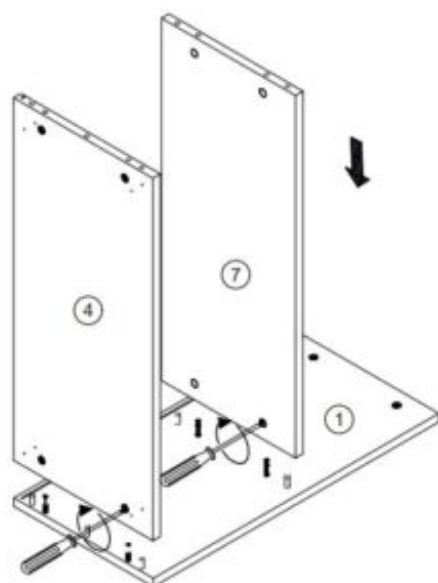

4

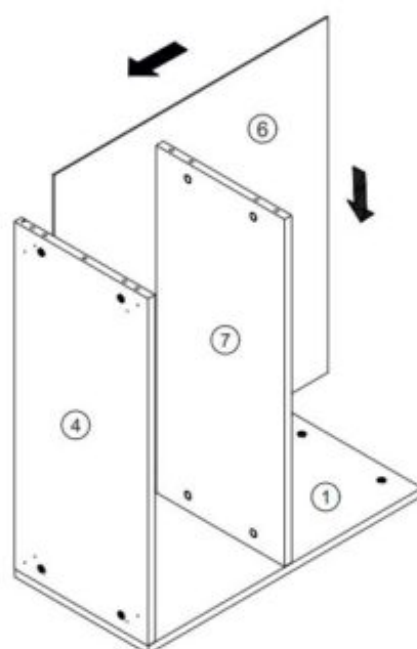



5

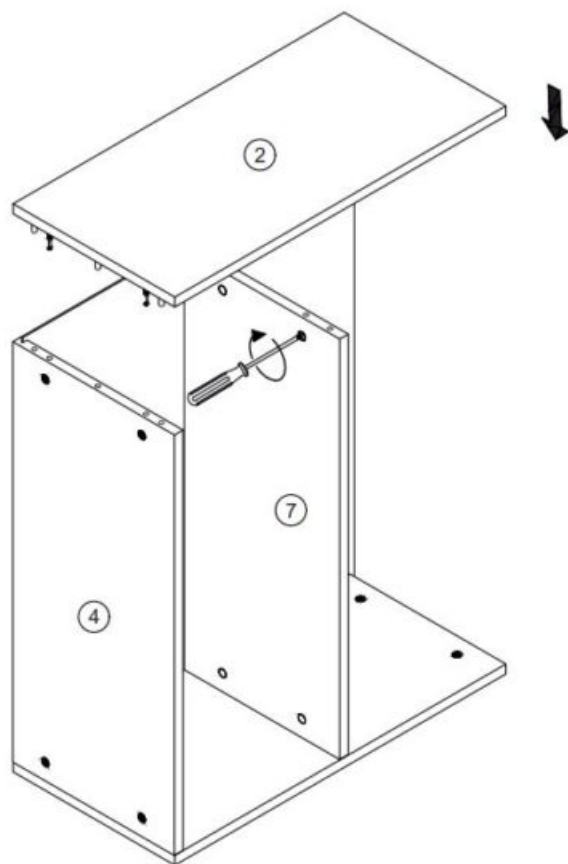

6

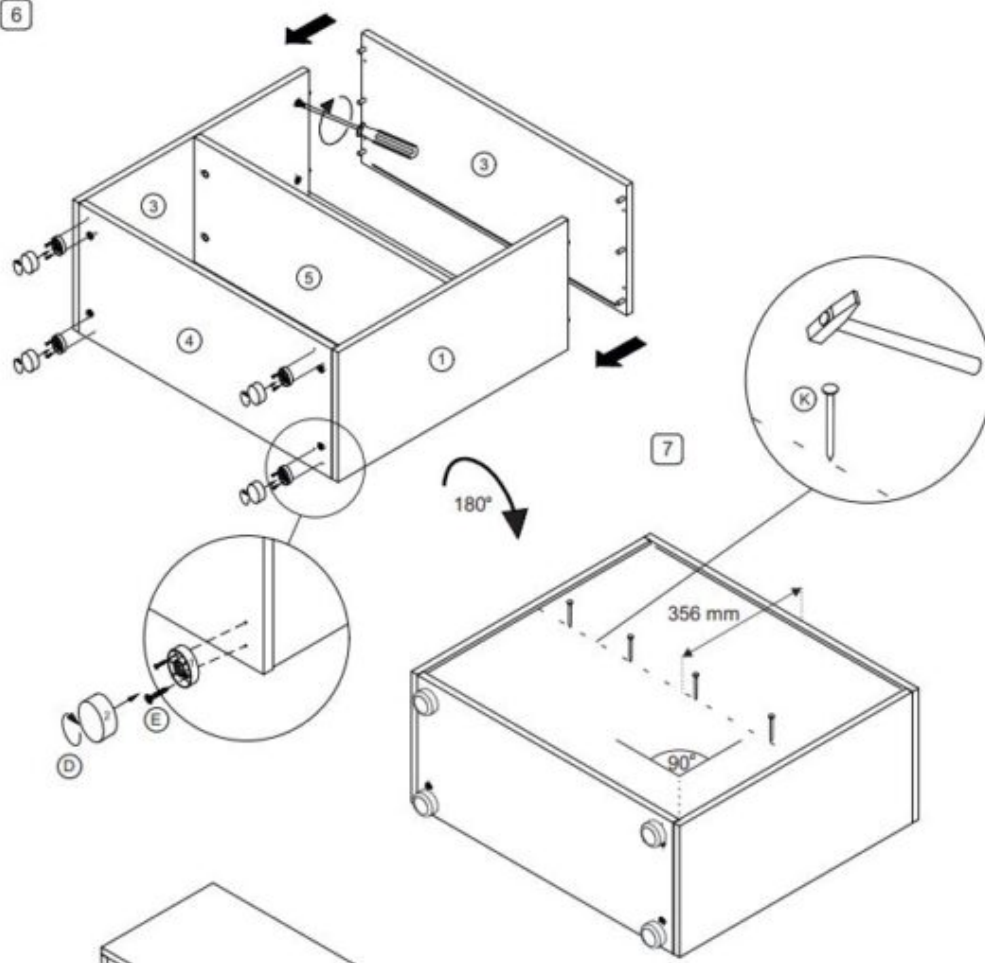

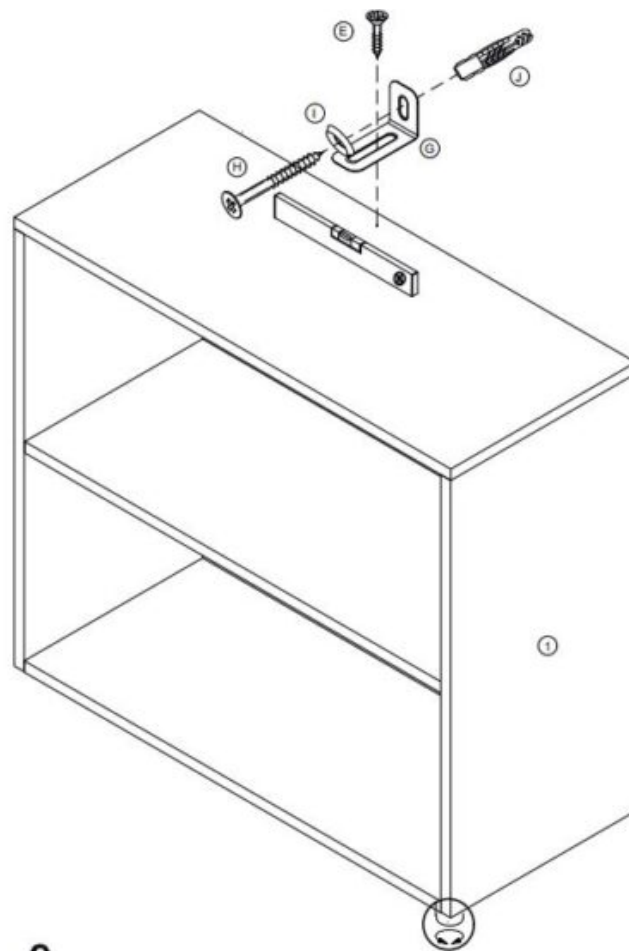
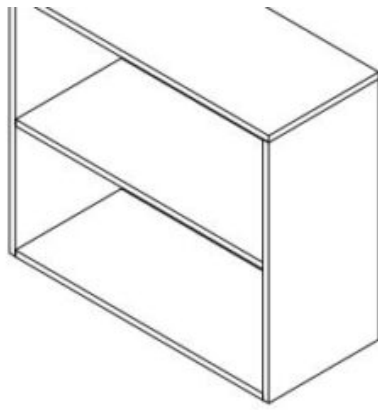

 **Wall-fixinf recommended**

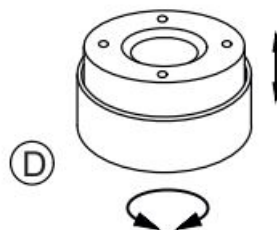

## Care



### General cleaning instructions:

Always remove stains immediately. Use a clean, white cloth.



Use clean water. If the stain does not come out, use soapy water. If you use cleaning detergents, always test them first in a concealed spot.



**CAUTION** Do not use any chemical or abrasive cleaning detergents or cloths/tools.

### Important:

Read carefully before assembling/keep and store Instruction for reference

## Regal 3 OH

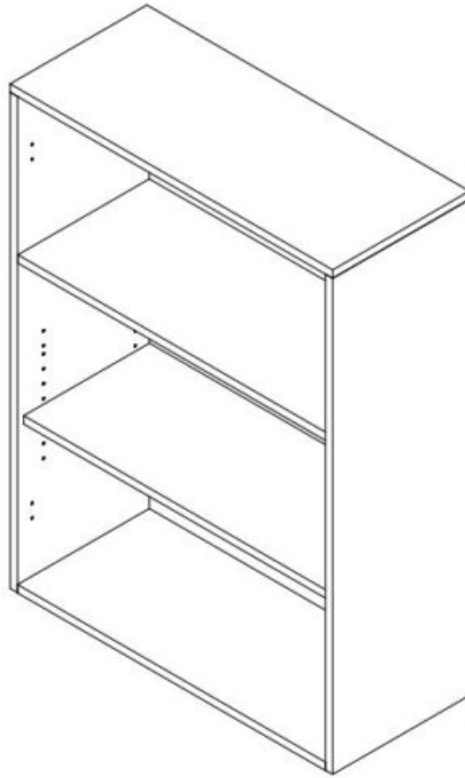

### Warning notice

Intended use:

Please make sure that you only use your furniture for the purpose it was designed for. Correct use and regular maintenance are essential for ensuring your furniture remains in working order for the long-term.

### Area Of use:

The storage furniture you have purchased is suitable for use in general private living quarters. It is not suitable for areas that are wet, outside or used for commercial purposes.

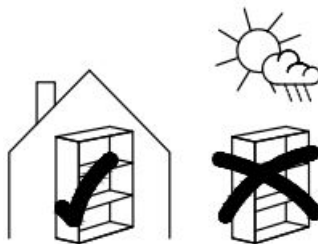

### WARNING

Risk of swallowing and choking:

Small parts and pack-aging material may be swallowed.



**WARNING!** Bags and film coverings are not toys! Please keep away from babies and small children! Do not put them over your head, risk of suffocation!

**PRECAUTION,** risk of injury: Small children must keep away from the assembly area. They must refrain from climbing up on the furniture.



### **ATTENTION**

Direct sunlight: results in discoloration.

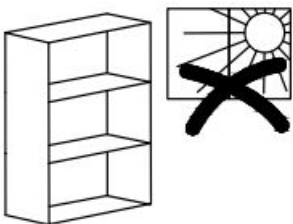

### **Protective covers:**

Protective covers, e.g. felt pads, prevent damage to floors that are easily scratched (e.g. parquet).

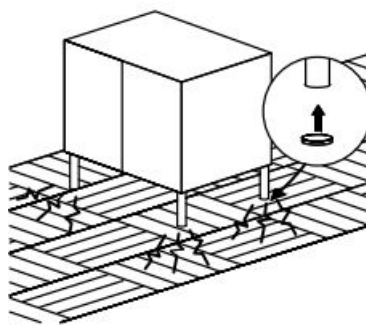

**ATTENTION,  
temperature:**

Do not place hot or cold objects directly on the surface. Use the appropriate protection, e.g. saucer.

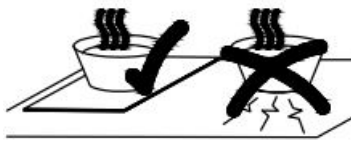

**PRECAUTION,**

this piece of furniture can tip over.

To prevent this it must be secured to the wall or ceiling with brackets. The type of bracket depends on the quality of the wall and/or ceiling (e.g. concrete, plaster, brick, wood) and must be mounted by a specialist.

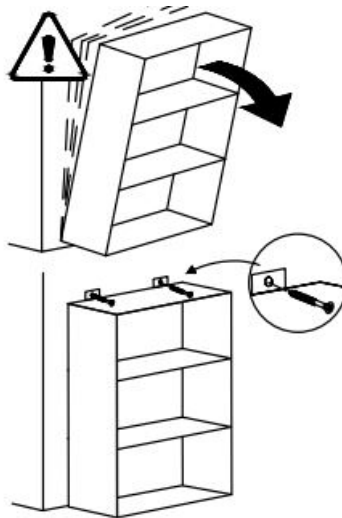

**Max. load:**

15 kg

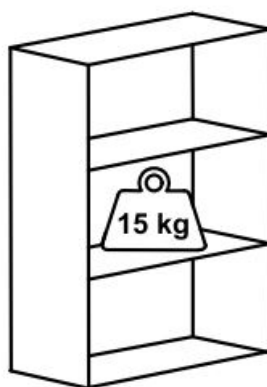

**Damages during assembly:**

These can be avoided if you use a clean soft surface (e.g. carpet).

Only place parts on a soft surface when unpacking or during the assembly. Make sure that larger parts can not tip over.

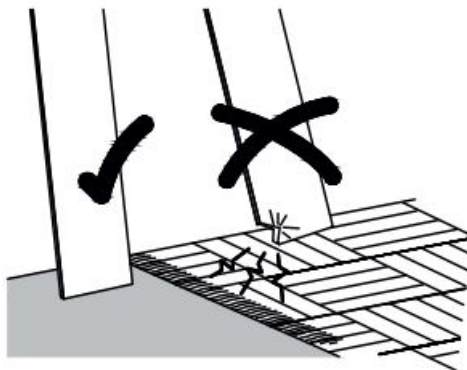
**People:**

Number of people required for the assembly.

**Assembly time:**

Approximate time in hours.

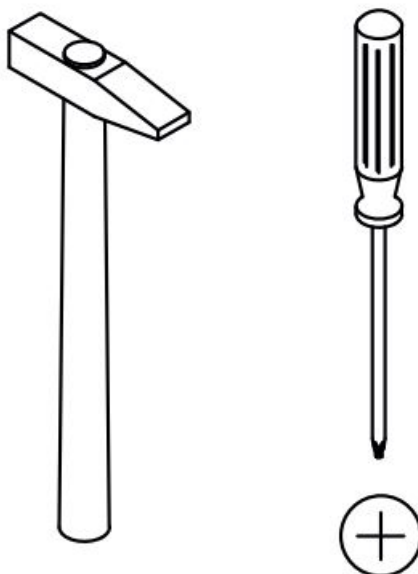
**Tools required:****Assembly information**

Components/ small parts:

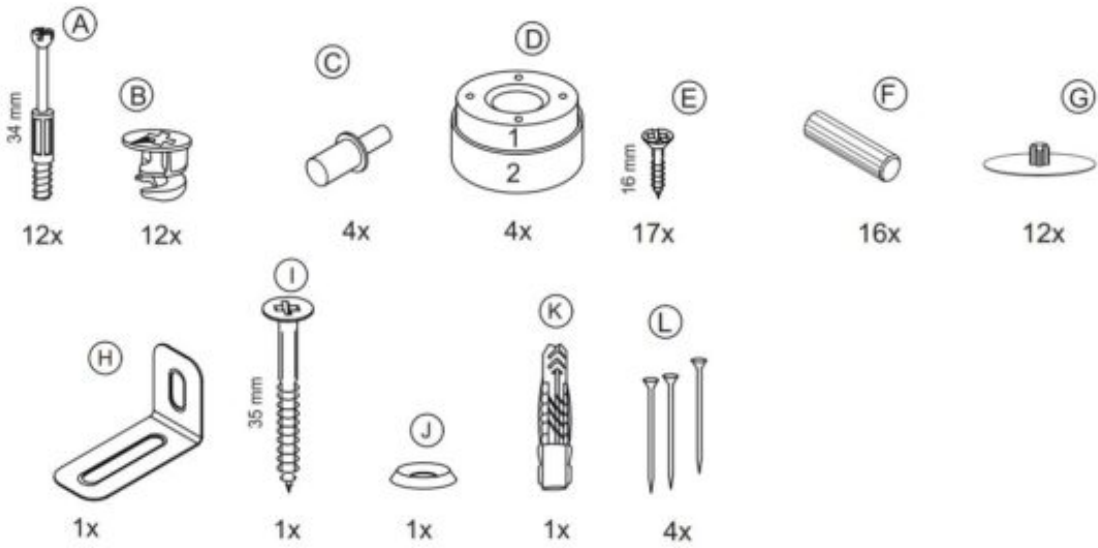
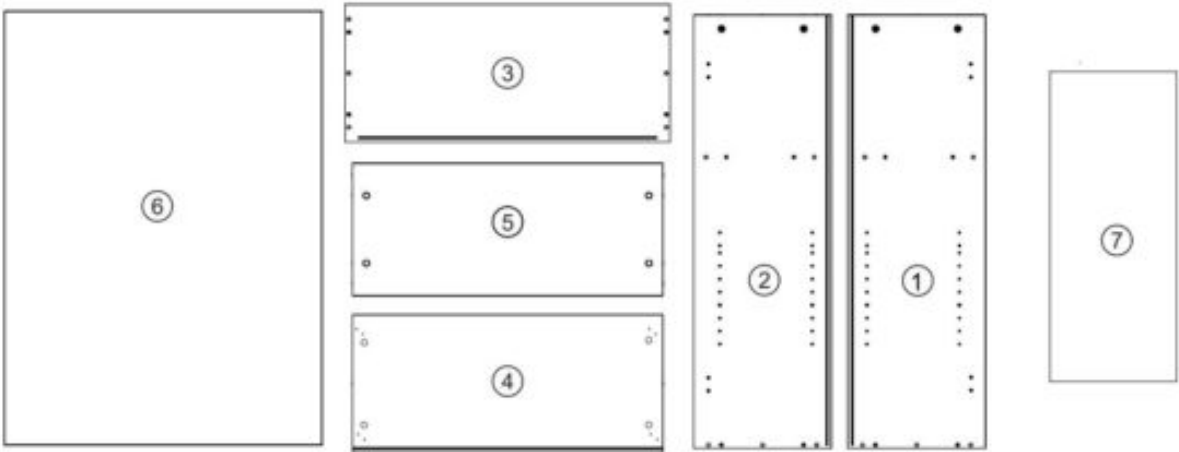

Assembling instruction



1

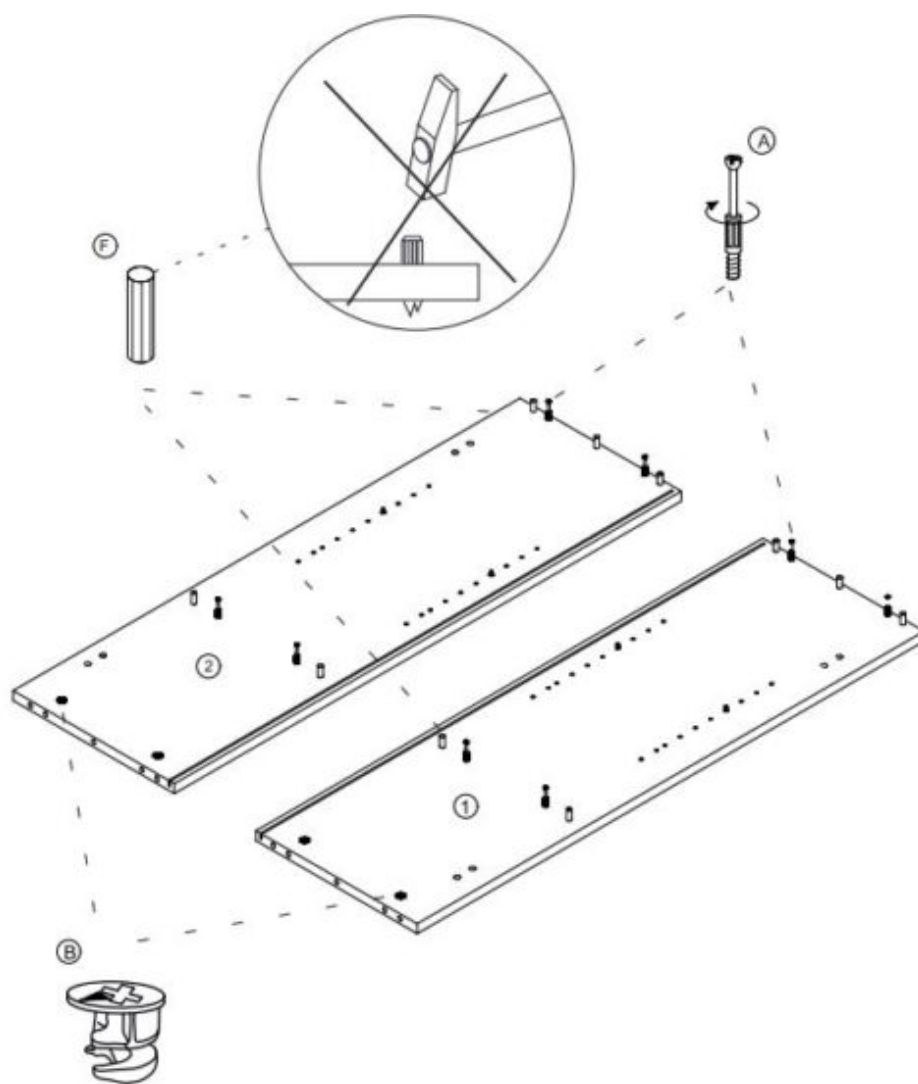

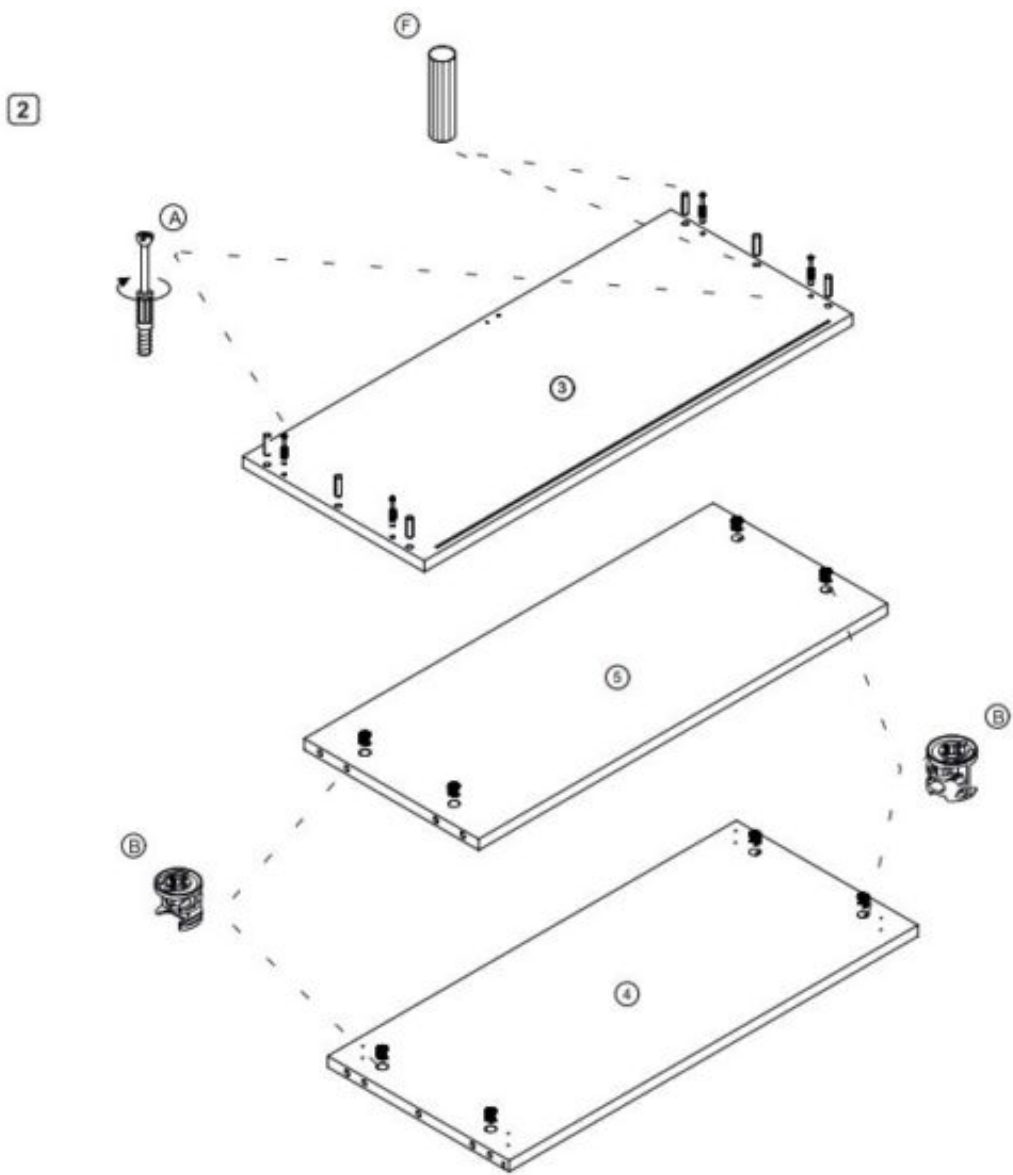

**3**

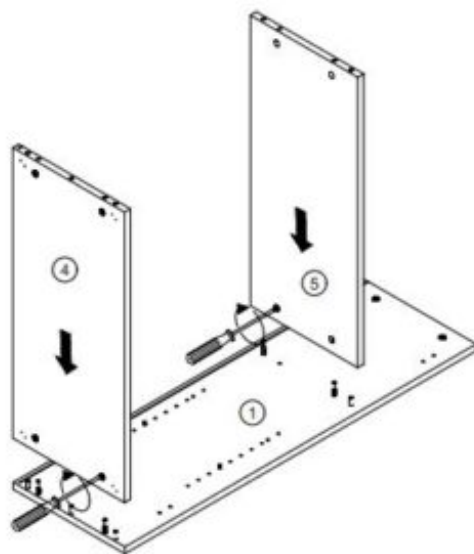

**4**

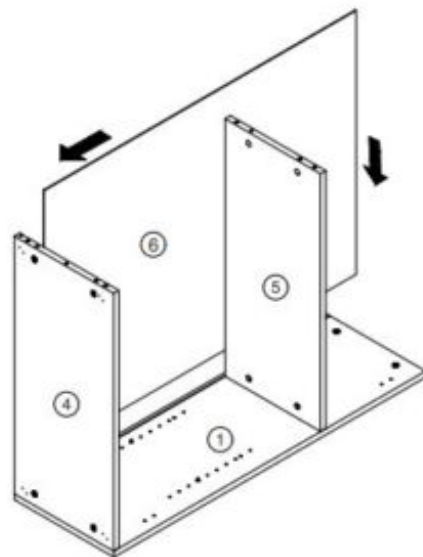

5

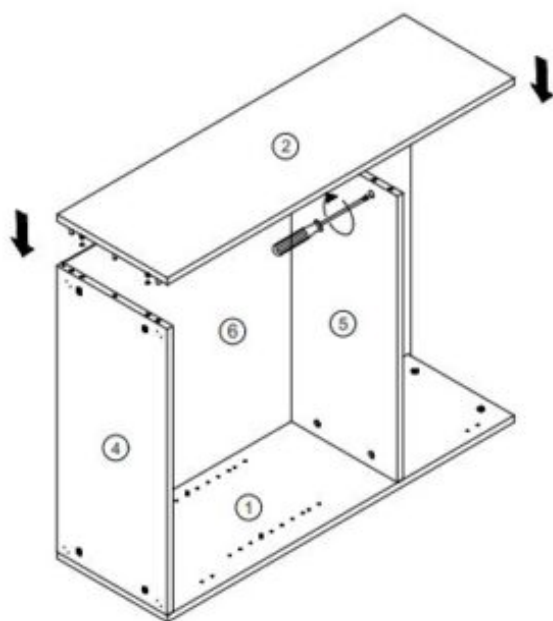

6

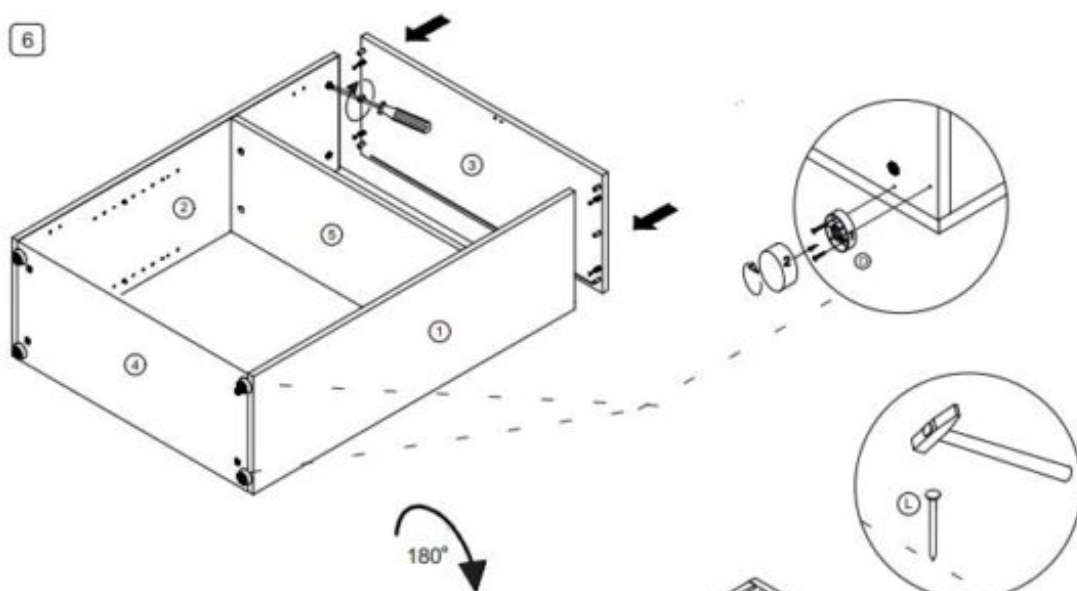

7

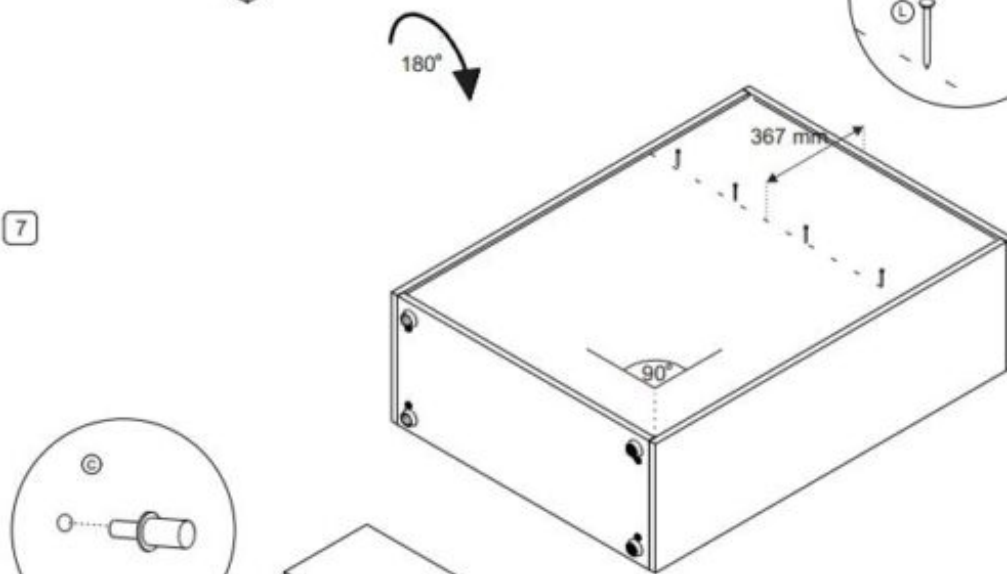

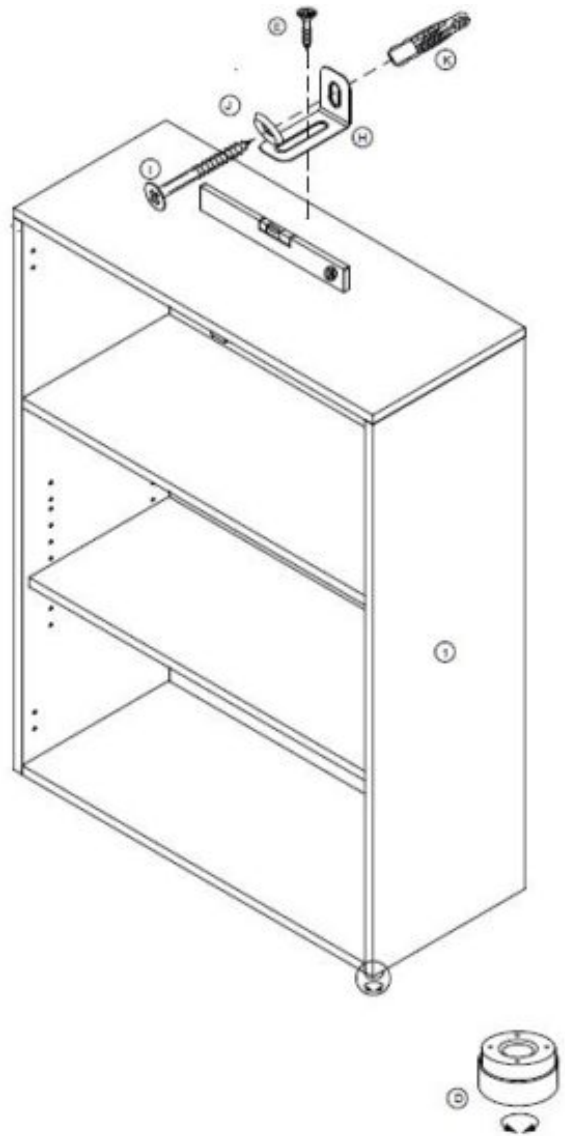
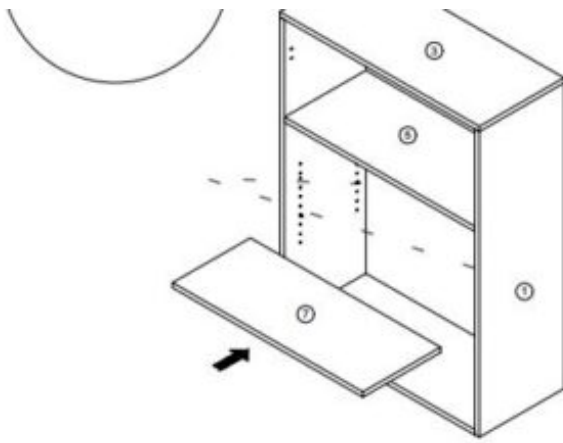

 **Wall-fixing recommended**

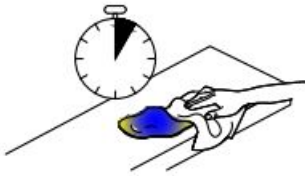

### General cleaning instructions:

Always remove stains immediately. Use a clean, white cloth.



Use clean water. If the stain does not come out, use soapy water. If you use cleaning detergents, always test them first in a concealed spot.



**CAUTION** Do not use any chemical or abrasive cleaning detergents or cloths/tools.

**Read More About This Manual & Download PDF:**

## Documents / Resources

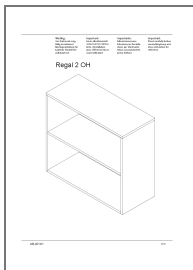

[BME express Regal 2 OH 2 File Shelf](#) [pdf] Instruction Manual  
Regal 2 OH 2 File Shelf, Regal 2 OH, 2 File Shelf, Shelf