



## P42 Blusafe Smart App User Guide

[Home](#) » [Blusafe](#) » P42 Blusafe Smart App User Guide 



### Contents

- [1 CREATING A ONE TIME PASSCODE OFFLINE](#)
- [2 UNLOCKING YOUR SMART LOCK](#)
- [3 OTHER FUNCTIONS](#)
- [4 Documents / Resources](#)
- [5 Related Posts](#)

### CREATING A ONE TIME PASSCODE OFFLINE

1. Select "One Time Code" under "Offline Code".

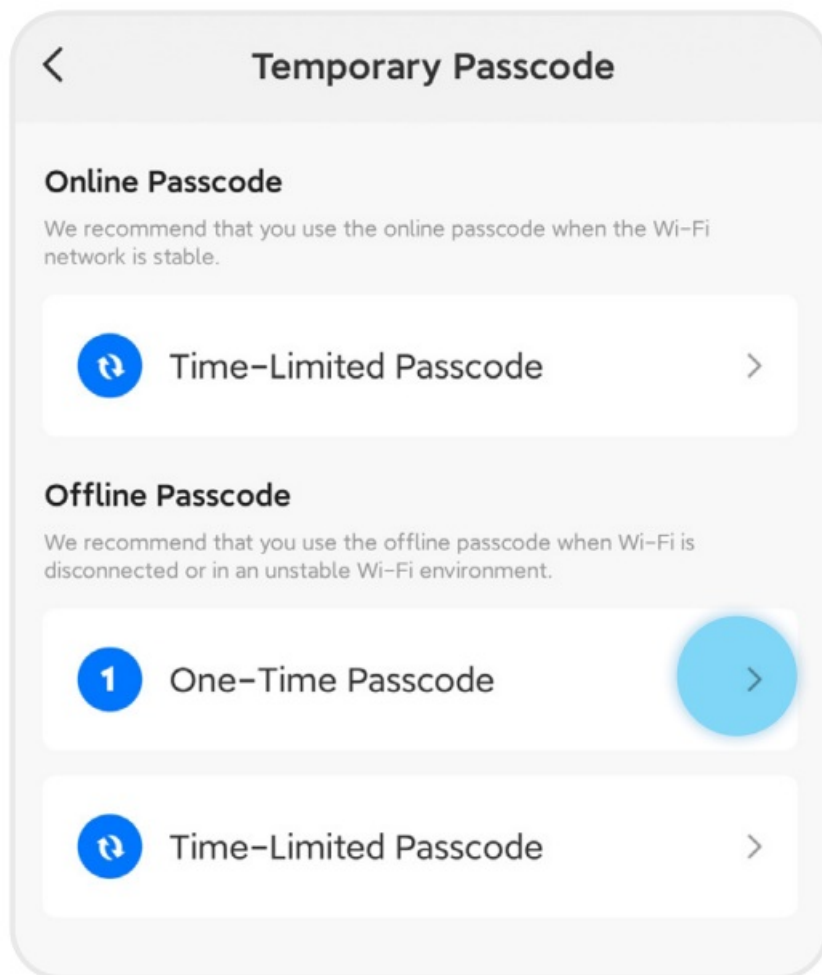

2. Click "Add".

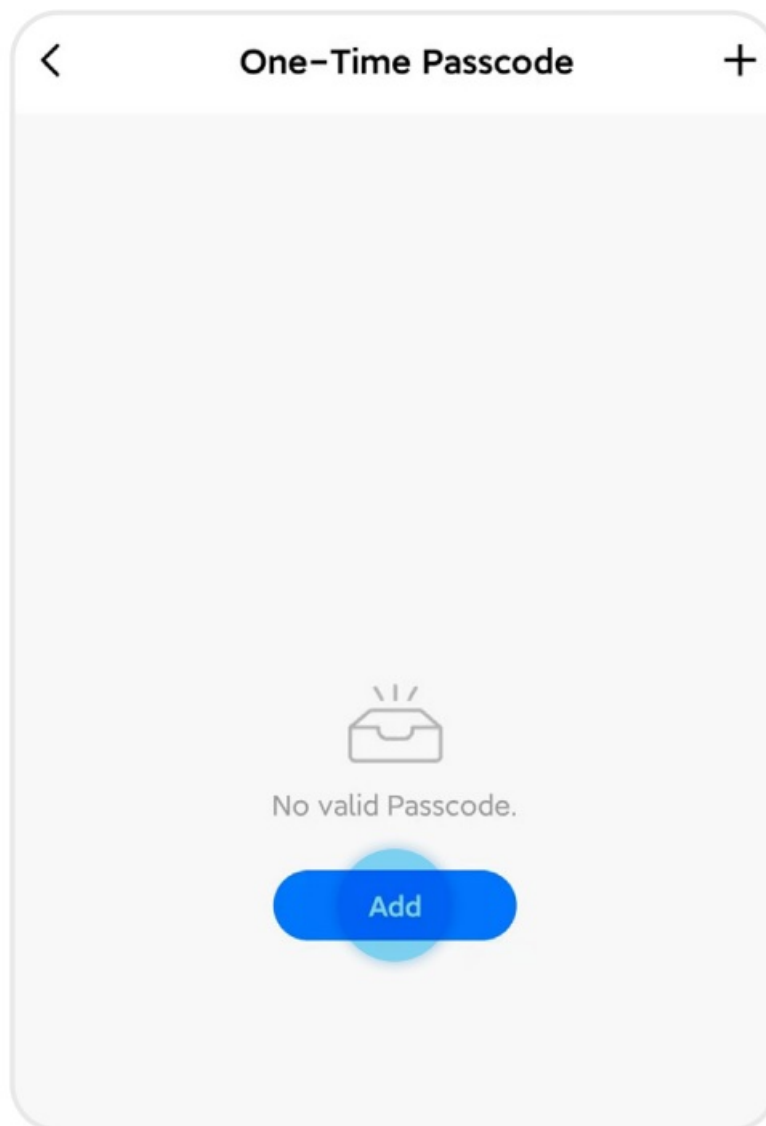

3. Click "Get Passcode".

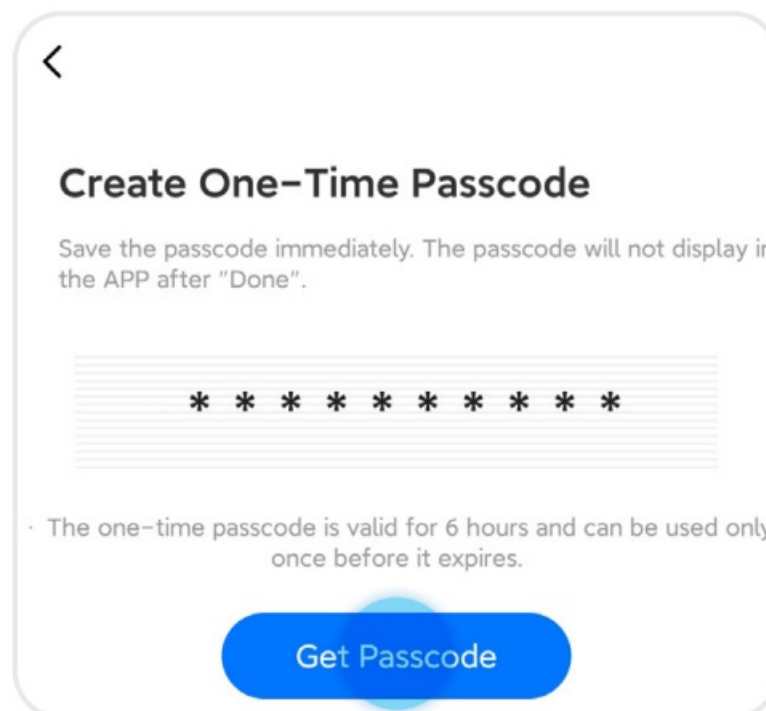

4. Copy the passcode and save it. Edit the passcode name and click "Done".

## The one-time passcode is obtained.

Save the passcode immediately. The passcode will not display in the APP after "Done".

3722528953

Copy

Passcode Name

A

Message Notification



· Passcode expires at 10-17 22:00 and can be used only once before it expires. Save it immediately. It is not displayed after it is created.

Done

### Tip

The offline one-time passcode will not appear after you have clicked "Done".

Please write it down or save it in another location, such as the NOTES application on your smart device.

## CREATING A TIME LIMITED PASSCODE OFFLINE

1. Enter the Blusafe Smart Application on your smart device, and enter the lock interface.

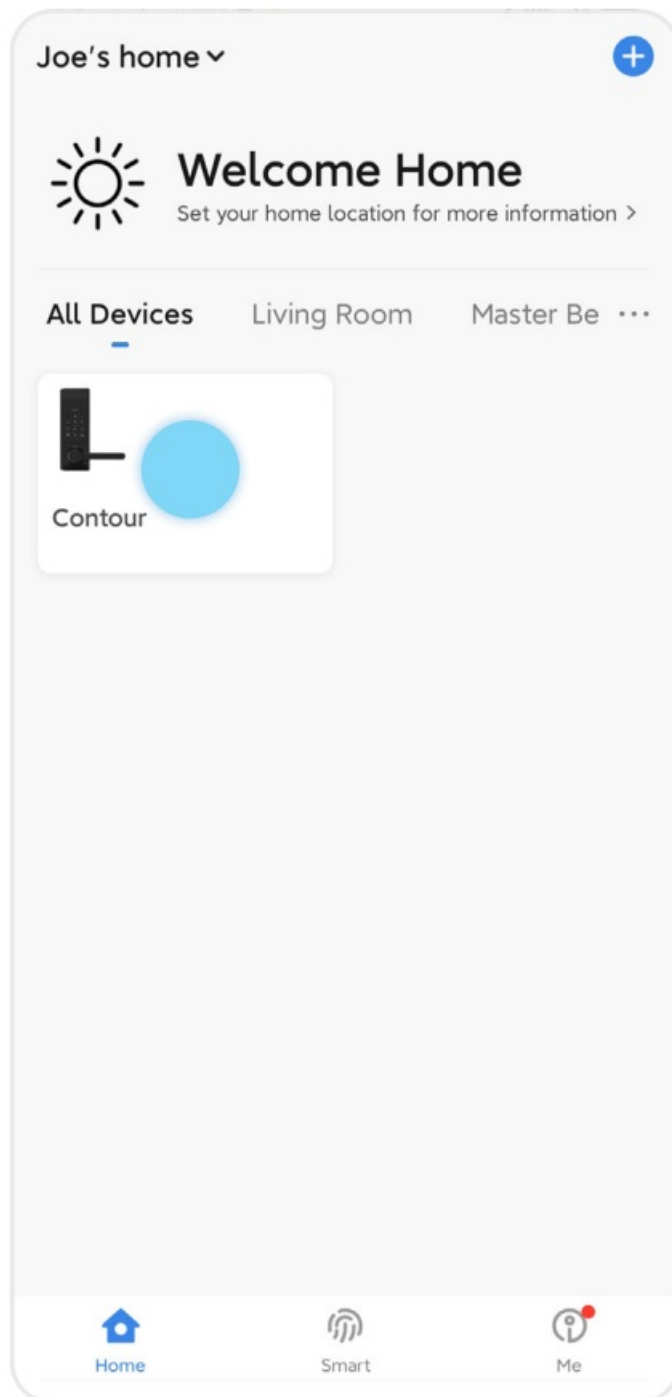

2. Click "Temporary Passcode" at the bottom of your screen.

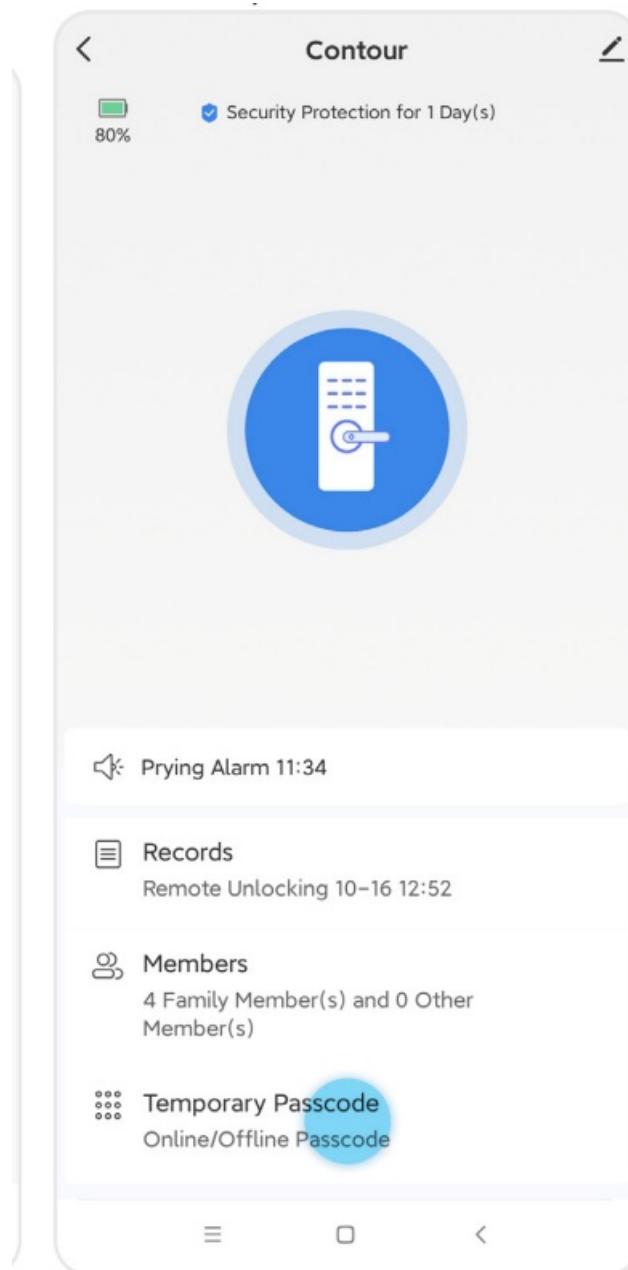

3. Select “Time Limited Code” under “Offline Passcode”.

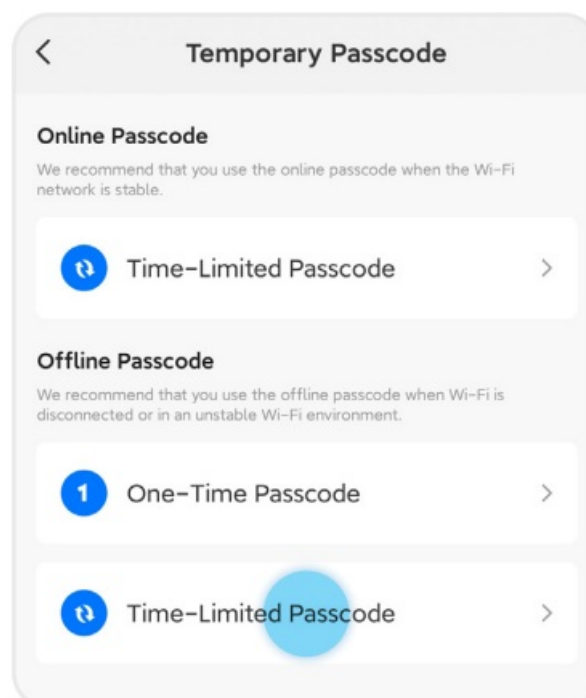

4. Click “Add”.

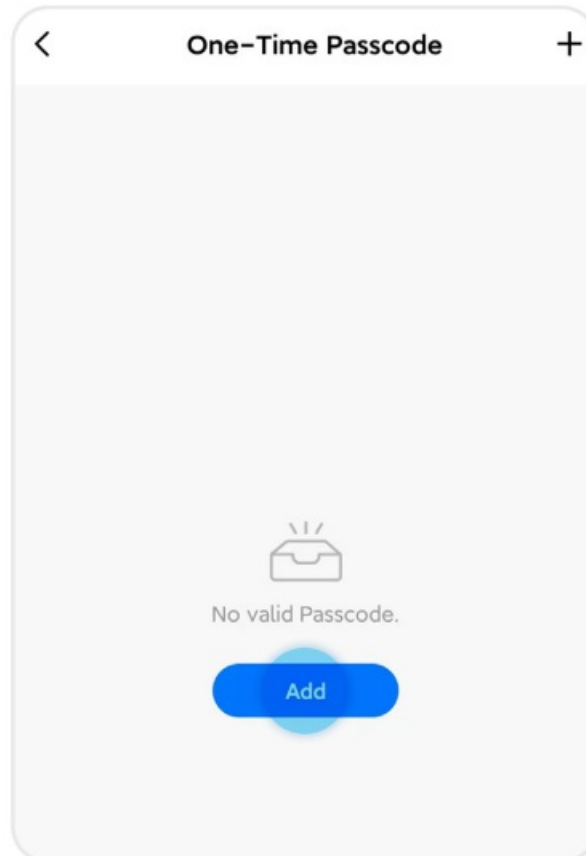

5. Select the start and end dates/times (Year/ Month/Date/Hour/Minute).

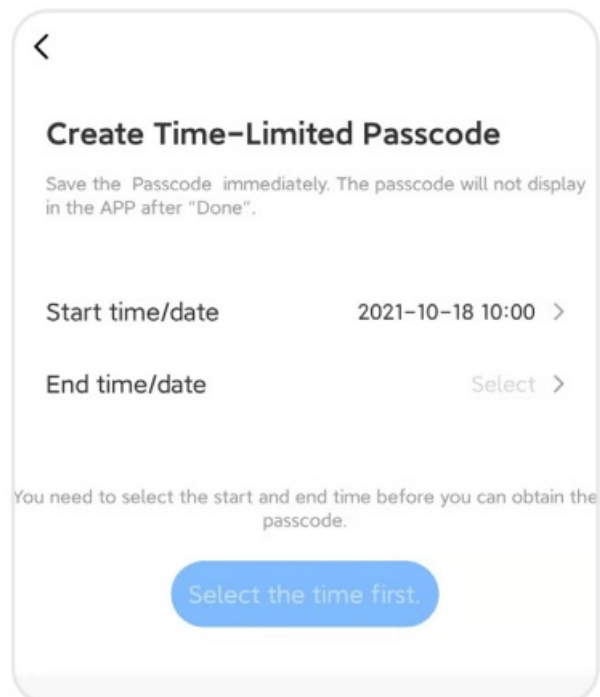

6. Click “Get passcode”.

<

Create Time-Limited Passcode

Save the Passcode immediately. The passcode will not display in the APP after "Done".

\* \* \* \* \*

Start time/date

2021-10-18 10:00 >

End time/date

2022-10-18 10:00 >

Use the time-limited passcode at least once within 24 hours after the passcode takes effect. Otherwise, the passcode becomes invalid.

Get Passcode

7. Copy the passcode and save it. Edit the passcode name and click "Done".



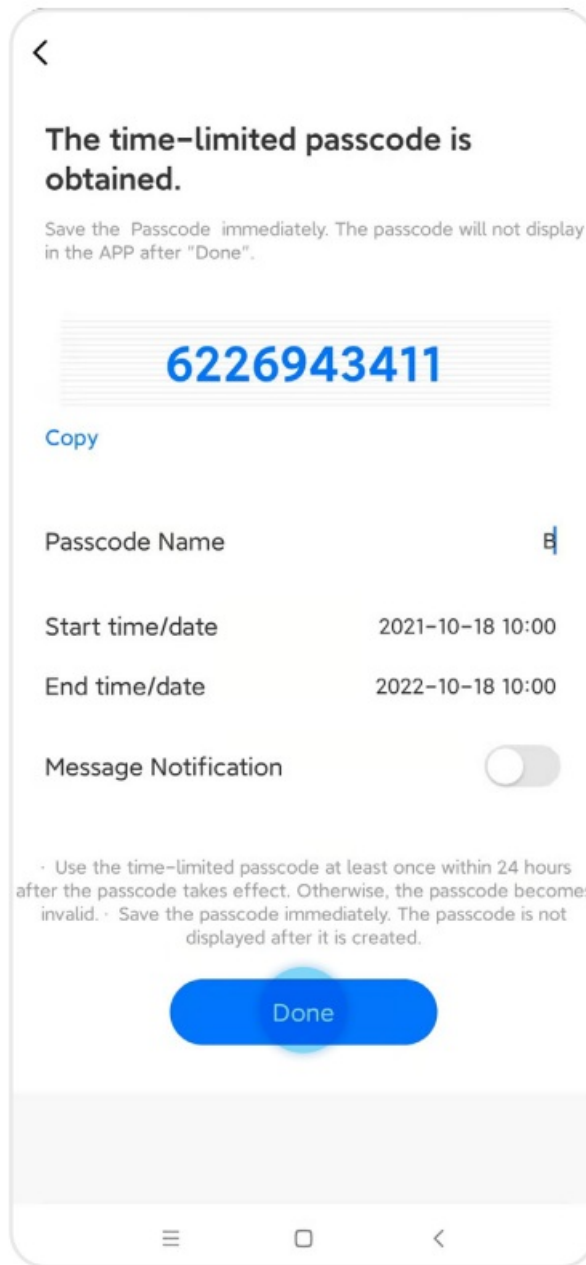

### Important !

- The offline time limited passcode will need to be used within 24 hours after it has been created. After 24 hours, the offline time limited passcode will become invalid.
- Only one offline time limited passcode can be created within the effective timeframe.  
Tip The offline time limited passcode will not appear after you have clicked "Done".  
Please write it down or save it in another location, such as the NOTES application on your smart device.

### CLEARING SELECTED OFFLINE TIME LIMITED PASSCODE

#### Note

You can only clear offline time limited passcode. The offline one-time passcode cannot be cleared.

1. Enter the Blusafe Smart Application on your smart device, and enter the lock interface.

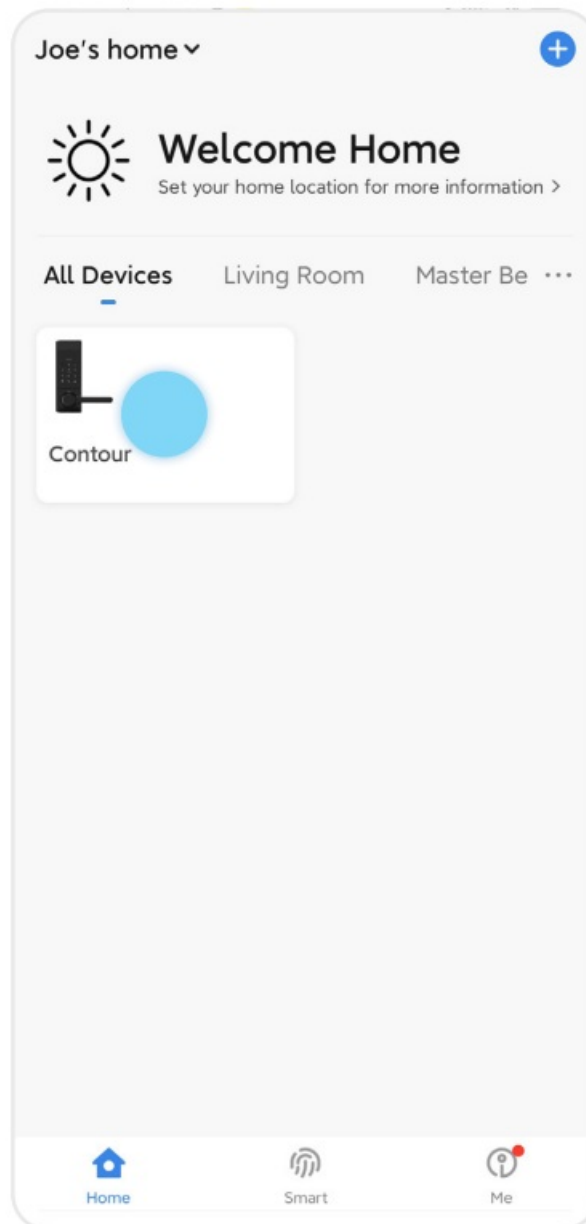

2. Click "Temporary Passcode" at the bottom of your screen.

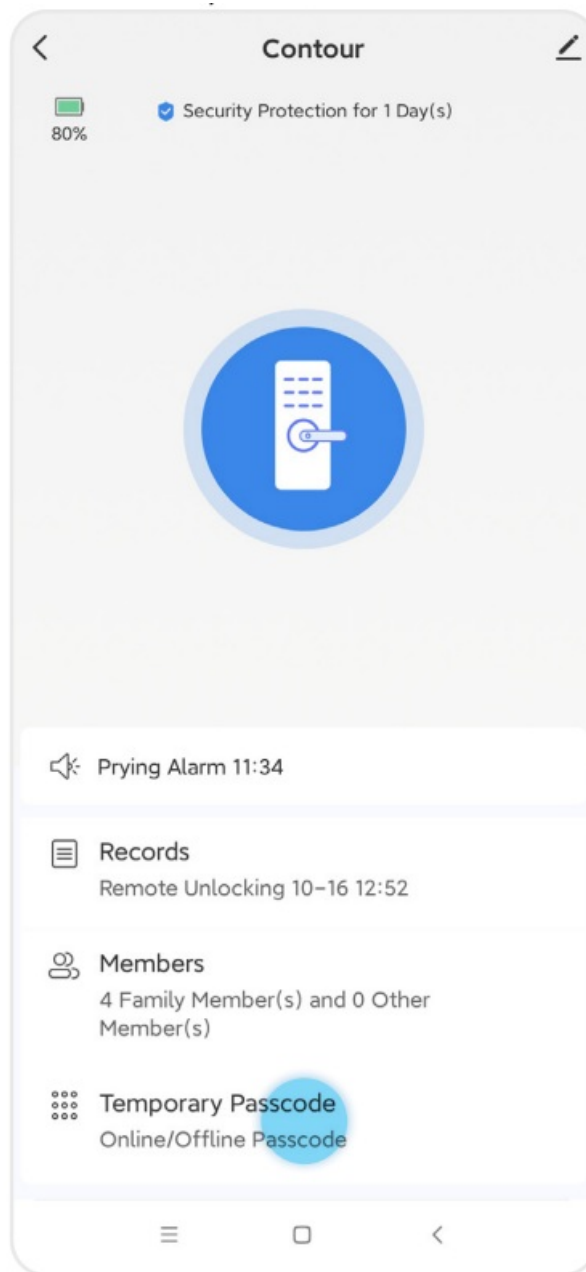

3. Select "Time Limited Code" under "Offline Passcode".

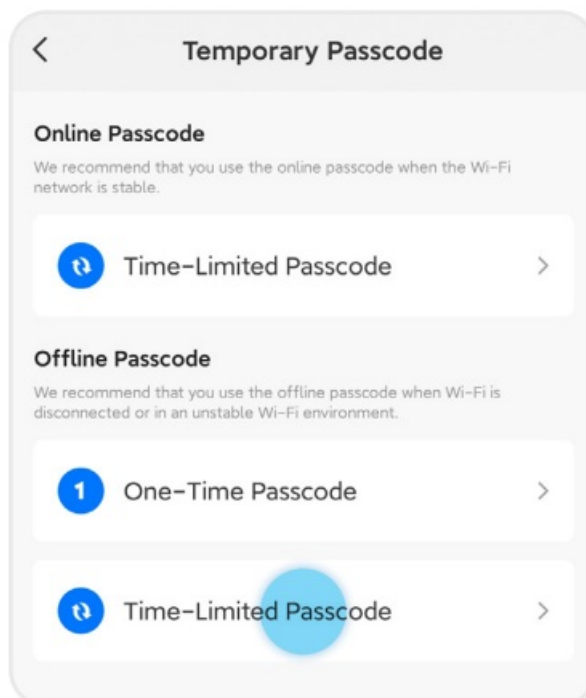

4. Select the passcode name you wish to remove.

**Note**

The passcode must be used at least once on the lock. Otherwise, it cannot be removed.

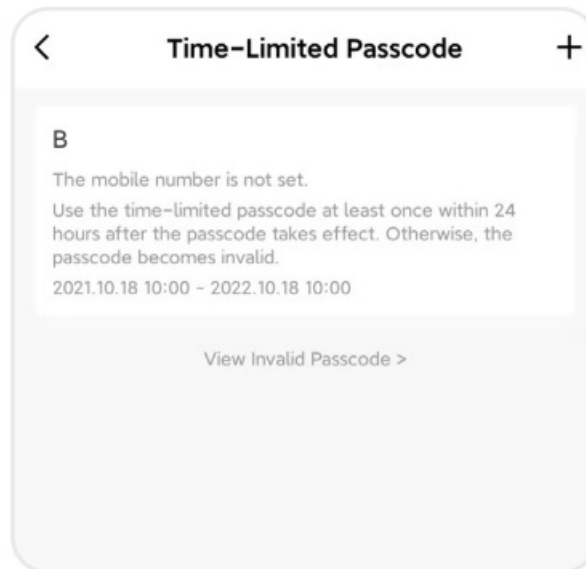

5. Click "Delete".



6. Click "Get clear code".

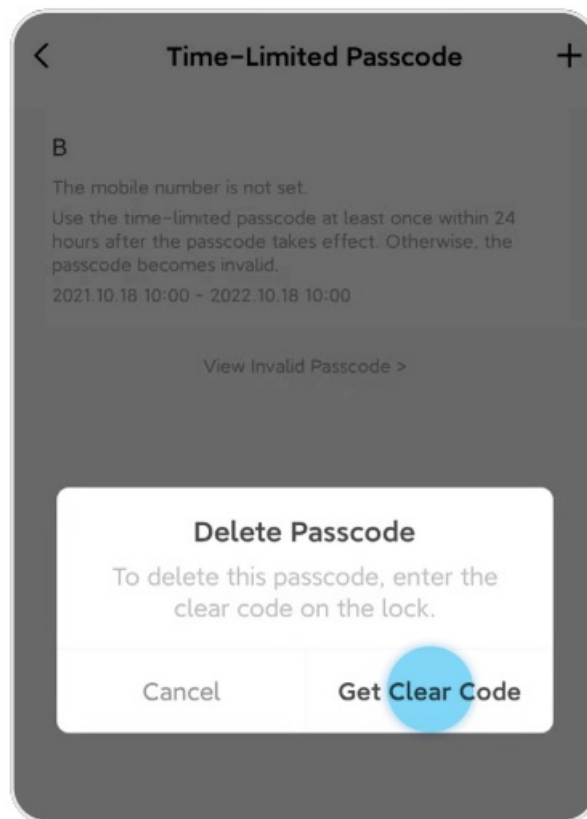

7. Click “Get clear code”.

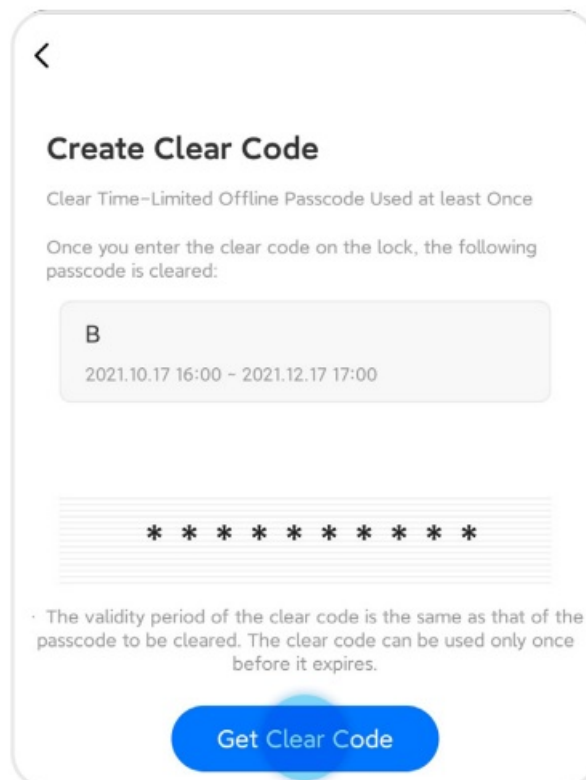

8. Copy the passcode and save it. Edit the passcode name and click “Done”.

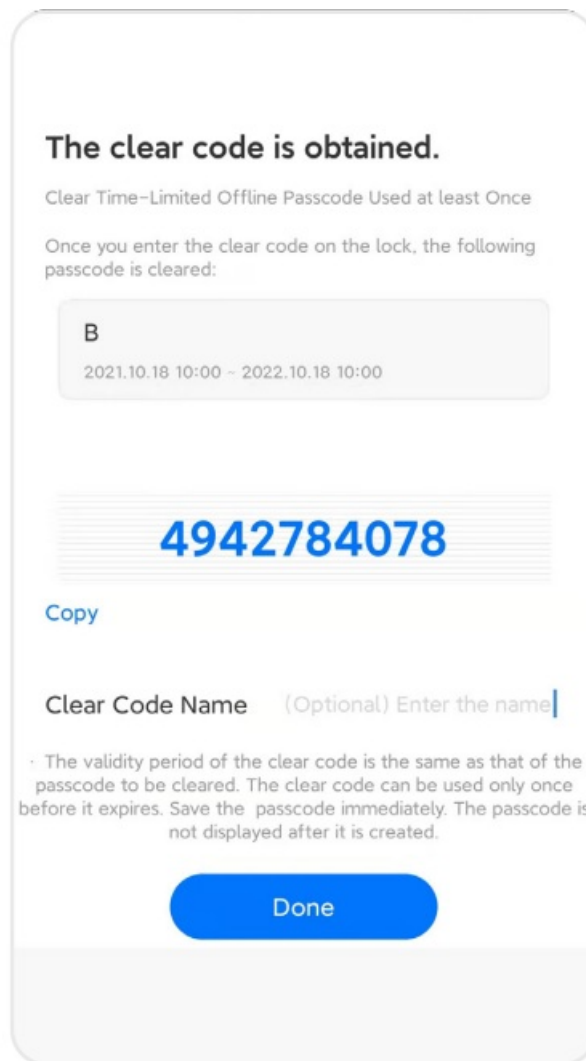

9. Input the clear code into the lock to erase the selected offline passcode.

**Warning!**

Unbinding the lock from the App or initiating a factory reset will NOT remove any temporary passcodes. Please follow the above steps to remove any temporary passcodes.

## UNLOCKING YOUR SMART LOCK

### INTRODUCTION

Your Contour / Contour V smart lock can be unlocked using fingerprint/keycard/passcode/manually. Please refer to the Lock User Manual for detail instructions.

**Important !**

Before the lock is setup, the Contour /Contour V smart lock can be unlocked by any fingerprint, keycard or default passcode 123456.

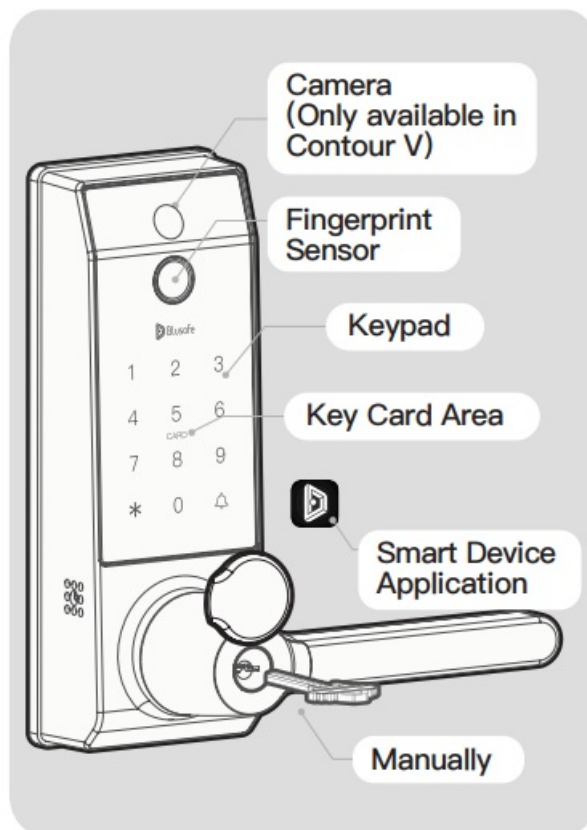

## DOORBELL UNLOCKING

The Contour / Contour V can also be unlocked remotely via App when a guest rings the doorbell on the lock.

### **Important !**

Please turn on the “Notifications” for Blusafe Smart App on your smart phone. This will enable notifications such as doorbell, anti-prying alerts, unlock logs etc.

1. Enter the Blusafe Smart Application on your smart device, and enter the lock interface.

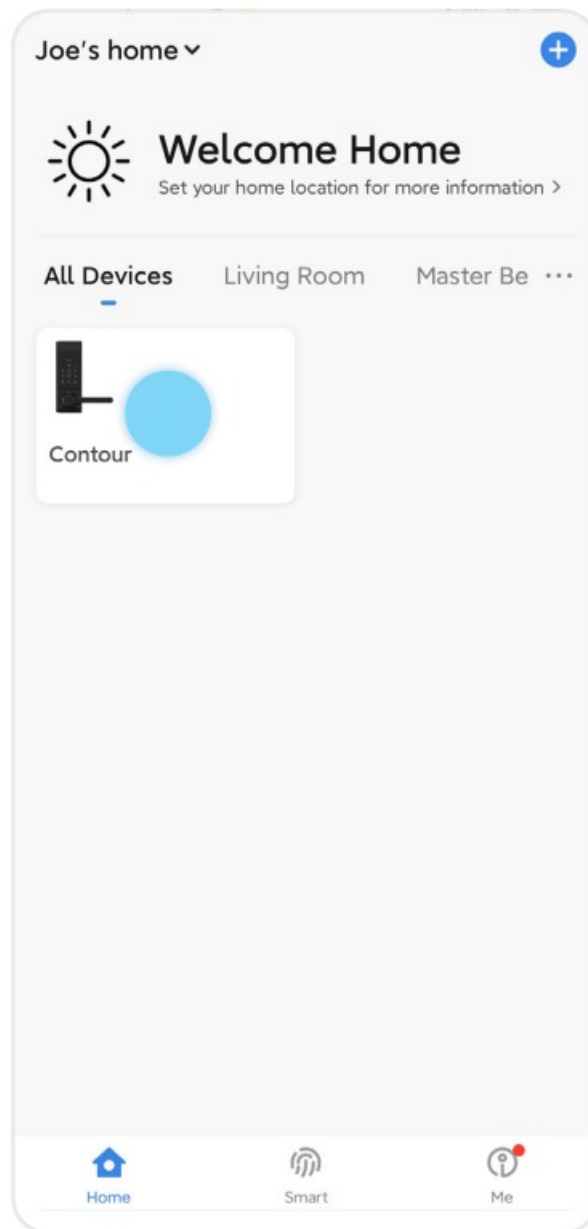

2. Enter the lock interface.



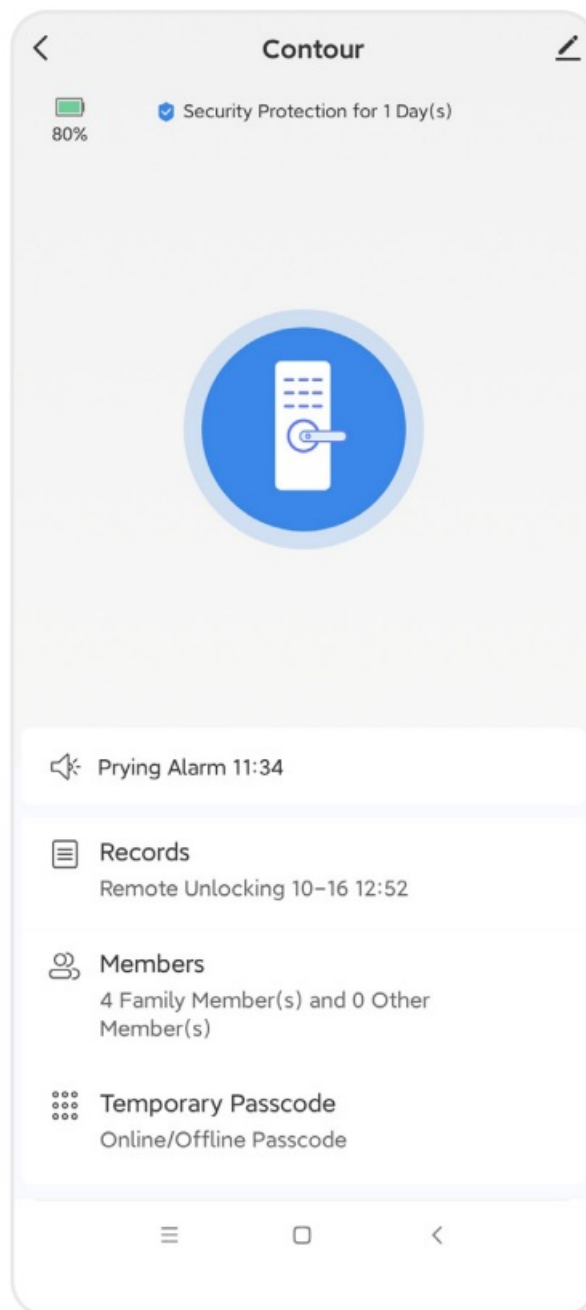

3. A popup will display as shown below.

Slide the key bar to the right to accept the unlock request, otherwise slide it to the left to deny.

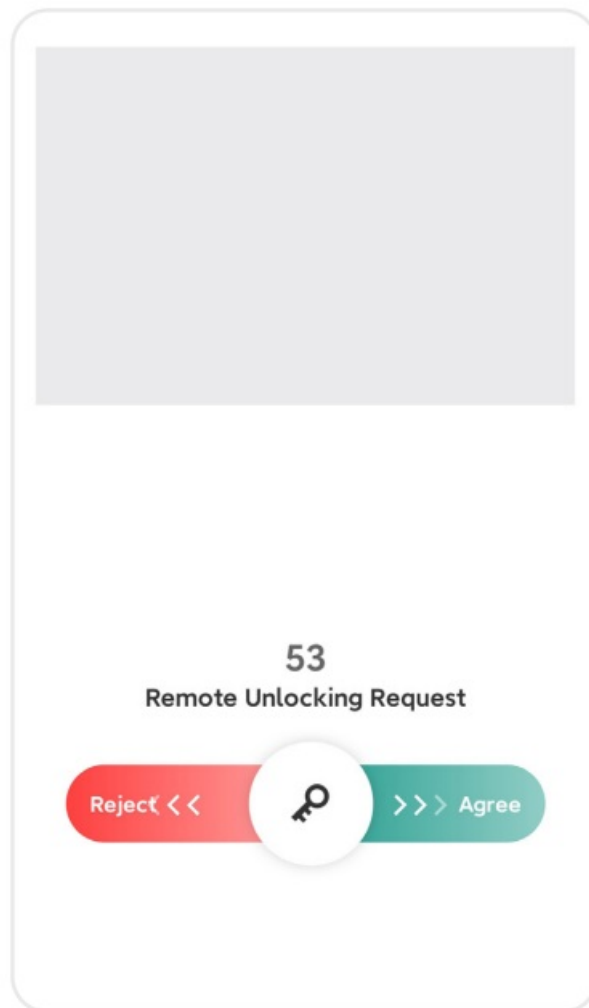

**Important !**

Sometimes the popup may take up to 10 seconds to be displayed, depends upon the Wi-Fi quality. Try click the photo area a few times to refresh if it doesn't display.

**Note**

If you have purchased the Contour V, a photo of the guest will be taken and display on the App automatically.

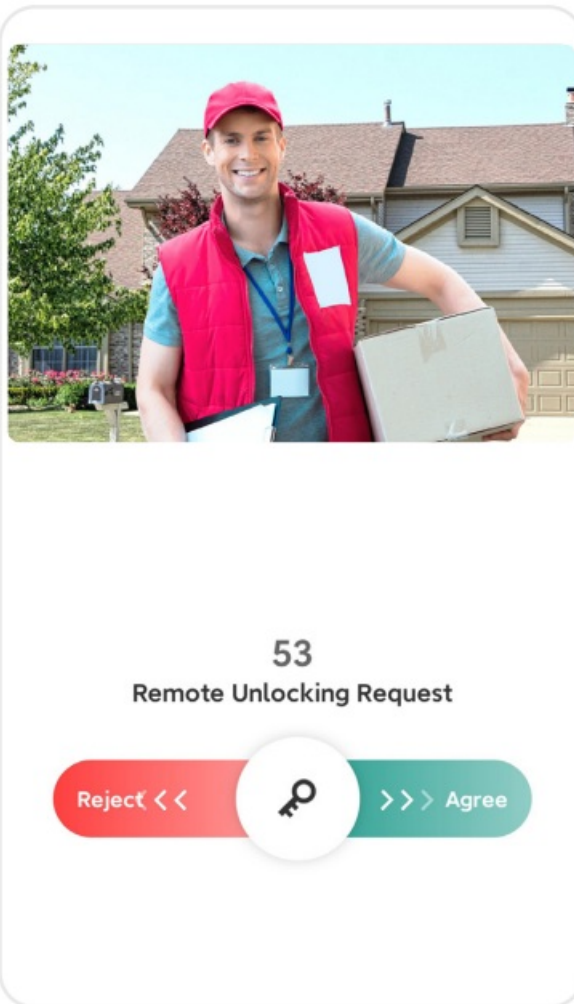

## OTHER FUNCTIONS

### SEARCH RECORDS

The home members can access the unlock records / activity log. This shows a record of every time the door was unlocked, at what time it was unlocked, and by which users. (This is why it is important to link the fingerprints, keycards and passcodes to designated members).

1. Enter the Blusafe Smart Application on your smart device, and enter the lock interface.

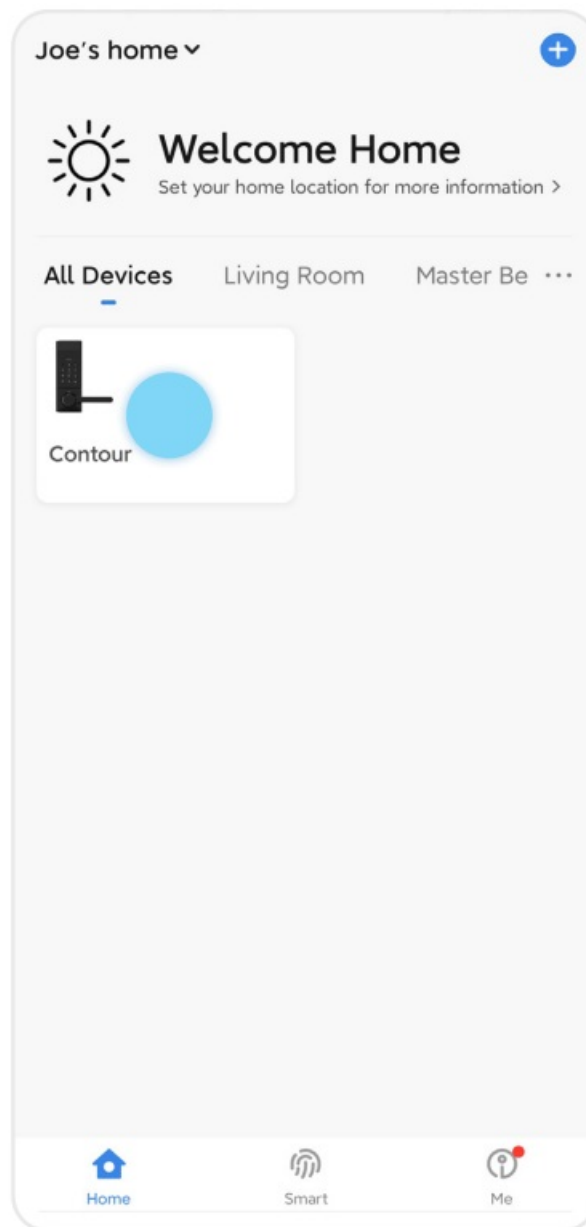

2. Click the "Records" to view all logs of unlocks.

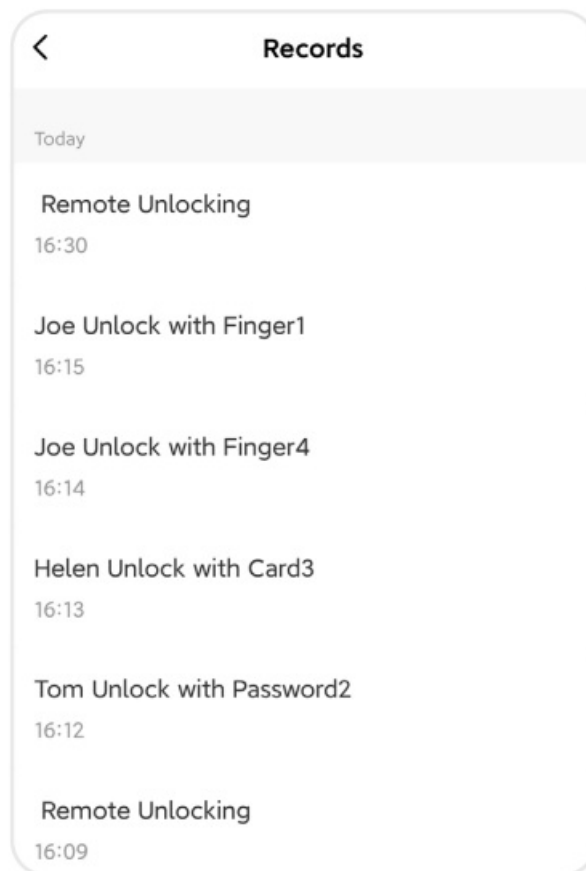
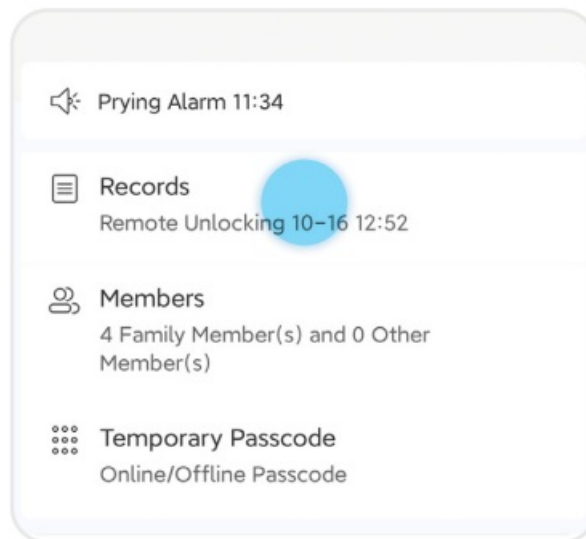

## ALERTS

Alerts will be shown in the App if special circumstances occur. For example, a system lockout, a doorbell ring, or anti-prying triggers.

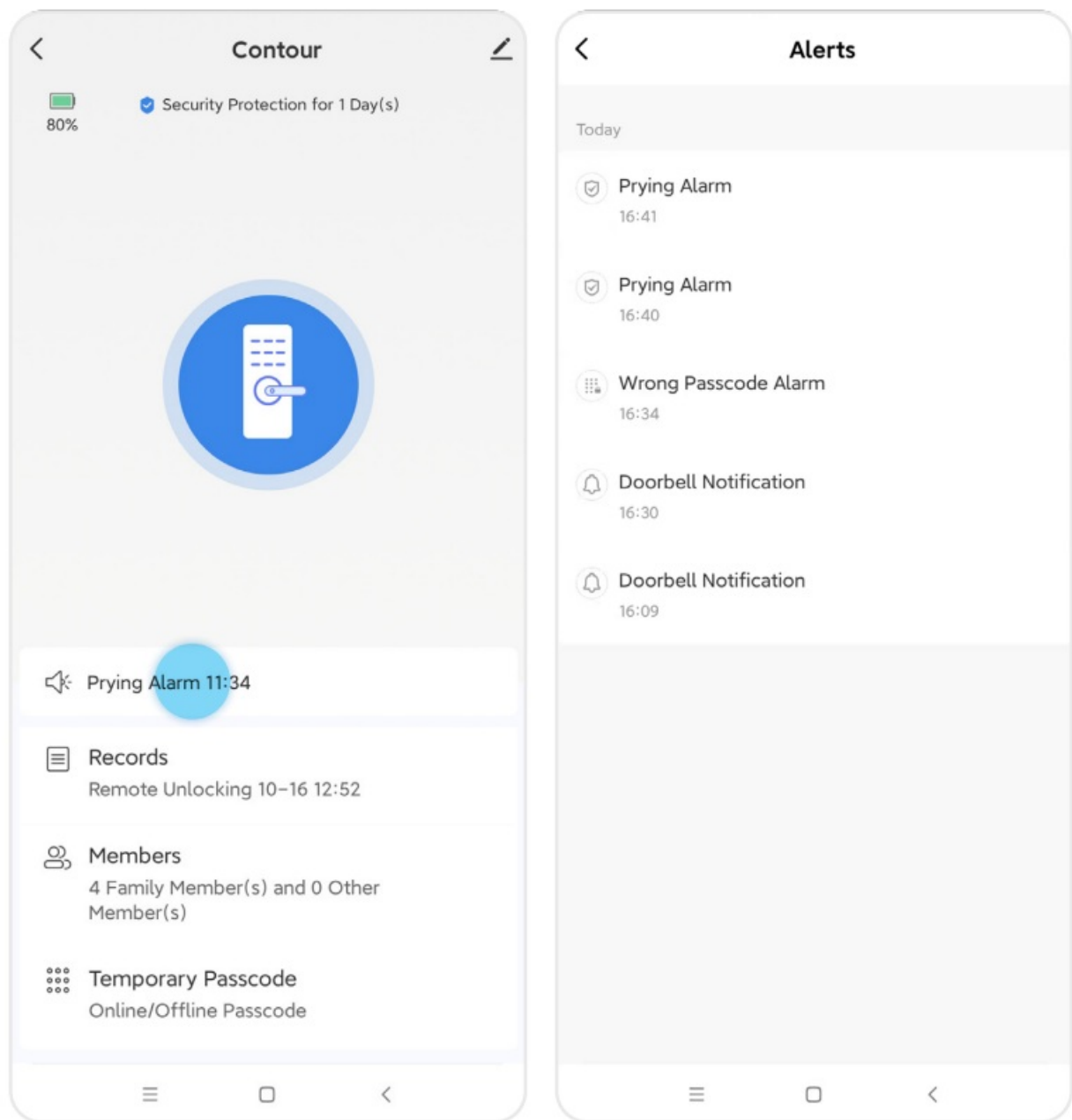

### ANTI-PRYING FUNCTION

If there is an attempt to force the lock open or physically attack the lock, the antiprying (tamper) alarm will be triggered. A warning alarm will sound, which will last for 60 seconds and an alert will also show on the App. During this time, unlocking the lock using a registered fingerprint or key card, or removing the batteries will turn off the alarm.

Please activate the anti-prying function AFTER installation. For instructions on how to turn on / off the anti-prying (tamper) function on the lock, please refer to the Lock User Manual for details.

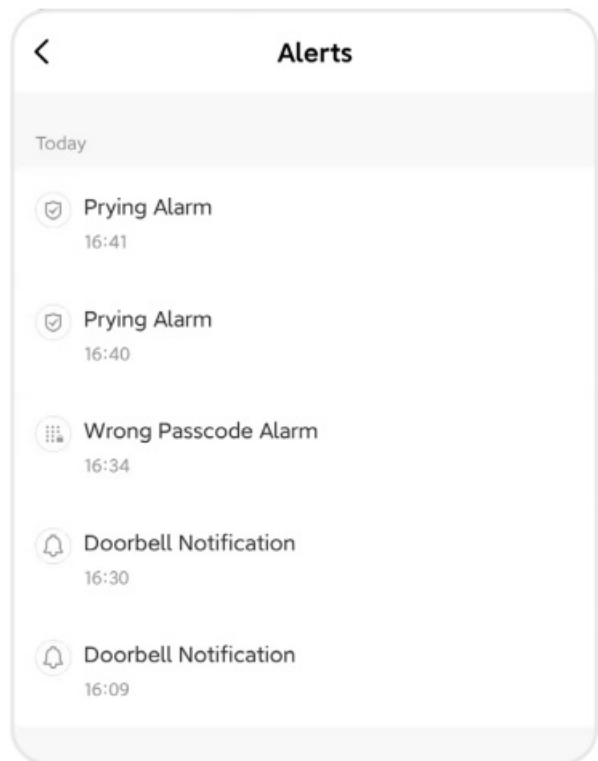
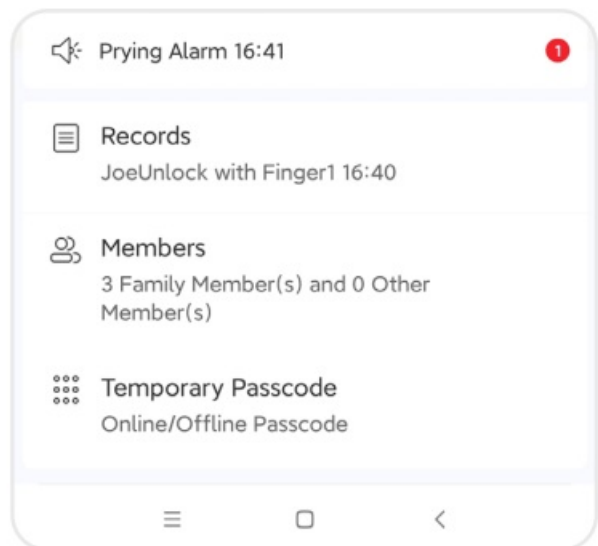
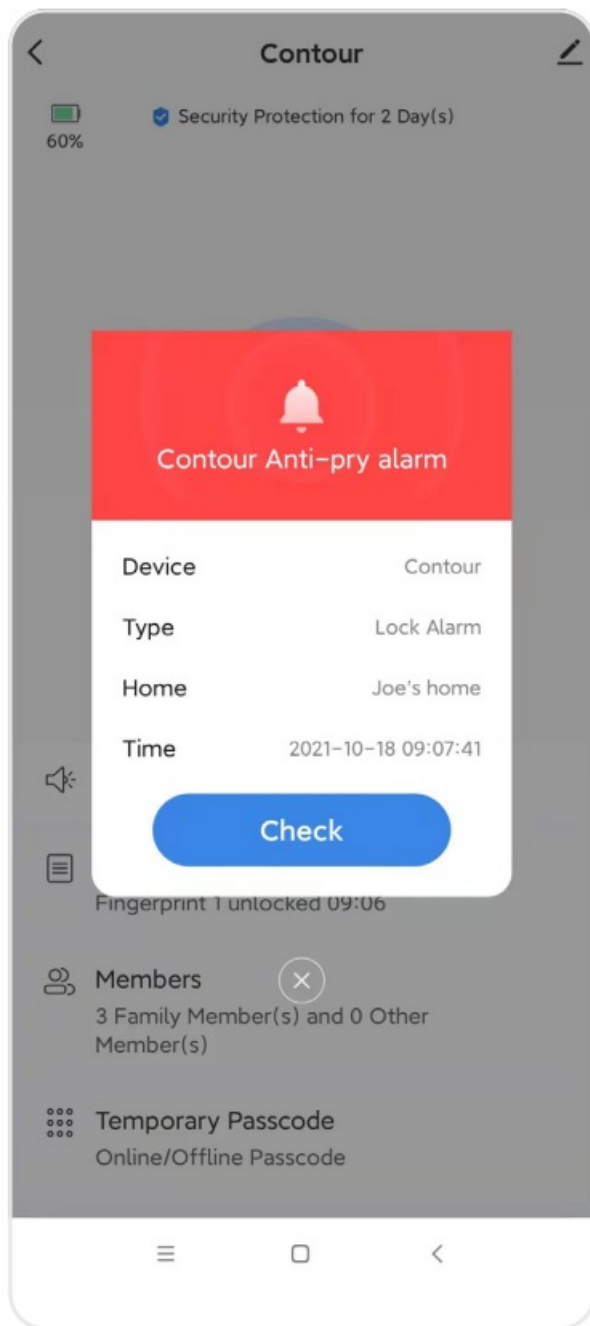

### Warning!

This device complies with Part 15 of the FCC Rules. Operation is subject to the following two conditions: (1) this device may not cause harmful interference, and (2) this device must accept any interference received, including interference that may cause undesired operation.

Changes or modifications not expressly approved by the party responsible for compliance could void the user's authority to operate the equipment.

### Note

This equipment has been tested and found to comply with the limits for a Class B digital device, pursuant to Part 15 of the FCC Rules. These limits are designed to provide reasonable protection against harmful interference in a residential installation. This equipment generates, uses and can radiate radio frequency energy and, if not installed and used in accordance with the instructions, may cause harmful interference to radio communications. However, there is no guarantee that interference will not occur in a particular installation.

If this equipment does cause harmful interference to radio or television reception which can be determined by turning the equipment off and on, the user is encouraged to try to correct the interference by one or more of the following measures:

- Reorient or relocate the receiving antenna.
- Increase the separation between the equipment and receiver

- Connect the equipment into an outlet on a circuit different from that to which the receiver is connected.
- Consult the dealer or an experienced radio/TV technician for help

**Note**

This device and its antenna(s) must not be co-located or operation in conjunction with any other antenna or transmitter

**RF Exposure Statement**

To maintain compliance with FCC's RF Exposure guidelines, this equipment should be installed and operated with minimum distance of 20cm the radiator your body. This device and its antenna(s) must not be co-located or operation in conjunction with any other antenna nr transmitter.

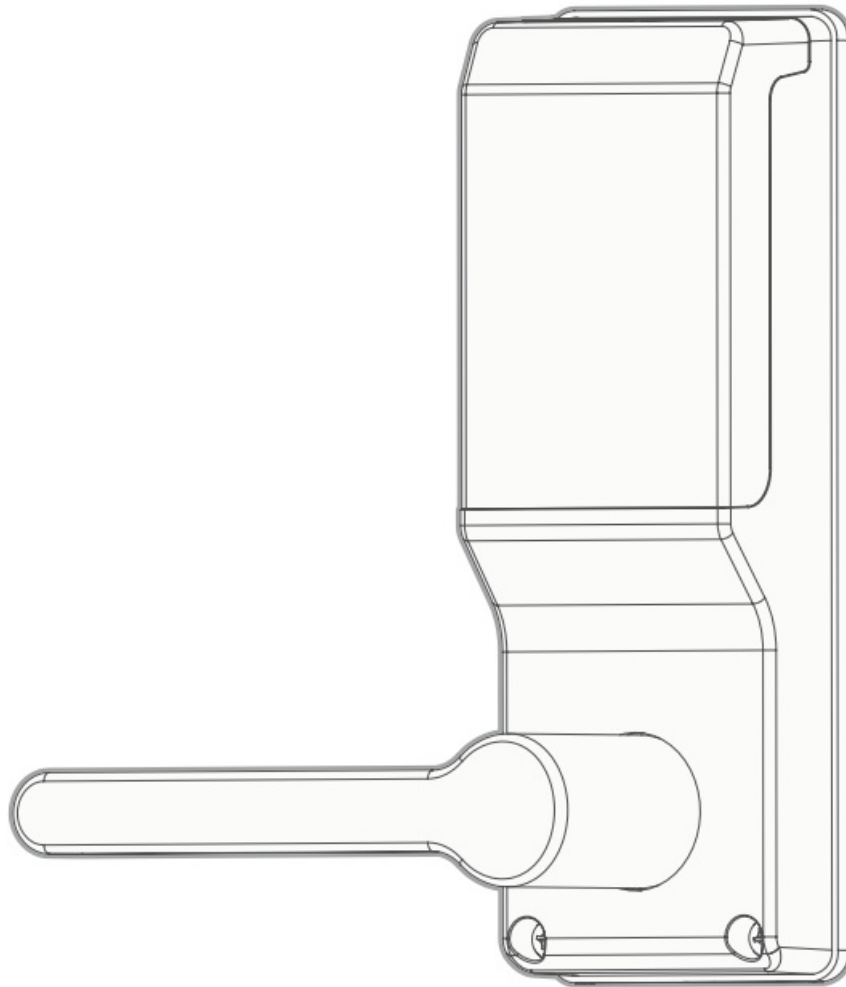

Please scan the QR to get newest manuals on Blusafe Products



<https://blusafesolutions.com/download-manuals/>



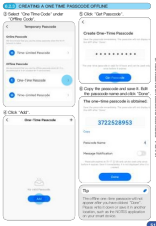

## Blusafe P42 Blusafe Smart App [pdf] User Guide

2A9DX-C01, 2A9DXC01, C01, P42 Blusafe Smart App, Blusafe Smart App, Smart App