



blurams D10C Smart Doorbell with Wi-Fi and Remote Controller User Manual

[Home](#) » [blurams](#) » blurams D10C Smart Doorbell with Wi-Fi and Remote Controller User Manual 

Contents

- [1 blurams D10C Smart Doorbell with Wi-Fi and Remote Controller](#)
- [2 Charge your doorbell battery](#)
- [3 Download blurams App](#)
- [4 Add your doorbell into App](#)
- [5 FCC Statement](#)
- [6 Documents / Resources](#)
- [7 Related Posts](#)

blurams

blurams D10C Smart Doorbell with Wi-Fi and Remote Controller



Packing list



1 × Doorbell

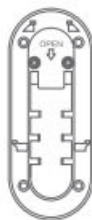

1 × Mounting base

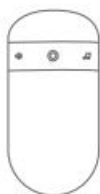

1 × Chime

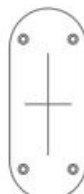

1 × Positioning paper



1 × Manual

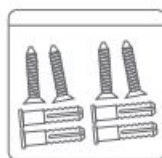

1 × Screw accessory
pack

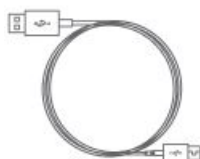

1 × USB cable



1 × terminal screw wire
terminal accessory pack

Get to know your doorbell

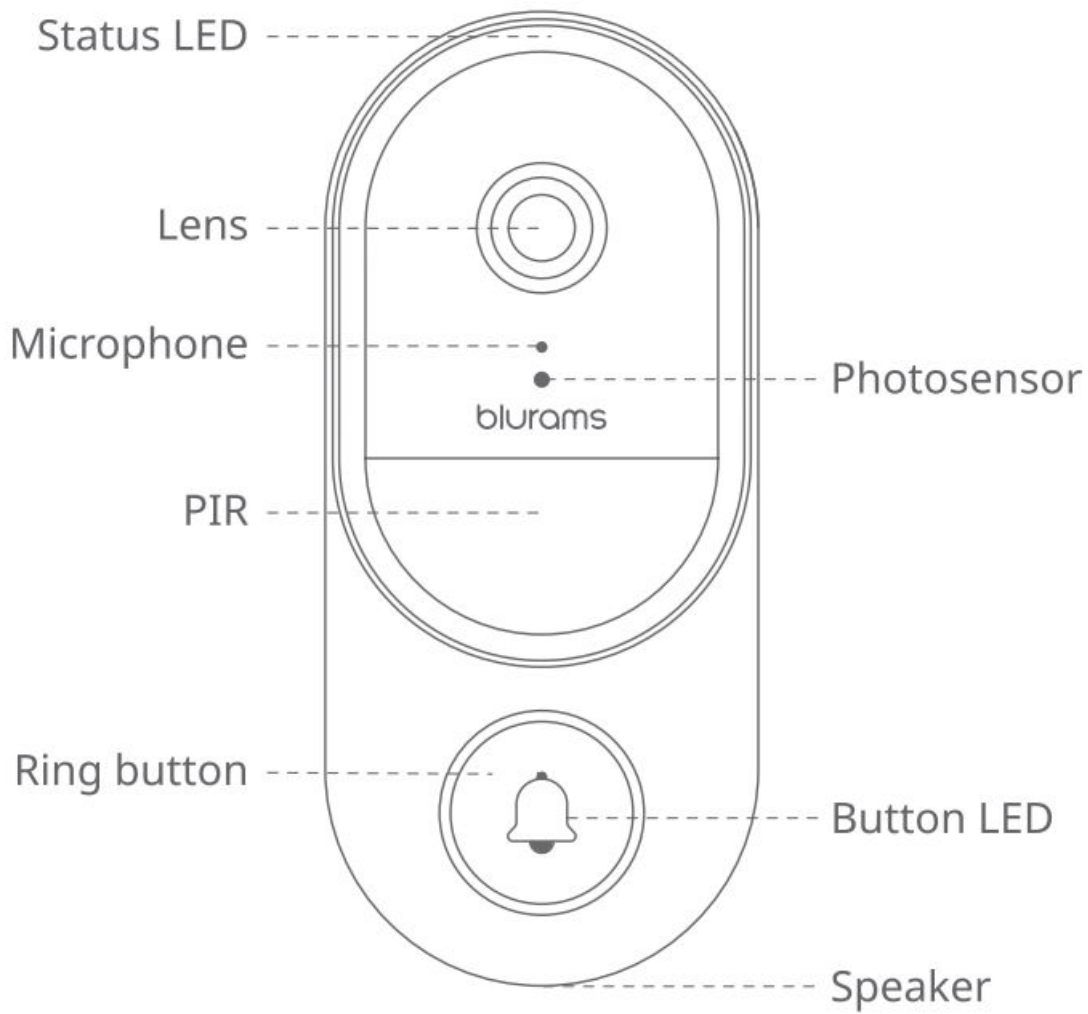

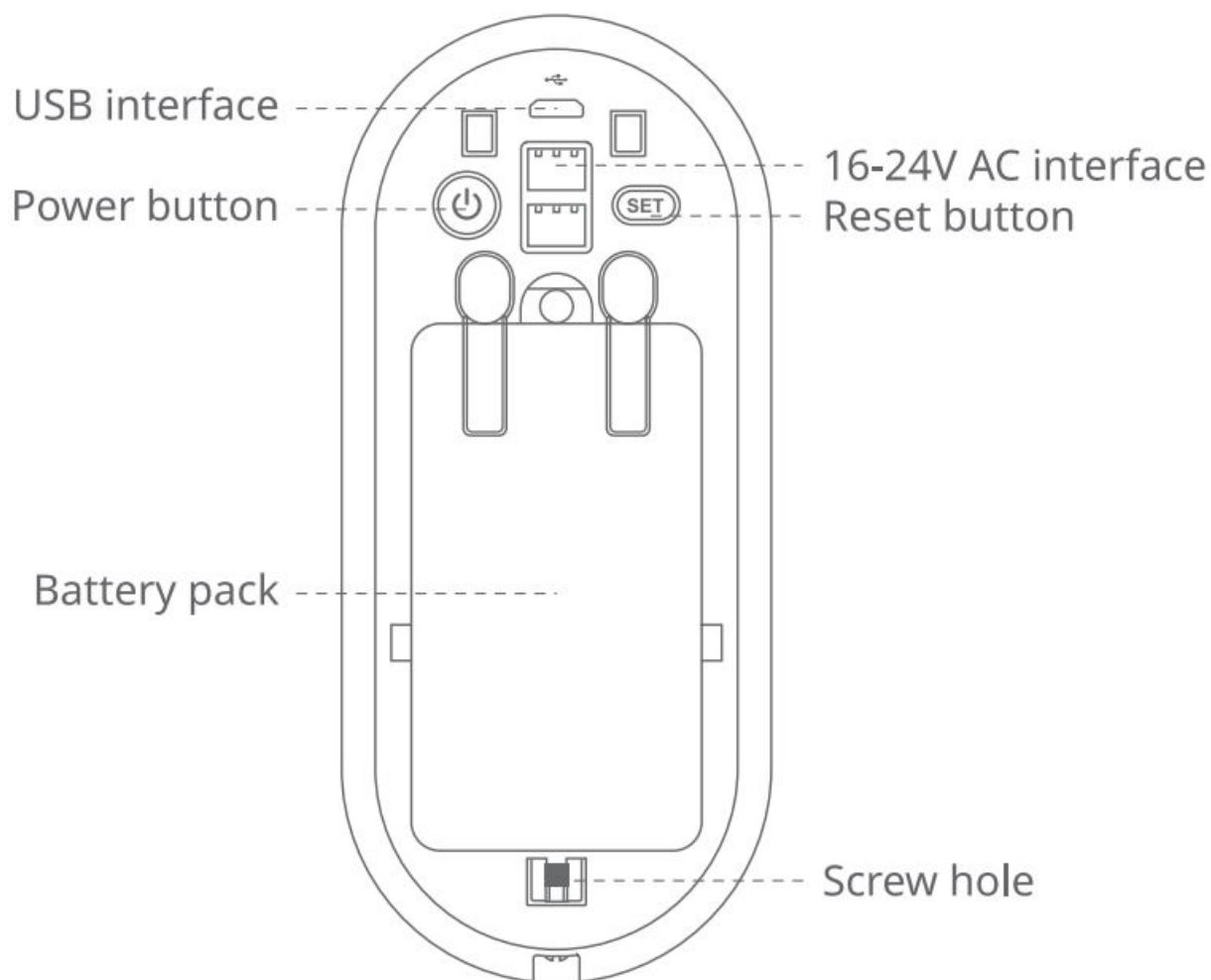

Charge your doorbell battery

First, fully charge your doorbell battery. Plug Into a USB power source (self-provided) using the provided cable.

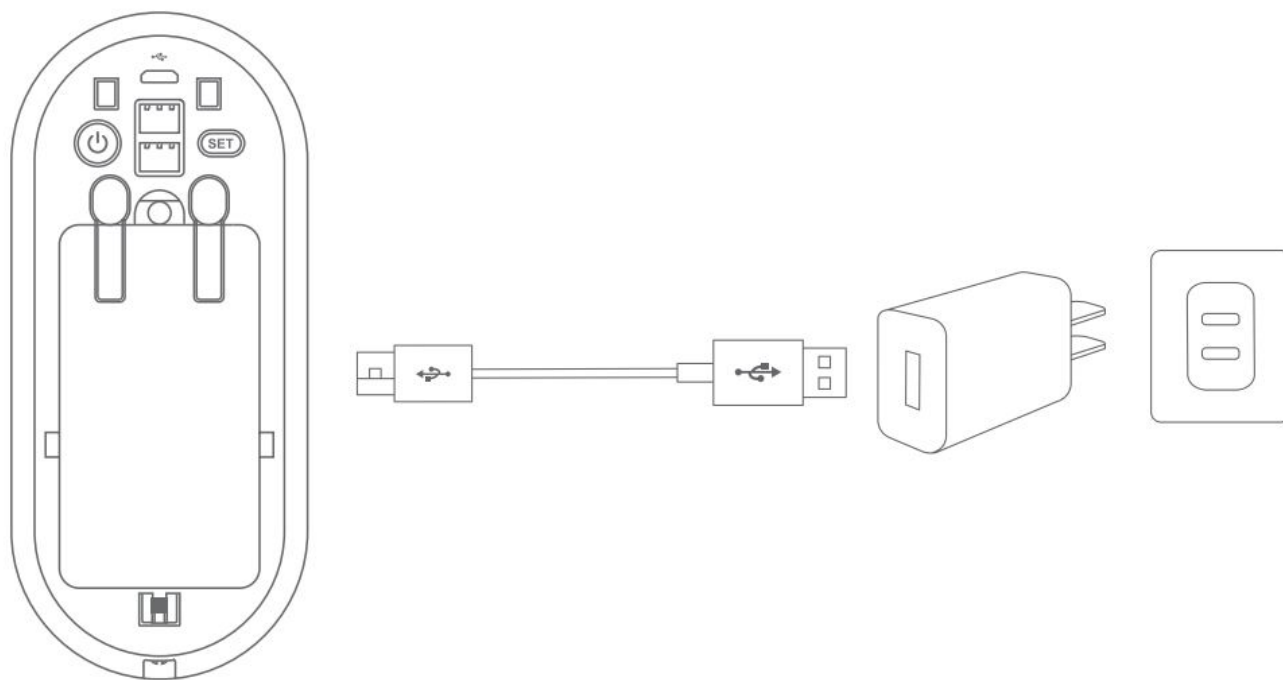

Charging: Status LED red light on and breathe. Charged: Status LED red light off.

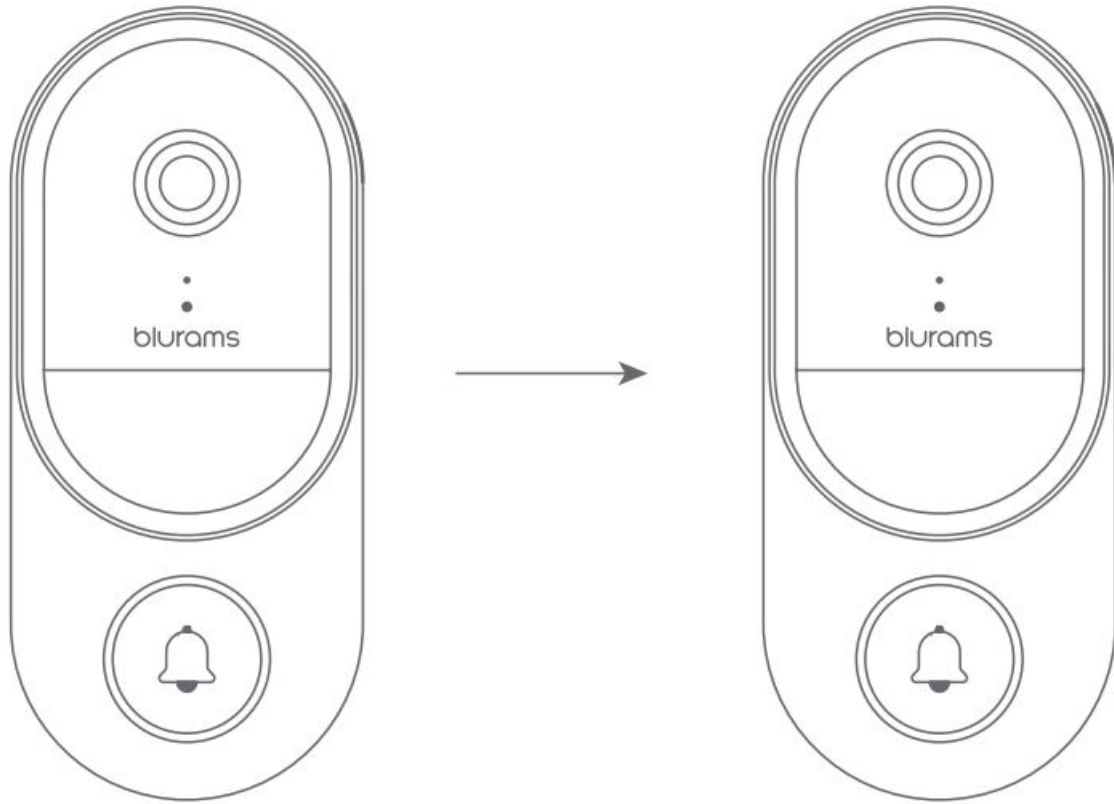

Download blurams App

Download the App by searching "blurams" in the App Store or Google Play. Alternatively, you can open a QR scanner App and scan the blurams App QR code below to install the App.



Add your doorbell into App

Enter into the blurams App, sign up for a free blurams account and log in. Go to the home page and click the "+" icon on the top right corner, select doorbell. Please follow the instruction on the App interface to add your doorbell.

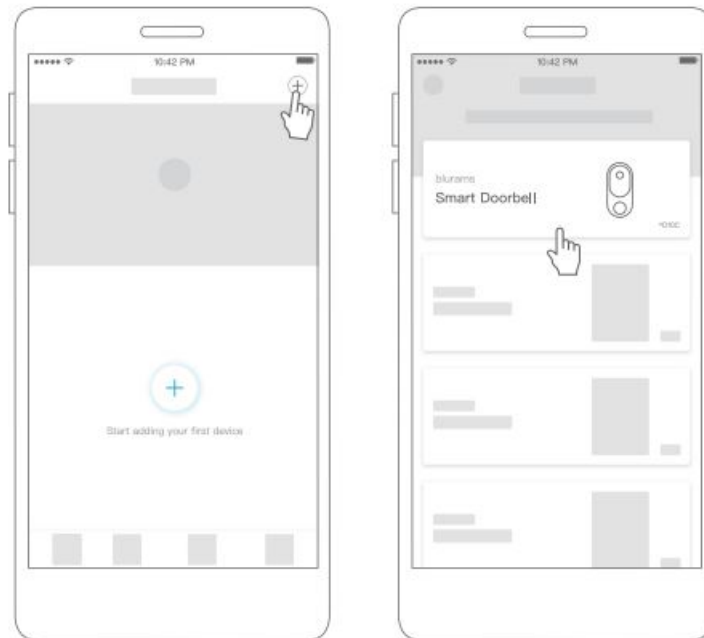
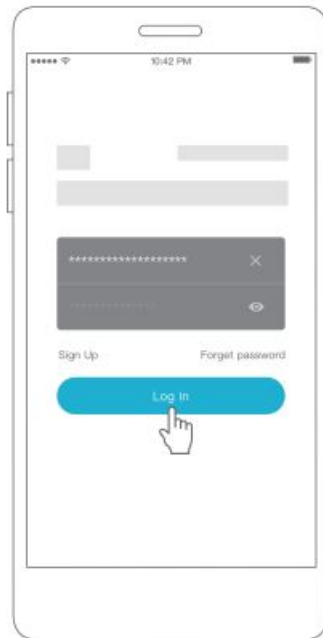

FAQs

If you encounter any troubles in product information, product installation and use, please refer to the “Mine> Help And Feedback” in blurams app or email at support@blurams.com.

Give us your feedback

blurams strive for a high-quality product and user experience, we’re eager to hear your feedback or suggestions. Send your feedback through the App or email at support@blurams.com.

Do not use the camera in the environment at too high or too low temperature, never expose the camera under strong sunshine or too wet environment. The suitable temperature for the product and accessories is -10°C-50°C. When charging, please place the camera in an environment that has a normal room temperature and good ventilation. It is recommended to charge the camera in an environment with a temperature that ranges from 5°C~25°C. The adapter shall be installed near the equipment and shall be easily accessible. The plug considered as disconnect device of adapter. If you use a third-party charger, the recommended output voltage/current of the adaptor is 5Vdc/2A, and the adapter shall be CE approval type. CAUTION RISK OF EXPLOSION IF BATTERY IS REPLACED BY AN INCORRECT TYPE. DISPOSE OF USED BATTERIES ACCORDING TO THE INSTRUCTIONS. RF exposure information: The Maximum Permissible Exposure (MPE) level has been calculated based on a distance of d=20 cm between the device and the human body. To maintain compliance with RF

exposure requirement, use product that maintain a 20cm distance between the device and human body.
Operating Frequency Range: 2412 MHz- 2472 MHz Max Output Power: < 20dBm
This product can be used across EU member states.

FCC Statement

This equipment has been tested and found to comply with the limits for a Class B digital device, pursuant to part 15 of the FCC rules. These limits are designed to provide reasonable protection against harmful interference in a residential installation. This equipment generates, uses and can radiate radio frequency energy and, if not installed and used in accordance with the instructions, may cause harmful interference to radio communications. However, there is no guarantee that interference will not occur in a particular installation. If this equipment does cause harmful interference to radio or television reception, which can be determined by turning the equipment off and on, the user is encouraged to try to correct the interference by one or more of the following measures:

- reorient or relocate the receiving antenna.
- Increase the separation between the equipment and receiver.
- Connect the equipment into an outlet on a circuit different from that to which the receiver is connected.
- Consult the dealer or an experienced radio/TV technician for help.

To assure continued compliance, any changes or modifications not expressly approved by the party responsible for compliance could void the user's authority to operate this equipment. (Example- use only shielded interface cables when connecting to computer or peripheral devices). This equipment complies with Part 15 of the FCC Rules. Operation is subject to the following two conditions: (1) This device may not cause harmful interference, and (2) This device must accept any interference received, including interference that may cause undesired operation. FCC Radiation Exposure Statement: The equipment complies with FCC Radiation exposure limits set forth for uncontrolled environment. This equipment should be installed and operated with minimum distance 20cm between the radiator and your body.

FCC ID: 2ASAQ-D1 DC

Documents / Resources

	<p>blurams D10C Smart Doorbell with Wi-Fi and Remote Controller [pdf] User Manual D10C, 2ASAQ-D10C, 2ASAQD10C, D10C Smart Doorbell with Wi-Fi and Remote Controller, D10C, Smart Doorbell with Wi-Fi and Remote Controller</p>
---	--