

Bluedio T7 User Manual

Microphone for
noise cancellation



[Home](#) » [Bluedio](#) » Bluedio T7 User Manual

User Manual
Model: T7

Headphone Overview

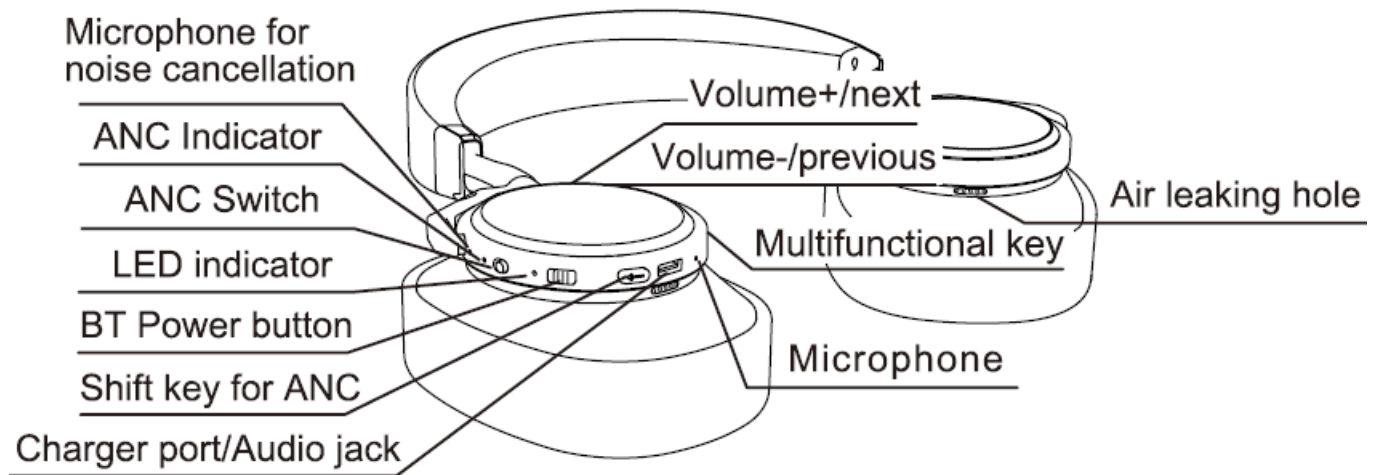

Notes on usage and operation:

Power on / off

Toggle the power-on key of Bluetooth to control the power-on / power-off of the headset.

Bluetooth Pairing:

1. The earphone will automatically enter the pairing mode after starting up.
2. Start the Bluetooth of the mobile phone, search / add Bluetooth devices, and select " T7" among Bluetooth devices that founded(some devices need to enter the password " 0000").
3. Headphones that have been successfully paired will automatically enter the reconnection mode after being turned on, and will automatically connect with the device that was successfully paired last time.

Music Control:

Click the multifunctional key to control the pause/play of music Click the key of volume up to increase the volume, and press and hold to switch to the next song. Click the key of volume down to lower the volume and press and hold to switch to the previous song.

Incoming Call Control

When there is a coming call, click the multifunctional key to answer the call, and click again to hang up the call. You can also tap the right shell of the earphone twice with your finger to answer the incoming call when someone calls in, and tap the right shell of the earphone twice again to hang up the call. When there is a incoming call, you can press and hold the multifunctional key to reject the call.

ANC Active Noise-cancelling:

Toggle the ANC active noise-canceling switch, the green indicator light will turn on for a long time and it means that the noise reduction feature will turn on. When the ANC switch is toggled again, the green indicator close down automatically, and it means that the noise reduction feature is turned off.

ANC Shift Switch:

Double-click the ANC shift switch to change the ANC gear position. (Shift between High and Low) Note: ANC shift feature is only effective both in Bluetooth mode and ANC turned on. The default degree of ANC is high-level.

Intelligent Playback:

Taking off the earphone when playing music, the music being played will automatically pause , and when you put on the earphone again, the music will play automatically.

Line-In Music Playing:

Use a 3.5mm to Type-C audio cable to connect headphones with mobile phones. computers and other devices to play music. Note: The headset must be turned off when using this feature. (This product does not give away audio cable, if necessary, please purchase audio cable through Bluedio official store)

Line-out Music Playing

First, connect the headphone No. 1 with the mobile phone via Bluetooth, then turn off ANC feature, and use the 3.5mm to Type-C audio cable to connect the headphone No. 1 with the headphone No. 2 to play music.

Note: ANC must be turned off when using the above feature. Headset No. 2 must support a 3.5 connector. (This product does not give away audio cable, if necessary, please purchase audio cable through Bluedio official store)

Charge Headset

Turn off the headphones before charging, and use the standard charging cable to charge. When charging, the red indicator will be on all the time. It takes 2 hours for the headphone to be fully charged, and the blue indicator will be on after it is fully charged.

Web services

This product supports web-services. Users can turn to the last page of the manual and scan the QR code with their mobile phones to download APP.

Wake – up web services (Mobile Phone Installed with APP)

When both the mobile phone and APP are connected to the headset is Bluetooth, double-click the multifunctional key of the headset or tap the right shell of the headset twice to wake-up the feature, and then use the web-services feature and enjoy intelligent services.

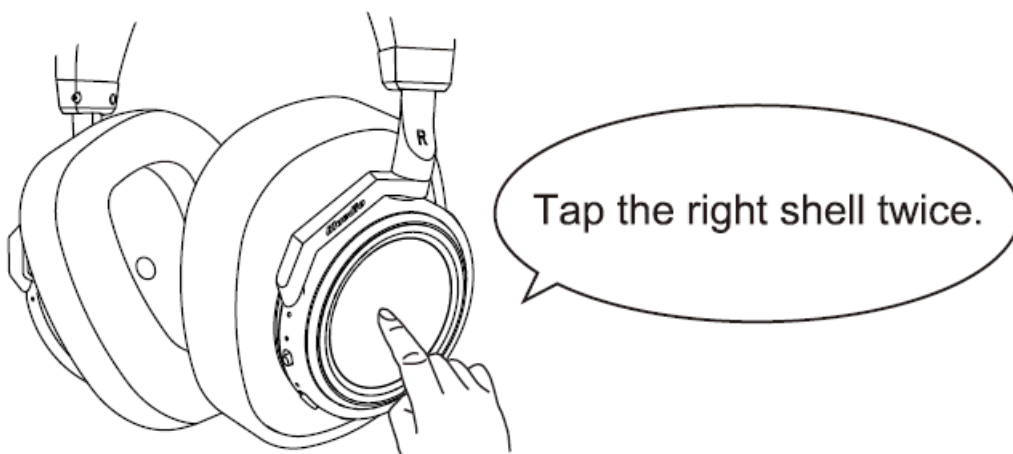

Product Anti-forgery

Scrape off the anti-forgery sticker coating on the packaging box to obtain the anti-counterfeiting number of the

product, then log on to the official website of www.bluedio.com and type-in the anti-counterfeiting number to check the authenticity of the product.

Consultation and Assistance

Please log on to www.bluedio.com to inquire about the relevant information and technical support of the product. If necessary, please send an email to aftersales@bluedio.com or call the after-sales hotline 400 – 889 – 0123.

Technical specifications:

Bluetooth Version: Bluetooth 5.0

Working Range: up to 10 meters (free space)

Frequency Range: 2.4GHz-2.48GHz

Support profiles: A2DP, AVRCP, HSP, HFP

Driver Unit: 57mm

Noise-cancellation Sensitivity: -25dB

Impedance: 160

Frequency Response Range: 20Hz-20KHz

Sound pressure level(SPL): 115dB

Standby Time: about 1000 hours

Music / Talk Time: about 30 Hours

Working time(For Only Running the ANC): about 40 hours

Charging time: about 2 hours

Operating temperature range: – 10 °C – 50 °C

Input Voltage / Current: 5V / > 500mA

Output Power: 50mW*50mW

[Bluedio T7 User Manual](#)

[Download](#)

Questions about your Manual ? Post in the comments!

Related Posts



[Bluedio BL User Manual](#)

USER MANUAL Bluetooth audio music Receiver 3.5mm Audio Stereo Cable Model: Bluedio BL We appreciate your choice of...



[Bluedio T-talking User Manual](#)

USER MANUAL Model: Bluedio T-talking Press and hold MF button to enter into paring Mode Tum on Bluetooth...

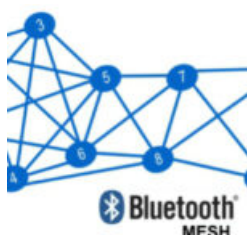

[Bluetooth Mesh Networking User Manual](#)

Bluetooth Mesh Networking User Manual - Optimized PDF Bluetooth Mesh Networking User Manual - Original PDF

[Bluedio TN User Manual](#)



User Manual Headset Overview Operation instructions Power On: When the headset is off, press and hold the MF...