

Bluedio T-Elf User Manual

[Home](#) » [Bluedio](#) » Bluedio T-Elf User Manual 

User's Manual

Model: T-Elf

Structural Sketch

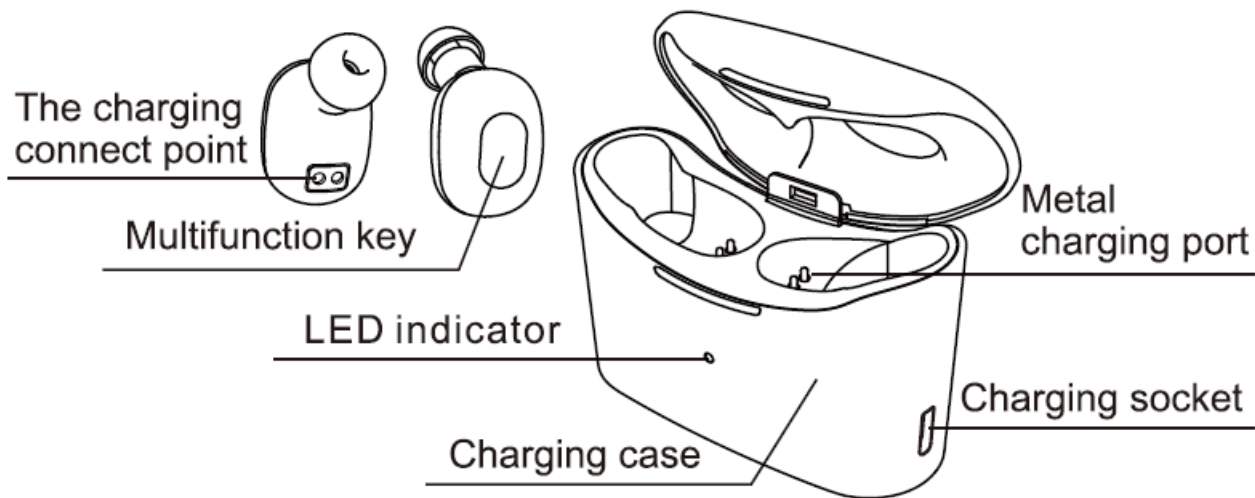

T Elf edition tips:

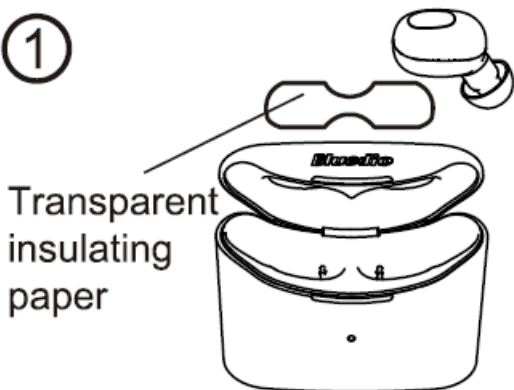

Tips: before using for the first time, remove the transparent insulating paper under the headphones, then put the headphones back into the charging box for normal use.

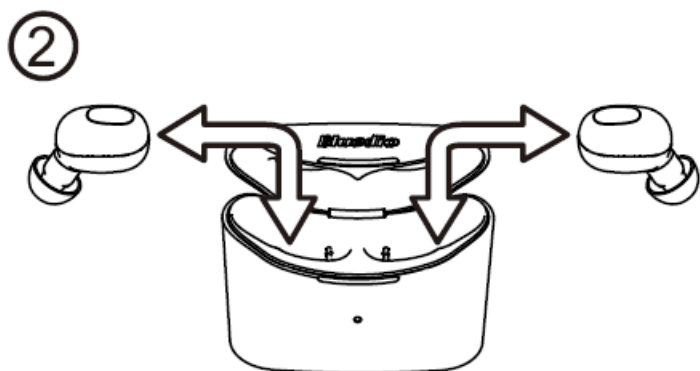

When a single unit is low in power, you can put the two units into the charging box and fully charge them, and then restore the two units for normal use.

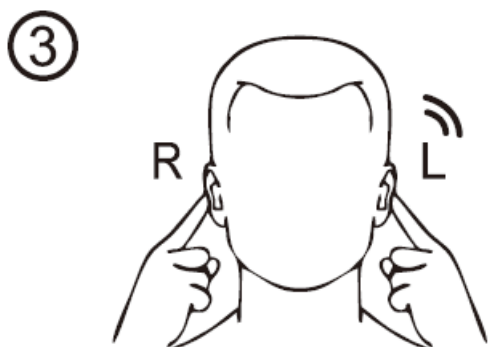

T Elf edition is intelligently paired and the one with the prompt tone is the left-hand channel which can be used separately for the main ear set, such as, driving and calling.

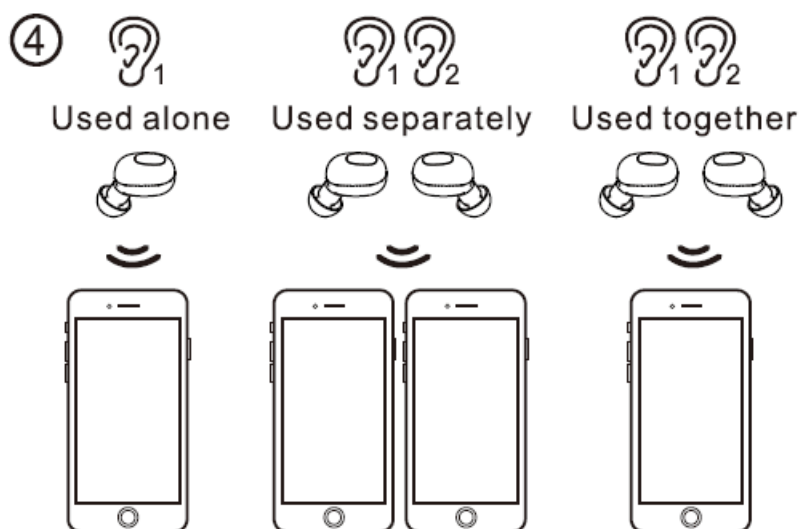

The two headsets are paired with different mobile phones and can be used separately. When two headsets are paired with the same mobile phone, the one with the prompt tone can be used alone.

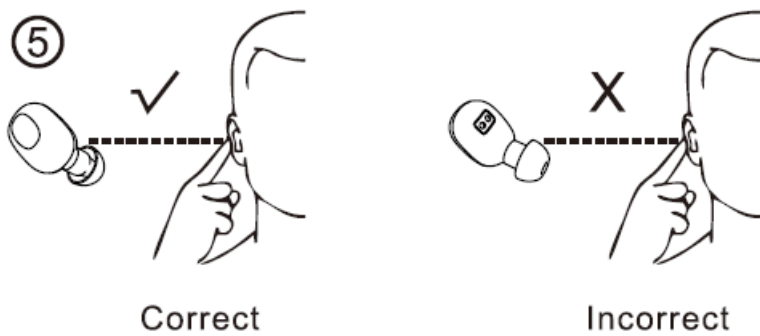

When it Wearing Properly, It will not drop when exercising, and the sense of hearing is batter.

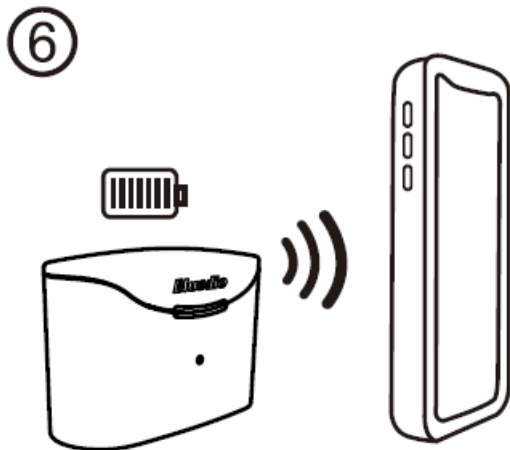

When the headset is fully charged in the charging box, it will reconnect automatically. if you do not want to reconnect it, you can tum off the mobile phone Bluetooth when charging, so as not to affect the alarm clock and other functions.

Instructions for use:

Power on: open the charging box cover or press and hold the multi-function button.

Power off: put the headset back in the charging box, close the lid or press and hold the multi-function button.

Bluetooth pairing: after the headset is turned on, start the phone Bluetooth and search "T Elf" and click on the connection.

Music control: click the multi-function button to control music pause/play.

Call control: click the multi-function button to answer/ hang up the call; long press the multi-function button to reject the call.

Last radial: press the multi-function key twice.

Voice assistant: press and hold the multi-function button for a second and release it when hearing "clanging".

Charging

Headset charging: put the headset back in the charging box and close the lid. When charging, the charging box blue light is turned on, and when it is fully charged, the blue light is turned off.

Charging In the charging box: when charging, the green light of the charging box is turned on for long time, and the green light is turned off when it is fully charged.

The red light flashes on the charging box: it indicates that the battery is low and needs to be charged.

The left and right headsets clear the pairing information:

If only one headset has sound or the other headset is not connected, please make the following operations separately for the two headsets :

1. Press and hold the multi-function button until the headset is turned off.
2. Press and hold the multi-function button until the headset is turned on. When you hear the pairing tone, release the button, press the multi-function button for three times and the headset will automatically turn off.
3. Put the two headsets back into the charging box and close the box and clear the pairing information.
4. Open the cover of the charging box and activate the Bluetooth function of the mobile phone to make a pairing connection.

Technical Specifications

Bluetooth version: 5.0

Frequency range: 2.4 GHz-2.48 GHz

Support protocols: A2DP, AVRCP, HSP, HFP

Frequency response range: 20Hz-15KHz

Standby time: about 1000 Hours

Music/Call Time: About 7 Hours

Charging time: About 1 hour for earphone and 2.5 hours for charging case

Input voltage/current: 5V/>100mA

Output power: 7mW + 7mW

Contact Us

www.bluedio.com

400-889-0123

aflersales@bluedio.com

[Bluedio T-Elf Manual](#)

Download

Questions about your Manual ? Post in the comments!