

bluebuilt 933696 DisplayLink Docking Station Pro with USB C



bluebuilt 933696 DisplayLink Docking Station Pro with USB C Instruction Manual

[Home](#) » [bluebuilt](#) » bluebuilt 933696 DisplayLink Docking Station Pro with USB C Instruction Manual 

Contents

- 1 blue built 933696 DisplayLink Docking Station Pro with USB C
- 2 Product Overview
- 3 PRODUCT OVERVIEW
- 4 CONNECTING THE DOCKING STATION
- 5 EXPLANATION OF THE PORTS
- 6 DECLARATION OF CONFORMITY
- 7 SAFETY INSTRUCTIONS
- 8 Documents / Resources
 - 8.1 References



blue built 933696 DisplayLink Docking Station Pro with USB C



Product Specifications

- **Input:** 22V5.9A 129.8W
- **Cable input:** 20V5A 100W
- **Adapter input:** 100-240V~ 50/60Hz 2.5A
- **Adapter output:** 22V5.9A 129.8W

Product Overview

The DisplayLink Docking Station Pro with USB-C provides multiple connectivity options for your devices.

- On/off button
- USB-C 3.1
- Audio port (3.5 mm)
- SD/microSD card slots
- USB Type-A 3.1 ports (max. 10 Gbps)

Connecting the Docking Station

1. Connect the docking station to power using the DC adapter.
2. Use the on/off button to start the docking station.
3. Connect your laptop to the USB-C Power Delivery port for charging.

Explanation of the Ports

The ports on the docking station serve various functions:

1. USB-C port for connecting compatible devices.
2. Audio port for headphones or speakers.
3. SD/microSD slots for reading memory cards.
4. USB Type-A ports for connecting peripherals like a mouse or keyboard.

FAQ

- **Q: Can I connect multiple screens to the docking station?**
 - **A:** Yes, you can connect up to two screens simultaneously via the HDMI ports or DisplayPorts.

PRODUCT OVERVIEW

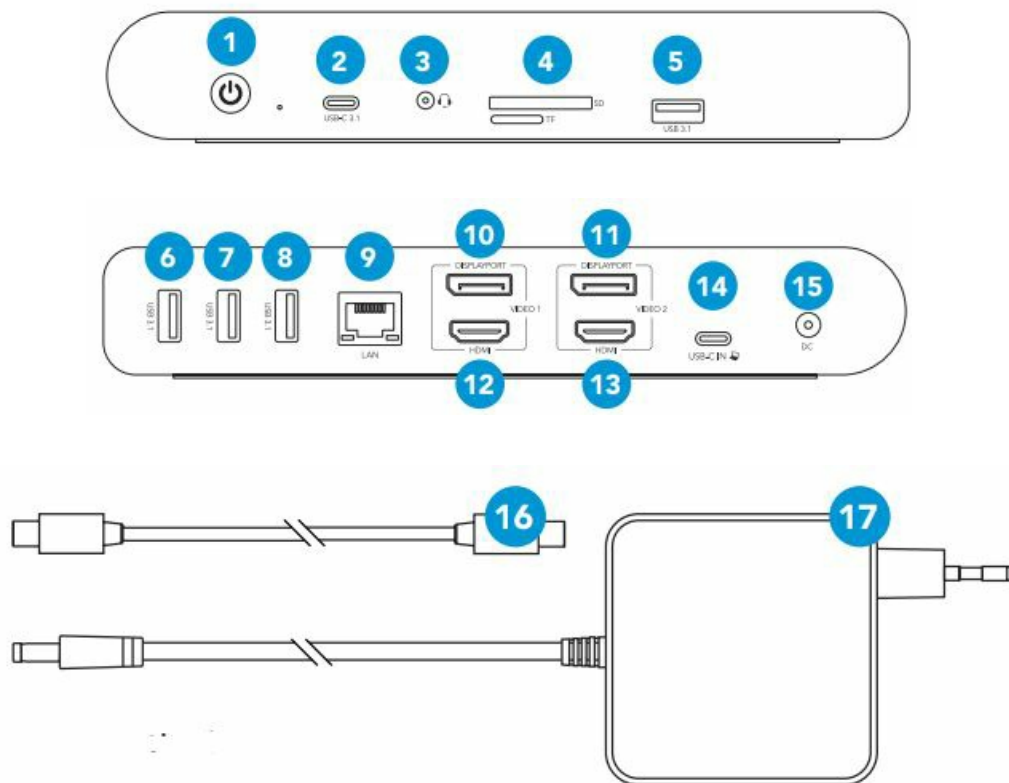

1. On/off button
2. USB-C3.1
3. Audio port (3,5 mm)
4. SD/ microSD (SD/SDHC/SDXC, microSD/HC/XC)
5. USB TYPE-A 3.1 (max. 10 Gbps)
6. USB TYPE-A 3.1 (max. 10 Gbps)
7. USB TYPE-A 3.1 (max. 10 Gbps)
8. USB TYPE-A 3.1 (max. 10 Gbps)
9. LAN/ethernet (10/100/1000 Mbps)
10. Display Port (max. 3840 x 2160, 60Hz)
11. DisplayPort (max. 3840 x 2160, 60Hz)
12. HDMI (max. 3840 x 2160, 60Hz)
13. HDMI (max. 3840 x 2160, 60Hz)

14. Power Delivery (20V, max. 5A, 100W)
15. External DC power (22V, 129.8W)
16. USB-C to USB-C cable
17. DC adapter (22V, 129.8W)

CONNECTING THE DOCKING STATION

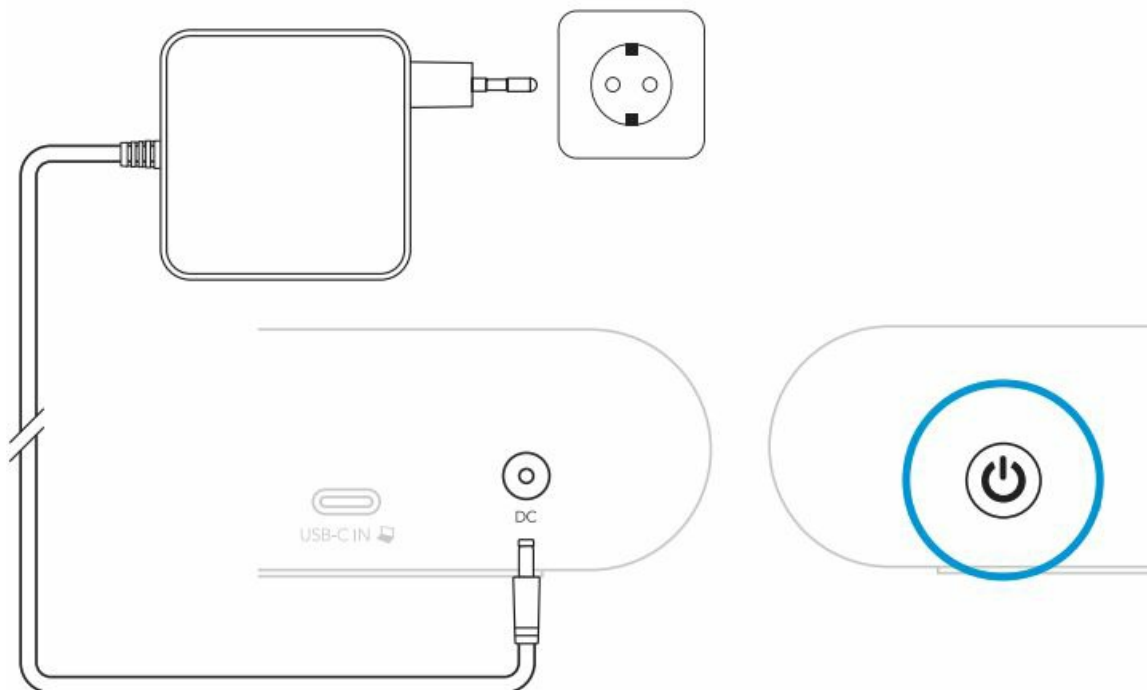

Connect the docking station with the DC adapter 17 to the power grid.

Use the on/ off button to start the docking station 1.

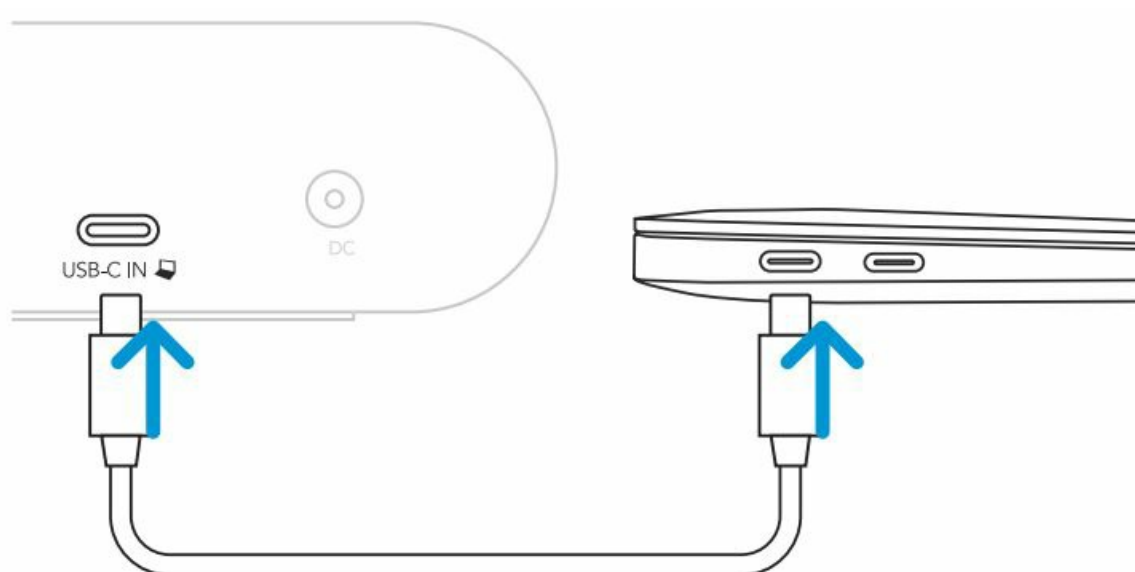

Connect your laptop to the USB-C Power Delivery port 14.

Charging your laptop via the docking station only works if your laptop supports Power Delivery (PD) or Thunderbolt 3 or 4 technology. View the manual of your laptop for more information.

EXPLANATION OF THE PORTS

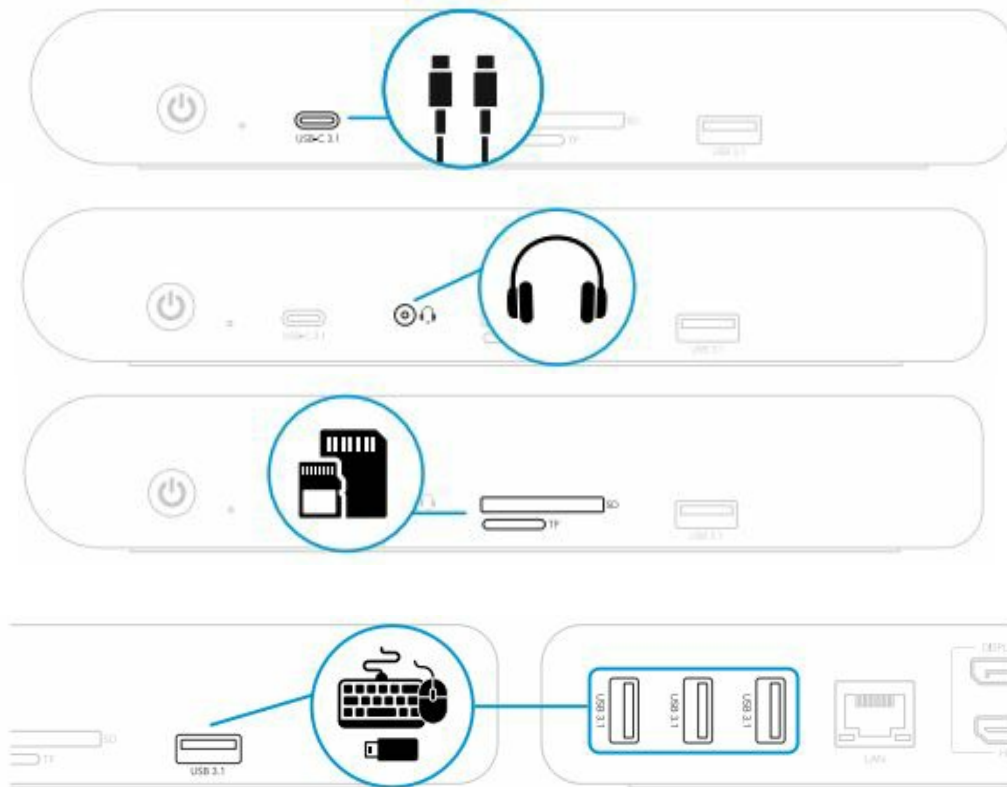

- Connect a device with USB-C, such as a data cable 2.
- Connect a device with a 3.5mm jack, such as headphones 3
- Place an SD or microSD card in the (micro) SD slot to read your data 4.
- Connect a USB device, such as a mouse, keyboard, or USB flash drive 5/6/7/8.



- Connect an Ethernet cable to the Ethernet port 9. The docking station supports a speed of up to 1000Mbps. To reach this speed, you use a Category 5e (CatSe) Ethernet cable or higher.

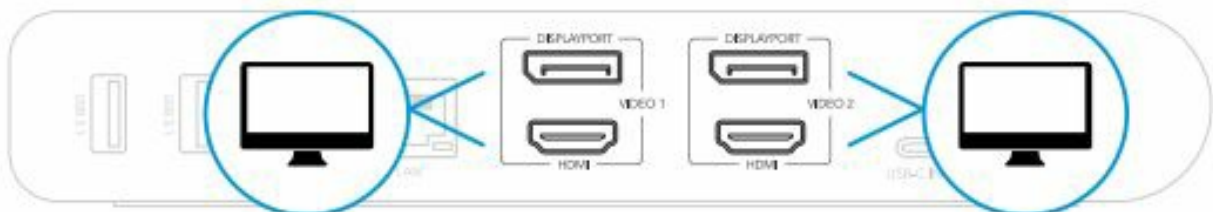

- Connect up to two screens simultaneously via the HDMI ports or DisplayPorts.



- You can only achieve the maximum resolution of 4K at 60Hz if your laptop supports Display Port 1.4 via alternate mode via the USB-C port and if you download the DisplayLink® software. Scan the QR code for the right program. For more information, check the manual of your laptop.
- **Note:** the docking station only works with HDMI or DisplayPort cables. HDMI to Display Port cables are not suitable.
- Connect up to two screens simultaneously via the HDMI ports or Niclaw Ports

DECLARATION OF CONFORMITY

PRODUCT SPECIFICATIONS

- **Input:** 22V –5.9A 129.8W
- **Cable input:** 20V –5A 100W
- **Adapter input:** 100-240V- 50/60Hz 2.5A
- **Adapter output:** 22V -5.9A 129.8W

SAFETY INSTRUCTIONS

1. Always follow these instructions and note the warnings, save this document for future use as long as you own or use the device, and give it to the next users of the device.
2. Make sure you read and understand the entire manual before you use the device.
3. Use the device only in the application for which it is intended, namely as a device for charging laptops and/or connecting them to other devices and/ or peripherals.
4. Before you connect a device, check if the output power of the charger provides enough power for the connected device.
5. Don't expose the device to extreme heat, like sunlight or fire. Avoid sudden temperature shifts.
6. Don't use or use the device in moist or wet conditions.
7. Don't use the device close to explosive gasses or flammable materials.
8. Don't burn the device.
9. Avoid contact with the chemicals of the battery. When the chemicals of the battery come into contact with the skin or the eyes, stop using the device right away, use plenty of water to rinse off the chemicals, and contact a doctor.
10. Don't throw, shake, vibrate, drop, or mechanically misuse the device and don't expose it to impacts.
11. Don't cover the device with objects that affect the heat dispersal.
12. Only use the device with the included cables or with cables that came with the device. Don't use the device when the included cables are damaged or have gotten damaged over time.
13. Disconnect the device when it's not in use. Don't charge or discharge the device unsupervised.
14. Keep the device away from children.
15. Don't disassemble, open, or repair the device.
16. Only clean the device with a damp cloth with water. Don't use (aggressive) cleaning agents.
17. This device can be used by people with reduced physical, sensory, or mental capacity, or by people without experience and knowledge, given that they're supervised or have gotten instructions about safe use of the product and understand any dangers.

WARRANTY AND LIABILITY

This device comes with a warranty period of five (5) years after the date of purchase. For more information about the warranty terms and conditions go to <https://www.coolblue.nl/en/customer-service>. Coolblue B.V. can in no way be held liable for material and immaterial damage suffered by you, others, the device, other property, or the property of others due to non-compliance with the instructions in this manual.



■ This symbol on the product indicates that it can't be treated as regular waste, but that it's supposed to be collected separately. Hand the product in at a collection point for the recycling of electronic devices if you live in the EU or in a different European country that has a separate collection system for electronic devices. If you correctly dispose of the product, you help to avoid risks for the environment and public health which might arise by the mishandling of disposed devices. Recycling materials contributes to the maintenance of our natural resources.

Turn over for use

Input in Volt, Ampere and Watt	22V$\overline{=}$5.9A 129.8W
Standby current	$\leq 3.5\text{w}$
Weight	445\pm10g
Dimensions	208 x 82.8 x 34 mm
Housing material	Aluminium, ABS
Operating temperature	0°C ~ 40°C
Storage temperature	-10°C ~ 70°C
Electrical class I, II or III	II (adapter)

BlueBuilt is a registered trademark of Coolblue B.V., Weena 664, 3012 CN Rotterdam, The Netherlands.



[bluebuilt 933696 DisplayLink Docking Station Pro with USB C](#) [pdf] Instruction Manual
933696 DisplayLink Docking Station Pro with USB C, 933696, DisplayLink Docking Station Pro
with USB C, Docking Station Pro with USB C, Station Pro with USB C, Pro with USB C, with US
B C, USB C

References

- [Coolblue Klantenservice - Coolblue - alles voor een glimlach](#)
- [User Manual](#)

Manuals+, Privacy Policy

This website is an independent publication and is neither affiliated with nor endorsed by any of the trademark owners. The "Bluetooth®" word mark and logos are registered trademarks owned by Bluetooth SIG, Inc. The "Wi-Fi®" word mark and logos are registered trademarks owned by the Wi-Fi Alliance. Any use of these marks on this website does not imply any affiliation with or endorsement.