



Blogole B30 Dash Camera User Manual

[Home](#) » [Blogole](#) » Blogole B30 Dash Camera User Manual 

Contents

- 1 Blogole B30 Dash Camera
- 2 PRODUCT OVERVIEW
 - 2.1 Main features
- 3 WHAT'S IN THE BOX
 - 3.1 CAMERA OVERVIEW
- 4 CAMERA INSTALLATION
 - 4.1 Install the front camera
 - 4.2 Install the Rear Camera
- 5 FORMATTING THE MEMORY CARD
- 6 STARTING VIDEO RECORDING
- 7 ICON INTRODUCTION
- 8 Parking Monitor
- 9 Files Browser
- 10 USING THE “JARVISCAM” APP
- 11 SPECIFICATIONS
- 12 FQA
- 13 FCC Warning
- 14 Documents / Resources
- 15 Related Posts

Blogole

Blogole B30 Dash Camera



For any inquiries about Blogole products, please feel free to contact us.

Email: support01@blogolestore.com

PRODUCT OVERVIEW

Main features

1. Secure 3M adhesive windscreen mount provides easy installation and vertical adjustment to match the glass angle. (No rubber suction cup to fall off the windscreen and cause vibration.)
2. Ultra-wide angle lenses (150° horizontal field of view) paired with the new Sony Starvis sensors for superior nighttime video quality and reduced motion blur on both front and rear views.
3. 4K Front view and 1080p Full HD resolution on rear view!
4. Super-capacitor power supply, avoids reliability and safety problems with lithium batteries swelling/failing in high summer temperatures.
5. In addition to the built-in setup menu and playback modes, Wi-Fi and app support provide setup, playback, and video clip download to iPhone and Android devices.
6. Loop recording ensures the camera never stops recording, and a G-sensor ensures important video clips do not get overwritten.
7. Large, easy-to-read LCD monitor with setup menus, video playback, live view, and screen saver function.
8. Optional hardwire kit (separate purchase) with parking mode function, provides a recording of video clips while parked when triggered by the G-sensor detecting an impact.
9. Micro SD memory card (64GB included), supports capacity up to 256 GB .
10. Video playback function built into the camera, It is more conveniently viewed via phone app.

WHAT'S IN THE BOX



B30 Dash Cam



waterproof Rear Camera



GPS Bracket
(Only GPS version with)



Car Charger



3M Adhesive Tape for Front Camera



Windshield Sticker



64G SD Card



Manual

CAMERA OVERVIEW

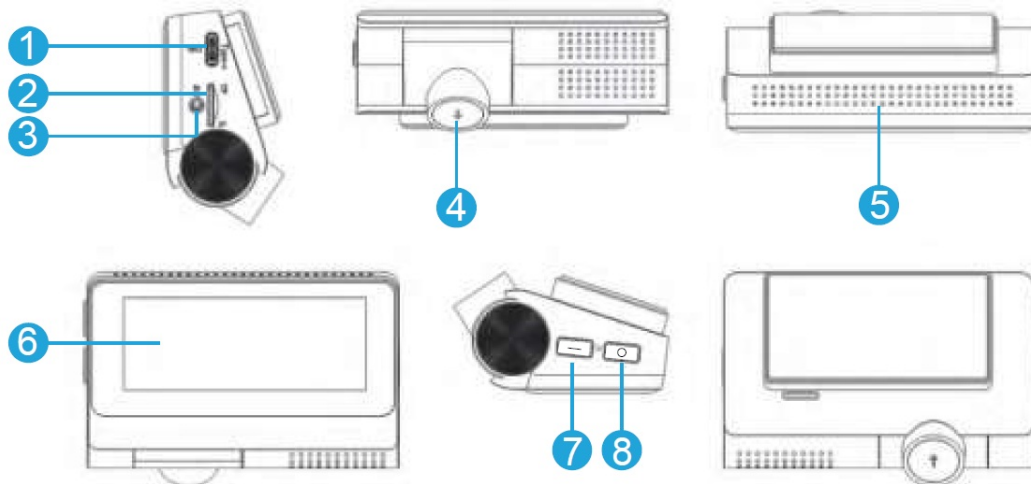

1. Tepe C USB Port
2. SD Card Slot
3. Rear Camera IN
4. Front Camera
5. Speaker
6. Touch Screen
7. Short press the button:
 1. Toggle screen view front cam only/rear cam only/Front+ rear overlaid
 2. Turn on/off the screen.
 Long press the button: Reset dashcam factory default settings.
8. Short press the button: move the option box.

Long press the button: equivalent to the confirmation button, you can enter the selected icon.

CAMERA INSTALLATION

Install the front camera

1. Insert a memory card into the camera card slot.
(For the first time use, please format the memory card first)



2. Slide the mount horizontally into the slot on the back of the camera.



3. Select a location on the windshield, just a little below the rearview mirror. The front lens needs to look through the area swept by the windshield wipers.

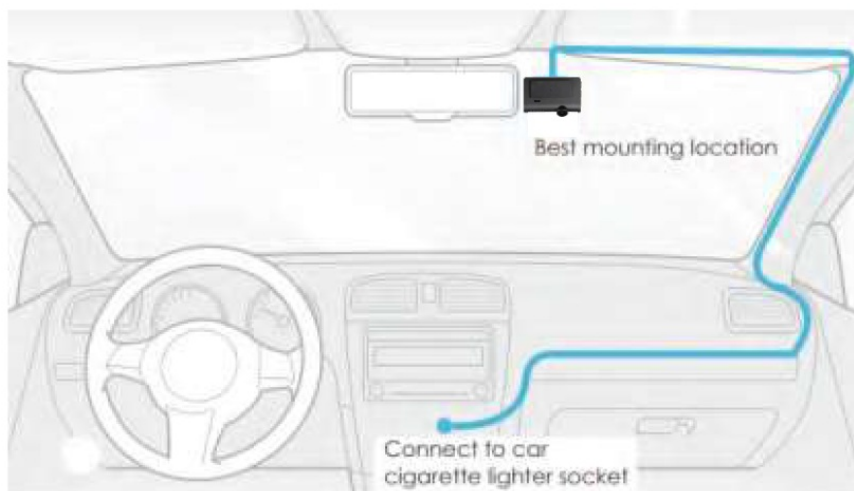

4. Wipe clean the chosen area of the windshield with a dry cloth; it must be completely grease free for the sticky pad to stick securely. Use detergent or an alcohol-based wipe to remove any grease.

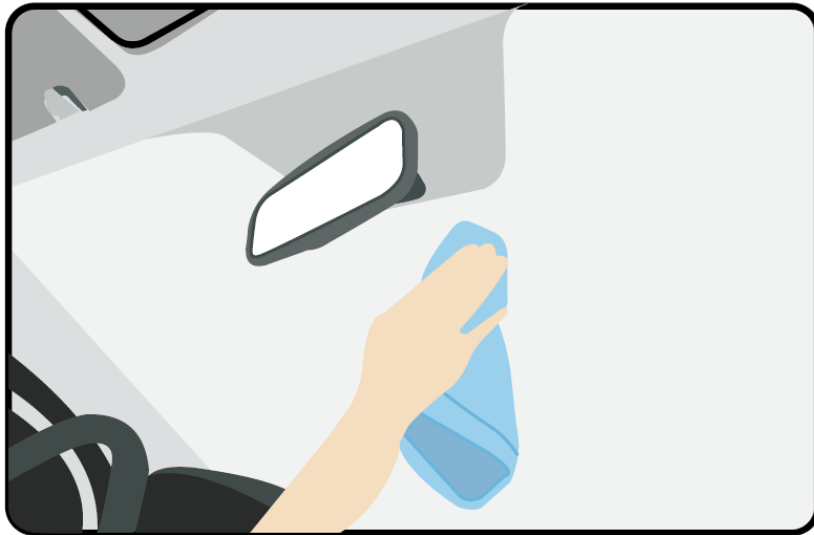

5. Peel the protection film off the 3M adhesive pad and the protection film of the camera lenses.
6. Fix the camera on the selected location; make sure the camera lenses is vertical before contact between the adhesive and windscreen. Push the mount firmly against the glass for 10 seconds for a good bond, the strength of the bond will increase over the first few days.

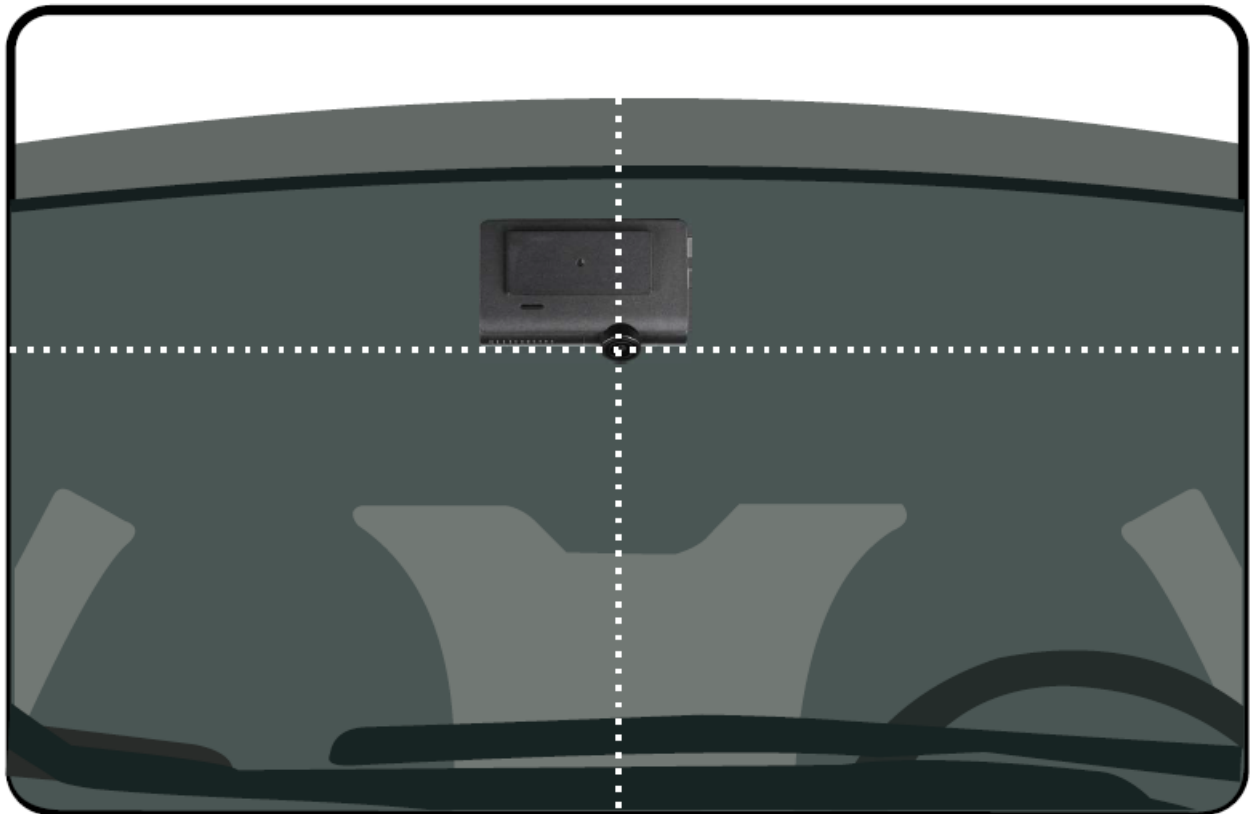

Install the Rear Camera

- Position 1: Install the rear camera on the rear windshield. The installation is easier.



- Position 2: Install the rear camera near the license plate.



7. Plug the USB charger into the car's 12V DC accessory/cigarette lighter socket.
8. Adjust the lens angle
Adjust the angle of the lenses up/down by rotating lens units if necessary.



FORMATTING THE MEMORY CARD

Please format your memory card in the camera before using this dash cam and use a high-speed memory card of Class10 or higher.

1. Tap the Format icon to enter the Format page.
2. then tap the "OK" icon. Wait a few seconds to finish the formatting and the system will exit automatically.

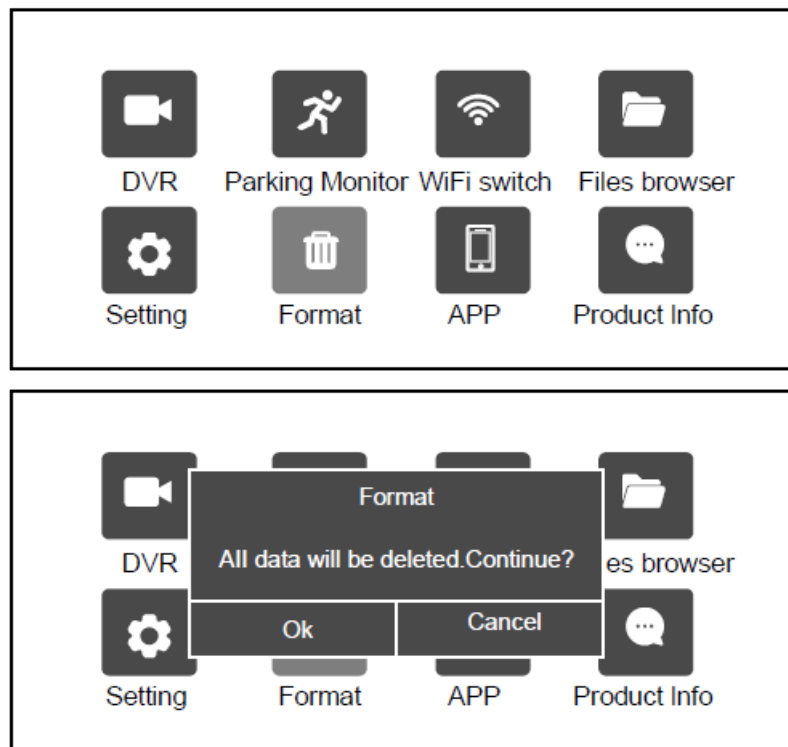

STARTING VIDEO RECORDING

1. After finishing formatting, connect a car charger and start the car engine, the device will automatically turn on and begin recording.
2. Loop recording is already enabled on the B30 dash cam, the default setting is 1 min.
3. G-sensor is already enabled on the B30 dash cam, the default setting is Middle. If an impact or sudden braking is detected, it will automatically start recording and lock the video.

ICON INTRODUCTION

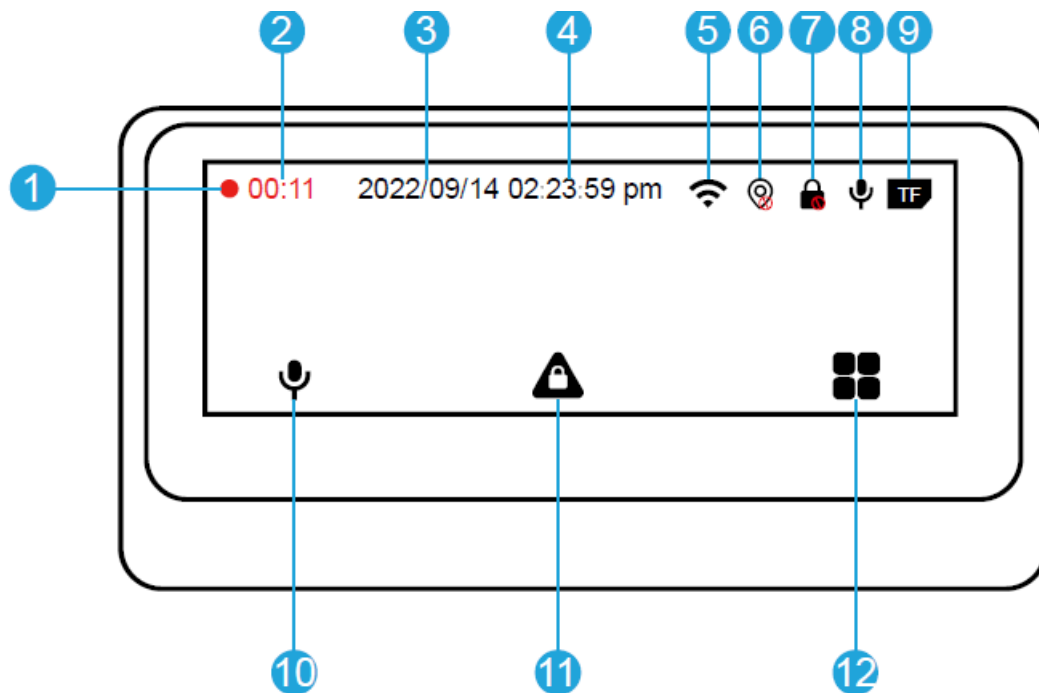

1. Recoding Indicator

2. Video Time
3. Date
4. Time
5. WiFi Indicator
6. GPS (GPS failed/GPS received)
 - This menu is active only after plugging in an extra GPS module!
7. Video lock Indicator
8. Microphone Indicator (mute/unmute)
9. SD Card Indicator
10. Audio Record (Mute/Unmute)
11. Video lock/Unlock
12. Menu Settings

Parking Monitor

Parking Mode

Requires connection Hardwire Kit, not included

Parking mode I — Time-lapse Recording mode

The dash cam records continuously in low-bit-rate recording mode 12/24 hours a day in parking mode, which greatly saves memory space and provides a safer parking environment for your car.

Note: In parking mode, the screen will not display and the working indicator will be flickering while the recording is in progress. Touch this screen, the screen will light up.

Parking mode II — G-sensor Triggered Recording mode

In parking mode, if an impact is detected by the G-sensor then the camera starts video recording again automatically to record the incident 20s .

Files Browser

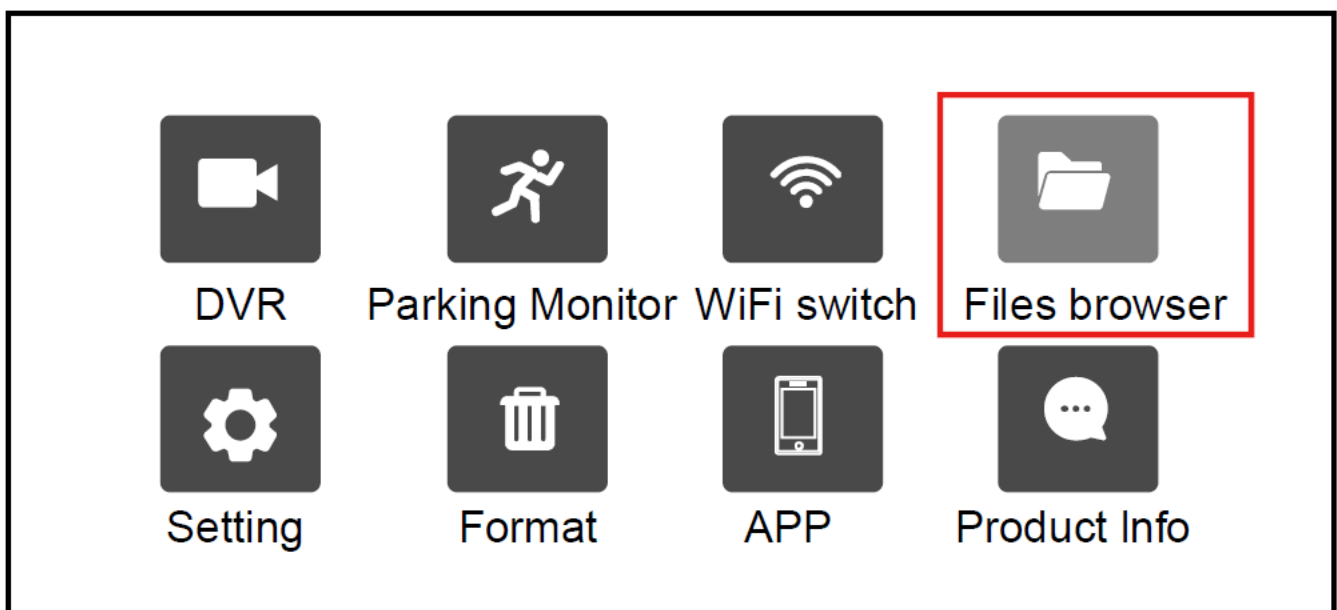

Normal Files: The files recorded by the dashcam cycle will be saved here. When the memory card is full, the new files will cover.

Lock Files: When the sensitivity mode is turned on, if an impact or sudden braking is detected, the dash cam will automatically start recording and saving content. The videos will be locked and saved here, which never be overwritten by new files.

Photo: The Photo taken by the dashcam will be saved here. When the memory card is full, the new Photo will cover.

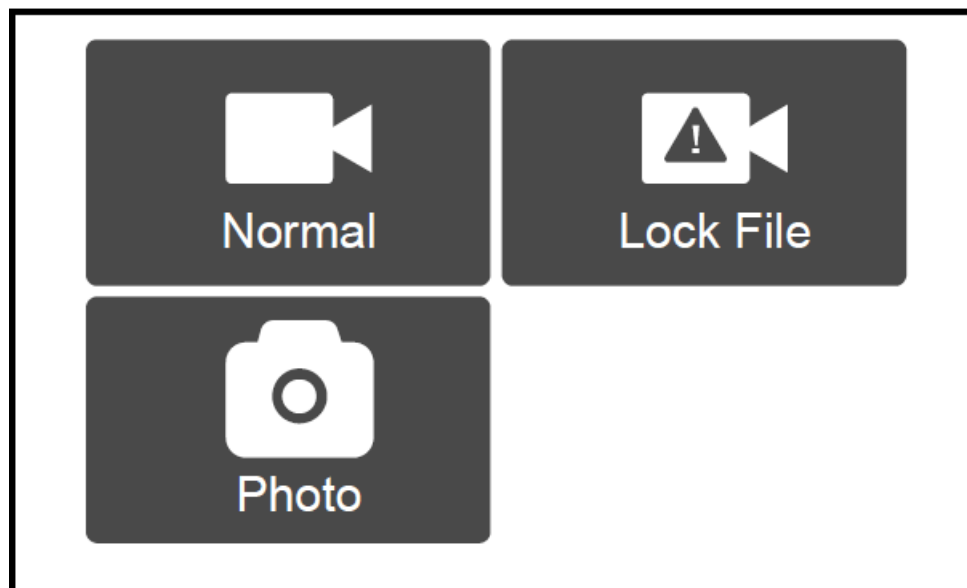

You can switch/delete the files saved by the front and rear cameras according to needs.

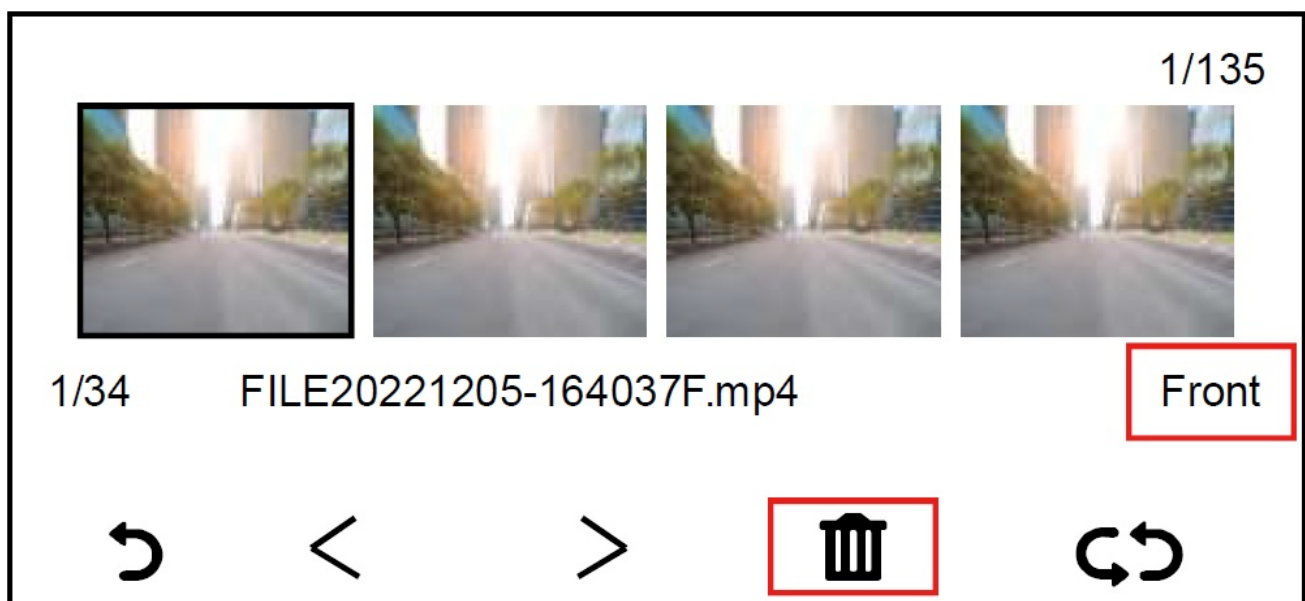

Setting

1. Language

- Options: English /Français/España/
- Default Setting: English

2. Screen Saver

The screen will be turned off automatically after the time you set. After turning it off, the screen will reduce power consumption. The camera still works while the display screen is turned off.

Just click the screen and it will turn on.

Options: Off/1MIN/3MINS

Default Setting: Off

3. Date time/Set Time

Set the date and time manually.

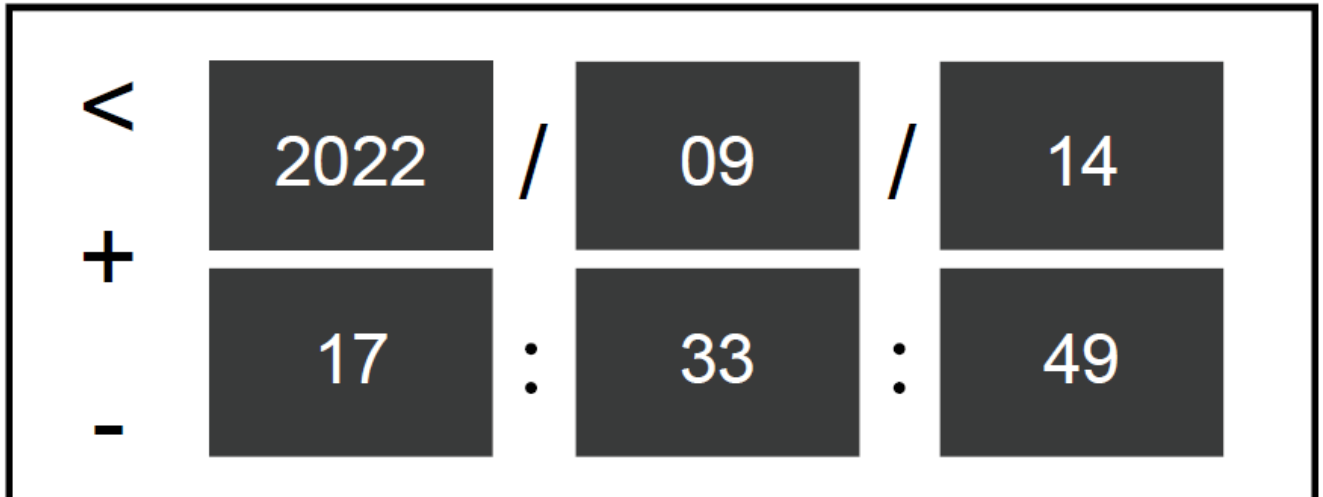

4. Volume

Adjust the volume in the playback video.

Options: Mute/Low/Middle/High Default

Setting: Middle

5. Click Tone

Options: On/Off

Default Setting: On

6. Time Format

Set the format you prefer. Options: 12/24H Default Setting: 12H

7. Time Zone This menu is active only after plugging in an extra GPS module!

Sets the current time zone and Daylight Savings offset if required for GPS time and date synchronization.

Noan extra GPS module!

Sets the current time zone and Daylight Savings offset if required for GPS time and date synchronization.

Notes:

The default time zone is GMT-0 London city. Set your local time zone, for example, GMT -8 Los Angeles. tes:

The default time zone is GMT-0 London city. Set your local time zone, for example, GMT -8 Los Angeles.

8. GPS Info This menu is active only after plugging in an extra GPS module!

The Dash Cam needs to be in an outdoor environment with a good signal so that the GPS can locate it.

9. GPS Timer Setting This menu is active only after plugging in an extra GPS module!

Default Setting:

Turning on means that the Dash Cam can synchronize the satellite time when the GPS search is normal;

turning off means that the Dash Cam is based on the manually set time and does not synchronize the GPS satellite time.

10. Speed Unit This menu is active only after plugging in an extra GPS module!

Options: km/h and mph

Default Setting: mph

11. Daylight saving time (DST)

The default setting is OFF; you can turn on DST as needed. After turning on DST, the time zone will add 1 to adjust to daylight saving time;

12. Frequency

Frequency: 50Hz | 60Hz

Default Setting: 60Hz

This option should be set according to the power supply specification used in your country or geographical region.

For example, USA users should select 60Hz, Europe 50Hz. Choosing the correct value will reduce flickering caused by incandescent/fluorescent lamps at night time. LED traffic lights may still flicker as these use different frequencies.

13. RearCam Mirror

A mirror image (in a plane mirror) is a reflected duplication of an object that appears almost identical but is reversed in the direction perpendicular to the mirror surface. As an optical effect, it results from reflection from substances such as a mirror or water.

14. RearCam Flip

A flipped image or reversed image, the more formal term, is a static or moving image that is generated by a mirror-reversal of an original across a horizontal axis (a flopped image is mirrored across the vertical axis).

15. Reset Setup

All settings will be restored to factory settings.

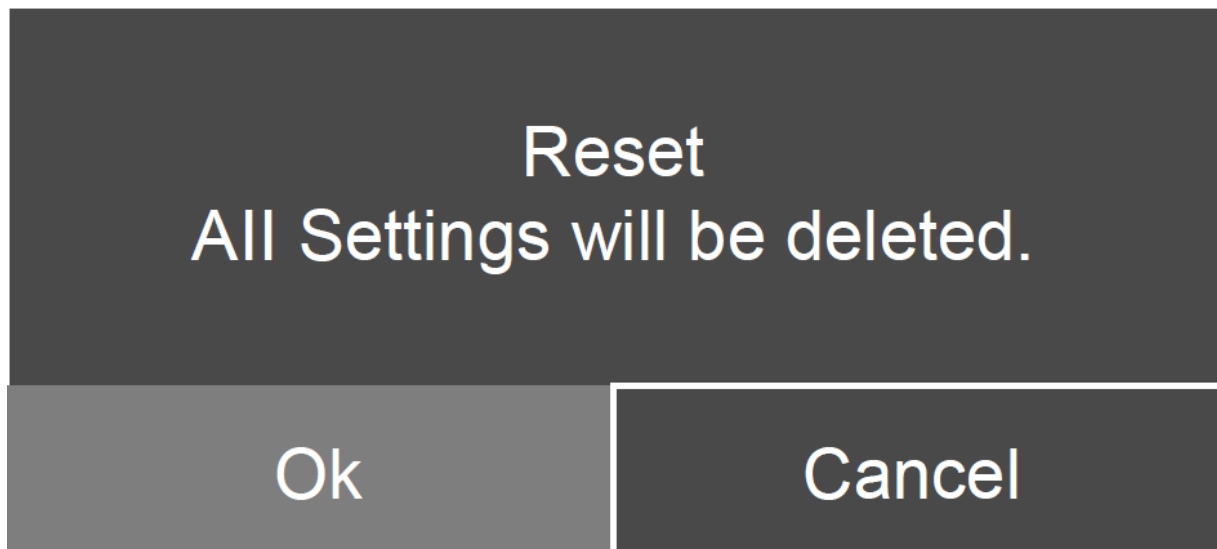

16. Video Resolution

You can choose the front camera resolution.

Options: 2160P/1440P/1080P

Default Setting: 2160P

The rear camera resolution is 1080P

17. Loop Recording

The files will be saved every 3 MIN if you choose the 3 MIN option. When the memory card is full, the new files will cover the old ones if the loop recording is on. If it is off, the camera will not record anymore when the card is full. You will then need to format the memory card or change it to a new one. Options: Off/1Min/2Min/3Min

Default Setting: 1Min

18. Sound Record

If turned on, the Dash Cam will record sound while recording. Default Setting: On

19. G-SENSOR/G-Sensitivity

When the sensitivity mode is turned on, if an impact or sudden braking is detected, it will automatically start recording and saving content. The videos will be locked and never be overwritten by new files. The higher the sensitivity level, the easier it is to trigger the emergency recording.

Options: Off/Low/Middle/High

Default Setting: Middle

DOWNLOAD THE APP

Download the “JarvisCam” app on the App Store or Google Play.



DOWNLOAD THE GPS PLAYER

GPS player download link : <http://www.gpsplayer.net/setup.html>



USING THE “JARVISCAM” APP

1. Stop video recording on the dash cam. Click the “Setting” icon
2. Tap the “WiFi” icon on the dash cam.

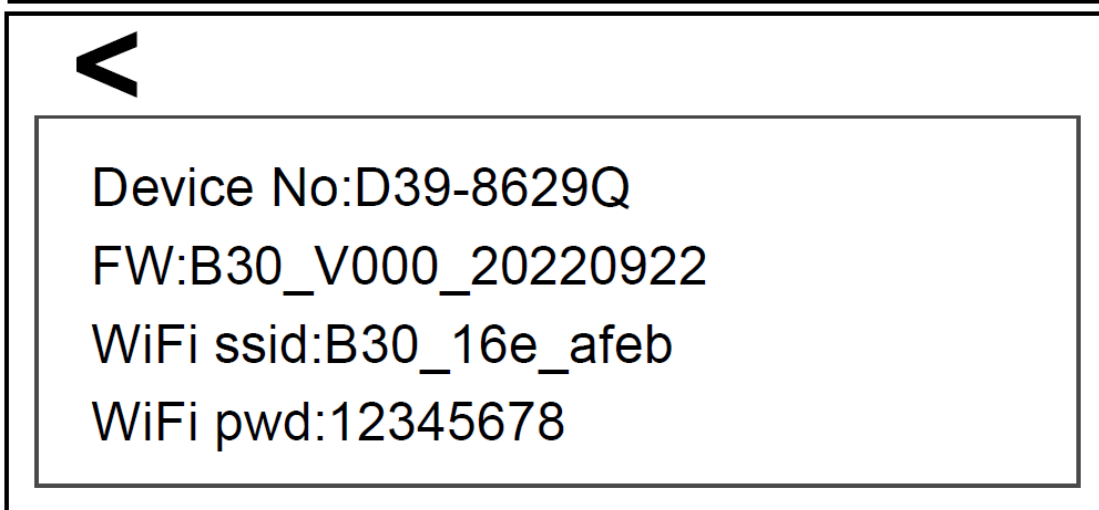
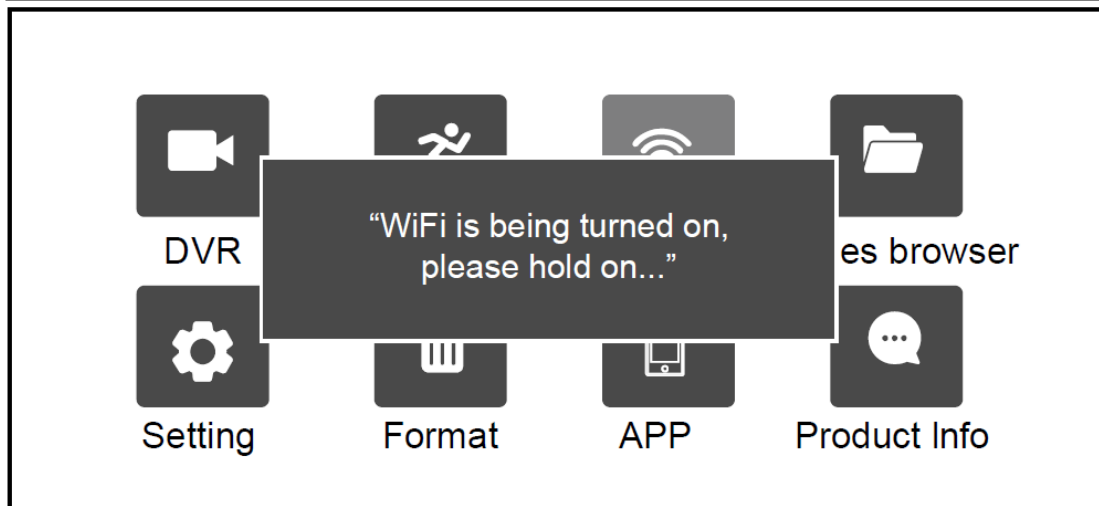
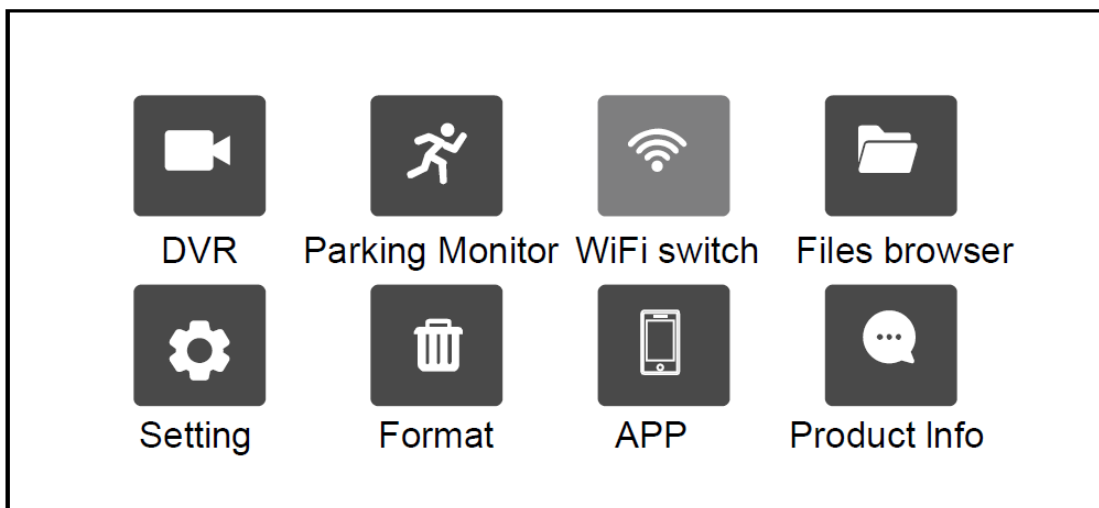

3. Go to your smartphone's WiFi settings and connect to the WiFi name "B30 xxxx". Enter the password "12345678" and confirm the WiFi network.
4. Open the "JarvisCam" app, tap "Connect Camera", and wait a few seconds to enter the preview interface.
5. Tap the video or photo icon to control the dash cam, either recording videos or shooting photos.

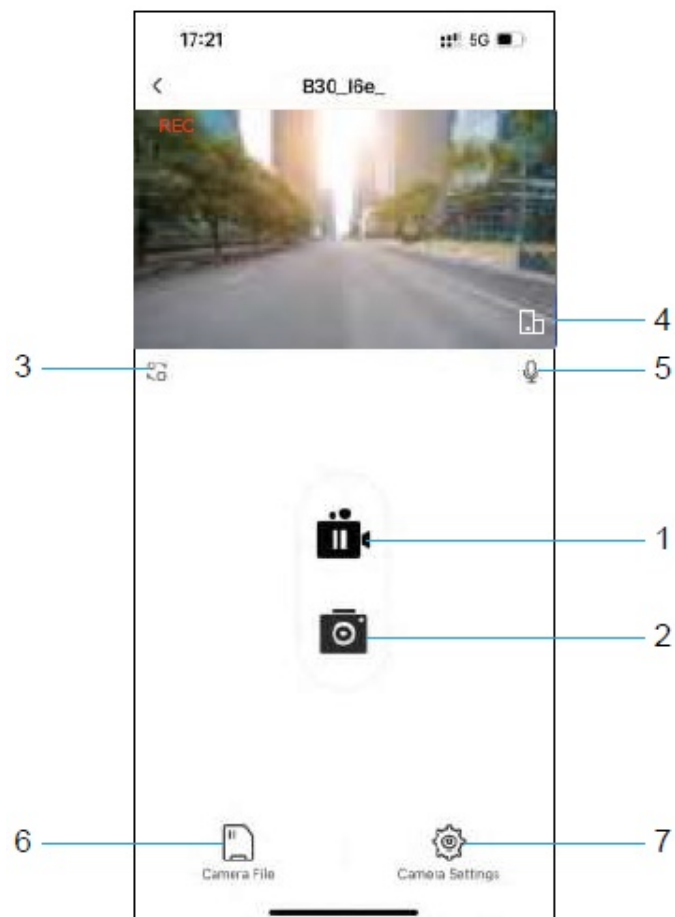

1. Tap the icon to stop/start the recording.
2. Tap the icon to take the photos.
3. Tap the switch icon to switch to the front or rear camera display.
4. Tap the icon to switch to full screen.
5. Tap the microphone icon to turn the microphone on/off
6. Tap the "Camera File" icon to choose the videos or photos that you want.
7. Tap the camera setting icon to set parameters
8. Tap the download or delete icon to download or delete.

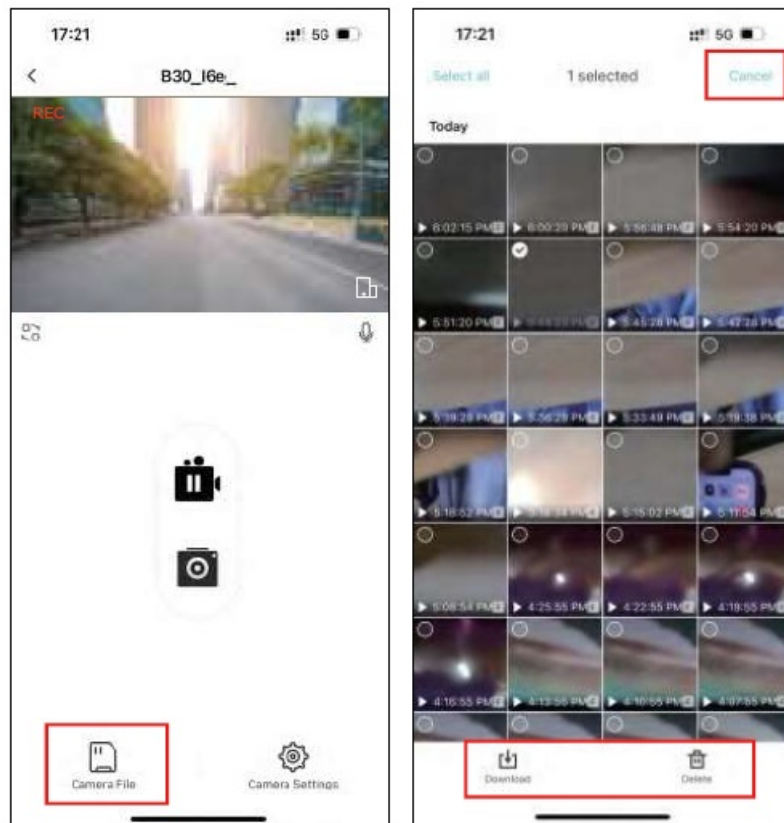

SPECIFICATIONS

- Front Camera: f/1.8, 150° FOV
- Rear Camera: f/2.0, 150° FOV
- Video: 4K+1080P@25fps/2.5k+1080P@30fps
- Screen: 3.18-inch IPS touchscreen
- Working Temperature: -20°C~60°C (-4°F~140°F)

If your dashcam does not appear to be working properly, please follow these troubleshooting steps:

1. The dash cam can't record.
 - Check whether your memory card has enough space. Please back up any important data to other devices first, and then format the memory card.
 - Check if the loop recording in the settings menu is set to OFF. Set "Loop Record" to 3 MINS.
2. When recording, it stops automatically.

At the time of recording, a large amount of high-definition video data is processed. Please use a high-speed memory card of Class 10 or higher.
3. A "File Error" prompt appears when playing back pictures and videos. Please use a genuine memory card. Please format the memory card.
4. The image is misty.

Ensure there are no fingerprints or other marks on the camera lens. Use a soft and dry cloth to clean the lens. Clean the front windshield.
5. Crashing

If your device crashes, use a sharp object to press the reset button to restart the device.
6. No sound on the video.

Ensure the audio recording mode is on.

7. The camera keeps turning on and off automatically. Please charge the camera with the included car charger.
Do not charge the battery via the USB data cable with other adapters.

FQA

1. The dash camera does not record.

Please use a high-speed microSD card (C10 or above).

If there is a card error, format the memory card in the camera or change it to a new card.

2. The dash camera does not loop record.

Check if the microSD card has enough free space, it may be full of locked files. All files can be deleted quickly by formatting the card in the camera.

3. A Document Error occurs when replaying photos or videos.

This can happen due to a bad-quality microSD card or a corrupted card format. Please format or replace the microSD card.

4. The video file is not clear.

Please check if the lens is clean, clean the lens with a soft cloth/lens wipe.

5. There are cross stripes or flickers in the recorded video. In the menu, set the frequency to "50Hz" or "60Hz" depending on the local electricity supply frequency.

6. What's the electrostatic sticker for? Does it just goes on the windscreen and the dashcam stick to it?

It sticks to your windshield without using sticky glue, then the adhesive mount can stick to it, which means that the mount can subsequently be cleanly removed from the windshield without leaving any sticky residue.

7. Why the dash camera cannot read the license plate number?

Video image and sound quality will vary depending on weather conditions, lighting conditions, vehicle speed, cleanliness of the windshield and camera lenses, etc. Also, the camera can only read license plates within a limited distance. We cannot guarantee the capture of all accident-related details.

For best image quality: Ensure that the windshield and camera lenses are clean, Do not use cleaning products that leave a residue (eg polish/anti-mist products) on the glass surface. Ensure that the angle of the dash camera is set so that the horizon is located in the center of the image (50% from the top-bottom). The use of the dash camera behind dark window tints will reduce image quality and increase motion blur.

8. Why the dash camera beeps and indicates it was a failed card?

In general, the memory card lifespan when used in the dash camera is about six months to 1 year of recording for a 64GB card. A card double the size will have about double the lifespan before being worn out. After this the memory card may become too slow for live video recording and errors will be detected.

A memory card may also suffer data corruption or failure due to static electricity and/or external voltage when being handled. For these reasons, we highly recommend the user copies or save important data to external media as soon as possible (e.g. Mobile Phone, hard disc, USB drive, etc.). It is strongly recommended to check for correct recording and then format the memory card regularly to ensure reliable recording and minimize memory card errors.

CAUTION!

1. Please place your device in a secure place and prevent the lens from scratches or dirt.
2. Do not expose the device to rain, moisture, or water under any circumstance.

3. Avoid leaving the device in direct sunlight for extended periods of time.
4. Do not dismantle or expose the internal battery

CUSTOMER SERVICE

support01@blogolestore.com

If you have any questions, please feel free to contact us, we will offer you the best solution

FCC Warning

This equipment has been tested and found to comply with the limits for a Class B digital device, pursuant to part 15 of the FCC Rules. These limits are designed to provide reasonable protection against harmful interference in a residential installation. This equipment generates, uses and can radiate radio frequency energy and, if not installed and used in accordance with the instructions, may cause harmful interference to radio communications. However, there is no guarantee that interference will not occur in a particular installation.

If this equipment does cause harmful interference to radio or television reception, which can be determined by turning the equipment off and on, the user is encouraged to try to correct the interference by one or more of the following measures:

- Reorient or relocate the receiving antenna.
- Increase the separation between the equipment and receiver.
- Connect the equipment into an outlet on a circuit different from that to which the receiver is connected.
- Consult the dealer or an experienced radio/TV technician for help.

Caution: Any changes or modifications to this device not explicitly approved by manufacturer could void your authority to operate this equipment.

This device complies with part 15 of the FCC Rules.

Operation is subject to the following two conditions:

1. This device may not cause harmful interference, and
2. this device must accept any interference received, including interference that may cause undesired operation.

The device has been evaluated to meet general RF exposure requirement.

This equipment complies with FCC radiation exposure limits set forth for an uncontrolled environment.

This equipment should be installed and operated with minimum distance 20cm between the radiator & your body.

IC warning statements:

-English Warning Statement:

RSS-GEN ISSUE 5, 8.4 User manual notice

This device contains license-exempt transmitter(s)/receiver(s) that comply with Innovation, Science and Economic Development Canada's license exempt RSS(s).

Operation is subject to the following two conditions:

1. This device may not cause interference.
2. This device must accept any interference, including interference that may cause undesired operation of the device.

The digital apparatus complies with Canadian CAN ICES-3 (B)/NMB-3(B).

Documents / Resources

	<p>Blogole B30 Dash Camera [pdf] User Manual B30, 2A3SE-B30, 2A3SEB30, B30 Dash Camera, Dash Camera, Camera</p>
---	---