

# BLNAN LS-CL-G3-24W-Dim-APPWYRGB Smart Ceiling Light With Remote and App Control User Manual

[Home](#) » [BLNAN](#) » BLNAN LS-CL-G3-24W-Dim-APPWYRGB Smart Ceiling Light With Remote and App Control User Manual 

## Contents

- 1 BLNAN LS-CL-G3-24W-Dim-APPWYRGB Smart Ceiling Light With Remote and App Control
- 2 INTRODUCTION
- 3 SPECIFICATION
- 4 OVERVIEW OF ANNAROR SMART CEILING LIGHT
- 5 2.4G REMOTE CONTROL INSTRUCTION
- 6 REMOTE CONTROL PAIRING
- 7 MEMORY FUNCTION
- 8 ACCESSORIES LIST
- 9 INSTALLATION STEPS
- 10 PRECAUTIONS
- 11 Documents / Resources

# BLNAN

BLNAN LS-CL-G3-24W-Dim-APPWYRGB Smart Ceiling Light With Remote and App Control

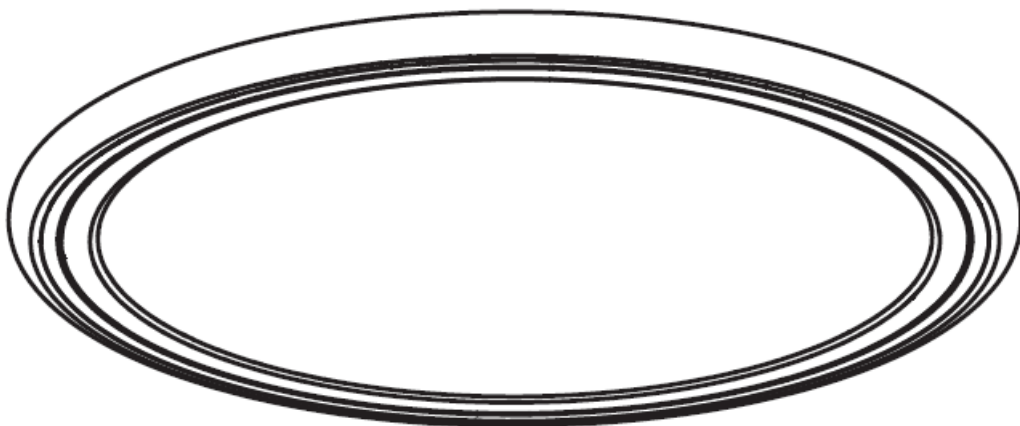

## INTRODUCTION

Thank you for choosing Annaror ceiling light. This product is suitable for indoor use and we hope that it will bring brightness and comfort to your home or office. If you have any questions or concerns during use, please do not hesitate to contact us via our brand email: support@blnan.net Our customer service team will be happy to assist you in a timely manner.

Take full control of your ceiling light with our product that seamlessly integrates with app and remote control. With RGB options and adjustable color temperature, create the perfect ambiance for any occasion

## SPECIFICATION

Model	LS-CL-G3-24W-Dim-APPWYRGB	
Size		30*2.SCM /11.B*0.98 inch
Power	24 Watts	
Voltage	AC1 20V	
Luminous flux	2400 Lumen	
Color temperature	3000K~6500K	
Color rendering index	90	
PGB	Static modes and dynamic modes	
APP	Tuya /Smart Life	
Material	PC	
Waterproof	IP40	
Remote control frequency	2.4G	
Remote control distance	IOM	
Lifetime	30000H	

## OVERVIEW OF ANNAROR SMART CEILING LIGHT

1. Compatible with Google Home and Alexa, supports voice control.
2. Choose from 16 million colors to make your life more colorful. Brightness & color temperature are adjustable {adjustable between 3000K-6500K}, and colors can be DIV.
3. Easily create different lighting atmospheres for different scenes.
4. Music mode (colors change continuously while music is playing).
5. Timer control through an app (Timer does not have memory function; the light will turn off when the time is up, and users need to set the timer again for future use).

## 2.4G REMOTE CONTROL INSTRUCTION

1. ON
2. OFF
3. Stepless dim up to 100% brightness

4. Step less dim down to 10% brightness with seamless adjustment
5. Adjust color temperature down to 3000K
6. Adjust color temperature up to 6500K
7. Signal button: Long press for 3-5 seconds to make the light flash 70 times quickly to enter WiFi connection mode; short press to activate night light mode (3000K, 70% brightness)
8. 7 RGB Colors
9. RGB cycle mode (fast/slow)
10. Different color temperatures (3000K/4000K/6500K)
11. Warm white: 3000K
12. Cool white: 6500K

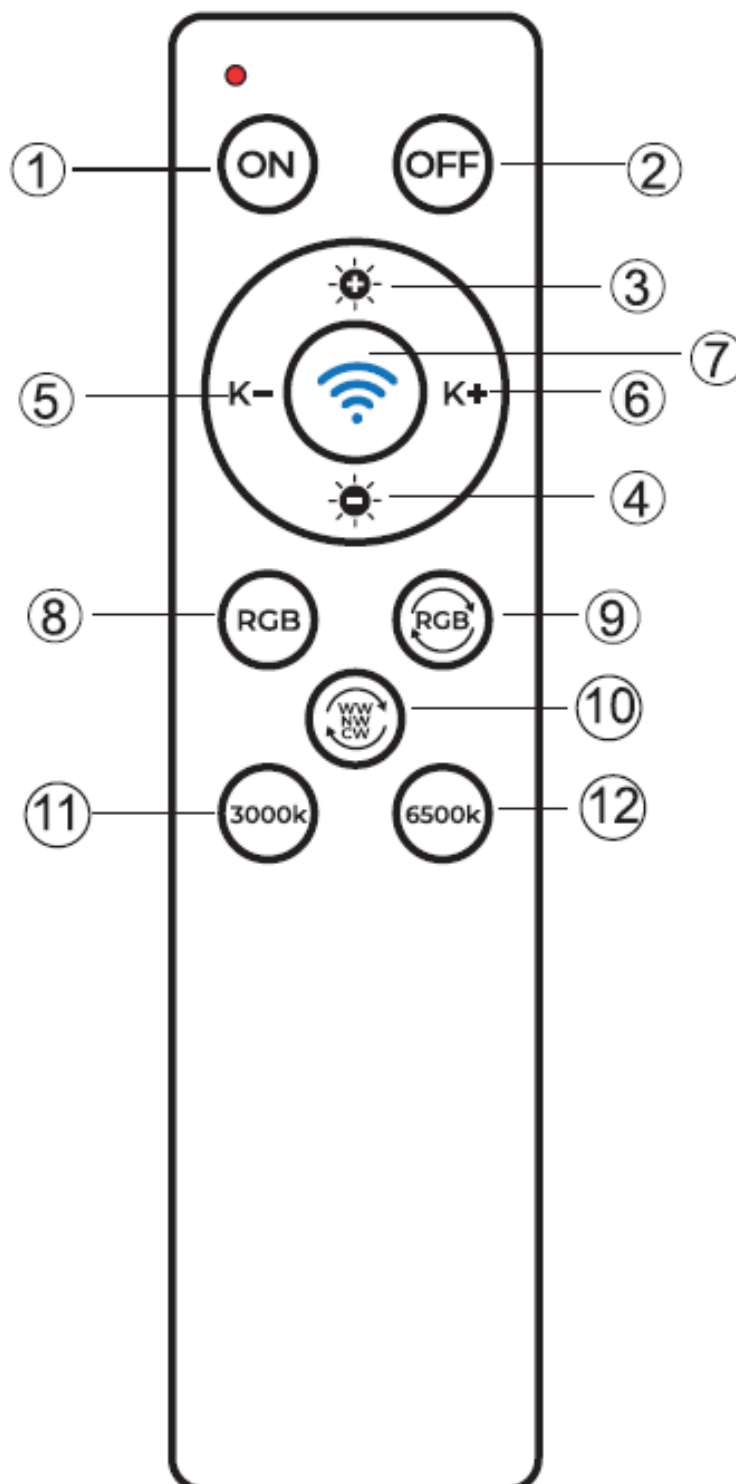

## REMOTE CONTROL PAIRING

### Steps to pair.

1. Power off for 10-20 seconds.
2. Power ON again.
3. Long press the "ON" button for 5 seconds to match the code, the light flashes once and the pairing is successful.

### Steps to cancel the pairing:

1. Power off for 10-20 seconds.
2. Power ON again.
3. Long press the "OFF" button for 5 seconds to match the code, the light flashes twice and the pairing is canceled.

### NOTE

1. Battery not included.
2. Not suitable for use with dimmer switches.
3. Remote control distance is within 10 meters.

## MEMORY FUNCTION

Remote and APP control: Except for the RGB cycling mode, all other modes can remember the last setting.

Wall switch: The current setting is kept for 1 minute and the ceiling light is turned on for more than 15 seconds, the light will remember the setting when it is turned back on. (except for RGB cycling).

APP and remote control can switch control.

## WALL SWITCH OPERATION INSTRUCTIONS

Change the 6500K-+ 3000K-+ 4000K-+ night light mode-+ RGB cycle mode in turn. (Do not fit for home dimmer!)

## ACCESSORIES LIST



Screw for  
junction box x2

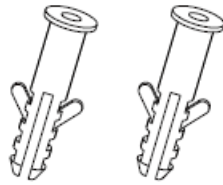

Anchor x2



Screw for anchor x2

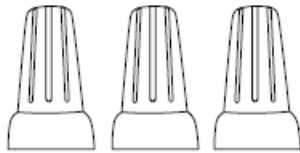

Wire nut x3



Remote control



Instruction for  
installation x1

## INSTALLATION STEPS

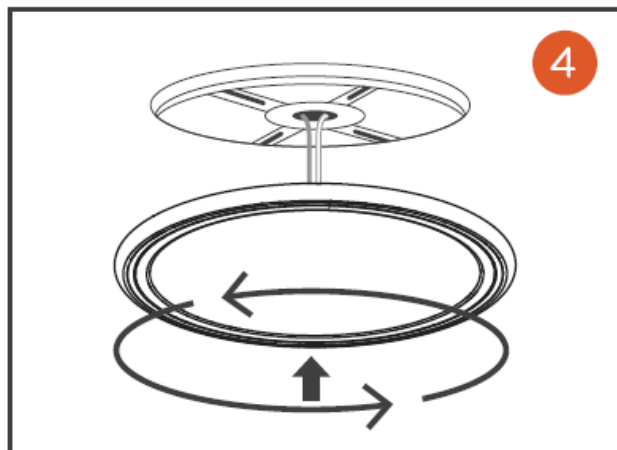
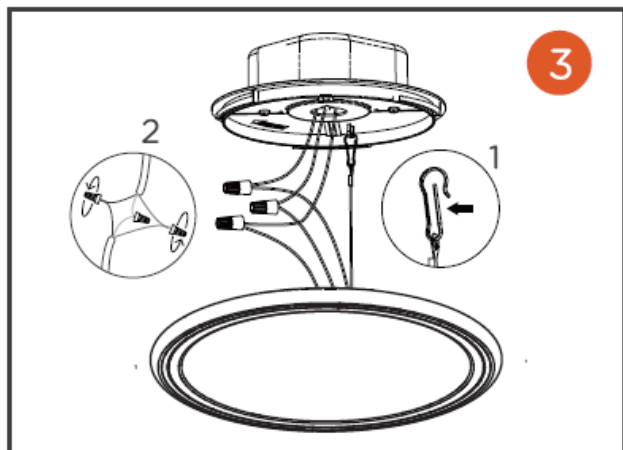
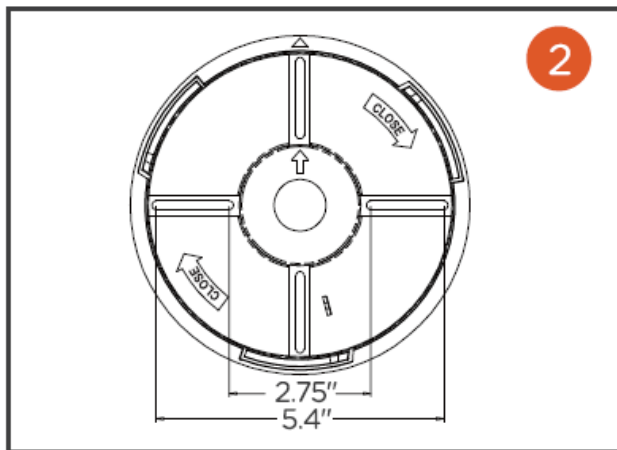
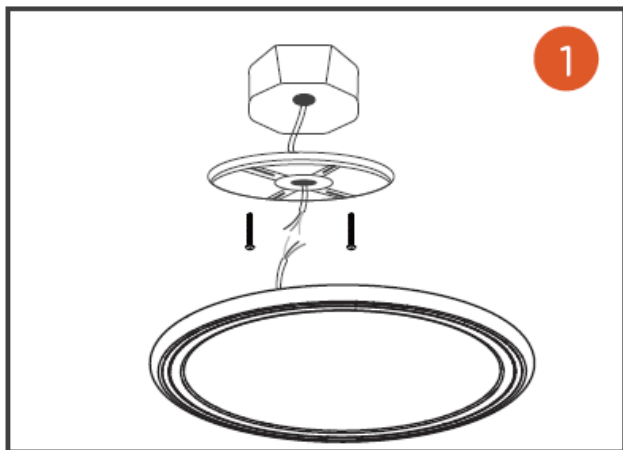

1. Please rotate and remove the base plate, fix the base plate to the junction box with screws provided.
2. Please use the correct size junction box. The screw hole distance of the junction box: 2.75-5.4 inches.
3. Hang up the wire rope and connect the wires of the corresponding color, then push and feed all wires up into the junction box.  
(Description of the supply terminals: Black: Hot Wire; White: Neutral Wire; Green: Ground Wire)
4. Please put the arrow on the base plate aiming at the arrow on the back of the lamp, push and rotate the lamp to install it on the base.

## PRECAUTIONS

### Precautions Before Installation

1. Power off before installation.
2. Do not exceed the rated voltage.
3. Do not install it on surfaces where are not stable or deformed.
4. Do not install it on or above the surface with high temperatures.
5. Please make sure that no gas, water, or electricity pipes and wires can be drilled through or damaged in your chosen mounting location.

### Precautions During Installation

1. There must be no corrosive, explosive, or flammable materials around the lamp.

2. User should connect the cable correctly, and the lamp should be installed by a qualified electrician.
3. Please pay attention to connecting the wires correctly, and make sure the cable connection comply with national regulations.
4. Please make sure that the lampshade is clear in case of low luminous efficiency.
5. Please make sure that illuminants are securely fixed during the installation.

### Precautions About the Product

1. It is not suitable for dimmers switches.
  2. The LED light source inside the lamp body can not replaceable.
  3. The lampshade cannot be opened.
  4. Do not touch the light when it is running.
  5. Do not look straight into the light source (illuminant, LED, etc.).
  6. Do not let the children touch this light and packaging to avoid danger.
- 

### Documents / Resources

	<p><a href="#">BLNAN LS-CL-G3-24W-Dim-APPWYRGB Smart Ceiling Light With Remote and App Control [pdf]</a> User Manual</p> <p>LS-CL-G3-24W-Dim-APPWYRGB Smart Ceiling Light With Remote and App Control, LS-CL-G3-24W-Dim-APPWYRGB, Smart Ceiling Light With Remote and App Control, Ceiling Light With Remote and App Control, Light With Remote and App Control, Remote and App Control, App Control, Control</p>
---	---