



BLITZWOLF BW-SS9 Wi-Fi Smart Wall Light Switch with APP Control User Manual

[Home](#) » [Blitzwolf](#) » BLITZWOLF BW-SS9 Wi-Fi Smart Wall Light Switch with APP Control User Manual 



User Manual BW-SS9

Contents

- [1 What's in the box](#)
- [2 Documents / Resources](#)

What's in the box

BW-SS9 Smart SwitchM, Screw 'Ceti. MA*1

II. To know the product

1. It is recommended to test the product performance before installation and use. and then install and debug after understanding the working principle of the product.
2. The smart switch is not just a functional switch, it is essentially an electrical appliance and can work independently.
3. The on/off button can be used as a reset button. long press to reset, the Been indicator lint flashes.
4. Only supports a 2.4GHz WIFI network (802.11 b/g/n), and the installation location is recommended to be within the Vii1F1 coverage.
5. Basic electrical wiring knowledge or experience is required. otherwise please consult a professional electrician.

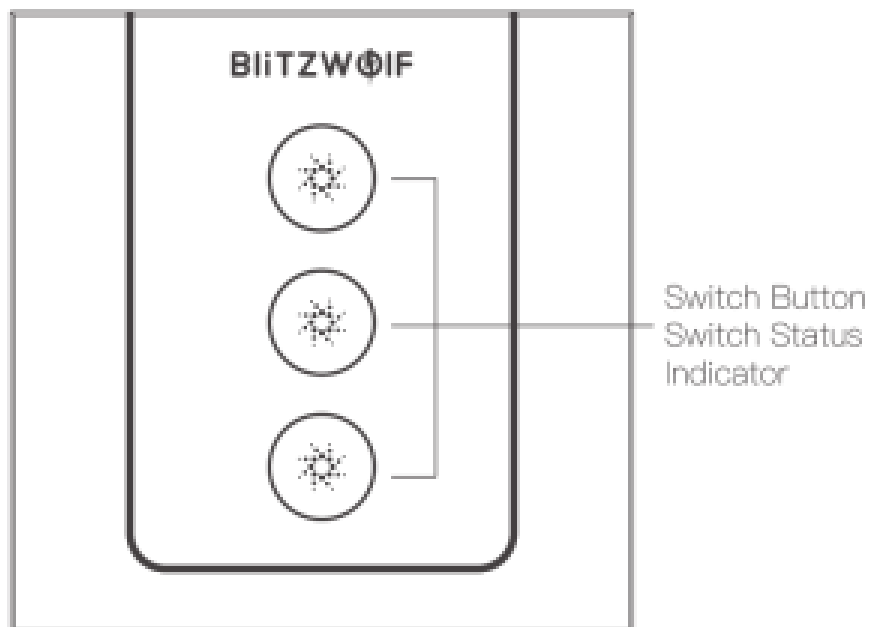

Note: The smart switch is divided into the panel and the back shell wiring part. The panel has switch buttons and indicator lights, and the wiring part of the rear shell should be wired according to the instruction diagram. Non-professionals are forbidden to disassemble the PC8 circuit panel for maintenance.

Indicator Meaning

Indicator Status	Indicator meaning	Trigger method
Switch Status Indicator Blue	The snarl light is turned on and the light is off	Power on
Switch Status Indicator Red	The light is turned on. touch to turn off the light	Trigger when the light is turned on
Switch Status Indicator Flashes Green	VVIFI to CO connected	It will enter the paired YOH state after powering on for the first time. When a forced reset is required, press and hold the first switch button for 20s to trigger.

General Parameters

Working Voltage	AC110-240V150/60Hz /
Maximum Load	800W/Gang
Working current	MAX 10A
Wireless Protocol	IEEE 802.11 b/g/n (2.4GHz WEL)
Material	Flame retardant ABS+ Glass
Size	86mm*86mm*34mm

III. How to use

1. Use a screwdriver to open the panel.

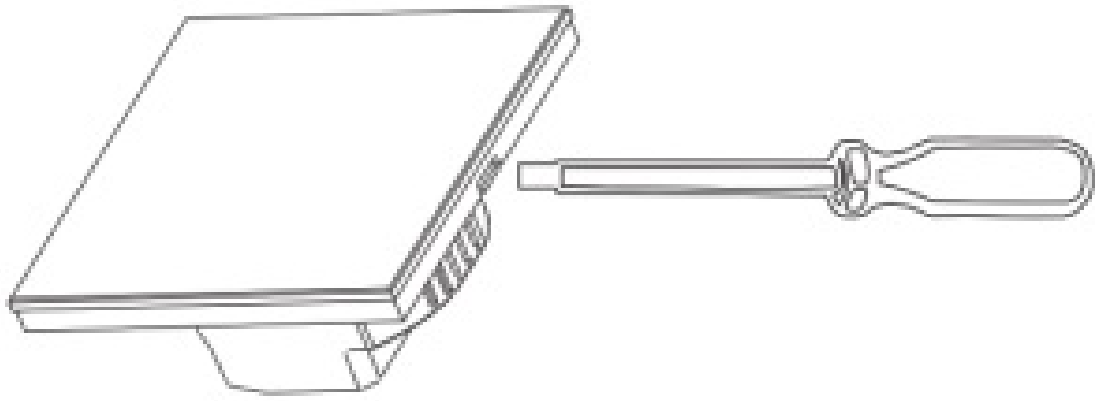

2. Corned as shown in the figure.

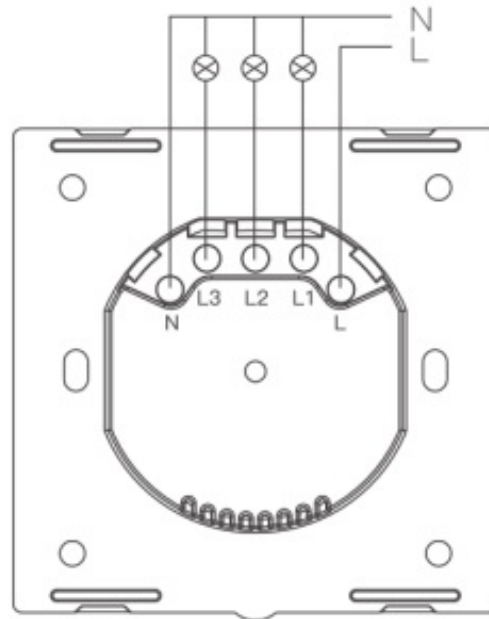

3. Use the screws in the saew package to fa and fix the rear cover panel.

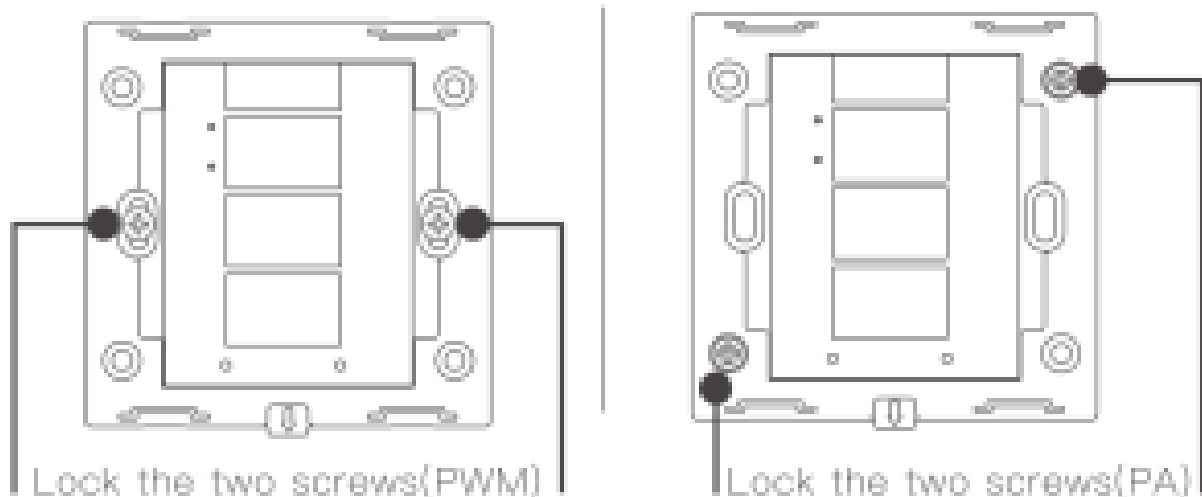

4. Connect to the pairing APP

The paired WIFI needs to use 2.4GHz VVIFI, and the password is entered correctly without special characters. The WIFI signal strength is high. It is recommended that the product is connected and paired. The *stance between the mobile phone and the WIFI is close. and the 501-tz WIFI does not support correcting this product. After the new installation is powered on, it is in the pairing state by the deal. If you are not in the pairing state, you need to press and hold the first switch button until the green indicator light flashes.

1. Scan QR code identification/search and download EIIIt2WclF APP In the APP Store



<https://smartapp.tuya.com/blitzhome>

2. Sign up for BlitzWolf APP
 3. Go to the home page of the APP, click + on the upper right corner, and select the corresponding device to add
 4. Confirm that the device WIFI icon is in flashing state and the device is in pairing state
 5. Press the operation prompt to enter the WIFI password
 6. Wait a moment to complete the pairing process and customize the device name
-
5. Learn to use and be familiar with your APP
 - * After the configuration is successful, you can control the Wifi light switch on the APP.
 - * The timer can be set for each group on the APP.
 - * App can share the control of the device with your family/friends.
 6. If you need to connect to Alexa, Google Home, IFTTT control, please follow the instructions in the APP to connect.

IV. Q&A

1. Failed to pair to WIFI

Check whether the WIFI password is entered correctly, whether the WIFI is 2.4GHz WIFI, the product, mobile phone and WIFI are close when connected, and the smart switch installation must be within the coverage of the WIFI signal. If the WIFI quick connection mode is unsuccessful, you can use the hotspot network distribution mode to search for the AP signal emitted by the smart switch.

2. Touch the switch button, the light is off

It is recommended to check whether the indicator light has changed, whether the lamp is burned out or has poor contact, and whether the wire connection is correct.

3. APP cannot remotely control the lamps

It is recommended to check whether the WIFI network can connect to the Internet normally and whether the smart switch has been successfully paired and bound in the APP.



SCHEUFER Technologies GmbH

Address: Hertleinstrasse 37, 91052, Erlangen, Germany

E-mail: Mark.Zhang@scheufer.com



VISHTEC UK Co.,Ltd

Address: Unit G25 Waterfront Studios, 1 DockRoad, London, E16 1 AH

E-mail: Vincent.feng@vish-tec.com

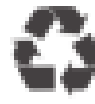

MADE IN CHINA



Documents / Resources

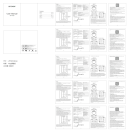

[BlitzWolf BW-SS9 Wi-Fi Smart Wall Light Switch with APP Control](#) [pdf] User Manual
BW-SS9, Wi-Fi Smart Wall Light Switch with APP Control

[Manuals+](#)