



## BLITZWOLF BW-CML4 Monitor Light Bar Rechargeable with APP Control User Manual

[Home](#) » [Blitzwolf](#) » BLITZWOLF BW-CML4 Monitor Light Bar Rechargeable with APP Control User Manual 

### BLITZWOLF BW-CML4 Monitor Light Bar Rechargeable with APP Control User Manual



#### Contents

- [1 Overview](#)
- [2 Quick Start](#)
  - [2.1 Installation Instructions](#)
- [3 App Operation](#)
- [4 Connect Amazon Alexa/Google Assistant](#)
- [5 Specifications](#)
- [6 Documents / Resources](#)
- [7 Related Posts](#)

#### Overview

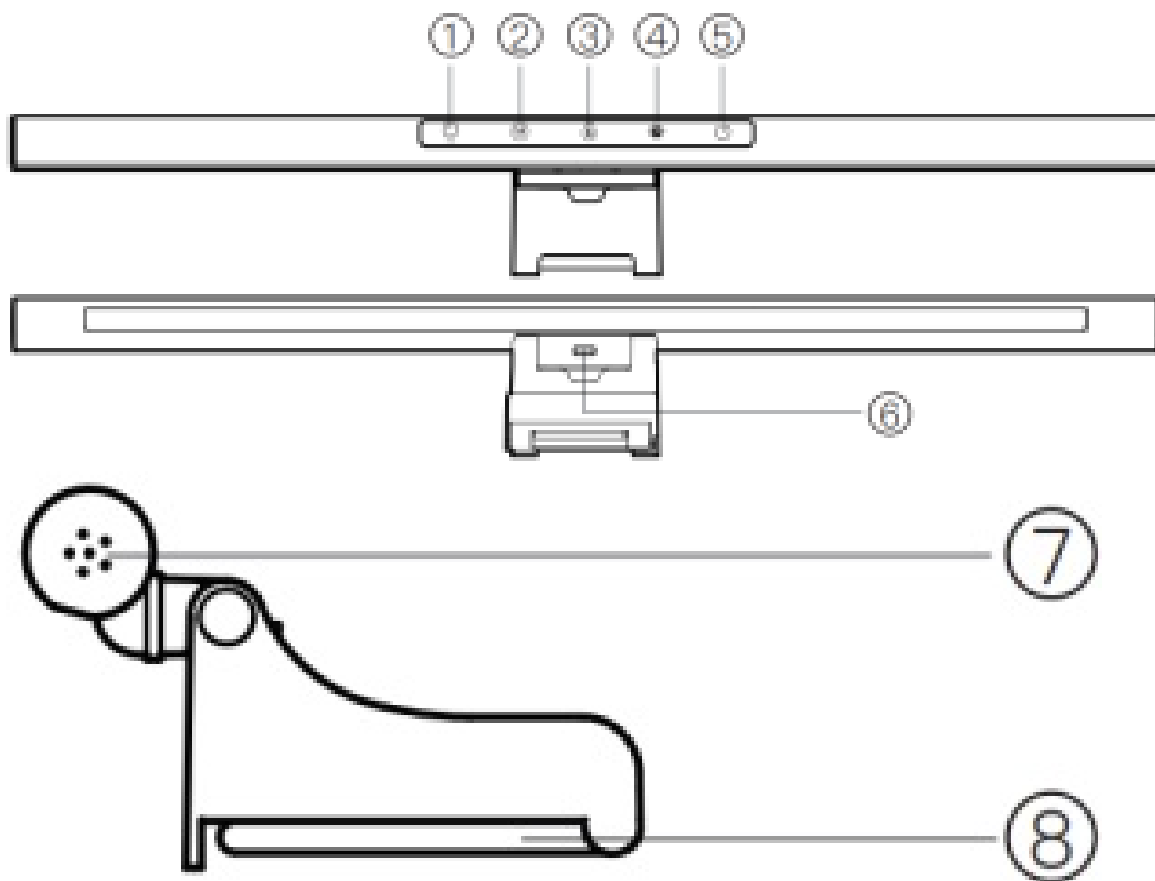

#### 1. RGB ON/OFF Button

Short press the RGB switch button to turn on/off the RGB light.

Long press the RGB switch button for about 5 seconds until the red light flashes to enter the APP connection mode.

#### 2. RGB Mode Switch Button

Short press the RGB mode switch button to turn on the four working modes Gradient Mode/Symphony Mode/Adjoint Mode/Classic mode.

#### 3. Color Temperature Adjustment Button

Press and hold the color temperature adjustment button to adjust the three-clock light color temperature: 3000K (warm light)/4000K (natural light)/6500K (cool light).

#### 4. Light Brightness Adjustment Button

Press and hold the light brightness adjustment button to adjust the brightness of the front lighting: 10%/20%/40%/60%/80%/100%.

#### 5. White Light ON/OFF Button

Click the white light on/off button to turn on/off the white light.

#### 6. Type-c Power Input

#### 7. Collect Music Microphone

#### 8. Install The Fixing Clip

### Quick Start

#### Installation Instructions

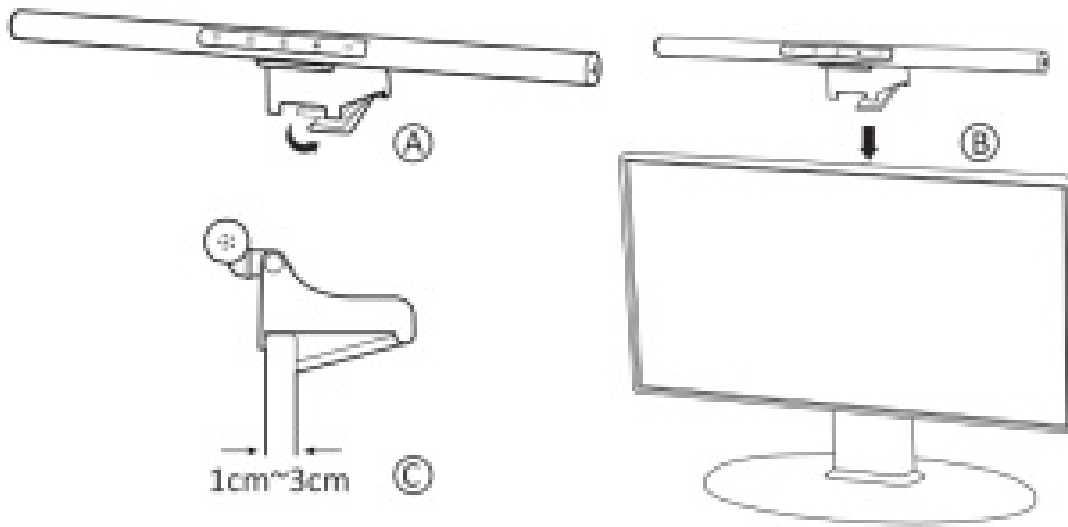

**Step 1:** Place the light bar with clip on top of your monitor, make sure the light bar is fixed.

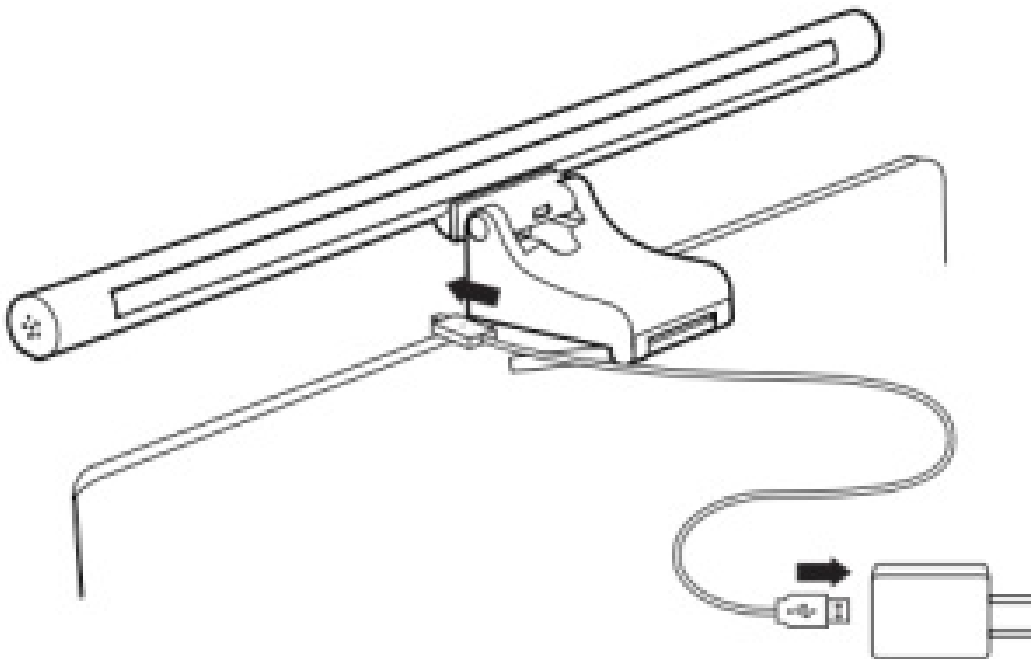

**Step 2:** To supply power to the light bar, it is recommended to use a 5V/2A power adapter.

## App Operation

Before starting the pairing, make sure your smartphone is connected to a 2.4GHz Wi-Fi network and turned on Bluetooth. If your router supports both 2.4G and 5G Wi-Fi, please separate the two frequency bands in the router settings, and select the 2.4G Wi-Fi to connection.

### Step 1. Install the App.

You can search for the “BlitzWolf”, “Tuya” and “SmartLife” App on the App Store/Google Play, and install it. Open the App and click “Register”, or if you have an account, click “Login.”

### Step 2. Connect your light bar to the App.

1. Enter the App, click “+” in the upper right corner, select “Lighting”, and click on “Light Source(BLE+Wi-Fi)” to add the Smart ScreenBar.
2. Power on the light bar.

Press and hold the RGB Light ON/OFF Button()for 5 seconds, to activate the red light into rapid blinking status, the light bar will be enter pairing mode( If the phone has Bluetooth turned on, the APP may automatically pop up the light bar pairing page).

3. Tap “Confirm indicator rapidly blink”, choose the Wi-Fi network and enter the Wi-Fi password, the App will detect to the light bar. 2.4 Wait for the light bar to configure successfully, then tap “Completed” to enter the device page.

**Connect Amazon Alexa/Google Assistant**

If you need voice control of the smart light bar (turn ON/OFF/change the color/adjust the brightness, etc.), please refer to the configuration instructions of the Alexa/Google Assistant control platform. And please make sure your Alexa App/Google Home App has been connected to Echo/Google Assistant.

**Specifications**

Model	BW-CML4
Rated Input	DC 5V 2A
Maximum Power	10W
Light Source	LED
Lamp Life	50,000h
Luminous Flux	200-250lm
Color Temperature	3000K-6500K
Color Rendering Index	90
Material	Aluminum Alloy+PC+ABS
Lamp Size	Φ2.2x48cm

MADE IN CHINA



Documents / Resources

	<p><a href="#">BLITZWOLF BW-CML4 Monitor Light Bar Rechargeable with APP Control</a> [pdf] User Manual</p> <p>BLITZWOLF BW-CML4 Monitor Light Bar Rechargeable with APP Control, BLITZWOLF BW-CML4, Monitor Light Bar Rechargeable with APP Control</p>
---	---